

SOMERSET ST. WEST

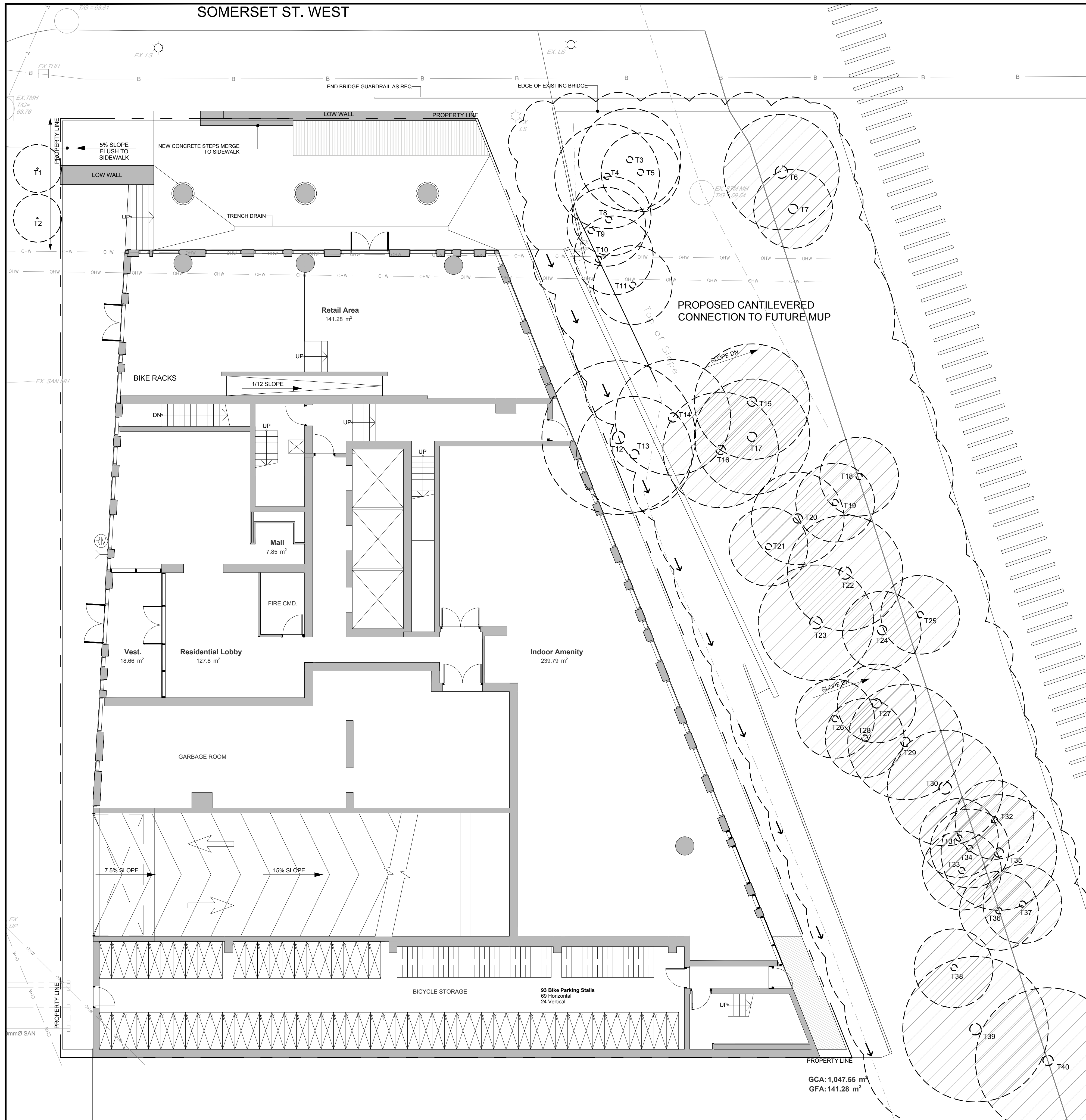

EXISTING TREE LIST

KEY	BOTANICAL NAME	COMMON NAME	SIZE	CONDITION	REMARKS	OWNER
T1	Gleditsia triacanthos	Honey Locust	200mm	GOOD	TO REMAIN	CITY OF OTTAWA
T2	Ulmus pumila	Siberian Elm	150mm	FAIR	TO REMAIN	CITY OF OTTAWA
T3	Acer negundo	Manitoba Maple	150mm	POOR	TO REMAIN	CITY OF OTTAWA
T4	Acer negundo	Manitoba Maple	150mm	FAIR	TO BE REMOVED	CITY OF OTTAWA
T5	Acer negundo	Manitoba Maple	150mm	GOOD	TO BE REMOVED	CITY OF OTTAWA
T6	Acer negundo	Manitoba Maple	300mm	GOOD	TO REMAIN	CITY OF OTTAWA
T7	Acer negundo	Manitoba Maple	200mm	GOOD	TO REMAIN	CITY OF OTTAWA
T8	Acer negundo	Manitoba Maple	150mm	GOOD	TO BE REMOVED	CITY OF OTTAWA
T9	Acer negundo	Manitoba Maple	150mm	GOOD	TO BE REMOVED	CITY OF OTTAWA
T10	Acer negundo	Manitoba Maple	150mm	GOOD	TO BE REMOVED	CITY OF OTTAWA
T11	Acer negundo	Manitoba Maple	150mm	GOOD	TO BE REMOVED	CITY OF OTTAWA
T12	Acer negundo	Manitoba Maple	250mm	GOOD	TO BE REMOVED	CITY OF OTTAWA
T13	Acer negundo	Manitoba Maple	200mm	GOOD	TO BE REMOVED	CITY OF OTTAWA
T14	Acer negundo	Manitoba Maple	200mm	GOOD	TO BE REMOVED	CITY OF OTTAWA
T15	Acer negundo	Manitoba Maple	250mm	GOOD	TO REMAIN	CITY OF OTTAWA
T16	Acer negundo	Manitoba Maple	250mm	GOOD	TO REMAIN	CITY OF OTTAWA
T17	Acer negundo	Manitoba Maple	250mm	GOOD	TO REMAIN	CITY OF OTTAWA
T18	Acer negundo	Manitoba Maple	100mm	GOOD	TO REMAIN	CITY OF OTTAWA
T19	Acer negundo	Manitoba Maple	100mm	GOOD	TO REMAIN	CITY OF OTTAWA
T20	Acer negundo	Manitoba Maple	250mm	GOOD	TO REMAIN	CITY OF OTTAWA
T21	Acer negundo	Manitoba Maple	150mm	GOOD	TO REMAIN	CITY OF OTTAWA
T22	Acer negundo	Manitoba Maple	250mm	GOOD	TO REMAIN	CITY OF OTTAWA
T23	Acer negundo	Manitoba Maple	250mm	GOOD	TO REMAIN	CITY OF OTTAWA
T24	Acer negundo	Manitoba Maple	200mm	GOOD	TO REMAIN	CITY OF OTTAWA
T25	Acer negundo	Manitoba Maple	150mm	GOOD	TO REMAIN	CITY OF OTTAWA
T26	Acer negundo	Manitoba Maple	150mm	GOOD	TO REMAIN	CITY OF OTTAWA
T27	Acer negundo	Manitoba Maple	200mm	GOOD	TO REMAIN	CITY OF OTTAWA
T28	Acer negundo	Manitoba Maple	150mm	GOOD	TO REMAIN	CITY OF OTTAWA
T29	Acer negundo	Manitoba Maple	200mm	GOOD	TO REMAIN	CITY OF OTTAWA
T30	Acer negundo	Manitoba Maple	250mm	GOOD	TO REMAIN	CITY OF OTTAWA
T31	Acer negundo	Manitoba Maple	100mm	GOOD	TO REMAIN	CITY OF OTTAWA
T32	Acer negundo	Manitoba Maple	200mm	GOOD	TO REMAIN	CITY OF OTTAWA
T33	Acer negundo	Manitoba Maple	150mm	GOOD	TO REMAIN	CITY OF OTTAWA
T34	Acer negundo	Manitoba Maple	100mm	GOOD	TO REMAIN	CITY OF OTTAWA
T35	Acer negundo	Manitoba Maple	200mm	GOOD	TO REMAIN	CITY OF OTTAWA
T36	Acer negundo	Manitoba Maple	150mm	GOOD	TO REMAIN	CITY OF OTTAWA
T37	Acer negundo	Manitoba Maple	150mm	GOOD	TO REMAIN	CITY OF OTTAWA
T38	Acer negundo	Manitoba Maple	100mm	GOOD	TO REMAIN	CITY OF OTTAWA
T39	Salix sp.	Willow	500mm	GOOD	TO REMAIN	CITY OF OTTAWA
T40	Salix sp.	Willow	600mm	GOOD	TO REMAIN	CITY OF OTTAWA

NOTE REGARDING THE REMOVAL OR DAMAGE OF EXISTING TREES:
 A CITY OF OTTAWA TREE REMOVAL PERMIT FROM THE PLANNING AND GROWTH MANAGEMENT DEPARTMENT IS REQUIRED TO REMOVE ANY OF THE TREES INDICATED FOR REMOVAL ON THIS PLAN. IN ADDITION TO THIS, THE CONTRACTOR IS TO RECEIVE APPROVAL FROM THE OWNER'S OF ADJACENT PROPERTIES WHERE THE TREES MAY BE ON OR CLOSE TO THE PROPERTY LINE SUCH AS ALONG THE EAST LOT LINE OF THE SUBJECT PROPERTY. PROPERTY OWNERS AND THE CITY OF OTTAWA PLANNING AND GROWTH MANAGEMENT DEPARTMENT MUST BE NOTIFIED PRIOR TO ANY ACTIVITY WITHIN THE CRITICAL ROOT ZONE (CRZ) OF EXISTING TREES TO REMAIN. THE CITY OF OTTAWA PLANNING AND GROWTH MANAGEMENT DEPARTMENT IS TO APPROVE IN WRITING THE REMOVAL OF ANY ADDITIONAL TREES TO BE REMOVED WHICH ARE NOT INDICATED ON THIS PLAN.

GENERAL NOTES:
 1. It is the responsibility of the appropriate contractor or official to report any errors, omissions or discrepancies on this plan with actual site conditions to the Landscape Architect before proceeding with construction.
 2. The contractor is to notify all utility companies and authorities prior to any excavation and ascertain locations of underground services.
 3. The contractor is to reinstaite all areas and items damaged as a result of construction activity.
 4. The contractor is to comply with all pertinent codes and by-laws.
 5. The contractor is to maintain a positive surface run-off throughout the entire construction period.
 6. The Landscape Architect is not responsible for subsurface conditions.
 7. The contractor is to identify all existing trees to remain on site with the Landscape Architect prior to construction.

CLIENT
 Claridge Homes
 2001 Gladstone Ave., Suite 210
 Ottawa, ON
 Tel: (613) 233-6030

CONSULTANTS
 ARCHITECTS:

 architectsAlliance
 205-317 Avenue St. West
 Toronto, Ontario M5V 1Y9
 T 416 593 4000
 F 416 593 4111
 info@architectsalliance.com

SURVEYORS:
 ANNS O' SULLIVAN VOLLEBEKK LTD.
 14 CONCOURSE GATE, SUITE 500, NEPEAN, ON
 Tel: (613) 727-0850

CIVIL ENGINEERS:
 NOVATECH ENG. CONSULTANTS LTD.
 240 MICHAEL COMPTON DRIVE, SUITE 200, OTTAWA, ON
 Tel: (613) 234-9643

LEGEND

1	ISSUED FOR COMMENT AND REVIEW	02/19/2021	WF	JL
No.	Issue	Date	Drawn	DR
		MM/DD/YY		CK

JAMES B. LENNOX & ASSOCIATES INC.
 LANDSCAPE ARCHITECTS
 3332 CARLING AVE. OTTAWA, ONTARIO K2H 5A8
 Tel. (613) 722-5168 Fax. (613) 343-3942

PROJECT
 1040 SOMERSET
 1040 SOMERSET STREET WEST, OTTAWA

DRAWING
 TREE CONSERVATION REPORT

STAMP

SCALE
 AS SHOWN

START DATE
 JANUARY, 2013

PROJECT NO.
 13-CLG-1316

PROJECT NORTH

DRAWING NO.
 L.1

PLOT SIZE ARCH-D