

WATERIDGE VILLAGE

BLOCKS 22



NAK PROJECT NO. 20-076

PROJECT ADDRESS:
OTTAWA, ON

ISSUED FOR THIRD SITE PLAN CONTROL APPLICATION
DECEMBER, 2020

LIST OF DRAWINGS:

NAK	
L00	- COVER SHEET
L01	- LANDSCAPE PLAN
L02	- PLANTING PLAN
DETAILS	
D01	- DETAILS
D02	- DETAILS

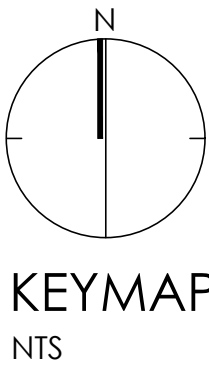

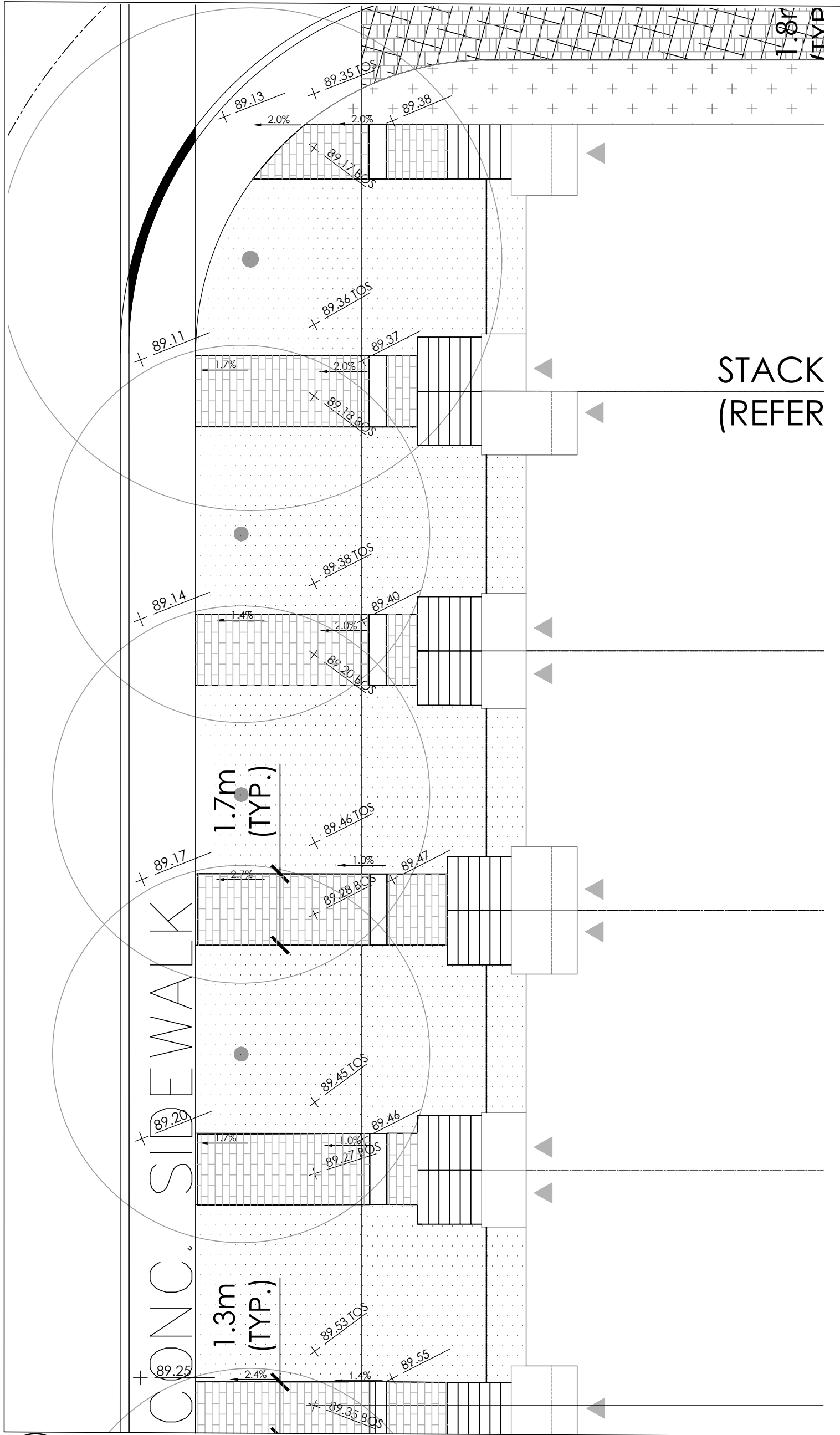
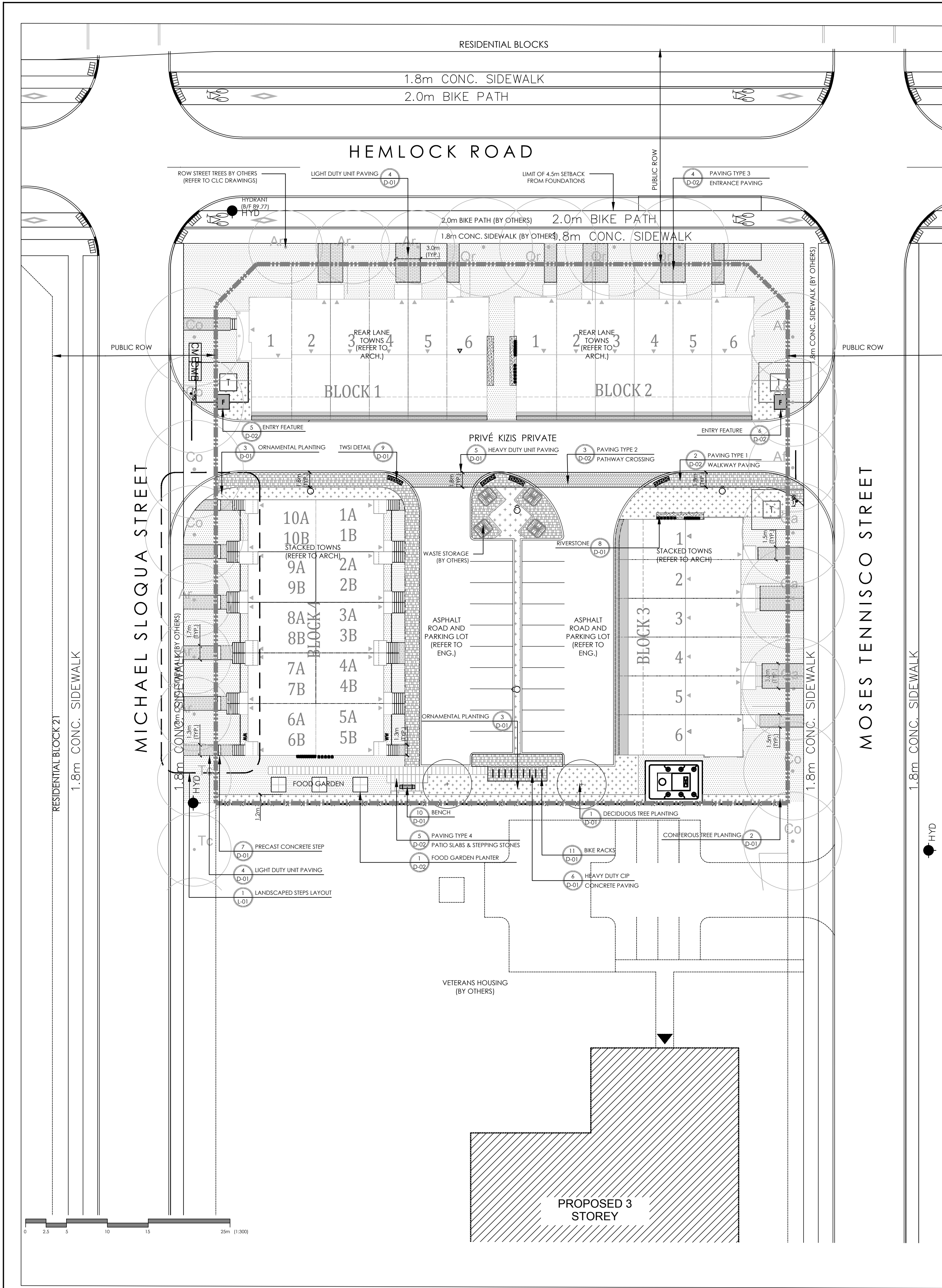

1 LANDSCAPED STEPS LAYOUT
1:100

LAYOUT NOTES:

- ALL WORKS AND MATERIALS SHALL CONFORM TO THE LATEST REVISION OF THE STANDARDS AND SPECIFICATIONS FOR THE CITY OF OTTAWA, ONTARIO PROVINCIAL STANDARD DRAWINGS (OPS) AND SPECIFICATIONS (OPS), WHERE APPLICABLE. LOCAL UTILITY STANDARDS AND MINISTRY OF TRANSPORTATION STANDARDS WILL APPLY WHERE REQUIRED.
- THE CONTRACTOR SHALL CONFIRM THE LOCATION OF ALL EXISTING UTILITIES WITHIN THE SITE AND ADJACENT WORK AREAS. THE CONTRACTOR SHALL BE RESPONSIBLE FOR PROTECTING ALL EXISTING UTILITIES TO THE SATISFACTION OF THE AUTHORITY HAVING JURISDICTION. THE CONTRACTOR SHALL BE RESPONSIBLE FOR THE REPAIR OR REPLACEMENT OF ANY SERVICES OR UTILITIES DISTURBED DURING CONSTRUCTION, TO THE SATISFACTION OF THE AUTHORITY HAVING JURISDICTION.
- ALL DIMENSIONS SHALL BE CHECKED AND VERIFIED IN THE FIELD BY THE CONTRACTOR PRIOR TO THE START OF CONSTRUCTION. ANY DISCREPANCIES SHALL BE REPORTED IMMEDIATELY TO THE LANDSCAPE ARCHITECT, LOST TIME DUE TO FAILURE OF THE CONTRACTOR TO CONFIRM UTILITY LOCATIONS AND NOTIFY LANDSCAPE ARCHITECT OF POSSIBLE CONFLICTS PRIOR TO CONSTRUCTION WILL BE AT THE CONTRACTORS EXPENSE.
- ANY AREAS BEYOND THE LIMIT OF THE SITE DISTURBED DURING CONSTRUCTION SHALL BE RESTORED TO ORIGINAL CONDITION OR BETTER TO THE SATISFACTION OF THE AUTHORITY HAVING JURISDICTION AT THE CONTRACTORS EXPENSE.
- ALL WORK SHALL BE COMPLETED IN ACCORDANCE WITH THE 'OCCUPATIONAL HEALTH AND SAFETY ACT AND REGULATIONS FOR CONSTRUCTION PROJECTS'. THE GENERAL CONTRACTOR SHALL BE DEEMED TO BE THE 'CONSTRUCTOR' AS DEFINED IN THE ACT.
- ALL CONSTRUCTION SIGNAGE MUST CONFORM TO THE MINISTRY OF TRANSPORTATION OF ONTARIO MANUAL OF UNIFORM TRAFFIC CONTROL DEVICES PER LATEST AMENDMENT.
- ALL DIMENSIONS ARE IN METRES UNLESS SPECIFIED OTHERWISE.
- THERE WILL BE NO SUBSTITUTION OF MATERIALS UNLESS PRIOR WRITTEN APPROVAL IS RECEIVED FROM THE LANDSCAPE ARCHITECT.
- ALL CONSTRUCTION SHALL BE CARRIED OUT IN ACCORDANCE WITH THE RECOMMENDATIONS MADE IN THE GEOTECHNICAL INVESTIGATION, PROPOSED RESIDENTIAL BLOCK 15, 22, 24, BY PATERSON GROUP DATED AUGUST 8, 2017.
- THE CONTRACTOR IS RESPONSIBLE FOR OBTAINING ALL PERMITS REQUIRED AND TO BEAR THE COST OF THE SAME.
- BENCHMARKS: IT IS THE RESPONSIBILITY OF THE CONTRACTOR TO VERIFY THAT THE SITE BENCHMARK(S) HAS NOT BEEN ALTERED OR DISTURBED AND THAT ITS RELATIVE ELEVATION AND DESCRIPTION AGREES WITH THE INFORMATION DEPICTED ON THIS PLAN.
- THE LANDSCAPE ARCHITECT SHALL APPROVE ANY MODIFICATIONS ON-SITE PRIOR TO CONSTRUCTION.
- CONTRACTOR SHALL EMPLOY QUALIFIED SURVEYOR AT THEIR EXPENSE TO SET FINISHED GRADE STAKES AND MAINTAIN GRADE CONTROL AND LAYOUT UNTIL SUBSTANTIAL COMPLETION OF WORK.

GENERAL NOTES:

- ALL LANDSCAPE DRAWINGS TO BE READ IN CONJUNCTION WITH SITE PLAN AND GRADING PLAN.
- ALL DIMENSIONS SHALL BE CHECKED AND VERIFIED IN THE FIELD BY THE CONTRACTOR PRIOR TO THE START OF CONSTRUCTION. ANY DISCREPANCIES SHALL BE REPORTED IMMEDIATELY TO THE LANDSCAPE ARCHITECT AND ENGINEER, LOST TIME DUE TO FAILURE OF THE CONTRACTOR TO CONFIRM UTILITY LOCATIONS AND NOTIFY ENGINEER OF POSSIBLE CONFLICTS PRIOR TO CONSTRUCTION WILL BE AT THE CONTRACTORS EXPENSE.
- REPORT ANY DISCREPANCIES TO THE LANDSCAPE ARCHITECT PRIOR TO COMMENCING WORK. NO RESPONSIBILITY IS BORNE BY THE CONTRACT ADMINISTRATOR FOR UNKNOWN SURFACE CONDITIONS.
- REINSTATE ALL AREAS AND ITEMS DAMAGED ON SITE AND REPORT ANY ERRORS AND/OR OMISSIONS TO LANDSCAPE ARCHITECT. ANY AREAS BEYOND THE LIMIT OF THE SITE DISTURBED DURING CONSTRUCTION SHALL BE RESTORED TO ORIGINAL CONDITION OR BETTER TO THE SATISFACTION OF THE AUTHORITY HAVING JURISDICTION AT THE CONTRACTORS EXPENSE.
- ALL WORKS AND MATERIALS SHALL CONFORM TO THE LATEST REVISION OF THE STANDARDS AND SPECIFICATIONS FOR THE CITY OF OTTAWA, ONTARIO PROVINCIAL STANDARD DRAWINGS (OPS) AND SPECIFICATIONS (OPS), WHERE APPLICABLE. LOCAL UTILITY STANDARDS AND MINISTRY OF TRANSPORTATION STANDARDS WILL APPLY WHERE REQUIRED.
- THERE WILL BE NO SUBSTITUTION OF MATERIALS UNLESS PRIOR WRITTEN APPROVAL IS RECEIVED FROM THE LANDSCAPE ARCHITECT.
- ALL CONSTRUCTION SHALL BE CARRIED OUT IN ACCORDANCE WITH THE RECOMMENDATIONS MADE IN THE GEOTECHNICAL INVESTIGATION, PROPOSED BY PATERSON GROUP.
- THE CONTRACTOR IS RESPONSIBLE FOR OBTAINING ALL PERMITS REQUIRED AND TO BEAR THE COST OF THE SAME.
- ALL WORK SHALL BE COMPLETED IN ACCORDANCE WITH THE 'OCCUPATIONAL HEALTH AND SAFETY ACT AND REGULATIONS FOR CONSTRUCTION PROJECTS'. THE GENERAL CONTRACTOR SHALL BE DEEMED TO BE THE 'CONSTRUCTOR' AS DEFINED IN THE ACT.
- ALL CONSTRUCTION SIGNAGE MUST CONFORM TO THE MINISTRY OF TRANSPORTATION OF ONTARIO MANUAL OF UNIFORM TRAFFIC CONTROL DEVICES PER LATEST AMENDMENT.
- THE CONTRACTOR IS ADVISED THAT WORKS BY OTHERS MAY BE ONGOING DURING THE PERIOD OF THIS CONTRACT. THE CONTRACTOR SHALL COORDINATE CONSTRUCTION ACTIVITIES TO PREVENT CONFLICTS.
- SHOULD DEEPLY BURIED ARCHAEOLOGICAL REMAINS BE FOUND ON THE PROPERTY DURING CONSTRUCTION ACTIVITIES, THE HERITAGE OPERATIONS UNIT OF THE ONTARIO MINISTRY OF CULTURE MUST BE NOTIFIED IMMEDIATELY.
- THE LOCATION OF THE TREES SHOWN ON THIS PLAN IS APPROXIMATE AND SHALL NOT BE SCALED FROM THIS DRAWING. THIS PLAN MUST BE READ IN CONJUNCTION WITH THE APPROVED CLIP AND CITY CROSS SECTIONS.
- THE CONTRACTOR SHALL CONFIRM THE LOCATION OF ALL EXISTING UTILITIES WITHIN THE SITE AND ADJACENT WORK AREAS. THE CONTRACTOR SHALL BE RESPONSIBLE FOR PROTECTING ALL EXISTING UTILITIES TO THE SATISFACTION OF THE AUTHORITY HAVING JURISDICTION. THE CONTRACTOR SHALL BE RESPONSIBLE FOR THE REPAIR OR REPLACEMENT OF ANY SERVICES OR UTILITIES DISTURBED DURING CONSTRUCTION, TO THE SATISFACTION OF THE AUTHORITY HAVING JURISDICTION.
- DRAWINGS SHALL BE READ IN CONJUNCTION WITH THE CIVIL, LIGHTING AND ARCHITECTURAL DRAWINGS.
- CONTRACTOR SHALL EMPLOY QUALIFIED SURVEYOR AT THEIR EXPENSE TO SET FINISHED GRADE STAKES AND MAINTAIN GRADE CONTROL AND LAYOUT UNTIL SUBSTANTIAL COMPLETION OF WORK.
- BENCHMARKS: IT IS THE RESPONSIBILITY OF THE CONTRACTOR TO VERIFY THAT THE SITE BENCHMARK(S) HAS NOT BEEN ALTERED OR DISTURBED AND THAT ITS RELATIVE ELEVATION AND DESCRIPTION AGREES WITH THE INFORMATION DEPICTED ON THIS PLAN.
- TREE PLANTING GUIDELINE
APPROVED CROSS SECTIONS SHALL TAKE PRECEDENCE
4.5M - STREET LIGHT
2.5M - STREET LIGHT (SMALL TREE <7M MATURE HT.)
3.0M - HYDRO TRANSFORMER ACCESS DOOR
1.5M - HYDRO TRANSFORMER SIDES AND BACKS
1.0M - HYDRO LATERAL
1.5M - PATH, DRIVEWAY, FENCE
4.5M - CONIFERS MINIMUM SETBACK FROM CURB
2.5M - FIRE HYDRANTS
1.5M - WATER SERVICE / CURB STOP
1.0M - BELL / CABLE PEDESTALS

KEY PLAN

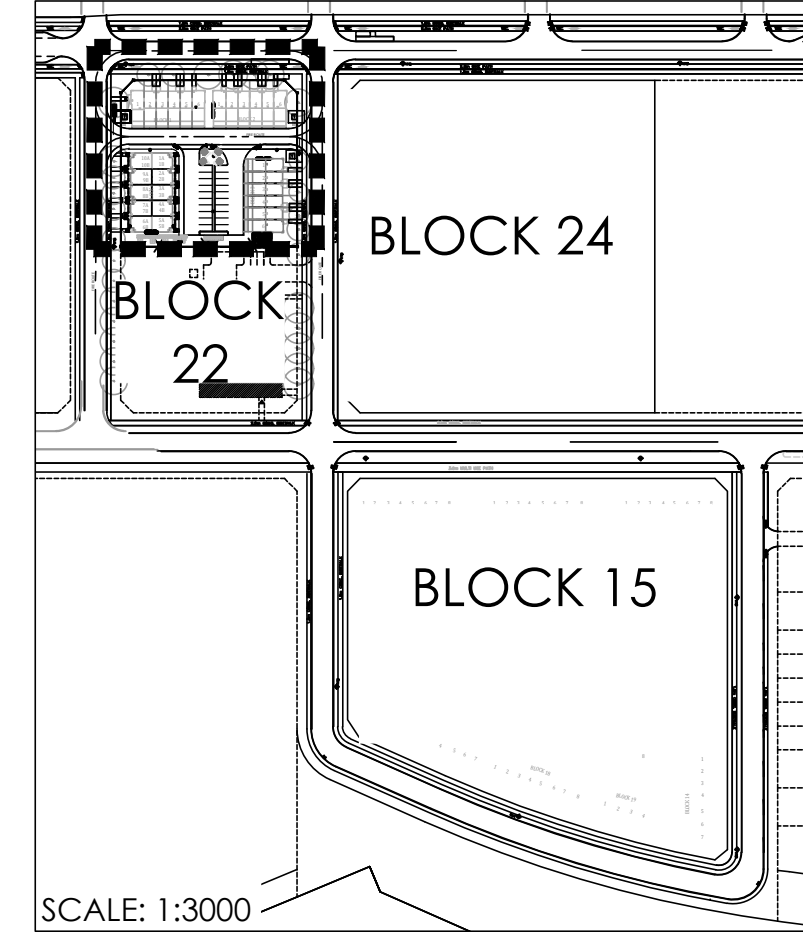

Contractor shall check all dimensions on the work and report any discrepancy to the Landscape Architect before proceeding. All drawings and specifications are the property of the Landscape Architect and must be returned at the completion of the work. This drawing is not to be used for construction until signed by the Landscape Architect.



LEGEND

LIMIT OF WORK	
FENCING	
2.0m HT GARBAGE ENCLOSURE FENCE	
SURFACING	
LIGHT DUTY UNIT PAVING - TYPE 1	
HEAVY DUTY UNIT PAVING - TYPE 2	
LIGHT DUTY ENTRANCE PAVING - TYPE 3	
HEAVY DUTY CIP CONCRETE PAVING	
RIVERSTONE EDGING	
STEPPING STONE CONCRETE SLAB	
PLANTING	
STREET TREES (BY OTHERS)	
ORNAMENTAL PLANTING	
FOOD GARDEN	
SOD	
AMENITIES	
BENCH	
ART FEATURES	
BIKE RACK	
DETAIL KEY	
DETAIL NO.	
SHEET NO.	

5	Issued for 3rd Site Plan Control Application	18.12.20
4	Issued for 2nd Site Plan Control Application	30.09.20
3	Issued for 1st Site Plan Control Application	05.26.20
2	Issued for Coordination	05.05.20
1	Issued for 1st Submission Client Review	22.04.20
No.	Description	Date
Revision		
City Approval Stamp		

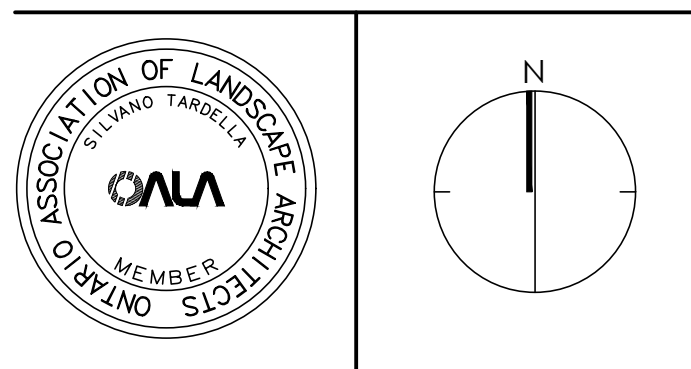

NAK
design strategies
1285 WELLINGTON STREET WEST, OTTAWA, ON K1Y 3A8 CANADA
T 613.237.2345 F 613.237.6423 NAKDESIGNSTRATEGIES.COM
Project

WATERIDGE VILLAGE

Title	LANDSCAPE PLAN BLOCK 22
Date	DEC. 2020
Scale	1:300
Drawn	EJ
Checked	TM
Job No.	20-076
Sheet	L-01

KEY	QTY.	BOTANICAL NAME	COMMON NAME	NATIVE (N)	MATURE SIZE (HT./WD.)	CAL/HT. (mm)	ROOT
MEDIUM OR LARGE DECIDUOUS TREES							
GB	2	GINKGO BILOBA 'AUTUMN GOLD'	AUTUMN GOLD MAIDENHAIR TREE	C	15m/10m	50	W.B.
CONIFEROUS TREES							
TE	47	THUJA OCCIDENTALIS 'EMERALD'	EMERALD CEDAR	C	5m/1.25m	200cm	B&B
DECIDUOUS SHRUBS							
CK	54	CORNUS SERICEA 'KELSEY'	KELSEY DWARF DOGWOOD	C	0.6m/0.6m	60cm	3 GAL
Cs	4	CORNUS SERICEA	RED OSIER DOGWOOD	N	2m/2.5m	60cm	3 GAL
Ca	25	CEANOTHUS AMERICANUS	NEW JERSEY TEA	N	1.25m/1.25m	60cm	3 GAL
Va	15	VIBURNUM ACERIFOLIUM	MAPLE LEAF VIBURNUM	N	1.75m/1.25m	60cm	3 GAL
VI	16	VIBURNUM TRELOBIUM 'COMPACTUM'	DWARF AMERICAN CRANBERRY	C	1.5m/1.5m	60cm	3 GAL
CONIFEROUS AND EVERGREEN SHRUBS							
Js	23	JUNIPERUS SABINA 'TAM ARSICIFOLIA'	TAM ARIX JUNIPER	O	0.6m/2m	60cm	3 GAL
GRASSES/PERENNIALS/FERNS							
dc	37	DESCHAMPSIA CESPITOSA	TUFTED HAIR GRASS	N	0.9m/0.8m	30cm	1 GAL
ep	10	ECHINACEA PURPUREA	PURPLE CONEFLOWERS	N	1.2m/0.6m	30cm	1 GAL
ss	150	SCHIZACHYRIUM SCOPARIUM	LITTLE BLUESTEM	N	0.8m/0.6m	30cm	1 GAL
NATIVE LEGEND							
N	NATIVE						
C	CULTIVAR OF NATIVE SPECIES						
O	NON-NATIVE						

*CULTIVARS OF NATIVE SPECIES MAY BE SPECIFIED DEPENDING ON LANDSCAPE VALUE.
**STREET TREES BY OTHERS. REFER TO CLC DRAWINGS

STREET TREES (BY OTHERS)

Af Acer Rubrum
Af Acer x freemanii 'Celebration'
As Acer saccharum 'Commemoration'
Co Celtis occidentalis
Ct Gleditsia triacanthos
Qa Quercus alba
Or Quercus rubra
Tc Tilia cordata
Uw Ulmus wilsonii 'Prospector'

Ams Amelanchier laevis 'Spring Flurry'
Cc Corpinus carolinana
Md Malus 'Donald Wyman'
Ps Prunus sargentii

TREE PLANTING IN MARINE CLAY SOILS

*THE LANDSCAPE CONSIDERATIONS CONTAINED WITHIN SEC. 6.8 OF PATERSON GROUP'S GEOTECHNICAL INVESTIGATION, DATED SEPTEMBER 10, 2020, REPORT PG5345-1, REVISION 1 HAVE BEEN IMPLEMENTED.

1. THIS LANDSCAPE PLAN CONFORMS WITH THE TREE-TO-FOUNDATION SETBACK, SOIL VOLUME, AND SURFACE-GRADING REQUIREMENTS OUTLINED IN THE CITY OF OTTAWA'S GUIDELINES FOR TREE PLANTING IN SENSITIVE MARINE CLAY SOILS (2017), BASED ON THE FINDINGS OUTLINED IN THE PROJECT GEOTECHNICAL REPORT.
2. ADDITIONAL REQUIREMENTS OUTLINED IN THE CITY OF OTTAWA'S GUIDELINES FOR TREE PLANTING IN SENSITIVE MARINE CLAY SOILS (2017), INCLUDING USF DEPTH, FOUNDATION WALL REINFORCEMENT, AND SUBDIVISION GRADING, SHOULD BE CONFIRMED BY THE PROJECT ENGINEER(S).
3. THE CONTRACTOR SHOULD REPORT ANY DISCREPANCIES TO THE CONTRACT ADMINISTRATOR BEFORE PLANTING TREES.
4. CITY OF OTTAWA: GUIDELINES FOR TREE PLANTING IN SENSITIVE MARINE CLAY SOILS (2017): THE FOLLOWING GUIDELINES ARE PRIMARILY FOCUSED ON SMALL AND MEDIUM SIZE STREET TREES. HOWEVER, LARGE TREES (MATURE HEIGHT OVER 14M) CAN STILL BE PLANTED IN AREAS OF SMC SOILS PROVIDED A TREE TO FOUNDATION SETBACK EQUAL TO THE FULL MATURE HEIGHT OF THE TREE CAN BE PROVIDED (E.G. IN A PARK OR OTHER GREEN SPACE). FOR STREET TREES IN THE ROAD RIGHT-OF-WAY WHERE SMC SOILS HAVE BEEN IDENTIFIED, THE TREE TO FOUNDATION SETBACKS MAY BE REDUCED TO 4.5M FOR SMALL (MATURE TREE HEIGHT UP TO 7.5M) AND MEDIUM SIZE TREES (MATURE TREE HEIGHT 7.5M-14M) PROVIDED ALL OF THE FOLLOWING SIX CONDITIONS ARE MET:
 1. THE MODIFIED PLASTICITY INDEX OF THE SOIL BETWEEN THE UNDERSIDE OF FOOTING (USF) AND A DEPTH OF 3.5M GENERALLY DOES NOT EXCEED 40%. THIS CORRESPONDS TO SOILS WITH LOW/MEDIUM POTENTIAL FOR SOIL VOLUME CHANGE. CLAY SOILS THAT EXCEED THE 40% PLASTICITY INDEX ARE CONSIDERED TO HAVE HIGH POTENTIAL FOR SOIL VOLUME CHANGE. FOR THESE WORST-CASE SOILS, THE SETBACKS AND TREE PLANTING RESTRICTIONS REMAIN UNCHANGED FROM THE 2005 CLAY SOILS POLICY (TREE SETBACK MUST EQUAL THE MATURE HEIGHT OF THE TREE - I.E. 7.5M SETBACK FOR SMALL TREES).
 2. THE USF IS 2.1M OR GREATER BELOW THE LOWEST FINISHED GRADE. NOTE: THIS FOOTING LEVEL MUST BE SATISFIED FOR FOOTINGS WITHIN 10M OF THE TREE, AS MEASURED FROM THE CENTRE OF THE TREE TRUNK, AND VERIFIED BY MEANS OF THE GRADING PLAN AS INDICATED IN THE PROCEDURAL CHANGES BELOW.
 3. A SMALL SIZE TREE MUST BE PROVIDED WITH A MINIMUM OF 25M³ OF AVAILABLE SOIL VOLUME, AS DETERMINED BY A LANDSCAPE ARCHITECT. A MEDIUM SIZE TREE MUST BE PROVIDED WITH A MINIMUM OF 30M³ OF AVAILABLE SOIL VOLUME, AS DETERMINED BY A LANDSCAPE ARCHITECT. THE DEVELOPER WILL ENSURE THE SOIL IS GENERALLY UNCOMPACTED WHEN BACKFILLING IN STREET TREE PLANTING LOCATIONS.
NOTE: THE SOIL VOLUME CALCULATION MUST BE BASED ON A DEPTH OF 1.5M BELOW FINISHED GRADE (E.G. 3M LENGTH X 4M WIDTH AT SURFACE X 1.5M DEPTH = 30M³). IT MAY INCLUDE LANDS IN THE RIGHT-OF-WAY AND ON PRIVATE PROPERTY, BUT MUST SUBTRACT THE VOLUME OF SHALLOW UTILITY TRENCHES (I.E. VOLUME OF SHALLOW UTILITY TRENCHES CANNOT COUNT TOWARDS MINIMUM SOIL VOLUME).
 4. THE TREE SPECIES MUST BE SMALL TO MEDIUM SIZE, AS CONFIRMED BY A LANDSCAPE ARCHITECT IN THE LANDSCAPE PLAN.
 5. THE FOUNDATION WALLS ARE TO BE REINFORCED AT LEAST NOMINALLY (MINIMUM OF TWO UPPER AND TWO LOWER 1.5M BARS IN THE FOUNDATION WALL) TO PROVIDE DUCTILITY AS DESCRIBED IN THE GEOTECHNICAL REPORT.
 6. GRADING SURROUNDING THE TREE MUST PROMOTE DRAINING TO THE TREE ROOT ZONE (IN SUCH A MANNER AS NOT TO BE DETRIMENTAL TO THE TREE), AS NOTED ON THE SUBDIVISION GRADING PLAN.

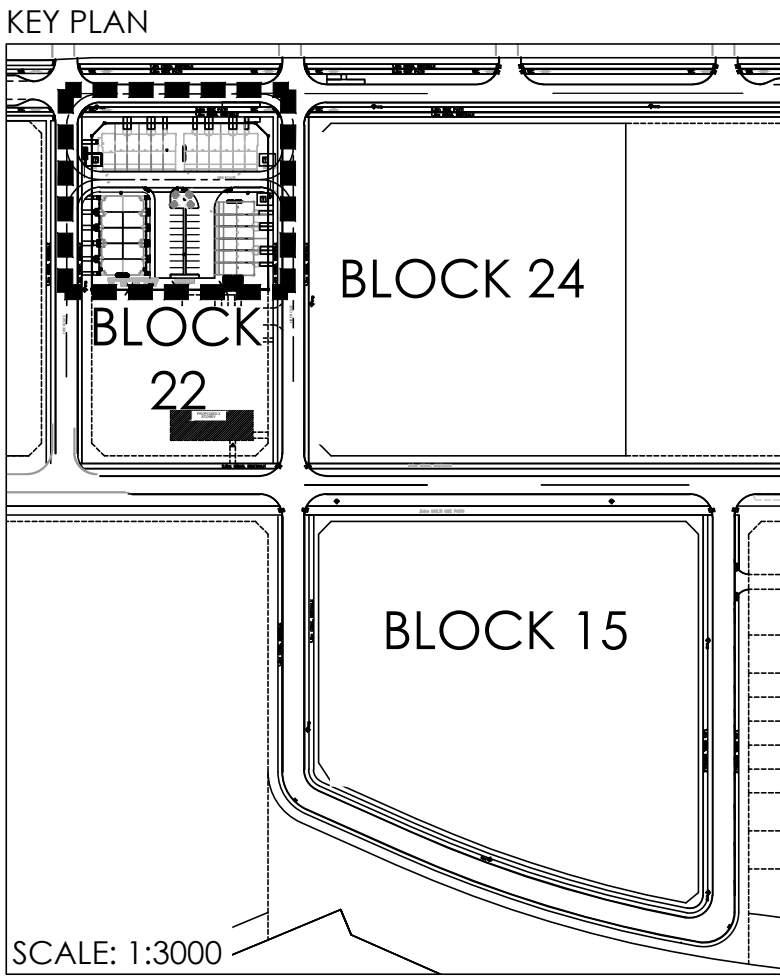
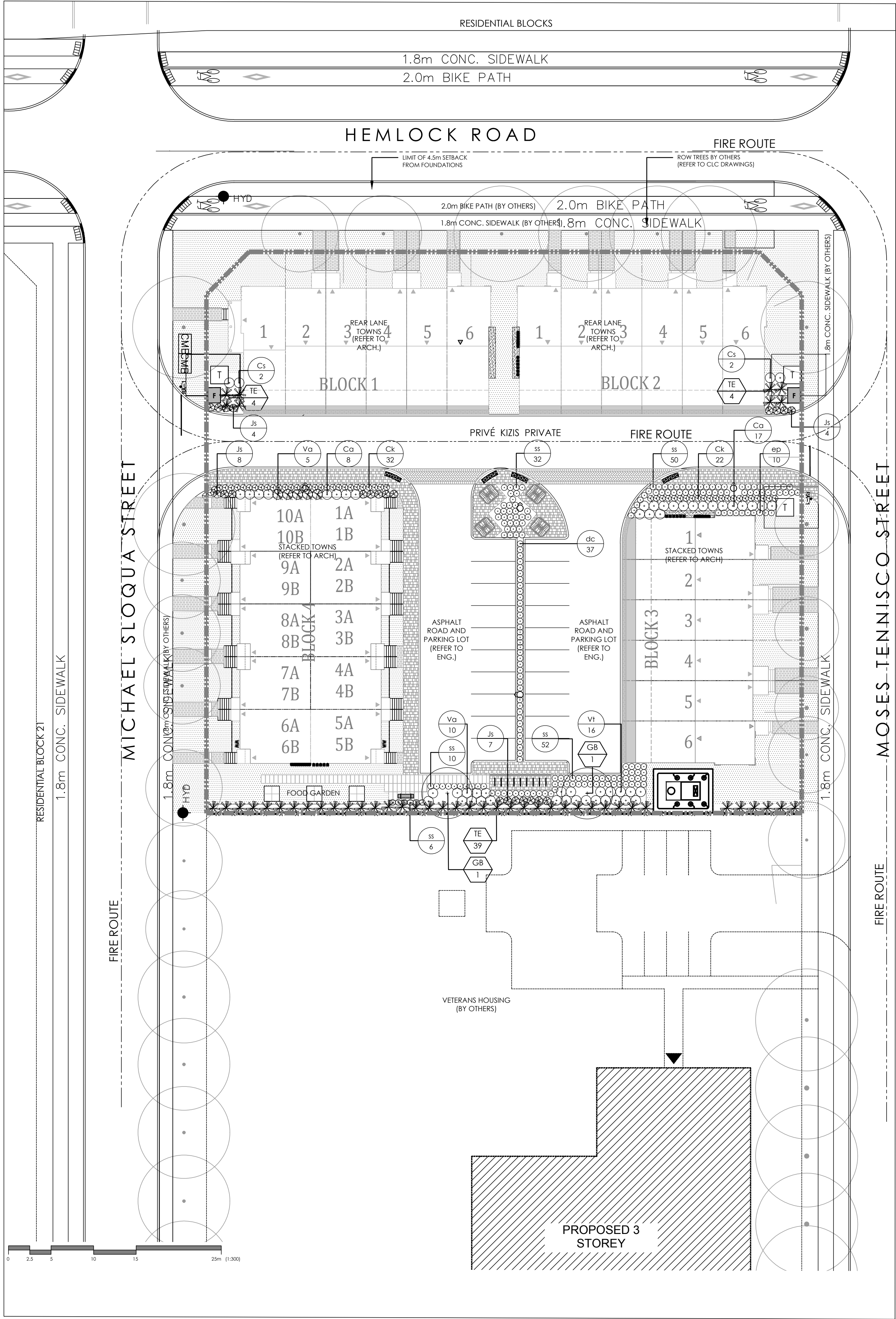

PLANTING NOTES:

1. CONTRACTOR TO VERIFY LOCATION OF ALL SERVICES PRIOR TO ANY EXCAVATION.
2. LOCATIONS OF ALL PLANT MATERIALS TO BE STAKED BY THE CONTRACTOR AND VERIFIED IN THE FIELD BY LANDSCAPE ARCHITECT PRIOR TO THE EXCAVATION OF PITS.
3. ALL PLANT MATERIAL SHALL BE NURSERY GROWN STOCK UNLESS OTHERWISE NOTED.
4. DECIDUOUS TREES TO HAVE A MINIMUM 1800 CLEAR STEM ABOVE GRADE.
5. ALL PLANT MATERIAL SHALL BE WARRANTED FOR TWO YEARS FROM THE DATE OF PERFORMANCE ACCEPTANCE AS DETERMINED BY THE LANDSCAPE ARCHITECT.
6. ALL STEEL T-BARS TO BE REMOVED AT THE ONE YEAR INTERIM INSPECTION UNLESS OTHERWISE DIRECTED BY THE LANDSCAPE ARCHITECT.
7. CONTRACTOR TO MAKE GOOD ALL EXISTING AREAS DAMAGED BY HIS WORK TO THE SATISFACTION OF THE LANDSCAPE ARCHITECT.
8. PERIODIC REVIEWS OF PLANTING SHALL BE CARRIED OUT BY THE LANDSCAPE ARCHITECT.
9. ACER RUBRUM TO BE SPRING DUG SPECIMENS AND PLANTING IN THE SPRING ONLY.
10. ANY PROPOSED SUBSTITUTIONS OF PLANT SPECIES SHALL BE MADE WITH PLANTS OF EQUIVALENT OVERALL FORM, HEIGHT, BRANCHING HABIT, FLOWER, LEAF, COLOR, FRUIT AND CULTURE AND ONLY AFTER APPROVAL OF THE LANDSCAPE ARCHITECT.

SHRUB NOTES:

1. PLACE THE SHRUB AS UPRIGHT AS POSSIBLE, INCLUDING ON SLOPES.
2. PLANT SHRUBS AT THE PROPER DEPTH AS INDICATED ON THE DRAWINGS.
3. PACK THE SOIL WELL AROUND THE PLANT BASE TO REMOVE AIR POCKETS, BUT DON'T OVER PACK IT. PRESS GENTLY BUT FIRMLY TO PREVENT SHOCKING THE ROOTS.
4. PLACE SPECIES ACCORDING TO THE QUANTITIES AND SPACING AS INDICATED ON THE DRAWINGS.
5. PLANT SHRUBS AT THE PROPER DEPTH THE ROOT COLLARS SHOULD BE AT GROUND LEVEL.
6. MULCH THE SOIL SURFACE AS INDICATED ON DRAWINGS.
7. WATER PLANTS THOROUGHLY FOLLOWING PLANTING.
8. REFER TO SPECIFICATIONS FOR MAINTENANCE REQUIREMENTS.

SOD NOTES:

1. SODDED AREAS SHALL HAVE A MINIMUM 150mm TOPSOIL.
2. SURVEY THE PLANTING SITE FOR INVASIVE WEEDS AND REMOVE ALL OR AS MUCH UNDESIRABLE VEGETATION AS POSSIBLE.
3. FIRM THE SOIL, GENTLY TAMP OR ROLL THE SEEDBED, DO NOT COMPACT THE SOIL. EXCESSIVE FORCE WILL DESTROY THE SOIL STRUCTURE AND INHIBIT GERMINATION.
4. CUT THE GRASS TO 50mm WHENEVER IT REACHES THE HEIGHT OF 70mm. REMOVE CLIPPINGS THAT WILL SMOTHER GRASS.
5. SODDED AREAS WILL BE ACCEPTED BY THE PROJECT MANAGER FOLLOWING PERFORMANCE ACCEPTANCE, PROVIDED:
 - SEEDDED AREAS ARE PROPERLY ESTABLISHED.
 - TURF IS FREE OF DEAD SPOTS AND WEEDS.
 - NO SURFACE SOIL IS VISIBLE WHEN GRASS HAS BEEN CUT TO A HEIGHT OF 50mm.
 - TURF AREAS HAVE BEEN CUT NO LESS THAN TWICE, THE LAST CUT BEING CARRIED OUT WITHIN 24 HOURS PRIOR TO THE ACCEPTANCE INSPECTION.

Contractor shall check all dimensions on the work and report any discrepancy to the Landscape Architect before proceeding. All drawings and specifications are the property of the Landscape Architect and must be returned at the completion of the work. This drawing is not to be used for construction until signed by the Landscape Architect.



LEGEND		
---	LIMIT OF WORK	
---	FENCING	
---	2.0m HT GARBAGE ENCLOSURE FENCE	
PLANTING		
○	STREET TREES (BY OTHERS)	
○	LARGE DECIDUOUS TREE	
✱	CONIFEROUS TREE	
✱	DECIDUOUS SHRUBS	
✱	CONIFEROUS/EVERGREEN SHRUBS	
○	GRASSES/PERENNIALS	
□	ORNAMENTAL PLANTING	
□	FOOD GARDEN	
□	SOD	
AMENITIES		
□	WALL MOUNT BENCH WITHOUT BACK	
□	ART FEATURES	
	BIKE RACK	
PLANTING KEY		
XX	TREE SPECIES	QUANTITY
XX	SHRUB SPECIES	QUANTITY

No.	Description	Date
1	Issued for 3rd Site Plan Control Application	18.12.20
2	Issued for 2nd Site Plan Control Application	30.09.20
3	Issued for 1st Site Plan Control Application	05.26.20
4	Issued for Coordination	05.05.20
5	Issued for 1st Submission Client Review	22.04.20
Revision		
City Approval Stamp		

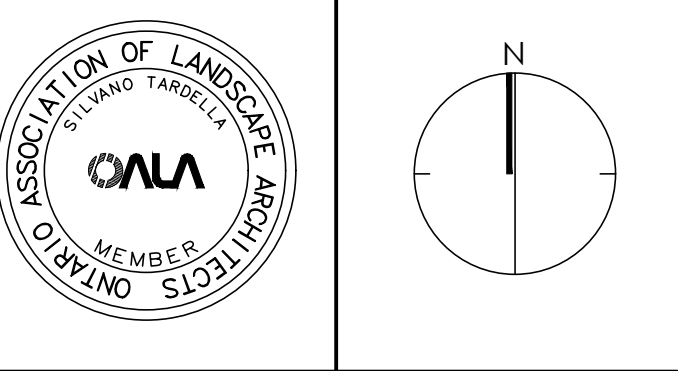

NAK
design strategies

1285 WELLINGTON STREET WEST, OTTAWA, ON K1Y 3A8 CANADA
T 613.237.2345 F 613.237.6423 NAKDESIGNS7RATEGIES.COM

Project

WATERIDGE VILLAGE

Title		
PLANTING PLAN BLOCK 22		
Date	Sept 1 2020	Sheet
Scale	1:300	
Drawn	EJ	
Checked	TM	
Job No.	20-076	

L-02

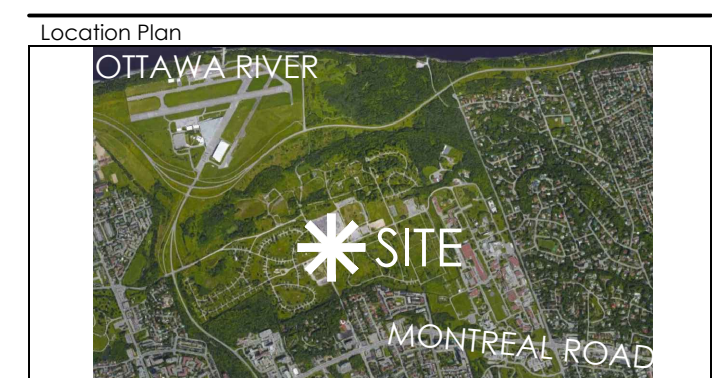
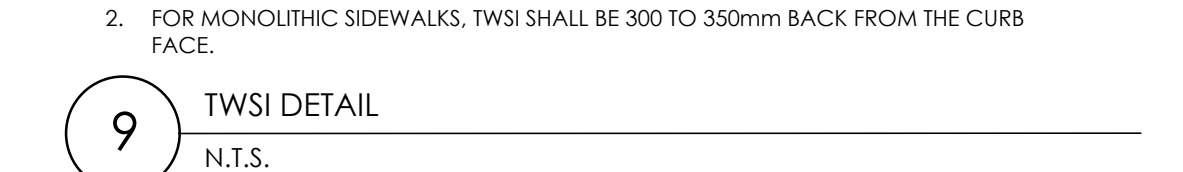
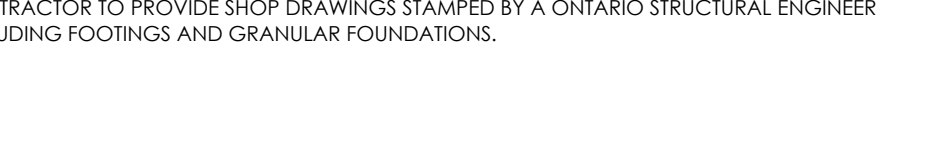
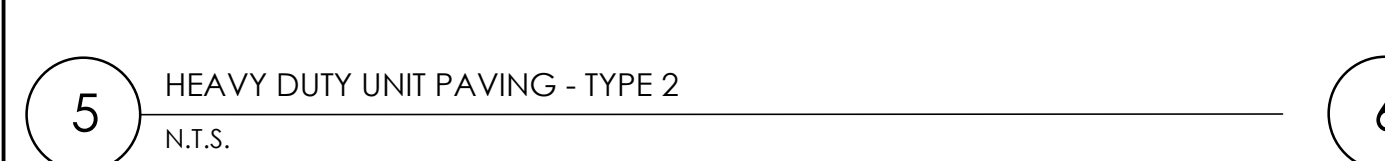
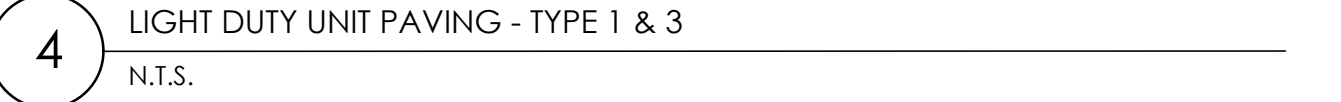
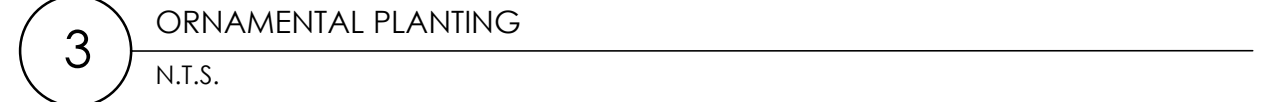
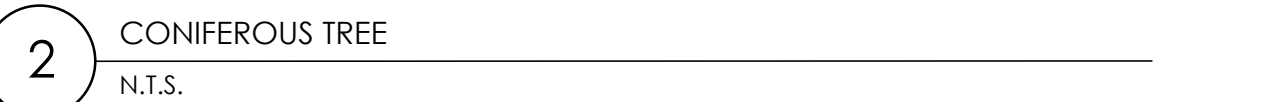
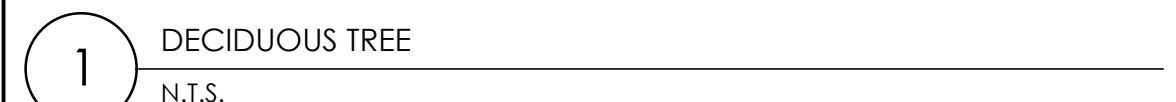

-		
-		
5	Issued for 3rd Site Plan Control Application	18.12.20
4	Issued for 2nd Site Plan Control Application	30.09.20
3	Issued for 1st Site Plan Control Application	05.26.20
2	Issued for Coordination	05.05.20
1	Issued for 1st Submission Client Review	22.04.20
No.	Description	Date
Revision		
City Approval Stamp		

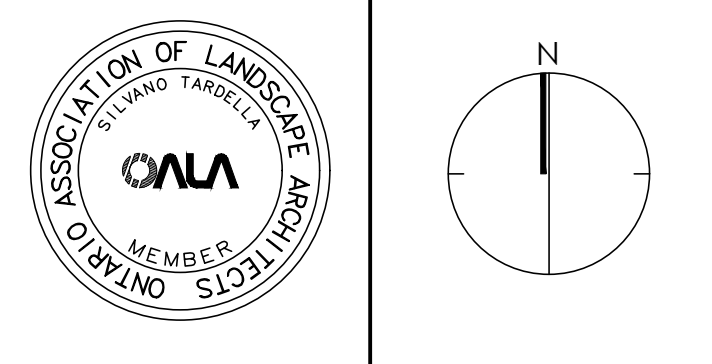

NAK 
design strategies

1285 WELLINGTON STREET WEST, OTTAWA, ON K1Y 3A8 CANADA
T 613.237.2345 F 613.237.6423 NAKDESIGNSTRATEGIES.COM

Project

WATERIDGE VILLAGE

Title		DETAILS BLOCK 22	
Date	DEC 2020	Sheet	D-01
Scale	N.T.S		
Drawn	EJ		
Checked	TM		
Job No.	20-076		

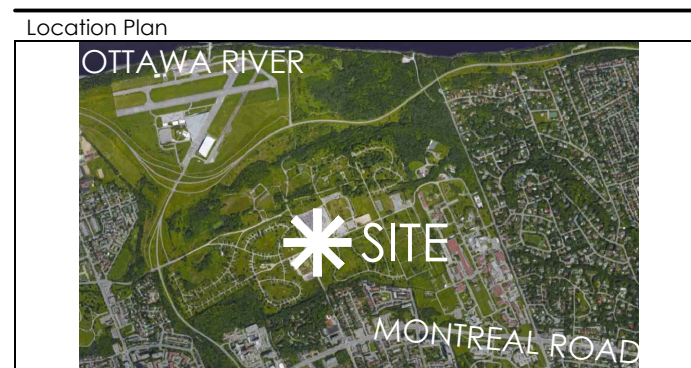
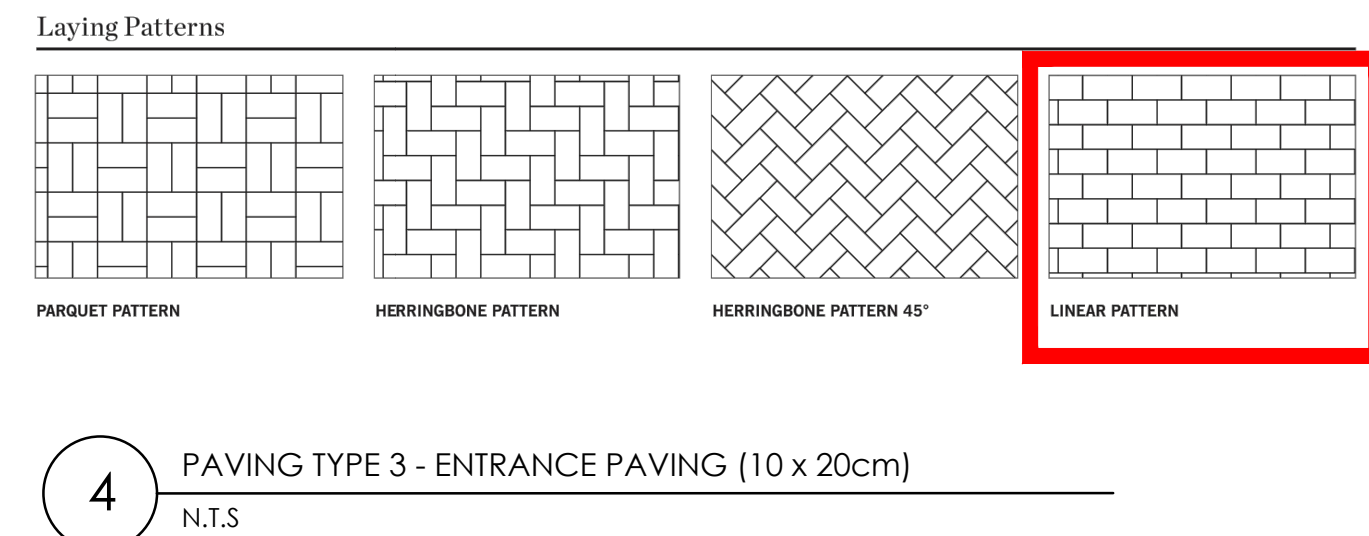
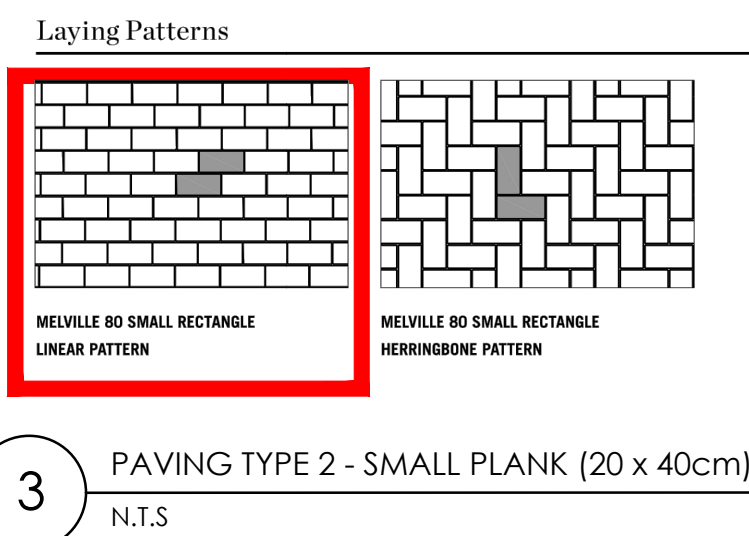
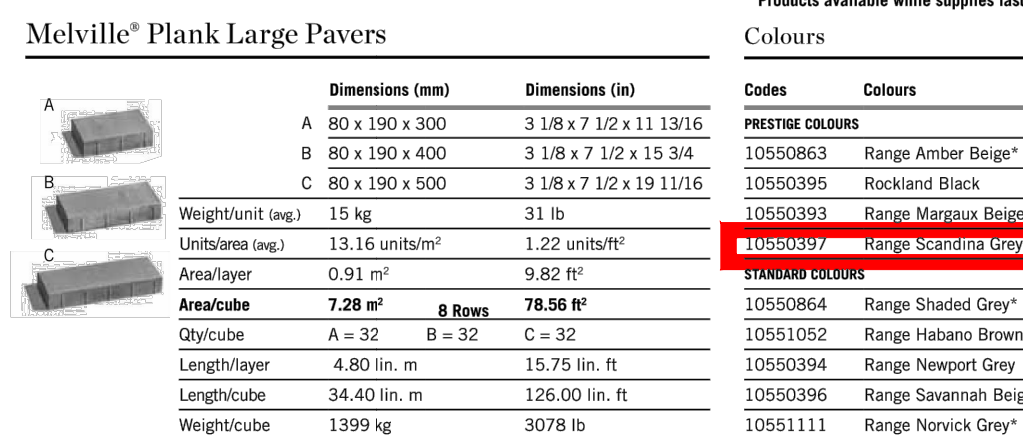

-		
-		
5	Issued for 3rd Site Plan Control Application	18.12.20
4	Issued for 2nd Site Plan Control Application	30.09.20
3	Issued for 1st Site Plan Control Application	05.26.20
2	Issued for Coordination	05.05.20
1	Issued for 1st Submission Client Review	22.04.20
No.	Description	Date
Revision		
City Approval Stamp		

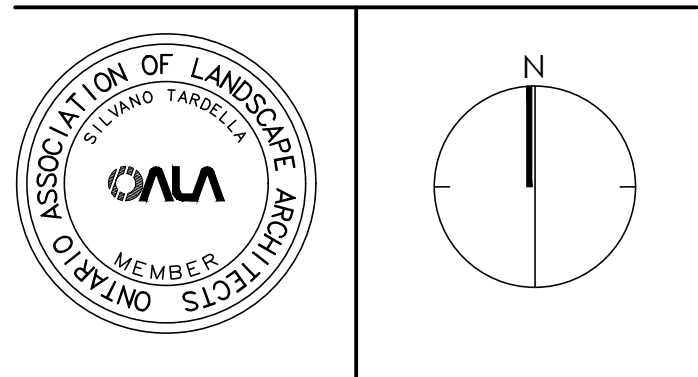

Project

WATERIDGE VILLAGE

Title	
DETAILS BLOCK 22	
Date DEC 2020	Sheet
Scale N.T.S	D-02
Drawn EJ	
Checked TM	
Job No. 20-076	