

GENERAL NOTES:

- COORDINATE AND SCHEDULE ALL WORK WITH OTHER TRADES AND CONTRACTORS.
- DETERMINE THE EXACT LOCATION, SIZE, MATERIAL AND ELEVATION OF ALL EXISTING UTILITIES PRIOR TO COMMENCING CONSTRUCTION, PROTECT AND ASSUME RESPONSIBILITY FOR ALL EXISTING UTILITIES WHETHER OR NOT SHOWN ON THIS DRAWING.
- OBTAIN ALL NECESSARY PERMITS AND APPROVALS FROM THE CITY OF OTTAWA BEFORE COMMENCING CONSTRUCTION.
- BEFORE COMMENCING CONSTRUCTION OBTAIN AND PROVIDE PROOF OF COMPREHENSIVE, ALL RISK AND OPERATIONAL LIABILITY INSURANCE FOR \$5,000,000.00, INSURANCE POLICY TO NAME OWNERS, ENGINEERS AND ARCHITECTS AS CO-INSURED.
- RESTORE ALL DISTURBED AREAS ON-SITE AND OFF-SITE, INCLUDING TRENCHES AND SURFACES ON PUBLIC ROAD ALLOWANCES TO EXISTING CONDITIONS OR BETTER TO THE SATISFACTION OF THE CITY OF OTTAWA AND ENGINEER.
- REMOVE FROM SITE ALL EXCESS EXCAVATED MATERIAL, ORGANIC MATERIAL AND DEBRIS UNLESS OTHERWISE INSTRUCTED BY ENGINEER. EXCAVATE AND REMOVE FROM SITE ANY CONTAMINATED MATERIAL. ALL CONTAMINATED MATERIAL SHALL BE DISPOSED OF AT A LICENSED LANDFILL FACILITY.
- ALL ELEVATIONS ARE GEODETIC. PROPERTY SURVEY COMPLETED BY J.D. BARNES DATED JUNE 21, 2019, DRAWING NUMBER 19-10-048-00. ELEVATIONS WERE CONFIRMED BY OBSERVATION ON PUBLISHED GEODETIC CONTROL POINT 001196530367 HAVING AN ELEVATION OF 92.397m.
- REFER TO GEOTECHNICAL REPORT (65032.03, DATED FEB 14, 2020), PREPARED BY GEMTEC, FOR SUBSURFACE CONDITIONS, CONSTRUCTION RECOMMENDATIONS, AND GEOTECHNICAL INSPECTION REQUIREMENTS. THE GEOTECHNICAL CONSULTANT IS TO REVIEW ON-SITE CONDITIONS AFTER EXCAVATION PRIOR TO PLACEMENT OF THE GRANULAR MATERIAL.
- REFER TO ARCHITECTS' AND LANDSCAPE ARCHITECTS' DRAWINGS FOR BUILDING AND HARD SURFACE AREAS AND DIMENSIONS.
- REFER TO DEVELOPMENT SERVICING & STORMWATER MANAGEMENT REPORT (R-2020-036) PREPARED BY NOVATECH.
- SAW CUT AND KEY GRIND ASPHALT AT ALL ROAD CUTS AND ASPHALT TIE IN POINTS AS PER CITY OF OTTAWA STANDARDS (R10).
- REFER TO EROSION AND SEDIMENT CONTROL PLAN PREPARED BY GEMTEC, PROJECT 65032.03, DATED FEBRUARY 04, 2020 FOR EROSION AND SEDIMENT CONTROL REQUIREMENTS DURING CONSTRUCTION.

SEWER NOTES:

- SUPPLY AND CONSTRUCT ALL SEWERS AND APPURTENANCES IN ACCORDANCE WITH THE MOST CURRENT CITY OF OTTAWA STANDARDS AND SPECIFICATIONS.
- SPECIFICATIONS:

ITEM	SPEC. No.	REFERENCE
CATCHBASIN (600x600mm)	705.010	OPSD
STORM / SANITARY MANHOLE (1200mmØ)	701.010	OPSD
STORM MANHOLE (1800mmØ)	701.050	OPSD
CB, FRAME & COVER	400.020	OPSD
STORM / SANITARY MH FRAME & COVER	401.010	OPSD
LANDSCAPE DRAIN	S31	CITY OF OTTAWA
SEWER TRENCH	S6	CITY OF OTTAWA
SANITARY SEWER	PVC DR 35	
375mmØ AND LESS STORM SEWER	PVC DR 35	
450mmØ STORM SEWER	COCN 650	
- ALL STORM AND SANITARY SERVICE LATERALS SHALL BE EQUIPPED WITH BACKFLOW PREVENTION DEVICES AS PER THE CITY OF OTTAWA STANDARD DETAILS S14 AND S14.1 OR S14.2.
- INSULATE ALL PIPES (SAN/STM) THAT HAVE LESS THAN 1.5m COVER WITH HI-40 INSULATION PER INSULATION DETAIL FOR SHALLOW SEWERS. PROVIDE 150mm CLEARANCE BETWEEN PIPE AND INSULATION.
- SERVICES ARE TO BE CONSTRUCTED TO 1.0m FROM FACE OF BUILDING AT A MINIMUM SLOPE OF 1.0%.
- PIPE BEDDING, COVER AND BACKFILL ARE TO BE COMPACTED TO AT LEAST 95% OF THE STANDARD PROCTOR MAXIMUM DRY DENSITY. THE USE OF CLEAR CRUSHED STONE AS A BEDDING LAYER SHALL NOT BE PERMITTED.
- FLEXIBLE CONNECTIONS ARE REQUIRED FOR CONNECTING PIPES TO MANHOLES (FOR EXAMPLE KOR-N-SEAL, PSX: POSITIVE SEAL AND DURASEAL), THE CONCRETE CRADLE FOR THE PIPE CAN BE ELIMINATED.
- THE OWNER SHALL REQUIRE THAT THE SITE SERVICING CONTRACTOR PERFORM FIELD TESTS FOR QUALITY CONTROL OF ALL SANITARY SEWERS. LEAKAGE TESTING SHALL BE COMPLETED IN ACCORDANCE WITH OPSS 410.07.16, 410.07.16.04 AND 407.07.24. DYE TESTING IS TO BE COMPLETED ON ALL SANITARY SERVICES TO CONFIRM PROPER CONNECTION TO THE SANITARY SEWER MAIN. THE FIELD TESTS SHALL BE PERFORMED IN THE PRESENCE OF A CERTIFIED PROFESSIONAL ENGINEER WHO SHALL SUBMIT A CERTIFIED COPY OF THE TEST RESULTS.
- ALL STORM MANHOLES AND CATCHBASIN MANHOLES ARE TO HAVE 300mm SUMPS UNLESS OTHERWISE INDICATED. ALL CATCHBASINS ARE TO HAVE 600mm SUMPS UNLESS OTHERWISE INDICATED.
- ALL CATCHBASINS, MANHOLES AND/OR CATCHBASIN MANHOLES THAT ARE TO HAVE ICD'S INSTALLED WITHIN THEM ARE TO HAVE 600mm SUMPS.
- ALL WEEPING TILE CONNECTIONS TO BE MADE TO THE PROPOSED STORM SEWER SYSTEM DOWNSTREAM OF ANY INLET CONTROL DEVICES.
- THE CONTRACTOR IS TO TELEWISE (CCTV) ALL PROPOSED SEWERS, 200mmØ OR GREATER PRIOR TO BASE COURSE ASPHALT. UPON COMPLETION OF CONTRACT, THE CONTRACTOR IS RESPONSIBLE TO FLUSH AND CLEAN ALL SEWERS & APPURTENANCES.
- CONTRACTOR TO PROVIDE THE CONSULTANT WITH A GENERAL PLAN OF SERVICES INDICATING ALL APPLICABLE SERVICING AS-BUILT INFORMATION SHOWN ON THIS PLAN. AS-BUILT INFORMATION MUST INCLUDE: PIPE MATERIAL, SIZES, LENGTHS, SLOPES, INVERT AND T/G ELEVATIONS, STRUCTURE LOCATIONS AND ANY ALIGNMENT CHANGES, ETC.

WATERMAIN NOTES:

- SUPPLY AND CONSTRUCT ALL WATERMAINS AND APPURTENANCES IN ACCORDANCE WITH THE CITY OF OTTAWA STANDARDS AND SPECIFICATIONS. EXCAVATION, INSTALLATION, BACKFILL AND RESTORATION OF ALL WATERMAINS BY THE CONTRACTOR. CONNECTIONS AND SHUT-OFFS AT THE MAIN BY CITY OF OTTAWA FORCES. CHLORINATION OF THE WATER SYSTEM SHALL BE PERFORMED BY THE CONTRACTOR IN THE PRESENCE CITY OF OTTAWA FORCES.
- SPECIFICATIONS:

ITEM	SPEC. No.	REFERENCE
WATERMAIN TRENCHING	W17	CITY OF OTTAWA
THERMAL INSULATION IN SHALLOW TRENCHES	W22	CITY OF OTTAWA
THERMAL INSULATION AT OPEN STRUCTURES	W23	CITY OF OTTAWA
WATERMAIN SERVICE	W33	CITY OF OTTAWA
- WATERMAIN SHALL BE MINIMUM 2.4m DEPTH BELOW GRADE UNLESS OTHERWISE INDICATED.
- PROVIDE MINIMUM 0.5m CLEARANCE BETWEEN OUTSIDE OF PIPES AT ALL CROSSINGS.
- WATER SERVICE IS TO BE CONSTRUCTED TO WITHIN 1.0m OF FOUNDATION WALL AND CAPPED, UNLESS OTHERWISE INDICATED.

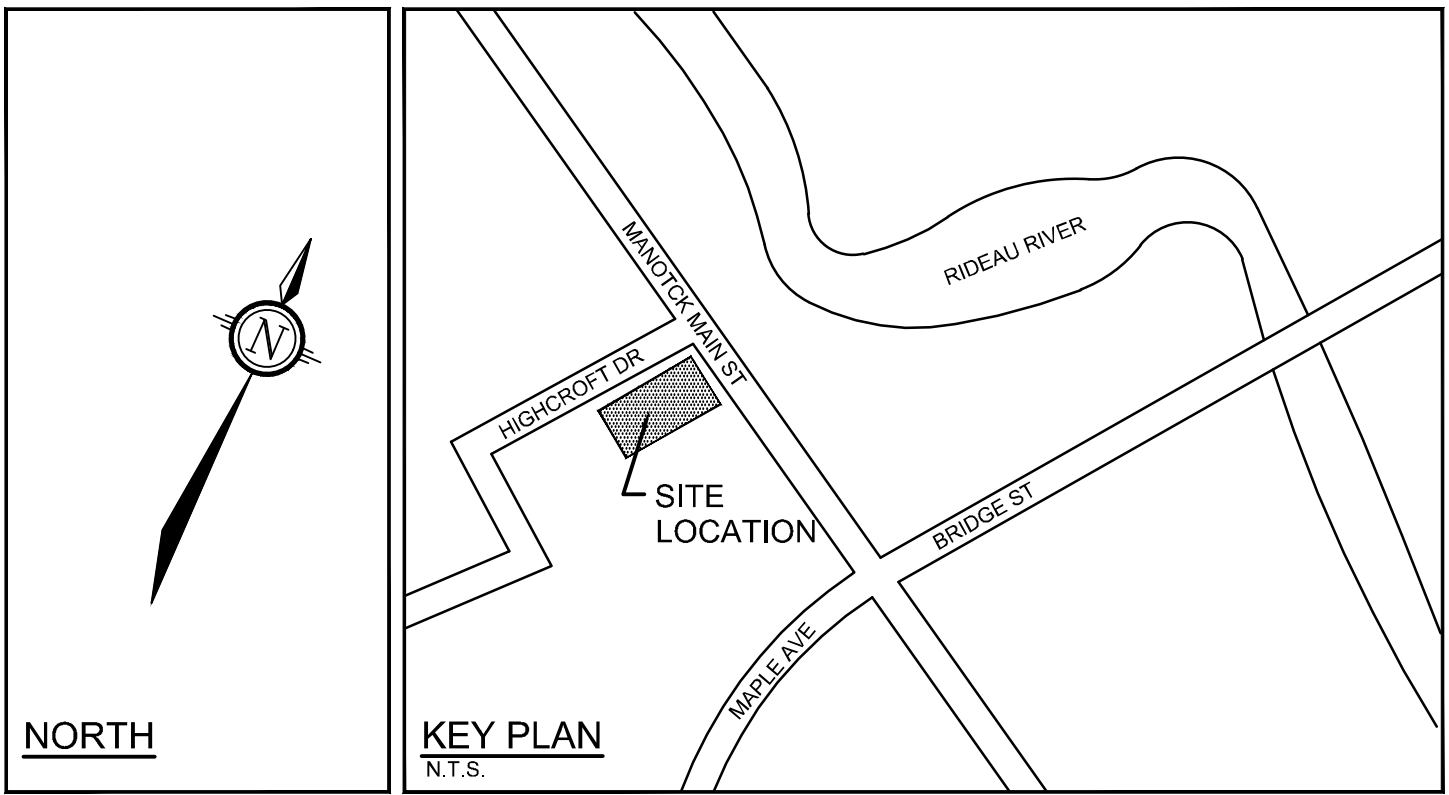

ROOF DRAIN TABLE: ROOF DRAINS RD1 & RD 2					
AREA ID	ROOF DRAIN No. (WATTS MODEL)	ROOF DRAIN OPENING SETTING	1.5 YEAR RELEASE RATE	APPROX. 5 YR PONDING DEPTH	1.100 YEAR RELEASE RATE
R-1	RD 1 (RD-100-A-ADJ)	1/2 OPEN	0.95 L/s	9 cm	1.10 L/s
R-2	RD 2 (RD-100-A-ADJ)	1/2 OPEN	0.95 L/s	10 cm	1.10 L/s

\* REFER TO THE 'DEVELOPMENT SERVICING STUDY AND STORMWATER MANAGEMENT REPORT' (R-2020-036) PREPARED BY NOVATECH FOR DRAINAGE AREA IDENTIFIERS AND STORMWATER MANAGEMENT DETAILS.  
\*\*ALL CONTROLLED FLOW ROOF DRAINS FOR THE PROPOSED BUILDING TO BE WATTS' ADJUSTABLE ACCUTROL' ROOF DRAINS.

AREA A-1: INLET CONTROL DEVICE DATA - CBMH 3					
DESIGN EVENT	ICD TYPE (TEMPEST MODEL)	DIAMETER OF OUTLET PIPE (mm)	DESIGN FLOW (L/s)	DESIGN HEAD (m)	WATER ELEVATION (m)
1.5 YR	MODEL 80	250	4.9	0.74	87.37
1.100 YR	MODEL 80	250	8.3	2.07	88.70

LEGEND

DC	PROPERTY LINE	200mmØ WM	EXISTING WATERMAIN
DC	PROPOSED DEPRESSED CURB	V&VB	EXISTING VALVE & VALVE BOX
SAW MH	PROPOSED STORM SEWER	SAW MH	EXISTING SANITARY MH & SEWER
STM MH	PROPOSED SANITARY SEWER	STM MH	EXISTING CATCHBASIN MH & STORM SEWER
SP	PROPOSED WATERMAIN	CBMH	EXISTING STORM MH & SEWER
M	PROPOSED STANDPOST	CB	EXISTING CATCHBASIN & CATCHBASIN LEAD
RM	PROPOSED WATER METER	G	EXISTING GAS
RM	PROPOSED WATER REMOTE METER	C	EXISTING CABLE
O	PROPOSED CATCHBASIN MANHOLE (DIAMETER AS INDICATED)	B	EXISTING BELL
OH	EXISTING CURB	OH	EXISTING OVERHEAD WIRES
EX HP		EX HP	EXISTING UTILITY POLE GW GUY WIRES
X-X		X-X	EXISTING FENCE

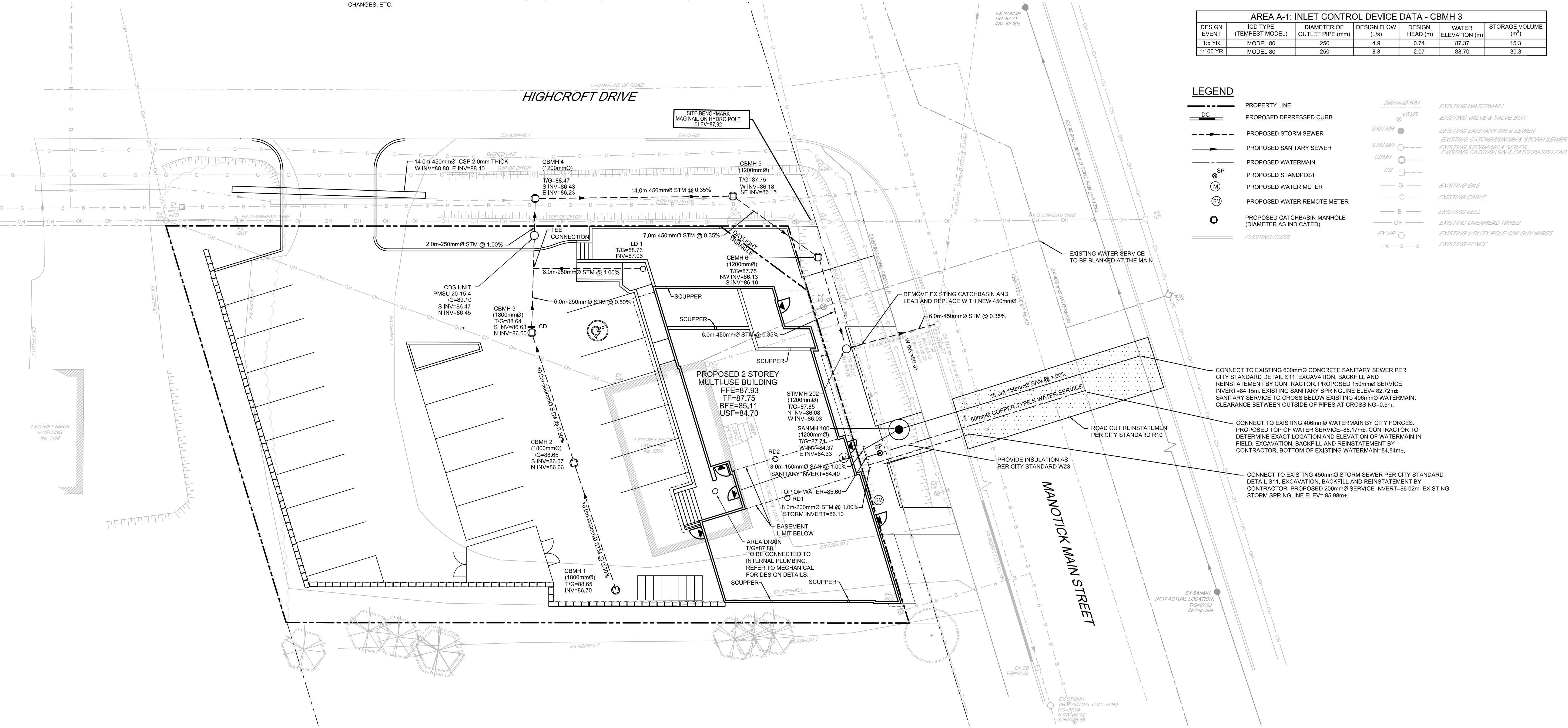

NOTE:  
THE POSITION OF ALL POLE LINES, CONDUITS, WATERMAINS, SEWERS AND OTHER UNDERGROUND AND OVERGROUND UTILITIES AND STRUCTURES IS NOT NECESSARILY SHOWN ON THE CONTRACT DRAWINGS, AND WHERE SHOWN, THE ACCURACY OF THE POSITION OF SUCH UTILITIES AND STRUCTURES IS NOT GUARANTEED. BEFORE STARTING WORK, DETERMINE THE EXACT LOCATION OF ALL SUCH UTILITIES AND STRUCTURES AND ASSUME ALL LIABILITY FOR DAMAGE TO THEM.

OWNER INFORMATION  
CEDAR SANDS HOLDINGS INC.  
C/O STEVEN JAMES MENARD  
184 REDPATH DRIVE  
OTTAWA, ONTARIO  
K2G 6K5

No.	REVISION	DATE	BY
3	REVISED PER CITY COMMENTS	JULY 29/20	MS
2	ISSUED FOR SITE PLAN APPLICATION	APR 20/20	MS
1	ISSUED FOR COORDINATION	MAR 31/20	MS

SCALE  
1:150

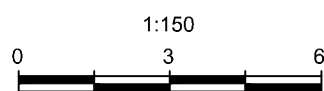

DESIGN	MS / LSC
CHECKED	MS
DRAWN	LSC
CHECKED	MS
APPROVED	MS

FOR REVIEW ONLY



**NOVATECH**  
Engineers, Planners & Landscape Architects  
Suite 200, 240 Michael Cowpland Drive  
Ottawa, Ontario, Canada K2M 1P6  
Telephone (613) 254-9643  
Facsimile (613) 254-5867  
Website www.novatech-eng.com

LOCATION  
CITY OF OTTAWA  
5506 MAIN STREET MANOTICK

DRAWING NAME  
GENERAL PLAN OF SERVICES

PROJECT No.	119234
REV	REV # 3
DRAWING No.	119234-GP