

GENERAL NOTES

- ALL WORKS TO BE COMPLETED IN ACCORDANCE WITH MUNICIPAL, PROVINCIAL AND LOCAL AUTHORITY STANDARDS AND REGULATIONS WHERE APPLICABLE, AND IN ACCORDANCE WITH ACCEPTED INDUSTRY BEST PRACTICE.
- INFORMATION PROVIDED ON THE PLAN IS BASED ON INFORMATION REASONABLY AVAILABLE AND/OR PROVIDED TO GEMTEC AT THE TIME OF DESIGN. THE CONTRACTOR/OWNER IS TO VERIFY THE ACCURACY OF THE INFORMATION CONTAINED HEREIN REGARDING, BUT NOT LIMITED TO, ELEVATIONS, DIMENSIONS, SETBACKS, EASEMENTS, UTILITY LOCATIONS AND DETAILS, ...ETC., AND REPORT ANY ERRORS OR OMISSIONS TO GEMTEC.
- THE LOCATION OF ALL OVERHEAD AND UNDERGROUND UTILITIES MAY NOT BE DISPLAYED ON THIS PLAN AND, WHERE SHOWN, THEIR POSITIONS MAY NOT BE ACCURATE. IT IS THE RESPONSIBILITY OF THE OWNER/CONTRACTOR TO LOCATE SUCH UTILITIES PRIOR TO COMMENCING WORKS. GEMTEC DOES NOT ASSUME LIABILITY FOR DAMAGE TO SERVICES, UTILITIES, AND STRUCTURES DURING CONSTRUCTION OPERATIONS.
- IT IS THE RESPONSIBILITY OF THE OWNER/CONTRACTOR TO ENSURE THAT THE PLAN USED FOR CONSTRUCTION IS AN APPROVED AND LATEST VERSION.
- DIMENSIONS AND ELEVATIONS DISPLAYED ON THIS PLAN ARE IN METRES. THIS IS NOT A PLAN OF SURVEY. THIS PLAN IS NOT TO BE SCALED, ALTERED OR REPRODUCED AND IS INTENDED FOR USE ONLY IN RELATION TO THE PROJECT FOR WHICH IT WAS PREPARED.
- THIS PLAN SHOULD BE USED IN CONJUNCTION WITH RELEVANT DOCUMENTS, PLANS, AND DETAILS PREPARED BY GEMTEC.

EROSION AND SEDIMENT CONTROL NOTES :

- THE CONTRACTOR SHALL IMPLEMENT BEST MANAGEMENT PRACTICES, TO PROVIDE FOR PROTECTION OF THE AREA DRAINAGE SYSTEM AND THE RECEIVING WATERCOURSE, DURING CONSTRUCTION ACTIVITIES. THE CONTRACTOR ACKNOWLEDGES THAT FAILURE TO IMPLEMENT APPROPRIATE EROSION AND SEDIMENT CONTROL MEASURES MAY BE SUBJECT TO PENALTIES IMPOSED BY ANY APPLICABLE REGULATORY AGENCY.
- ALL EROSION AND SEDIMENT CONTROLS ARE TO BE INSTALLED TO THE SATISFACTION OF THE ENGINEER AND THE CITY OF OTTAWA. THEY ARE TO BE APPROPRIATE TO THE SITE CONDITIONS, PRIOR TO UNDERTAKING ANY SITE ALTERATIONS (FILLING, GRADING, REMOVAL OF VEGETATION ETC.) AND DURING ALL PHASES OF SITE PREPARATION AND CONSTRUCTION. THESE PRACTICES ARE TO BE IMPLEMENTED IN ACCORDANCE WITH THE CURRENT BEST MANAGEMENT PRACTICES FOR EROSION AND SEDIMENT CONTROL AND SHOULD INCLUDE AS A MINIMUM THOSE MEASURES INDICATED ON THE PLAN.
- EROSION AND SEDIMENT CONTROL MEASURES WILL BE IMPLEMENTED DURING CONSTRUCTION IN ACCORDANCE WITH THE "GUIDELINES ON EROSION AND SEDIMENT CONTROL FOR URBAN CONSTRUCTION SITES" (GOVERNMENT OF ONTARIO, MAY 1997). THE CONTRACTOR SHALL BE SOLELY RESPONSIBLE FOR MEETING ALL REGULATORY AGENCY REQUIREMENTS.
- TO PREVENT SURFACE EROSION FROM ENTERING ANY STORM SEWER SYSTEM DURING CONSTRUCTION, FILTER BAG WILL BE PLACED UNDER GRATES OF NEARBY CATCHBASINS AND STRUCTURES. A LIGHT DUTY SILT FENCE BARRIER WILL ALSO BE INSTALLED AROUND THE CONSTRUCTION AREA (WHERE APPLICABLE). THESE CONTROL MEASURES WILL REMAIN IN PLACE UNTIL CONSTRUCTION IS COMPLETE.
- TO LIMIT EROSION: MINIMIZE THE AMOUNT OF EXPOSED SOILS AT ANY GIVEN TIME. RE-VEGETATE EXPOSED AREAS AND SLOPES AS SOON AS POSSIBLE AND PROTECT EXPOSED SLOPES WITH NATURAL OR SYNTHETIC MULCHES.
- FOR MATERIAL STOCKPILING: MINIMIZE THE AMOUNT OF EXPOSED MATERIALS AT ANY GIVEN TIME. APPLY TEMPORARY SEEDING, TARPS, COMPACTION AND/OR SURFACE ROUGHENING AS REQUIRED TO STABILIZE STOCKPILED MATERIALS THAT WILL NOT BE USED WITHIN 14 DAYS.
- THE SEDIMENT CONTROL MEASURES SHALL ONLY BE REMOVED WHEN, IN THE OPINION OF THE ENGINEER, THE MEASURES ARE NO LONGER REQUIRED. NO CONTROL MEASURES MAY BE PERMANENTLY REMOVED WITHOUT PRIOR AUTHORIZATION FROM THE ENGINEER.
- THE CONTRACTOR SHALL IMMEDIATELY REPORT TO THE ENGINEER ANY ACCIDENTAL DISCHARGES OF SEDIMENT MATERIAL INTO ANY STORM SEWER SYSTEM. APPROPRIATE RESPONSE MEASURES, INCLUDING ANY REPAIRS TO EXISTING CONTROL MEASURES OR THE IMPLEMENTATION OF ADDITIONAL CONTROL MEASURES, SHALL BE CARRIED OUT BY THE CONTRACTOR WITHOUT DELAY.
- THE CONTRACTOR ACKNOWLEDGES THAT FAILURE TO IMPLEMENT EROSION AND SEDIMENT CONTROL MEASURES MAY BE SUBJECT TO PENALTIES IMPOSED BY ANY APPLICABLE REGULATORY AGENCY.
- HIGHCROFT DRIVE AND MANOTICK MAIN STREET ARE TO BE SWEEP AS REQUIRED OR AS DIRECTED BY THE ENGINEER AND/OR THE MUNICIPALITY.
- THE CONTRACTOR SHALL ENSURE PROPER DUST CONTROL IS PROVIDED WITH THE APPLICATION OF WATER (AND IF REQUIRED, CALCIUM CHLORIDE) DURING DRY PERIODS. MONITOR DUST LEVELS DURING SITE PREPARATION, EXCAVATION, AND CONSTRUCTION ACTIVITIES, AND WHEN DUST LEVELS BECOME VISUALLY APPARENT SPRAY WATER TO MINIMIZE THE RELEASE OF DUST FROM GRAVEL, PAVED AREAS AND EXPOSED SOILS. USE CHEMICAL DUST SUPPRESSANTS ONLY WHERE NECESSARY ON PROBLEM AREAS.
- THE PROPOSED MEASURES AND THE IMPLEMENTATION OF SUCH MEASURES SHALL BE IN ACCORDANCE WITH THE DETAILS PROVIDED IN THIS PLAN, AS WELL AS PER OPSS 805, CONTRACT SPECIAL PROVISIONS, AND MANUFACTURER RECOMMENDATIONS.
- THE CONTRACTOR IS RESPONSIBLE FOR INSPECTING, MONITORING, AND MAINTAINING THE ESC MEASURES, AS WELL AS MAINTAINING RECORDS OF SUCH AS REQUIRED (MIN. WEEKLY). THE REPORTS, SIGNED BY THE EOR, SHALL BE PROVIDED TO THE CONTRACT ADMINISTRATOR WITHIN 48 HOURS OF THE INSPECTION.
- THE CONTRACTOR IS RESPONSIBLE FOR ENSURING THAT ALL WORKERS, INCLUDING SUB-CONTRACTORS, ARE INFORMED OF THE IMPORTANCE OF ESC AND THE CONSEQUENCES OF FAILURE TO COMPLY WITH THE REQUIREMENTS OF ALL REGULATORY AGENCIES AND SPECIFICATIONS DETAILED HEREIN, AS WELL THAT ALL WORKERS ARE ADEQUATELY TRAINED IN REGARDS TO THE INSTALLATION, OPERATION AND MAINTENANCE OF THE CONTROL MEASURES.
- THE CONTRACTOR SHALL IMMEDIATELY REPORT TO APPLICABLE REGULATORY AGENCIES AND THE CONTRACT ADMINISTRATOR ANY ACCIDENTAL DISCHARGE OF SEDIMENT MATERIAL INTO EITHER THE WATERCOURSE OR THE STORM SEWER SYSTEM.

PRELIMINARY SCHEDULE	
ITEM	DATE
MOBILIZATION	NOVEMBER 2020
ESC MEASURES/REMOVALS/DEMOLITION	DECEMBER 2020
SITE SERVICING/ROUGH GRADING	MARCH 2021
BUILDING ENVELOPE	MAY 2020 - MAY 2021
FINAL GRADING	AUGUST 2021
PAVEMENT/CURBS	SEPTEMBER 2021
FINAL LANDSCAPING	OCTOBER 2021
DEMOLITION	DECEMBER 2021

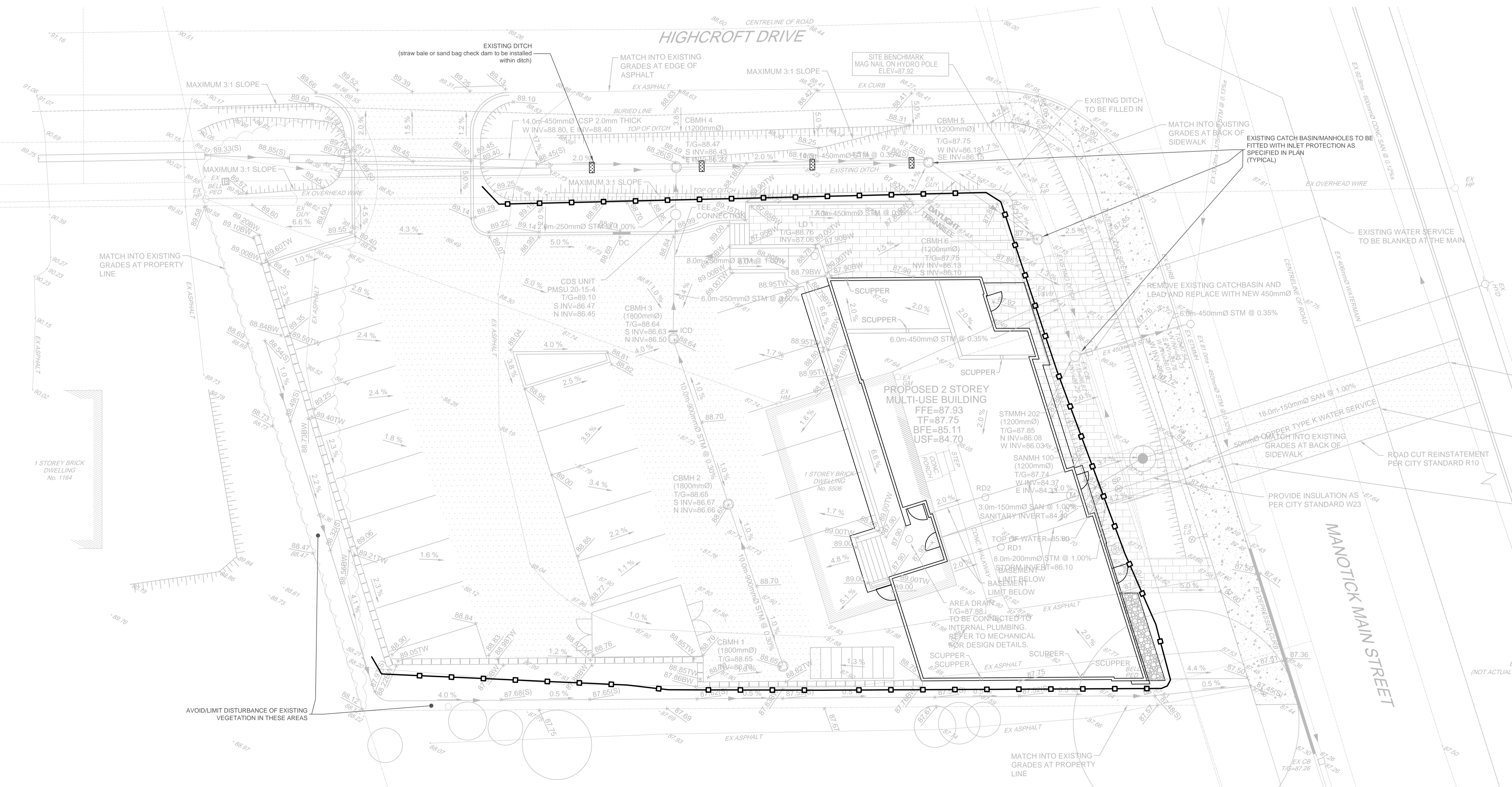
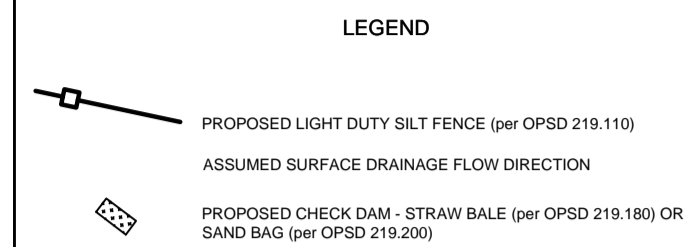

BASE PLAN PROVIDED BY NOVATECH ENGINEERING CONSULTANTS LTD.

Engineers Stamp

 A.C. HOULE
 LICENSED PROFESSIONAL ENGINEER
 PROVINCE OF ONTARIO
 SEPT 17, 2020

Drawn By: MR | Checked By: ACH

Project: 5506 MANOTICK MAIN STREET OTTAWA, ON

Drawing: EROSION & SEDIMENT CONTROL PLAN

Scale: 1:125

File No.: 65032.03 | Sheet No.: 1

GEMTEC
 CONSULTING ENGINEERS AND SCIENTISTS