

**KEY PLAN**

CB	CATCH BASIN
MH	MANHOLE
CB/MH	CATCH BASIN/MANHOLE
SPL	SPRINGLINE OF PIPE
INV	INVERT OF PIPE
SD	SUBDRAIN IN CB
SS	SUBDRAIN IN CB/MH
SS	SANITARY SEWER
SS	STORM SEWER
WS/W	WATER SERVICE/WATERMAIN
CS	CURB STOP & STANDPOST
VP	VALVE & VALVE BOX
FH	FIRE HYDRANT
FDC	FIRE DEPARTMENT CONNECTION
RD	ROOF DRAIN
WM	WATER METER
RM	REMOTE WATER METER READOUT
GE	EXISTING GRADE ELEVATION
PG	PROPOSED GRADE ELEVATION
OS	EXISTING SLOPE OF GRADE
PS	PROPOSED SLOPE OF GRADE
OF	EMERGENCY OVERLAND FLOW
BS	BOTTOM OF SLOPE
CL	CENTRELINE OF SHALE
PL	PROPERTY LINE
SB	SILT FENCE BARRIER
DC	CONC. CURB/DEPRESSED CURB (150mm EXCEPT WHERE NOTED)
LP	LIGHT-DUTY PAVEMENT
HP	HEAVY-DUTY PAVEMENT
TR	TWIST
FL	FIRST FLOOR ELEVATION
BF	BASEMENT FLOOR ELEVATION
USF	UNDERSIDE OF FOOTING

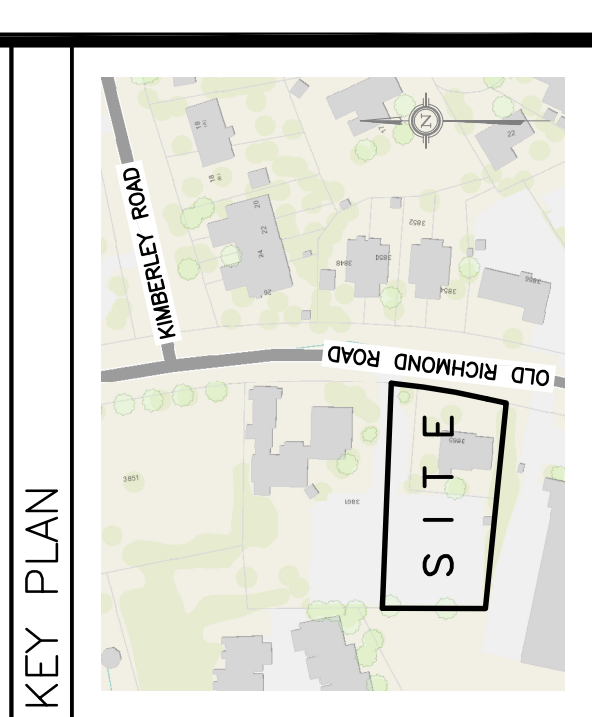

No.	DATE	REVISION
4	OCT 8-20	RE-ISSUED FOR APPROVAL
3	JUL 28-20	RE-ISSUED FOR APPROVAL
2	APR 28-20	ISSUED FOR APPROVAL
1	APR 22-20	ISSUED FOR COORDINATION

**D. B. GRAY ENGINEERING INC.**  
 700 Long Point Circle  
 Ottawa, Ontario  
 613-425-8044  
 dgray@dbgrayengineering.com

**PROPOSED 3 STOREY MIXED USE BUILDING**  
 3865 OLD RICHMOND ROAD  
 OTTAWA, ONTARIO

**EROSION & SEDIMENT CONTROL PLAN**

Engineer's Seal  
  
 Drawing No. **C-4 of 7**  
 NOT VALID UNLESS SIGNED & DATED

APPROVED  REFUSED   
 THIS 02 DAY OF December, 2020  
  
 ERIN O'CONNELL, MCIP, RPP, MANAGER (A)  
 DEVELOPMENT REVIEW, WEST  
 PLANNING, INFRASTRUCTURE AND ECONOMIC  
 DEVELOPMENT DEPARTMENT, CITY OF OTTAWA

REMOVE EXISTING LID FRAME AND CONCRETE RINGS AND ADJUSTMENT RINGS AS NECESSARY TO ACHIEVE TOP ELEVATION OF 93.33. INSTALL EXISTING MANHOLE LID AND FRAME.