

Legend

- × 85.59 PROPOSED ELEVATION
- EXISTING GROUND ELEVATIONS
- PROPOSED GRADE
- MAJOR OVERLAND FLOW ROUTE
- EXISTING STORM MANHOLE
- PROPOSED CATCHBASIN MANHOLE
- EXISTING SANITARY MANHOLE
- EXISTING CATCHBASIN
- ▬ PROPOSED BARRIER CURB SC1.1
- ▬ PROPOSED DEPRESSED BARRIER CURB SC1.1
- ▬ 3:1 TERRACING UNLESS OTHERWISE SHOWN
- ▬ PROPOSED TACTILE WALKING SURFACE INDICATOR (SEE DETAIL ON DWG EC-1)
- ▬ PROPOSED FIRE WALL (REFER TO ARCHITECTURAL DWGS)

GENERAL NOTES

1. ALL WORK SHALL BE CARRIED OUT IN COMPLIANCE WITH THE ONTARIO OCCUPATIONAL HEALTH AND SAFETY ACT AND REGULATIONS FOR CONSTRUCTION PROJECTS.
2. ALL WORK AND MATERIALS TO CONFORM WITH CURRENT MINISTRY OF THE ENVIRONMENT & ENERGY OF ONTARIO, CITY OF OTTAWA AND ONTARIO PROVINCIAL STANDARDS AND SPECIFICATIONS. LOCAL UTILITY STANDARDS AND MINISTRY OF TRANSPORTATION STANDARDS WILL APPLY WHERE REQUIRED.
3. SITE PLAN PREPARED BY: ROSALINE J. HILL
REVISION: REVISED REAR YARD EXIT PATH DATED SEPTEMBER 28, 2020
DRAWING: A1.1 - SITE PLAN
SITE BENCHMARK PROVIDED BY: ANNS, O'SULLIVAN, AND VOLLEBECK LTD.
LOCATION / DESCRIPTION: TOP OF SPINDLE OF EX. SOUTHWEST FIRE HYDRANT ON BEDALE DRIVE ELEV=65.20
TOPO SURVEY: PREPARED BY: ANNS, O'SULLIVAN, AND VOLLEBECK LTD.
DATED: SEPTEMBER 11, 2020
4. THE CONTRACTOR IS ADVISED THAT WORKS BY OTHERS MAY BE ONGOING DURING THE PERIOD OF THIS CONTRACT. THE CONTRACTOR SHALL COORDINATE CONSTRUCTION ACTIVITIES AND COORDINATION WITH ALL OTHER CONTRACTORS AND PREVENT CONSTRUCTION CONFLICTS.
5. THE INFORMATION SHOWN FOR EXISTING UTILITIES WAS PROVIDED BY OTHERS. THE CONTRACTOR IS RESPONSIBLE FOR LOCATING AND VERIFYING BY EACH UTILITY PRIOR TO COMMENCEMENT OF WORK. ANY VARIANCE IS TO BE IMMEDIATELY REPORTED TO THE ENGINEER. LOST TIME DUE TO FAILURE OF THE CONTRACTOR TO CONFIRM UTILITY LOCATIONS AND NOTIFY THE ENGINEER OF POSSIBLE CONFLICTS PRIOR TO CONSTRUCTION WILL BE AT THE CONTRACTOR'S EXPENSE.
6. ALL CONSTRUCTION SHALL BE CARRIED OUT IN ACCORDANCE WITH THE RECOMMENDATIONS MADE IN THE GEOTECHNICAL REPORT PG3682-1 PREPARED BY PATERSON GROUP INC. DATED JANUARY 6, 2016.
7. THE CONTRACTOR IS RESPONSIBLE FOR OBTAINING ALL PERMITS REQUIRED AND TO BEAR THE COST OF SAME INCLUDING WATER PERMIT AND ASSOCIATED COSTS.
8. ALL DISTURBED AREAS SHALL BE REINSTATED TO EQUAL OR BETTER CONDITION TO THE SATISFACTION OF THE ENGINEER AND THE CITY. PAVEMENT REINSTATEMENT FOR SERVICE AND UTILITY CUTS SHALL BE IN ACCORDANCE WITH DETAIL R10 ON DWG GP-1.
9. FOR DETAILS RELATING TO STORMWATER MANAGEMENT AND ROOF DRAINAGE, SEE THE STORMWATER MANAGEMENT REPORT PREPARED BY STANTEC CONSULTING LTD. ROOF DRAINAGE TO BE PROVIDED VIA RESTRICTED FLOW ROOF DRAINS.
10. BENCHMARKS: IT IS THE RESPONSIBILITY OF THE CONTRACTOR TO VERIFY THAT THE SITE BENCHMARK(S) HAS NOT BEEN ALTERED OR DISTURBED AND THAT ITS RELATIVE ELEVATION AND DESCRIPTION AGREES WITH THE INFORMATION SHOWN ON DRAWING GP-1.
11. THE CONTRACTOR SHALL PROVIDE TO THE ENGINEER 1 (ONE) SET OF AS CONSTRUCTED SITE SERVING, GRADING, AND SITE ELECTRICAL DWGS.
12. SANITARY AND WATER SERVICE SIZED TO BE CONFIRMED BY MECHANICAL CONSULTANT AT DETAILED DESIGN.

Revision	By	Appd.	YY.MM.DD
3	WAJ	SGG	20.10.01
2	WAJ	SGG	16.12.01
1	WAJ	SGG	16.01.22

File Name: 160401218-FB

Permit-Seal

Client/Project
CARDEL DEVELOPMENTS LTD

3368 CARLING AVE

OTTAWA, ON

Title

GRADING PLAN

Project No. 160401218

Scale 1:150

Drawing No. GP-1

Sheet 2 of 4

Revision 3

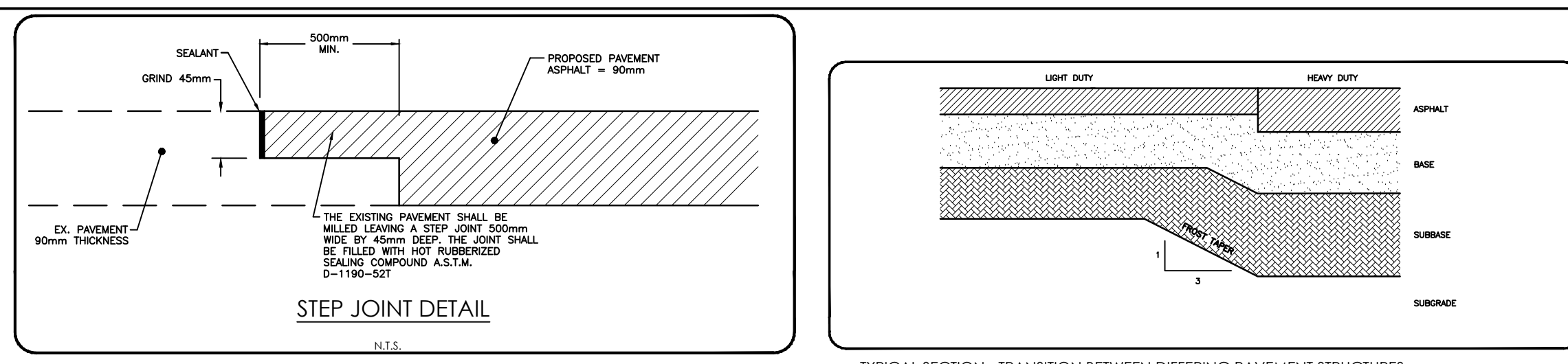
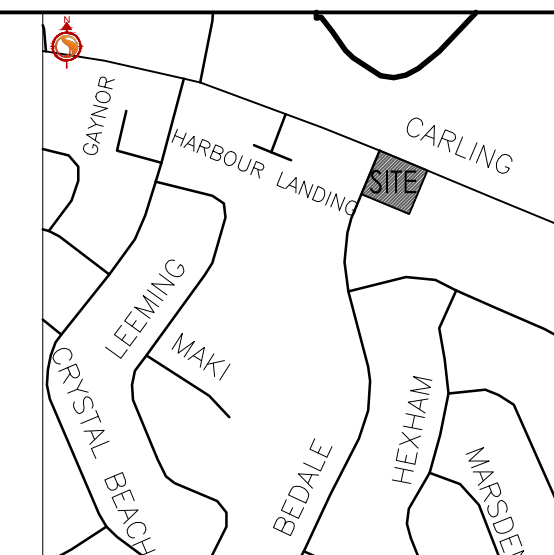

- SITE GRADING
1. ALL GRANULAR BASE & SUB-BASE COURSE MATERIALS SHALL BE COMPACTED TO 98% STANDARD PROCTOR MAX. DRY DENSITY.
 2. ALL DISTURBED GRASSED AREAS SHALL BE RESTORED TO ORIGINAL CONDITION OR BETTER, WITH SO2 ON MIN. 100mm TOPSOIL. THE RELOCATION OF TREES AND SHRUBS SHALL BE SUBJECT TO APPROVAL BY THE PROJECT LANDSCAPE ARCHITECT OR ENGINEER.
 3. ALL BARRIER CURBS, CONCRETE ISLANDS AND SIDEWALKS (SEE LEGEND) SHOWN ON THIS DRAWING ARE TO BE PRICED IN THE SITEMWORKS PORTION OF THE CONTRACT. ALL BARRIER CURBS AND SIDEWALKS TO BE CONSTRUCTED PER CITY OF OTTAWA STANDARD DRAWING SC1.1 AND SC2.
 4. INSPECTIONS: ALL WORK ON THE MUNICIPAL RIGHT OF WAY AND CASSEMENTS TO BE INSPECTED BY THE MUNICIPALITY PRIOR TO BACKFILLING. ALL WORK RELATING TO WATERMANS AND SEWERS TO BE INSPECTED BY THE MUNICIPALITY WHEN REQUIRED.
 5. REFER TO ARCHITECTURAL SITE PLAN FOR DIMENSIONS AND SITE DETAILS.
 6. STEP JOINTS ARE TO BE USED WHERE PROPOSED ASPHALT MEETS EXISTING ASPHALT AS PER DETAIL ON GP-1. ALL JOINTS MUST BE SEALED AS PER DETAIL.
 7. CONTRACTOR TO OBTAIN A ROAD OCCUPANCY PERMIT 48 HOURS PRIOR TO COMMENCING ANY WORK WITHIN THE MUNICIPAL ROAD ALLOWANCE IF REQUIRED BY THE MUNICIPALITY.
 8. EMBANKMENTS TO BE SLOPED AT MIN. 3:1, UNLESS OTHERWISE SPECIFIED.
 9. ALL PAVEMENT MARKING, LINE PAINTING, DIRECTIONAL LINES/ARROWS ETC. SHALL BE PLACED IN ACCORDANCE WITH THE ARCHITECTURAL SITE PLAN OR THE OWNER'S TRAFFIC ENGINEERING CONSULTANT'S DRAWINGS. LINE PAINTING AND DIRECTIONAL SYMBOLS SHALL BE APPLIED WITH A MINIMUM OF TWO COATS OF ORGANIC SOLVENT BASED PAINT.
 10. THE CONTRACTOR SHALL PROVIDE TO THE ENGINEER 1 (ONE) SET OF AS CONSTRUCTED SITE SERVING, GRADING, AND SITE ELECTRICAL DWGS.
 11. SITE SIGNAGE TO BE INSTALLED AS PER ARCHITECTURAL SITE PLAN.
 12. ALL NECESSARY CLEARING AND GRUBBING SHALL BE COMPLETED BY THE CONTRACTOR. REVIEW WITH ARCHITECT AND THE CITY OF OTTAWA PRIOR TO TREE CUTTING.
 13. SUB-EXCAVATE SOFT AREAS & FILL WITH GRANULAR 'B' COMPACTED IN 0.30m LAYERS.
 14. FOR ALL LANDSCAPING FEATURES (i.e. TREES, WALKWAYS, PARK DETAILS, NOISE BARRIERS, FENCES etc.) REFER TO LANDSCAPE ARCHITECT PLAN.
 15. ROUGH GRADING FOR LANDSCAPED ISLANDS TO BE LEFT 150mm BELOW CURB AND COMPACTED TO 95%.
 16. WHERE APPLICABLE THE CONTRACTOR IS TO SUBMIT SHOP DRAWINGS FOR RETAINING WALLS (INCLUDE RAILINGS IF APPLICABLE) TO THE ENGINEER FOR APPROVAL PRIOR TO CONSTRUCTION. SHOP DRAWINGS MUST BE SITE SPECIFIC, SIGNED AND SEALED BY A LICENSED STRUCTURAL ENGINEER. THE CONTRACTOR WILL ALSO BE REQUIRED TO SUPPLY STRUCTURAL AND GEOTECHNICAL CERTIFICATION OF THE AS-CONSTRUCTED RETAINING WALL TO THE ENGINEER PRIOR TO FINAL ACCEPTANCE.
 17. RAMP STYLE VEHICLE ACCESS CROSSING AS PER STD DWG SC13
 18. RETAINING WALLS GREATER THAN 1.0m HEIGHT TO BE DESIGNED BY A STRUCTURAL ENGINEER LICENSED AND REGISTERED IN THE PROVINCE OF ONTARIO.
 19. FENCES OR RAILINGS ARE REQUIRED FOR RETAINING WALLS GREATER THAN 0.60m IN HEIGHT.

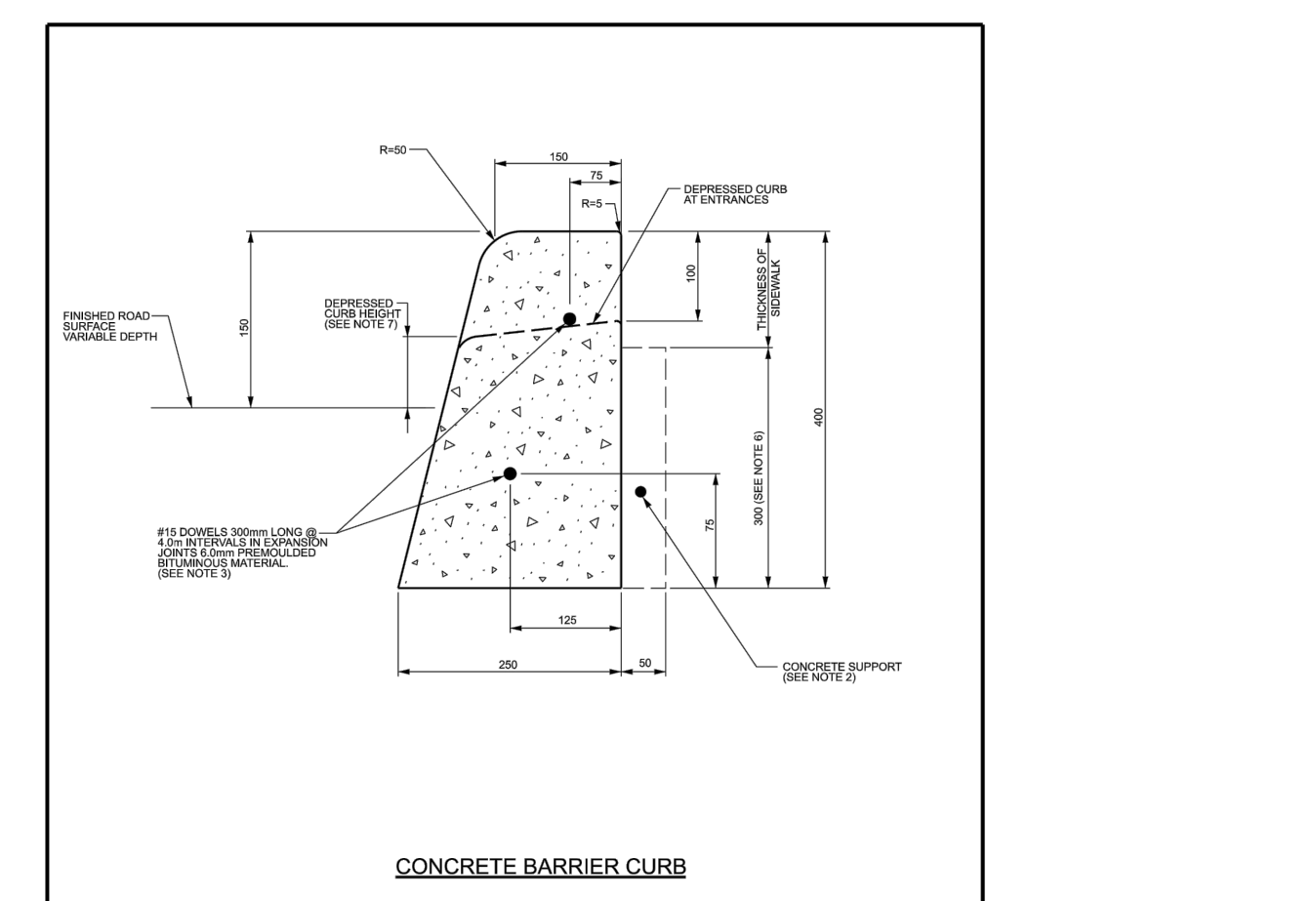
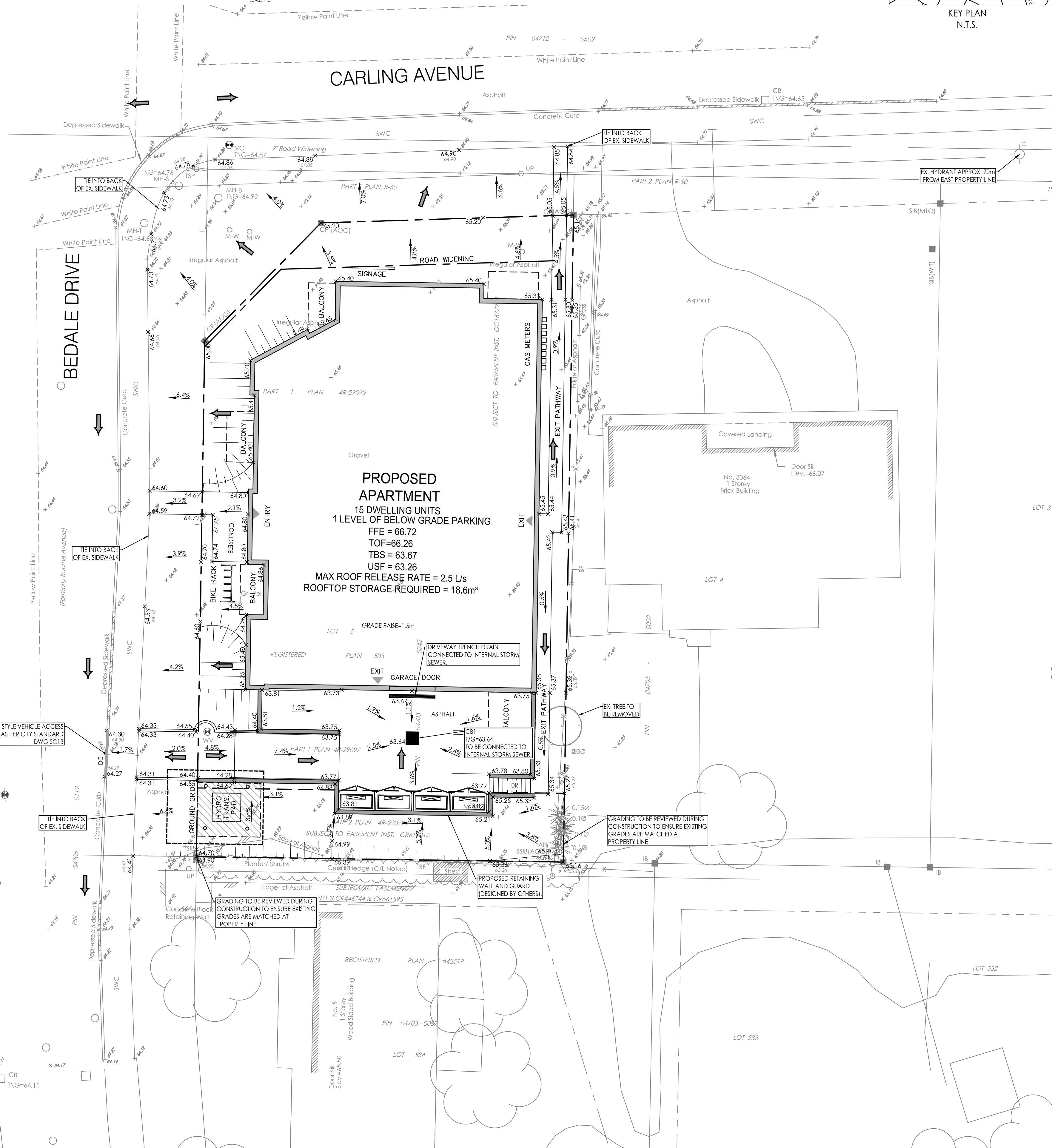

- NOTES:
1. THE FULL CURB DEPTH SHALL BE CARRIED THROUGH THE DEPRESSED ACCESS CROSSING.
 2. A CONCRETE SUPPORT IS REQUIRED WHEN BUILT ADJACENT TO THE SIDEWALK.
 3. IF PAVEMENT IS TO BE INSTALLED OVER EXISTING SIDEWALK, THE 415 DOWELS ARE TO BE PLACED AT THE END OF THE EXTRUSION.
 4. ALL DIMENSIONS ARE IN MILLIMETRES UNLESS SHOWN OTHERWISE.
 5. QUARRY JOINTS SHALL BE 35mm DEEP. FRONT, BACK AND TOP OF SECTION AT ALL SPACING OR MATCH JOINTS WHERE SIDEWALK IS ADJACENT.
 6. FOR DEPRESSED CURB AT ENTRANCES SEE DET. 200.
 7. DEPRESSED CURB HEIGHT - FOR PRIVATE DRIVE ENTRANCES 150 TO 250mm.

CONCRETE BARRIER CURB FOR GRANULAR BASE PAVEMENT (MODIFIED OPSD-600.110)	
DATE:	JANUARY 2003
REV.:	MARCH 2019
DWG. NO.:	SC1.1

W:\archive\160401218_3368 Carling Ave (rev: 1203)\design\dwg\160401218-FB.dwg 22/07/2021 10:45 AM by: jomson, Norman ORIGINAL SHEET - ARCH D