

# WATERIDGE VILLAGE

## BLOCKS 22



NAK PROJECT NO. 20-076

PROJECT ADDRESS:  
OTTAWA, ON

ISSUED FOR FIRST SITE PLAN CONTROL APPLICATION  
SEPTEMBER, 2020

**LIST OF DRAWINGS:**

- |            |                  |
|------------|------------------|
| <u>NAK</u> |                  |
| L00        | - COVER SHEET    |
| L01        | - LANDSCAPE PLAN |
| L02        | - PLANTING PLAN  |

- |                |           |
|----------------|-----------|
| <u>DETAILS</u> |           |
| D01            | - DETAILS |
| D02            | - DETAILS |

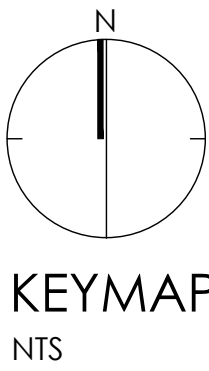



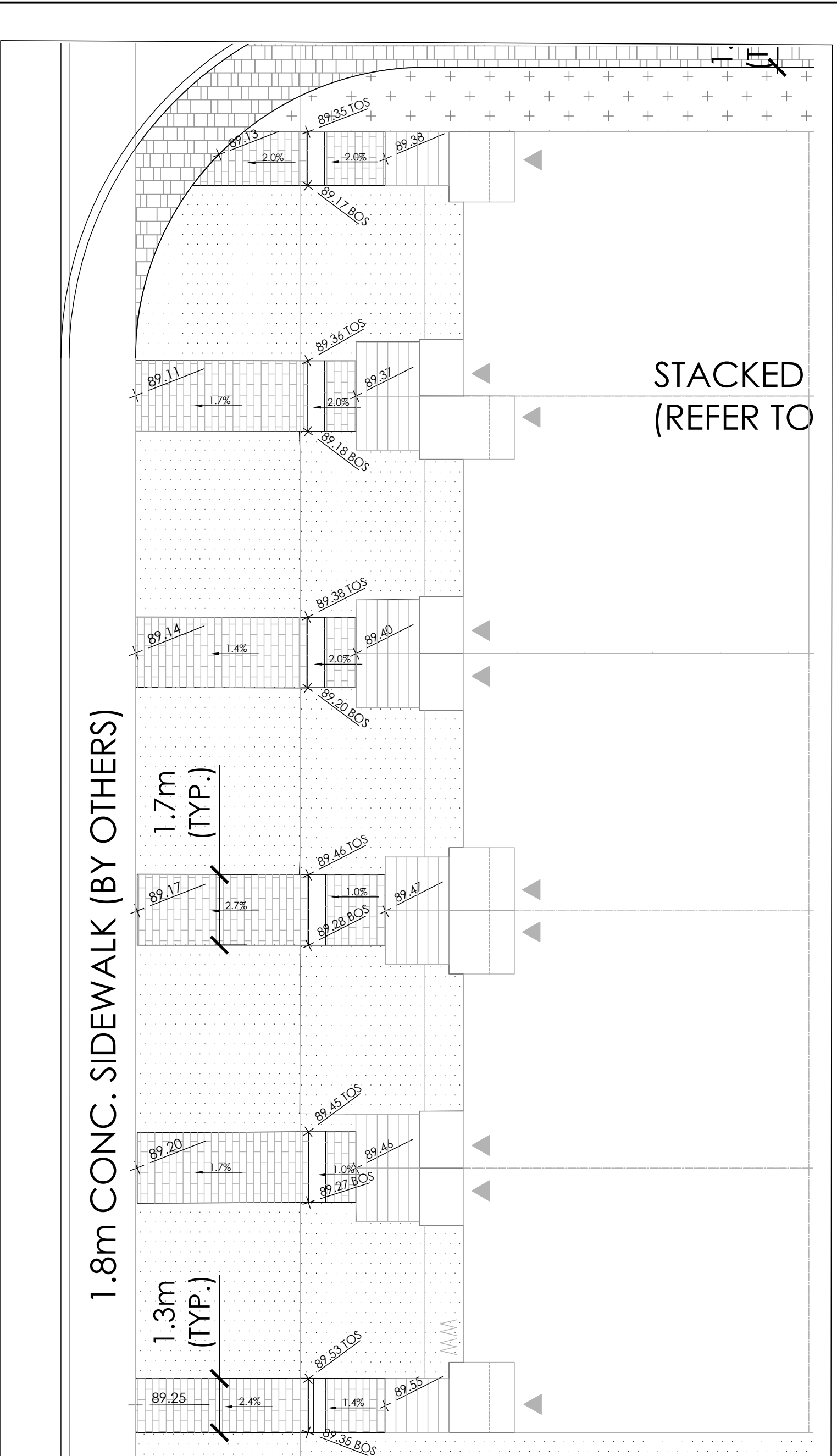
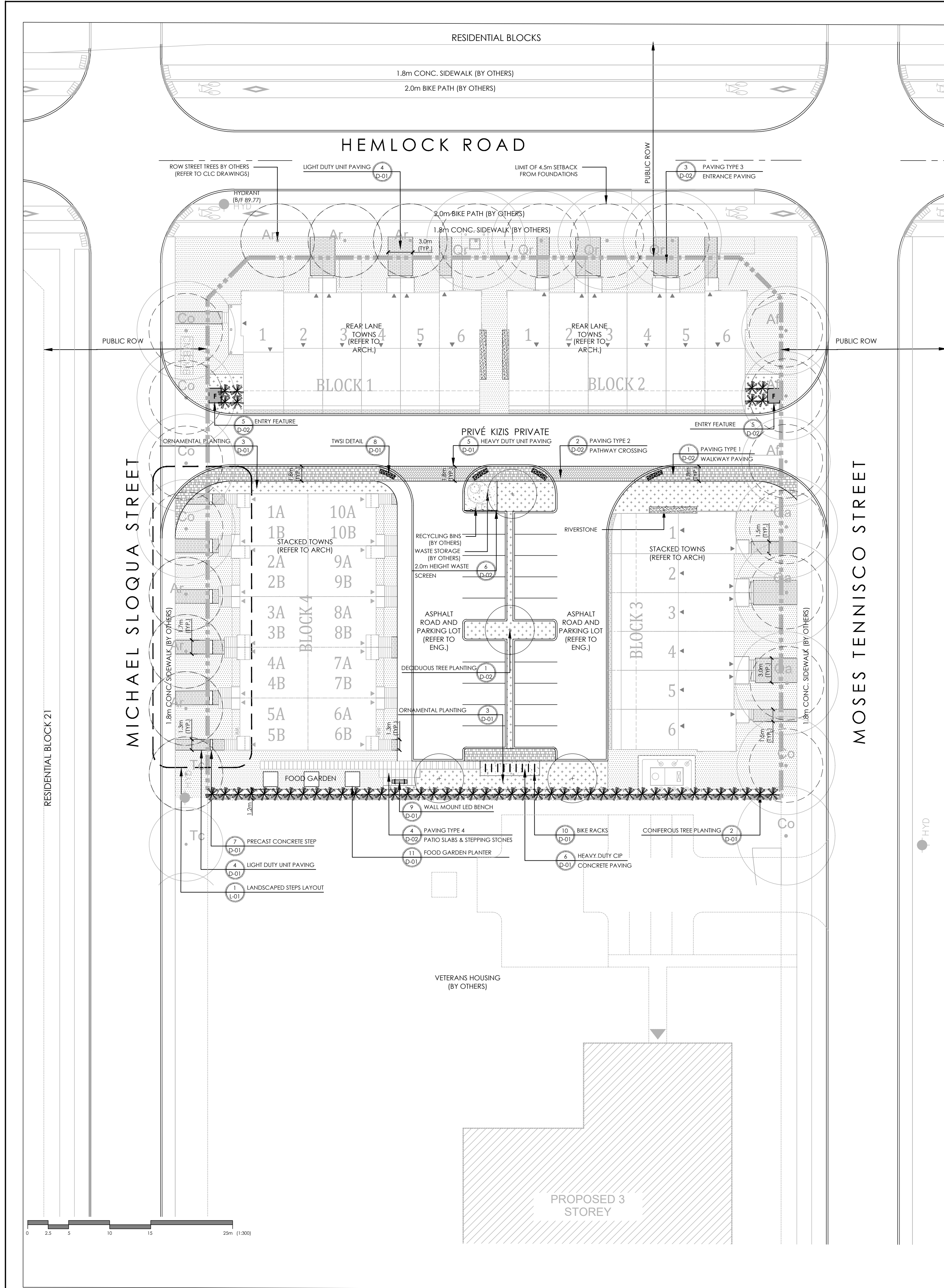

- 1 LANDSCAPED STEPS LAYOUT  
1:100
- LAYOUT NOTES:
- ALL WORKS AND MATERIALS SHALL CONFORM TO THE LATEST REVISION OF THE STANDARDS AND SPECIFICATIONS FOR THE CITY OF OTTAWA, ONTARIO PROVINCIAL STANDARD DRAWINGS (OPSD) AND SPECIFICATIONS (OPSS), WHERE APPLICABLE. LOCAL UTILITY STANDARDS AND MINISTRY OF TRANSPORTATION STANDARDS WILL APPLY WHERE REQUIRED.
  - THE CONTRACTOR SHALL CONFIRM THE LOCATION OF ALL EXISTING UTILITIES WITHIN THE SITE AND ADJACENT WORK AREAS. THE CONTRACTOR SHALL BE RESPONSIBLE FOR PROTECTING ALL EXISTING UTILITIES TO THE SATISFACTION OF THE AUTHORITY HAVING JURISDICTION. THE CONTRACTOR SHALL BE RESPONSIBLE FOR THE REPAIR OR REPLACEMENT OF ANY SERVICES OR UTILITIES DISTURBED DURING CONSTRUCTION. TO THE SATISFACTION OF THE AUTHORITY HAVING JURISDICTION.
  - ALL DIMENSIONS SHALL BE CHECKED AND VERIFIED IN THE FIELD BY THE CONTRACTOR PRIOR TO THE START OF CONSTRUCTION. ANY DISCREPANCIES SHALL BE REPORTED IMMEDIATELY TO THE LANDSCAPE ARCHITECT. LOST TIME DUE TO FAILURE OF THE CONTRACTOR TO CONFIRM UTILITY LOCATIONS AND NOTIFY LANDSCAPE ARCHITECT OF POSSIBLE CONFLICTS PRIOR TO CONSTRUCTION WILL BE AT THE CONTRACTORS EXPENSE.
  - ANY AREAS BEYOND THE LIMIT OF THE SITE DISTURBED DURING CONSTRUCTION SHALL BE RESTORED TO ORIGINAL CONDITION OR BETTER TO THE SATISFACTION OF THE AUTHORITY HAVING JURISDICTION AT THE CONTRACTOR'S EXPENSE.
  - ALL WORK SHALL BE COMPLETED IN ACCORDANCE WITH THE 'OCCUPATIONAL HEALTH AND SAFETY ACT AND REGULATIONS FOR CONSTRUCTION PROJECTS'. THE GENERAL CONTRACTOR SHALL BE DEEMED TO BE THE 'CONSTRUCTOR' AS DEFINED IN THE ACT.
  - ALL CONSTRUCTION SIGNAGE MUST CONFORM TO THE MINISTRY OF TRANSPORTATION OF ONTARIO MANUAL OF UNIFORM TRAFFIC CONTROL DEVICES PER LATEST AMENDMENT.
  - ALL DIMENSIONS ARE IN METRES UNLESS SPECIFIED OTHERWISE.
  - THERE WILL BE NO SUBSTITUTION OF MATERIALS UNLESS PRIOR WRITTEN APPROVAL IS RECEIVED FROM THE LANDSCAPE ARCHITECT.
  - ALL CONSTRUCTION SHALL BE CARRIED OUT IN ACCORDANCE WITH THE RECOMMENDATIONS MADE IN THE GEOTECHNICAL INVESTIGATION. PROPOSED RESIDENTIAL BLOCK 15, 22, 24, BY PATERSON GROUP DATED AUGUST 8, 2017.
  - THE CONTRACTOR IS RESPONSIBLE FOR OBTAINING ALL PERMITS REQUIRED AND TO BEAR THE COST OF THE SAME.
  - BENCHMARKS: IT IS THE RESPONSIBILITY OF THE CONTRACTOR TO VERIFY THAT THE SITE BENCHMARK(S) HAS NOT BEEN ALTERED OR DISTURBED AND THAT ITS RELATIVE ELEVATION AND DESCRIPTION AGREES WITH THE INFORMATION DEPICTED ON THIS PLAN.
  - THE LANDSCAPE ARCHITECT SHALL APPROVE ANY MODIFICATIONS ON-SITE PRIOR TO CONSTRUCTION.
  - CONTRACTOR SHALL EMPLOY QUALIFIED SURVEYOR AT THEIR EXPENSE TO SET FINISHED GRADE STAKES AND MAINTAIN GRADE CONTROL AND LAYOUT UNTIL SUBSTANTIAL COMPLETION OF WORK.

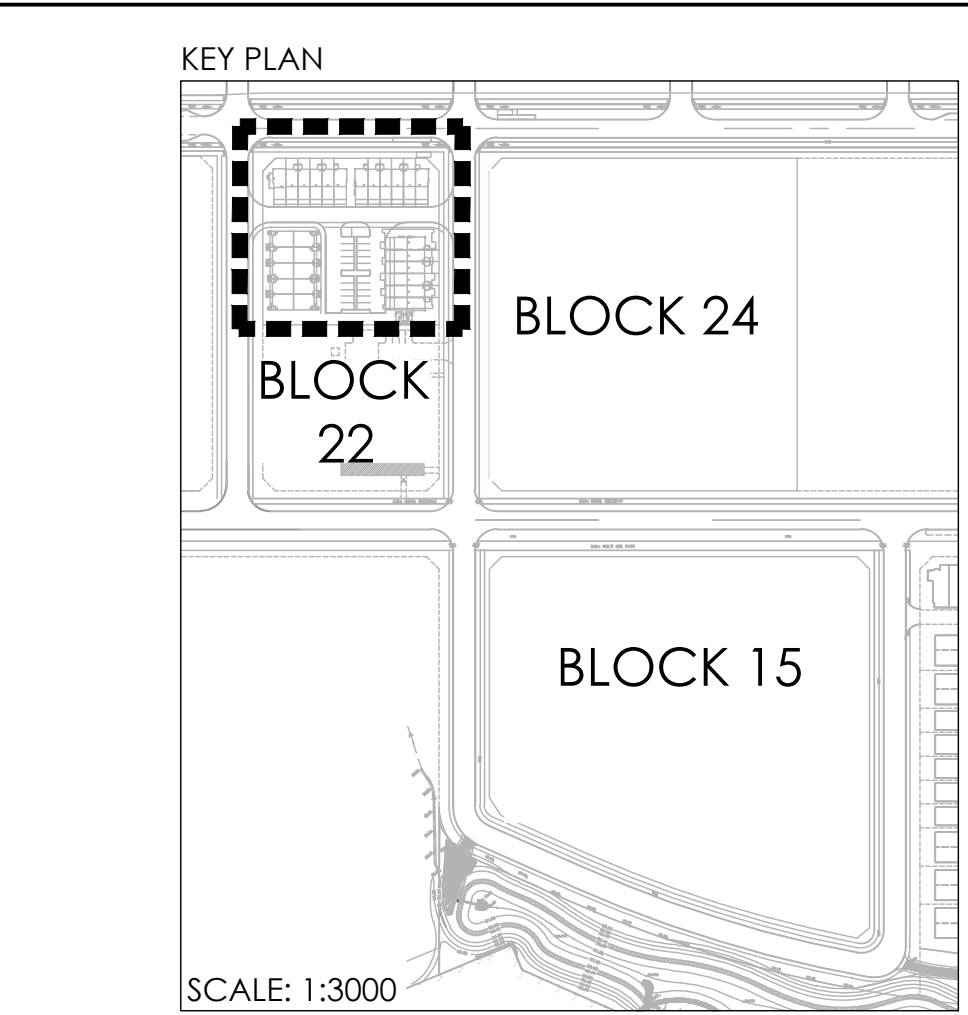

- GENERAL NOTES:
- ALL LANDSCAPE DRAWINGS TO BE READ IN CONJUNCTION WITH SITE PLAN AND GRADING PLAN.
  - ALL DIMENSIONS SHALL BE CHECKED AND VERIFIED IN THE FIELD BY THE CONTRACTOR PRIOR TO THE START OF CONSTRUCTION. ANY DISCREPANCIES SHALL BE REPORTED IMMEDIATELY TO THE LANDSCAPE ARCHITECT AND ENGINEER. LOST TIME DUE TO FAILURE OF THE CONTRACTOR TO CONFIRM UTILITY LOCATIONS AND NOTIFY ENGINEER OF POSSIBLE CONFLICTS PRIOR TO CONSTRUCTION WILL BE AT THE CONTRACTORS EXPENSE.
  - REPORT ANY DISCREPANCIES TO THE LANDSCAPE ARCHITECT PRIOR TO COMMENCING WORK. NO RESPONSIBILITY IS BORNE BY THE CONTRACT ADMINISTRATOR FOR UNKNOWN SURFACE CONDITIONS.
  - REINSTATE ALL AREAS AND ITEMS DAMAGED ON SITE AND REPORT ANY ERRORS AND/OR OMISSIONS TO LANDSCAPE ARCHITECT. ANY AREAS BEYOND THE LIMIT OF THE SITE DISTURBED DURING CONSTRUCTION SHALL BE RESTORED TO ORIGINAL CONDITION OR BETTER TO THE SATISFACTION OF THE AUTHORITY HAVING JURISDICTION AT THE CONTRACTOR'S EXPENSE.
  - ALL WORKS AND MATERIALS SHALL CONFORM TO THE LATEST REVISION OF THE STANDARDS AND SPECIFICATIONS FOR THE CITY OF OTTAWA, ONTARIO PROVINCIAL STANDARD DRAWINGS (OPSD) AND SPECIFICATIONS (OPSS), WHERE APPLICABLE. LOCAL UTILITY STANDARDS AND MINISTRY OF TRANSPORTATION STANDARDS WILL APPLY WHERE REQUIRED.
  - THERE WILL BE NO SUBSTITUTION OF MATERIALS UNLESS PRIOR WRITTEN APPROVAL IS RECEIVED FROM THE LANDSCAPE ARCHITECT.
  - ALL CONSTRUCTION SHALL BE CARRIED OUT IN ACCORDANCE WITH THE RECOMMENDATIONS MADE IN THE GEOTECHNICAL INVESTIGATION. PROPOSED BY PATERSON GROUP.
  - THE CONTRACTOR IS RESPONSIBLE FOR OBTAINING ALL PERMITS REQUIRED AND TO BEAR THE COST OF THE SAME.
  - ALL WORK SHALL BE COMPLETED IN ACCORDANCE WITH THE 'OCCUPATIONAL HEALTH AND SAFETY ACT AND REGULATIONS FOR CONSTRUCTION PROJECT'. THE GENERAL CONTRACTOR SHALL BE DEEMED TO BE THE 'CONSTRUCTOR' AS DEFINED IN THE ACT.
  - ALL CONSTRUCTION SIGNAGE MUST CONFORM TO THE MINISTRY OF TRANSPORTATION OF ONTARIO MANUAL OF UNIFORM TRAFFIC CONTROL DEVICES PER LATEST AMENDMENT.
  - THE CONTRACTOR IS ADVISED THAT WORKS BY OTHERS MAY BE ONGOING DURING THE PERIOD OF THIS CONTRACT. THE CONTRACTOR SHALL COORDINATE CONSTRUCTION ACTIVITIES TO PREVENT CONFLICTS.
  - SHOULD DEEPLY BURIED ARCHAEOLOGICAL REMAINS BE FOUND ON THE PROPERTY DURING CONSTRUCTION ACTIVITIES, THE HERITAGE OPERATIONS UNIT OF THE ONTARIO MINISTRY OF CULTURE MUST BE NOTIFIED IMMEDIATELY.
  - THE LOCATION OF THE TREES SHOWN ON THIS PLAN IS APPROXIMATE AND SHALL NOT BE SCALED FROM THIS DRAWING. THIS PLAN MUST BE READ IN CONJUNCTION WITH THE APPROVED CLIP AND CITY CROSS SECTIONS.
  - THE CONTRACTOR SHALL CONFIRM THE LOCATION OF ALL EXISTING UTILITIES WITHIN THE SITE AND ADJACENT WORK AREAS. THE CONTRACTOR SHALL BE RESPONSIBLE FOR PROTECTING ALL EXISTING UTILITIES TO THE SATISFACTION OF THE AUTHORITY HAVING JURISDICTION. THE CONTRACTOR SHALL BE RESPONSIBLE FOR THE REPAIR OR REPLACEMENT OF ANY SERVICES OR UTILITIES DISTURBED DURING CONSTRUCTION. TO THE SATISFACTION OF THE AUTHORITY HAVING JURISDICTION.
  - DRAWINGS SHALL BE READ IN CONJUNCTION WITH THE CIVIL, LIGHTING AND ARCHITECTURAL DRAWINGS.
  - CONTRACTOR SHALL EMPLOY QUALIFIED SURVEYOR AT THEIR EXPENSE TO SET FINISHED GRADE STAKES AND MAINTAIN GRADE CONTROL AND LAYOUT UNTIL SUBSTANTIAL COMPLETION OF WORK.
  - BENCHMARKS: IT IS THE RESPONSIBILITY OF THE CONTRACTOR TO VERIFY THAT THE SITE BENCHMARK(S) HAS NOT BEEN ALTERED OR DISTURBED AND THAT ITS RELATIVE ELEVATION AND DESCRIPTION AGREES WITH THE INFORMATION DEPICTED ON THIS PLAN.
  - TREE PLANTING GUIDELINE  
APPROVED CROSS SECTIONS SHALL TAKE PRECEDENCE  
4.5M - STREET LIGHT  
2.5M - STREET LIGHT (SMALL TREE <7M MATURE HT.)  
3.0M - HYDRO TRANSFORMER ACCESS DOOR  
1.5M - HYDRO TRANSFORMER SIDES AND BACKS  
1.0M - HYDRO LATERAL  
1.5M - PATH, DRIVEWAY, FENCE  
4.5M - CONIFERS MINIMUM SETBACK FROM CURB  
2.5M - FIRE HYDRANTS  
1.5M - WATER SERVICE / CURB STOP  
1.0M - BELL / CABLE PEDESTALS

Contractor shall check all dimensions on the work and report any discrepancy to the Landscape Architect before proceeding. All drawings and specifications are the property of the Landscape Architect and must be returned at the completion of the work. This drawing is not to be used for construction until signed by the Landscape Architect.

Location Plan

LEGEND

LIMIT OF WORK

FENCING

2.0m HT GARBAGE ENCLOSURE FENCE

SURFACING

LIGHT DUTY UNIT PAVING - TYPE 1

HEAVY DUTY UNIT PAVING - TYPE 2

LIGHT DUTY ENTRANCE PAVING - TYPE 3

HEAVY DUTY CIP CONCRETE PAVING

RIVERSTONE EDGING

STEPPING STONE CONCRETE SLAB

PLANTING

STREET TREES (BY OTHERS)

ORNAMENTAL PLANTING

FOOD GARDEN

SOD

AMENITIES

WALL MOUNT BENCH WITHOUT BACK

ART FEATURES

BIKE RACK

DETAIL KEY

DETAIL NO. SHEET NO.

-		
-		
-		
4	Issued for 2nd Site Plan Control Application	30.09.20
3	Issued for 1st Site Plan Control Application	05.26.20
2	Issued for Coordination	05.05.20
1	Issued for 1st Submission Client Review	22.04.20
No.	Description	Date
Revision		
City Approval Stamp		

ASSOCIATION OF LANDSCAPE ARCHITECTS ONTARIO

NAK design strategies

1285 WELLINGTON STREET WEST, OTTAWA, ON K1Y 3A8 CANADA  
T 613.237.2345 F 613.237.6423 NAKDESIGNSTRATEGIES.COM

Project

WATERIDGE VILLAGE

Title

LANDSCAPE PLAN  
BLOCK 22

Date: Sept 2020  
Scale: 1:300  
Drawn: TY  
Checked: TM  
Job No.: 20-076

Sheet

L-01



PLANT LIST								
KEY	QTY.	BOTANICAL NAME	COMMON NAME	NATIVE (N)	MATURE SIZE (HT./WD.)	CAL/HT. (mm)	ROOT	
MEDIUM OR LARGE DECIDUOUS TREES								
AR	2	ACER RUBRUM	RED MAPLE	N	15m/12m	50	W.B.	
GB	2	GINKGO BILOBA 'AUTUMN GOLD'	AUTUMN GOLD MAIDENHAIR TREE	C	15m/10m	50	W.B.	
CONIFEROUS TREES								
TE	52	THUJA OCCIDENTALIS 'EMERALD'	EMERALD CEDAR	C	5m/1.25m	300cm	B&B	
DECIDUOUS SHRUBS								
Cs	38	CORNUS SERICEA 'KELSEY'	KELSEY DWARF DOGWOOD	C	0.6m/0.6m	60cm	3 GAL.	
Cs	8	CORNUS SERICEA	RED OSIER DOGWOOD	N	2m/2.5m	60cm	3 GAL.	
Ca	27	CEANOTHUS AMERICANUS	NEW JERSEY TEA	N	1.25m/1.25m	60cm	3 GAL.	
Va	15	VIBURNUM ACERIFOLIUM	MAPLE LEAF VIBURNUM	N	1.75m/1.25m	60cm	3 GAL.	
VI	12	VIBURNUM TRILOBUM 'COMPACTUM'	DWARF AMERICAN CRANBERRY	C	1.5m/1.5m	60cm	3 GAL.	
CONIFEROUS AND EVERGREEN SHRUBS								
Js	23	JUNIPERUS SABINA 'TAM ARSICIFOLIA'	TAM ARIX JUNIPER	O	0.6m/2m	60cm	3 GAL.	
GRASSES/PERENNIALS/PERNS								
dc	38	DESCHAMPSIA CESPITOSA	TUFTED HAIR GRASS	N	0.9m/0.8m	30cm	1 GAL.	
ep	15	ECHINACEA PURPUREA	PURPLE CONEFLOWERS	N	1.2m/0.6m	30cm	1 GAL.	
ss	192	SCHIZACHYRIUM SCOPARIUM	LITTLE BLUESTEM	N	0.8m/0.6m	30cm	1 GAL.	
	247							

NATIVE LEGEND  
N NATIVE  
C CULTIVAR OF NATIVE SPECIES  
O NON-NATIVE

\*CULTIVARS OF NATIVE SPECIES MAY BE SPECIFIED DEPENDING ON LANDSCAPE VALUE.  
\*\*STREET TREES BY OTHERS. REFER TO CLC DRAWINGS

#### STREET TREES (BY OTHERS)

Ar Acer Rubrum  
Af Acer x freemanii 'Celebration'  
As Acer saccharum 'Commemoration'  
Ca Celtis occidentalis  
Gt Gleditsia triacanthos  
Qa Quercus alba  
Qr Quercus rubra  
Tc Tilia cordata  
Uw Ulmus wilsonii 'Prospector'

Am Amelanchier laevis 'Spring Runy'  
Cc Carpinus caroliniana  
Md Malus 'Donald Wyman'  
Ps Prunus sargentii

#### TREE PLANTING IN MARINE CLAY SOILS

\*THE LANDSCAPE CONSIDERATIONS CONTAINED WITHIN SEC. 6.8 OF PATERSON GROUP'S GEOTECHNICAL INVESTIGATION, DATED SEPTEMBER 10, 2020, REPORT PG5345-1, REVISION 1 HAVE BEEN IMPLEMENTED.

1. THIS LANDSCAPE PLAN CONFORMS WITH THE TREE-TO-FOUNDATION SETBACK, SOIL VOLUME, AND SURFACE GRADING REQUIREMENTS OUTLINED IN THE CITY OF OTTAWA'S GUIDELINES FOR TREE PLANTING IN SENSITIVE MARINE CLAY SOILS (2017). BASED ON THE FINDINGS OUTLINED IN THE PROJECT GEOTECHNICAL REPORT.
2. ADDITIONAL REQUIREMENTS OUTLINED IN THE CITY OF OTTAWA'S GUIDELINES FOR TREE PLANTING IN SENSITIVE MARINE CLAY SOILS (2017), INCLUDING USF DEPTH, FOUNDATION WALL REINFORCEMENT, AND SUBDIVISION GRADING, SHOULD BE CONFIRMED BY THE PROJECT ENGINEER(S).
3. THE CONTRACTOR SHOULD REPORT ANY DISCREPANCIES TO THE CONTRACT ADMINISTRATOR BEFORE PLANTING TREES.
4. CITY OF OTTAWA: GUIDELINES FOR TREE PLANTING IN SENSITIVE MARINE CLAY SOILS (2017): THE FOLLOWING GUIDELINES ARE PRIMARILY FOCUSED ON SMALL AND MEDIUM SIZE STREET TREES. HOWEVER, LARGE TREES (MATURE HEIGHT OVER 14M) CAN STILL BE PLANTED IN AREAS OF SMC SOILS PROVIDED A TREE TO FOUNDATION SETBACK EQUAL TO THE FULL MATURE HEIGHT OF THE TREE CAN BE PROVIDED (E.G. IN A PARK OR OTHER GREEN SPACE). FOR STREET TREES IN THE ROAD RIGHT-OF-WAY WHERE SMC SOILS HAVE BEEN IDENTIFIED, THE TREE TO FOUNDATION SETBACKS MAY BE REDUCED TO 4.5M FOR SMALL (MATURE TREE HEIGHT UP TO 7.5M) AND MEDIUM SIZE TREES (MATURE TREE HEIGHT 7.5M-14M) PROVIDED ALL OF THE FOLLOWING SIX CONDITIONS ARE MET:

1. THE MODIFIED PLASTICITY INDEX OF THE SOIL BETWEEN THE UNDERSIDE OF FOOTING (USF) AND A DEPTH OF 3.5M GENERALLY DOES NOT EXCEED 40%. THIS CORRESPONDS TO SOILS WITH LOW/MEDIUM POTENTIAL FOR SOIL VOLUME CHANGE. CLAY SOILS THAT EXCEED THE 40% PLASTICITY INDEX ARE CONSIDERED TO HAVE HIGH POTENTIAL FOR SOIL VOLUME CHANGE. FOR THESE WORST-CASE SOILS, THE SETBACKS AND TREE PLANTING RESTRICTIONS REMAIN UNCHANGED FROM THE 2005 CLAY SOILS POLICY (TREE SETBACK MUST EQUAL THE MATURE HEIGHT OF THE TREE - I.E. 7.5M SETBACK FOR SMALL TREES).
2. THE USF IS 2.1M OR GREATER BELOW THE LOWEST FINISHED GRADE. NOTE: THIS FOOTING LEVEL MUST BE SATISFIED FOR FOOTINGS WITHIN 10M OF THE TREE, AS MEASURED FROM THE CENTRE OF THE TREE TRUNK, AND VERIFIED BY MEANS OF THE GRADING PLAN AS INDICATED IN THE PROCEDURAL CHANGES BELOW.
3. A SMALL SIZE TREE MUST BE PROVIDED WITH A MINIMUM OF 25M3 OF AVAILABLE SOIL VOLUME, AS DETERMINED BY A LANDSCAPE ARCHITECT. A MEDIUM SIZE TREE MUST BE PROVIDED WITH A MINIMUM OF 30M3 OF AVAILABLE SOIL VOLUME, AS DETERMINED BY A LANDSCAPE ARCHITECT. THE DEVELOPER WILL ENSURE THE SOIL IS GENERALLY UNCOMPACTED WHEN BACKFILLING IN STREET TREE PLANTING LOCATIONS.  
NOTE: THE SOIL VOLUME CALCULATION MUST BE BASED ON A DEPTH OF 1.5M BELOW FINISHED GRADE (E.G. 5M LENGTH X 4M WIDTH AT SURFACE X 1.5M DEPTH = 30M3). IT MAY INCLUDE LANDS IN THE RIGHT-OF-WAY AND ON PRIVATE PROPERTY, BUT MUST SUBTRACT THE VOLUME OF SHALLOW UTILITY TRENCHES (I.E. VOLUME OF SHALLOW UTILITY TRENCHES CANNOT COUNT TOWARDS MINIMUM SOIL VOLUME).
4. THE TREE SPECIES MUST BE SMALL TO MEDIUM SIZE, AS CONFIRMED BY A LANDSCAPE ARCHITECT IN THE LANDSCAPE PLAN.
5. THE FOUNDATION WALLS ARE TO BE REINFORCED AT LEAST NOMINALLY (MINIMUM OF TWO UPPER AND TWO LOWER 15M BARS IN THE FOUNDATION WALL) TO PROVIDE DUCTILITY AS DESCRIBED IN THE GEOTECHNICAL REPORT.
6. GRADING SURROUNDING THE TREE MUST PROMOTE DRAINING TO THE TREE ROOT ZONE (IN SUCH A MANNER AS NOT TO BE DETRIMENTAL TO THE TREE), AS NOTED ON THE SUBDIVISION GRADING PLAN.

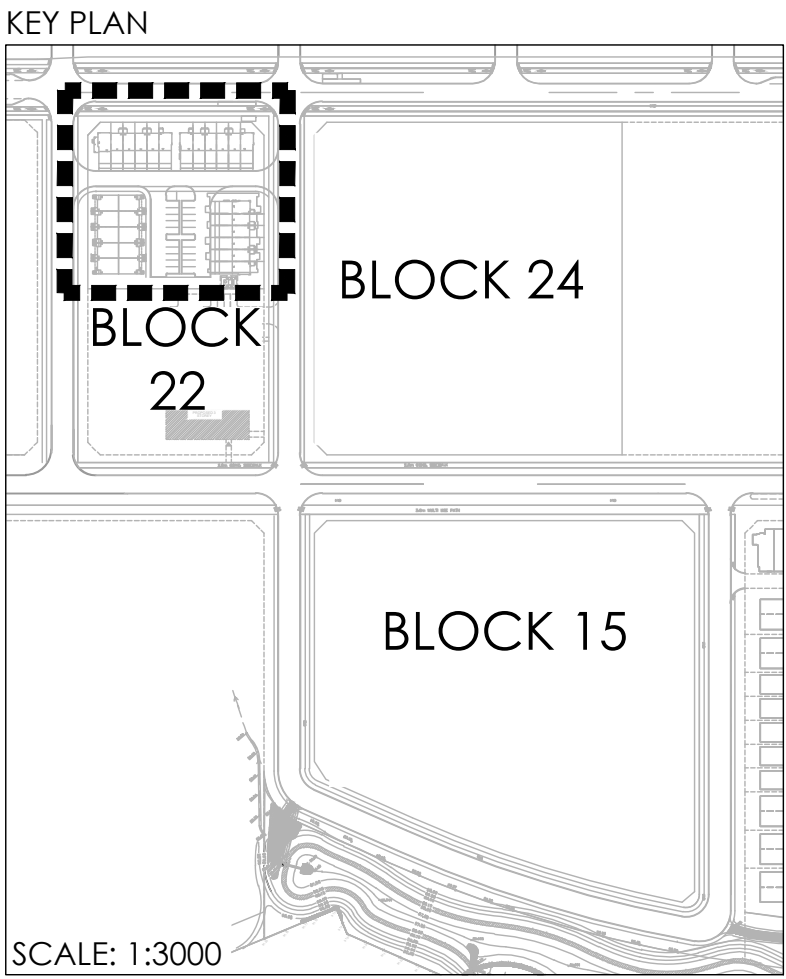
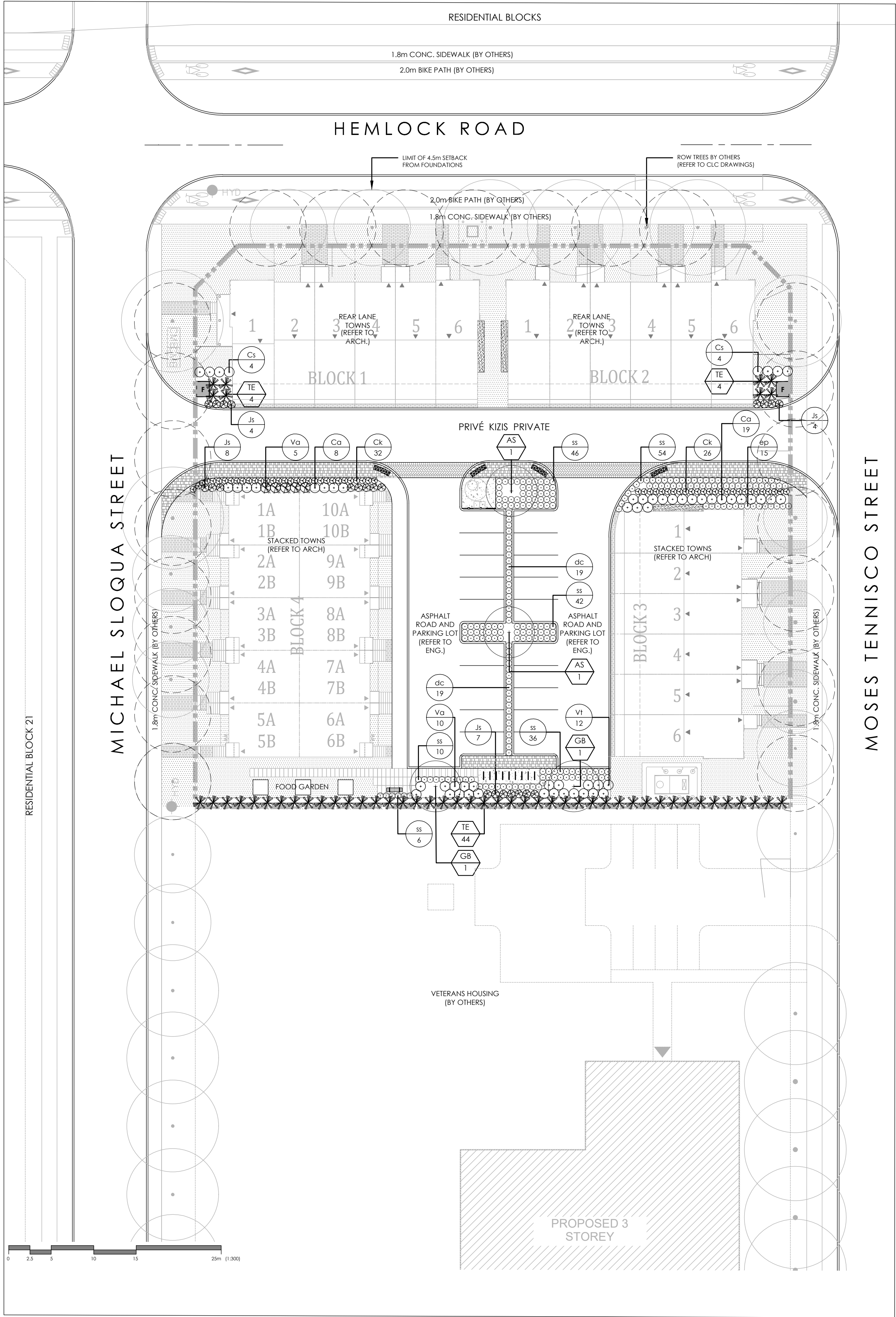

#### PLANTING NOTES:

1. CONTRACTOR TO VERIFY LOCATION OF ALL SERVICES PRIOR TO ANY EXCAVATION.
2. LOCATIONS OF ALL PLANT MATERIALS TO BE STAKED BY THE CONTRACTOR AND VERIFIED IN THE FIELD BY LANDSCAPE ARCHITECT PRIOR TO THE EXCAVATION OF PITS.
3. ALL PLANT MATERIAL SHALL BE NURSERY GROWN STOCK UNLESS OTHERWISE NOTED.
4. DECIDUOUS TREES TO HAVE A MINIMUM 1800 CLEAR STEM ABOVE GRADE.
5. ALL PLANT MATERIAL SHALL BE WARRANTED FOR TWO YEARS FROM THE DATE OF PERFORMANCE ACCEPTANCE AS DETERMINED BY THE LANDSCAPE ARCHITECT.
6. ALL STEEL I-BARS TO BE REMOVED AT THE ONE YEAR INTERIM INSPECTION UNLESS OTHERWISE DIRECTED BY THE LANDSCAPE ARCHITECT.
7. CONTRACTOR TO MAKE GOOD ALL EXISTING AREAS DAMAGED BY HIS WORK TO THE SATISFACTION OF THE LANDSCAPE ARCHITECT.
8. PERIODIC REVIEWS OF PLANTING SHALL BE CARRIED OUT BY THE LANDSCAPE ARCHITECT.
9. ACER RUBRUM TO BE SPRING DUG SPECIMENS AND PLANTING IN THE SPRING ONLY.
10. ANY PROPOSED SUBSTITUTIONS OF PLANT SPECIES SHALL BE MADE WITH PLANTS OF EQUIVALENT OVERALL FORM, HEIGHT, BRANCHING HABIT, FLOWER, LEAF, COLOR, FRUIT AND CULTURE AND ONLY AFTER APPROVAL OF THE LANDSCAPE ARCHITECT.

#### SHRUB NOTES:

1. PLACE THE SHRUB AS UPRIGHT AS POSSIBLE, INCLUDING ON SLOPES.
2. PLANT SHRUBS AT THE PROPER DEPTH AS INDICATED ON THE DRAWINGS.
3. PACK THE SOIL WELL AROUND THE PLANT BASE TO REMOVE AIR POCKETS, BUT DON'T OVER PACK IT. PRESS GENTLY BUT FIRMLY TO PREVENT SHOCKING THE ROOTS.
4. PLACE SPECIES ACCORDING TO THE QUANTITIES AND SPACING AS INDICATED ON THE DRAWINGS.
5. PLANT SHRUBS AT THE PROPER DEPTH THE ROOT COLLARS SHOULD BE AT GROUND LEVEL.
6. MULCH THE SOIL SURFACE AS INDICATED ON DRAWINGS.
7. WATER PLANTS THOROUGHLY FOLLOWING PLANTING.
8. REFER TO SPECIFICATIONS FOR MAINTENANCE REQUIREMENTS.

#### SOD NOTES:

1. SODDED AREAS SHALL HAVE A MINIMUM 150mm TOPSOIL.
2. SURVEY THE PLANTING SITE FOR INVASIVE WEEDS AND REMOVE ALL OR AS MUCH UNDESIRABLE VEGETATION AS POSSIBLE.
3. FIRM THE SOIL, GENTLY TAMP OR ROLL THE SEEDBED. DO NOT COMPACT THE SOIL. EXCESSIVE FORCE WILL DESTROY THE SOIL STRUCTURE AND INHIBIT GERMINATION.
4. CUT THE GRASS TO 50mm WHENEVER IT REACHES THE HEIGHT OF 70mm. REMOVE CLIPPINGS THAT WILL SMOTHER GRASS.
5. SODDED AREAS WILL BE ACCEPTED BY THE PROJECT MANAGER FOLLOWING PERFORMANCE ACCEPTANCE, PROVIDED:
  - SEEDING AREAS ARE PROPERLY ESTABLISHED.
  - TURF IS FREE OF DEAD SPOTS AND WEEDS.
  - NO SURFACE SOIL IS VISIBLE WHEN GRASS HAS BEEN CUT TO A HEIGHT OF 50mm.
  - TURF AREAS HAVE BEEN CUT NO LESS THAN TWICE, THE LAST CUT BEING CARRIED OUT WITHIN 24 HOURS PRIOR TO THE ACCEPTANCE INSPECTION.

Contractor shall check all dimensions on the work and report any discrepancy to the Landscape Architect before proceeding. All drawings and specifications are the property of the Landscape Architect and must be returned at the completion of the work. This drawing is not to be used for construction until signed by the Landscape Architect.



LEGEND	
--- LIMIT OF WORK	
FENCING	
--- 2.0m HT GARBAGE ENCLOSURE FENCE	
PLANTING	
● STREET TREES (BY OTHERS)	
● LARGE DECIDUOUS TREE	
✱ CONIFEROUS TREE	
⊗ DECIDUOUS SHRUBS	
⊗ CONIFEROUS/EVERGREEN SHRUBS	
○ GRASSES/PERENNIALS	
■ ORNAMENTAL PLANTING	
■ FOOD GARDEN	
■ SOD	
AMENITIES	
■ WALL MOUNT BENCH WITHOUT BACK	
■ ART FEATURES	
■ BIKE RACK	
PLANTING KEY	
XX/00 TREE SPECIES QUANTITY	
XX/00 SHRUB SPECIES QUANTITY	

-		
-		
-		
4	Issued for 2nd Site Plan Control Application	30.09.20
3	Issued for 1st Site Plan Control Application	05.26.20
2	Issued for Coordination	05.05.20
1	Issued for 1st Submission Client Review	22.04.20
No.	Description	Date
Revision		
City Approval Stamp		

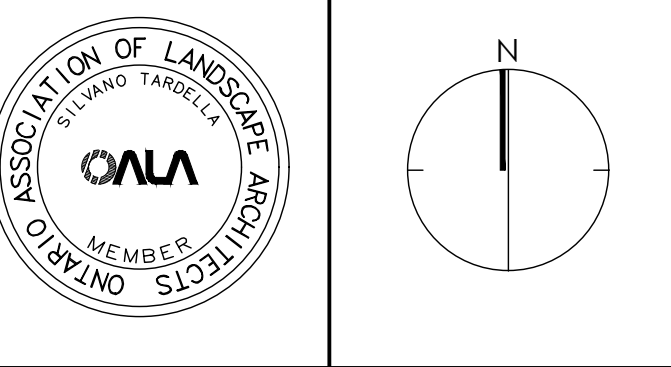

**NAK** design strategies  
1285 WELLINGTON STREET WEST, OTTAWA, ON K1T 3A8 CANADA  
T 613.237.2345 F 613.237.6423 [NAKDESIGNSTRATEGIES.COM](http://NAKDESIGNSTRATEGIES.COM)

Project

## WATERIDGE VILLAGE

Title		
PLANTING PLAN BLOCK 22		
Date	Sep1 2020	Sheet
Scale	1:300	
Drawn	TY	
Checked	CM	
Job No.	20-076	

L-02



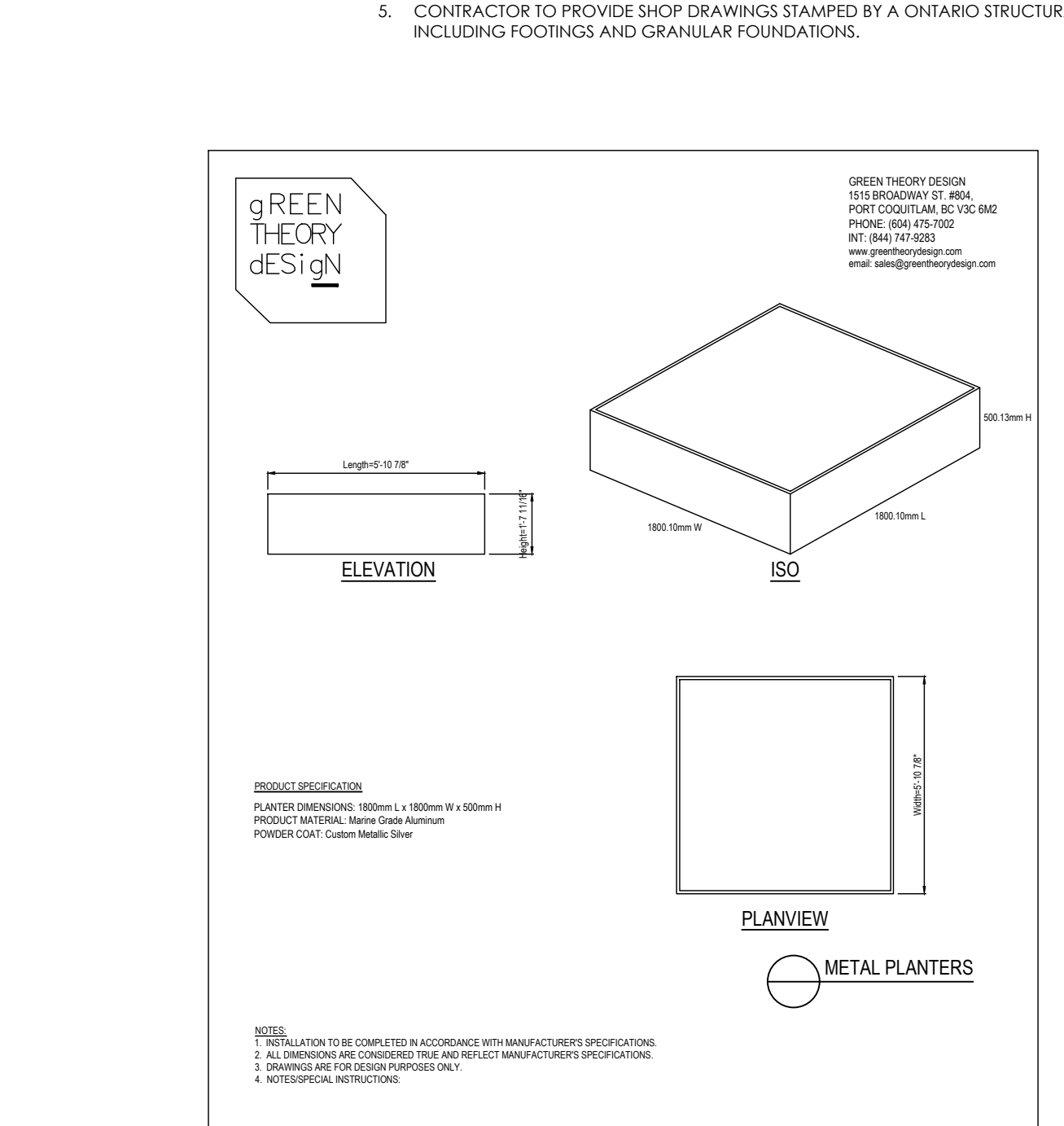
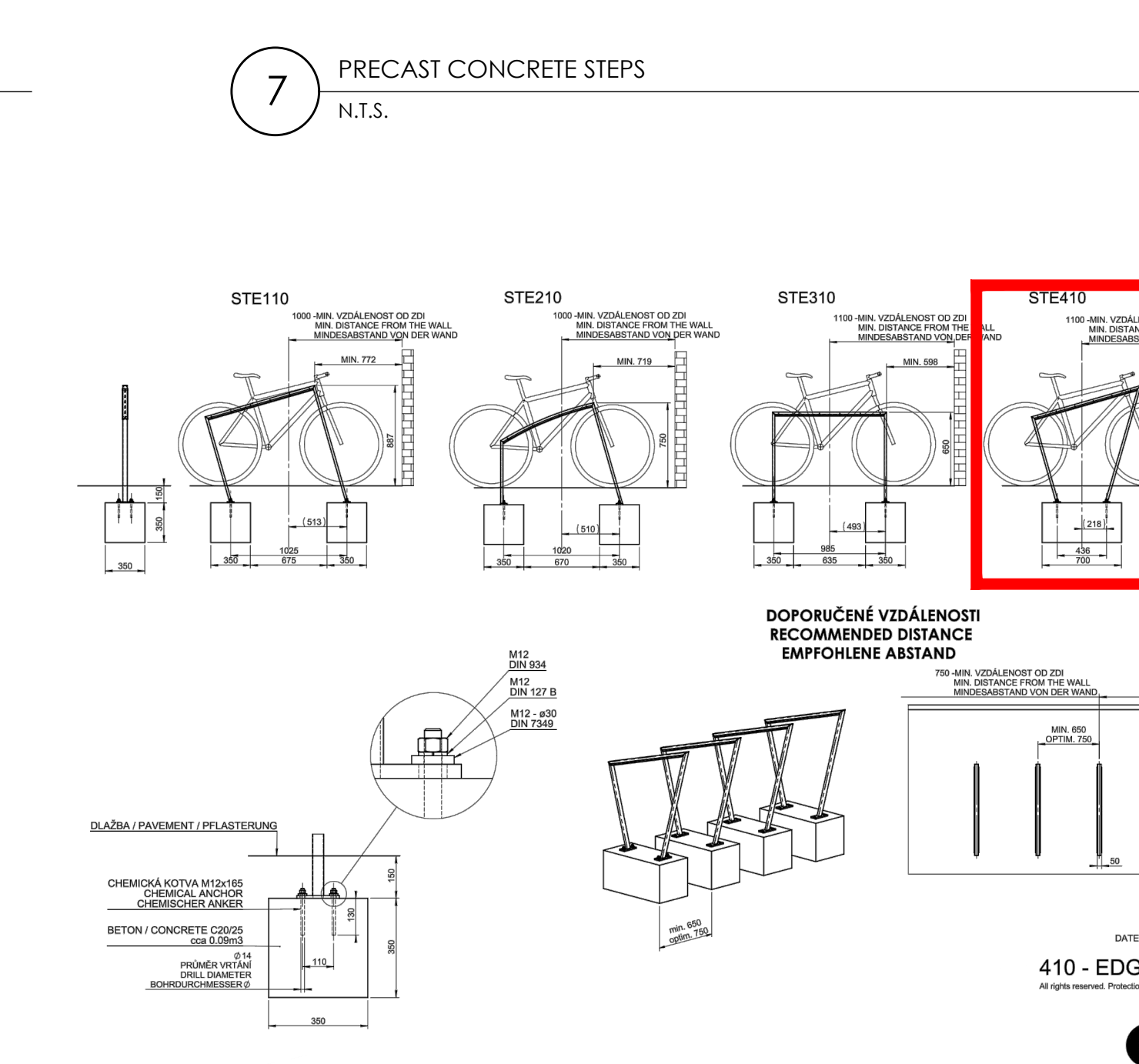
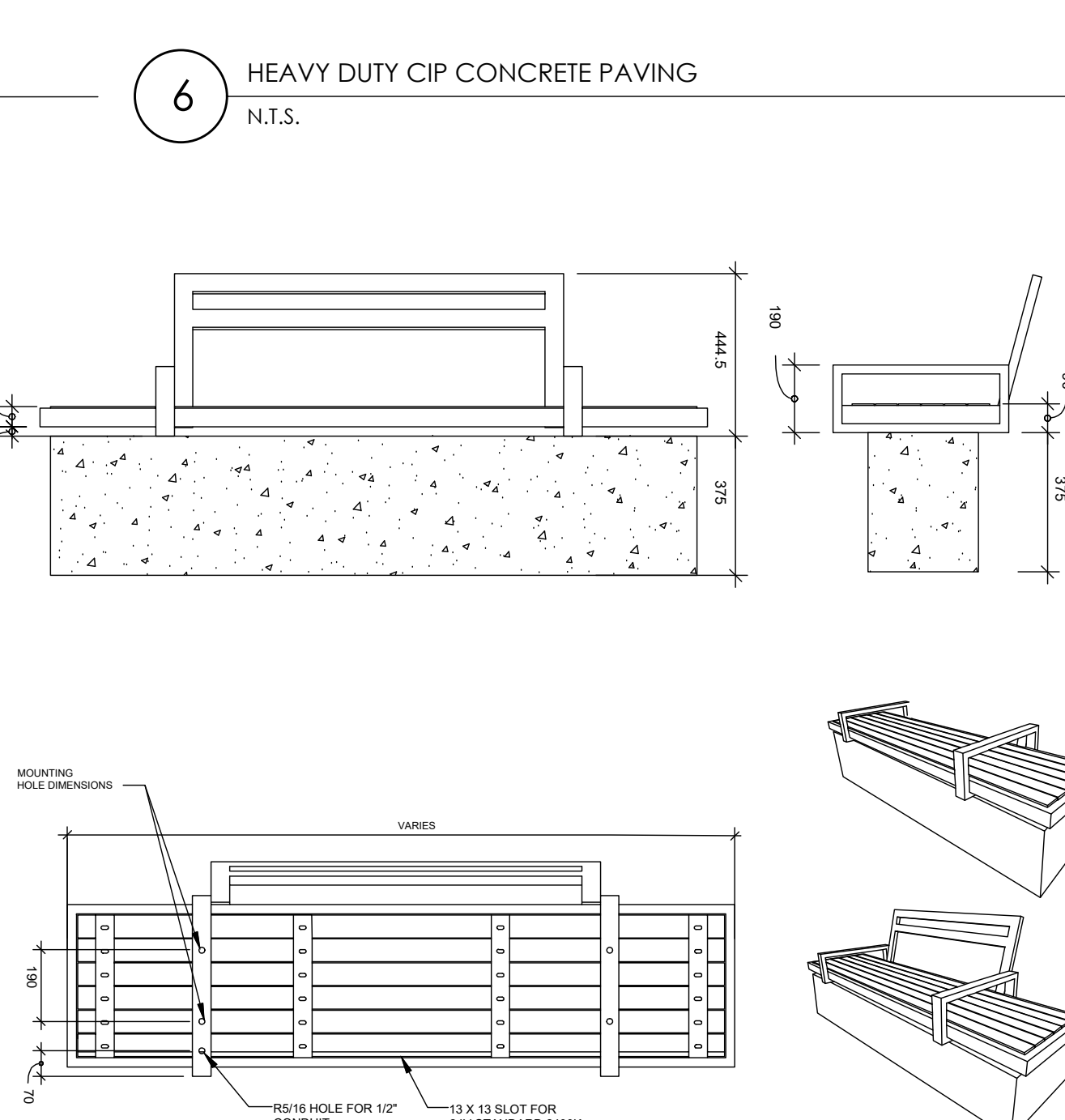
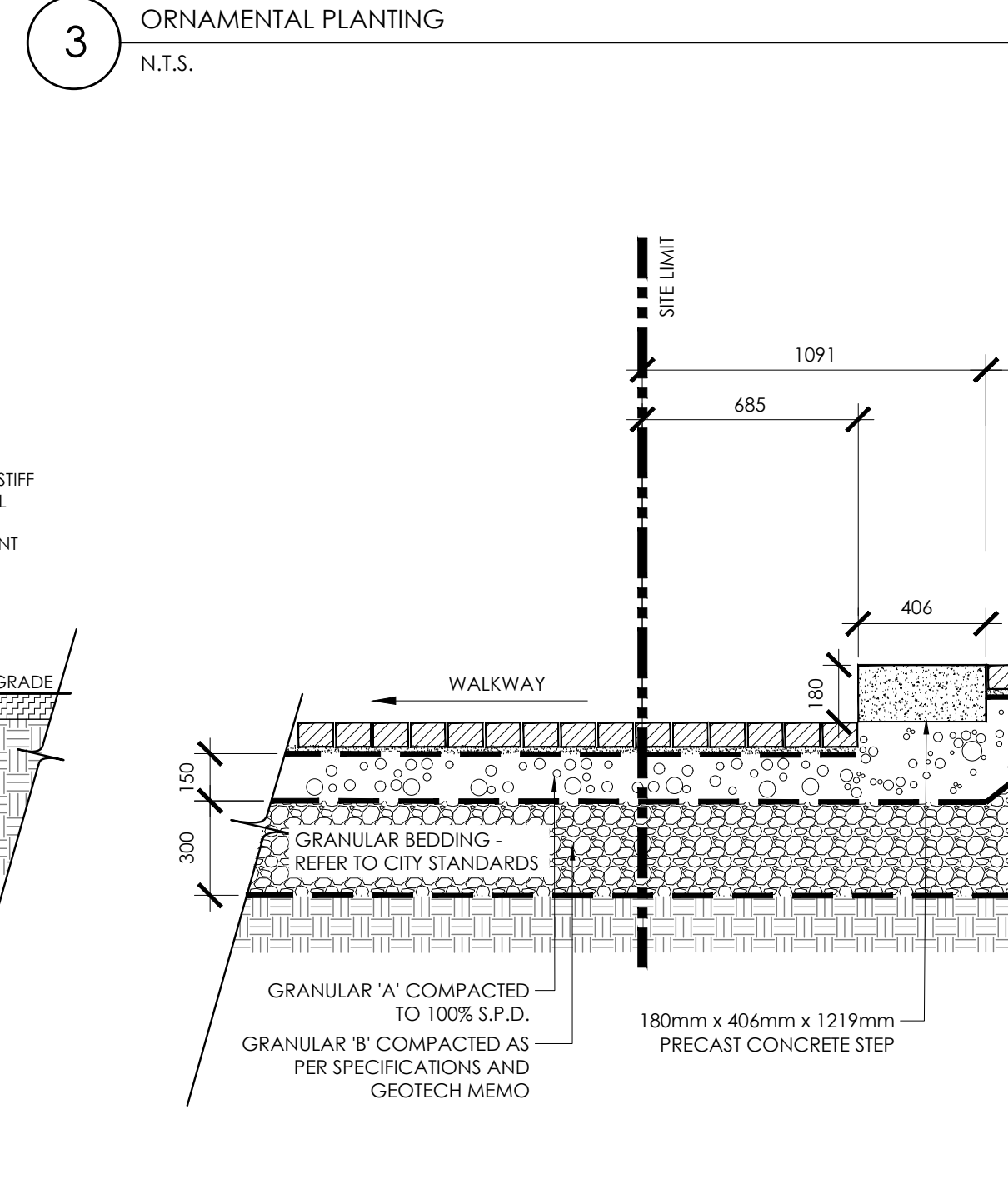
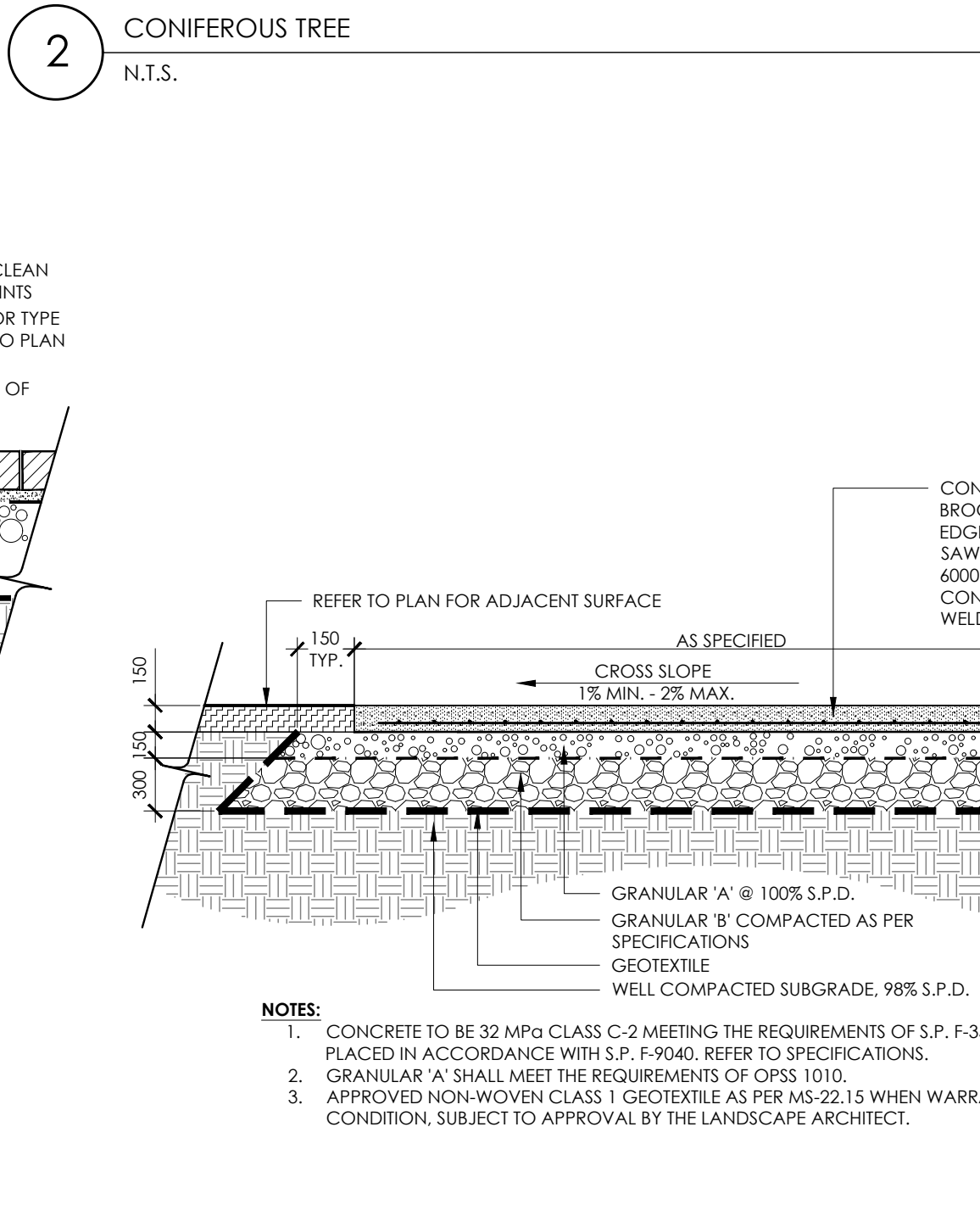
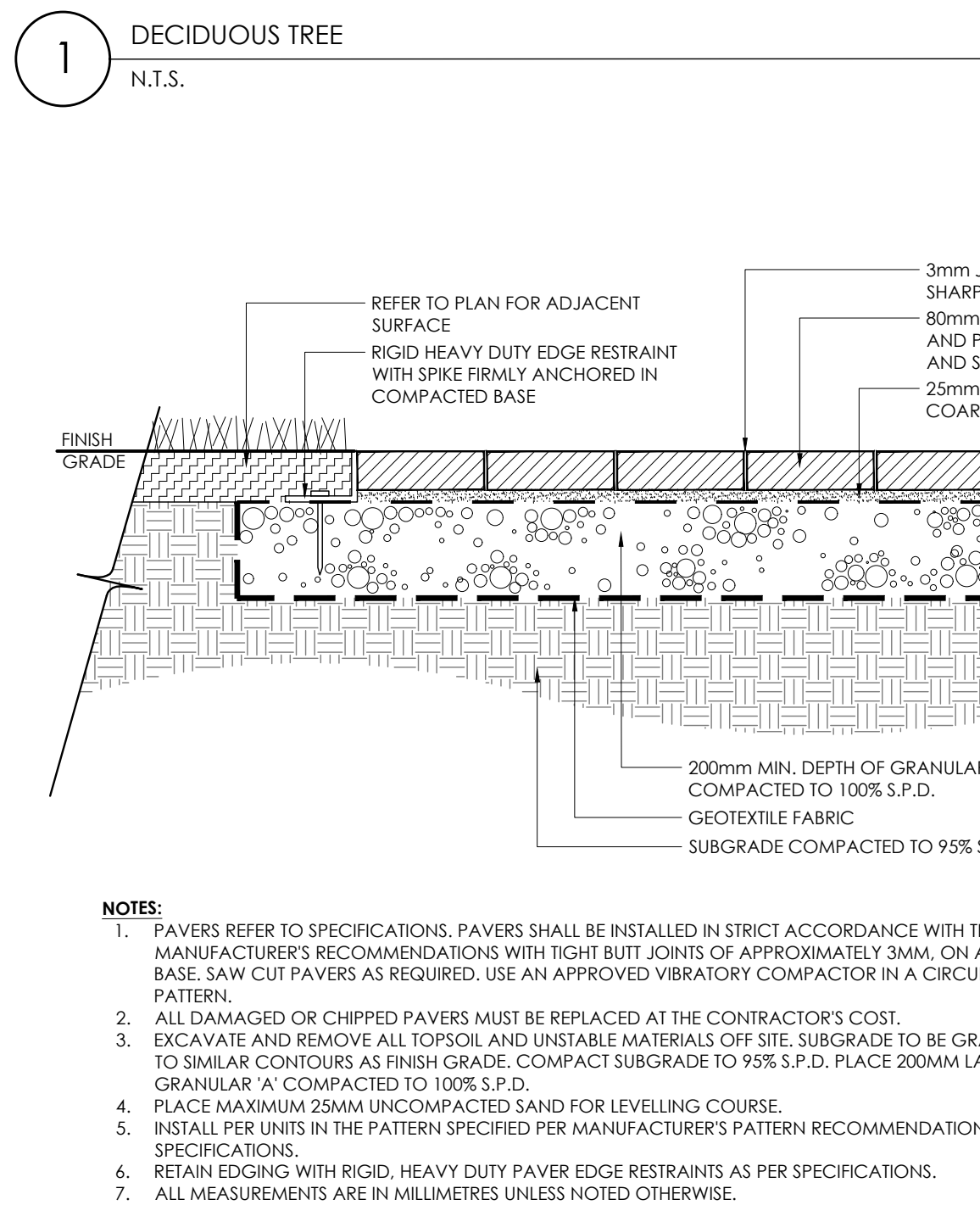
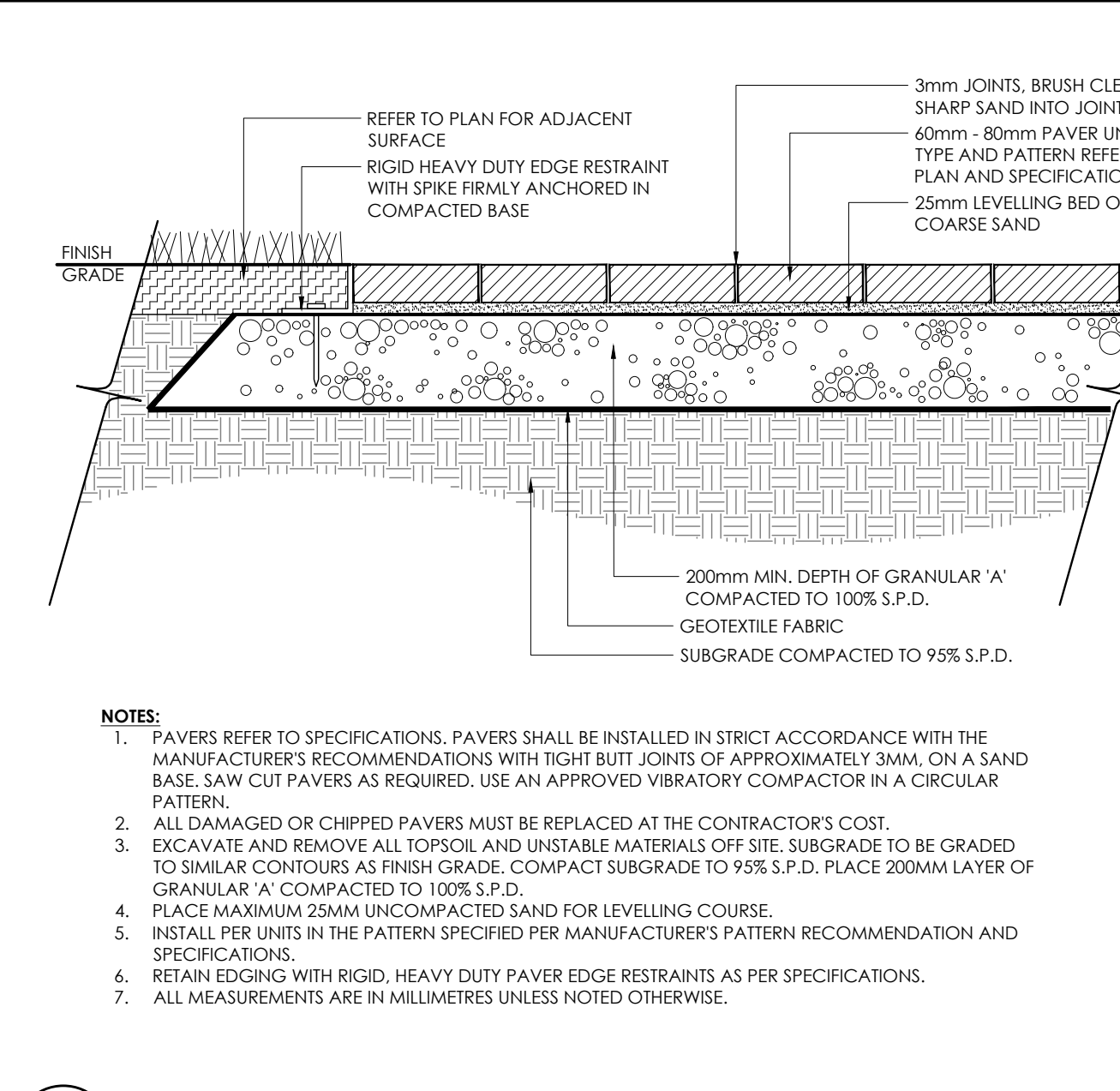
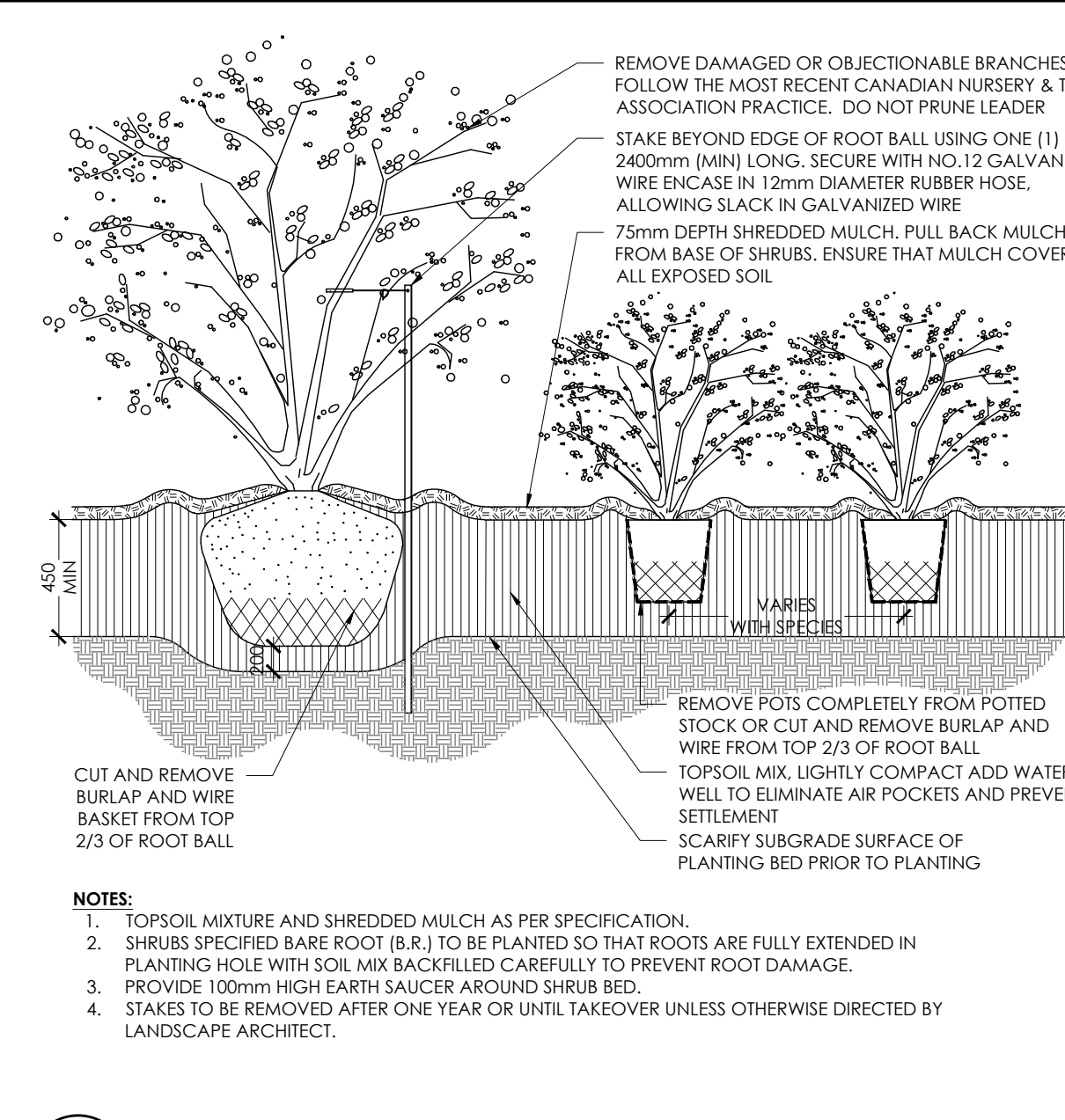
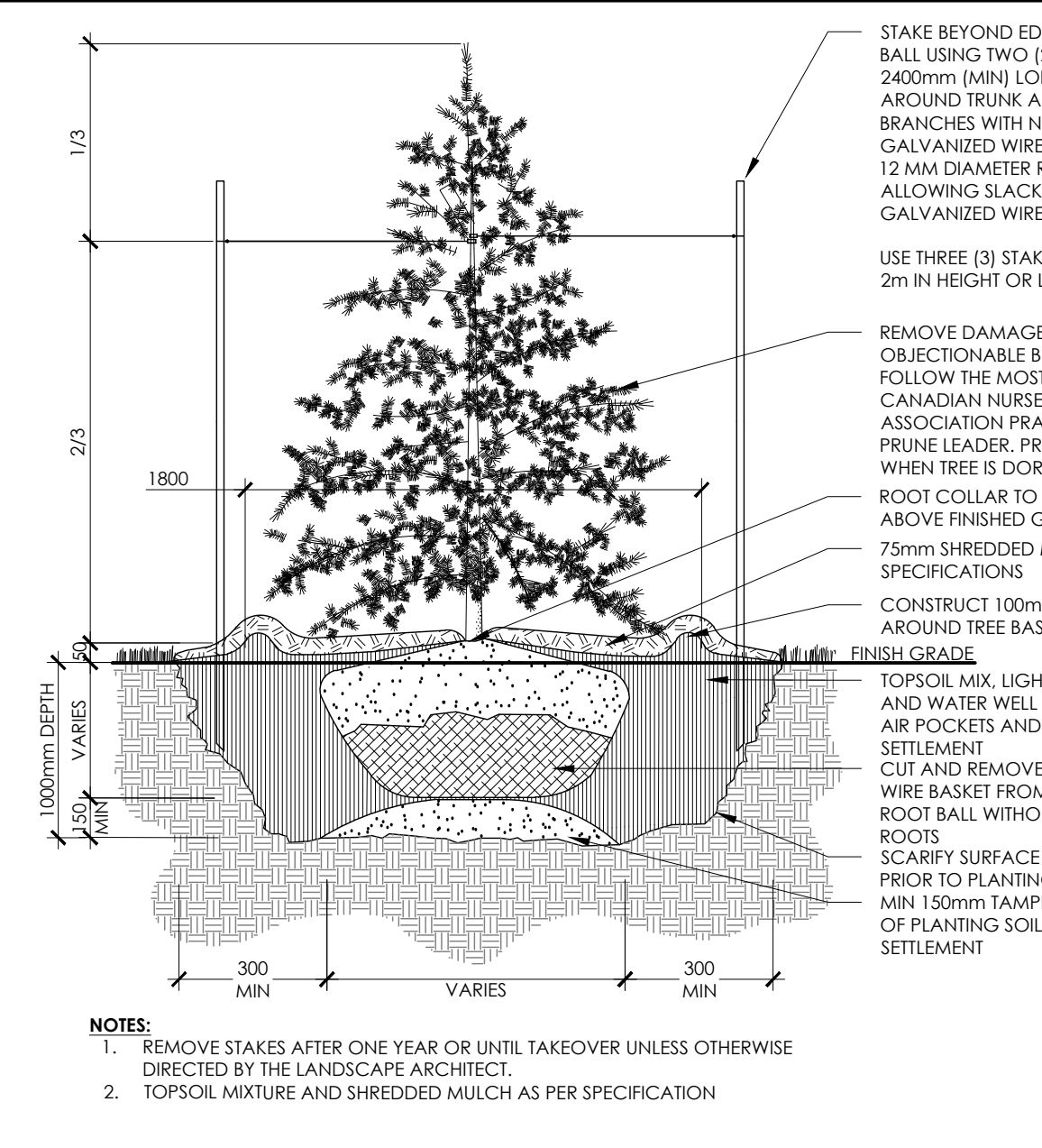
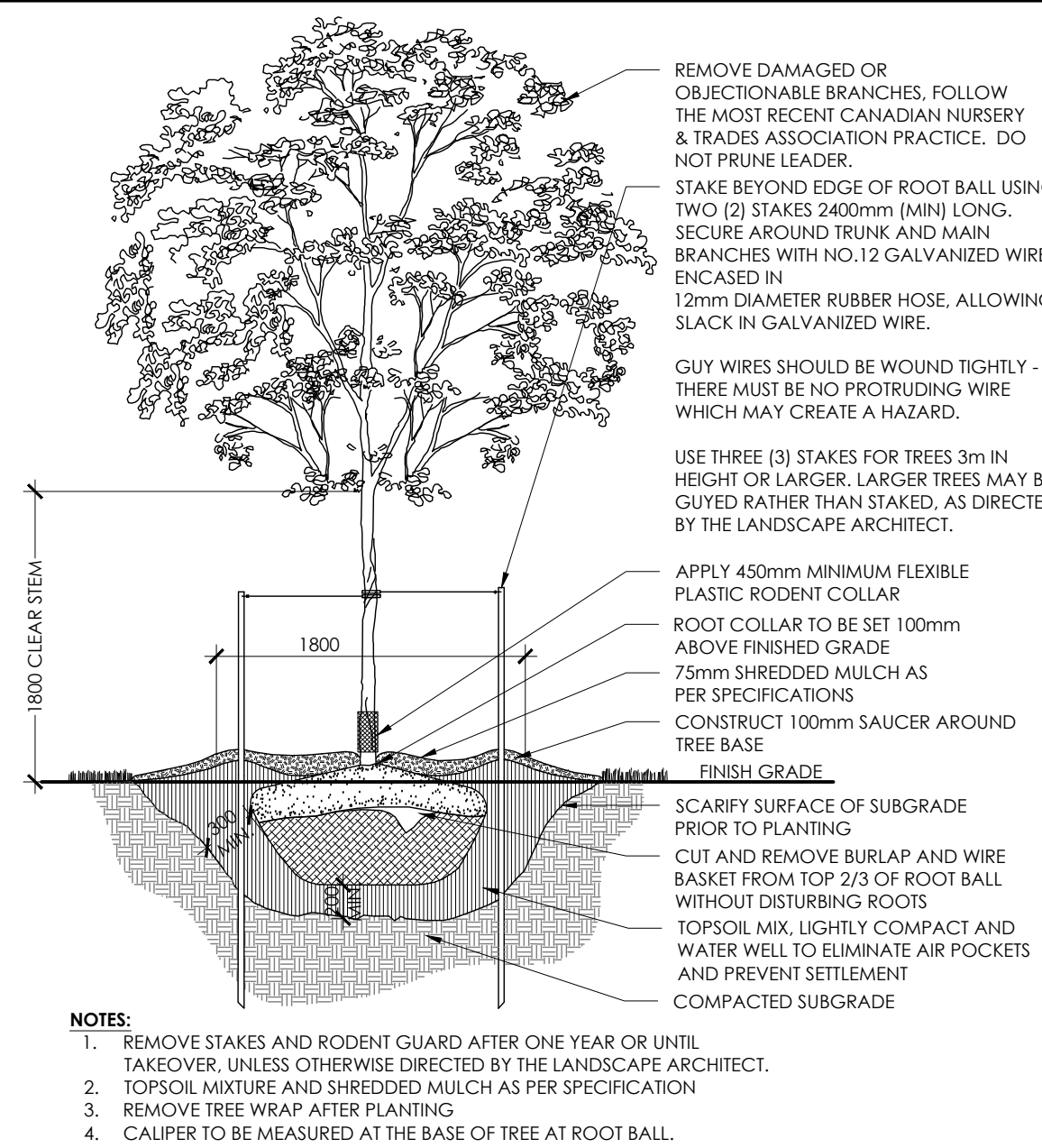

Contractor shall check all dimensions on the work and report any discrepancy to the Landscape Architect before proceeding. All drawings and specifications are the property of the Landscape Architect and must be returned after the completion of the work. This drawing is not to be used for construction until signed by the Landscape Architect.



No.	Description	Date
1	Issued for 1st Submission Client Review	22.04.20
2	Issued for Coordination	05.05.20
3	Issued for 1st Site Plan Control Application	05.26.20
4	Issued for 2nd Site Plan Control Application	30.09.20
5	Issued for 3rd Site Plan Control Application	05.26.20
6	Issued for 4th Site Plan Control Application	05.26.20
7	Issued for 5th Site Plan Control Application	05.26.20
8	Issued for 6th Site Plan Control Application	05.26.20
9	Issued for 7th Site Plan Control Application	05.26.20
10	Issued for 8th Site Plan Control Application	05.26.20
11	Issued for 9th Site Plan Control Application	05.26.20
12	Issued for 10th Site Plan Control Application	05.26.20
13	Issued for 11th Site Plan Control Application	05.26.20
14	Issued for 12th Site Plan Control Application	05.26.20
15	Issued for 13th Site Plan Control Application	05.26.20
16	Issued for 14th Site Plan Control Application	05.26.20
17	Issued for 15th Site Plan Control Application	05.26.20
18	Issued for 16th Site Plan Control Application	05.26.20
19	Issued for 17th Site Plan Control Application	05.26.20
20	Issued for 18th Site Plan Control Application	05.26.20
21	Issued for 19th Site Plan Control Application	05.26.20
22	Issued for 20th Site Plan Control Application	05.26.20
23	Issued for 21st Site Plan Control Application	05.26.20
24	Issued for 22nd Site Plan Control Application	05.26.20
25	Issued for 23rd Site Plan Control Application	05.26.20
26	Issued for 24th Site Plan Control Application	05.26.20
27	Issued for 25th Site Plan Control Application	05.26.20
28	Issued for 26th Site Plan Control Application	05.26.20
29	Issued for 27th Site Plan Control Application	05.26.20
30	Issued for 28th Site Plan Control Application	05.26.20
31	Issued for 29th Site Plan Control Application	05.26.20
32	Issued for 30th Site Plan Control Application	05.26.20
33	Issued for 31st Site Plan Control Application	05.26.20
34	Issued for 32nd Site Plan Control Application	05.26.20
35	Issued for 33rd Site Plan Control Application	05.26.20
36	Issued for 34th Site Plan Control Application	05.26.20
37	Issued for 35th Site Plan Control Application	05.26.20
38	Issued for 36th Site Plan Control Application	05.26.20
39	Issued for 37th Site Plan Control Application	05.26.20
40	Issued for 38th Site Plan Control Application	05.26.20
41	Issued for 39th Site Plan Control Application	05.26.20
42	Issued for 40th Site Plan Control Application	05.26.20
43	Issued for 41st Site Plan Control Application	05.26.20
44	Issued for 42nd Site Plan Control Application	05.26.20
45	Issued for 43rd Site Plan Control Application	05.26.20
46	Issued for 44th Site Plan Control Application	05.26.20
47	Issued for 45th Site Plan Control Application	05.26.20
48	Issued for 46th Site Plan Control Application	05.26.20
49	Issued for 47th Site Plan Control Application	05.26.20
50	Issued for 48th Site Plan Control Application	05.26.20
51	Issued for 49th Site Plan Control Application	05.26.20
52	Issued for 50th Site Plan Control Application	05.26.20
53	Issued for 51st Site Plan Control Application	05.26.20
54	Issued for 52nd Site Plan Control Application	05.26.20
55	Issued for 53rd Site Plan Control Application	05.26.20
56	Issued for 54th Site Plan Control Application	05.26.20
57	Issued for 55th Site Plan Control Application	05.26.20
58	Issued for 56th Site Plan Control Application	05.26.20
59	Issued for 57th Site Plan Control Application	05.26.20
60	Issued for 58th Site Plan Control Application	05.26.20
61	Issued for 59th Site Plan Control Application	05.26.20
62	Issued for 60th Site Plan Control Application	05.26.20
63	Issued for 61st Site Plan Control Application	05.26.20
64	Issued for 62nd Site Plan Control Application	05.26.20
65	Issued for 63rd Site Plan Control Application	05.26.20
66	Issued for 64th Site Plan Control Application	05.26.20
67	Issued for 65th Site Plan Control Application	05.26.20
68	Issued for 66th Site Plan Control Application	05.26.20
69	Issued for 67th Site Plan Control Application	05.26.20
70	Issued for 68th Site Plan Control Application	05.26.20
71	Issued for 69th Site Plan Control Application	05.26.20
72	Issued for 70th Site Plan Control Application	05.26.20
73	Issued for 71st Site Plan Control Application	05.26.20
74	Issued for 72nd Site Plan Control Application	05.26.20
75	Issued for 73rd Site Plan Control Application	05.26.20
76	Issued for 74th Site Plan Control Application	05.26.20
77	Issued for 75th Site Plan Control Application	05.26.20
78	Issued for 76th Site Plan Control Application	05.26.20
79	Issued for 77th Site Plan Control Application	05.26.20
80	Issued for 78th Site Plan Control Application	05.26.20
81	Issued for 79th Site Plan Control Application	05.26.20
82	Issued for 80th Site Plan Control Application	05.26.20
83	Issued for 81st Site Plan Control Application	05.26.20
84	Issued for 82nd Site Plan Control Application	05.26.20
85	Issued for 83rd Site Plan Control Application	05.26.20
86	Issued for 84th Site Plan Control Application	05.26.20
87	Issued for 85th Site Plan Control Application	05.26.20
88	Issued for 86th Site Plan Control Application	05.26.20
89	Issued for 87th Site Plan Control Application	05.26.20
90	Issued for 88th Site Plan Control Application	05.26.20
91	Issued for 89th Site Plan Control Application	05.26.20
92	Issued for 90th Site Plan Control Application	05.26.20
93	Issued for 91st Site Plan Control Application	05.26.20
94	Issued for 92nd Site Plan Control Application	05.26.20
95	Issued for 93rd Site Plan Control Application	05.26.20
96	Issued for 94th Site Plan Control Application	05.26.20
97	Issued for 95th Site Plan Control Application	05.26.20
98	Issued for 96th Site Plan Control Application	05.26.20
99	Issued for 97th Site Plan Control Application	05.26.20
100	Issued for 98th Site Plan Control Application	05.26.20
101	Issued for 99th Site Plan Control Application	05.26.20
102	Issued for 100th Site Plan Control Application	05.26.20

No.	Description	Date
1	Issued for 1st Submission Client Review	22.04.20
2	Issued for Coordination	05.05.20
3	Issued for 1st Site Plan Control Application	05.26.20
4	Issued for 2nd Site Plan Control Application	30.09.20
5	Issued for 3rd Site Plan Control Application	05.26.20
6	Issued for 4th Site Plan Control Application	05.26.20
7	Issued for 5th Site Plan Control Application	05.26.20
8	Issued for 6th Site Plan Control Application	05.26.20
9	Issued for 7th Site Plan Control Application	05.26.20
10	Issued for 8th Site Plan Control Application	05.26.20
11	Issued for 9th Site Plan Control Application	05.26.20
12	Issued for 10th Site Plan Control Application	05.26.20
13	Issued for 11th Site Plan Control Application	05.26.20
14	Issued for 12th Site Plan Control Application	05.26.20
15	Issued for 13th Site Plan Control Application	05.26.20
16	Issued for 14th Site Plan Control Application	05.26.20
17	Issued for 15th Site Plan Control Application	05.26.20
18	Issued for 16th Site Plan Control Application	05.26.20
19	Issued for 17th Site Plan Control Application	05.26.20
20	Issued for 18th Site Plan Control Application	05.26.20
21	Issued for 19th Site Plan Control Application	05.26.20
22	Issued for 20th Site Plan Control Application	05.26.20
23	Issued for 21st Site Plan Control Application	05.26.20
24	Issued for 22nd Site Plan Control Application	05.26.20
25	Issued for 23rd Site Plan Control Application	05.26.20
26	Issued for 24th Site Plan Control Application	05.26.20
27	Issued for 25th Site Plan Control Application	05.26.20
28	Issued for 26th Site Plan Control Application	05.26.20
29	Issued for 27th Site Plan Control Application	05.26.20
30	Issued for 28th Site Plan Control Application	05.26.20
31	Issued for 29th Site Plan Control Application	05.26.20
32	Issued for 30th Site Plan Control Application	05.26.20
33	Issued for 31st Site Plan Control Application	05.26.20
34	Issued for 32nd Site Plan Control Application	05.26.20
35	Issued for 33rd Site Plan Control Application	05.26.20
36	Issued for 34th Site Plan Control Application	05.26.20
37	Issued for 35th Site Plan Control Application	05.26.20
38	Issued for 36th Site Plan Control Application	05.26.20
39	Issued for 37th Site Plan Control Application	05.26.20
40	Issued for 38th Site Plan Control Application	05.26.20
41	Issued for 39th Site Plan Control Application	05.26.20
42	Issued for 40th Site Plan Control Application	05.26.20
43	Issued for 41st Site Plan Control Application	05.26.20
44	Issued for 42nd Site Plan Control Application	05.26.20
45	Issued for 43rd Site Plan Control Application	05.26.20
46	Issued for 44th Site Plan Control Application	05.26.20
47	Issued for 45th Site Plan Control Application	05.26.20
48	Issued for 46th Site Plan Control Application	05.26.20
49	Issued for 47th Site Plan Control Application	05.26.20
50	Issued for 48th Site Plan Control Application	05.26.20
51	Issued for 49th Site Plan Control Application	05.26.20
52	Issued for 50th Site Plan Control Application	05.26.20
53	Issued for 51st Site Plan Control Application	05.26.20
54	Issued for 52nd Site Plan Control Application	05.26.20
55	Issued for 53rd Site Plan Control Application	05.26.20
56	Issued for 54th Site Plan Control Application	05.26.20
57	Issued for 55th Site Plan Control Application	05.26.20
58	Issued for 56th Site Plan Control Application	05.26.20
59	Issued for 57th Site Plan Control Application	05.26.20
60	Issued for 58th Site Plan Control Application	05.26.20
61	Issued for 59th Site Plan Control Application	05.26.20
62	Issued for 60th Site Plan Control Application	05.26.20
63	Issued for 61st Site Plan Control Application	05.26.20
64	Issued for 62nd Site Plan Control Application	05.26.20





## Melville® Plank Pavers

- Technical** Sand 1 Bag - Approx. 53 ft² coverage
- Pedestrian** - Designed to withstand pedestrian traffic
- Vehicular** - Designed to withstand car traffic

### Melville® Plank Slim Pavers

	Dimensions (mm)	Dimensions (in)
A	80 x 127 x 300	3 1/8 x 5 x 11 13/16
B	80 x 127 x 400	3 1/8 x 5 x 15 3/4
C	80 x 127 x 500	3 1/8 x 5 x 19 11/16
Weight/unit (avg)	9 kg	21 lb
Unit/area (sq)	19.61 units/m²	1.83 units/ft²
Area/layer	1.07 m²	11.48 ft²
Area/cube	8.56 m³	91.84 ft³
Qty/cube	A = 56 B = 56 C = 56	
Length/layer	8.40 lin. m	27.56 lin. ft
Length/cube	67.20 lin. m	220.48 lin. ft
Weight/cube	1610 kg	3542 lb

### Colours

Code	Colours
<b>PRESTIGE COLOURS</b>	
10550862	Range Amber Beige*
10550398	Rockland Black
10550400	Range Margaux Beige
10550392	Range Scandina Grey
<b>STANDARD COLOURS</b>	
10550861	Range Shaded Grey*
10551051	Range Habana Brown*
10550399	Range Newport Grey
10550391	Range Savannah Beige*
10559036	Range Norvick Grey*

Can be double stacked  
Sold in full cubes only  
Production location - Bolton  
\* Products available while supplies last

### Colours

Code	Colours
<b>PRESTIGE COLOURS</b>	
10550863	Range Amber Beige*
10550395	Rockland Black
10550392	Range Scandina Grey
<b>STANDARD COLOURS</b>	
10550864	Range Shaded Grey*
10551052	Range Habana Brown*
10550394	Range Newport Grey
10550396	Range Savannah Beige*
10551111	Range Norvick Grey*

Can be double stacked  
Sold in full cubes only  
Production location - Bolton  
\* Products available while supplies last

### Laying Patterns

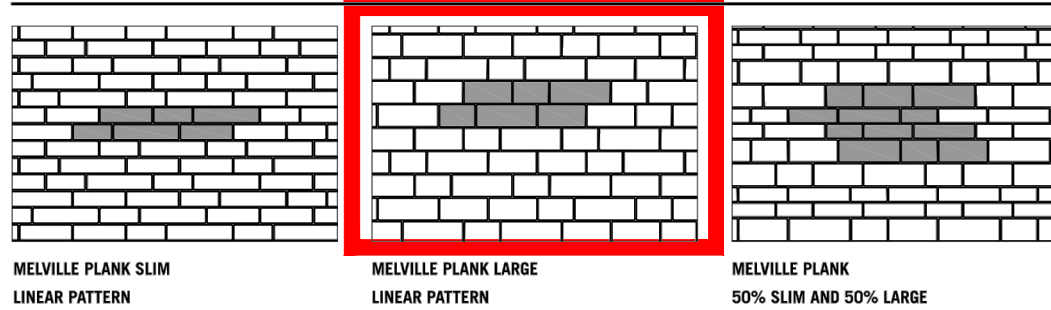

## PAVING TYPE 1 - LARGE PLANK (20 x 50cm)

N.T.S.



## Melville® 80 Pavers Small Rectangle

- Technical** Sand 1 Bag - Approx. 56 ft² coverage
- Pedestrian** - Designed to withstand pedestrian traffic
- Vehicular** - Designed to withstand car traffic

### Melville® 80 Pavers Small Rectangle

	Dimensions (mm)	Dimensions (in)
Weight/unit	14 kg	30 lb
Unit/area	13.89 units/m²	1.29 units/ft²
Area/layer	0.87 m²	9.33 ft²
Area/cube	7.83 m³	83.87 ft³
Length/layer (1)	2.28 lin. m	7.48 lin. ft
Length/cube (1)	20.52 lin. m	67.34 lin. ft
Qty/cube	108 units	108 units
Weight/cube	1465 kg	3225 lb
Weight/cube	1463 kg	3225 lb

(1) Soldier course

### Colours

Code	Colours
<b>PRESTIGE COLOURS</b>	
10550871	Range Amber Beige
10551033	Rockland Black
10551035	Range Margaux Beige*
10551031	Range Scandina Grey*
<b>STANDARD COLOURS</b>	
10550870	Range Shaded Grey
10551054	Range Habana Brown*
10551034	Range Newport Grey*
10551032	Range Savannah Beige
10559019	Range Norvick Grey*

Can be double stacked  
Sold in full cubes only  
Production location - Bolton  
\* Products available while supplies last

### Laying Patterns

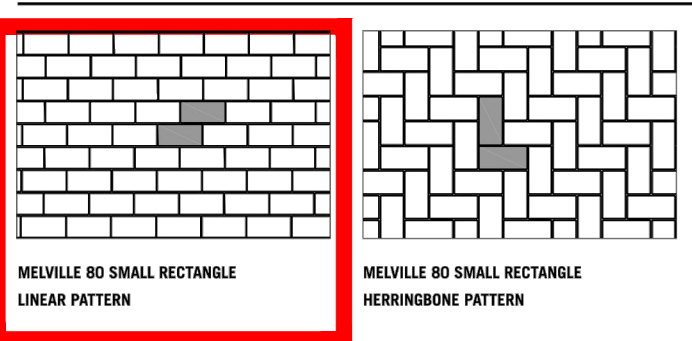

## PAVING TYPE 2 - SMALL PLANK (20 x 40cm)

N.T.S.



## Melville® Classic Pavers

- Pedestrian** - Designed to withstand pedestrian traffic
- Vehicular** - Designed to withstand car traffic

### Melville® Classic Pavers

	Dimensions (mm)	Dimensions (in)
Weight/unit	2.8 kg	6 lbs
Unit/area	50.50 units/m²	4.57 units/ft²
Area/layer	1.10 m²	11.82 ft²
Area/cube	11.00 m³	118.20 ft³
Length/layer (1)	5.50 lin. m	18.05 lin. ft
Length/cube (1)	55.00 lin. m	180.50 lin. ft
Weight/cube	1549 kg	3420 lbs

(1) Soldier course

### Colours

Code	Colours
<b>PRESTIGE COLOURS</b>	
10550876	Rockland Black
10550875	Range Margaux Beige*
<b>STANDARD COLOURS</b>	
10550875	Range Margaux Beige*
10550876	Range Shaded Grey
10550877	Range Savannah Beige
10550878	Range Norvick Grey*

Can be double stacked  
Sold in full cubes only  
Production location - Bolton  
\* Products available while supplies last

### Laying Patterns

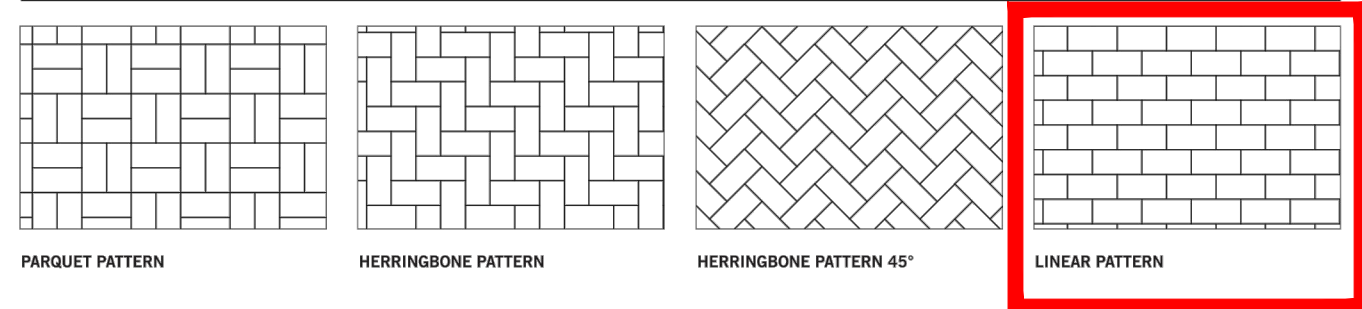

## PAVING TYPE 3 - ENTRANCE PAVING (10 x 20cm)

N.T.S.



## Mega-Melville® 60 Slabs

- Pedestrian** - Designed to withstand pedestrian traffic

### Mega-Melville® 60 Slabs

	Dimensions (mm)	Dimensions (in)
Weight/unit	73 kg	161 lb
Unit/area	6.64 m²	7.14 ft²
Area/layer	1.68 m²	18.05 ft²
Area/cube	1.68 m³	18.05 ft³
Qty/cube	22 units	22 units
Weight/cube	1474 kg	3250 lbs

### Colours

Code	Colours
<b>PRESTIGE COLOURS</b>	
10550876	Rockland Black
10550875	Range Margaux Beige*
<b>STANDARD COLOURS</b>	
10550875	Range Margaux Beige*
10550876	Range Shaded Grey
10550877	Range Savannah Beige
10550878	Range Norvick Grey*

Can be double stacked

### Laying Patterns

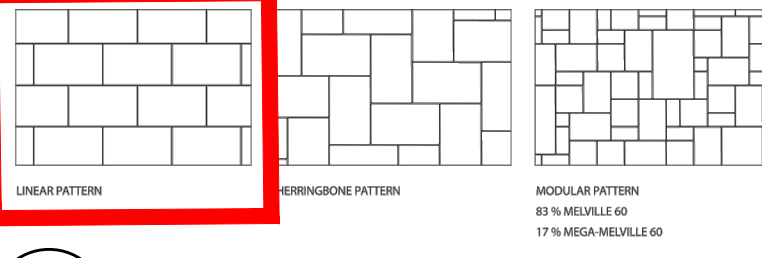

## PAVING TYPE 4 - PATIO SLABS AND STEPPING STONES

N.T.S.



AMETCO MANUFACTURING CORPORATION  
4328 HAMANN PARKWAY, P.O. BOX 1210  
WILLOUGHBY, OHIO 44096  
TOLL FREE: 1-800-321-7042  
PHONE: (440) 951-4300  
FAX: (440) 951-2542  
www.ametco.com

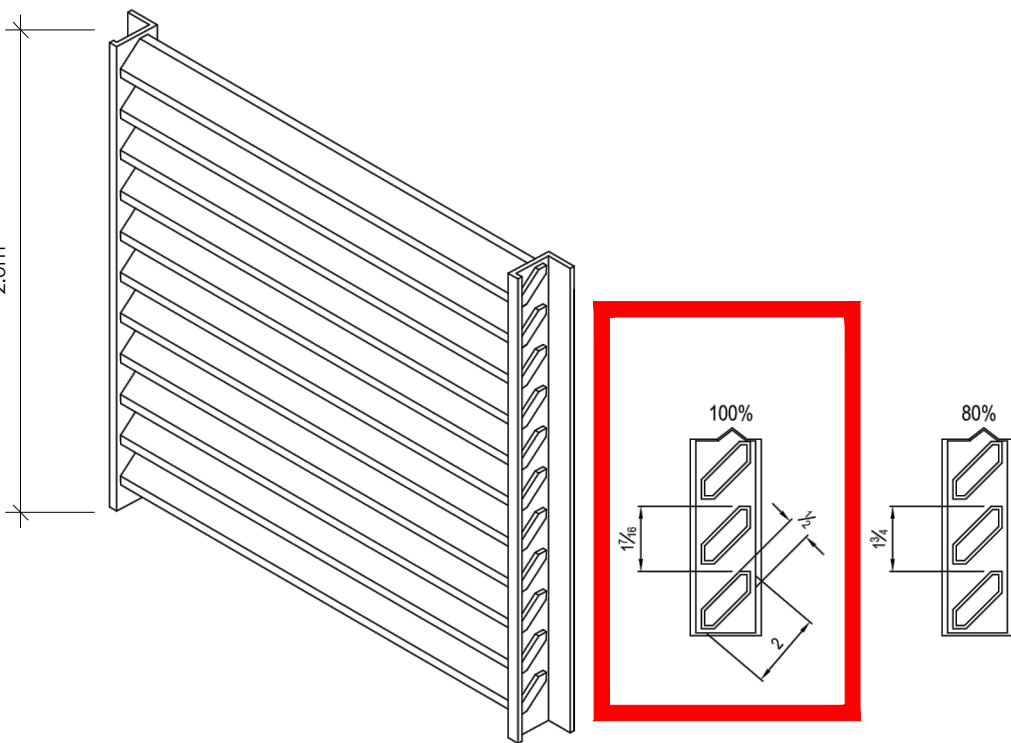

- NOTES:**
- IT IS RECOMMENDED THAT THE TITAN DESIGN BE USED HORIZONTALLY.
  - INSTALLATION TO BE COMPLETED IN ACCORDANCE WITH MANUFACTURER'S SPECIFICATIONS.
  - ALL DIMENSIONS ARE CONSIDERED TRUE AND REFLECT MANUFACTURER'S SPECIFICATIONS.
  - AMETCO'S ALUMINUM FENCING SYSTEM IS 100% MANUFACTURED IN THE UNITED STATES.
  - DO NOT SCALE DRAWINGS.
  - CONTRACTORS NOTE FOR PRODUCT AND COMPANY INFORMATION VISIT [www.CADetails.com/info](http://www.CADetails.com/info)
  - REFERENCE NUMBER 046-18

### ALUMINUM FENCE SYSTEMS

TITAN DESIGN FIXED LOUVER ALUMINUM FENCE SYSTEM

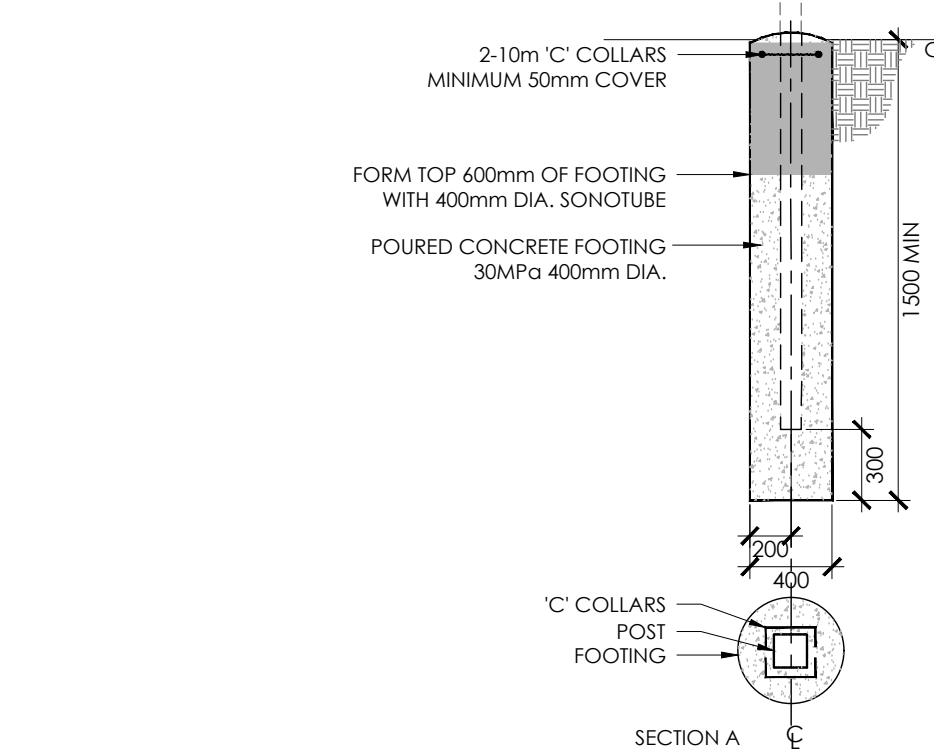

## ENTRY FEATURE

N.T.S.

## 2.0m HEIGHT WASTE SCREEN

N.T.S.

Contractor shall check all dimensions on the work and report any discrepancy to the Landscape Architect before proceeding. All drawings and specifications are the property of the Landscape Architect and must be returned at the completion of the work. This drawing is not to be used for construction until signed by the Landscape Architect.

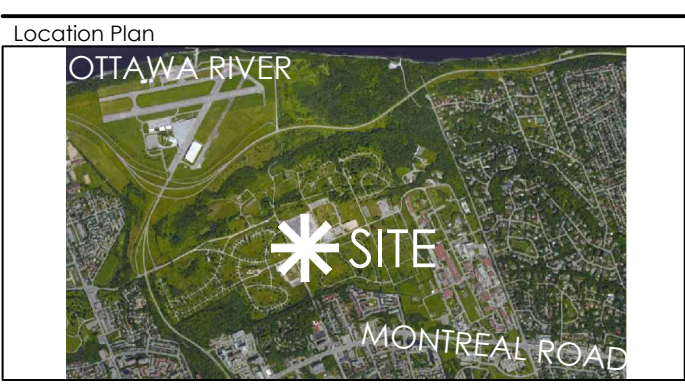

No.	Description	Date
1	Issued for 1st Submission Client Review	22.04.20
2	Issued for Coordination	05.05.20
3	Issued for 1st Site Plan Control Application	05.26.20
4	Issued for 2nd Site Plan Control Application	30.09.20

No.	Description	Date
1	Issued for 1st Submission Client Review	22.04.20
2	Issued for Coordination	05.05.20
3	Issued for 1st Site Plan Control Application	05.26.20
4	Issued for 2nd Site Plan Control Application	30.09.20

City Approval Stamp

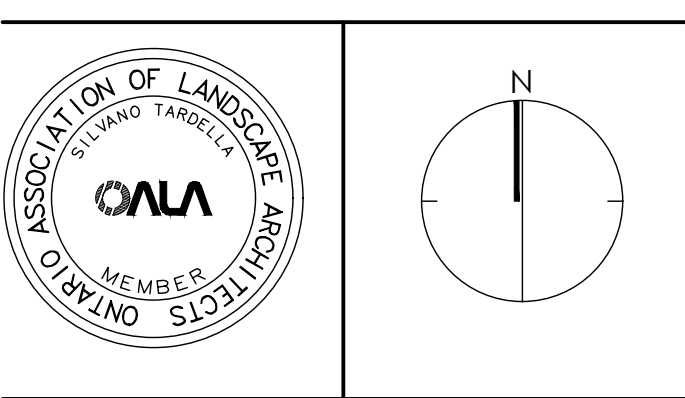

**NAK**  
design strategies  
1285 WELLINGTON STREET WEST, OTTAWA, ON K1Y 3A8 CANADA  
T 613.237.2345 F 613.237.6423 [NAKDESIGNSTRATEGIES.COM](http://NAKDESIGNSTRATEGIES.COM)

Project

## WATERIDGE VILLAGE

Title	Details
	BLOCK 22
Date	Sept 2020
Scale	1:300
Drawn	TY
Checked	CM
Job No.	20-076