



**Site Plan Control Application Summary**  
**Revision - Standard (Staff approval, no public consultation)**

---

<b>File Number:</b> D07-12-20-0101	<b>Date:</b> August 28, 2020
<b>Applicant:</b> MB Ford Construction Ltd.	<b>Comments due date:</b> September 11, 2020
<b>Email:</b> Chris@MBFORD.ca	<b>Planner:</b> Steve Belan
<b>Phone:</b> 613-742-8338	<b>Ward:</b> Ward 1 Orléans
<b>Owner:</b> Dilawri Holding Inc.	<b>Councillor:</b> Matthew Luloff

---

**Site Location**

1479 Youville Drive

**Applicant's Proposal**

A Site Plan Control application to construct upgrade site services by replacing and adding catch basins and repaving site.

**Proposal Details**

The site is located on the south side of Youville Drive approximately 130 metres west of Jeanne d'Arc Boulevard S.

The property is an automotive retail facility and outdoor storage lot. The property is surrounded by other automotive uses to the east and west. To the south is a vacant grocery store. On the north side of Youville Drive is the City's Bob MacQuarrie Recreation Complex.

The application is being made to approve proposed services and site drainage. There will be no changes to the existing buildings.

**Related Planning Applications**

N/A

**Roadway Modifications**

N/A

**How to Provide Comments**

For additional information or to provide your comments go through [Ottawa.ca/devapps](http://Ottawa.ca/devapps) or contact:\*

Steve Belan  
Planner  
Development Review, East

110 Laurier Avenue West, 4<sup>th</sup> floor  
Ottawa, ON K1P 1J1  
613-580-2424, ext. 27591  
Fax No.: 613-560-6006  
Steve.Belan@ottawa.ca

\*Please provide comments by **September 11, 2020**

## Location Map / Carte de l'emplacement

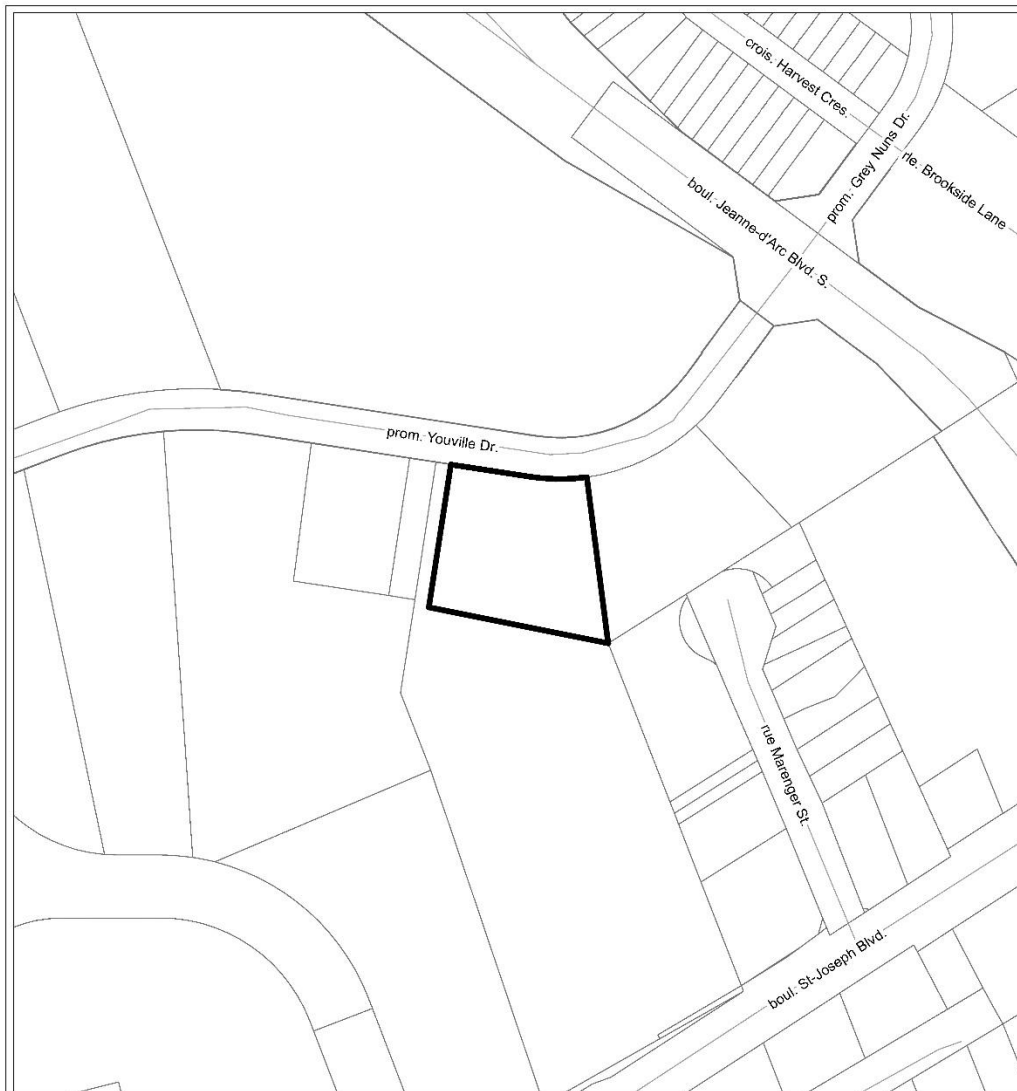

		LOCATION MAP / PLAN DE LOCALISATION SITE PLAN / PLAN D'EMPLACEMENT
D07-12-20-0101	20-0739-L	
I:\CO\2020\Site\Youville_1479		
<small>©Parcel data is owned by Teranet Enterprises Inc. and its suppliers. All rights reserved. May not be produced without permission. THIS IS NOT A PLAN OF SURVEY.</small>		
<small>©Les données de parcelles appartiennent à Teranet Enterprises Inc. et à ses fournisseurs. Tous droits réservés. Ne peut être reproduit sans autorisation. CECI N'EST PAS UN PLAN D'ARPENTAGE.</small>		
REVISION / RÉVISION - 2020 / 08 / 26		