

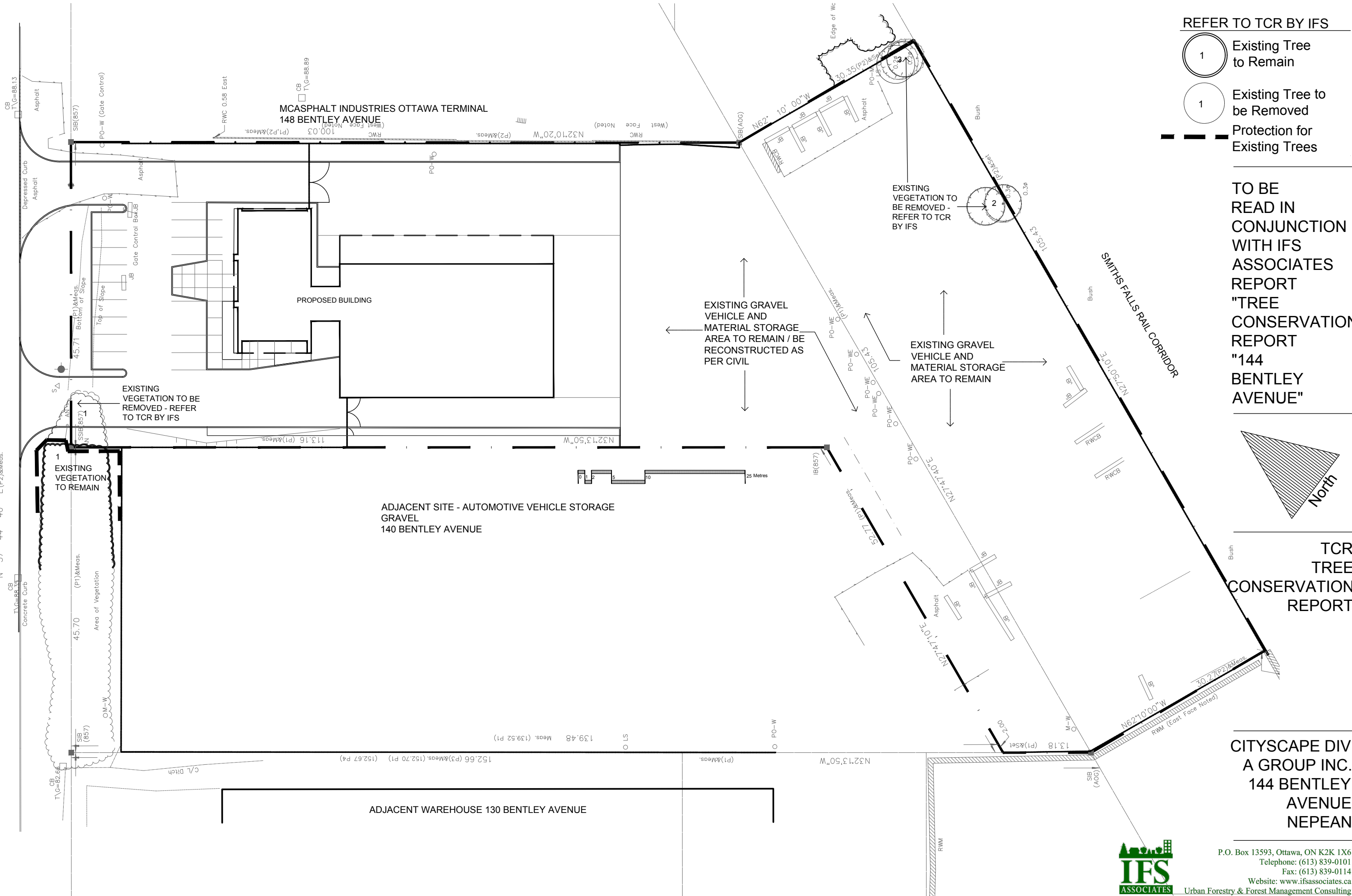

BENTLEY AVENUE

N 57° 44' 40" E (P2)&Meas.

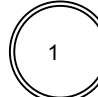
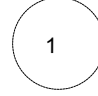

REFER TO TCR BY IFS

-  Existing Tree to Remain
-  Existing Tree to be Removed
-  Protection for Existing Trees

TO BE READ IN CONJUNCTION WITH IFS ASSOCIATES REPORT "TREE CONSERVATION REPORT "144 BENTLEY AVENUE"

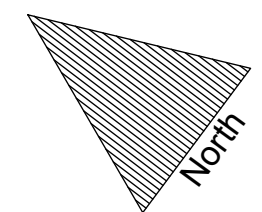

TCR TREE CONSERVATION REPORT

CITYSCAPE DIV
A GROUP INC.
144 BENTLEY AVENUE
NEPEAN



P.O. Box 13593, Ottawa, ON K2K 1X6
Telephone: (613) 839-0101
Fax: (613) 839-0114
Website: www.ifsassociates.ca
Urban Forestry & Forest Management Consulting