

Metric
DISTANCES SHOWN ON THIS PLAN ARE IN METRES AND
CAN BE CONVERTED TO FEET BY DIVIDING BY 0.3048

JOB BENCHMARK
Top of Spindle on
Fire Hydrant
Elev=63.84

SURVEYOR'S REAL PROPERTY REPORT
PART 1 Plan of
LOT 40 And
PART OF LOT 42
REGISTERED PLAN 57
CITY OF OTTAWA
Surveyed by Annis, O'Sullivan, Vollebakk Ltd.

Scale 1 : 200

8.0 6.0 4.0 2.0 0 4 8 Metres

Surveyor's Certificate

I CERTIFY THAT:

1. This survey and plan are correct and in accordance with the Surveys Act, the Surveyors Act and the Land Titles Act and the regulations made under them.
2. The survey was completed on the 14th day of August, 2018.

Aug 15/2018
Date

Andre Roy
Ontario Land Surveyor

PART 2

THIS PLAN MUST BE READ IN CONJUNCTION WITH
SURVEY REPORT DATED: AUGUST 15, 2018

ANNIS, O'SULLIVAN, VOLLEBEKK LTD. grants to
Botros D. Botros ("The Client"), their solicitors,
mortgagees, and other related parties, permission to use original, signed, sealed
copies of the Surveyor's Real Property Report in transactions involving The Client.

Notes & Legend

Denotes	Survey Monument Planted
□	Survey Monument Found
SIB	Standard Iron Bar
SSIB	Short Standard Iron Bar
IB	Iron Bar
IBØ	Round Iron bar
CP	Concrete Pin
CC	Cut Cross
*	0.3 metre long Survey Monument
(WIT)	Witness
(AOG)	Annis, O'Sullivan, Vollebakk Ltd.
Meas.	Measured
(P1)	Registered Plan 57
(P2)	(AOG) Plan, September 23, 1988
(P3)	(857) Plan, July 4, 2000
(P4)	(725) Plan, January 29, 1976
(P5)	(1319) Plan, March 18, 1987
(D1)	Inst. CR705537
(D2)	Inst. CR705539
○ MH-ST	Maintenance Hole (Storm Sewer)
○ MH-S	Maintenance Hole (Sanitary)
⊕ VC	Valve Chamber (Watermain)
□ CB	Catch Basin
○ FH	Fire Hydrant
Inv.	Invert
T/G	Top of Grate
C/L	Centreline
⊕ B	Gas Meter
⊕ S	Bollard
△ S	Sign
CLF	Chain Link Fence
BF	Board Fence
+65.00'	Top of Retaining Wall Elevation
+65.00	Location of Elevations
○ UP	Utility Pole
○ AN	Anchor
— OHW —	Overhead Wires

Bearings are grid, derived from GPS observations and are referred to the
Central Meridian of MTM Zone 9 (76°30' West Longitude)NAD-83 (original).

For bearing comparisons, a rotation of 0°04'40" clockwise was applied to
bearings on plan P2.

ELEVATION NOTES

1. Elevations shown are geodetic and are referred to the CGVD28 geodetic datum.
2. It is the responsibility of the user of this information to verify that the job benchmark has not been altered or disturbed and that it's relative elevation and description agrees with the information shown on this drawing.

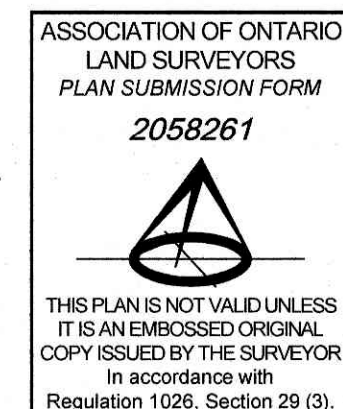

UTILITY NOTES

1. This drawing cannot be accepted as acknowledging all of the utilities and it will be the responsibility of the user to contact the respective utility authorities for confirmation.
2. Only visible surface utilities were located.
3. A field location of underground plant by the pertinent utility authority is mandatory before any work involving breaking ground, probing, excavating etc.

© Annis, O'Sullivan, Vollebakk Ltd. 2018. "THIS PLAN IS PROTECTED BY COPYRIGHT"
ANNIS, O'SULLIVAN, VOLLEBEKK LTD.
14 Concourse Gate, Suite 500
Nepean, Ont. K2E 7S6
Phone: (613) 727-0850 / Fax: (613) 727-1079
Email: Nepean@aoivld.com
Job No. 18987-18 Botros Lts 40 42 RP 57 T F