

PLAN

SCALE = 1:250

LEGEND

- EXISTING ELEVATION
- PROPOSED/EXISTING ELEVATIONS
- PROPOSED ELEVATION
- PROPOSED CENTRELINE OF DITCH ELEVATION
- DRAINAGE SLOPE
- DIRECTION OF FLOW
- PROPERTY LINE
- TOP OF SLOPE
- CENTRELINE OF ROAD
- SILT FENCE
- TEMPORARY BENCHMARK



KEY PLAN
NOT TO SCALE

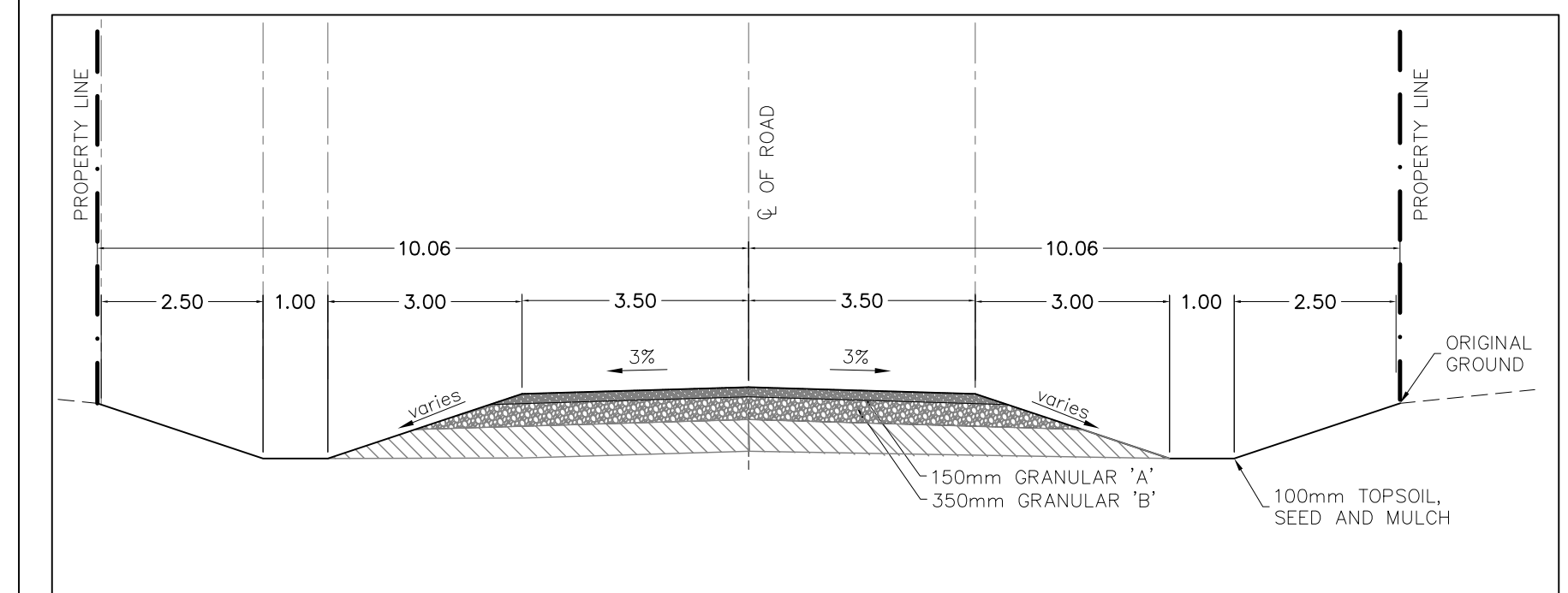

ROAD SECTION (TYPICAL)

NOT TO SCALE

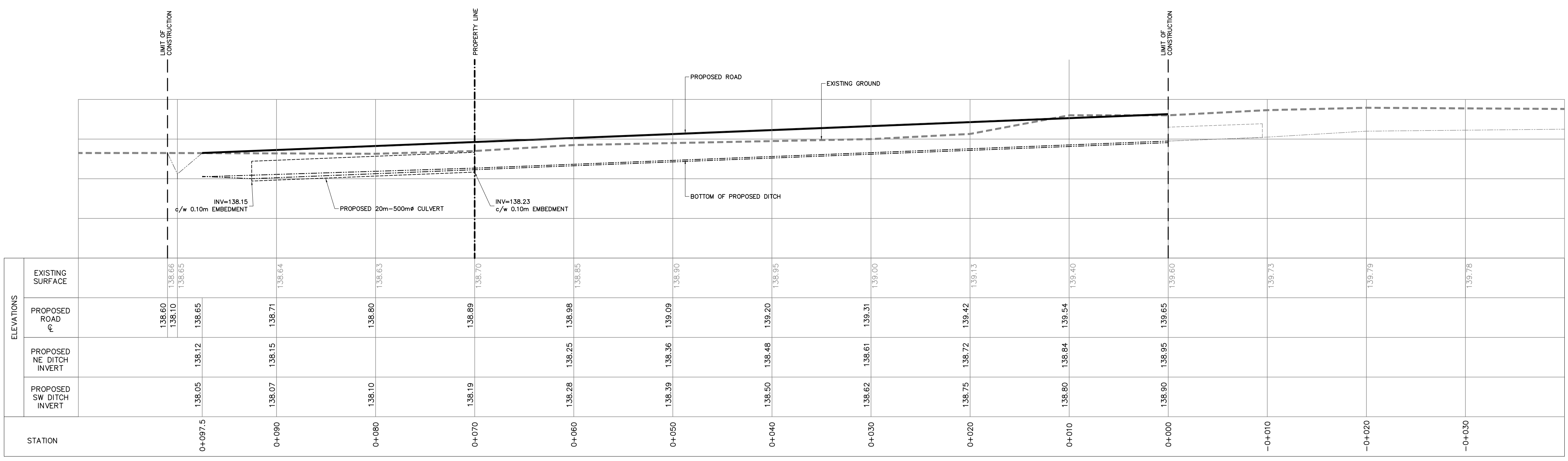

PROFILE

HORIZ. SCALE = 1:250 VERT. SCALE = 1:250

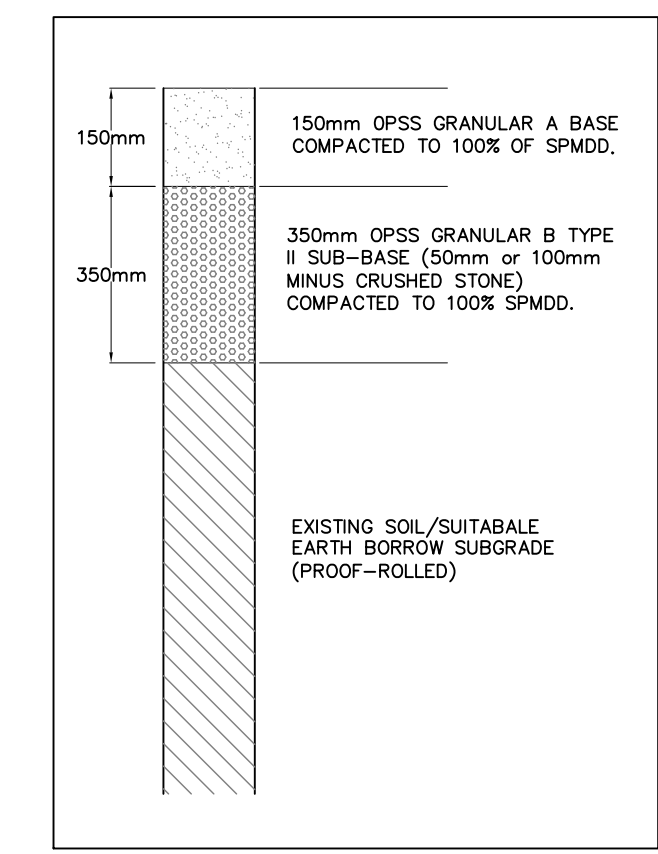

ROAD STRUCTURE

NOT TO SCALE

- NOTES:
- ALL DIMENSIONS ARE IN METRES, UNLESS OTHERWISE SPECIFIED; ALL ELEVATIONS ARE IN METRES AND ARE GEODETIC.
 - THIS IS NOT A LEGAL SURVEY.
 - TBM = NAIL IN EXISTING TREE ON PROPERTY (340 LOWE ROAD), ELEVATION = 140.89m.
 - CLIENT IS RESPONSIBLE FOR ACQUIRING ALL NECESSARY PERMITS.
 - CONTRACTOR TO VERIFY THAT APPROPRIATE PERMITS HAVE BEEN ACQUIRED PRIOR TO ANY CONSTRUCTION.
 - CONTRACTOR IS RESPONSIBLE FOR LOCATION AND PROTECTION OF UTILITIES.
 - ALL DIMENSIONS TO BE VERIFIED ON SITE BY CONTRACTOR PRIOR TO CONSTRUCTION.
 - THIS DRAWING IS NOT FOR CONSTRUCTION UNTIL ALL APPROVALS HAVE BEEN GRANTED.
 - HYDRO SERVICE TO BE INSTALLED ACCORDING TO THE SPECIFICATIONS OF SERVICE PROVIDER AND THE MECHANICAL ENGINEER.
 - ALL MATERIALS AND CONSTRUCTION TO BE IN ACCORDANCE WITH CITY OF OTTAWA STANDARDS AND ONTARIO PROVINCIAL STANDARDS AND SPECIFICATIONS; SEWER AND WATERMAIN MATERIAL TYPES; DISINFECTION, PROVIDE MINIMUM 2.4 METRES OF COVER FOR WATER SERVICES, CATHODIC PROTECTION, CITY OF OTTAWA INSULATION SPECIFICATIONS FOR WATERMAIN, PIPE BEDDING, REINSTATEMENT OF DISTURBED AREAS AND LEAKAGE TESTING.
 - ANY CHANGES MADE TO THIS PLAN MUST BE VERIFIED AND APPROVED BY KOLLAARD ASSOCIATES, INC.
 - THIS DRAWING IS PART OF KOLLAARD ASSOCIATES DESIGN REPORT NO. 200143

No.	REVISION	DATE	BY
0	ISSUED FOR SUBMISSION	JULY 30/2020	ML
#	REVISION ITEM / DESCRIPTION	REV. DATE	INT.

CONSULTANTS

Kollaard Associates
Engineers

BOX 189
210 PRESCOTT STREET
KEMPVILLE, ONTARIO
K0G 1A0
FACSIMILE (613) 258-0475

(613) 860-0923

DESIGN	SD
DRAWN	ML
CHECKED	--
APPROVED	SD

STAMP

LICENSED PROFESSIONAL ENGINEER
JULY 30, 2020
S.E. deWit
100079612
PROVINCE OF ONTARIO

CLIENT NAME	AARON WOLF
PROJECT NAME	LOWE ROAD EXTENSION
PROJECT LOCATION	LOWE ROAD WEST CARLETON (HUNTLEY), CITY OF OTTAWA, ONTARIO
DRAWING	PLAN AND PROFILE

PROJECT No.	200143
DATE	JUNE 1, 2020
SCALE	AS NOTED
DRAWING No.	200143-PP