

1 TREE CONSERVATION REPORT & LANDSCAPE PLAN  
SCALE: 1:75

GENERAL NOTES:

1. It is the responsibility of the appropriate contractor or official to report any errors, omissions or discrepancies on this plan with actual site conditions to the Landscape Architect before proceeding with construction.
2. The contractor is to notify all utility companies and authorities prior to any excavation and ascertain locations of underground services.
3. The contractor is to reinstate all areas and items damaged as a result of construction activity.
4. The contractor is to comply with all pertinent codes and by-laws.
5. The contractor is to maintain a positive surface run-off throughout the entire construction period.
6. The Landscape Architect is not responsible for subsurface conditions.
7. The contractor is to identify all existing trees to remain on site with the Landscape Architect prior to construction.
8. The contractor is to stake the proposed location of all plant material in conjunction with the Landscape Architect prior to excavation.
9. Minimum distances for selected deciduous trees are as follows:
  - Building Foundations 7.5m
  - Sidewalks 1.5m
  - Public Streets 2.5m
  - Underground Infrastructure 2.0m
10. All trees within 1m of underground utility trenches are to be excavated by hand.
11. Remove all protective wrapping from tree trunks after installation.
12. Staking of trees shall only be performed if necessary.
13. Ensure that mulch is pulled back a min. distance of 75mm from base of tree trunk.

PROPOSED PLANT LIST

KEY	QTY	BOTANICAL NAME	COMMON NAME	SIZE	CONDITION	REMARKS
TREES						
SB	1	Amelanchier canadensis	Serviceberry	60mm cal.	B&B	
PERENNIALS						
HR	12	Hemerocallis 'Happy Returns'	Happy Returns Daylily	100mm pot	Potted	300 mm o.c.
MF	8	Hemerocallis 'Moses Fire'	Moses Fire Daylily	100mm pot	Potted	300 mm o.c.
RG	22	Phlox arundinacea 'Strawberries And Cream'	Strawberries & Cream Ribbon Grass	250mm pot	Potted	600 mm o.c.

EXISTING TREE LIST

KEY	QTY	BOTANICAL NAME	COMMON NAME	SIZE	CONDITION	REMARKS
AN	2	Acer negundo	Manitoba Maple	200-1000mm DBH	Fair-Good	See plan
RT	5	Rhus typhina	Staghorn Sumac	150-200mm DBH	Good	See plan
UA	2	Ulmus americana	American Elm	300mm DBH	Poor	To Remain

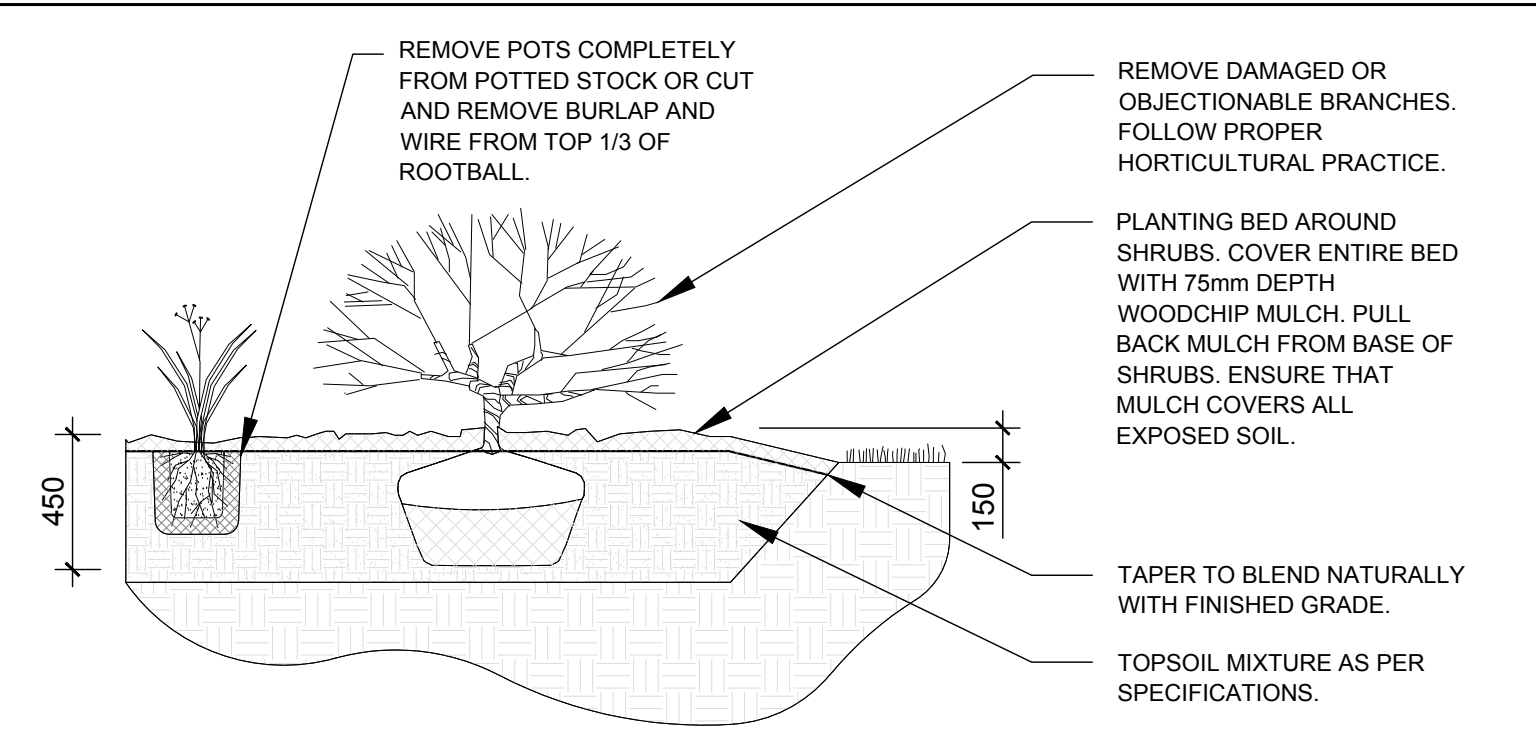

2 PERENNIAL PLANTING  
SCALE: NTS

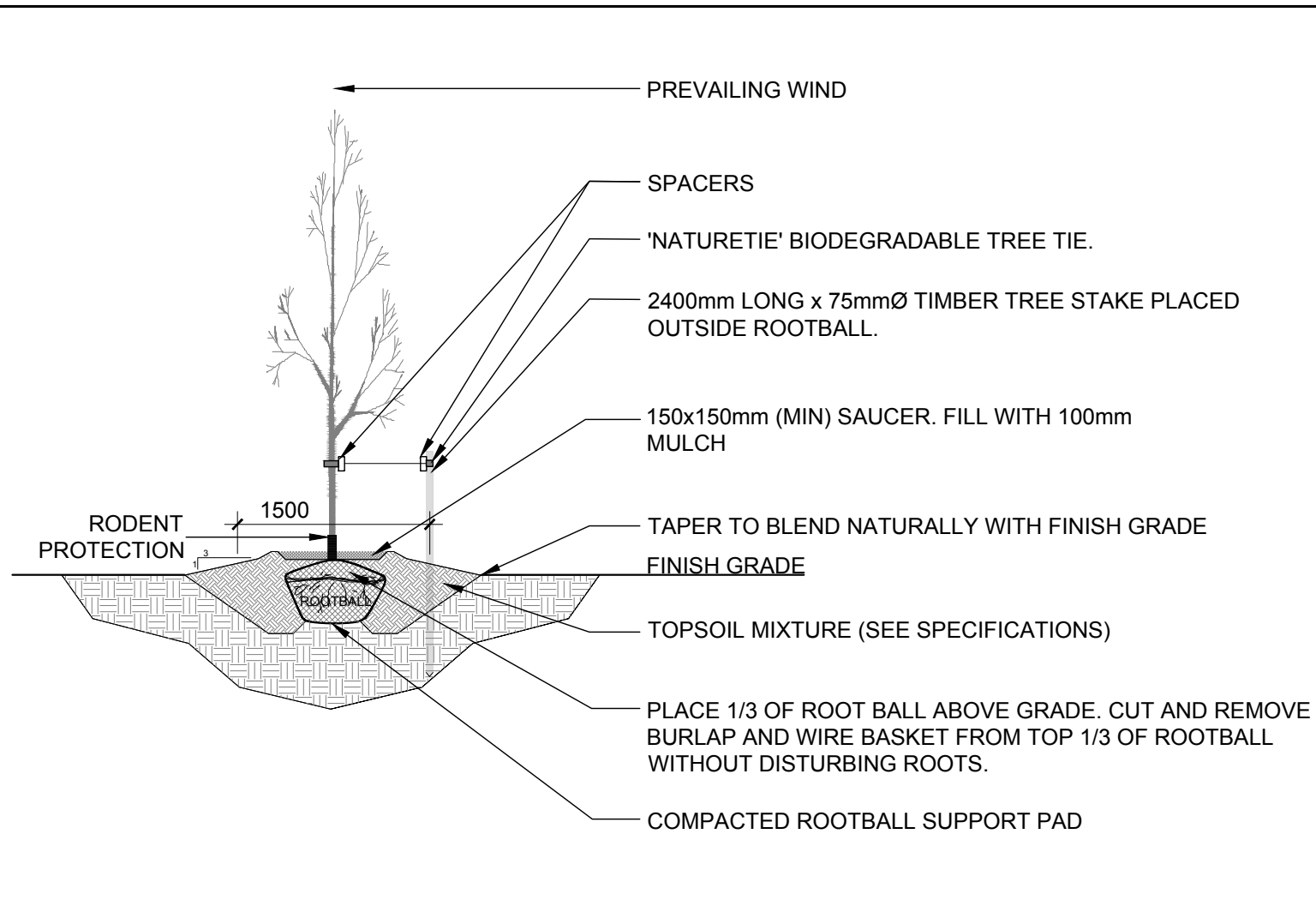

3 DECIDUOUS TREE PLANTING  
SCALE: NTS

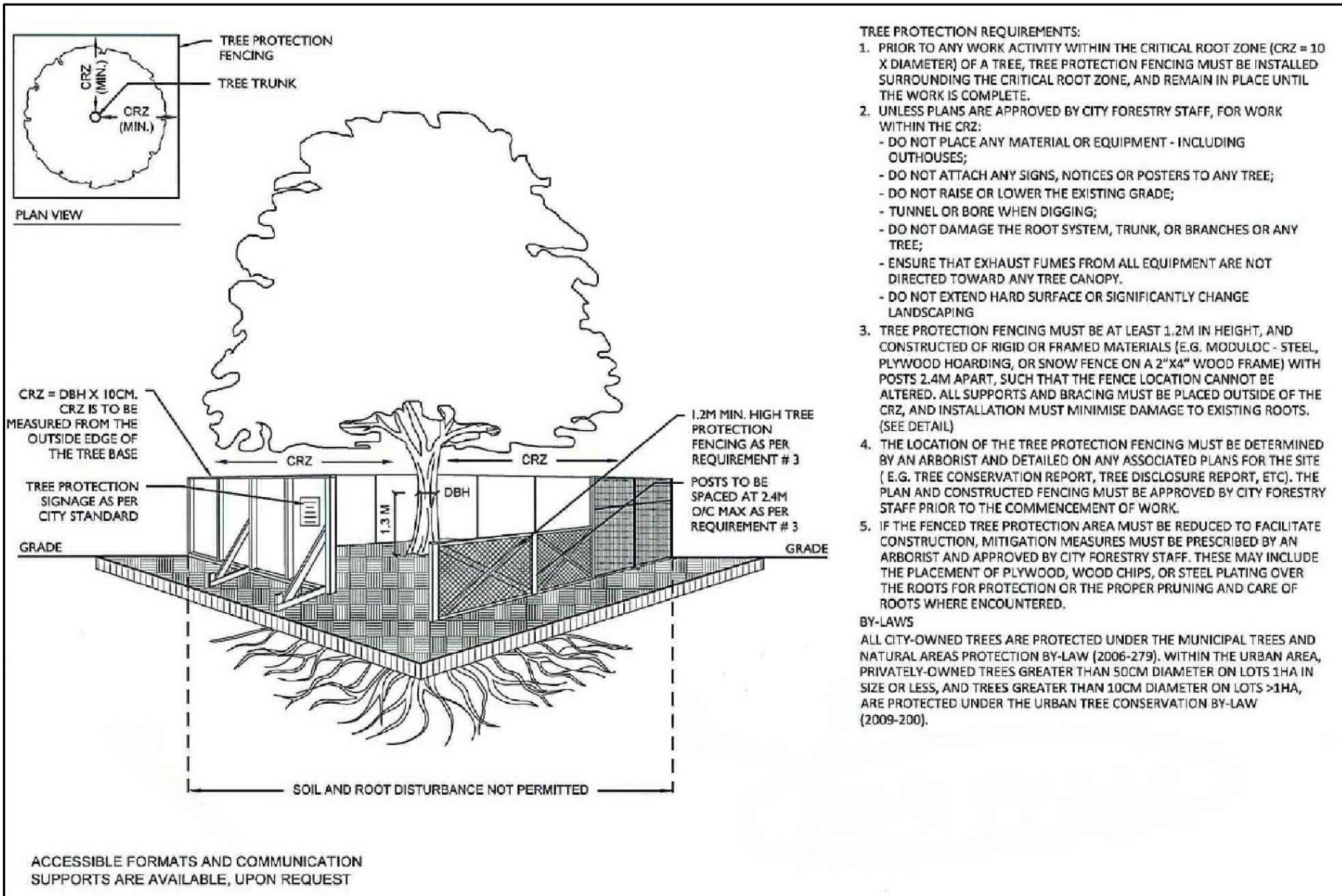

4 TREE PROTECTION FENCE  
SCALE: NTS

CLIENT: YAR CAPITAL PROPERTIES

CONSULTANTS

ARCHITECTS:



SURVEYORS:



ANNIS, O'SULLIVAN, VOLLEBEKK LTD.  
14 Concourse Gate, Suite 500  
Napier, Ont. K2E 7S6  
Phone: (613) 727-0850 / Fax: (613) 727-1079  
Email: info@annisov.com

CIVIL ENGINEERS:

D. B. GRAY ENGINEERING INC.

Stormwater Management - Grading & Drainage - Storm & Sanitary Sewers - Watermain

700 Long Point Circle Tel: 613-425-8044  
Ottawa, Ontario K1T 4E9 dgray@rogers.com

LEGEND

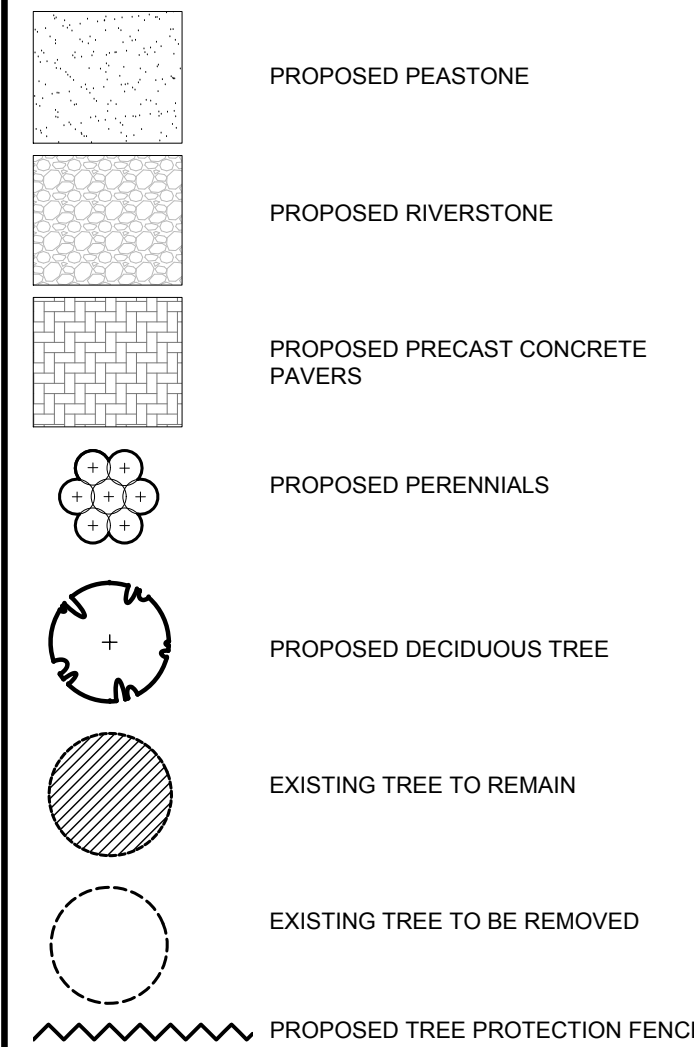

1	ISSUED FOR SITE PLAN CONTROL	06/26/2020	ML	JL
No.	Issue	Date	ML	DR

JAMES B. LENNOX & ASSOCIATES INC.  
LANDSCAPE ARCHITECTS  
3332 CARLING AVE. OTTAWA, ONTARIO K2H 5A8  
Tel. (613) 722-5168 Fax. (613) 722-5162

PROJECT

FOUR STOREY TWELVE DWELLING UNIT +1  
COMMERCIAL BUILDING

52 GARLAND STREET, OTTAWA ON

DRAWING

TREE CONSERVATION REPORT &  
LANDSCAPE PLAN

STAMP

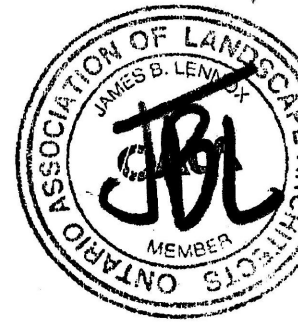

PROJECT NORTH

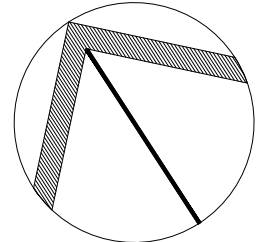

SCALE

AS SHOWN

START DATE

MAY 2020

PROJECT NO.

DRAWING NO.

L.1

PLOT SIZE ARCH-D