

Jeff McEwen

JEFF MCEWEN P.ENG.
MANAGER, DEVELOPMENT REVIEW EAST BRANCH
PLANNING, INFRASTRUCTURE & ECONOMIC
DEVELOPMENT DEPARTMENT, CITY OF OTTAWA

APPROVED
 By Jeff McEwen at 3:00 pm, Mar 05, 2020

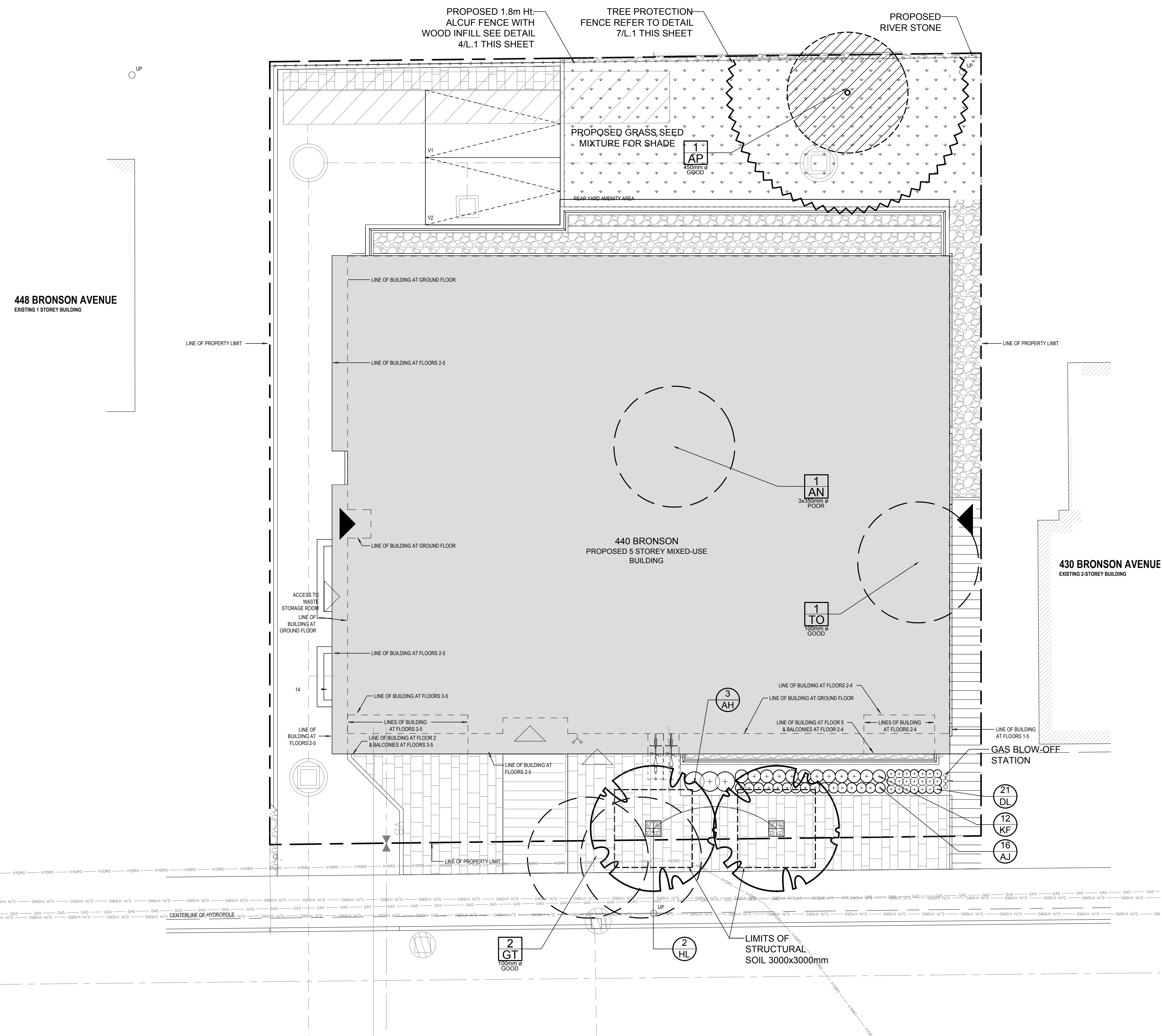

1
 TREE CONSERVATION REPORT & LANDSCAPE PLAN
 SCALE 1:100

- GENERAL NOTES:**
- It is the responsibility of the appropriate contractor or official to report any errors, omissions or discrepancies on this plan with actual site conditions to the Landscape Architect before proceeding with construction.
 - The contractor is to notify all utility companies and authorities prior to any excavation and ascertain locations of underground services.
 - The contractor is to reinstate all areas and items damaged as a result of construction activity.
 - The contractor is to comply with all pertinent codes and by-laws.
 - The contractor is to maintain a positive surface run-off throughout the entire construction period.
 - The Landscape Architect is not responsible for subsurface conditions.
 - The contractor is to identify all existing trees to remain on site with the Landscape Architect prior to construction.
 - The contractor is to stake the proposed location of all plant material in conjunction with the Landscape Architect prior to excavation.
 - Minimum distances for selected deciduous trees are as follows:
 - Building Foundations 7.5m
 - Sidewalks 1.5m
 - Public Streets 2.5m
 - Underground Infrastructure 2.0m
 - All trees within 1m of underground utility trenches are to be excavated by hand.
 - Remove all protective wrapping from tree trunks after installation.
 - Staking of trees shall only be performed if necessary.
 - Ensure that mulch is pulled back a min. distance of 75mm from base of tree trunk.

EXISTING TREE LIST

KEY	QTY	BOTANICAL NAME	COMMON NAME	SIZE	CONDITION	REMARKS
AN	1	Acer negundo	Manitoba Maple	3x350mm ø	POOR	See Plan
AP	1	Acer platanoides	Norway Maple	450mm ø	GOOD	See Plan
GT	2	Gleditsia triacanthos	Honey Locust	100mm ø	GOOD	See Plan
TO	1	Thuja occidentalis	White Cedar	100mm ø	GOOD	See Plan

PROPOSED PLANT LIST

KEY	QTY	BOTANICAL NAME	COMMON NAME	SIZE	CONDITION	REMARKS
HL	2	Gleditsia triacanthos 'Draves'	Street Keeper Honey Locust	70mm ø	B&B	See Plan
AH	3	Hydrangea arborescens 'Annabelle'	Annabelle Hydrangea	800mm Ht.	1 Gal Pot.	Space 1000mm O.C.
AJ	16	Sedum 'Autumn Joy'	Autumn Joy Sedum	100mm Pot.	Potted	Space 400mm O.C.
DL	21	Hemerocallis 'Stella D'Oro'	Stella D'Oro Daylily	100mm Pot.	Potted	Space 300mm O.C.
KF	12	Calamagrostis x acutiflora 'Karl Foerster'	Feather Reed Grass	250mm Pot.	Potted	Space 600mm O.C.

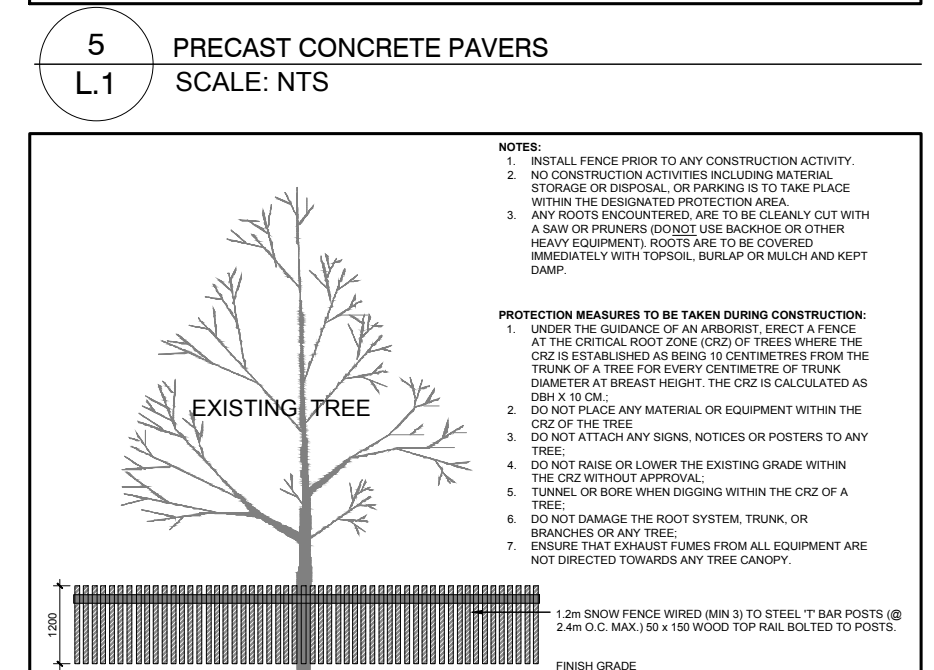
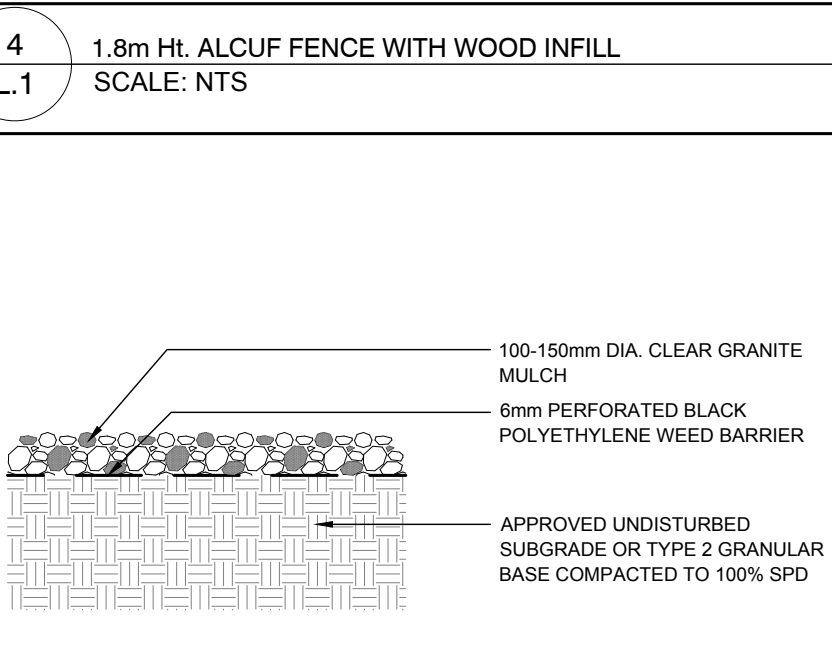
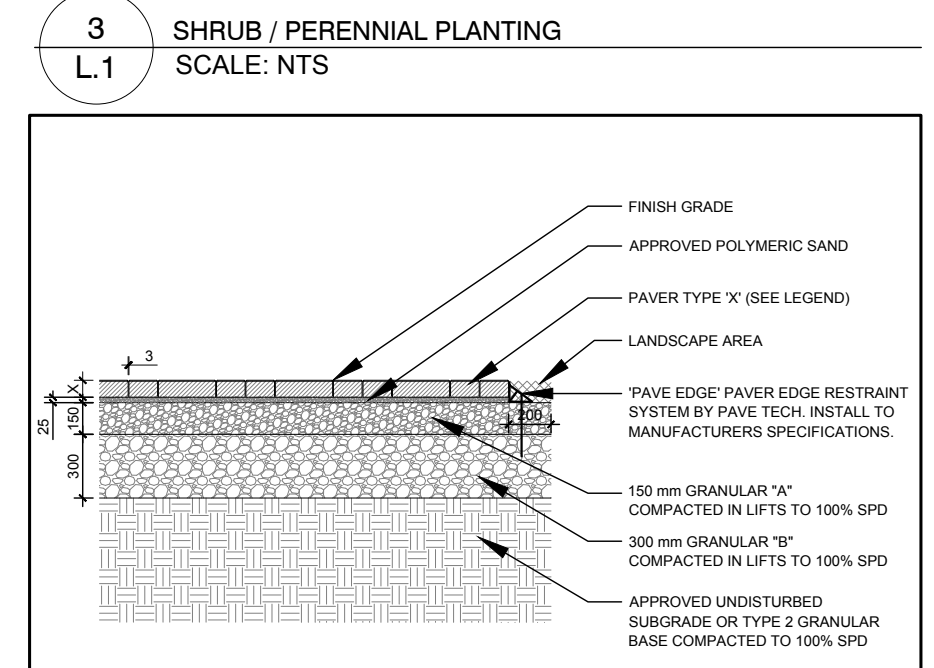
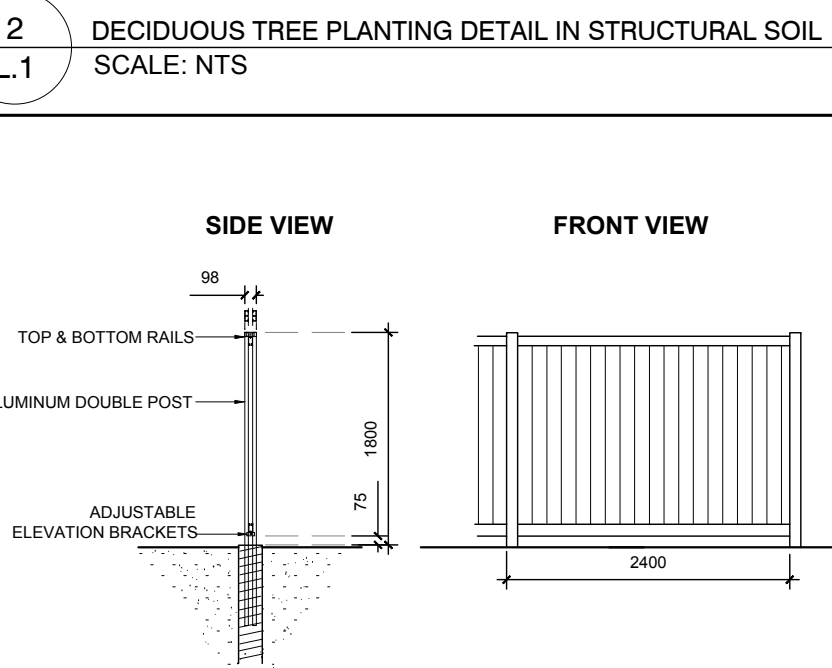
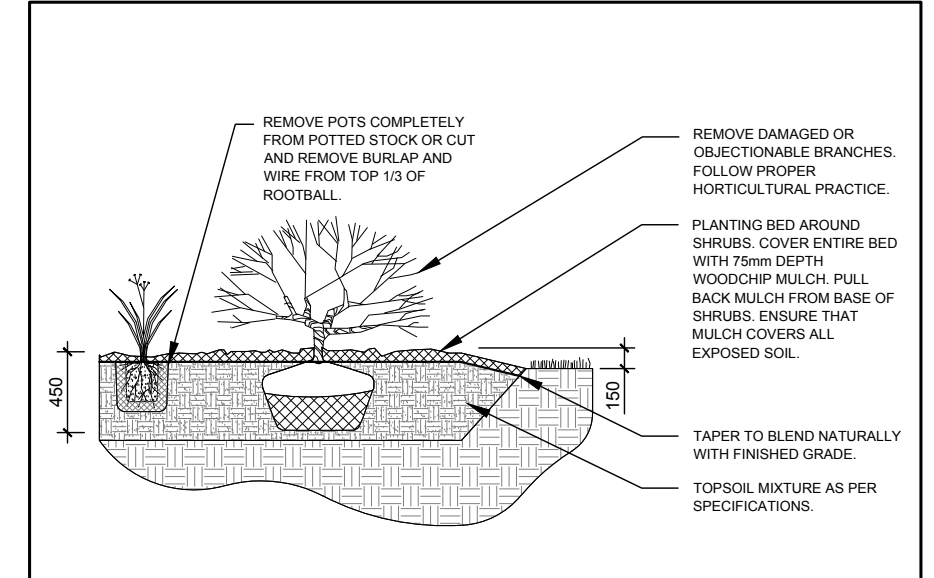
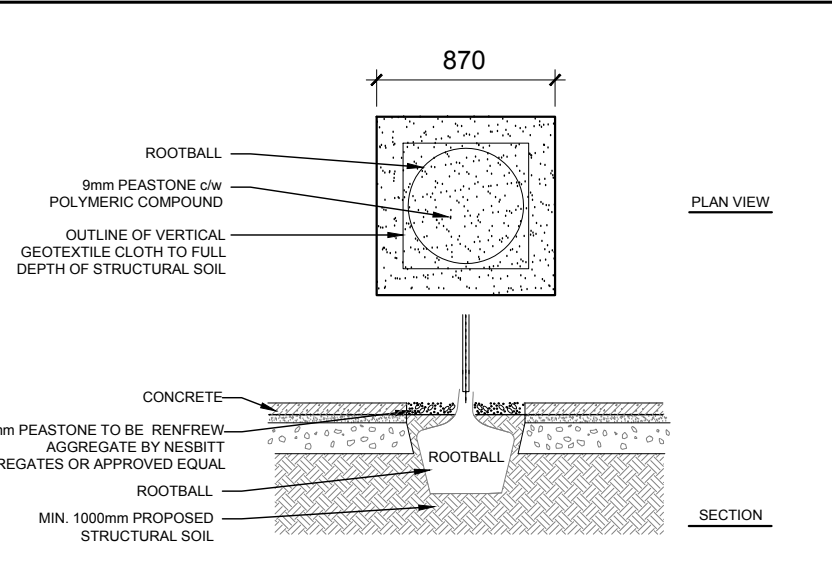

CLIENT: **TC UNITED GROUP**
 1800 INDUSTRIAL AVE, UNIT 9
 OTTAWA, ON
 Tel: (613) 680-5582

CONSULTANTS:
project1 studio
 Project Studio Incorporated
 (613) 884-3938 | info@project1studio.ca

CIVIL ENGINEERS:
DSEL LTD.
 120 IBER ROAD, SUITE 103
 OTTAWA, ON
 Tel: (613) 836-0856

- LEGEND**
- EXISTING TREE TO BE REMOVED
 - EXISTING TREE TO REMAIN
 - PROPOSED DECIDUOUS TREE- SEE DETAIL THIS SHEET
 - PROPOSED SHRUBS OR PERENNIALS- SEE DETAIL THIS SHEET
 - PROPOSED RIVER STONE MULCH (100-150mm DIA.) CLEAR GRANITE MULCH TO A 150mm DEPTH. INSTALL ON A PERFORATED 6mm BLACK POLY WEED BARRIER. INSTALL AS PER DETAIL THIS SHEET.
 - PROPOSED APPROVED GRASS SEED FOR SHADE- INSTALL ON A 150mm APPROVED SCREENED TOPSOIL BASE TO THE RATE AS SPECIFIED BY THE SUPPLIER.
 - PROPOSED PRECAST CONCRETE PAVERS- "PERIMACON MELVILLE SLIM PLANK PAVERS" UNITS A, B AND C. INSTALL ON A RANDOM PATTERN WITH A FULL BED OF APPROVED POLYMERIC SAND. INSTALL AS PER DETAIL THIS SHEET.
 - PROPOSED CONCRETE WALKWAY- SEE ARCHITECTURAL OR ENGINEERING DRAWINGS FOR DETAILS

No.	Issue	Date	MM/SS/YY	DR	CK
10	REVISED PER CITY COMMENTS	11/25/2019	ML	JL	
9	REVISED PER CITY COMMENTS	07/29/2019	ML	JL	
8	REVISED PER CITY COMMENTS	07/19/2019	ML	JL	
7	ISSUED FOR TENDER	07/15/2019	ML	JL	
6	REVISED PER NEW SITE PLAN	05/15/2019	ML	JL	
5	REVISED PER NEW SITE PLAN	04/26/2019	ML	JL	
4	REVISED PER NEW SITE PLAN	11/20/2018	ML	JL	
3	REVISED PER NEW SITE PLAN	08/22/2018	ML	JL	
2	REVISED PER CITY COMMENTS	04/06/2018	ML	JL	
1	ISSUED FOR SITE PLAN APPROVAL	10/30/2017	ML	JL	

JAMES B. LENNOX & ASSOCIATES INC.
LANDSCAPE ARCHITECTS
 3332 CARLING AVE. OTTAWA, ONTARIO K2H 5A8
 Tel: (613) 722-5168 Fax: (866) 343-3942

PROJECT
440 BRONSON
 440-444 BRONSON AVENUE, OTTAWA ON

DRAWING
TREE CONSERVATION REPORT & LANDSCAPE PLAN

SCALE
 AS SHOWN
 START DATE
 OCTOBER 2017
 PROJECT NO.
 18-MIS-1801

PROJECT NORTH

 DRAWING NO.
L.1
 PLOT SIZE ARCH-D