

PROPOSED VEGETATION					
PLANT LIST					
KEY	SCIENTIFIC NAME	COMMON NAME	NO.	SIZE	COND.
DECIDUOUS TREES					
AP	<i>Acer Palmatum</i>	Japanese Maple	2	Relocate on Site	
SR	<i>Syringa reticulata</i>	'Ivory Silk' Ivory Silk Japanese Tree Lilac	4	75mm Cal. WB	
DECIDUOUS SHRUBS					
EA	<i>Euonymus alatus</i>	Burning Bush	5	80cm Ht. Pot	
EC	<i>Euonymus alatus</i>	'Compacta' Dwarf Burning Bush	6	80cm Ht. Pot	
HP	<i>Hydrangea paniculata</i>	Pinky Winky Hydrangea	3	80cm Ht. Pot	
	'Pinky Winky'				
PG	<i>Potentilla 'Goldfinger'</i>	Goldfinger Cinquefoil	6	60cm Ht. Pot	
RA	<i>Ribes alpinum</i>	Alpine Currant	7	80cm Ht. Pot	
SS	<i>Sorbaria sorbifolia</i>	False Spirea	7	1.0m Ht. Pot	
SV	<i>Spirea x vanhouttii</i>	Bridle Wreath Spirea	4	1.0m Ht. Pot	
PERENNIALS & GRASSES					
CA	<i>Calamagrostis x acutifolia</i>	Karl Foerster Feather Reed Grass	23	15cm Pot	
	'Karl Foerster'				
FV	<i>Filipendula vulgaris</i>	Double Dropwort 'Flora Plena'	16	15cm Pot	
	'Flora Plena'				
HS	<i>Hemerocallis 'Stella D'or'</i>	Stella D'or Daylily	14	15cm Pot	
VM	<i>Vinca minor</i>	Periwinkle	46	10cm Pot	

- LANDSCAPE NOTES**
- Plant material shall be No.1 Grade and shall comply with the Metric Guide Specifications for Nursery Stock (latest version) published by the Canadian Nursery Trades Association.
  - Plant substitutions shall not be permitted unless approved by the Landscape Architect.
  - Contractor shall warranty all plant materials for a period of one (1) full year from the date of final acceptance.
  - Obtain approval of planting locations prior to digging.
  - All planting beds shall be mulched with 75mm shredded wood mulch.
  - Topsoil for planting shall be friable sandy loam: add 30% peatmoss by volume and bonemeal at a rate of 3 kg/cubic metre to topsoil.
  - Sod areas to receive 100mm topsoil. Sod shall be No.1 Grade conforming to the Canadian Sod Growers Specification.
  - Reinstate all areas damaged or disturbed beyond the limit of work.

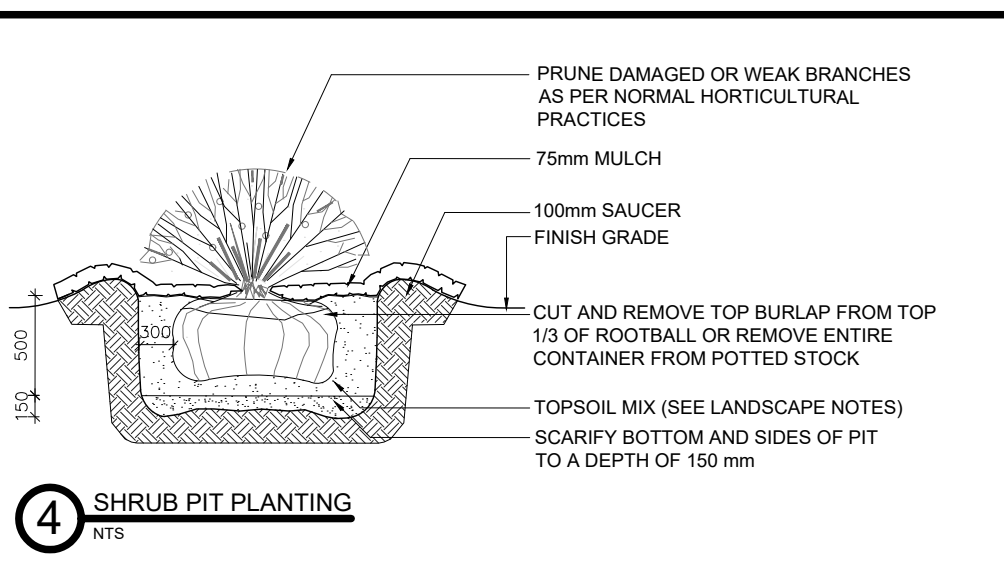
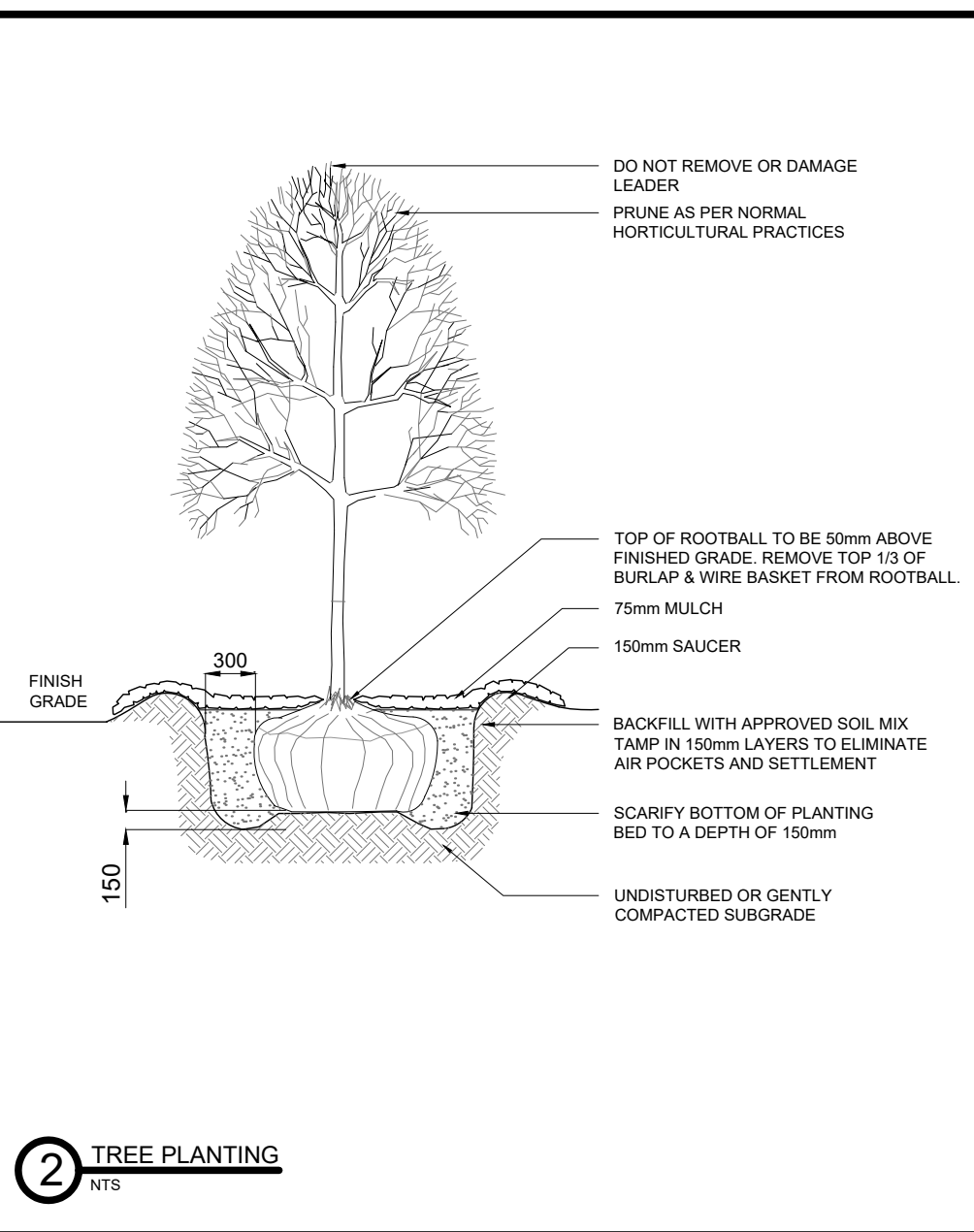
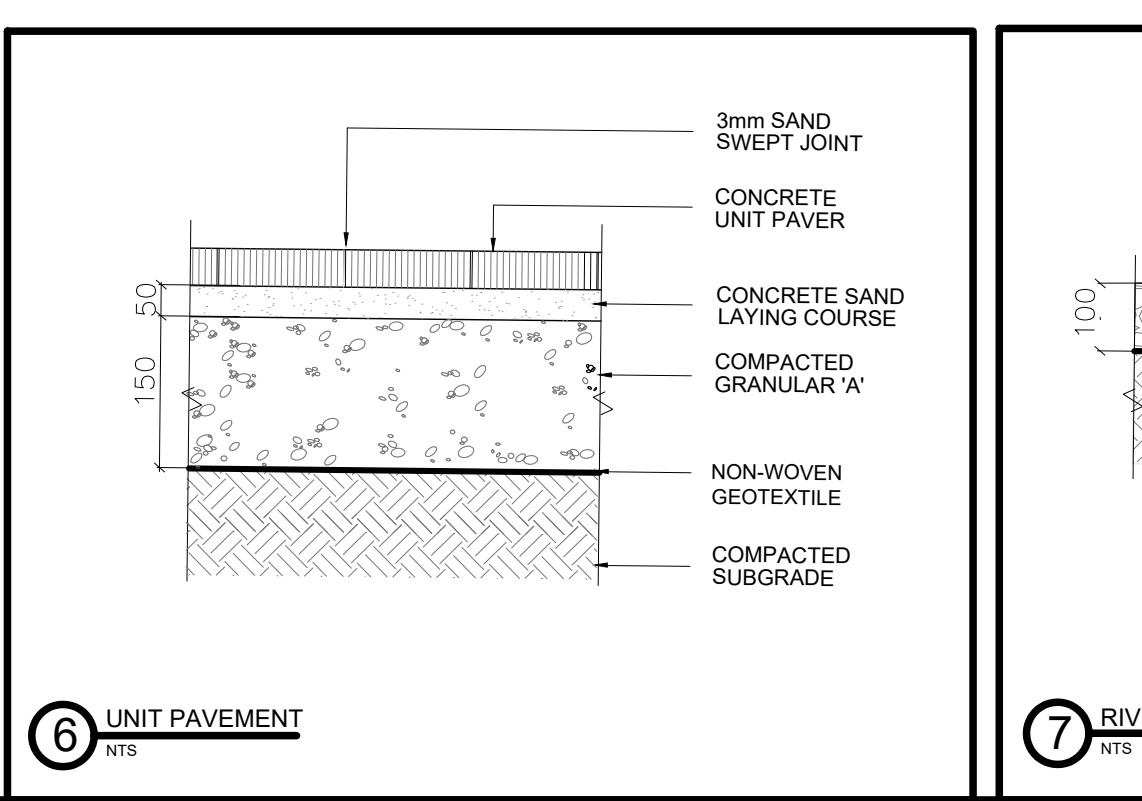
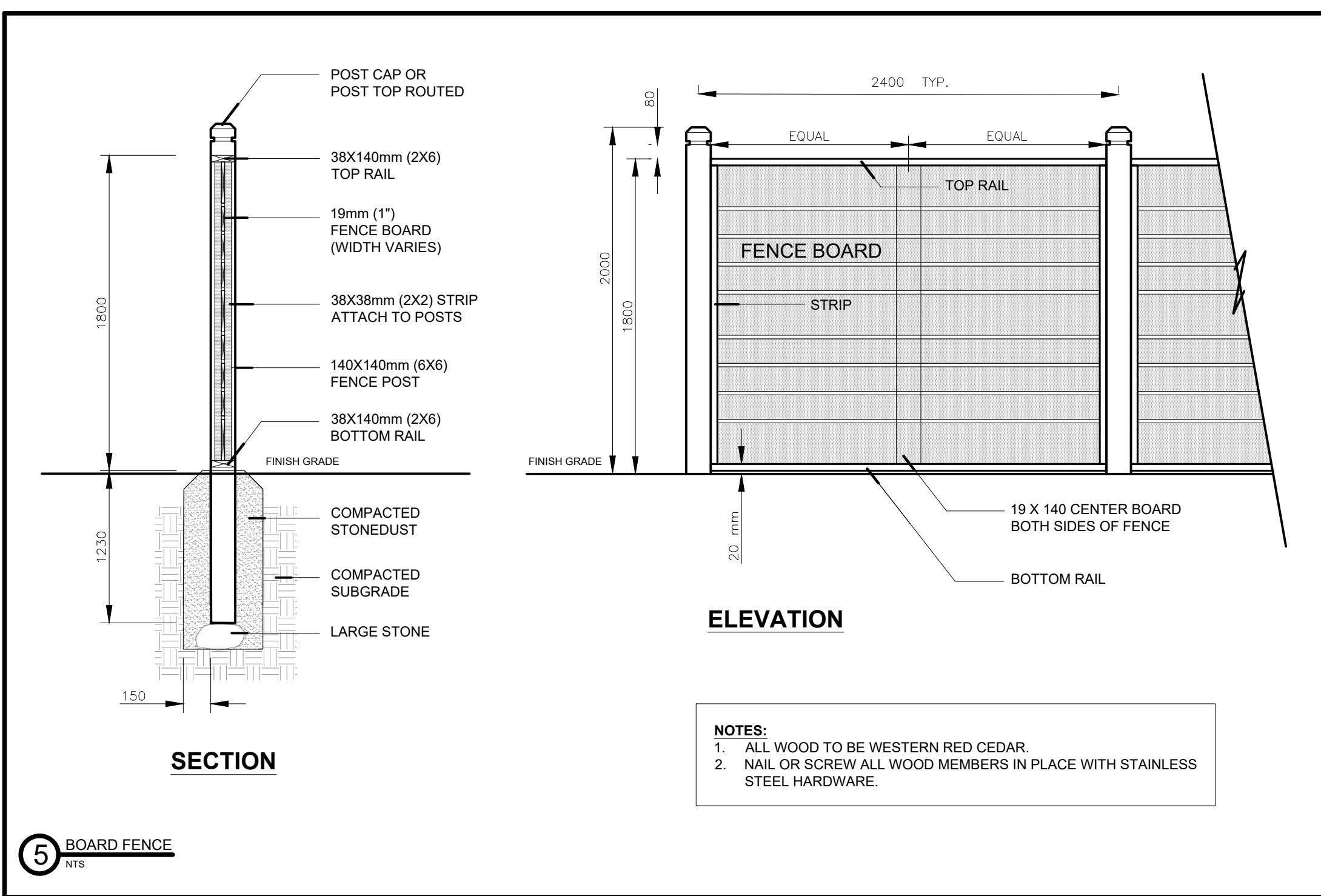
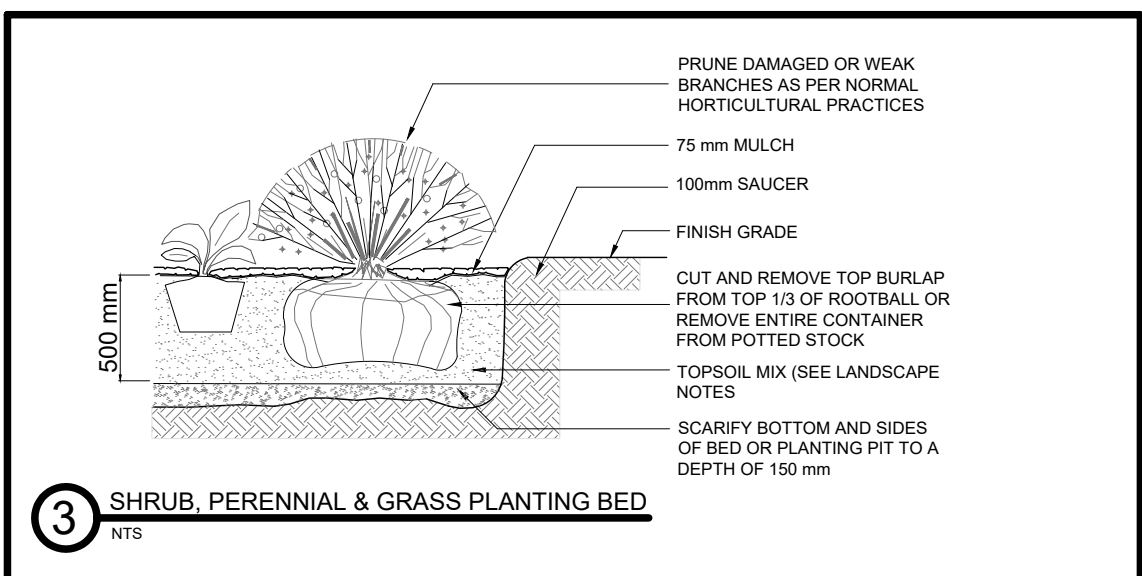
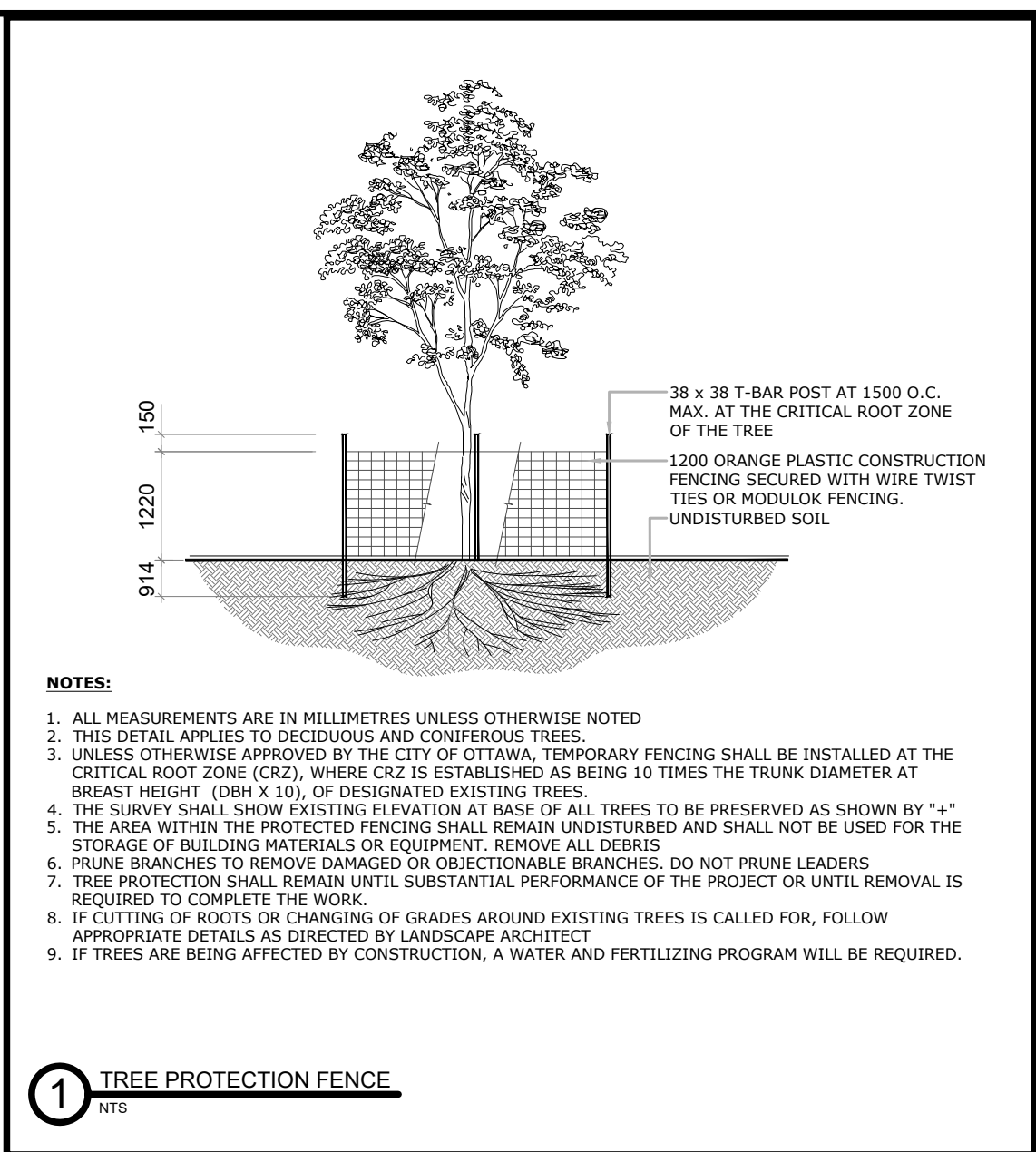

**GENERAL NOTES**

- This drawing has been prepared for site plan approval only. Additional detailing and specifications are required for construction.
- It is the responsibility of the Contractor to verify all dimensions & conditions on site. Report any errors or omissions to the Landscape Architect prior to commencing work.
- It is the responsibility of the Contractor to locate all underground utilities prior to construction.
- All dimensions are in metric.
- Do not scale the drawings.
- All drawings & designs remain the property of TRACY WHALEN - LANDSCAPE ARCHITECT & are protected by copyright.

**TREE CONSERVATION NOTES**  
(PERTAINING TO TREES WHICH ARE ON SITE & PARTIALLY LOCATED ON ADJACENT PROPERTIES)

- Do not place any material or equipment within the critical root zone (CRZ) of the trees.
- Do not attach any sign, notice or posters to any tree.
- Do not raise or lower the existing grade within the CRZ without approval.
- Tunnel or bore when digging within the CRZ of a tree.
- Do not damage the root system, trunk or branches of any tree.
- Ensure that exhaust fumes from all equipment are NOT directed towards any tree's canopy.

**LEGEND**

**EXISTING**

- OVERHEAD HYDRO
- OVERHEAD PHONE

**PROPOSED**

- TREE PROTECTION FENCE
- BOARD FENCE
- DECIDUOUS TREES
- DECIDUOUS SHRUBS
- PERENNIALS
- PLANTING BED
- SOD
- SPECIES KEY ON CENTRE
- UNIT PAVERS
- RIVERWASH STONE

**DETAIL NUMBER**  
DRAWING NUMBER

**DETAIL KEY**

05	Revised to coordinate with Arch. dwgs.	2020-01-24
04	Revised in response to SPA comments.	2020-01-17
03	Revised & Reissued for Site Plan Approval	2019-10-21
02	Issued for Site Plan Approval	2019-09-25
01	Issued for Discussion	2019-09-20
NO.	REVISION	DATE

**WOODMAN ARCHITECT & ASSOCIATES LTD.**

4 BEECHWOOD, SUITE 201, OTTAWA, ONTARIO, CANADA K1L 8L9  
TEL: 613 228 9850 FAX: 613 228 9848 mailbox@woodmanarchitect.com

**DEVELOPER:**  
NICK & CARMEN ARGENTINA  
1504 GOTH AVENUE, OTTAWA

**CONSULTANTS:**

**TRACY WHALEN - LANDSCAPE ARCHITECT**  
Studio B, 5 Wellfleet Cres., Ottawa, Ontario K2J 2X7 (613) 825-9756

**ASSOCIATION OF LANDSCAPE ARCHITECTS OF ONTARIO**

**PROJECT**  
114, 118, 122  
RUSSELL AVENUE - OTTAWA

**DRAWING:**  
LANDSCAPE SITE PLAN  
PROPOSED DEVELOPMENT

DATE	SEPTEMBER 25, 2019	JOB NO.	190993
SCALE	1:150	DRAWING NO.	
DRAWN BY	T.W.		
REVIEWED BY	T.W.		

**L2**