

CLIENT: JADCO GROUP
345 BOLLIVARD SANSON, LAVAL, QC

CONSULTANTS: Roderick Lahey Architect Inc.
56 Beach St.
Ottawa, ON
Tel: (613) 724-8822

SURVEYORS: Annis, O'Sullivan, Vollebakk Ltd.
14 Concourse Gate, Suite 200
Nepean, ON
Tel: (613) 274-9850

CIVIL ENGINEERS: Novatech Engineering Consultants Ltd.
240 Michael Cowpland Dr., Suite 200
Ottawa, ON
Tel: (613) 274-9843

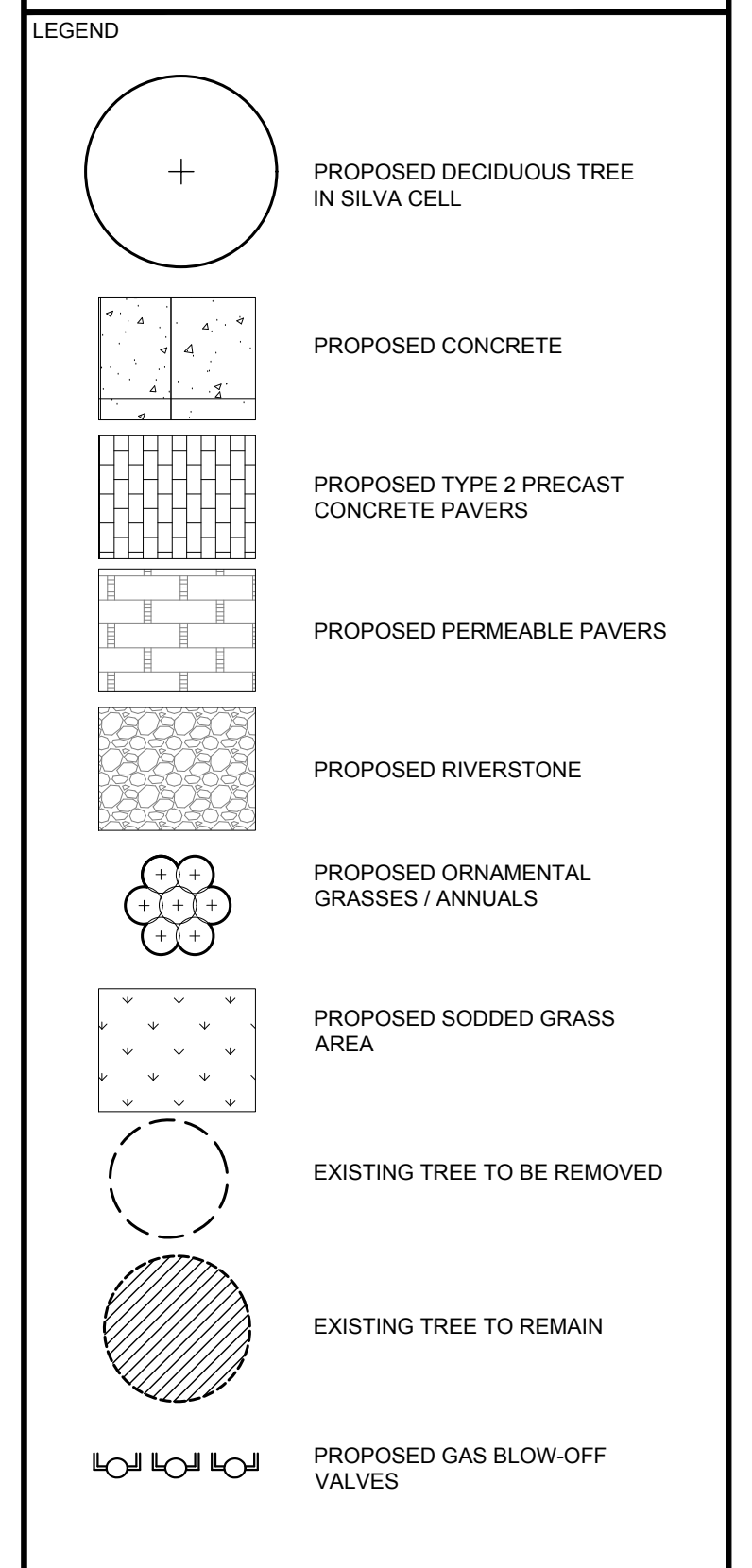

5	NOTE RE: GAS BLOW-OFF VALVES ADDED	04/22/2019	ML	JL
4	REVISED PER CITY COMMENTS	03/05/2019	ML	JL
3	REVISED PER UDRP COMMENTS	02/06/2019	ML	JL
2	REVISED PER CITY COMMENTS	12/21/2018	ML	JL
1	ISSUED FOR SITE PLAN CONTROL	08/17/2018	ML	JL
No.	Issue	Date	ML	DR
		MM/DD/YY		CK

JAMES B. LENNOX & ASSOCIATES INC.
LANDSCAPE ARCHITECTS
3332 CARLING AVE. OTTAWA, ONTARIO K2H 5A8
Tel: (613) 722-5168 Fax: (866) 343-3942

PROJECT: PROPOSED COMMERCIAL / APARTMENT BUILDING
180 METCALFE, OTTAWA ON

DRAWING: TREE CONSERVATION REPORT & LANDSCAPE PLAN

SCALE: 1:100
START DATE: JUNE, 2018
PROJECT NO.: 18-MIS-1847

DRAWING NO.: L.1
PLOT SIZE ARCH-D

1 TREE CONSERVATION REPORT AND LANDSCAPE PLAN
SCALE: 1:100

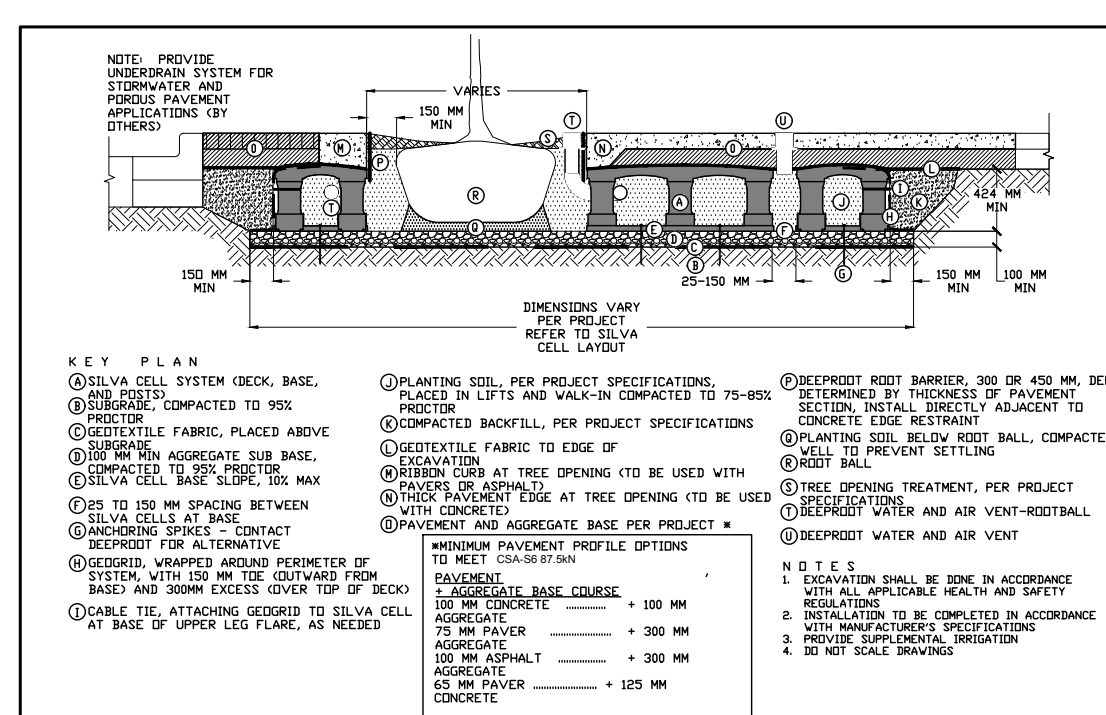

2 DECIDUOUS TREE PLANTING IN SILVA CELL
SCALE: NTS

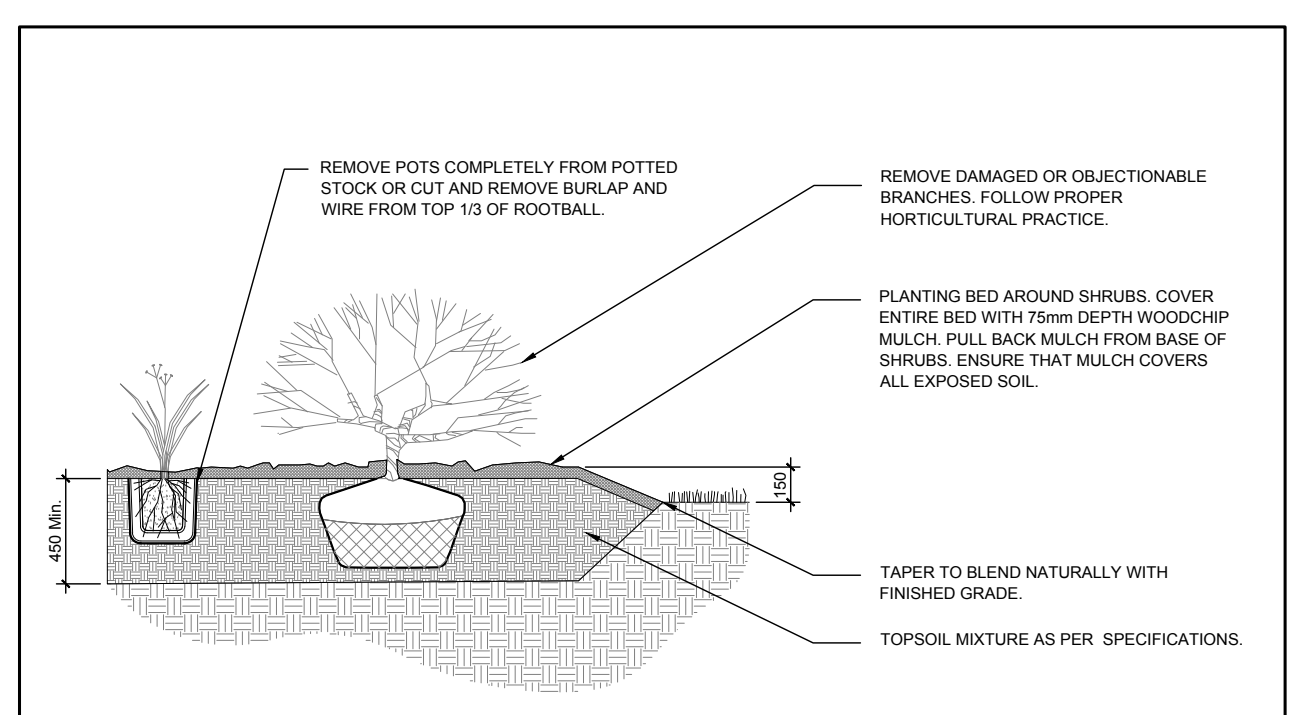

3 ORNAMENTAL GRASS PLANTING
SCALE: NTS

- GENERAL NOTES:
- It is the responsibility of the appropriate contractor or official to report any errors, omissions or discrepancies on this plan with actual site conditions to the Landscape Architect before proceeding with construction.
 - The contractor is to notify all utility companies and authorities prior to any excavation and ascertain locations of underground services.
 - The contractor is to reinstate all areas and items damaged as a result of construction activity.
 - The contractor is to comply with all pertinent codes and by-laws.
 - The contractor is to maintain a positive surface run-off throughout the entire construction period.
 - The Landscape Architect is not responsible for subsurface conditions.
 - The contractor is to identify all existing trees to remain on site with the Landscape Architect prior to construction.
 - The contractor is to stake the proposed location of all plant material in conjunction with the Landscape Architect prior to excavation.
 - Minimum distances for selected deciduous trees are as follows:
 - Building Foundations 7.5m
 - Sidewalks 1.5m
 - Public Streets 2.5m
 - Underground Infrastructure 2.0m
 - All trees within 1m of underground utility trenches are to be excavated by hand.
 - Remove all protective wrapping from tree trunks after installation.
 - Staking of trees shall only be performed if necessary.
 - Ensure that mulch is pulled back a min. distance of 75mm from base of tree trunk.

EXISTING TREE LIST

KEY	QTY	BOTANICAL NAME	COMMON NAME	SIZE	CONDITION	REMARKS
AN	11	Acer negundo	Manitoba Maple	150-350mm DBH.	Good	See Plan
AP	2	Acer glaberrimum	Norway Maple	250-800mm DBH.	Good	See Plan
FR	3	Fraxinus pennsylvanica	Green Ash	100-250mm DBH.	Dead-Fair	See Plan
UP	3	Ulmus pumila	Siberian Elm	300-350mm DBH.	Good	See Plan

PROPOSED PLANT LIST

KEY	QTY	BOTANICAL NAME	COMMON NAME	SIZE	CONDITION	REMARKS
HL	4	Gleditsia triacanthos 'Draves'	Streetkeeper Honey Locust	60mm Cal.	B&B	
PA	134	Phalaris arundinacea 'Strawberries & Cream'	Strawberries & Cream Ribbon Grass	250mm Pot	Potted	Space 600mm O.C.

D07-12-18-0125

#17827