

ENLARGEMENT PLANT LISTS

| 120025 - Block 13 - Plants Adjacent to Building - Plant List |     |   |                         |          |      |            |
|--|-----|---|-------------------------|----------|------|------------|
| KEY  | QTY | BOTANICAL NAME  | COMMON NAME             | SIZE     | COND | SPACING    |
| <b>Deciduous Trees</b>                                       |     |   |                         |          |      |            |
| AFAF   | 8   | <i>Acer x freemanii 'Autumn Fantasy'</i>                | Autumn Fantasy Maple    | 50mm Cal | WB   | As Shown   |
| GT1  | 12  | <i>Gleditsia triacanthos var. inermis 'Shademaster'</i> | Shademaster Honeylocust | 50mm Cal | WB   | As Shown   |
| MSS  | 4   | <i>Morus 'Spring Snow'</i>                              | Spring Snow Crabapple   | 50mm Cal | WB   | As Shown   |
| UAV  | 13  | <i>Ulmus americana 'Valley Forge'</i>                   | Valley Forge Elm        | 50mm Cal | WB   | As Shown   |
| <b>Coniferous Shrubs</b>                                     |     |   |                         |          |      |            |
| Psm  | 1   | <i>Pinus mugo 'Sloamound'</i>                           | Sloamound Mugo Pine     | 40cm Spr | PT   | 100cm O.C. |
| <b>Deciduous Shrubs</b>                                      |     |   |                         |          |      |            |
| Csa  | 120 | <i>Cornus sericea 'Farrow'</i>                          | Arctic Fire Dogwood     | 45cm Ht  | PT   | 90cm O.C.  |
| Hjk  | 420 | <i>Hypericum kalmianum</i>                              | Kalm's St. John's Wort  | 45cm Ht  | PT   | 60cm O.C.  |
| Pj   | 221 | <i>Physocarpus opulifolius 'UEFAM'</i>                  | Amber Jubilee Ninebark  | 60cm Ht  | PT   | 100cm O.C. |
| Rag  | 30  | <i>Rhus aromatica 'Gro-Low'</i>                         | Gro-Low Fragrant Sumac  | 45cm Ht  | PT   | 100cm O.C. |

| 120025 - Block 13 - Plants Adjacent to Building - Plant List |     |  |                               |      |      |            |
|--|-----|--|-------------------------------|------|------|------------|
| KEY  | QTY | BOTANICAL NAME                                 | COMMON NAME                   | SIZE | COND | SPACING    |
| <b>Perennials</b>  |     |  |                               |      |      |            |
| hfb  | 36  | <i>Hosta 'Fragrant Blue'</i>                   | Fragrant Blue Hosta           | 1g   | PT   | 90cm O.C.  |
| pls  | 326 | <i>Perovskia atriplicifolia 'Little Spire'</i> | Dwarf Russian Sage            | 1g   | PT   | 60cm O.C.  |
| rg   | 360 | <i>Rudbeckia fulgida 'Little Gold Star'</i>    | Little Gold Star Coneflower   | 1g   | PT   | 45cm O.C.  |
| sm   | 38  | <i>Salvia nemorosa 'May Night'</i>             | May Night Perennial Salvia    | 1g   | PT   | 45cm O.C.  |
| <b>Vines</b>   |     |  |                               |      |      |            |
| Lds  | 32  | <i>Lonicera x brownii 'Dropmore Scarlett'</i>  | Dropmore Scarlett Honeysuckle | 1g   | PT   | 150cm O.C. |
| <b>Ornamental Grasses</b>                                    |     |  |                               |      |      |            |
| pvn  | 56  | <i>Panicum virgatum 'Northwind'</i>            | Northwind Switch Grass        | 1g   | PT   | 60cm O.C.  |
| sh   | 442 | <i>Sporobolus heterolepis</i>                  | Prairie Dropseed              | 1g   | PT   | 45cm O.C.  |

| 120025 - Block 13 - Entrance Features - Plant List |     |  |                        |         |      |            |
|--|-----|--|------------------------|---------|------|------------|
| KEY  | QTY | BOTANICAL NAME                                 | COMMON NAME            | SIZE    | COND | SPACING    |
| <b>Deciduous Shrubs</b>                            |     |  |                        |         |      |            |
| Csa  | 29  | <i>Cornus sericea 'Farrow'</i>                 | Arctic Fire Dogwood    | 45cm Ht | PT   | 90cm O.C.  |
| Hjk  | 59  | <i>Hypericum kalmianum</i>                     | Kalm's St. John's Wort | 45cm Ht | PT   | 60cm O.C.  |
| Rag  | 24  | <i>Rhus aromatica 'Gro-Low'</i>                | Gro-Low Fragrant Sumac | 45cm Ht | PT   | 100cm O.C. |
| <b>Perennials</b>                                  |     |  |                        |         |      |            |
| pls  | 26  | <i>Perovskia atriplicifolia 'Little Spire'</i> | Dwarf Russian Sage     | 1g      | PT   | 60cm O.C.  |
| <b>Ornamental Grasses</b>                          |     |  |                        |         |      |            |
| pvn  | 14  | <i>Panicum virgatum 'Northwind'</i>            | Northwind Switch Grass | 1g      | PT   | 60cm O.C.  |

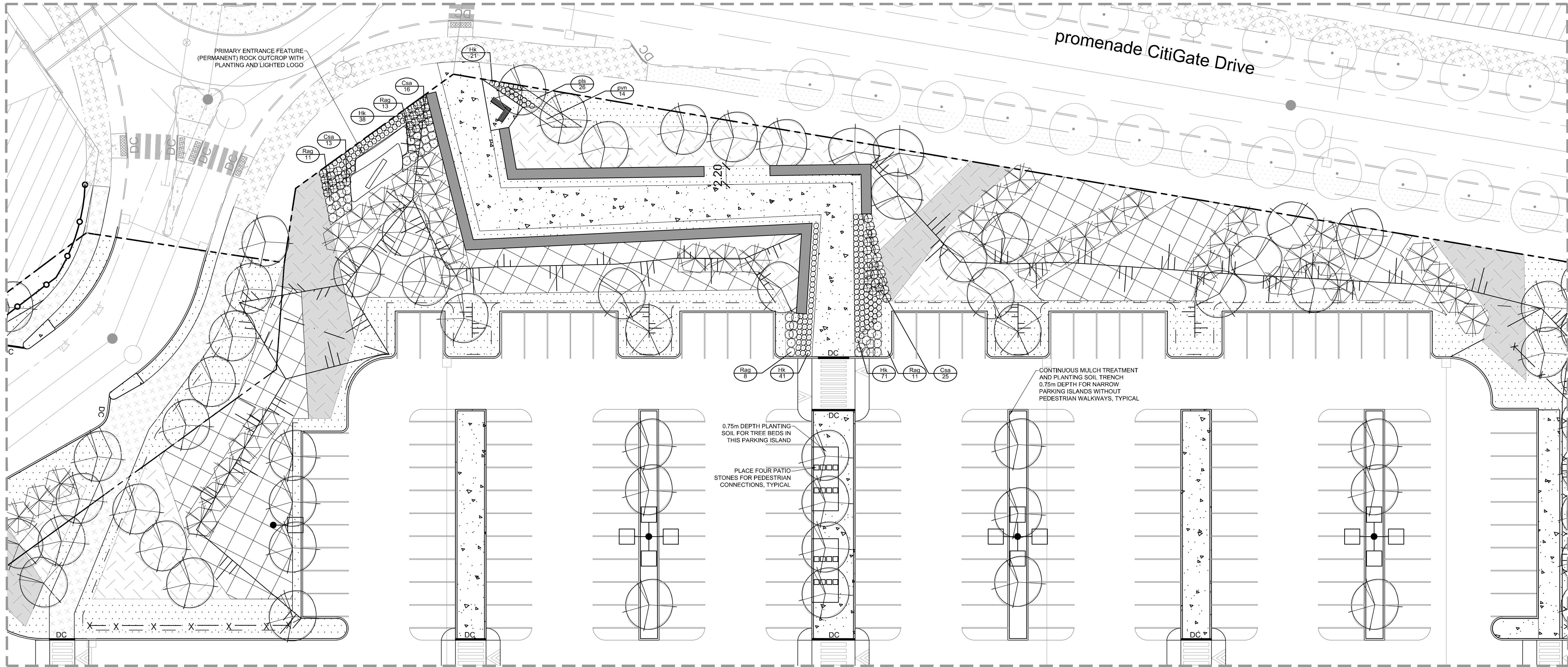

ENLARGEMENT - A

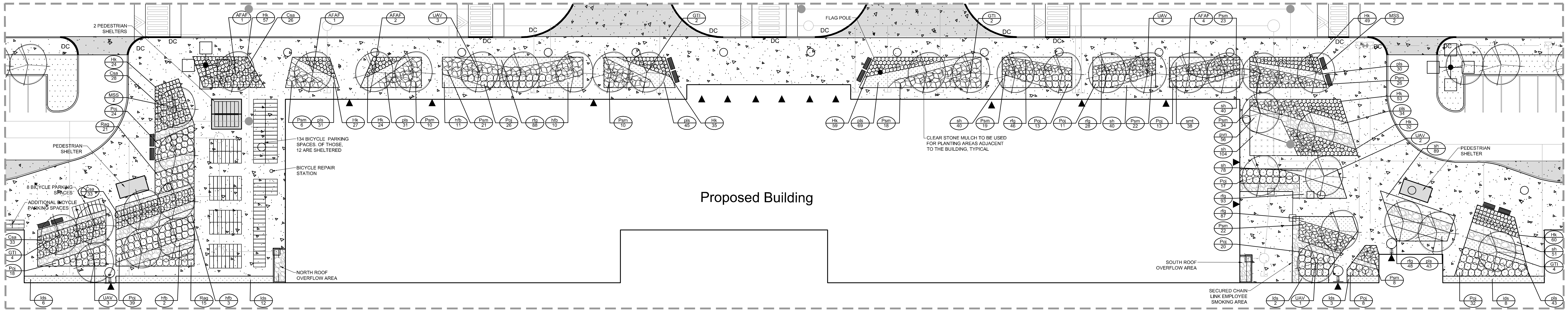

ENLARGEMENT - B

NOTE:  
THE POSITION OF ALL POLE LINES, CONDUITS,  
WATERMAINS, SEWERS AND OTHER  
UNDERGROUND AND OVERGROUND UTILITIES AND  
STRUCTURES IS NOT NECESSARILY SHOWN ON  
THE CONTRACT DRAWINGS, AND WHERE SHOWN,  
THE ACCURACY OF THE POSITION OF SUCH  
UTILITIES AND STRUCTURES IS NOT GUARANTEED.  
BEFORE STARTING WORK, DETERMINE THE EXACT  
LOCATION OF ALL SUCH UTILITIES AND  
STRUCTURES AND ASSUME ALL LIABILITY FOR  
DAMAGE TO THEM.

NOT FOR  
CONSTRUCTION

| SCALE        |  |  |  |
|--------------|--|--|--|
| 1:250        |  |  |  |
| 0 2 4 6 8 10 |  |  |  |
| DESIGN       |  |  |  |
| CHECKED      |  |  |  |
| DRAWN        |  |  |  |
| CHECKED      |  |  |  |
| APPROVED     |  |  |  |
| REVISION     |  |  |  |
| DATE         |  |  |  |
| BY           |  |  |  |

| FOR REVIEW ONLY |  |
|-----------------|--|
| KW/JP           |  |
| JP              |  |
| KW              |  |
| JP              |  |
| RU              |  |

**NOVATECH**  
Engineers, Planners & Landscape Architects  
Suite 200, 240 Michael Cowpland Drive  
Ottawa, Ontario, Canada K2M 1P6  
Telephone (613) 254-9643  
Facsimile (613) 254-9857  
Website www.novatech-eng.com

LOCATION  
PROJECT PYTHON  
222 CITIGATE DRIVE, CITY OF OTTAWA

DRAWING NAME  
LANDSCAPE  
ENLARGEMENTS A AND B

|             |           |
|-------------|-----------|
| PROJECT NO. | 120025-00 |
| REV         | REV # 4   |
| DRAWING NO. | 120025-L6 |