

- LEGEND**
- PROPERTY LINE
  - PRECAST CONCRETE RETAINING WALL WITH RAILING
  - CONCRETE CURBED PLANTER
  - PRECAST CONCRETE PLANTER
  - PRECAST CONCRETE SEAT WALL WITH GRANITE COPING
  - METAL FENCE
  - CONCRETE PAVING
  - PRECAST CONCRETE PAVERS - TYPE 1
  - PRECAST CONCRETE PAVERS - TYPE 2
  - ACCESS GATE
  - BIKE RACK
  - SHRUBS/ PERENNIALS
  - PROPOSED DECIDUOUS TREE
  - TRANSPLANTED DECIDUOUS TREE
  - EXISTING TREE TO REMAIN
  - FUTURE ROAD WIDENING
  - FUTURE CONCRETE SIDEWALK AFTER ROAD WIDENING
  - LIGHT STANDARD - REFER TO ARCHITECTURAL
  - BUILDING ENTRANCE
  - AIR INTAKE/ EXHAUST GRILL - REFER TO ARCHITECTURAL
  - WATER SERVICE - REFER TO CIVIL
  - STORM DRAIN - REFER TO CIVIL
  - CATCH BASIN - REFER TO CIVIL
  - UNDERGROUND STORM WATER STORAGE - REFER TO CIVIL

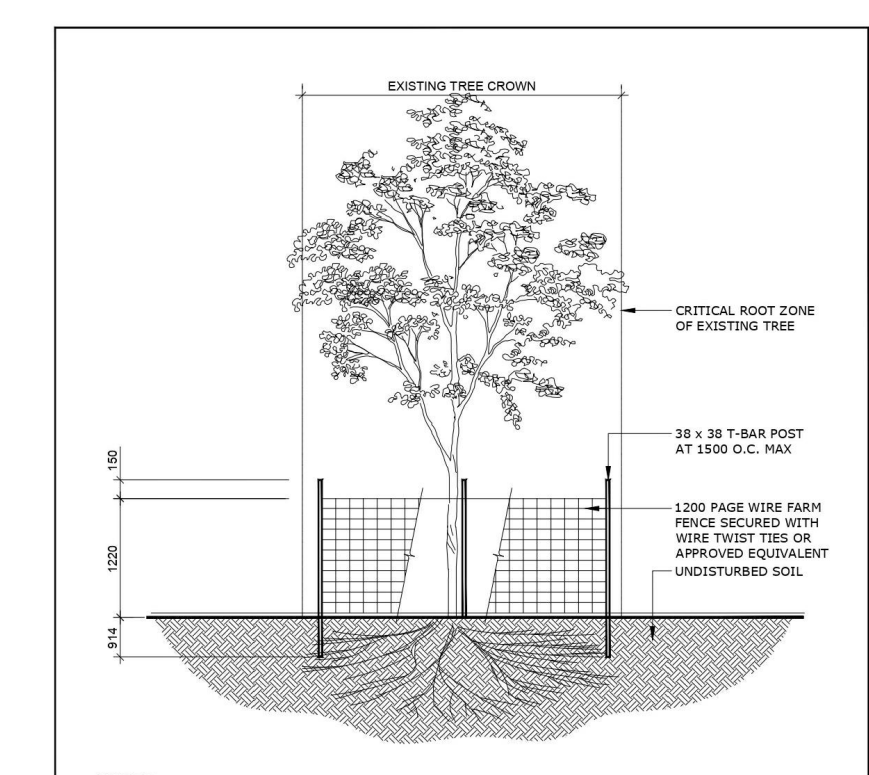

NO.	ISSUE	DATE	BY
10	REISSUED FOR SITE PLAN APPROVAL	15/05/2020	MK JL
9	ISSUED FOR TENDER	14/04/2020	MK JL
8	ISSUED FOR CLIENT REVIEW	06/02/2020	MK JL
7	ISSUED FOR COORDINATION	20/11/2019	MK JL
6	REISSUED FOR SITE PLAN APPROVAL	03/21/2019	LC JL
5	REVISED AS PER CITY COMMENTS	07/19/2019	LC JL
4	REISSUED FOR SITE PLAN APPROVAL	03/21/2019	LC JL
3	ISSUED FOR DISCUSSION AND REVIEW	03/15/2019	LC JL
2	ISSUED FOR DISCUSSION AND REVIEW	03/07/2019	LC JL
1	ISSUED FOR SPC	10/30/2018	SS JL
No.	ISSUE	Date	DR CK

**CLIENT**

**RIO CAN™**  
REAL VISION. SOLID GROUND.

**CONSULTANTS**

ARCHITECTS: **Roderick Lahey Architects**  
55 Beech Street  
Tel: (613) 724-9662

**GENERAL NOTES:**

- IT IS THE RESPONSIBILITY OF THE APPROPRIATE CONTRACTOR OR OFFICIAL TO REPORT ANY ERRORS, OMISSIONS OR DISCREPANCIES ON THIS PLAN WITH ACTUAL SITE CONDITIONS TO THE LANDSCAPE ARCHITECT BEFORE PROCEEDING WITH CONSTRUCTION.
- THE CONTRACTOR IS TO NOTIFY ALL UTILITY COMPANIES AND AUTHORITIES PRIOR TO ANY EXCAVATION AND ASCERTAIN LOCATIONS OF UNDERGROUND SERVICES.
- THE CONTRACTOR IS TO REINSTATE ALL AREAS AND ITEMS DAMAGED AS A RESULT OF CONSTRUCTION ACTIVITY.
- THE CONTRACTOR IS TO COMPLY WITH ALL PERTINENT CODES AND BY-LAWS.
- THE CONTRACTOR IS TO MAINTAIN A POSITIVE SURFACE RUN-OFF THROUGHOUT THE ENTIRE CONSTRUCTION PERIOD.
- THE LANDSCAPE ARCHITECT IS NOT RESPONSIBLE FOR SUBSURFACE CONDITIONS.
- THE CONTRACTOR IS TO IDENTIFY ALL EXISTING TREES TO REMAIN ON SITE WITH THE LANDSCAPE ARCHITECT PRIOR TO CONSTRUCTION.
- THE CONTRACTOR IS TO STAKE THE PROPOSED LOCATION OF ALL PLANT MATERIAL IN CONJUNCTION WITH THE LANDSCAPE ARCHITECT PRIOR TO EXCAVATION.
- MINIMUM DISTANCES FOR SELECTED DECIDUOUS TREES ARE AS FOLLOWS:
  - BUILDING FOUNDATIONS 7.5M
  - SIDEWALKS 1.5M
  - PUBLIC STREETS 2.5M
  - UNDERGROUND INFRASTRUCTURE 2.0M
- ALL TREES WITHIN 1M OF UNDERGROUND UTILITY TRENCHES ARE TO BE EXCAVATED BY HAND.
- REMOVE ALL PROTECTIVE WRAPPING FROM TREE TRUNKS AFTER INSTALLATION.
- ENSURE THAT MULCH IS PULLED BACK A MIN. DISTANCE OF 75MM FROM BASE OF TREE TRUNK.
- TRANSPLANTED TREES WILL REQUIRE WATERING FOR 2 YEARS FOLLOWING TRANSPLANTATION.
- COMPENSATION IS REQUIRED FOR THE REMOVAL OF THE TWO HEALTHY CITY OWNED GRABAPLES LOCATED ALONG MERIVALE RD. (THERE IS NO COMPENSATION REQUIRED FOR THE DEAD GRABAPPLE). COMPENSATION HAS BEEN CALCULATED IN THE AMOUNT OF \$1,200. ONCE COMPENSATION HAS BEEN RECEIVED FORESTRY WILL PROVIDE WRITTEN PERMISSION TO HAVE THE TREES REMOVED.

**JAMES B. LENNOX & ASSOCIATES INC.**  
**LANDSCAPE ARCHITECTS**  
3332 CARLING AVE. OTTAWA, ONTARIO K2H 5A8  
Tel: (613) 722-5168 Fax: (613) 443-3942

**PROJECT**  
WESTGATE - PHASE I  
1309 CARLING AVENUE, OTTAWA ON

**DRAWING**  
GROUND FLOOR  
LANDSCAPE - LAYOUT & MATERIALS

**STAMP**

**SCALE**  
AS SHOWN

**START DATE**  
SEPT 2018

**PROJECT NO.**

**DRAWING NO.**  
**L1.1**

**PLOT SIZE ISO-B1**

1 LAYOUT AND MATERIALS PLAN  
SCALE 1:150



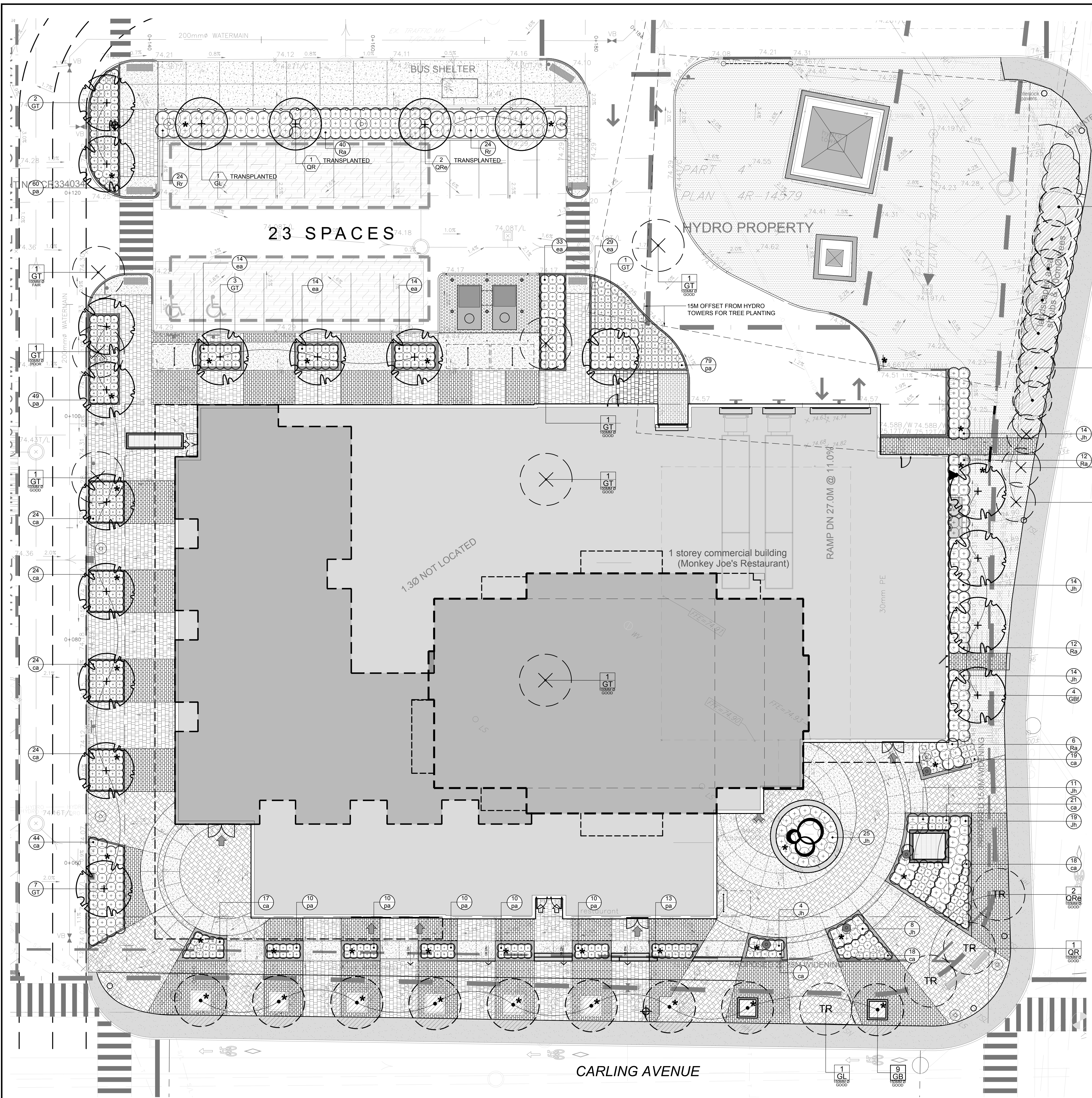

**LEGEND**

- PROPERTY LINE
- PRECAST CONCRETE RETAINING WALL
- PRECAST CONCRETE RETAINING WALL WITH PRIVACY SCREEN
- CONCRETE CURBED PLANTER
- PRECAST CONCRETE PLANTER WALL
- PRECAST CONCRETE SEAT WALL WITH GRANITE COPING
- METAL FENCE
- CONCRETE PAVING
- PRECAST CONCRETE PAVERS - TYPE 1
- PRECAST CONCRETE PAVERS - TYPE 2
- SOD
- ACCESS GATE
- BIKE RACK
- SHRUBS/ PERENNIALS
- PROPOSED DECIDUOUS TREE
- TRANSPLANTED DECIDUOUS TREE
- EXISTING TREE TO REMAIN
- EXISTING TREE TO BE TRANSPLANTED
- EXISTING TREE TO BE REMOVED
- FUTURE ROAD WIDENING
- FUTURE CONCRETE SIDEWALK AFTER ROAD WIDENING
- LIGHT STANDARD - REFER TO ELECTRICAL
- BUILDING ENTRANCE
- AIR INTAKE/ EXHAUST GRILL - REFER TO ARCHITECTURAL
- WATER SERVICE - REFER TO CIVIL
- STORM DRAIN - REFER TO CIVIL
- CATCH BASIN - REFER TO CIVIL
- UNDERGROUND STORM WATER STORAGE - REFER TO CIVIL
- PROVIDE IRRIGATION TO PLANTING BEDS/ PLANTERS/ SOD
- 1.5" IRRIGATION STUB TO OUTSIDE WALL LOCATION TO BE CONFIRMED ON SITE AND APPROVED BY CONSULTANT

**EXISTING TREE LIST**

KEY	QTY	BOTANICAL NAME	COMMON NAME	SIZE	CONDITION	REMARKS
<b>DECIDUOUS TREES</b>						
MA	2	Malus sp.	Crabapple	100mm Ø	Good	TO REMAIN
MA	3	Malus sp.	Crabapple	100mm Ø	Good	TO BE REMOVED
GB	9	Ginkgo biloba	Maidenhair	150mm Ø	Good	TO REMAIN
GL	1	Ginkgo biloba	Maidenhair Tree	150mm Ø	Tree Spade	TO BE TRANSPLANTED
GT	7	Gleditsia triacanthos	Honey Locust	100mm Ø	Fair-Good	TO BE REMOVED
SR	5	Syringa reticulata	Japanese Tree Lilac	150mm Ø	Good	TO REMAIN
QR	1	Quercus rubra	Red Oak	150mm Ø	Tree Spade	TO BE TRANSPLANTED
QR	2	Quercus robur	English Oak	60mm Ø	Tree Spade	TO BE TRANSPLANTED

**TRANSPLANT TREE LIST**

KEY	QTY	BOTANICAL NAME	COMMON NAME	SIZE	METHOD	REMARKS
<b>DECIDUOUS TREES</b>						
GL	1	Ginkgo biloba	Maidenhair Tree	150mm Ø	Tree Spade	TRANSPLANT OR REPLACE WITH NEW ACER X FREEMANII AUTUMN BLAZE 70MM CAL B&B NURSERY STOCK
QR	1	Quercus rubra	Red Oak	150mm Ø	Tree Spade	TRANSPLANT OR REPLACE WITH NEW ACER X FREEMANII AUTUMN BLAZE 70MM CAL B&B NURSERY STOCK
QR	2	Quercus robur	English Oak	60mm Ø	Tree Spade	TRANSPLANT OR REPLACE WITH NEW ACER X FREEMANII AUTUMN BLAZE 70MM CAL B&B NURSERY STOCK

**PROPOSED PLANT LIST**

KEY	QTY	BOTANICAL NAME	COMMON NAME	SCHED. SIZE	CONDITION	REMARKS
<b>DECIDUOUS TREES</b>						
GBF	2	Ginkgo biloba 'Fastigata'	Columnar Maidenhair Tree	60mm Ø	B&B	
GT	11	Gleditsia triacanthos var. inermis	Street Keeper Honeylocust	60mm Ø	B&B	
<b>SHRUBS</b>						
Jh	83	Juniperus horizontalis 'Bar Harbor'	Bar Harbor Juniper	60cm spr.	Potted	900 mm
Ra	70	Rhus aromatica	Fragrant Sumac	80cm ht.	Potted	900 mm
Rz	48	Rosa rugosa 'Hansa'	Hansa Rugosa Rose	80cm ht.	Potted	1000 mm
<b>ORNAMENTAL GRASSES</b>						
ca	198	Calamagrostis acutiflora 'Karl Foerster'	Karl Foerster Feather Reed Grass	25cm pot	Potted	600 mm
ep	104	Elymus arenarius 'Blue Dune'	Blue Dune Lyme Grass	25cm pot	Potted	600 mm
pp	251	Phalaris arundinacea 'Strawberries & Cream'	Strawberries & Cream Ribbon Grass	25cm pot	Potted	600 mm

CLIENT

**RIO CAN™**  
REAL VISION. SOLID GROUND.

CONSULTANTS

ARCHITECTS: Roderick Lahey Architects  
50 Beach Street  
Tel: (613) 724-9662

GENERAL NOTES:

- IT IS THE RESPONSIBILITY OF THE APPROPRIATE CONTRACTOR OR OFFICIAL TO REPORT ANY ERRORS, OMISSIONS OR DISCREPANCIES ON THIS PLAN WITH ACTUAL SITE CONDITIONS TO THE LANDSCAPE ARCHITECT BEFORE PROCEEDING WITH CONSTRUCTION.
- THE CONTRACTOR IS TO NOTIFY ALL UTILITY COMPANIES AND AUTHORITIES PRIOR TO ANY EXCAVATION AND ASCERTAIN LOCATIONS OF UNDERGROUND SERVICES.
- THE CONTRACTOR IS TO REINSTATE ALL AREAS AND ITEMS DAMAGED AS A RESULT OF CONSTRUCTION ACTIVITY.
- THE CONTRACTOR IS TO COMPLY WITH ALL PERTINENT CODES AND BY-LAWS.
- THE CONTRACTOR IS TO MAINTAIN A POSITIVE SURFACE RUN-OFF THROUGHOUT THE ENTIRE CONSTRUCTION PERIOD.
- THE LANDSCAPE ARCHITECT IS NOT RESPONSIBLE FOR SUBSURFACE CONDITIONS.
- THE CONTRACTOR IS TO IDENTIFY ALL EXISTING TREES TO REMAIN ON SITE WITH THE LANDSCAPE ARCHITECT PRIOR TO CONSTRUCTION.
- THE CONTRACTOR IS TO STAKE THE PROPOSED LOCATION OF ALL PLANT MATERIAL IN CONJUNCTION WITH THE LANDSCAPE ARCHITECT PRIOR TO EXCAVATION.
- MINIMUM DISTANCES FOR SELECTED DECIDUOUS TREES ARE AS FOLLOWS:  
- BUILDING FOUNDATIONS 7.5M  
- SIDEWALKS 1.5M  
- PUBLIC STREETS 2.5M  
- UNDERGROUND INFRASTRUCTURE 2.0M
- ALL TREES WITHIN 1M OF UNDERGROUND UTILITY TRENCHES ARE TO BE EXCAVATED BY HAND.
- REMOVE ALL PROTECTIVE WRAPPING FROM TREE TRUNKS AFTER INSTALLATION.
- ENSURE THAT MULCH IS PULLED BACK A MIN. DISTANCE OF 75MM FROM BASE OF TREE TRUNK.
- TRANSPLANTED TREES WILL REQUIRE WATERING FOR 2 YEARS FOLLOWING TRANSPLANTATION.
- COMPENSATION IS REQUIRED FOR THE REMOVAL OF THE TWO HEALTHY CITY OWNED CRABAPPLES LOCATED ALONG MERIVALE RD. THERE IS NO COMPENSATION REQUIRED FOR THE DEAD CRABAPPLE. COMPENSATION HAS BEEN CALCULATED IN THE AMOUNT OF \$1,200. ONCE COMPENSATION HAS BEEN RECEIVED FORESTRY WILL PROVIDE WRITTEN PERMISSION TO HAVE THE TREES REMOVED.

10	REISSUED FOR SITE PLAN APPROVAL	15/05/2020	MK	JL
9	ISSUED FOR TENDER	14/04/2020	MK	JL
8	ISSUED FOR CLIENT REVIEW	06/02/2020	MK	JL
7	ISSUED FOR COORDINATION	20/11/2019	MK	JL
6	REISSUED FOR SITE PLAN APPROVAL	03/21/2019	LC	JL
5	REVISED AS PER CITY COMMENTS	07/19/2019	LC	JL
4	REISSUED FOR SITE PLAN APPROVAL	03/21/2019	LC	JL
3	ISSUED FOR DISCUSSION AND REVIEW	03/15/2019	LC	JL
2	ISSUED FOR DISCUSSION AND REVIEW	03/07/2019	LC	JL
1	ISSUED FOR SPC	10/30/2018	SS	JL
No.	Issue	Date	DR	CK
		Issue		

**JAMES B. LENNOX & ASSOCIATES INC.**  
**LANDSCAPE ARCHITECTS**  
3332 CARLING AVE. OTTAWA, ONTARIO K2H 5A8  
Tel. (613) 722-5168 Fax. (613) 343-3942

PROJECT: WESTGATE - PHASE I

1309 CARLING AVENUE, OTTAWA ON

DRAWING: GROUND FLOOR LANDSCAPE - PLANTING PLAN

STAMP: ASSOCIATION OF LANDSCAPE ARCHITECTS OF ONTARIO

SCALE: AS SHOWN

START DATE: SEPT 2018

PROJECT NO.

PROJECT NORTH

DRAWING NO. **L1.2**

PLOT SIZE ISO-B1

1 PLANTING PLAN  
L1.2 SCALE 1:150



CLIENT

**RIOCAN™**  
REAL VISION. SOLID GROUND.

CONSULTANTS

ARCHITECTS: **Roderick Lahey Architects**  
55 Beech Street  
Ottawa, ON  
Tel: (613) 724-9662

GENERAL NOTES:

- IT IS THE RESPONSIBILITY OF THE APPROPRIATE CONTRACTOR OR OFFICIAL TO REPORT ANY ERRORS, OMISSIONS OR DISCREPANCIES ON THIS PLAN WITH ACTUAL SITE CONDITIONS TO THE LANDSCAPE ARCHITECT BEFORE PROCEEDING WITH CONSTRUCTION.
- THE CONTRACTOR IS TO NOTIFY ALL UTILITY COMPANIES AND AUTHORITIES PRIOR TO ANY EXCAVATION AND ASCERTAIN LOCATIONS OF UNDERGROUND SERVICES.
- THE CONTRACTOR IS TO REINSTATE ALL AREAS AND ITEMS DAMAGED AS A RESULT OF CONSTRUCTION ACTIVITY.
- THE CONTRACTOR IS TO COMPLY WITH ALL PERTINENT CODES AND BY-LAWS.
- THE CONTRACTOR IS TO MAINTAIN A POSITIVE SURFACE RUN-OFF THROUGHOUT THE ENTIRE CONSTRUCTION PERIOD.
- THE LANDSCAPE ARCHITECT IS NOT RESPONSIBLE FOR SUBSURFACE CONDITIONS.
- THE CONTRACTOR IS TO IDENTIFY ALL EXISTING TREES TO REMAIN ON SITE WITH THE LANDSCAPE ARCHITECT PRIOR TO CONSTRUCTION.
- THE CONTRACTOR IS TO STAKE THE PROPOSED LOCATION OF ALL PLANT MATERIAL IN CONJUNCTION WITH THE LANDSCAPE ARCHITECT PRIOR TO EXCAVATION.
- MINIMUM DISTANCES FOR SELECTED DECIDUOUS TREES ARE AS FOLLOWS:  
- BUILDING FOUNDATIONS 7.5M  
- SIDEWALKS 1.5M  
- PUBLIC STREETS 2.5M  
- UNDERGROUND INFRASTRUCTURE 2.0M
- ALL TREES WITHIN 1M OF UNDERGROUND UTILITY TRENCHES ARE TO BE EXCAVATED BY HAND.
- REMOVE ALL PROTECTIVE WRAPPING FROM TREE TRUNKS AFTER INSTALLATION.
- ENSURE THAT MULCH IS PULLED BACK A MIN. DISTANCE OF 75MM FROM BASE OF TREE TRUNK.
- TRANSPLANTED TREES WILL REQUIRE WATERING FOR 2 YEARS FOLLOWING TRANSPLANTATION.
- COMPENSATION IS REQUIRED FOR THE REMOVAL OF THE TWO HEALTHY CITY OWNED CRABAPPLES LOCATED ALONG MERIVALE RD. (THERE IS NO COMPENSATION REQUIRED FOR THE DEAD CRABAPPLE). COMPENSATION HAS BEEN CALCULATED IN THE AMOUNT OF \$1,200. ONCE COMPENSATION HAS BEEN RECEIVED FORESTRY WILL PROVIDE WRITTEN PERMISSION TO HAVE THE TREES REMOVED.

10	REISSUED FOR SITE PLAN APPROVAL	15/05/2020	MK	JL
9	ISSUED FOR TENDER	14/04/2020	MK	JL
8	ISSUED FOR CLIENT REVIEW	06/02/2020	MK	JL
7	ISSUED FOR COORDINATION	20/11/2019	MK	JL
6	REISSUED FOR SITE PLAN APPROVAL	03/21/2019	LC	JL
5	REVISED AS PER CITY COMMENTS	07/19/2019	LC	JL
4	REISSUED FOR SITE PLAN APPROVAL	03/21/2019	LC	JL
3	ISSUED FOR DISCUSSION AND REVIEW	03/15/2019	LC	JL
2	ISSUED FOR DISCUSSION AND REVIEW	03/07/2019	LC	JL
1	ISSUED FOR SPC	10/30/2018	SS	JL
No.	Issue	Date	DR	CK
		REVISION		

**JAMES B. LENNOX & ASSOCIATES INC.**  
**LANDSCAPE ARCHITECTS**  
3332 CARLING AVE. OTTAWA, ONTARIO K2H 5A8  
Tel. (613) 722-5168 Fax. (613) 343-3942

PROJECT

WESTGATE - PHASE I

1309 CARLING AVENUE, OTTAWA ON

DRAWING

GROUND FLOOR  
LANDSCAPE - CROSS SECTIONS

STAMP



SCALE

AS SHOWN

START DATE

SEPT 2018

PROJECT NO.

PROJECT NORTH

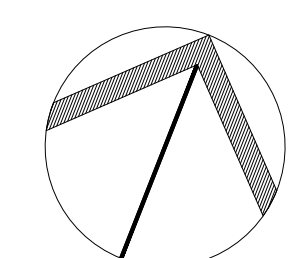

DRAWING NO.

**L1.3**

PLOT SIZE ISO-B1

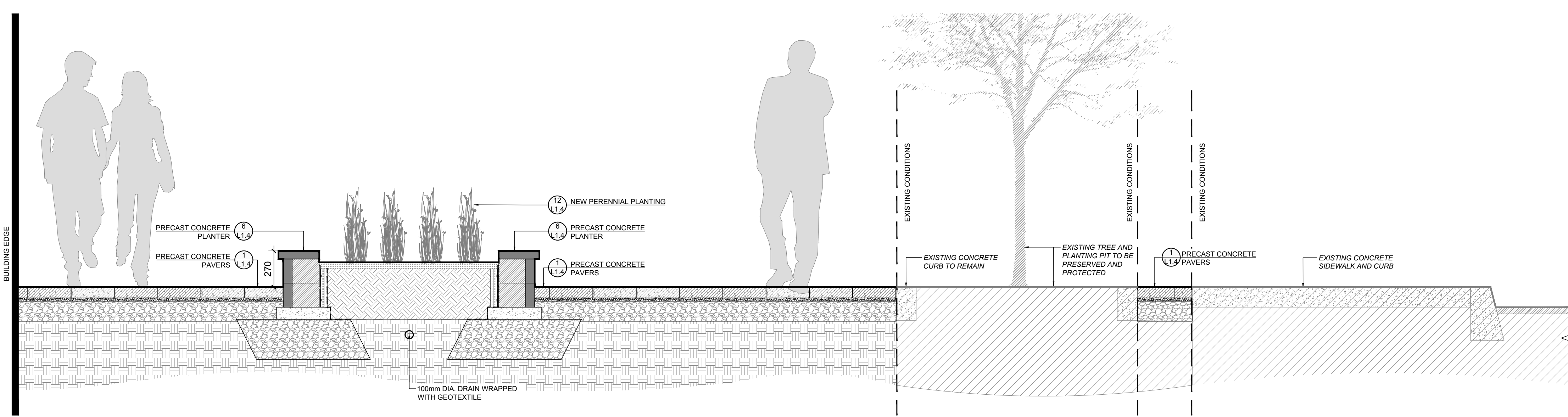

1 SECTION A-A: PLANTER @ CARLING  
SCALE 1:20

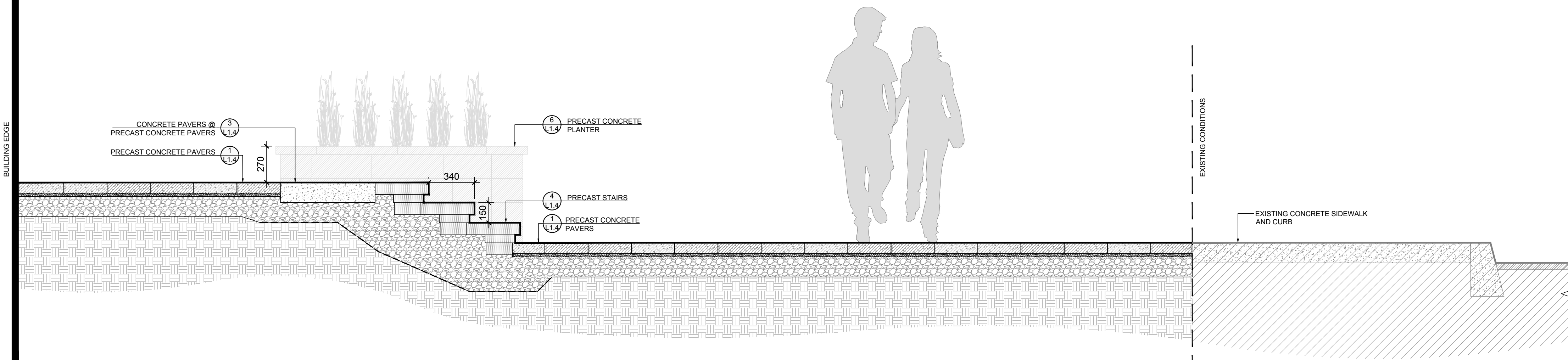

2 SECTION B-B: STAIRS @ CARLING  
SCALE 1:20

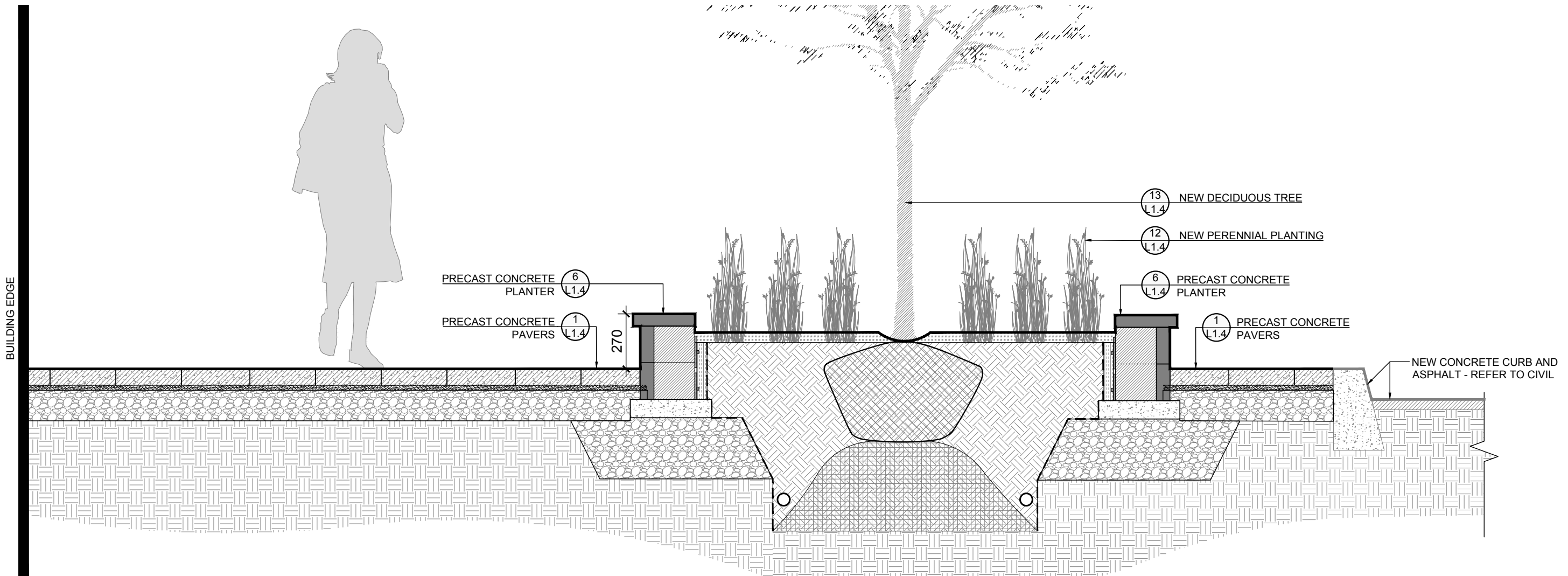

3 SECTION C-C: PLANTER @ NORTH SIDE  
SCALE 1:20

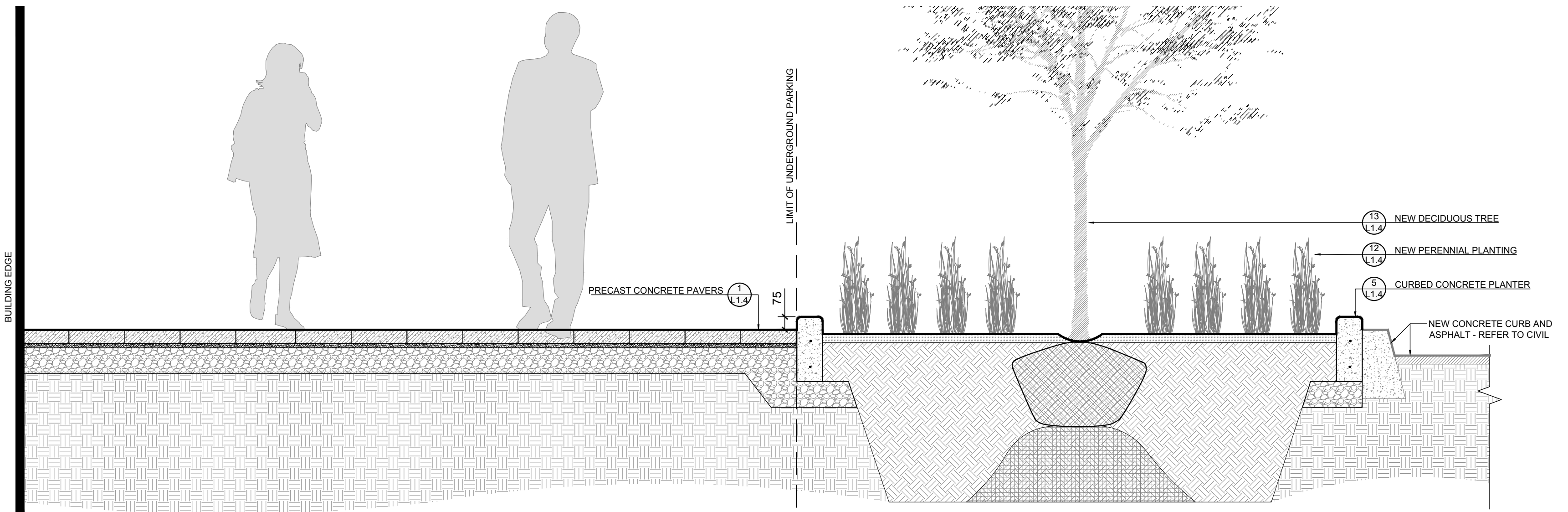

4 SECTION D-D: PLANTER @ WEST SIDE  
SCALE 1:20



- IT IS THE RESPONSIBILITY OF THE APPROPRIATE CONTRACTOR OR OFFICIAL TO REPORT ANY ERRORS, OMISSIONS OR DISCREPANCIES ON THIS PLAN WITH ACTUAL SITE CONDITIONS TO THE LANDSCAPE ARCHITECT BEFORE PROCEEDING WITH CONSTRUCTION.
- THE CONTRACTOR IS TO NOTIFY ALL UTILITY COMPANIES AND AUTHORITIES PRIOR TO ANY EXCAVATION AND ASCERTAIN LOCATIONS OF UNDERGROUND SERVICES.
- THE CONTRACTOR IS TO REINSTATE ALL AREAS AND ITEMS DAMAGED AS A RESULT OF CONSTRUCTION ACTIVITY.
- THE CONTRACTOR IS TO COMPLY WITH ALL PERTINENT CODES AND BY-LAWS.
- THE CONTRACTOR IS TO MAINTAIN A POSITIVE SURFACE RUN-OFF THROUGHOUT THE ENTIRE CONSTRUCTION PERIOD.
- THE LANDSCAPE ARCHITECT IS NOT RESPONSIBLE FOR SUBSURFACE CONDITIONS.
- THE CONTRACTOR IS TO IDENTIFY ALL EXISTING TREES TO REMAIN ON SITE WITH THE LANDSCAPE ARCHITECT PRIOR TO CONSTRUCTION.
- THE CONTRACTOR IS TO STAKE THE PROPOSED LOCATION OF ALL PLANT MATERIAL IN CONJUNCTION WITH THE LANDSCAPE ARCHITECT PRIOR TO EXCAVATION.
- MINIMUM DISTANCES FOR SELECTED DECIDUOUS TREES ARE AS FOLLOWS:
  - BUILDING FOUNDATIONS 1.5M
  - SIDEWALKS 1.5M
  - PUBLIC STREETS 2.5M
  - UNDERGROUND INFRASTRUCTURE 2.0M
- ALL TREES WITHIN 1M OF UNDERGROUND UTILITY TRENCHES ARE TO BE EXCAVATED BY HAND.
- REMOVE ALL PROTECTIVE WRAPPING FROM TREE TRUNKS AFTER INSTALLATION.
- ENSURE THAT MULCH IS PULLED BACK A MIN. DISTANCE OF 75MM FROM BASE OF TREE TRUNK.
- TRANSPLANTED TREES WILL REQUIRE WATERING FOR 2 YEARS FOLLOWING TRANSPLANTATION.
- COMPENSATION IS REQUIRED FOR THE REMOVAL OF THE TWO HEALTHY CITY OWNED GRAPPLES LOCATED ALONG MERIVALE RD. THERE IS NO COMPENSATION REQUIRED FOR THE DEAD GRAPPLE. COMPENSATION HAS BEEN CALCULATED IN THE AMOUNT OF \$1,200. ONCE COMPENSATION HAS BEEN RECEIVED FORESTRY WILL PROVIDE WRITTEN PERMISSION TO HAVE THE TREES REMOVED.

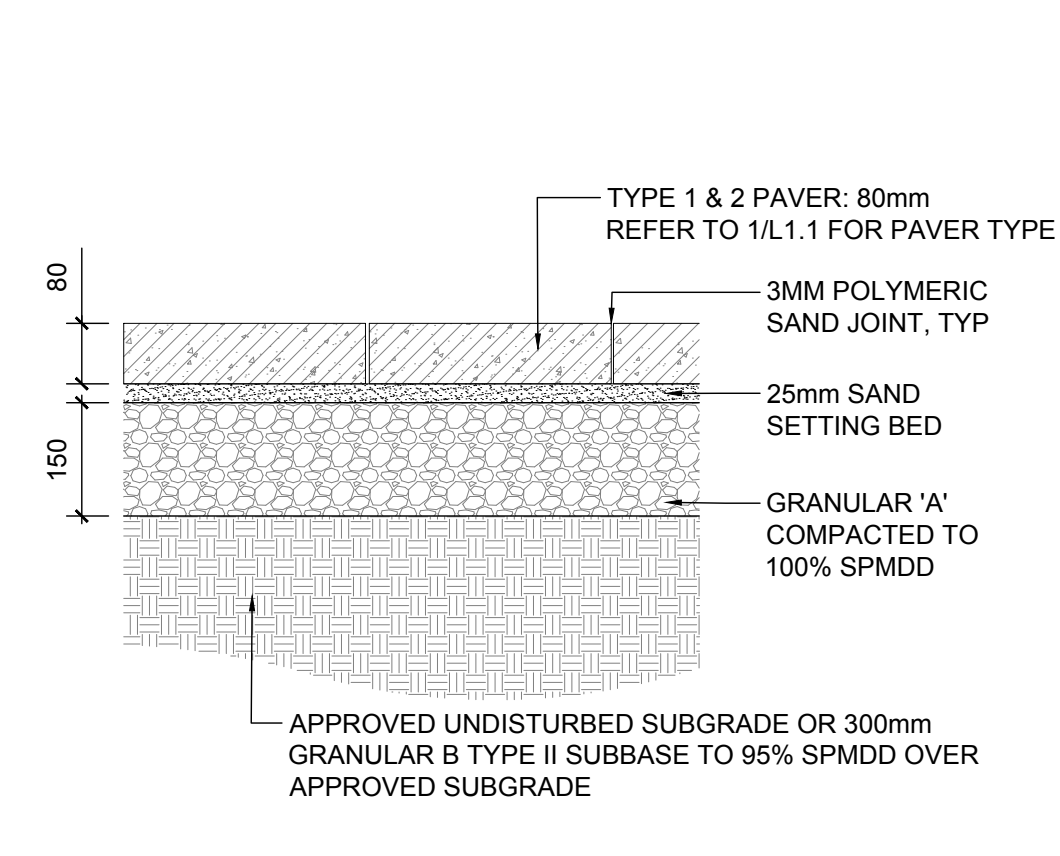

1 PRECAST CONCRETE PAVERS  
SCALE 1:10

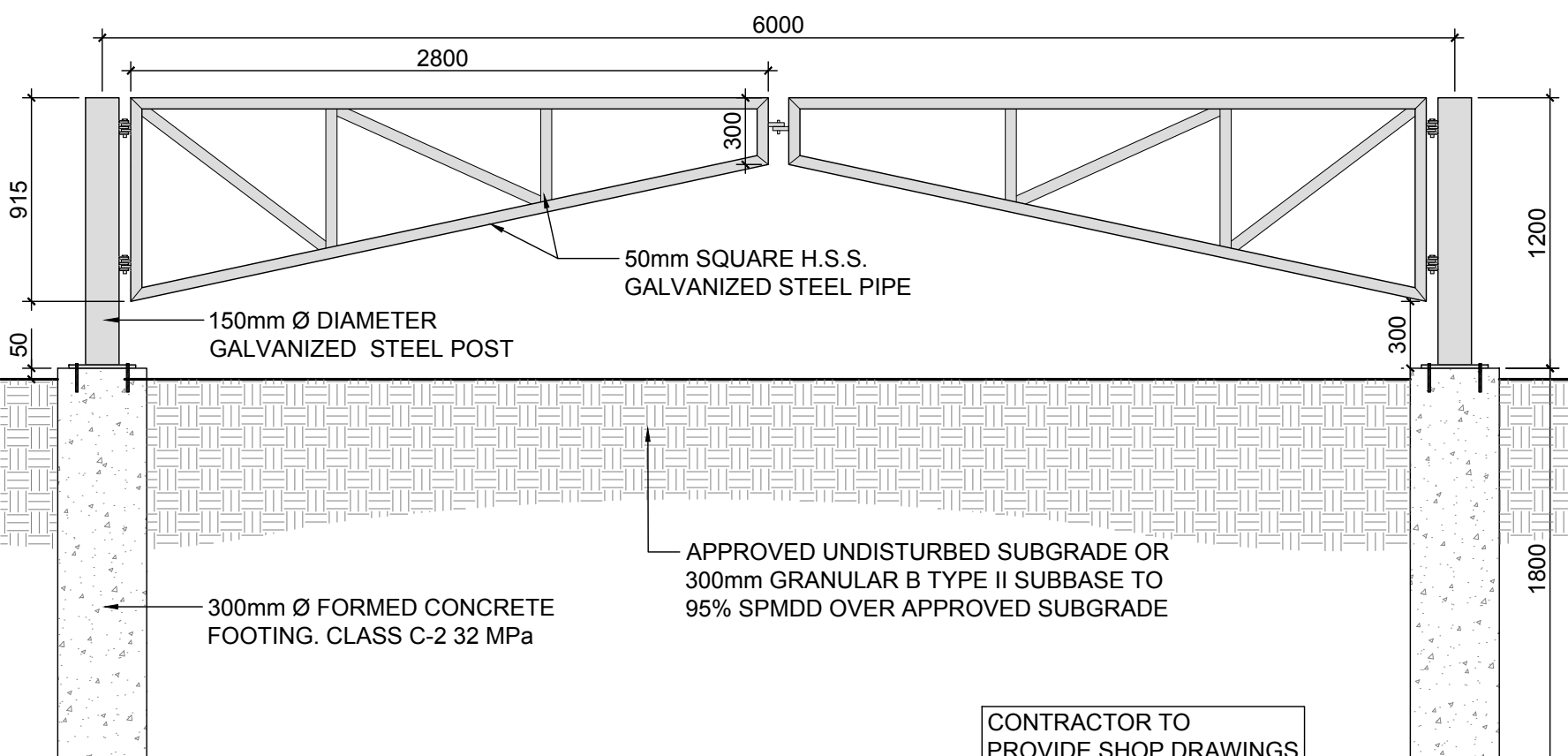

2 ACCESS GATE  
SCALE 1:30

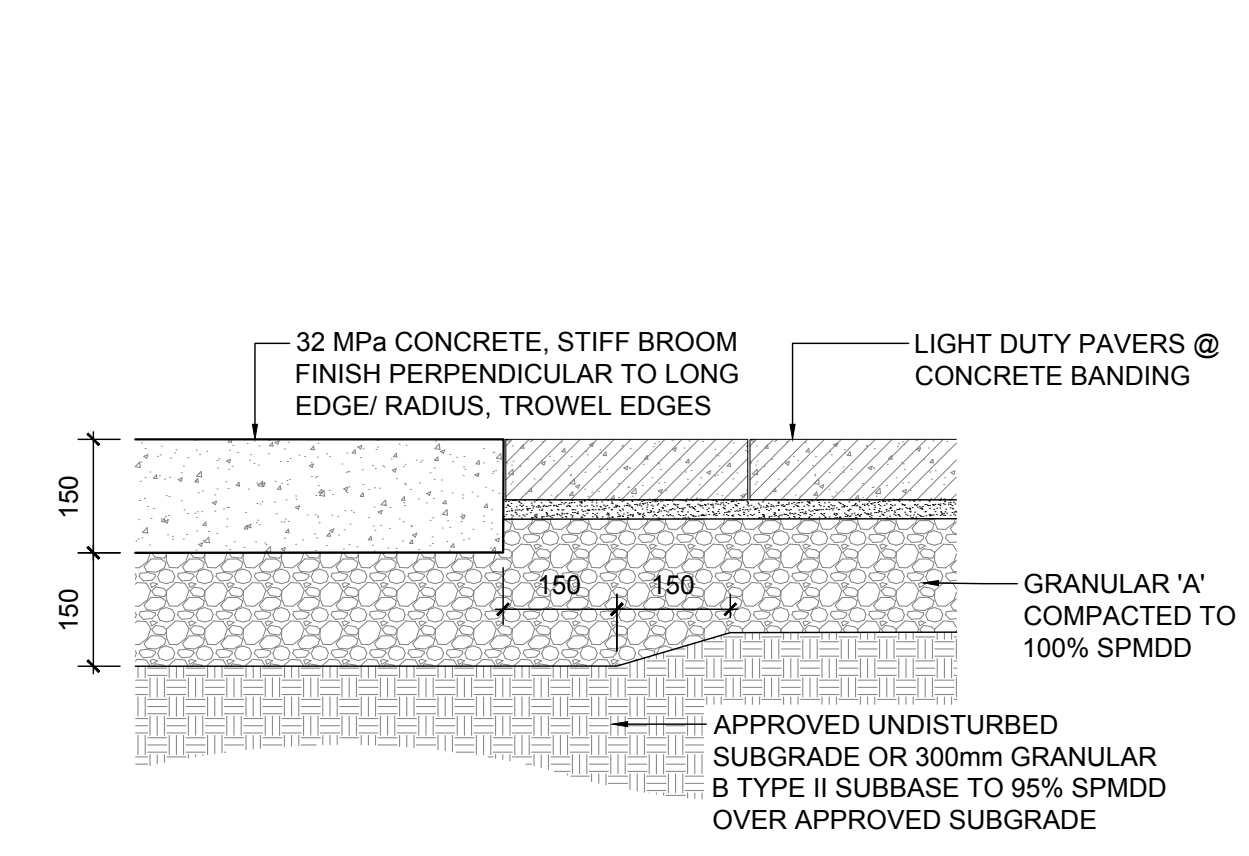

3 CONCRETE PAVING @ PRECAST CONCRETE PAVERS  
SCALE 1:10

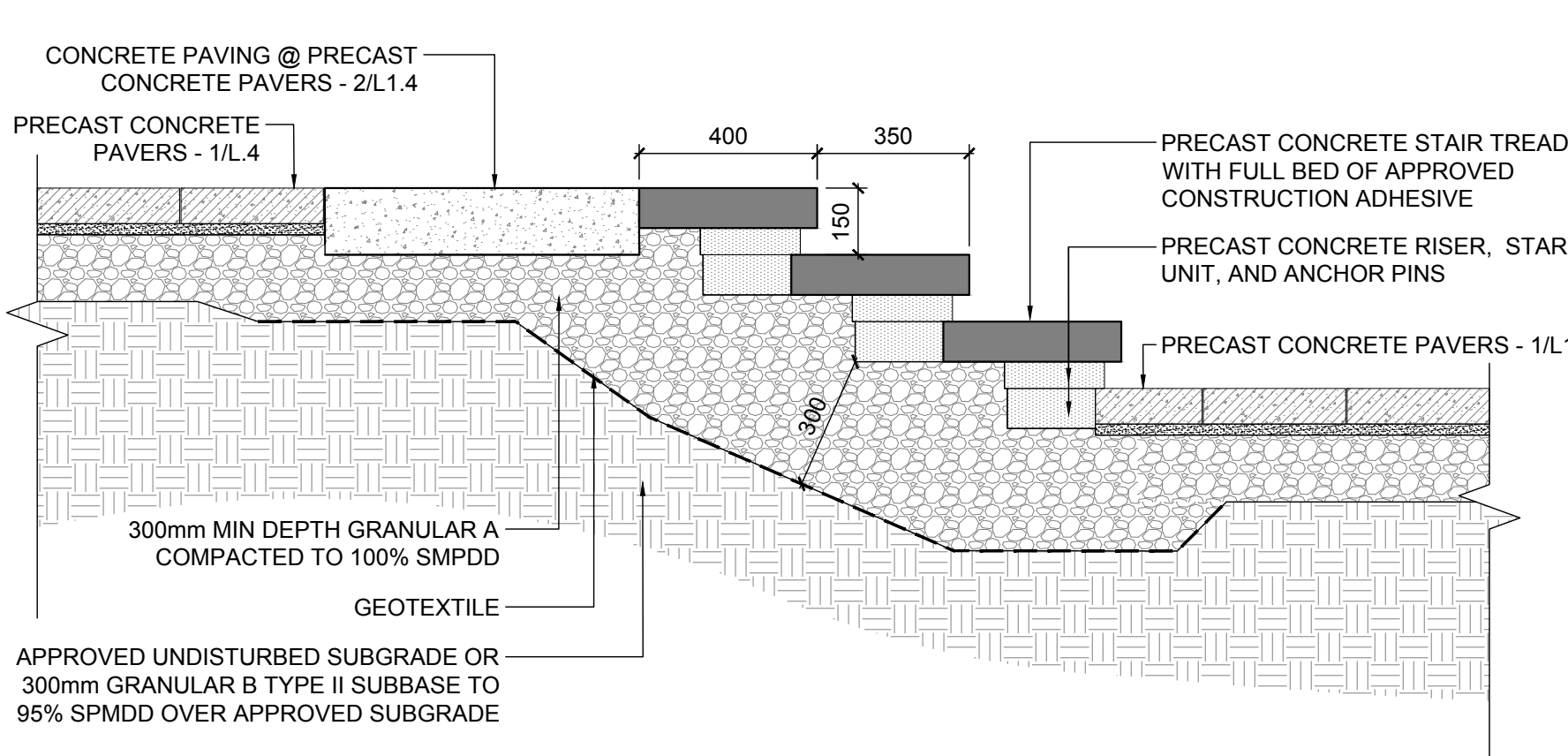

4 PRECAST STAIRS  
SCALE 1:15

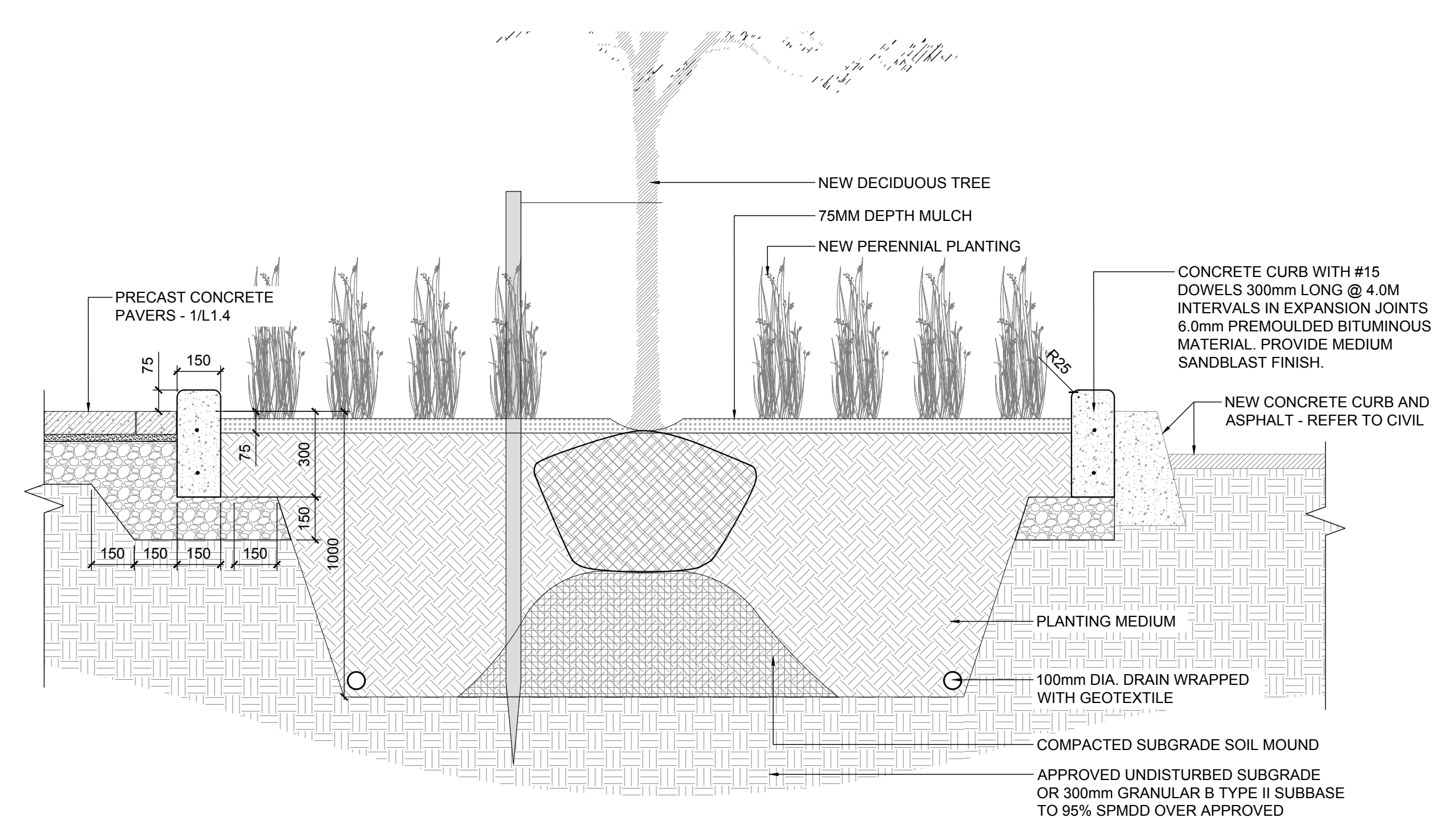

5 CURBED CONCRETE PLANTER  
SCALE 1:15

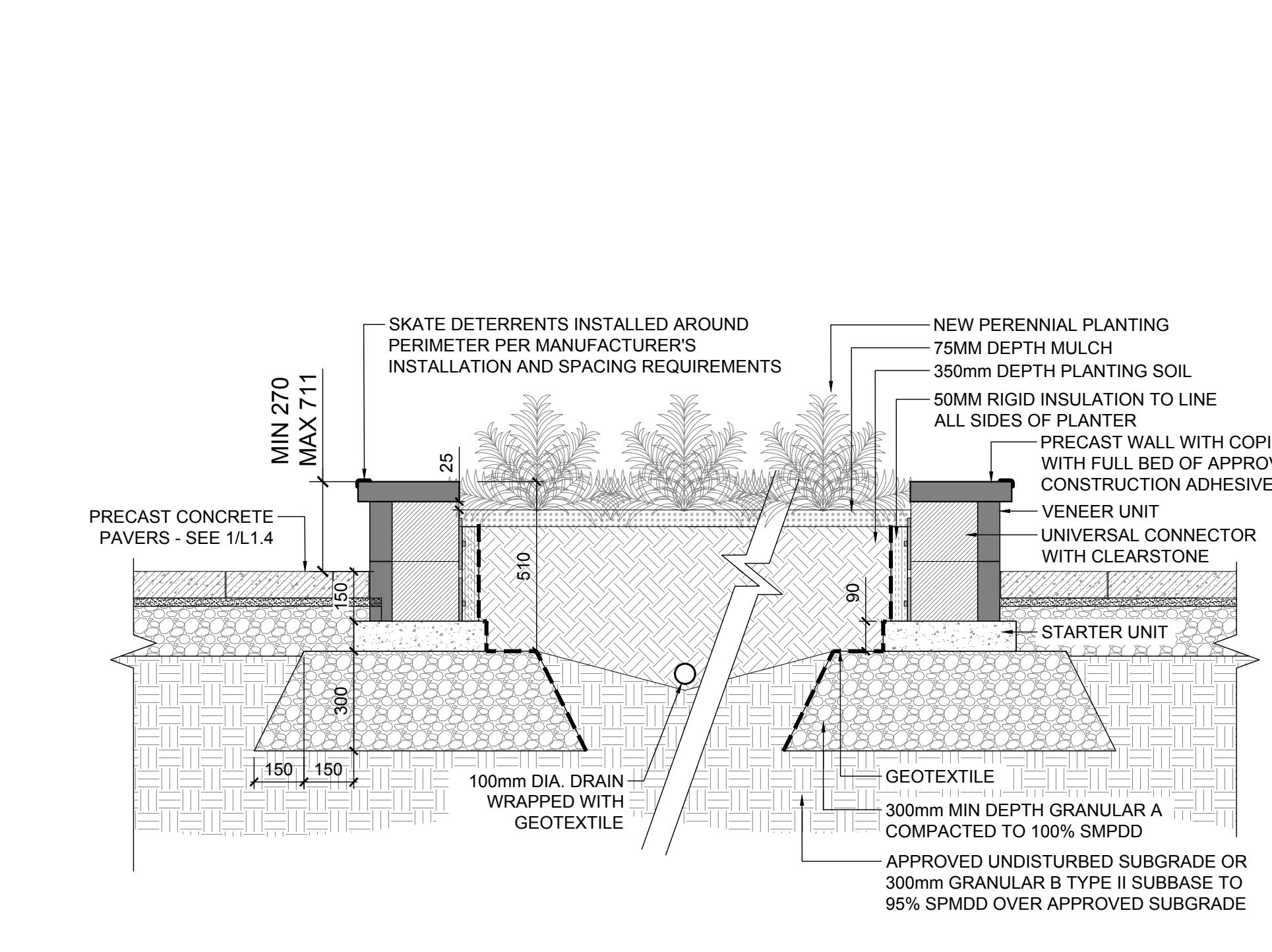

6 PRECAST CONCRETE PLANTER  
SCALE 1:15

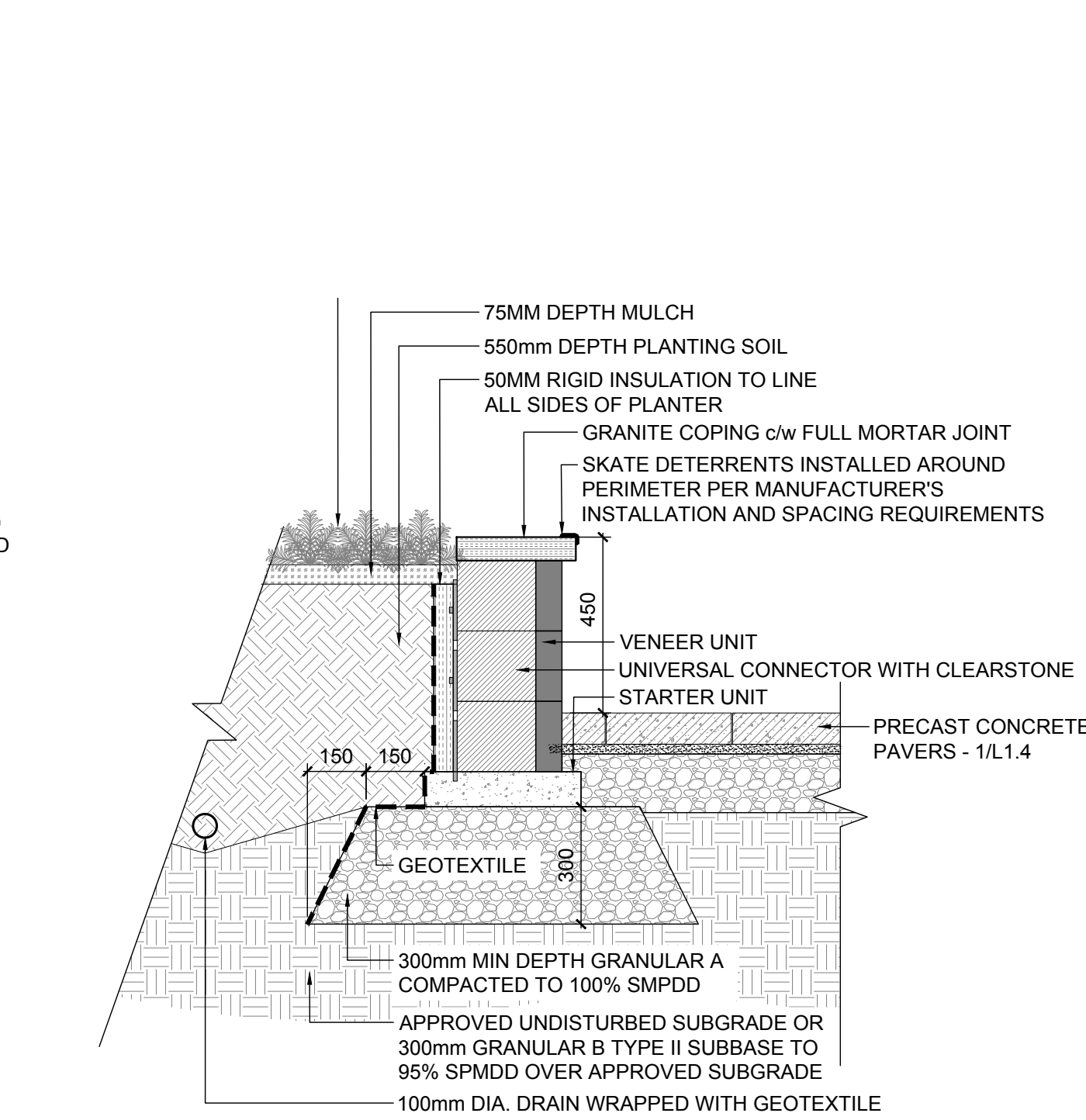

7 PRECAST CONCRETE SEAT WALL WITH GRANITE COPING  
SCALE 1:15

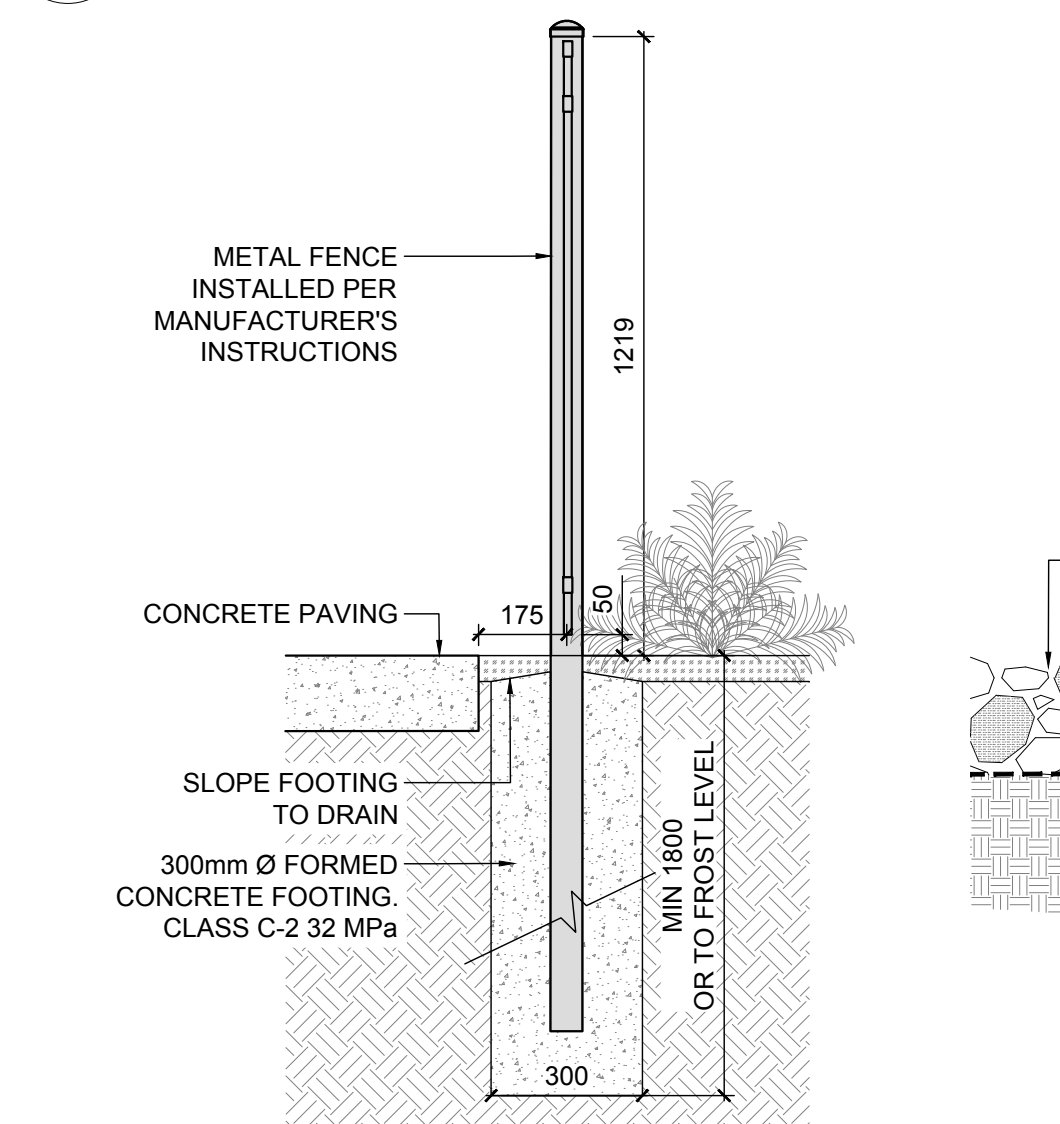

8 METAL FENCE  
SCALE 1:15

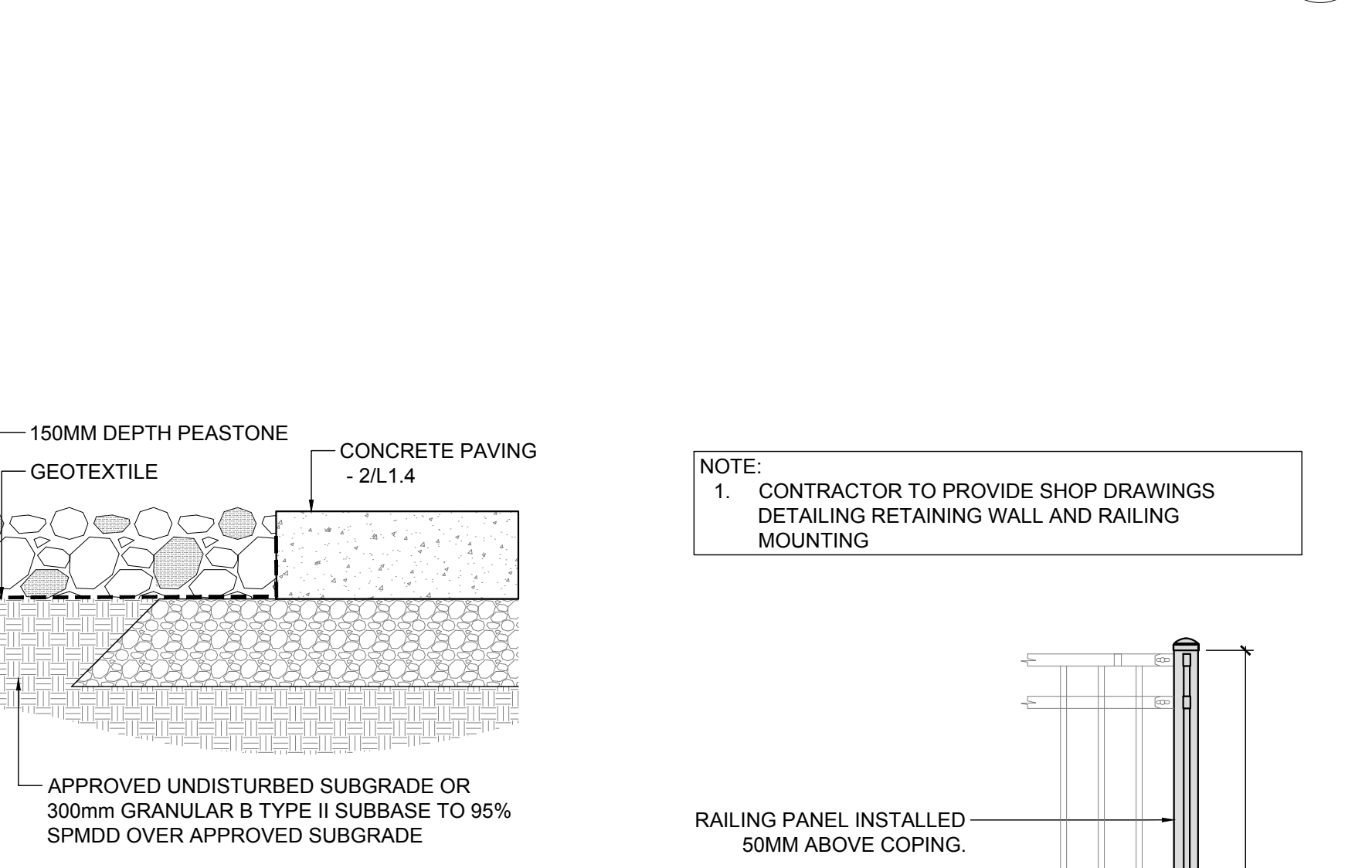

9 PEASTONE MULCH  
SCALE 1:10

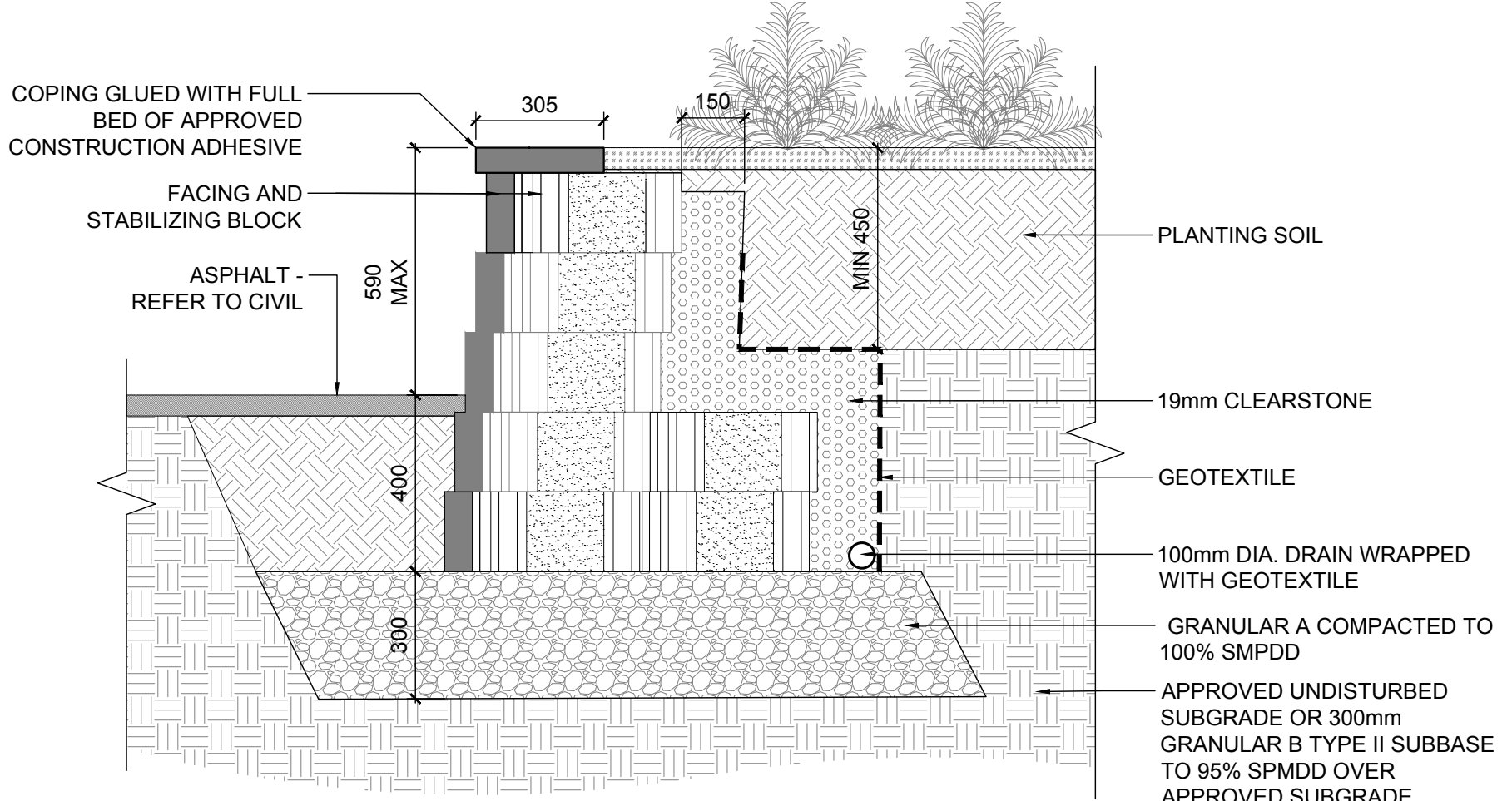

10 PRECAST CONCRETE RETAINING WALL  
SCALE 1:15

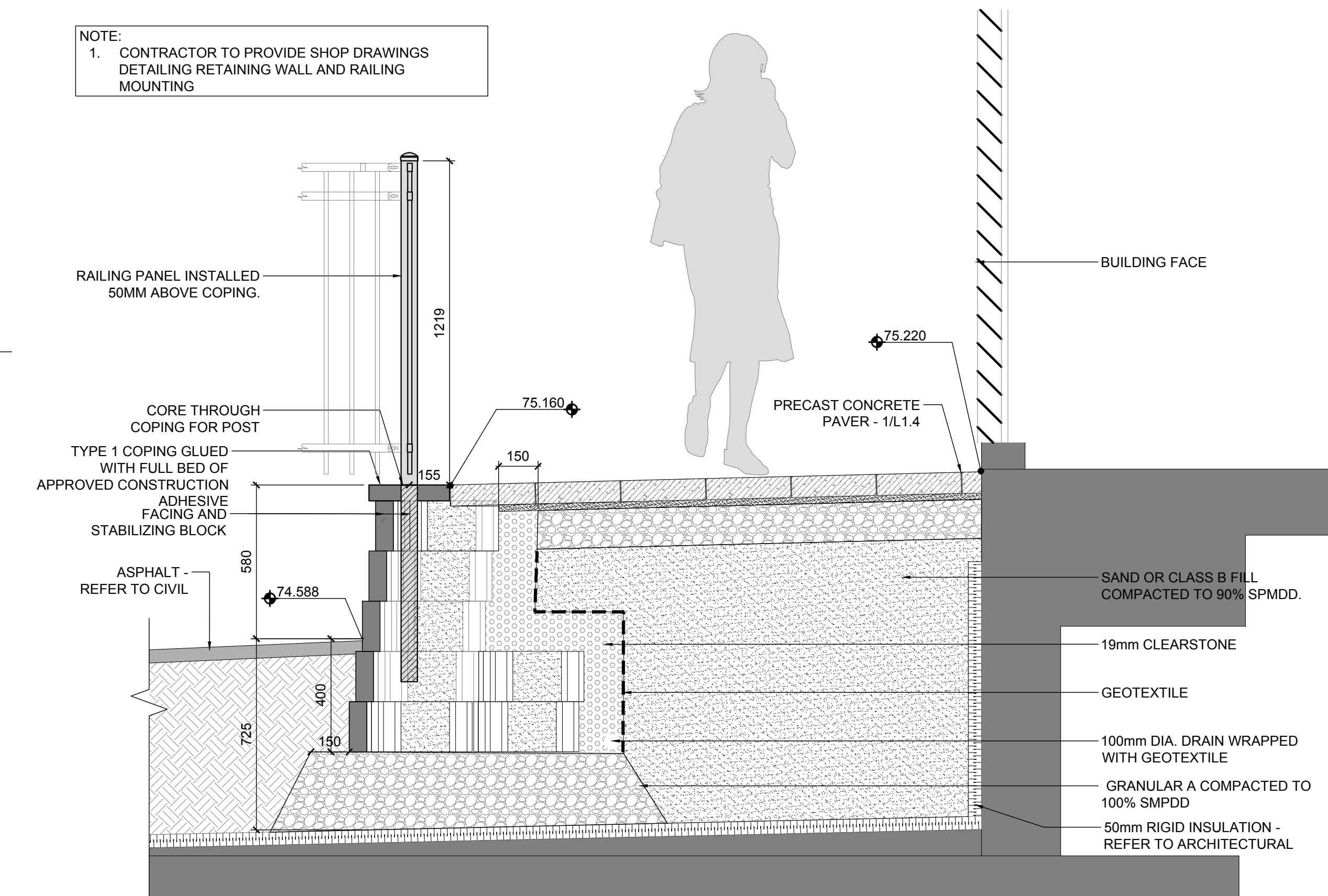

11 PRECAST CONCRETE RETAINING WALL WITH RAILING  
SCALE 1:15

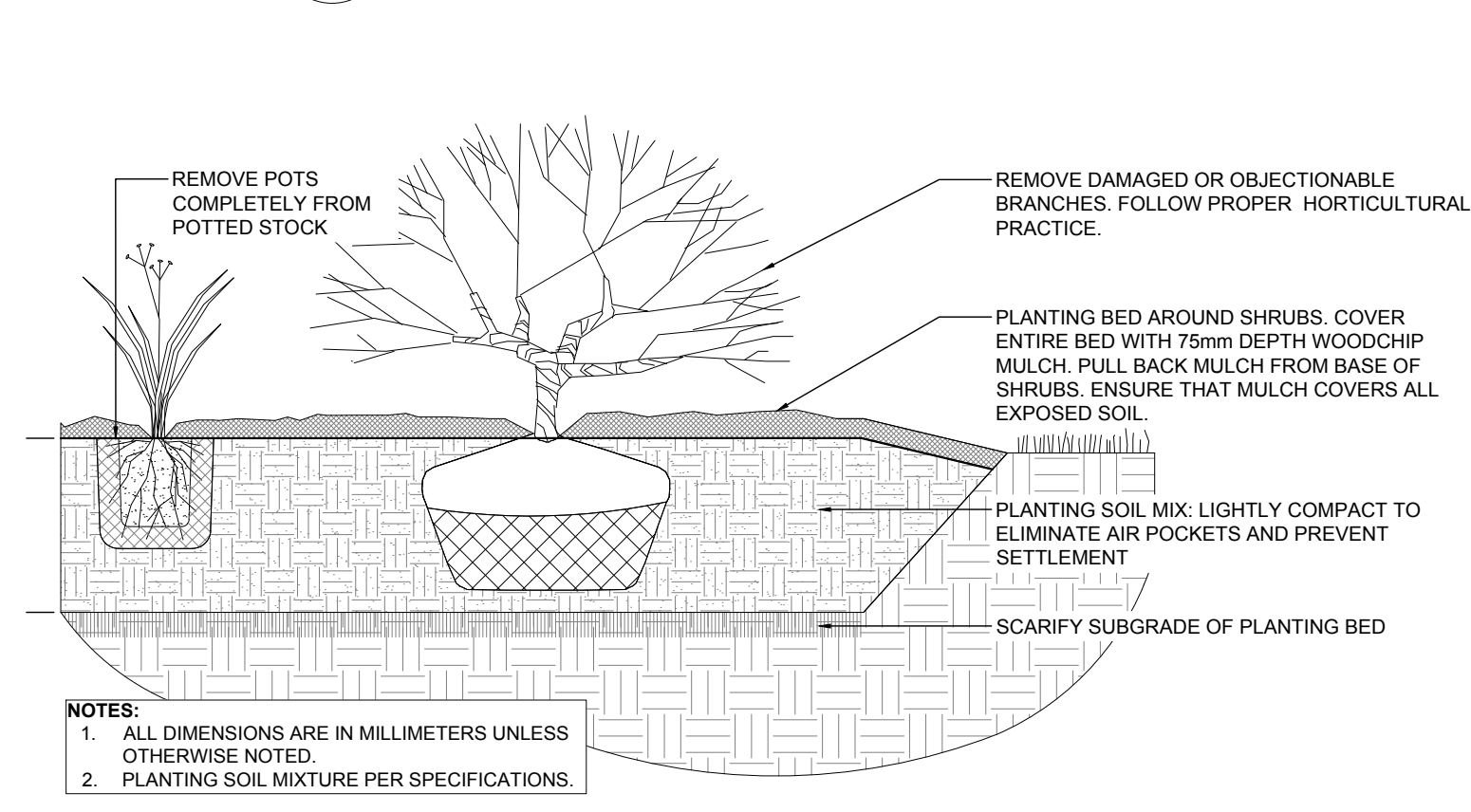

12 SHRUB/ PERENNIAL PLANTING  
SCALE: NTS

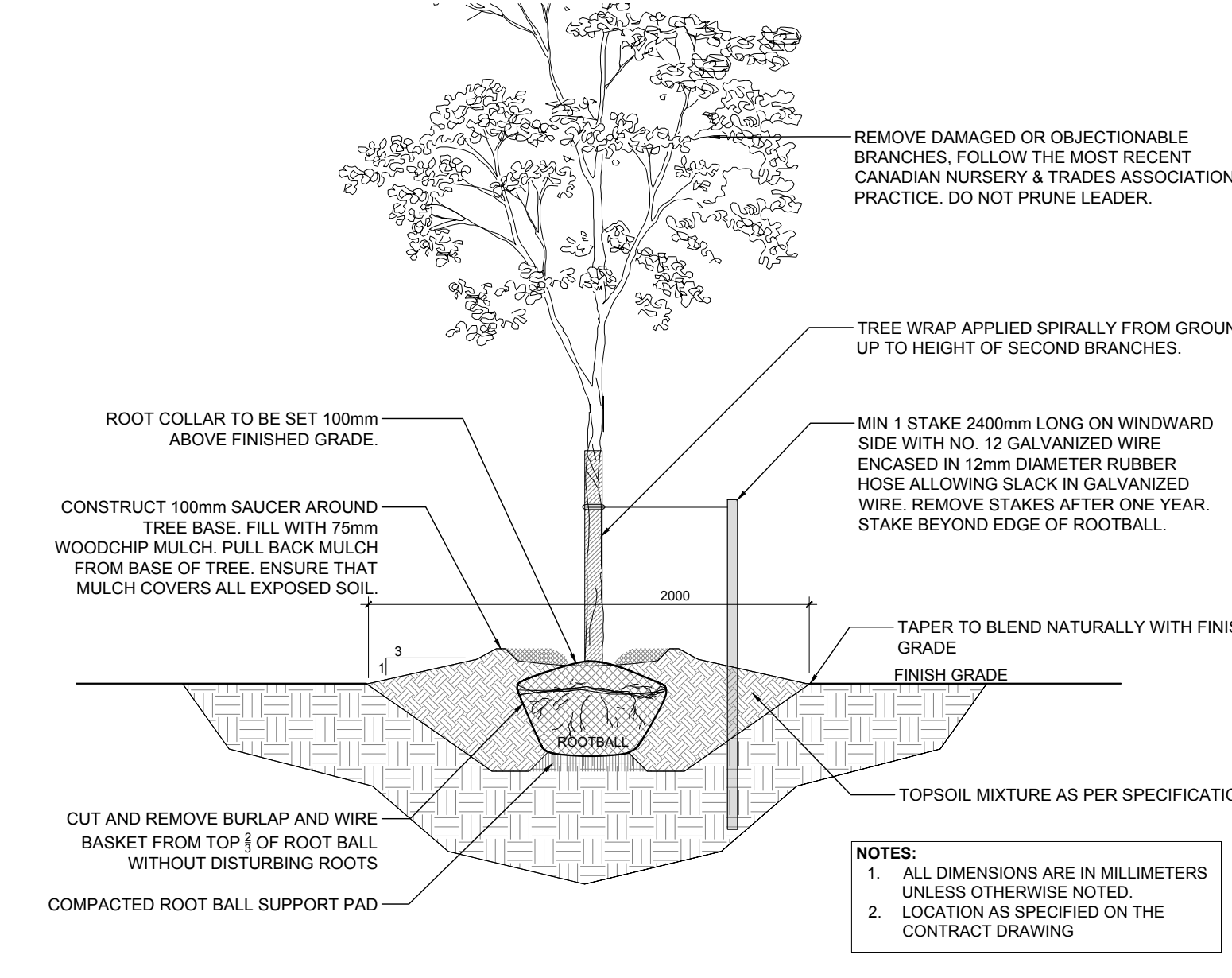

13 DECIDUOUS TREE PLANTING  
SCALE: NTS

10	REISSUED FOR SITE PLAN APPROVAL	15/05/2020	MK	JL
9	ISSUED FOR TENDER	14/04/2020	MK	JL
8	ISSUED FOR CLIENT REVIEW	06/02/2020	MK	JL
7	ISSUED FOR COORDINATION	20/11/2019	MK	JL
6	REISSUED FOR SITE PLAN APPROVAL	03/21/2019	LC	JL
5	REVISED AS PER CITY COMMENTS	07/19/2019	LC	JL
4	REISSUED FOR SITE PLAN APPROVAL	03/21/2019	LC	JL
3	ISSUED FOR DISCUSSION AND REVIEW	03/15/2019	LC	JL
2	ISSUED FOR DISCUSSION AND REVIEW	03/07/2019	LC	JL
1	ISSUED FOR SPc	10/30/2018	SS	JL
No.	Issue	Date	DR	CK

**JAMES B. LENNOX & ASSOCIATES INC.**  
**LANDSCAPE ARCHITECTS**  
3332 CARLING AVE. OTTAWA, ONTARIO K2H 5A8  
Tel. (613) 722-5168 Fax. 1(866) 343-3942

PROJECT

WESTGATE - PHASE I

1309 CARLING AVENUE, OTTAWA ON

DRAWING

GROUND FLOOR  
LANDSCAPE - DETAILS

STAMP

SCALE

AS SHOWN

START DATE

SEPT 2018

PROJECT NO.

DRAWING NO.

L1.4

PLOT SIZE ISO-B1



- GENERAL NOTES:
- IT IS THE RESPONSIBILITY OF THE APPROPRIATE CONTRACTOR OR OFFICIAL TO REPORT ANY ERRORS, OMISSIONS OR DISCREPANCIES ON THIS PLAN WITH ACTUAL SITE CONDITIONS TO THE LANDSCAPE ARCHITECT BEFORE PROCEEDING WITH CONSTRUCTION.
  - THE CONTRACTOR IS TO NOTIFY ALL UTILITY COMPANIES AND AUTHORITIES PRIOR TO ANY EXCAVATION AND ASCERTAIN LOCATIONS OF UNDERGROUND SERVICES.
  - THE CONTRACTOR IS TO REINSTATE ALL AREAS AND ITEMS DAMAGED AS A RESULT OF CONSTRUCTION ACTIVITY.
  - THE CONTRACTOR IS TO COMPLY WITH ALL PERTINENT CODES AND BY-LAWS.
  - THE CONTRACTOR IS TO MAINTAIN A POSITIVE SURFACE RUN-OFF THROUGHOUT THE ENTIRE CONSTRUCTION PERIOD.
  - THE LANDSCAPE ARCHITECT IS NOT RESPONSIBLE FOR SUBSURFACE CONDITIONS.
  - THE CONTRACTOR IS TO IDENTIFY ALL EXISTING TREES TO REMAIN ON SITE WITH THE LANDSCAPE ARCHITECT PRIOR TO CONSTRUCTION.
  - THE CONTRACTOR IS TO STAKE THE PROPOSED LOCATION OF ALL PLANT MATERIAL IN CONJUNCTION WITH THE LANDSCAPE ARCHITECT PRIOR TO EXCAVATION.
  - MINIMUM DISTANCES FOR SELECTED DECIDUOUS TREES ARE AS FOLLOWS:  
- BUILDING FOUNDATIONS 7.5M  
- SIDEWALKS 1.5M  
- PUBLIC STREETS 2.5M  
- UNDERGROUND INFRASTRUCTURE 2.0M
  - ALL TREES WITHIN 1M OF UNDERGROUND UTILITY TRENCHES ARE TO BE EXCAVATED BY HAND.
  - REMOVE ALL PROTECTIVE WRAPPING FROM TREE TRUNKS AFTER INSTALLATION.
  - ENSURE THAT MULCH IS PULLED BACK A MIN. DISTANCE OF 75MM FROM BASE OF TREE TRUNK.
  - TRANSPLANTED TREES WILL REQUIRE WATERING FOR 2 YEARS FOLLOWING TRANSPLANTATION.
  - COMPENSATION IS REQUIRED FOR THE REMOVAL OF THE TWO HEALTHY CITY OWNED GRAPPLES LOCATED ALONG MERVILLE RD. (THERE IS NO COMPENSATION REQUIRED FOR THE DEAD GRAPPLES). COMPENSATION HAS BEEN CALCULATED IN THE AMOUNT OF \$1,200. ONCE COMPENSATION HAS BEEN RECEIVED FORESTRY WILL PROVIDE WRITTEN PERMISSION TO HAVE THE TREES REMOVED.

No.	Issue	Date	By
10	REISSUED FOR SITE PLAN APPROVAL	15/05/2020	MK JL
9	ISSUED FOR TENDER	14/04/2020	MK JL
8	ISSUED FOR CLIENT REVIEW	06/02/2020	MK JL
7	ISSUED FOR COORDINATION	20/11/2019	MK JL
6	REISSUED FOR SITE PLAN APPROVAL	03/21/2019	LC JL
5	REVISED AS PER CITY COMMENTS	07/19/2019	LC JL
4	REISSUED FOR SITE PLAN APPROVAL	03/21/2019	LC JL
3	ISSUED FOR DISCUSSION AND REVIEW	03/15/2019	LC JL
2	ISSUED FOR DISCUSSION AND REVIEW	03/07/2019	LC JL
1	ISSUED FOR SPC	10/30/2018	SS JL
		Date	By
No.	Issue	Date	By

**JAMES B. LENNOX & ASSOCIATES INC.**  
**LANDSCAPE ARCHITECTS**  
3332 CARLING AVE. OTTAWA, ONTARIO K2H 5A8  
Tel. (613) 722-5168 Fax. (613) 722-5168

PROJECT  
WESTGATE - PHASE I  
  
1309 CARLING AVENUE, OTTAWA ON

DRAWING  
  
AMENITY TERRACE  
LANDSCAPE PLAN

STAMP	SCALE
	AS SHOWN
	START DATE SEPT 2018
	PROJECT NO.

PROJECT NORTH	DRAWING NO.
	<b>L2.1</b>
	PLOT SIZE ISO-B1

**PROPOSED PLANT LIST - AMENITY TERRACE**

KEY	QTY	BOTANICAL NAME	COMMON NAME	SCHED. SIZE	CONDITION	SPACING
<b>SHRUBS</b>						
Ha	10	<i>Hydrangea arborescens 'Annabelle'</i>	Annabelle Hydrangea	60cm ht.	Potted	800 mm
Sc	16	<i>Symphoricarpos chenaulti</i>	Hancock Coralberry	6cm ht.	Potted	800 mm
<b>PERENNIALS/ GRASSES/ VINES</b>						
ca	66	<i>Calamagrostis acutiflora 'Karl Foerster'</i>	Karl Foerster Feather Reed Grass	25cm pot	Potted	400 mm
hu	42	<i>Hosta undulata 'Alba Marginata'</i>	Variegated White Hosta	15cm pot	Potted	400 mm
pa	42	<i>Phalaris arundinacea 'Strawberries &amp; Cream'</i>	Strawberries & Cream Ribbon Grass	25cm pot	Potted	400 mm
pls	12	<i>Perovskia x 'Little Spire'</i>	Little Spire Russian Sage	15cm pot	Potted	400 mm
pq	12	<i>Parthenocissus quinquefolia</i>	Virginia Creeper	15cm pot	Potted	400 mm
sa	32	<i>Sedum 'Autumn Joy'</i>	Autumn Joy Sedum	15cm pot	Potted	400 mm

**LEGEND**

- HANDRAIL - REFER TO ARCHITECTURAL
- PRECAST CONCRETE PLANTER WALL
- BOCCE BALL COURT BORDER
- PRECAST CONCRETE PAVERS - TYPE 3
- PRECAST CONCRETE PAVERS - TYPE 4
- PRECAST CONCRETE PAVERS - TYPE 5
- PRECAST CONCRETE PAVERS - TYPE 3 (330x330)
- ARTIFICIAL TURF
- BARBEQUES
- TABLE AND BAR STOOLS
- CAFE TABLE AND STOOLS
- SECTIONAL
- ADIRONDACK CHAIR
- HEATER
- PLANTER
- SHRUBS/ PERENNIALS
- MESH PLUMBING VENT COVER
- LIGHT POST FOR CATENARY LIGHT SYSTEM
- ROOF DRAIN - REFER TO MECHANICAL
- HOSE BIB - REFER TO MECHANICAL
- GAS FEED - REFER TO MECHANICAL
- PROVIDE IRRIGATION TO ALL PLANTING BEDS/ PLANTERS
- 1" IRRIGATION STUB TO OUTSIDE WALL - LOCATION TO BE CONFIRMED ON SITE AND APPROVED BY CONSULTANT

**LIGHTING LEGEND (REFER TO ELECTRICAL)**

- AT GRADE RECESSED CONTINUOUS PATH LIGHT
- CATENARY LIGHT STRING
- RECESSED WALL LIGHT (DOWN WASH) MOUNTED AT 600mm HT, 1200mm SPACING

**2 CHESS BOARD PAVING PATTERN**  
SCALE 1:10

- TYPE 3 PAVER GREYED NICKLE (50% INTERIOR)
- TYPE 3 PAVER ONYX BLACK (50% INTERIOR)
- TYPE 3 PAVER ONYX BLACK (100% BORDER)

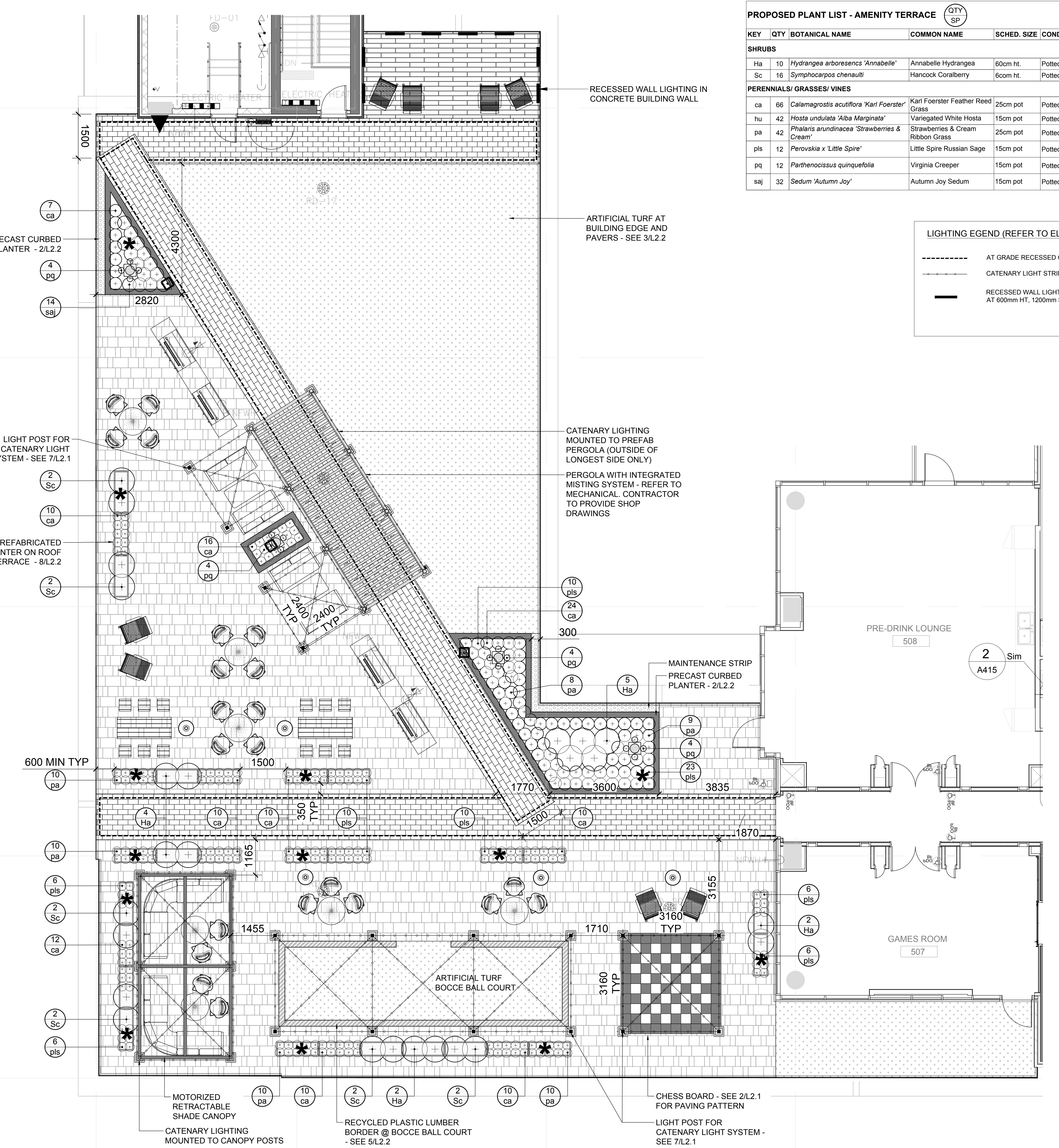

**1 AMENITY TERRACE LANDSCAPE PLAN**  
SCALE 1:60

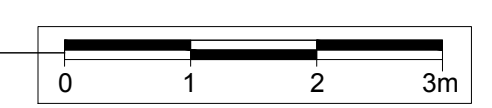

**2 CHESS BOARD PAVING PATTERN**  
SCALE 1:10



- IT IS THE RESPONSIBILITY OF THE APPROPRIATE CONTRACTOR OR OFFICIAL TO REPORT ANY ERRORS, OMISSIONS OR DISCREPANCIES ON THIS PLAN WITH ACTUAL SITE CONDITIONS TO THE LANDSCAPE ARCHITECT BEFORE PROCEEDING WITH CONSTRUCTION.
- THE CONTRACTOR IS TO NOTIFY ALL UTILITY COMPANIES AND AUTHORITIES PRIOR TO ANY EXCAVATION AND ASCERTAIN LOCATIONS OF UNDERGROUND SERVICES.
- THE CONTRACTOR IS TO REINSTATE ALL AREAS AND ITEMS DAMAGED AS A RESULT OF CONSTRUCTION ACTIVITY.
- THE CONTRACTOR IS TO COMPLY WITH ALL PERTINENT CODES AND BY-LAWS.
- THE CONTRACTOR IS TO MAINTAIN A POSITIVE SURFACE RUN-OFF THROUGHOUT THE ENTIRE CONSTRUCTION PERIOD.
- THE LANDSCAPE ARCHITECT IS NOT RESPONSIBLE FOR SUBSURFACE CONDITIONS.
- THE CONTRACTOR IS TO IDENTIFY ALL EXISTING TREES TO REMAIN ON SITE WITH THE LANDSCAPE ARCHITECT PRIOR TO CONSTRUCTION.
- THE CONTRACTOR IS TO STAKE THE PROPOSED LOCATION OF ALL PLANT MATERIAL IN CONJUNCTION WITH THE LANDSCAPE ARCHITECT PRIOR TO EXCAVATION.
- MINIMUM DISTANCES FOR SELECTED DECIDUOUS TREES ARE AS FOLLOWS:
  - BUILDING FOUNDATIONS 7.5M
  - SIDEWALKS 1.5M
  - PUBLIC STREETS 2.5M
  - UNDERGROUND INFRASTRUCTURE 2.0M
- ALL TREES WITHIN 1M OF UNDERGROUND UTILITY TRENCHES ARE TO BE EXCAVATED BY HAND.
- REMOVE ALL PROTECTIVE WRAPPING FROM TREE TRUNKS AFTER INSTALLATION.
- ENSURE THAT MULCH IS PULLED BACK A MIN. DISTANCE OF 75MM FROM BASE OF TREE TRUNK.
- TRANSPLANTED TREES WILL REQUIRE WATERING FOR 2 YEARS FOLLOWING TRANSPLANTATION.
- COMPENSATION IS REQUIRED FOR THE REMOVAL OF THE TWO HEALTHY CITY OWNED GRABAPLES LOCATED ALONG MERVALE RD. (THERE IS NO COMPENSATION REQUIRED FOR THE DEAD GRABAPPLE). COMPENSATION HAS BEEN CALCULATED IN THE AMOUNT OF \$1,200. ONCE COMPENSATION HAS BEEN RECEIVED FORESTRY WILL PROVIDE WRITTEN PERMISSION TO HAVE THE TREES REMOVED.

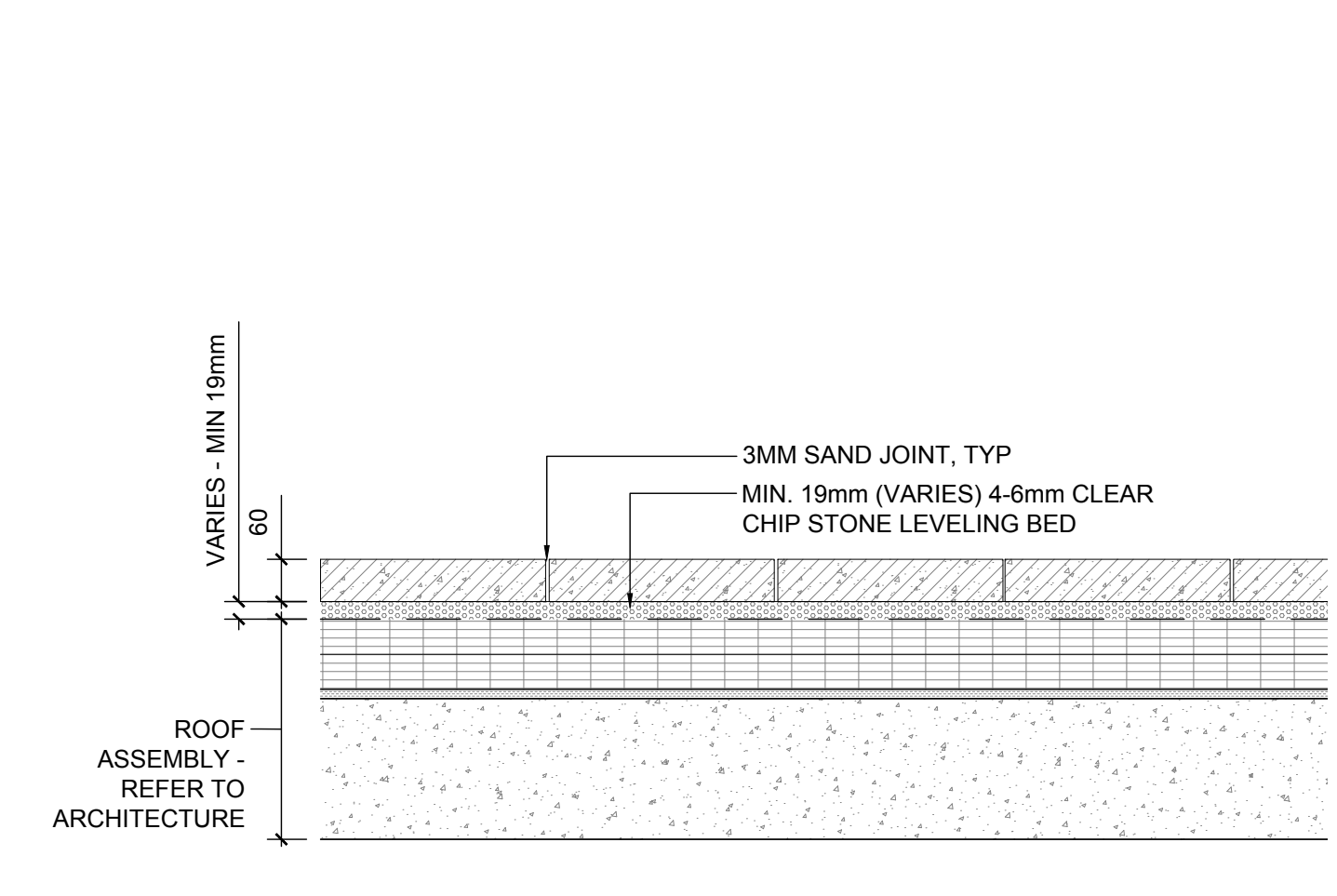

**1**  
L2.2 PRECAST CONCRETE PAVERS ON ROOF TERRACE  
SCALE 1:10

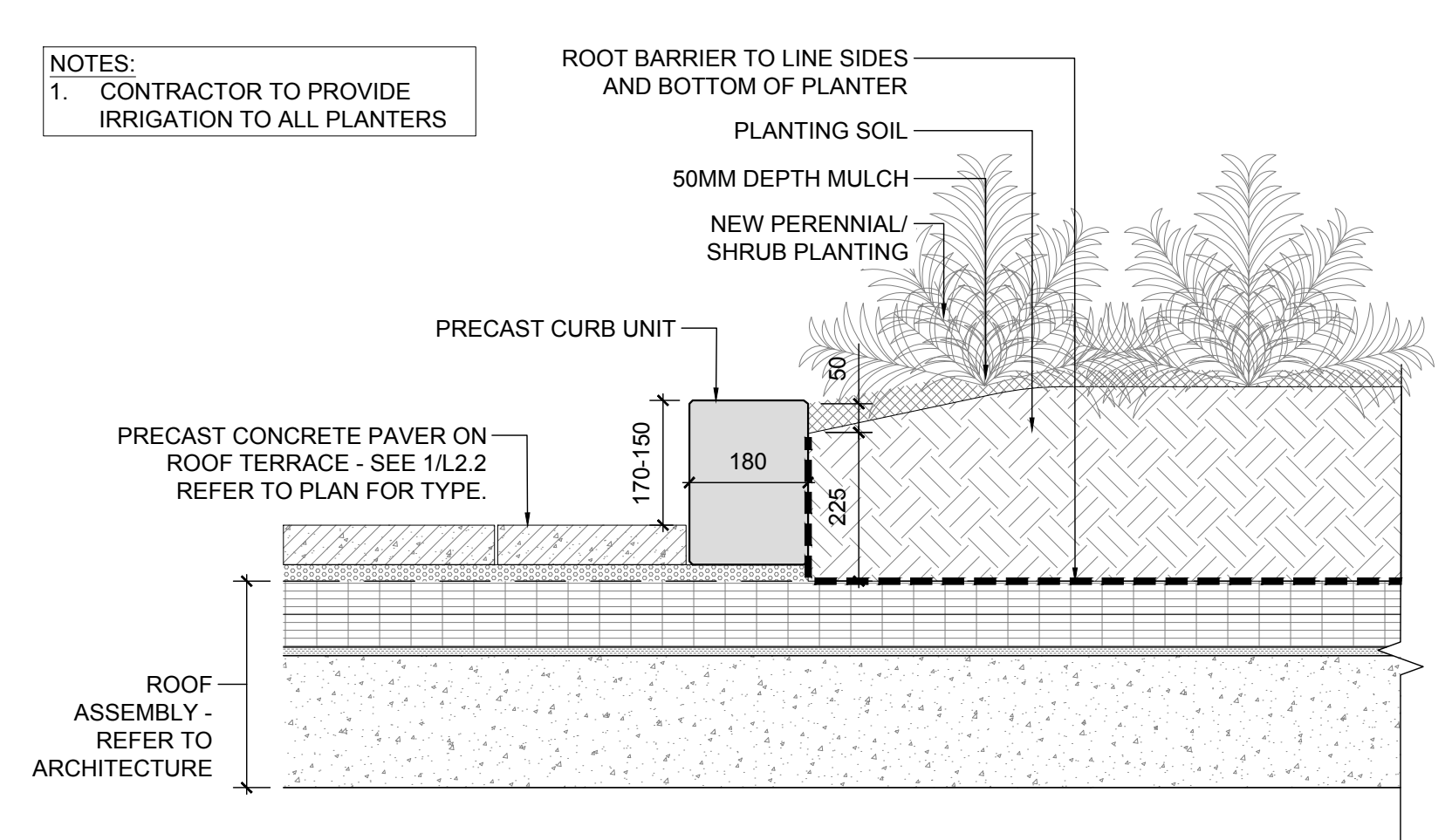

**2**  
L2.2 PRECAST CURBED PLANTER WALL ON ROOF TERRACE  
SCALE 1:10

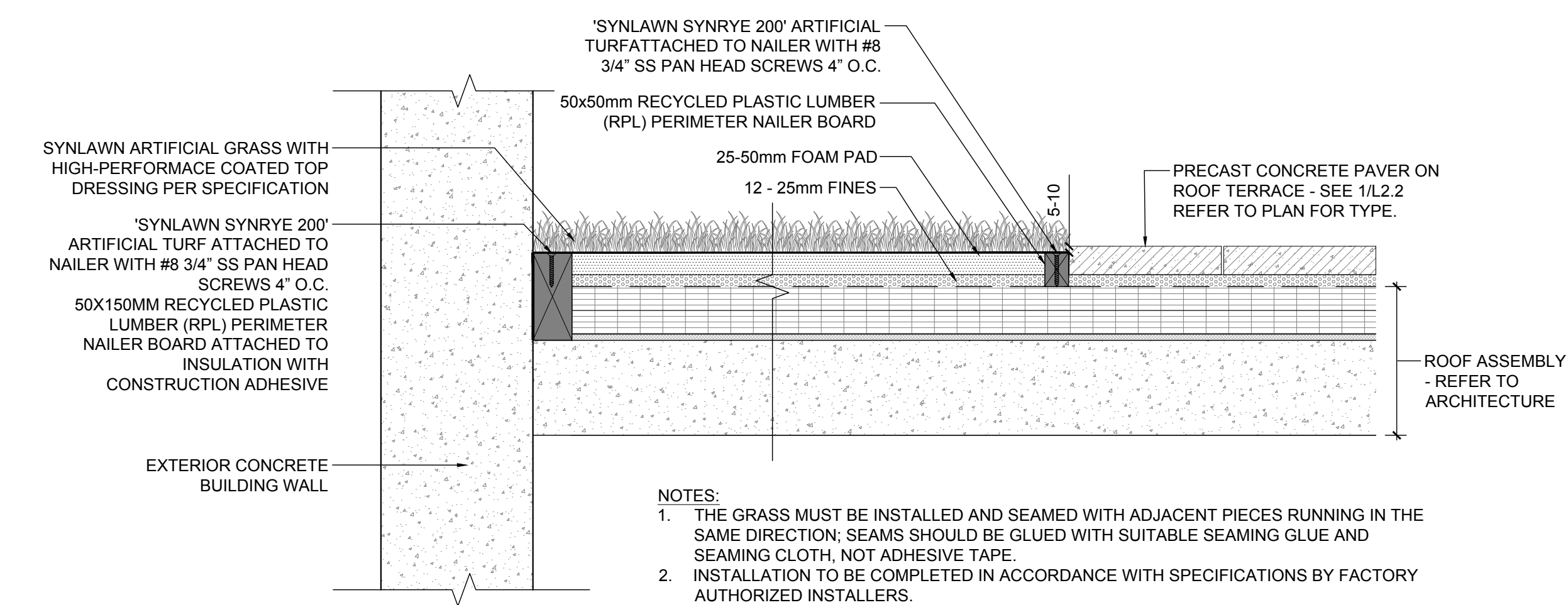

**3**  
L2.2 ARTIFICIAL TURF @ BUILDING EDGE AND PAVERS  
SCALE 1:10

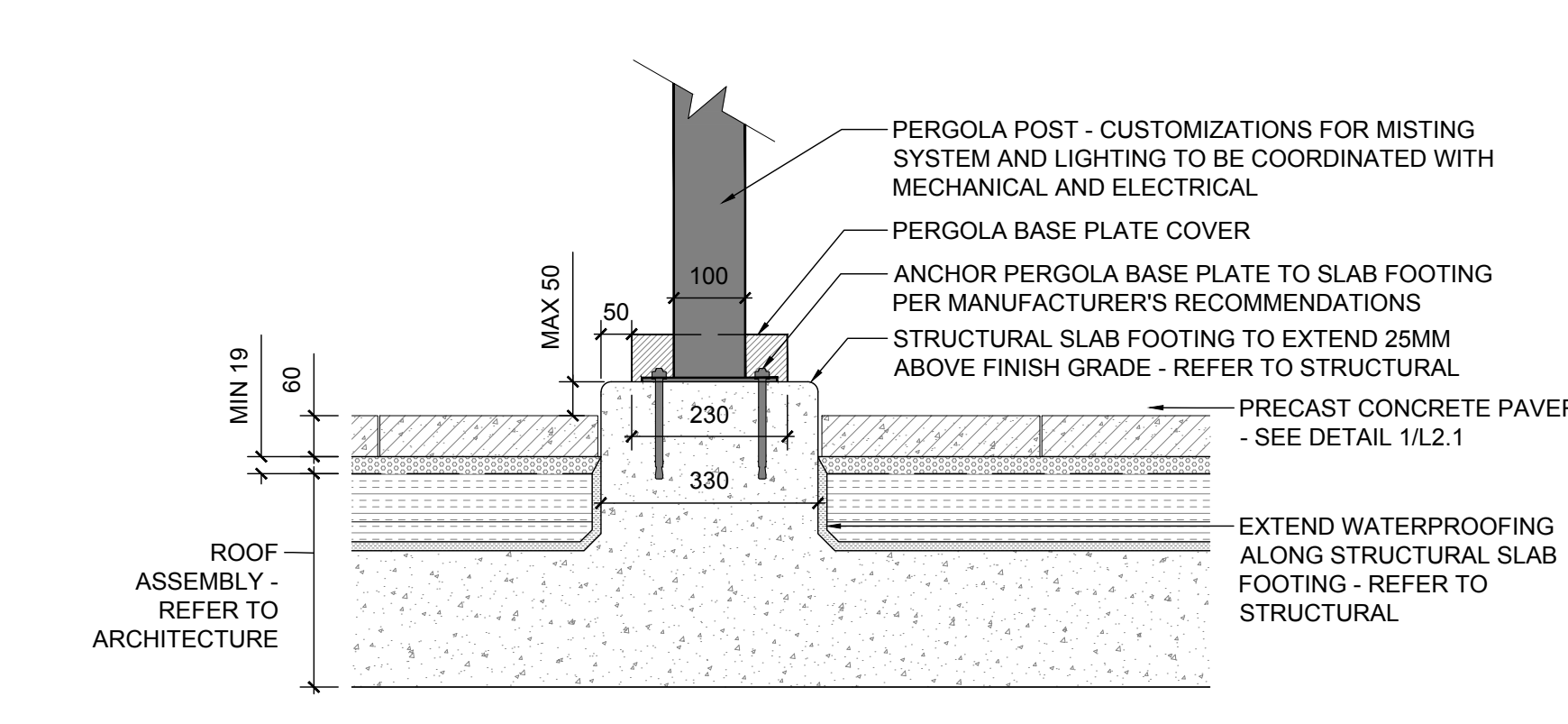

**4**  
L2.2 PERGOLA FOOTING  
SCALE 1:10

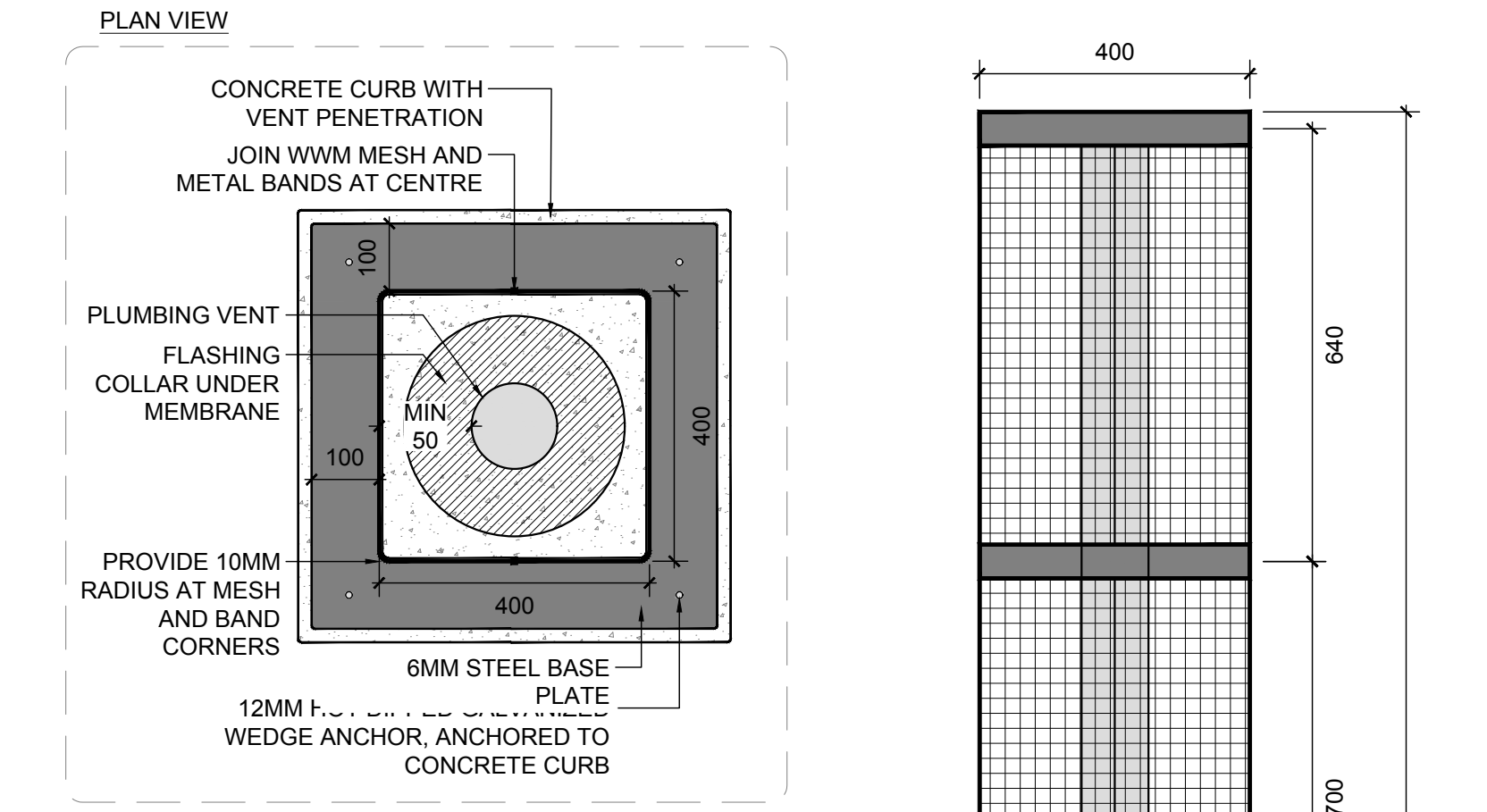

**5**  
L2.2 RECYCLED PLASTIC LUMBER BORDER @ BOCCIE BALL COURT  
SCALE 1:10

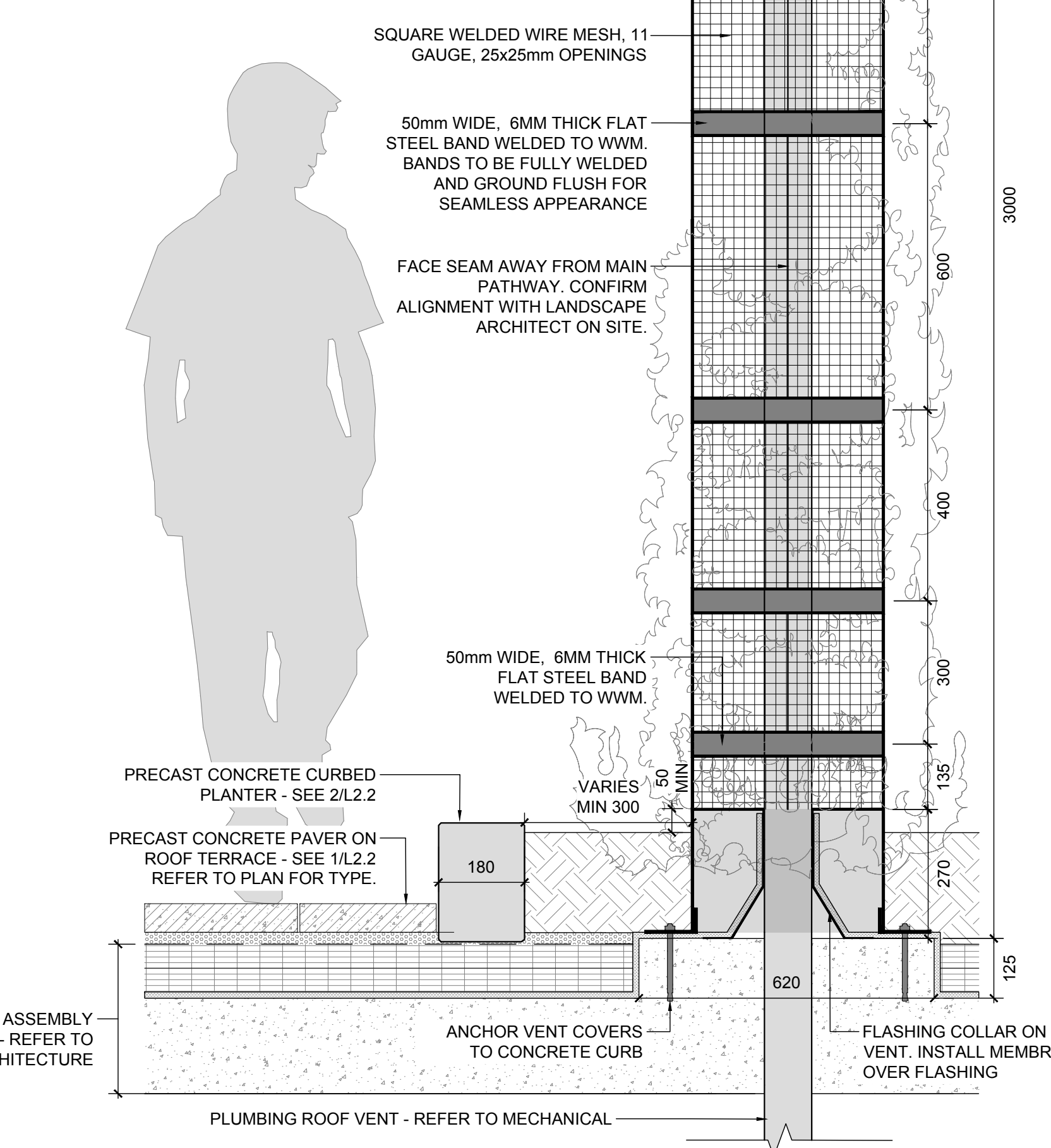

**6**  
L2.2 MESH PLUMBING VENT COVER  
SCALE 1:10

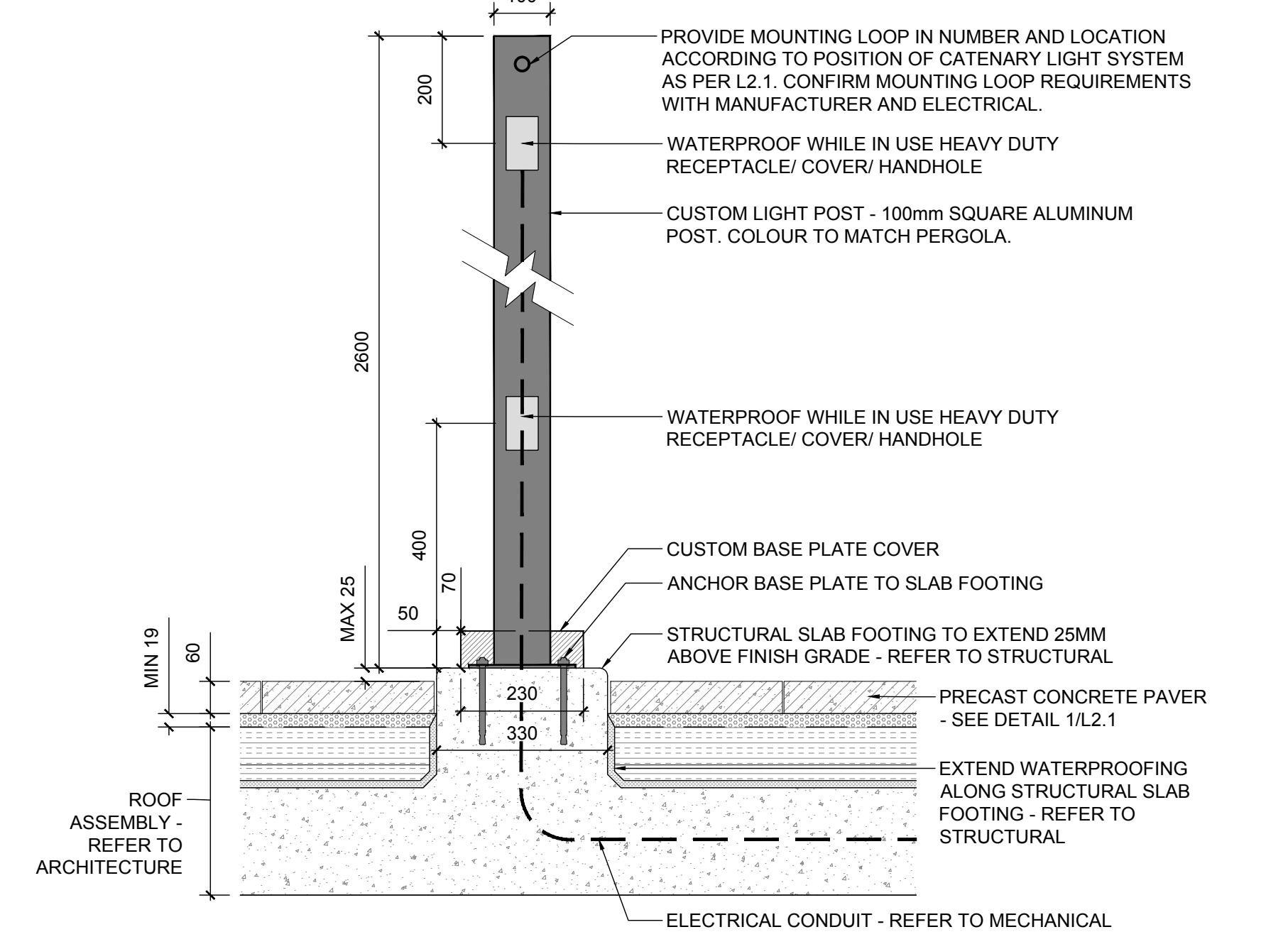

**7**  
L2.2 LIGHT POST FOR CATENARY LIGHT SYSTEM  
SCALE 1:10

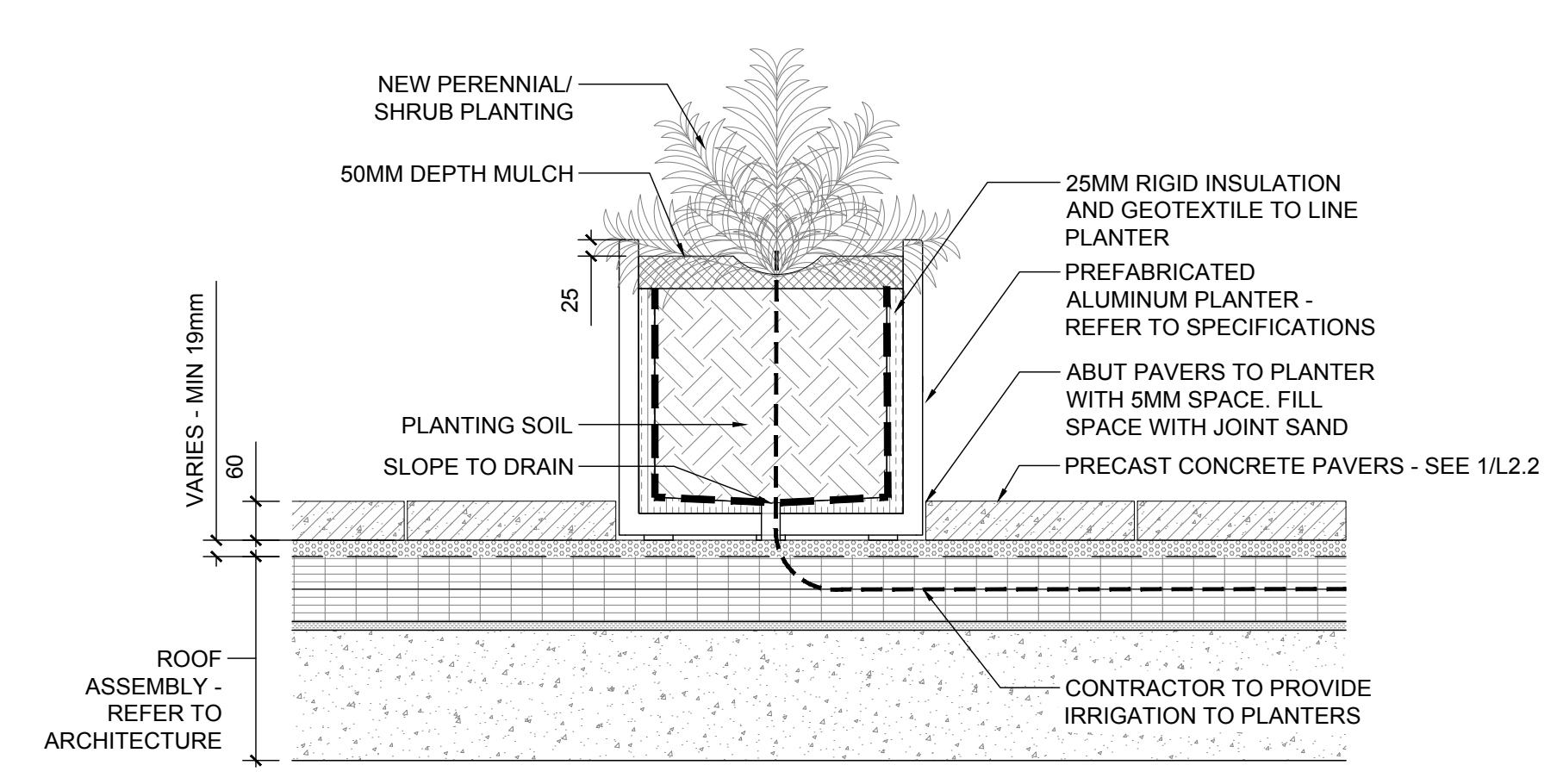

**8**  
L2.2 PREFABRICATED PLANTERS ON ROOF TERRACE  
SCALE 1:10

No.	Issue	Date	Author	Checked
10	REISSUED FOR SITE PLAN APPROVAL	15/05/2020	MK	JL
9	ISSUED FOR TENDER	14/04/2020	MK	JL
8	ISSUED FOR CLIENT REVIEW	06/02/2020	MK	JL
7	ISSUED FOR COORDINATION	20/11/2019	MK	JL
6	REISSUED FOR SITE PLAN APPROVAL	03/21/2019	LC	JL
5	REVISED AS PER CITY COMMENTS	07/19/2019	LC	JL
4	REISSUED FOR SITE PLAN APPROVAL	03/21/2019	LC	JL
3	ISSUED FOR DISCUSSION AND REVIEW	03/15/2019	LC	JL
2	ISSUED FOR DISCUSSION AND REVIEW	03/07/2019	LC	JL
1	ISSUED FOR SPK	10/30/2018	SS	JL
No.	Issue	Date	Author	Checked

**JAMES B. LENNOX & ASSOCIATES INC.**  
LANDSCAPE ARCHITECTS  
3332 CARLING AVE. OTTAWA, ONTARIO K2H 5A8  
Tel. (613) 722-5168 Fax. (613) 343-3942

PROJECT  
WESTGATE - PHASE I

1309 CARLING AVENUE, OTTAWA ON

DRAWING  
AMENITY TERRACE  
LANDSCAPE DETAILS

STAMP  
SCALE  
AS SHOWN

START DATE  
SEPT 2018

PROJECT NO.

PROJECT NORTH  
DRAWING NO.

**L2.2**

PLOT SIZE ISO-B1