

RUSSELL ROAD INDUSTRIAL DEVELOPMENT

OTTAWA, ON

PRELIMINARY LANDSCAPE ARCHITECTURE CONCEPT DEVELOPMENT



PP 19-575
MARCH 2020

PROJET | PAYSAGE
PLANIFICATION ET ARCHITECTURE DE PAYSAGE

01

CONTEXT

SITE LOCATION



SITE LOCATION



417 AUTOROUTE

SITE LOCATION



SITE LOCATION



SITE LOCATION



02

CONCEPT DEVELOPMENT

PROPOSED SITE PLAN



CIRCULATION

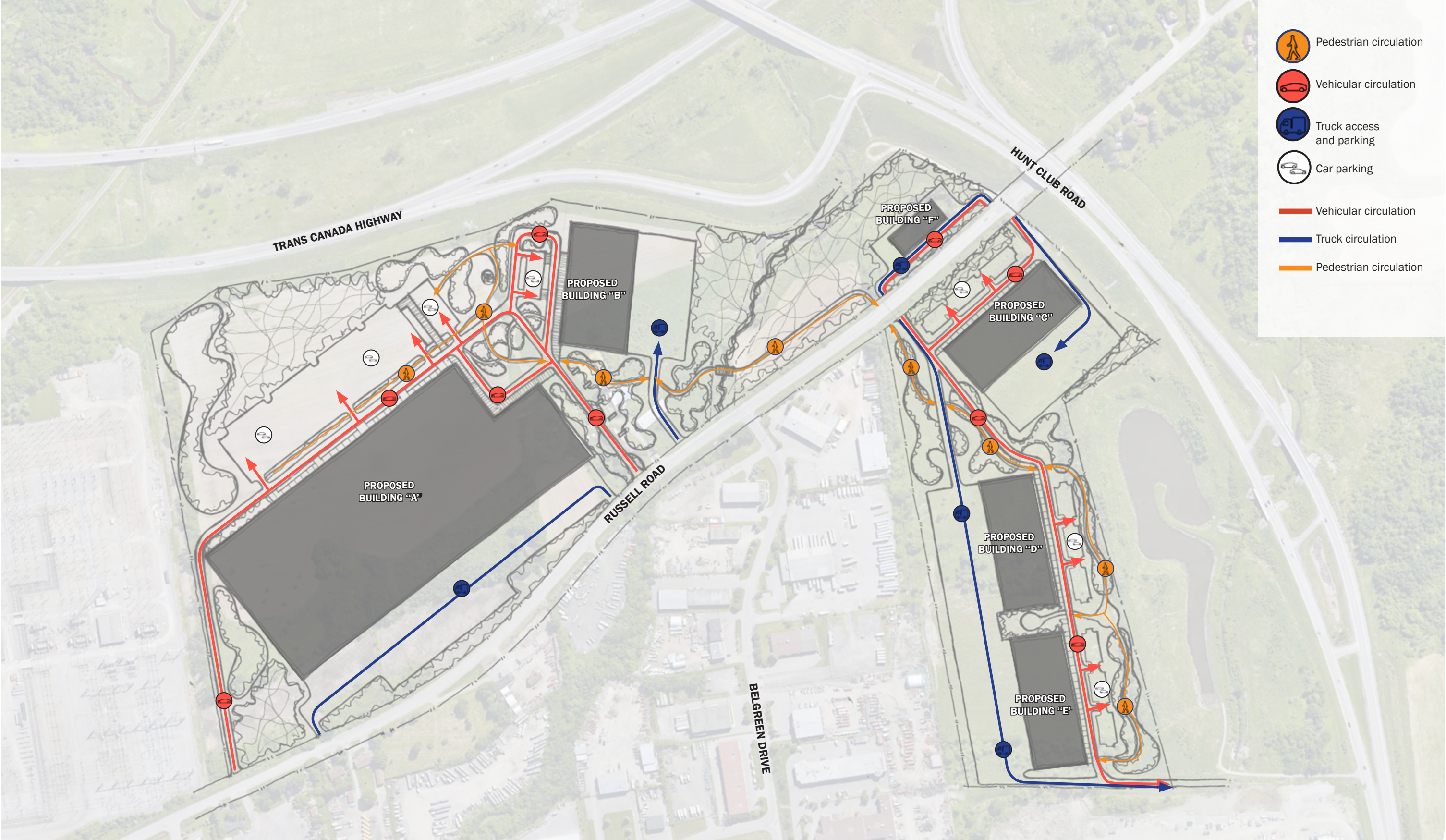

LANDSCAPE SECTORS

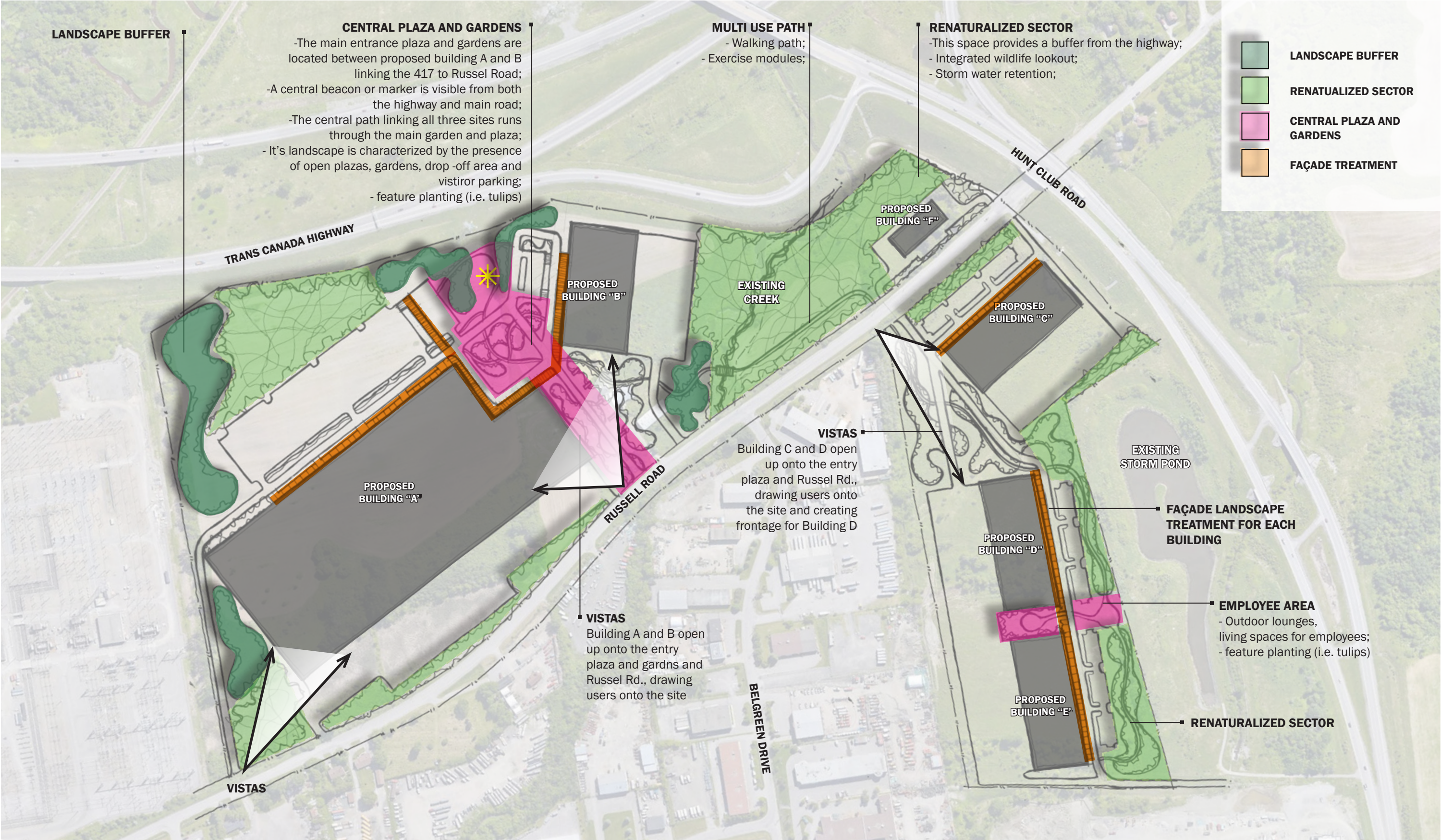

IMAGES OF INSPIRATION



IMAGES OF INSPIRATION

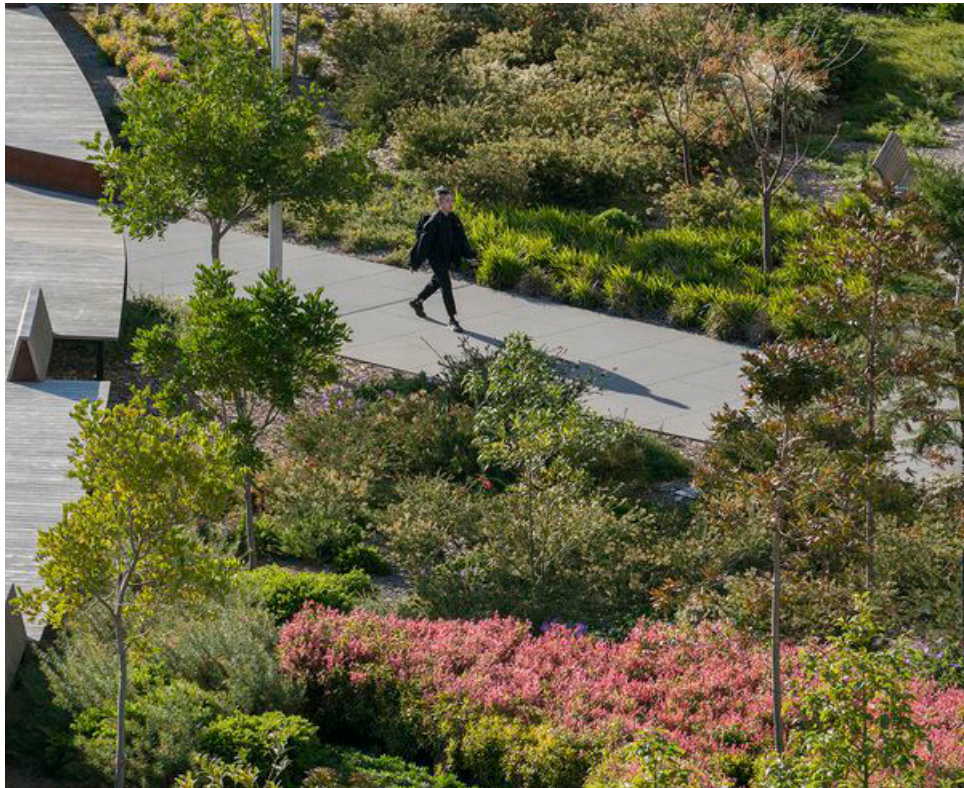

IMAGES OF INSPIRATION

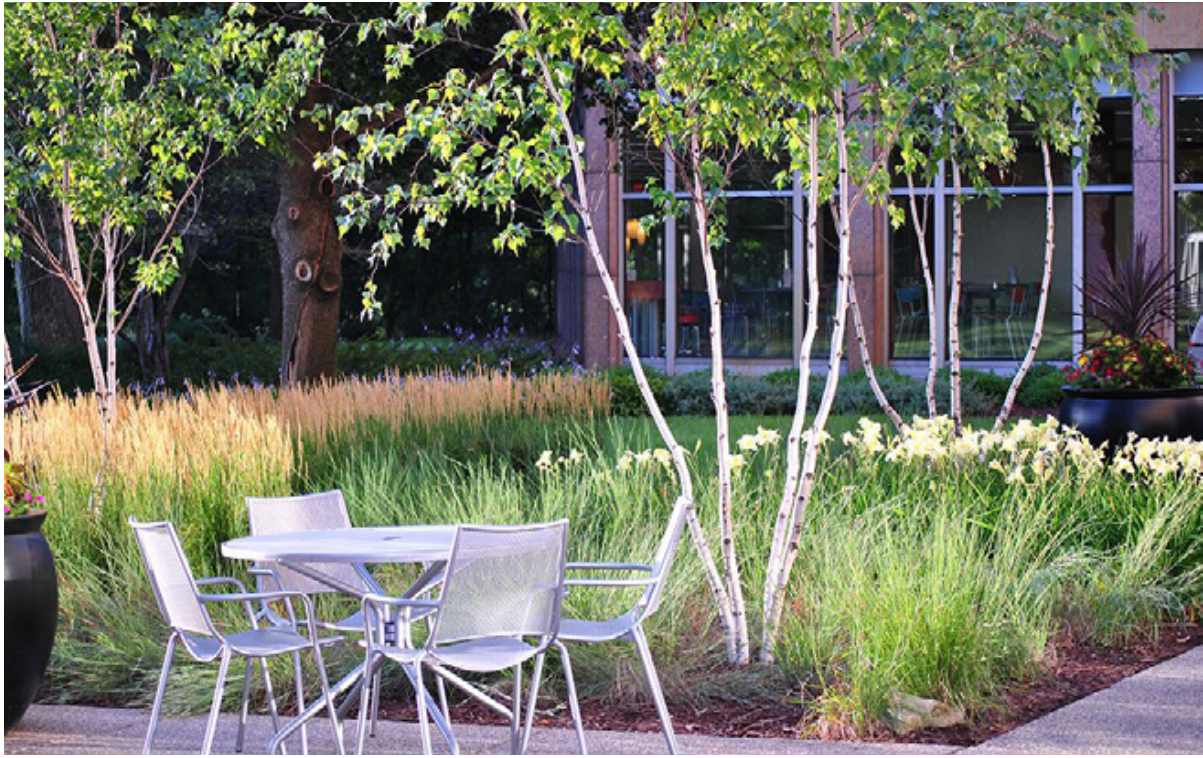

PROJET | PAYSAGE

PLANIFICATION ET ARCHITECTURE DE PAYSAGE