

Copyright Reserved

The Contractor shall verify and be responsible for all dimensions. DO NOT scale the drawing - any errors or omissions shall be reported to Stantec without delay.

The Copyrights to all designs and drawings are the property of Stantec. Reproduction or use for any purpose other than that authorized by Stantec is forbidden.

	PROPOSED DECIDUOUS TREE
	PROPOSED CONIFEROUS SHRUBS
	PROPOSED DECIDUOUS SHRUBS
	PROPOSED PLANTING BED
	PROPOSED PERENNIALS
	PLANT SPECIES/QUANTITY KEY
	TOPSOIL AND SOD
	PROPOSED STONE PILLAR, REFER TO DETAIL 5L300
	PROPOSED ORNAMENTAL FENCE, REFER TO DETAIL 5L300
	HYDRO TRANSFORMER / SWITCHGEAR PAD, REFER TO HYDRO DESIGN
	PROPOSED PROPERTY LINE

1. SITE PLAN PREPARED BY M. DAVID BLAKELY ARCHITECT INC., REVISION 19, DATED MARCH 2020.
2. TOPOGRAPHIC SURVEY SUPPLIED BY ANNIS, O'SULLIVAN, VOLLEBEKK LTD. PROJECT No 19060-18 RICHCRFT BLK 221, REGISTERED PLAN 4M-1573, CITY OF OTTAWA. DATED 2018-08-15

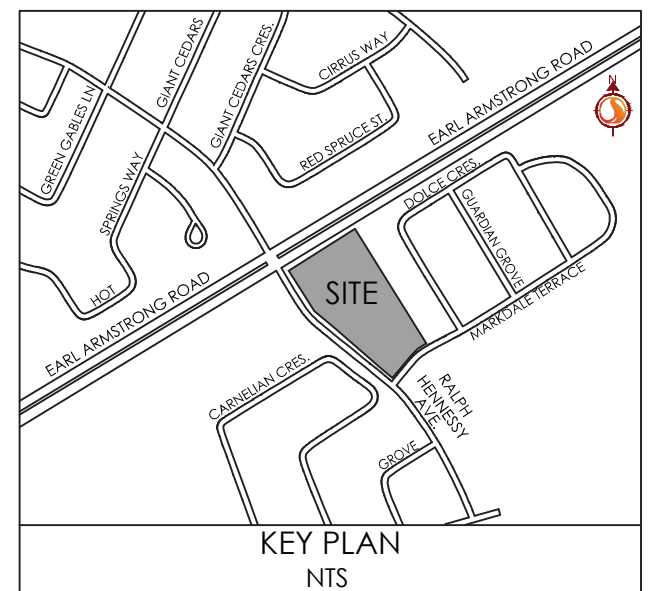

3	REVISED SITE PLAN	GM	ILL	20.04.02
2	ISSUED FOR REVIEW	GM	ILL	19.09.19
1	ISSUED TO CITY FOR SPA	ILL	ILL	19.01.08
Revision		By	Appd.	YY.MM.DD
File Name:	160401422_LB	MJS	ILL	18.12.10
		Dwn.	Chkd.	Dsgn.
				YY.MM.DD

Permit-Seal



Client/Project
RICH CRAFT HOMES

RIVERSIDE SOUTH PHASE 8
BLOCK 221
OTTAWA, ON

Title
LANDSCAPE PLAN

Project No. 160401422

Drawing No.	Sheet	Revision
-------------	-------	----------

L200 1 of 2 3

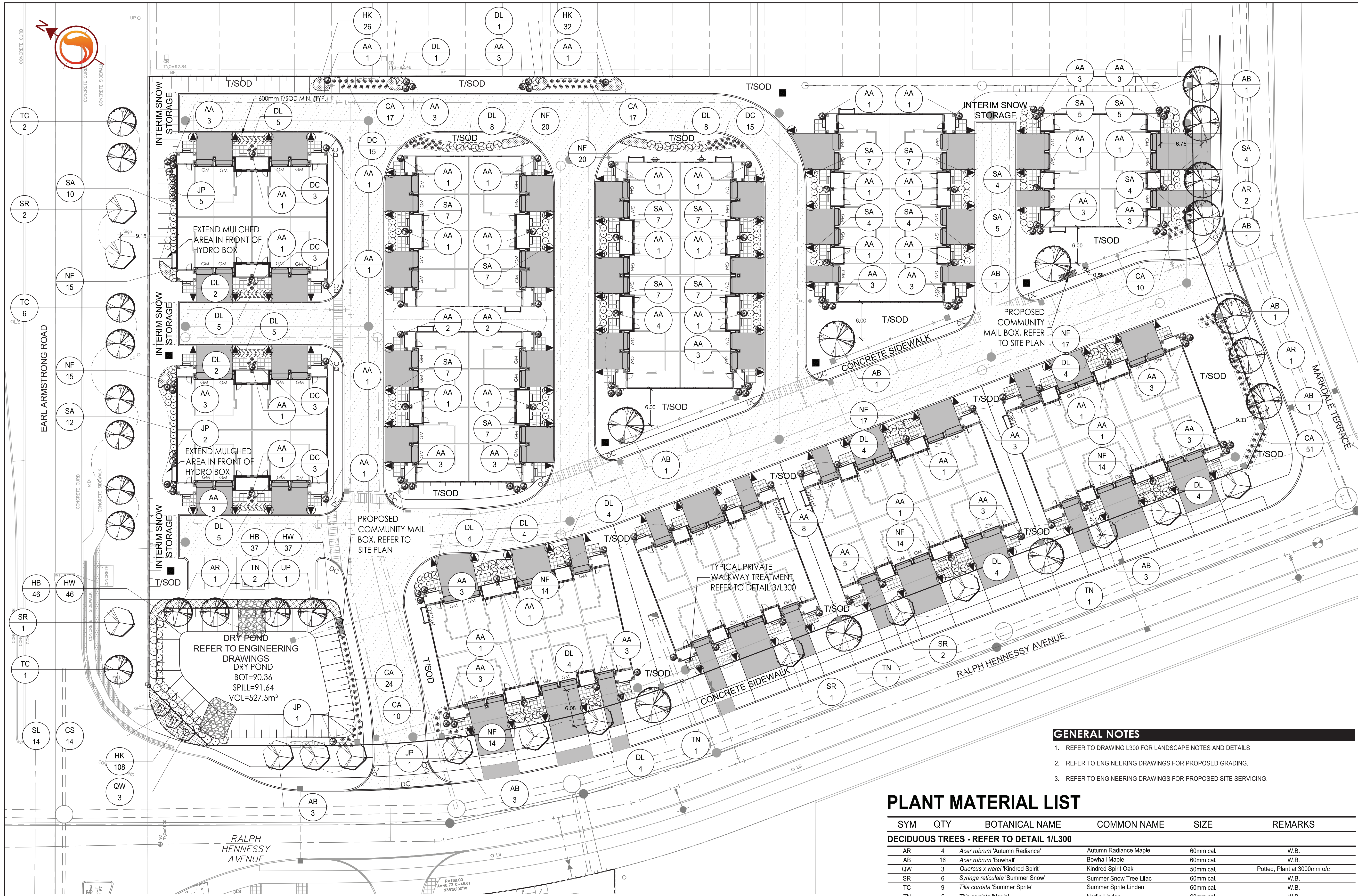

PLANT MATERIAL LIST

SYM	QTY	BOTANICAL NAME	COMMON NAME	SIZE	REMARKS
DECIDUOUS TREES - REFER TO DETAIL 1/L300					
AR	4	<i>Acer rubrum</i> 'Autumn Radiance'	Autumn Radiance Maple	60mm cal.	W.B.
AB	16	<i>Acer rubrum</i> 'Bowhall'	Bowhall Maple	60mm cal.	W.B.
QW	3	<i>Quercus x warei</i> 'Kindred Spirit'	Kindred Spirit Oak	50mm cal.	Potted; Plant at 3000mm o/c
SR	6	<i>Syringa reticulata</i> 'Summer Snow'	Summer Snow Tree Lilac	60mm cal.	W.B.
TC	9	<i>Tilia cordata</i> 'Summer Sprite'	Summer Sprite Linden	60mm cal.	W.B.
TN	5	<i>Tilia cordata</i> 'Norlin'	Norlin Linden	60mm cal.	W.B.
UP	1	<i>Ulmus x 'Pioneer'</i>	Pioneer Elm	60mm cal.	W.B.
DECIDUOUS SHRUBS - REFER TO DETAIL 2/L300					
CS	14	<i>Cornus sericea</i> 'Arc tic Fire'	Arc tic Fire Dogwood	2 gal.	Potted; Plant at 1200mm o/c
DL	78	<i>Diervilla lonicera</i>	Bush Honeysuckle	40cm ht.	Potted; Plant at 1200mm o/c
HK	166	<i>Hypericum kalmianum</i>	Pot 'O' Gold	40cm ht.	Potted; Plant at 500mm o/c
SL	14	<i>Spiraea alba</i>	Meadow Sweet Spiraea	1 gal.	Potted; Plant at 1200mm o/c
SA	127	<i>Spiraea x arguta</i> 'Graciosa'	Dwarf Garland Spiraea	50cm ht	Potted; Plant at 1000mm o/c
CONIFEROUS SHRUBS - REFER TO DETAIL 2/L300					
JP	9	<i>Juniperus x pfitzeriana</i> 'Old Gold'	Old Gold Juniper	40cm sp.	Potted; Plant at 1200mm o/c
AA	119	<i>Abies alba</i> 'Pyramidalis'	Pyramidal European Silver Fir	1000mm ht.	B.B.C., Plant at 1200mm o/c
PERENNIALS AND ORNAMENTAL GRASSES - REFER TO DETAIL 2/L300					
CA	129	<i>Calagrostis acutiflora</i> 'Karl Foerster'	Karl Foerster Feather Reed Grass	1 gal.	Potted; Plant at 1000mm o/c
DC	42	<i>Deschampsia cespitosa</i> 'Goldschleier'	Gold Veil Tufted Hair Grass	1 gal.	Potted; Plant at 750mm o/c
HB	83	<i>Hemerocallis</i> 'Little Business'	Little Business Daylily	1 gal.	Potted; Plant at 450mm o/c
HW	83	<i>Hemerocallis</i> 'Little Wine Cup'	Little Wine Cup Daylily	1 gal.	Potted; Plant at 450mm o/c
NF	160	<i>Nepeta faassenii</i> 'Droptone'	Droptone Blue Catmint	1 gal.	Potted; Plant at 450mm o/c