

**NOT FOR CONSTRUCTION**

**NOTE:**  
THE POSITION OF ALL POLE LINES, CONDUITS, WATER MAINS, SEWERS AND OTHER UTILITIES AND STRUCTURES IS NOT NECESSARILY SHOWN ON THE CONTRACT OF THE POSITION OF SUCH UTILITIES AND STRUCTURES IS NOT GUARANTEED. BEFORE STARTING WORK DETERMINE THE EXACT LOCATION OF ALL SUCH UTILITIES AND STRUCTURES AND ASSUME ALL LIABILITY FOR DAMAGE TO THEM.

No.	REVISION	DATE	BY
1.	ISSUED FOR SITE PLAN APPLICATION	NOV 28/19	KEW
2.	ISSUED FOR COORDINATION	OCT 16/19	KEW

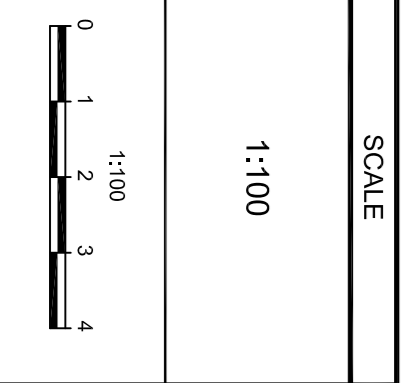

REVISION	KEY
CHECKED	RGI
DRAWN	KEW
CHECKED	RGI
APPROVED	RGI

**FOR REVIEW ONLY**

No.	Botanical Name	Common Name	DBH (m)	CRZ (m)	Condition	Remarks	Recomm.
1	Kerf platanoides	Norway Maple	0.30	2.00	F		PROJECT
2	Kerf platanoides	Norway Maple	0.20	2.00	F		PROJECT
3	Rosa rugosa	Black Rose	0.30	3.00	F		PROJECT
4	Kerf platanoides	Norway Maple	0.10	1.00	F		PROJECT
5	Kerf platanoides	Norway Maple	0.15	1.50	F		PROJECT
6	Rosa rugosa	Black Rose	0.20	2.00	F		PROJECT
7	Kerf platanoides	Norway Maple	0.10	1.00	F		PROJECT
8	Kerf platanoides	Norway Maple	0.15	1.50	F		PROJECT
9	Kerf platanoides	Norway Maple	0.20	2.00	F		PROJECT
10	Kerf platanoides	Norway Maple	0.20	2.00	F		PROJECT
11	Kerf platanoides	Norway Maple	0.20	2.00	F		PROJECT
12	Kerf platanoides	Norway Maple	0.20	2.00	F		PROJECT

Legend
G Good
F Fair
P Poor
VP Very Poor

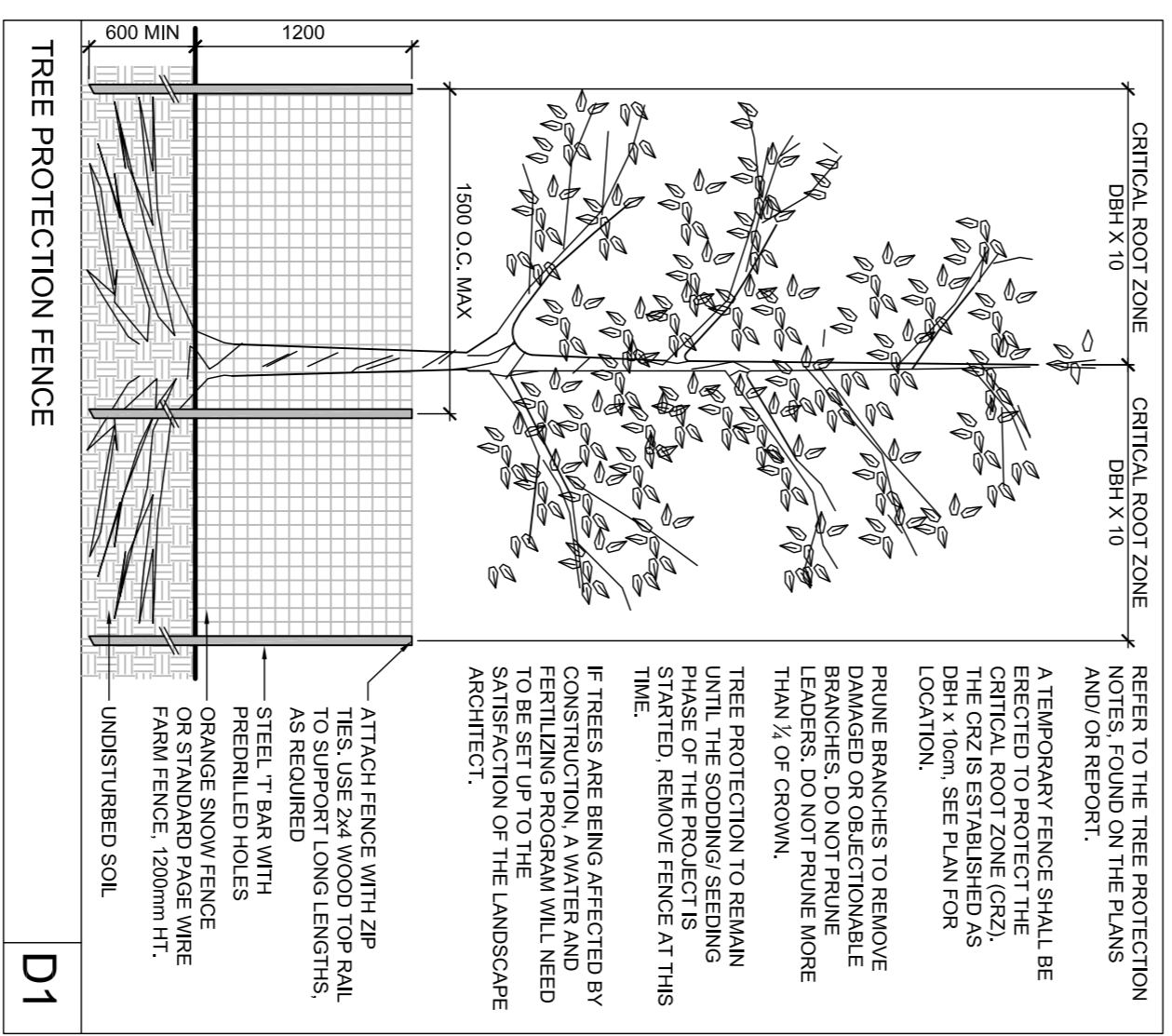

REFER TO THE TREE PROTECTION NOTES FOUND ON THE PLANS AND/OR REPORT.

A TEMPORARY FENCE SHALL BE ERECTED TO PROTECT THE CRITICAL ROOT ZONE (CRZ). DBH x 10m. SEE PLAN FOR LOCATION.

PRUNE BRANCHES TO REMOVE DAMAGED OR OBJECTIONABLE BRANCHES. DO NOT PRUNE MORE THAN 1/3 OF CANOPY.

TREE PROTECTION TO REMAIN UNTIL THE SOILING SEEDING PROGRAM IS COMPLETED. STARTED. REMOVE FENCE AT THIS TIME.

IF TREES ARE BEING AFFECTED BY CONSTRUCTION, A WATER AND FERTILIZING PROGRAM WILL NEED TO BE SET UP TO THE TREE TO BE SET UP TO THE LANDSCAPE ARCHITECT.

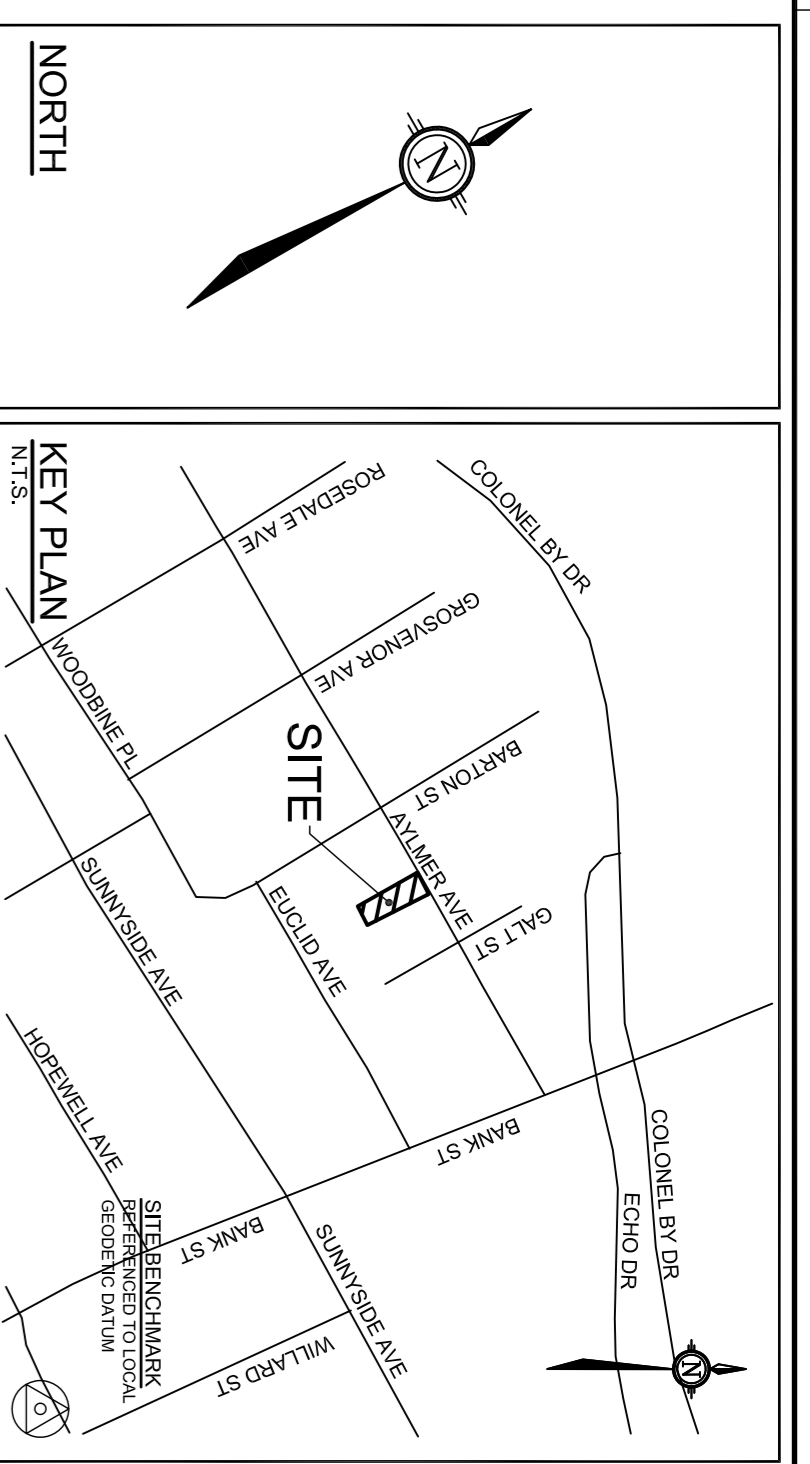

**LANDSCAPE LEGEND:**

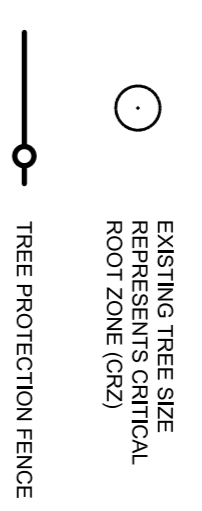

**TREE PROTECTION NOTES**

- Under the guidance of a Landscape Architect or Certified Arborist, erect a fence at the critical root zone (CRZ) of trees where the CRZ is established as being 10 centimetres from the trunk of a tree for trees with a DBH of 100mm or greater. For trees with a DBH less than 100mm, the CRZ shall be calculated as DBH x 10cm. Refer to the Tree Protection Fence detail. See plan for fence location.
- When trees to be removed overlap with the CRZ of trees to be preserved; cut roots at the edge of the CRZ and grind down stumps after tree removals. Do not pull out stumps. Exposed stumps are not to be cut at right angles with clean, sharp horizontal tools without leaving, crushing, or pulling. Refer to City of Ottawa Specification S.P. F-8011 Tree Protection, Excavation of Root Zone.
- Hand work only where required within the CRZ, absolutely no use of any power mechanical or equipment within the CRZ of any tree.
- Do not attach any signs, notices or posters to any tree.
- Do not disturb, raise or lower the existing grade within the CRZ without approval.
- Only tunnel or bore when digging within the CRZ of a tree.
- Do not damage the root system, trunk, or branches of any tree.
- Do not remove any trees from all equipment and directed away from any tree canopy.

**NOVATECH**  
Engineers, Planners & Landscape Architects  
Suite 200, 240 Mitchell Compound Drive  
Ottawa, Ontario, Canada K2M 1R5  
Telephone: (613) 254-5643  
Facsimile: (613) 254-5867  
Website: www.novatech-eng.com

**LOCATION:**  
CITY OF OTTAWA  
26 AYLMER AVENUE

**DRAWING NAME:**  
TREE CONSERVATION REPORT

PROJECT NO: 118092-00  
REV: #1  
REV: #2

DRAWING NO: 118092-00  
REV: #2