

EXISTING TREE INVENTORY (CONDUCTED JAN, 2020)						
No.	Botanical Name	Common Name	DBH (m)	CRZ (m)	Condition	Remarks
277	Quercus rubra	Red Oak	0.70	7.00	G	
3420	Populus sp.	Aspen/Poplar	0.90	9.00	P	Sap run / Internal rot likely
3421	Acer negundo	Manitoba Maple/Boxelder	0.45	4.50	P	Off-site / Internal rot / leaning
3423	Acer x freemanii	Freeman Maple	0.30	3.00	G	Premature leaf-drop on one side
						Conflict

#### TABLE LEGEND

Conflict Remove due to conflict with construction.  
Remove Remove due to tree health, or invasive status.

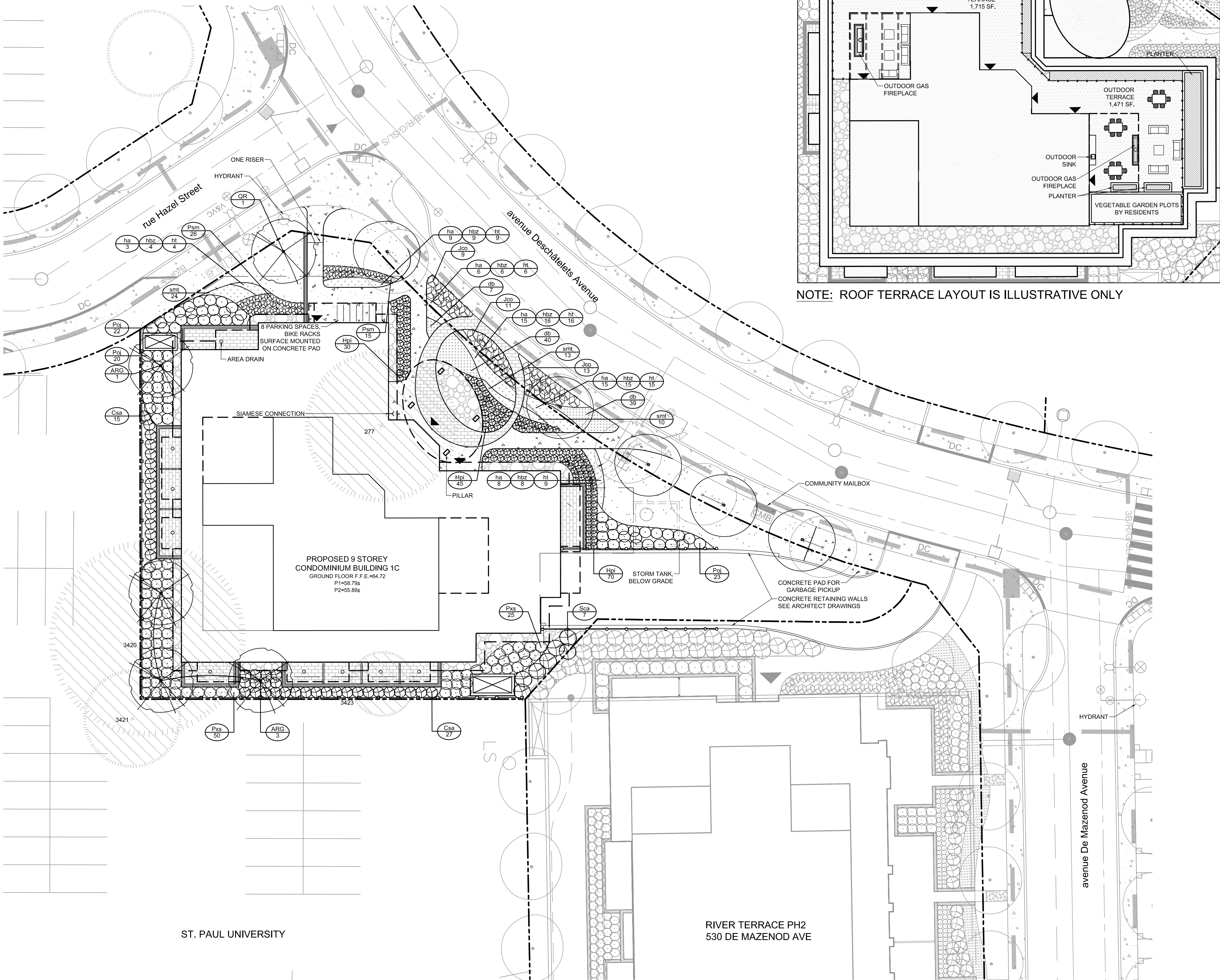

NOTE: ROOF TERRACE LAYOUT IS ILLUSTRATIVE ONLY

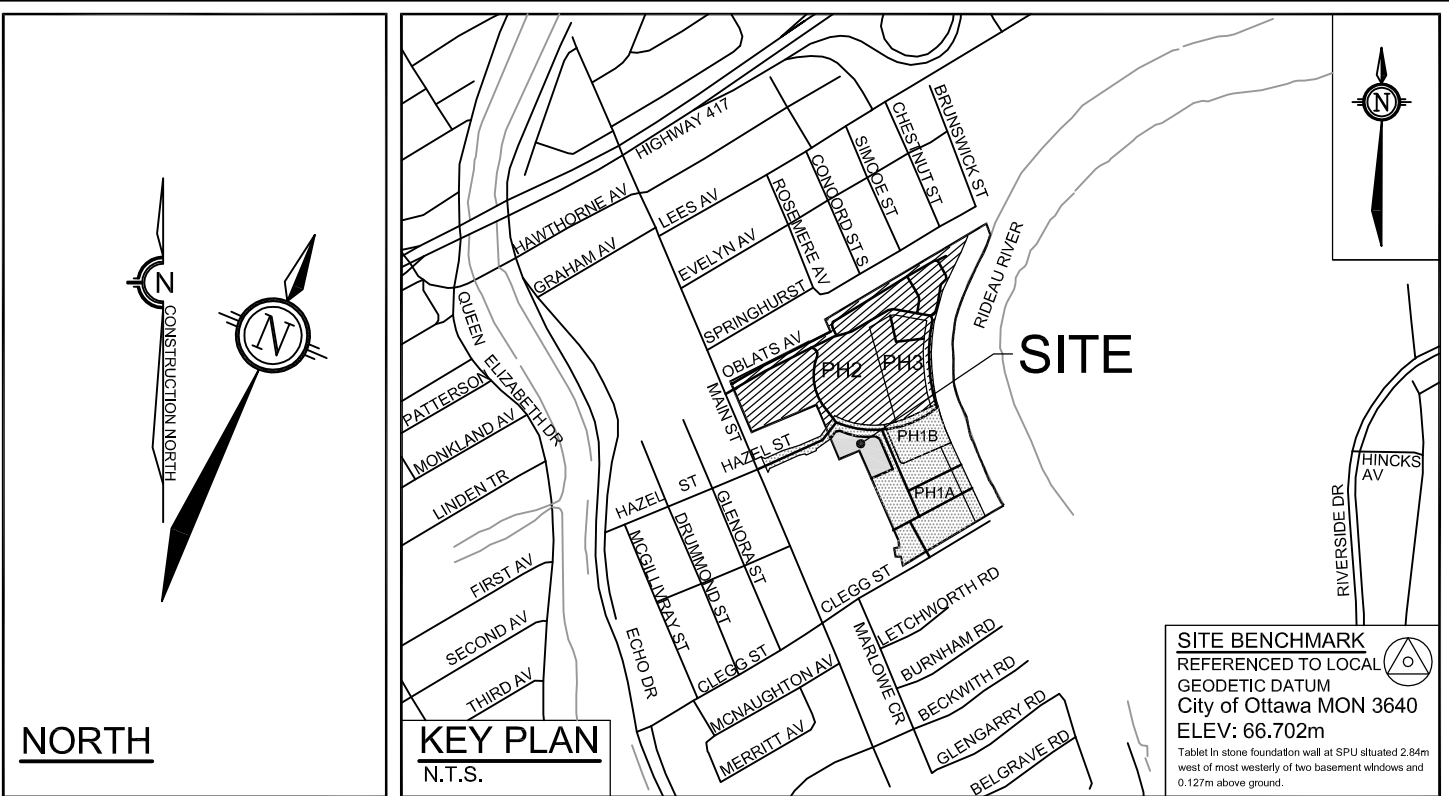

#### LANDSCAPE LEGEND

- PROPERTY LIMIT
- PROPOSED CONCRETE
- OFF-SITE CONCRETE
- PROPOSED PAVERS
- CLEAR STONE
- ROOF TERRACE SURFACE
- SOD
- PERENNIALS
- ORNAMENTAL GRASSES
- ROOF TERRACE PLANTING
- PROPOSED DECIDUOUS TREE
- REVISED STREET TREE LOCATION BASED ON WALKWAY CONNECTIONS, UTILITIES, ETC
- TREE PART OF APPROVED DRAWING SET
- EXISTING TREE TO REMOVE
- PROPOSED SHRUBS
- SPECIES (SEE PLANT LIST)
- QUANTITY
- PILLAR
- WOOD SCREEN 1.8m HT
- DECORATIVE METAL FENCE 1.2m HT
- WOOD PRIVACY FENCE 1.8m HT
- ROOF TERRACE GUARDRAIL
- OVERHANG
- LANDSCAPE RETAINING WALL
- LIMIT OF UNDERGROUND GARAGE

#### PLANTING NOTES

- This drawing shall be read in conjunction with all relevant Architectural, Engineering, and related drawings and documents.
- Refer to Engineering Drawings for Grading. Provide drainage as indicated in grading plan. Round all tops and toes of slopes, smoothly. Compact all areas to 95% Standard Proctor Density unless otherwise noted.
- Refer to Architectural Drawings for site servicing.
- Refer to Engineering Drawings for site servicing.
- Contractor must contact utility companies for locates prior to excavation or planting.
- It is essential to use the plans and details in conjunction with the specifications and notes.
- Existing trees to be retained shall be protected according to the contract detail and specifications.
- Plant material shall be No. 1 Grade and shall comply with Canadian Standards for Nursery Stock (latest edition) published by the Canadian Nursery Landscape Association.
- Use plant material with strong fibrous root system free of disease, defects or injuries, and structurally sound. Use trees with straight trunks, well and characteristically branched for species. Obtain approval from consultant of plant material at source prior to digging. All trees and shrubs shall be container grown, potted, W/B or B/B, as indicated on Plant List. Bare root planting will only be acceptable for certain species and as approved by the Landscape Architect.
- Plant material substitutions shall not be permitted without the written approval from the consultant, with 48 hours notice, prior to shipping plant material.
- Plant locations are schematic / approximate only. Contractor shall stake out locations on site for approval by the Landscape Architect prior to installation. The illustrated number of plants shown in the Planting Plan supersedes the estimated number in the Plant List. Contractor to report any discrepancies to the Landscape Architect prior to installation. Contractor will assume full responsibility if the Landscape Architect is not notified. Shrubs, Perennials, Vines, and Groundcovers shall be planted in a continuous planting bed of 450mm depth with approved topsoil covered with 75mm depth shredded bark mulch.
- Ensure trees are thoroughly watered following planting. Monitor material and ensure adequate moisture until acceptance.
- In heavy clay or poorly drained soils, set root ball with root collar 75-100mm higher than finished grade.
- Sod and/or seed areas to receive 100mm depth topsoil as specified. Sod shall be No. 1 Kentucky Bluegrass Sod grown from minimum mixture of 3 Kentucky Bluegrass cultivars. Quality and source shall comply with Canadian Standards for Nursery Stock, Section 17, (latest edition) published by the Canadian Nursery Landscape Nursery Landscape Association. Unless otherwise specified, turf is to be maintained by the contractor until a second cutting is accepted by the Landscape Architect.
- Apply the following mineral fertilizer unless soil tests show other requirements: Sodded areas - (8-32-16) 8% Nitrogen, 32% Phosphorus, 16% Potash at a rate of 350kg/ha. - Planting Beds - (8-32-16) - 8% Nitrogen, 32% Phosphorus, 16% Potash as per manufacturer specifications.
- Reinstate all areas damaged or disturbed beyond the Limit of Work.

#### PROPOSED PLANT LIST

KEY	QTY	BOTANICAL NAME	COMMON NAME	SIZE	COND	SPACING
Deciduous Trees						
ARG	4	Acer rubrum 'Armstrong Gold'	Armstrong Gold Red Maple	60mm Cal	WB	As Shown
QR	1	Quercus rubra	Red Oak	60mm Cal	WB	As Shown
Coniferous Shrubs						
Jco	33	Juniperus horiz. 'Plumosa Compacta'	Compact Andorra Juniper	0.50m Spr	PT	100cm O.C.
Psm	41	Pinus mugo 'Slowmound'	Slowmound Mugo Pine	0.30m Spr	PT	60cm O.C.
Deciduous Shrubs						
Csa	42	Cornus sericea 'Farrow'	Arctic Fire Dogwood	0.50m Ht	PT	100cm O.C.
Hpl	145	Hydrangea paniculata 'Vibro'	Bobo Dwarf Hydrangea	0.50m Ht	PT	80cm O.C.
Pxs	75	Philadelphus 'Snowbell'	Snowbell Mockorange	0.50m Ht	PT	100cm O.C.
Poj	65	Physocarpus opulifolius 'UEFAM'	Amber Jubilee Ninebark	0.50m Ht	PT	100cm O.C.
Sca	7	Sambucus canadensis 'Aurea'	Golden Elderberry	0.80m Ht	PT	150cm O.C.
Perennials						
ha	56	Hemerocallis 'Anzac'	Anzac Daylily	1g	PT	45cm O.C.
hbz	58	Hemerocallis 'Bonanza'	Bonanza Daylily	1g	PT	45cm O.C.
hl	59	Hemerocallis 'Primal Scream'	Primal Scream Daylily	1g	PT	45cm O.C.
smt	47	Salvia nemerosa 'Blue Queen'	Blue Queen Perennial Salvia	1g	PT	45cm O.C.
Ornamental Grasses						
db	86	Deschampsia cespitosa 'Bronzeschleier'	Bronze Veil Tufted Hair Grass	1g	PT	50cm O.C.

NOTE:  
THE POSITION OF ALL POLE LINES, CONDUITS,  
WATERMAINS, SEWERS AND OTHER  
UNDERGROUND AND OVERGROUND UTILITIES AND  
STRUCTURES IS NOT NECESSARILY SHOWN ON  
THE CONTRACT DRAWINGS, AND WHERE SHOWN,  
THE ACCURACY OF THE POSITION OF SUCH  
UTILITIES AND STRUCTURES IS NOT GUARANTEED.  
BEFORE STARTING WORK, DETERMINE THE EXACT  
LOCATION OF ALL SUCH UTILITIES AND  
STRUCTURES AND ASSUME ALL LIABILITY FOR  
DAMAGE TO THEM.

No.	REVISION	DATE	BY
3.	ISSUED FOR SITE PLAN APPLICATION	FEB 14/20	JP
2.	REISSUED FOR CLIENT REVIEW	FEB 05/20	JP
1.	ISSUED FOR CLIENT REVIEW	JAN 24/20	JP

#### SCALE

1:200

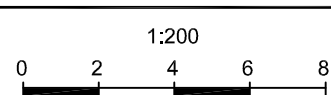

#### DESIGN

KEW  
JP  
KEW  
JP  
RGJ

#### FOR REVIEW ONLY



**NOVATECH**  
Engineers, Planners & Landscape Architects  
Suite 200, 240 Michael Cowpland Drive  
Ottawa, Ontario, Canada K2M 1P6  
Telephone (613) 254-9643  
Facsimile (613) 254-5867  
Website www.novatech-eng.com

CITY OF OTTAWA  
GREYSTONE VILLAGE  
CONDO 1C - 360 DESCHÂTELETS AVENUE

DRAWING NAME

TREE CONSERVATION AND  
LANDSCAPE PLAN

PROJECT No.

114025-1C

REV

REV # 3

DRAWING No.

114025-L1(1C)

PL-0001-2019-04-01mm202001