

CISTERN TO BE SPECIFIED AND ACCOMMODATED WITHIN THE BUILDING
 5-YEAR STORAGE REQ'D=41.5m³
 5-YEAR FLOW RATE=1.5L/s
 100-YEAR STORAGE REQ'D=82.3m³
 100-YEAR FLOW RATE=2.9L/s
 CISTERN TO BE PUMPED IN ACCORDANCE WITH THE RELEASE RATES ABOVE BY MECHANICAL SYSTEM (REFER TO DETAIL PREPARED BY QUADRANT ENGINEERING)

CONNECT TO EX. 300mm# COMBINED SEWER IN ACCORDANCE WITH CITY STANDARD DWG. S11.1
 EX. INV.=74.42
 PROP. INV.=74.57

RAISED VENT SHAFT
 ELEV.=77.60
 DRAINAGE TO BE DIRECTED TO THE INTERNAL MECHANICAL SYSTEM

AT GRADE GAP BELOW LANDSCAPING FEATURE TO ALLOW FOR STORMWATER TO SURFACE DRAIN TO CLEWOW AVENUE

TRANSITION TO MOUNTABLE CURB PER CITY STD. SC1.3
 EX. 112m-300mm# COMB PVC SDR 35 @ 2.94%

FULLY DEPRESSED CURB AND SIDEWALK PER CITY STD. SC7.1

SAW CUT INTO EXISTING SIDEWALK

3.9m-250mm# STM @ 1.0% (MIN)
 INV @ BLDG=74.61
 FOUNDATION DRAINS TO BE CONNECTED DOWNSTREAM OF CISTERN CONTROLS

AREA DRAIN TO BE SPECIFIED AND ACCOMMODATED WITHIN BUILDING MECHANICAL SYSTEM (REFER TO MECHANICAL DESIGN)

275 CARLING PROP. BLDG

77.45 54.70

LANDSCAPING WALL MAX HEIGHT=0.36m
 EX. CB DIRECTED TOWARDS INTERNAL MECHANICAL SYSTEM
 T/L=76.22

CB TO BE RELOCATED AND ACCOMMODATED WITHIN EXISTING BUILDING MECHANICAL SYSTEM
 T/L=76.24

AREA TO BE INCLUDED IN U1

APPROXIMATE OUTLINE OF UNDERGROUND PARKING (REFER TO ARCHITECTURAL PLANS)

A1
 0.153
 0.83

AREA DRAIN TO BE SPECIFIED AND ACCOMMODATED WITHIN BUILDING MECHANICAL SYSTEM (REFER TO MECHANICAL DESIGN)

U1
 0.038
 0.58

part 3 plan 5r-4231 (by-law 200-1987, inst. n419250)

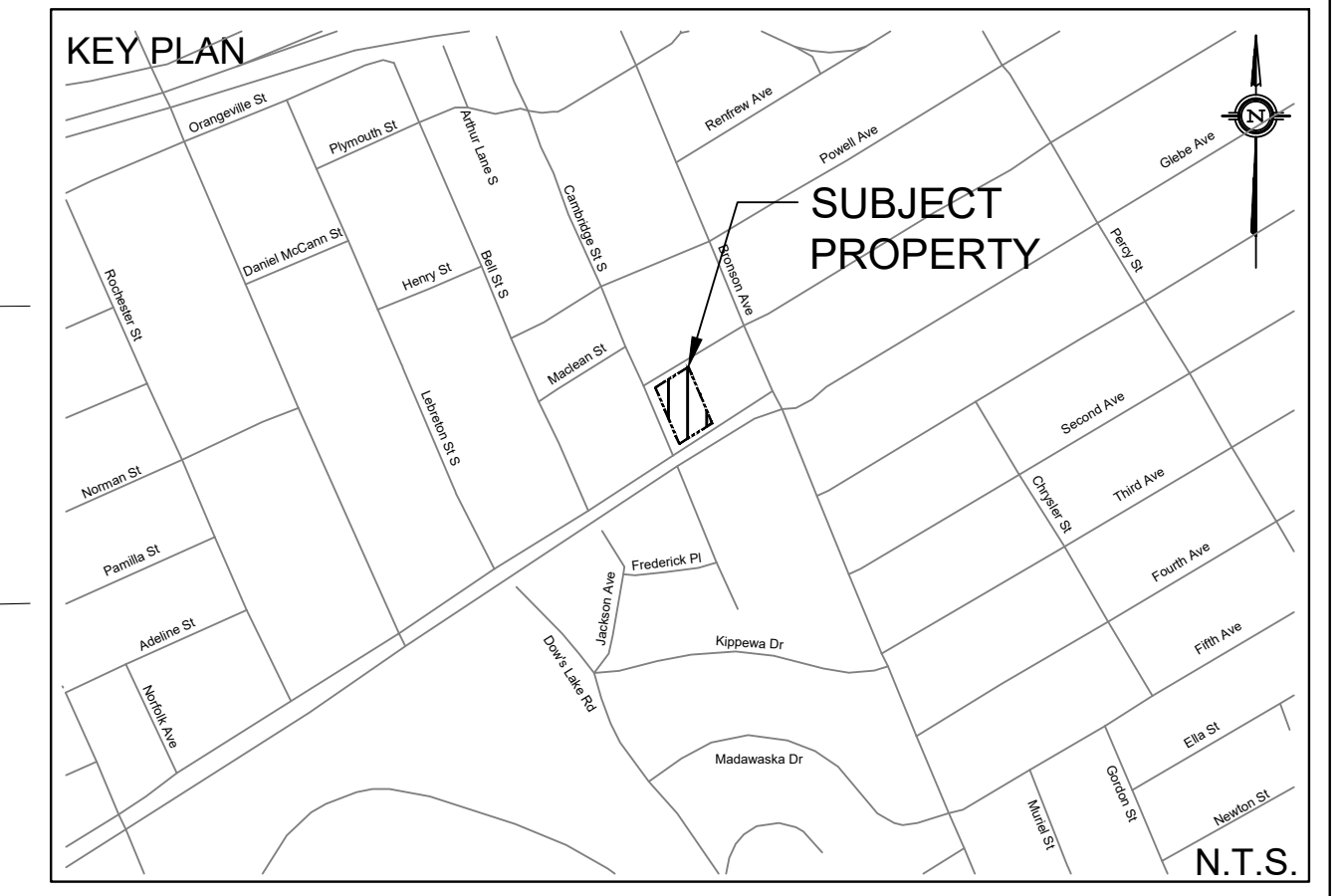

LEGEND

- PROPERTY LINE
- - - - PROPOSED STORM SEWER
- DRAINAGE DIVIDE
- PROPOSED SWALE
- o PROPOSED AREA DRAIN
- EMERGENCY FLOW ROUTE
- EX6 DRAINAGE AREA ID
- 4.010 AREA IN Ha
- 0.19 RATIONAL METHOD RUNOFF COEFFICIENT
- 100.00 FINISHED FLOOR ELEVATION
- 100.00 UNDERSIDE OF FOOTING

NOT FOR CONSTRUCTION

TOPOGRAPHIC INFORMATION
 TOPOGRAPHIC INFORMATION PROVIDED BY ANNIS, O'SULLIVAN, VOLLEBEK LTD.
 PROJ. NO. 12495-11
 DATED JANUARY 13, 2012

SITE PLAN INFORMATION
 SITE PLAN PROVIDED BY RODERICK LAHEY ARCHITECTS
 PROJ. NO. 1122
 DATED JUNE 21, 2019

GEOTECHNICAL STUDY
 GEOTECHNICAL RECOMMENDATIONS PROVIDED BY PATERSON GROUP
 PROJ. NO. PG2682-1
 DATED FEBRUARY 15, 2018

SITE SERVICING AND STORMWATER MANAGEMENT STUDY
 SERVICING AND STORMWATER MANAGEMENT RECOMMENDATIONS PROVIDED BY DSEL
 PROJ. NO. 17-988
 DATED JUNE 2019

BENCH MARK
 BENCHMARK #1: TOP OF FIRE HYDRANT SPINDLE LOCATED NORTH WEST OF SUBJECT SITE
 ELEV.=78.21
 BENCHMARK #2: TOP OF FIRE HYDRANT SPINDLE LOCATED SOUTH WEST OF SUBJECT SITE
 ELEV.=77.25

No.	BY	YY.MM.DD	DESCRIPTION
5	A.J.G.	19.02.18	ISSUED FOR MUNICIPAL REVIEW
4	A.J.G.	19.12.06	ISSUED FOR MUNICIPAL REVIEW
3	A.J.G.	19.06.21	ISSUED FOR MUNICIPAL REVIEW
2	A.J.G.	19.02.14	ISSUED FOR MUNICIPAL REVIEW
1	A.J.G.	18.07.20	ISSUED FOR MUNICIPAL REVIEW

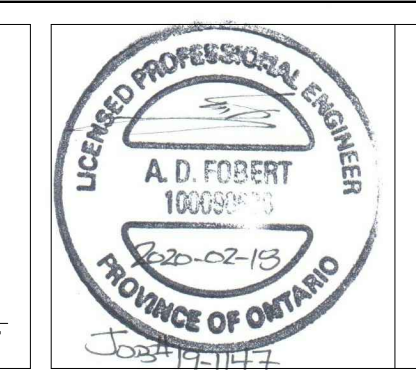

PROJECT No19-1147

STORMWATER MANAGEMENT PLAN
275 CARLING AVENUE © DSEL

Katasa Groupe + Développement 69, rue Jean-Proulx unité #301
 Gatineau, Quebec, J8Z 1W2
 Tel. (819) 771-2787

DSEL
 david schaeffer engineering ltd
 SMART SUBDIVISIONS™
 120 Iber Road Unit 103
 Stittsville, Ontario, K2S 1E9
 Tel. (613) 836-0856
 Fax. (613) 836-7183
 www.DSEL.ca

DRAWN BY: C.M.K.	CHECKED BY: A.D.F.	DRAWING NO. SWM-1	SHEET NO. 1 of 1
DESIGNED BY: C.M.K.	CHECKED BY: R.D.F.		
SCALE: 1:200	DATE: JUNE 2018		