

1 LANDSCAPE PLAN

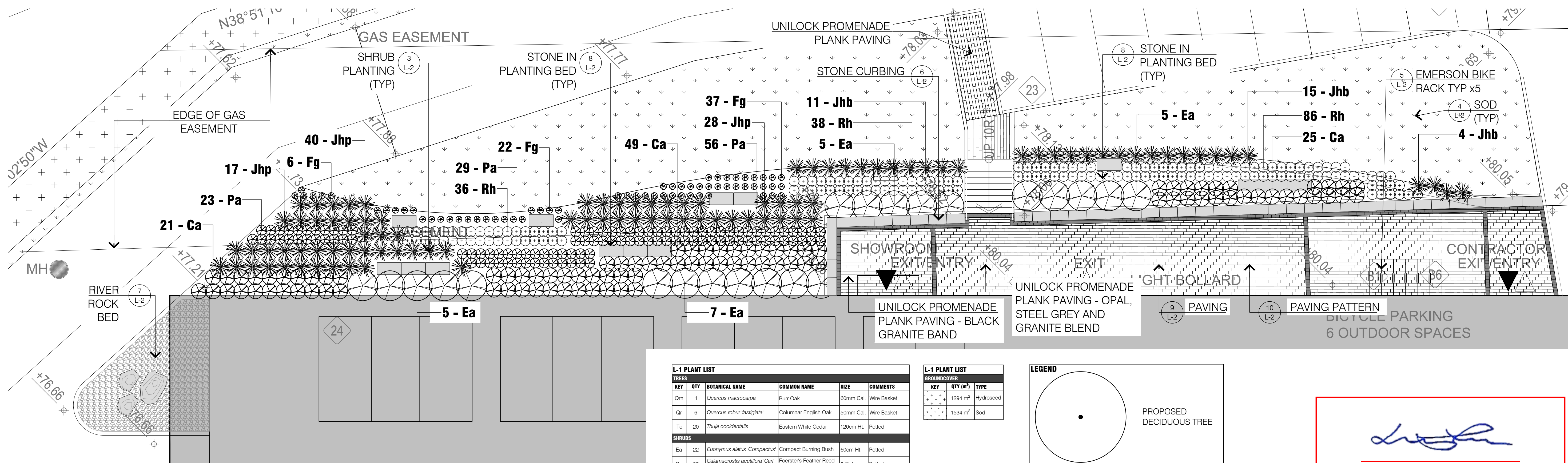

2 EAST FACADE DETAIL PLAN

| L-1 PLANT LIST |     |   |                               |           |             |
|----------------|-----|---|-------------------------------|-----------|-------------|
| TREES          |     |   |                               |           |             |
| KEY            | QTY | BOTANICAL NAME                            | COMMON NAME                   | SIZE      | COMMENTS    |
| Qm             | 1   | Quercus macrocarpa                        | Burr Oak                      | 60mm Cal. | Wire Basket |
| Qr             | 6   | Quercus robur 'fastigiata'                | Columnar English Oak          | 50mm Cal. | Wire Basket |
| To             | 20  | Thuja occidentalis                        | Eastern White Cedar           | 120cm Ht. | Potted      |
| SHRUBS         |     |   |                               |           |             |
| Ea             | 22  | Euonymus alatus 'Compactus'               | Compact Burning Bush          | 60cm Ht.  | Potted      |
| Ca             | 95  | Calamagrostis acutiflora 'Carl Foerster'  | Foerster's Feather Reed Grass | 2 Gal.    | Potted      |
| Fg             | 71  | Festuca glauca                            | Festuca Grass                 | 1 Gal.    | Potted      |
| Jhb            | 54  | Juniperus horizontalis 'Bar Harbour'      | Bar Harbour Creeping Juniper  | 2 Gal.    | Potted      |
| Jhp            | 45  | Juniperus horizontalis 'Plumosa Compacta' | Compact Andorra Juniper       | 2 Gal.    | Potted      |
| Pa             | 108 | Pennisetum alopecuroides 'Hameln'         | Dwarf Fountain Grass          | 1 Gal.    | Potted      |
| Rh             | 161 | Rudbeckia hirta                           | Black-Eyed Susan              | 1 Gal.    | Potted      |

| L-1 PLANT LIST |          |           |
|----------------|----------|-----------|
| GROUNDCOVER    |          |           |
| KEY            | QTY (m²) | TYPE      |
| +              | 1294 m²  | Hydroseed |
| •              | 1534 m²  | Sod       |

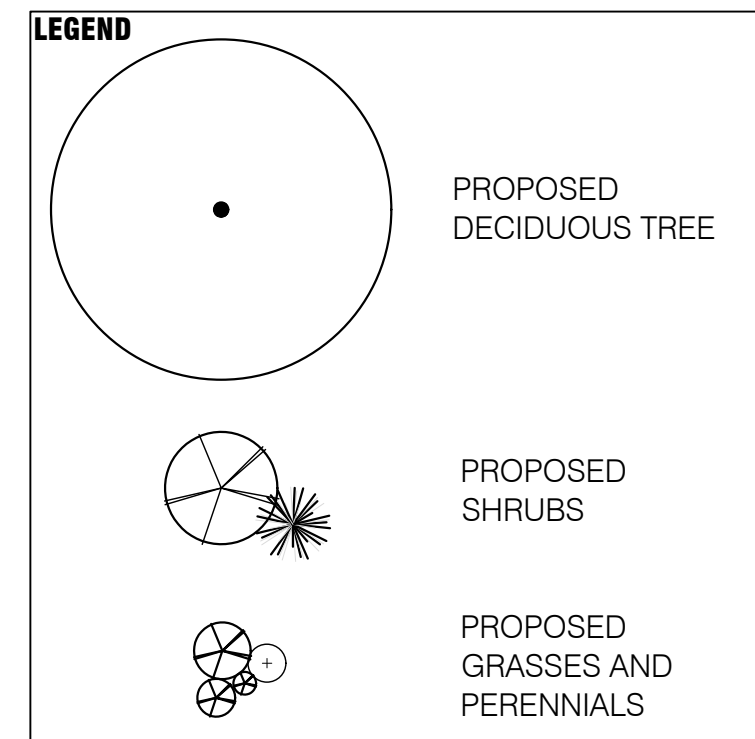

LILY XU, MCIP, RPP  
(A) MANAGER, DEVELOPMENT REVIEW - SOUTH  
PLANNING, INFRASTRUCTURE & ECONOMIC  
DEVELOPMENT DEPARTMENT, CITY OF OTTAWA

APPROVED  
By Lily Xu at 10:40 am, Jan 29, 2020

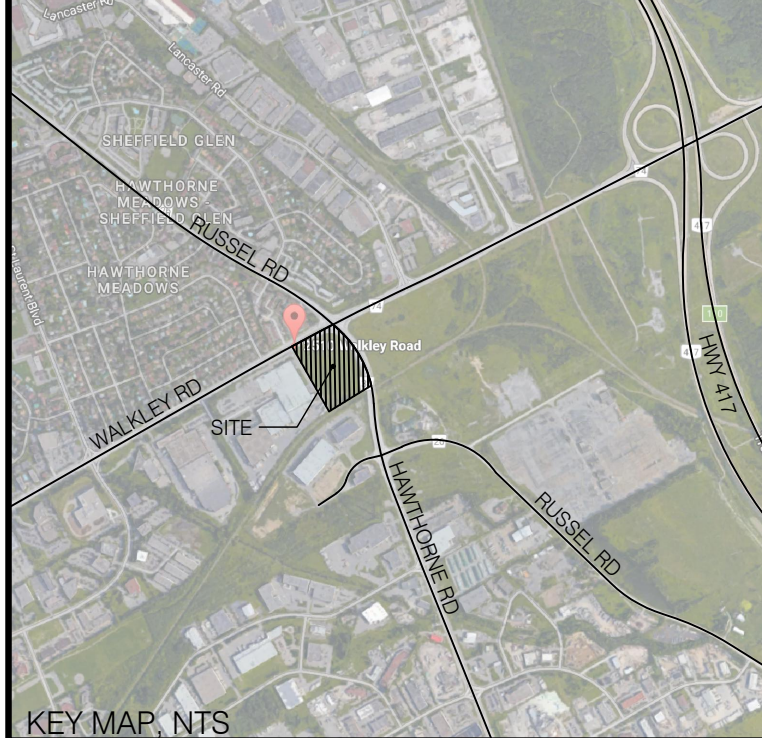

L1-1 GENERAL NOTES

- All general site information and conditions compiled from architect's and engineer's plans and surveys.
- Do not scale this drawing.
- Report any discrepancies prior to commencing work. No responsibility is born by the Landscape Architect for unknown subsurface conditions.
- Reinstate all areas and items damaged as a result of construction activities to the satisfaction of the Landscape Architect.
- Drawing may not be used for construction until signed by Landscape Architect as issued for construction.
- The accuracy of the position of utilities is not guaranteed.
- Individual utility co. must be contacted for confirmation of utility existence and location prior to digging.
- This drawing is an instrument of service and requires the permission of the Landscape Architect for use. Copyright is reserved by the Landscape Architect, David M. Lashley.

L1-1 LANDSCAPE NOTES

- Plant material shall be No. 1 Grade and shall comply with the Metric Guide Specifications for Nursery stock (latest edition), published by Canadian Nursery Trades Association.
- Plant substitutions shall not be permitted unless approved by the Landscape Architect.
- Obtain approval of planting prior to digging.
- Topsoil shall be garden soil mixture sandy loam with min. 5% organic matter and peat moss added at ratio of 1:10, topsoil to be approved by Landscape Architect.

| NO. | DATE       | DESCRIPTION             |
|-----|------------|-------------------------|
| 6   | 2019-10-17 | REVISED SPA SUBMISSION  |
| 5   | 2019-05-22 | REVISED SPA SUBMISSION  |
| 4   | 2019-04-11 | REVISED SPA SUBMISSION  |
| 3   | 2018-08-28 | REVISED SPA SUBMISSION  |
| 2   | 2018-01-31 | ISSUED FOR SPA          |
| 1   | 2017-12-01 | ISSUED FOR COORDINATION |

| NO.   | DATE | DESCRIPTION |
|-------|------|-------------|
| SEAL: |      |             |
|       |      |             |



CONSULTANT:

PROJECT:  
**CIOT  
SHOWROOM & WAREHOUSE**  
2400 RUSSEL ROAD  
OTTAWA, ONTARIO

DRAWING TITLE:  
LANDSCAPE PLAN

|                |            |              |
|----------------|------------|--------------|
| DATE:          | 2018/07/27 | DRAWING NO.: |
| SCALE:         | AS NOTED   |              |
| DRAWN BY:      | RP / JC    |              |
| LA PROJECT NO. | 17686-1    |              |

L-1



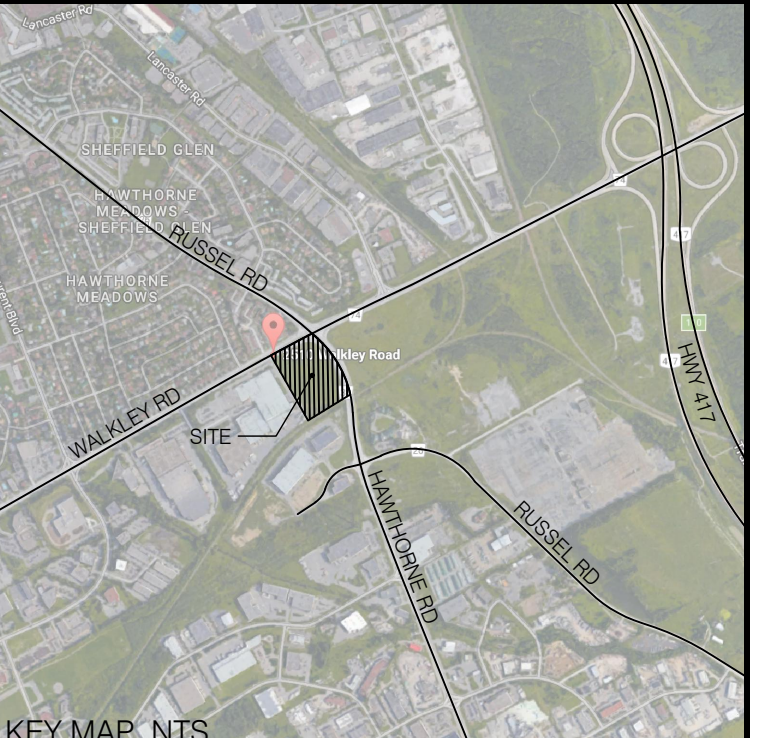
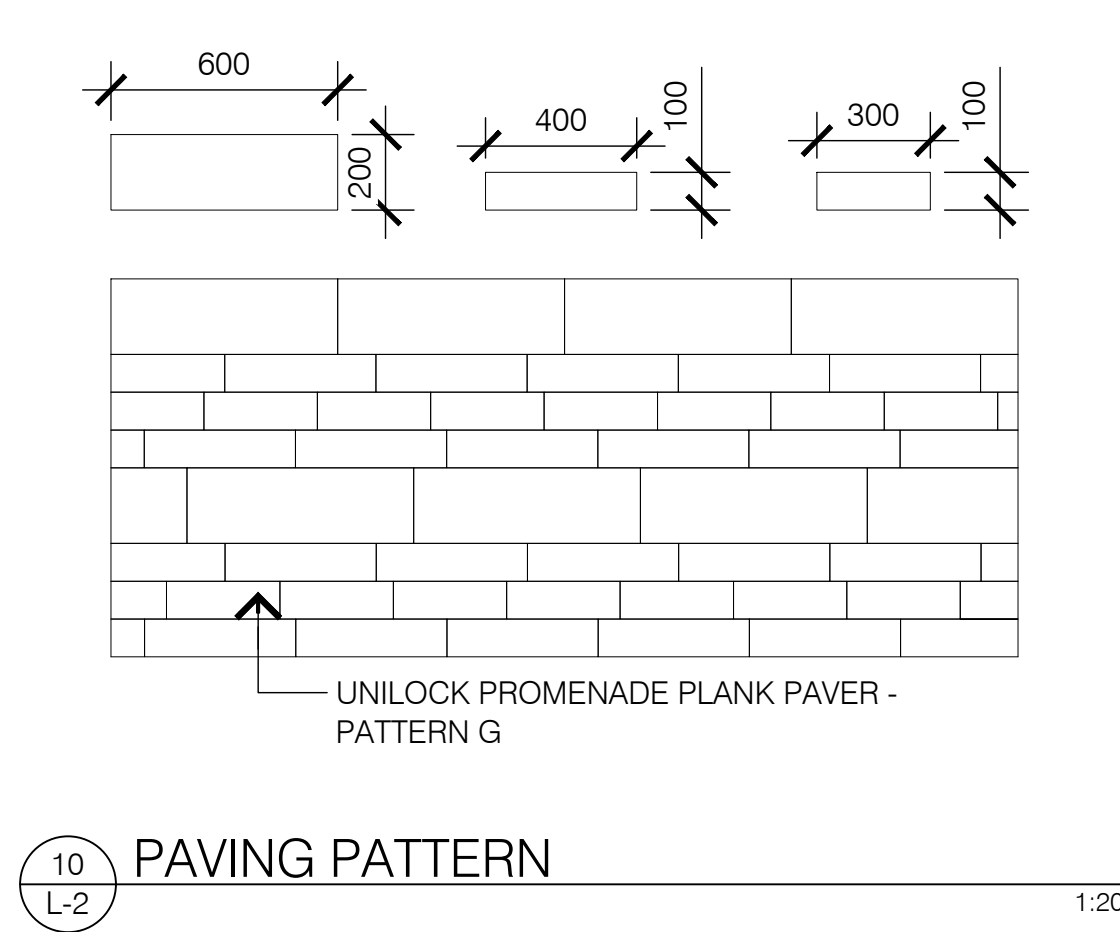
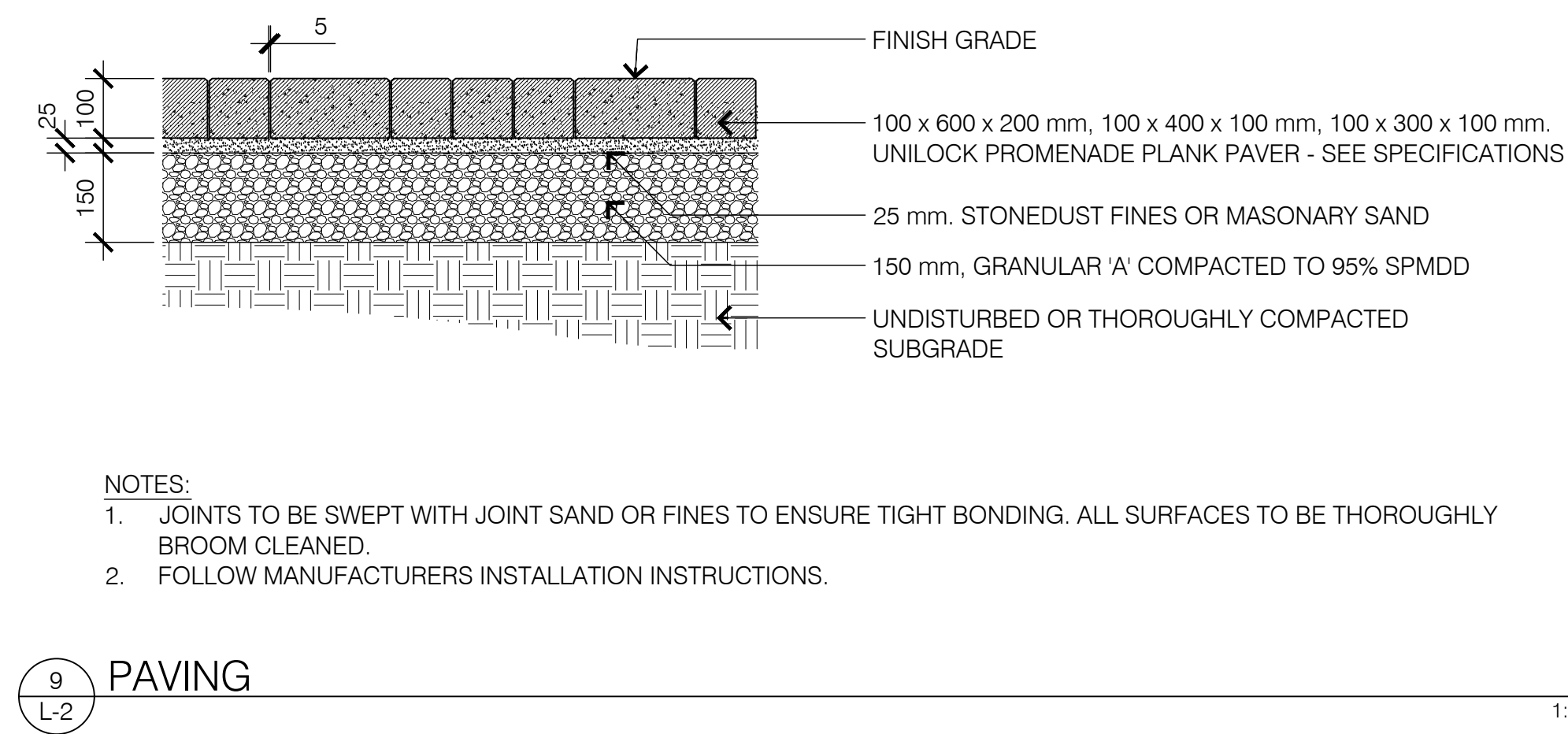
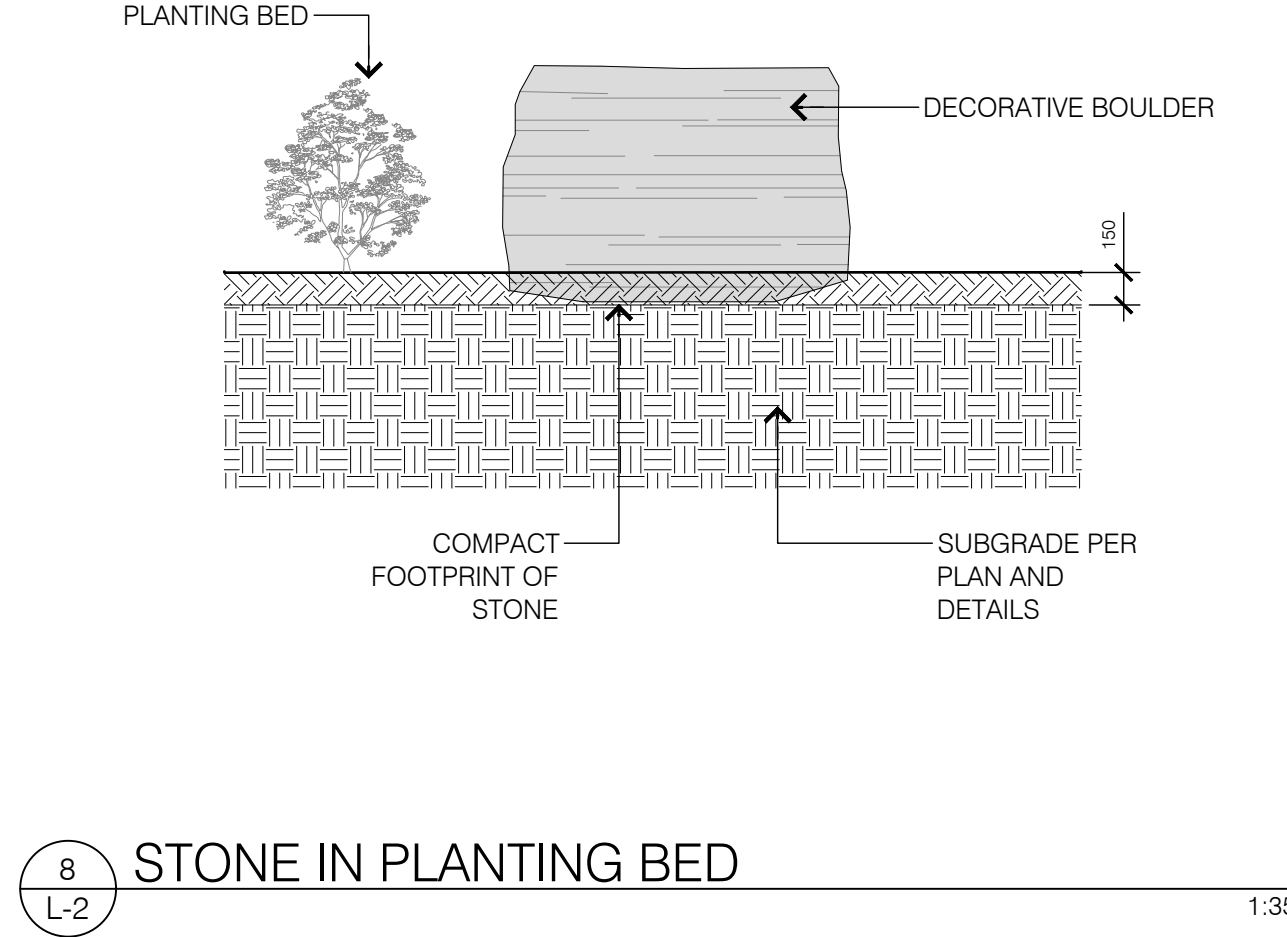
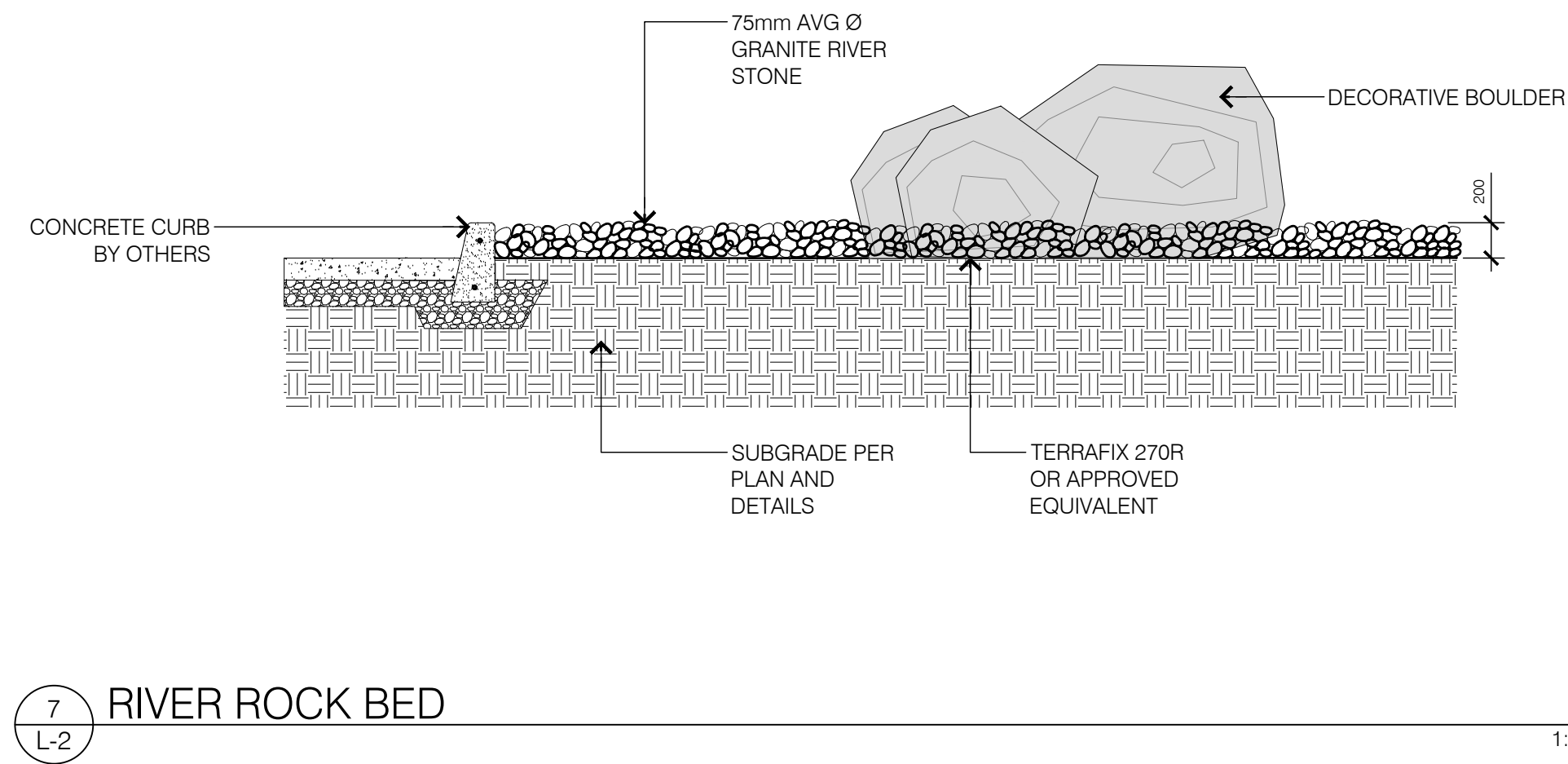
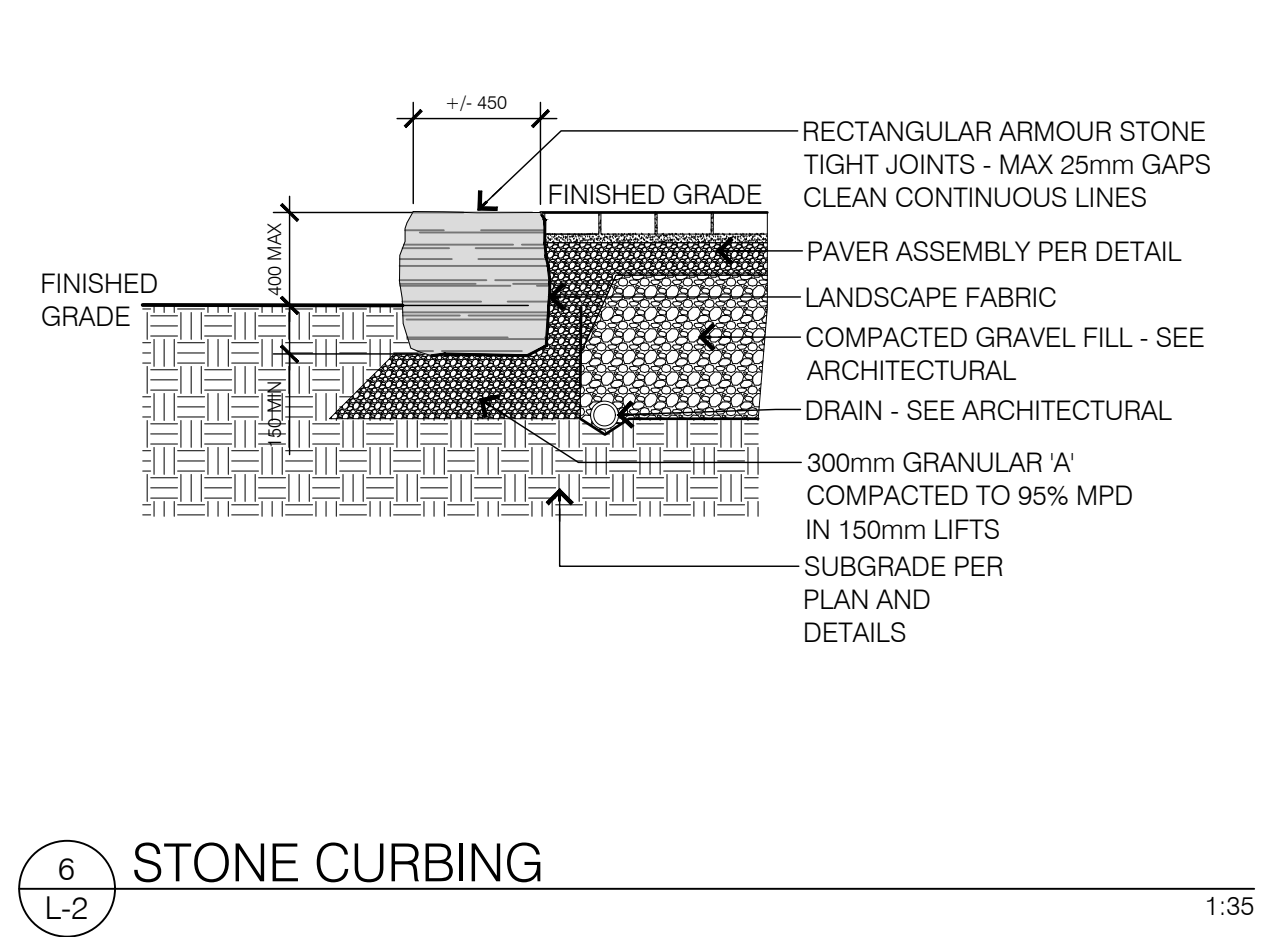
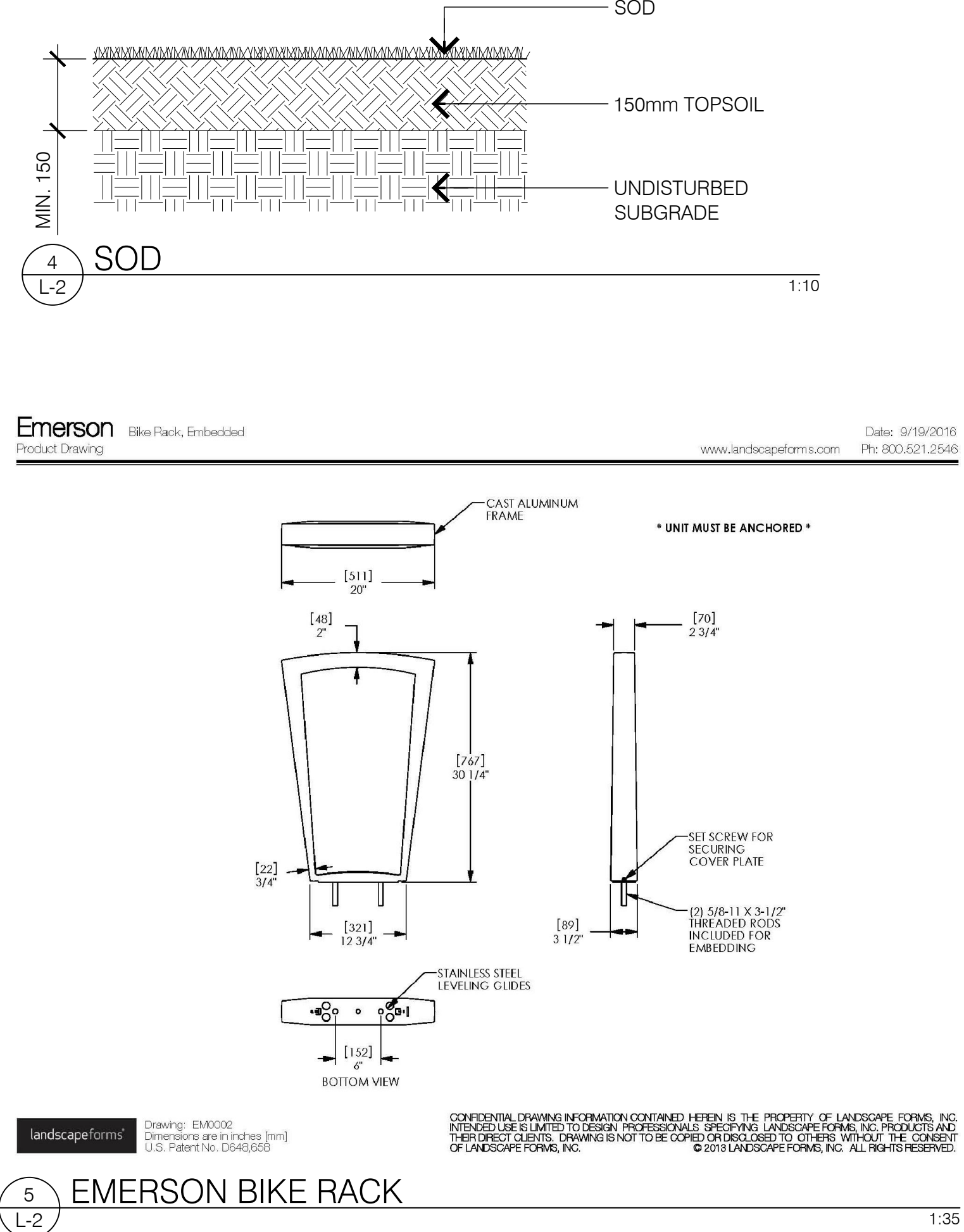
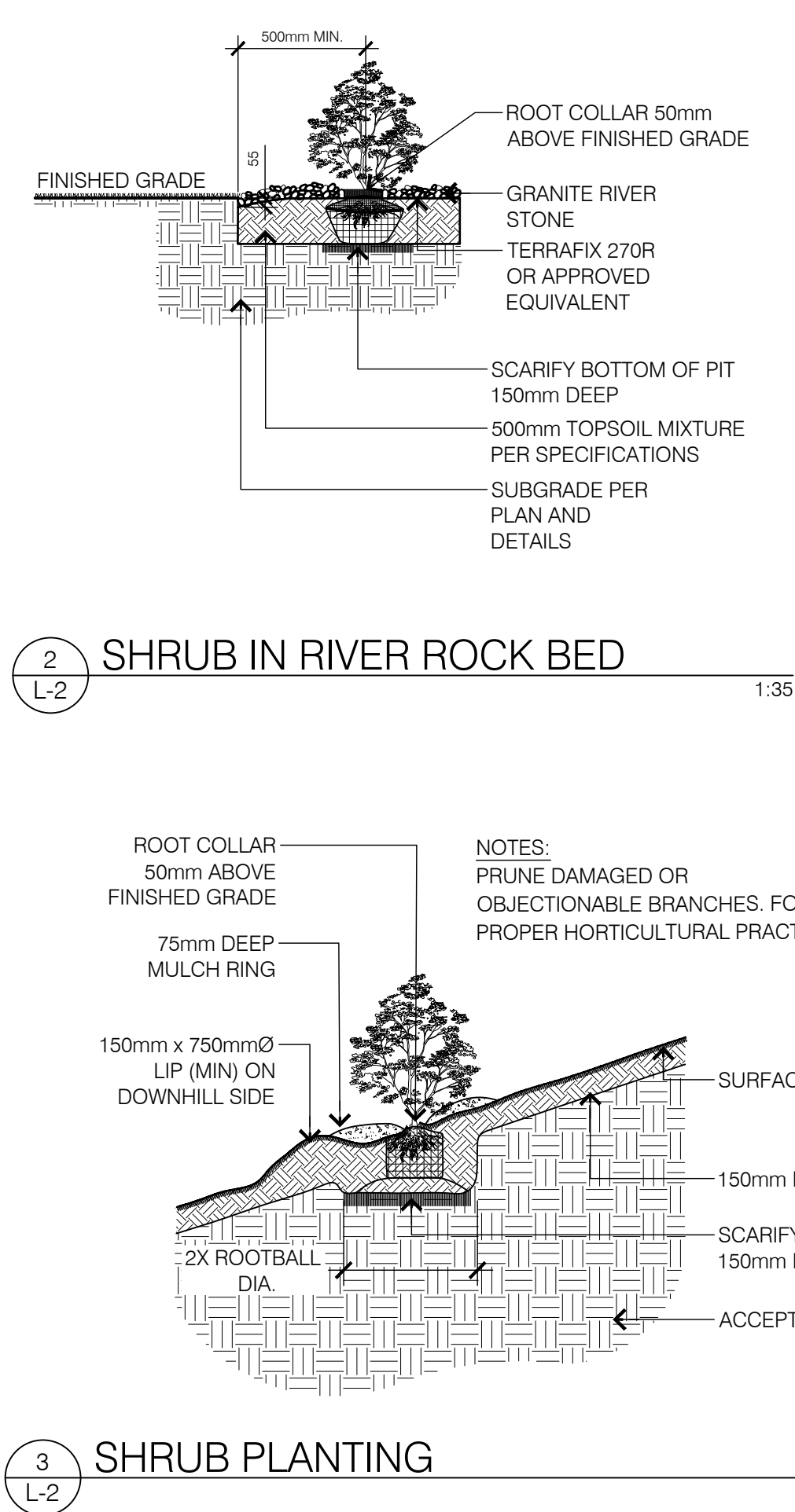
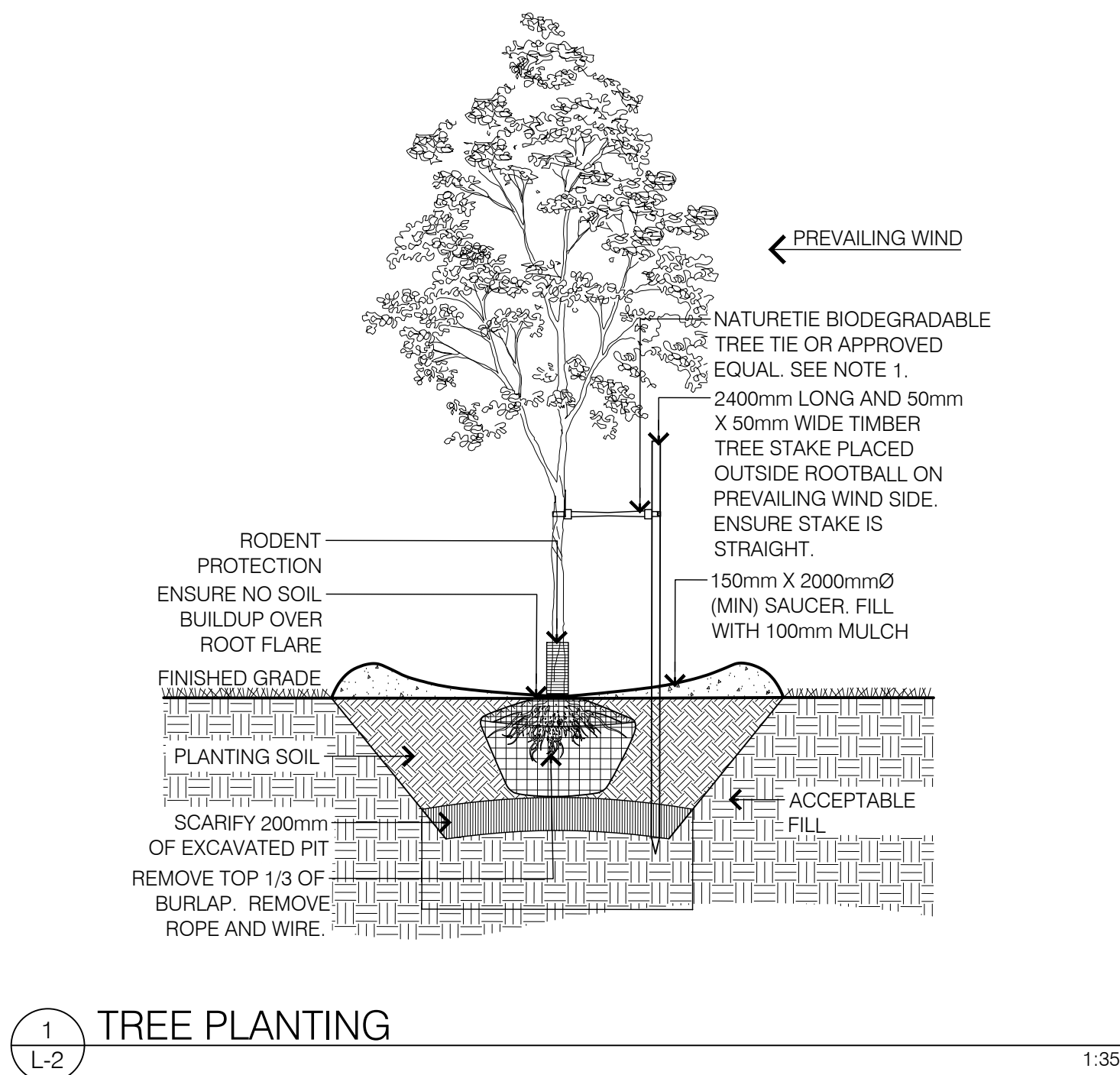

- L1-1 GENERAL NOTES**
- All general site information and conditions compiled from architect's and engineer's plans and surveys.
  - Do not scale this drawing.
  - Report any discrepancies prior to commencing work. No responsibility is born by the Landscape Architect for unknown subsurface conditions.
  - Reinstate all areas and items damaged as a result of construction activities to the satisfaction of the Landscape Architect.
  - Drawing may not be used for construction until signed by Landscape Architect as issued for construction.
  - The accuracy of the position of utilities is not guaranteed.
  - Individual utility co. must be contacted for confirmation of utility existence and location prior to digging.
  - This drawing is an instrument of service and requires the permission of the Landscape Architect for use. Copyright is reserved by the Landscape Architect, David M. Lashley.

- L1-1 LANDSCAPE NOTES**
- Plant material shall be No. 1 Grade and shall comply with the Metric Guide Specifications for Nursery stock (latest edition), published by Canadian Nursery Trades Association.
  - Plant substitutions shall not be permitted unless approved by the Landscape Architect.
  - Obtain approval of planting prior to digging.
  - Topsoil shall be garden soil mixture sandy loam with min. 5% organic matter and peat moss added at ratio of 1:10, topsoil to be approved by Landscape Architect.

|   |            |                         |
|---|------------|-------------------------|
| 6 | 2019-10-17 | REVISED SPA SUBMISSION  |
| 5 | 2019-05-22 | REVISED SPA SUBMISSION  |
| 4 | 2019-04-11 | REVISED SPA SUBMISSION  |
| 3 | 2018-08-28 | REVISED SPA SUBMISSION  |
| 2 | 2018-01-31 | ISSUED FOR SPA          |
| 1 | 2017-11-17 | ISSUED FOR COORDINATION |

| NO.   | DATE | DESCRIPTION |
|-------|------|-------------|
| SEAL: |      | NORTH:      |

**LASHLEY + ASSOCIATES**  
LANDSCAPE ARCHITECTURE AND SITE ENGINEERING  
202 860 OLIVASTONE AVENUE  
OTTAWA, ON K1Y 0E6  
T 613 283 8879  
F 613 283 8881  
W LashleyA.com  
E David.LashleyA.com

**CONSULTANT:**

**PROJECT:**

**CIOT**  
**SHOWROOM & WAREHOUSE**  
2400 RUSSEL ROAD  
OTTAWA, ONTARIO

**DRAWING TITLE:**

DETAILS

**LILY XU, MCIP, RPP**  
**(A) MANAGER, DEVELOPMENT REVIEW - SOUTH**  
**PLANNING, INFRASTRUCTURE & ECONOMIC**  
**DEVELOPMENT DEPARTMENT, CITY OF OTTAWA**

**APPROVED**  
By Lily Xu at 10:41 am, Jan 29, 2020

|                       |            |                     |
|-----------------------|------------|---------------------|
| <b>DATE:</b>          | 2018/07/27 | <b>DRAWING NO.:</b> |
| <b>SCALE:</b>         | AS NOTED   |                     |
| <b>DRAWN BY:</b>      | RP / JC    |                     |
| <b>LA PROJECT NO.</b> | 17686-1    |                     |

**L-2**