



SOMA PRO DESIGNS - BCIN#: 33578
2030 WOODCREST RD.
OTTAWA, ON. K1H 6H8

FERNANDO MATOS - BCIN#: 22431
613-884-4425

QUALIFICATION INFO
SMALL BUILDINGS
The undersigned has reviewed and takes responsibility for this design, and has the qualifications and meets the requirements set out in the Ontario Building Code to be a designer.

Fernando Matos
RESPONSIBILITIES:
DO NOT SCALE DRAWINGS
ALL DESIGN AND CONSTRUCTION TO BE IN ACCORDANCE WITH THE ONTARIO BUILDING CODE 2012
ALL CONTRACTORS MUST WORK IN ACCORDANCE WITH ALL LAWS, REGULATIONS AND BYLAWS HAVING JURISDICTION
IT IS THE RESPONSIBILITY OF THE APPROPRIATE CONTRACTOR TO CHECK AND VERIFY ALL DIMENSIONS ON SITE AND REPORT ALL ERRORS AND OMISSIONS TO THE ARCHITECT/DESIGNER.
COPYRIGHT RESERVED
GENERAL NOTES:

994 BRONSON AVENUE
NEW THREE STOREY, 13 UNITS
LOW RISE RESIDENTIAL

CONSULTANTS:
STRUCTURAL -
MECHANICAL -
ELECTRICAL -

NO.	REVISION/ISSUE	DATE
9		
8		
7		
6		
5		
4		
3		
2		
1		

PROJECT:
994 BRONSON AVENUE
NEW THREE STOREY
LOW RISE RESIDENTIAL
994 BRONSON AVENUE
OTTAWA, ON K1H 6H8

PROPOSED
SIDE (SOUTH) ELEVATION

DRAWN BY: L.T.
DATE: FEB 21, 2017
SCALE: AS NOTED

SHEET:
A8

NOTES

- 1 BRICK VENEER EXTERIOR FINISH
- 2 CEMENT BOARD PANEL FINISH
- 3 CEMENT PARGING
- 4 METAL CLADDING
- 5 STONE VENEER

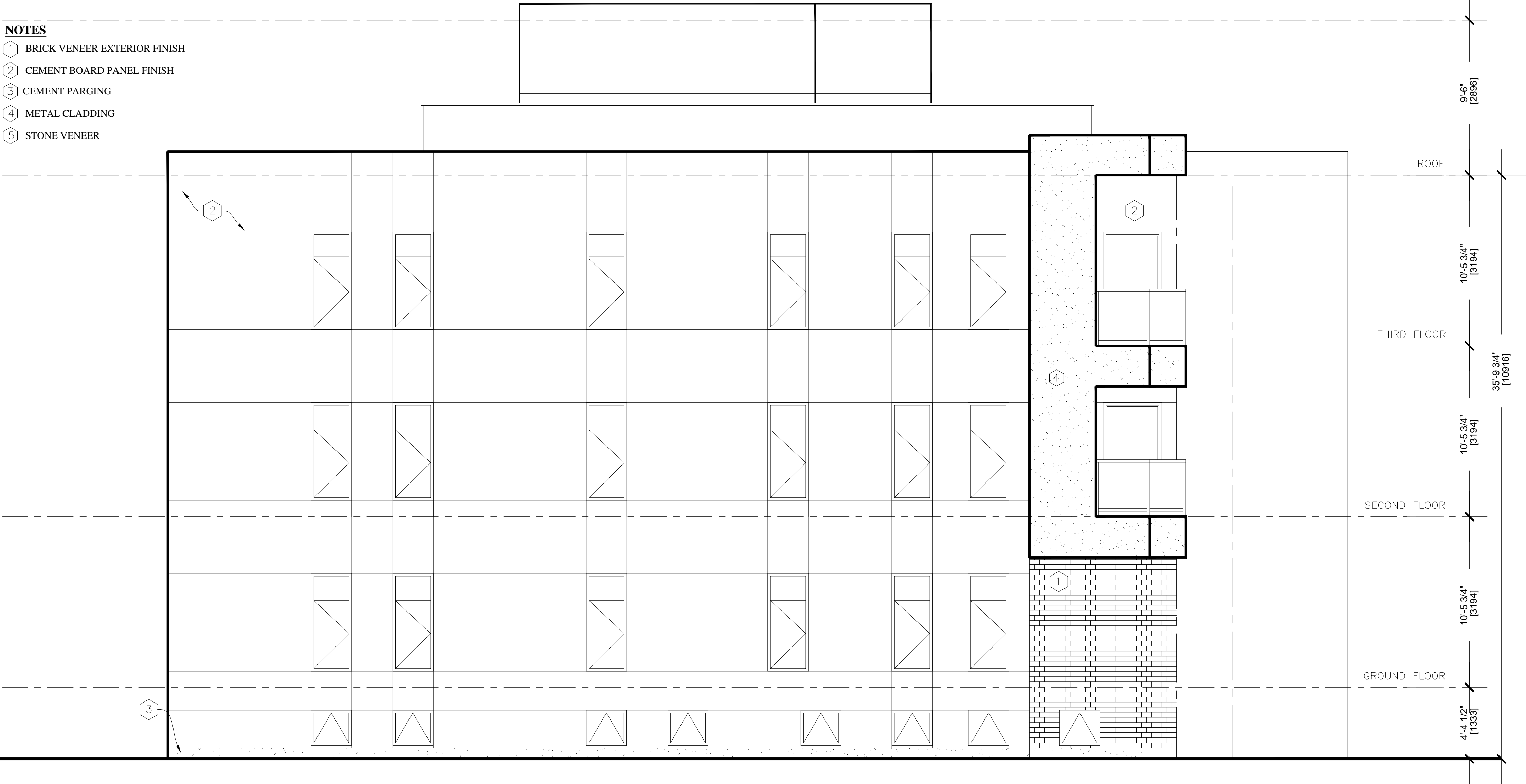

1 A8 PROPOSED SIDE (SOUTH) ELEVATION
SCALE: 1/4"=1'-0"