

SITE PLAN PROVIDED BY THE
CLIENT AND PREPARED BY
PETROFF PARTNERSHIP
ARCHITECTS

AREA OF WORK

1 KEY PLAN
A0.0 SCALE: 1:1000

LIST OF DRAWINGS:
ARCHITECTURAL
paul marques
architect inc
TEL. (647) 352-2121

ARCHITECTURAL

- A0.0 COVER PAGE, DRAWING LIST AND KEY PLAN
- A0.1 OBC DATA MATRIX
- A1.0 SITE PLAN
- A1.1 SITE DETAILS
- A2.1 FLOOR PLAN- BUILDING "W" (LCBO)
- A2.2 FLOOR PLAN- BUILDING "Y"
- A2.3 FLOOR PLAN- BUILDING "X"
- A4.1 ELEVATIONS BUILDING "W"
- A4.2 ELEVATIONS BUILDING "W"
- A4.3 ELEVATIONS BUILDING "X"
- A4.4 ELEVATIONS BUILDING "X"
- A4.5 ELEVATIONS BUILDING "Y"

2 DRAWING LIST
A0.0 SCALE: N/A

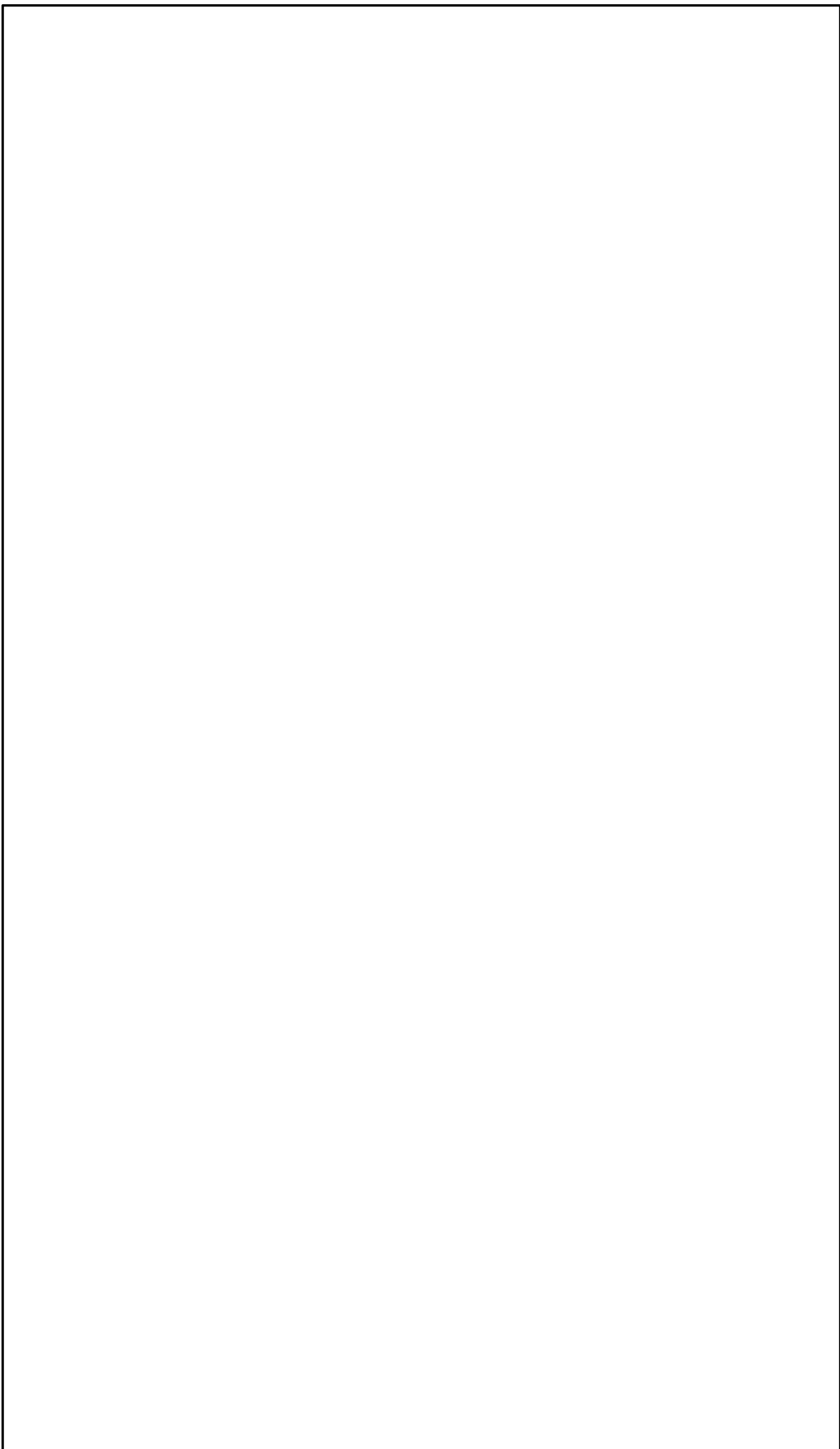

3 NOT USED
A0.0 SCALE: NTS



This drawing, as an instrument of service, is provided by and is the property of Paul Marques Architect Inc. The contractor must verify and accept responsibility for all dimensions and conditions on site and must notify Paul Marques Architect Inc. of any variations from the supplied information. This drawing is not to be scaled. The architect is not responsible for the accuracy of survey, structural, mechanical, electrical, etc., information shown on this drawing. Refer to the appropriate consultant's drawings before proceeding with the work. Construction must conform to all applicable codes and requirements of authorities having jurisdiction. The contractor working from drawings not specifically marked 'For Construction' must assume full responsibility and bear costs for any corrections or damages resulting from his work.

REV.	ISSUED FOR:	DATE:
1	CLIENT REVIEW	10/22/2019
3	CLIENT REVIEW	11/12/2019
4	CLIENT REVIEW	11/19/2019
5	SITE PLAN APPROVAL	11/19/2019
6	SITE PLAN APPROVAL	01/24/2020

paul marques
architect inc
2610 WESTON ROAD, #207
NORTH YORK, ONTARIO
M9N 2B1
TEL: 647.352.2121



Project:
BUILDING "W", "X" AND "Y"

1140 TERRY FOX DRIVE. KANATA, ON.

Drawing Name :

COVER PAGE, DRAWING
LIST AND KEY PLAN

Proj no.: 19-846 Date : OCTOBER 2019

Drawn by: NV Scale : AS NOTED

Checked by: PM

North : Drawing No :

A0.0

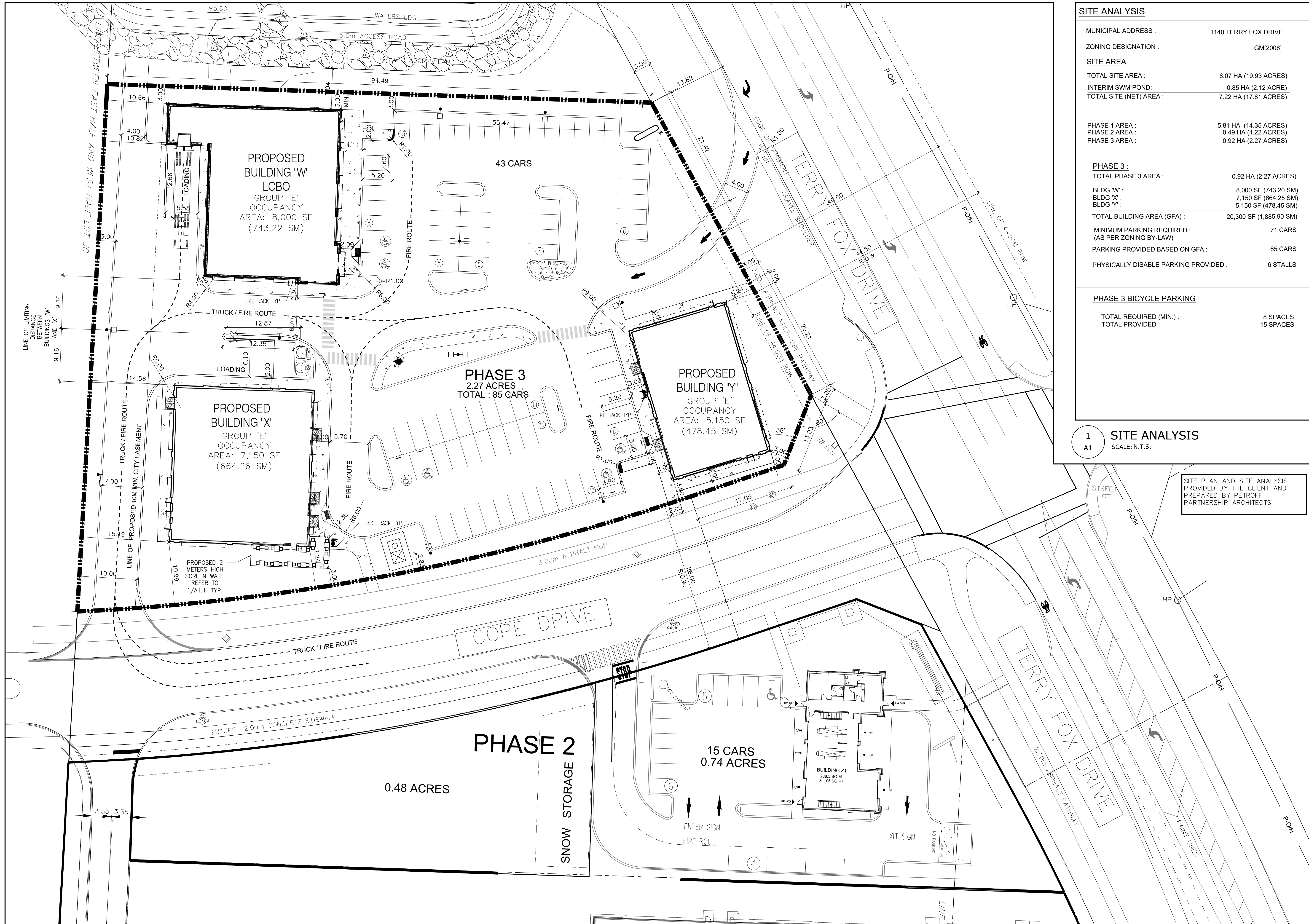

SITE ANALYSIS

MUNICIPAL ADDRESS : 1140 TERRY FOX DRIVE
ZONING DESIGNATION : GM(2006)
SITE AREA
TOTAL SITE AREA : 8.07 HA (19.93 ACRES)
INTERIM SWM POND: 0.85 HA (2.12 ACRE)
TOTAL SITE (NET) AREA : 7.22 HA (17.81 ACRES)

PHASE 1 AREA : 5.81 HA (14.35 ACRES)
PHASE 2 AREA : 0.49 HA (1.22 ACRES)
PHASE 3 AREA : 0.92 HA (2.27 ACRES)

PHASE 3 :
TOTAL PHASE 3 AREA : 0.92 HA (2.27 ACRES)
BLDG 'W' : 8,000 SF (743.20 SM)
BLDG 'X' : 7,150 SF (664.25 SM)
BLDG 'Y' : 5,150 SF (478.45 SM)
TOTAL BUILDING AREA (GFA) : 20,300 SF (1,885.90 SM)
MINIMUM PARKING REQUIRED : 71 CARS
(AS PER ZONING BY-LAW)
PARKING PROVIDED BASED ON GFA : 85 CARS
PHYSICALLY DISABLE PARKING PROVIDED : 6 STALLS

PHASE 3 BICYCLE PARKING

TOTAL REQUIRED (MIN.) : 8 SPACES
TOTAL PROVIDED : 15 SPACES

1 SITE ANALYSIS
A1 SCALE: N.T.S.

SITE PLAN AND SITE ANALYSIS
PROVIDED BY THE CLIENT AND
PREPARED BY PETROFF
PARTNERSHIP ARCHITECTS



This drawing, as an instrument of service, is provided by and is the property of Paul Marques Architect Inc. The contractor must verify and accept responsibility for all dimensions and conditions on site and must notify Paul Marques Architect Inc. of any variations from the supplied information. This drawing is not to be scaled. The architect is not responsible for the accuracy of survey, structural, mechanical, electrical, etc., information shown on this drawing. Refer to the appropriate consultant's drawings before proceeding with the work. Construction must conform to all applicable codes and requirements of authorities having jurisdiction. The contractor working from drawings not specifically marked 'For Construction' must assume full responsibility and bear costs for any corrections or damages resulting from his work.

REV.	ISSUED FOR:	DATE:
1	CLIENT REVIEW	10/22/2019
3	CLIENT REVIEW	11/12/2019
4	CLIENT REVIEW	11/19/2019
5	SITE PLAN APPROVAL	11/19/2019
6	SITE PLAN APPROVAL	01/24/2020

paul marques
architect inc
2610 WESTON ROAD, #207
NORTH YORK, ONTARIO
M9N 2B1
TEL: 647.852.2121



Project : BUILDING "W", "X" AND "Y"

1140 TERRY FOX DRIVE, KANATA, ON.

Drawing Name :

SITE PLAN

Proj no. : 19-846 Date : OCTOBER 2019
Drawn by : NV Scale : AS NOTED
Checked by : PM

North : Drawing No :

A1.0



4 NOT USED
A1.1 SCALE: N/A



2 NOT USED
A1.1 SCALE: N/A



3 NOT USED
A1.1 SCALE: N/A

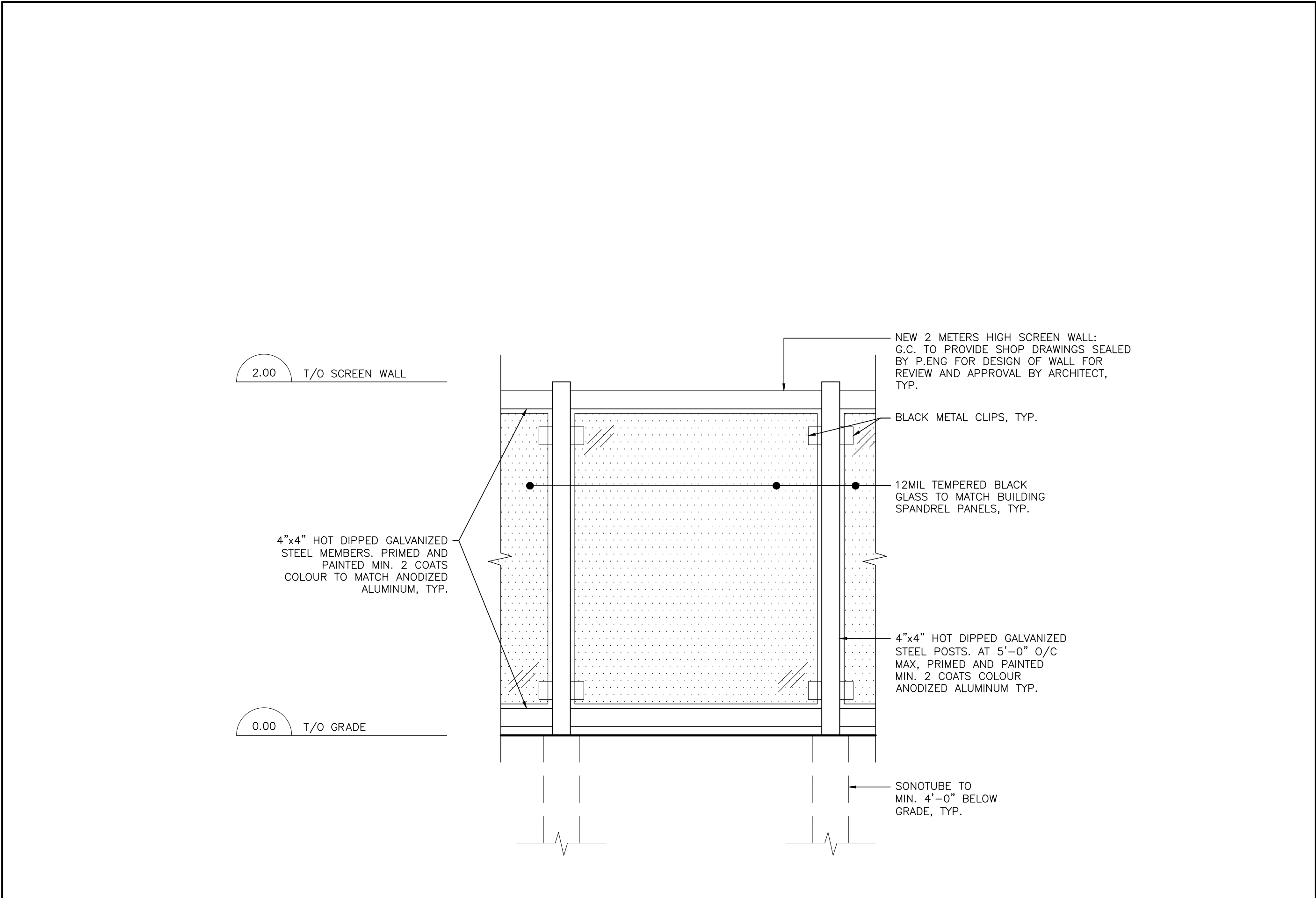

1 SCREEN WALL DETAIL - PATIO SCREEN BUILDING X
A1.1 SCALE: 1:20

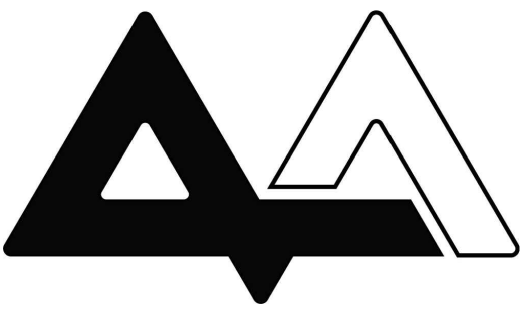

This drawing, as an instrument of service, is provided by and is the property of Paul marques Architect Inc. The contractor must verify and accept responsibility for all dimensions and conditions on site and must notify Paul Marques Architect Inc. of any variations from the supplied information. This drawing is not to be scaled. The architect is not responsible for the accuracy of survey, structural, mechanical, electrical, etc., information shown on this drawing. Refer to the appropriate consultant's drawings before proceeding with the work. Construction must conform to all applicable codes and requirements of authorities having jurisdiction. The contractor working from drawings not specifically marked 'For Construction' must assume full responsibility and bear costs for any corrections or damages resulting from his work.

REV.	ISSUED FOR:	DATE:
6	SITE PLAN APPROVAL	01/24/2020

paul marques
architect inc
2610 WESTON ROAD, #207
NORTH YORK, ONTARIO
M9N 2B1
TEL: 647.362.2121



Project :
BUILDING "W", "X" AND "Y"

1140 TERRY FOX DRIVE. KANATA, ON.

Drawing Name :

SITE DETAILS

Proj no. :	19-846	Date :	OCTOBER 2019
Drawn by :	NV	Scale :	AS NOTED
Checked by :	PM		
North :		Drawing No :	

A1.1