

1. ALL TOPSOIL AND ORGANIC MATERIAL TO BE STRIPPED FROM WITHIN THE FULL RIGHT OF WAY PRIOR TO CONSTRUCTION.
2. SUB-EXCAVATE SOFT AREAS & FILL WITH GRANULAR 'B' COMPACTED IN 0.30m LAYERS.
3. ALL GRANULAR FOR ROADS SHALL BE COMPACTED TO A MINIMUM OF 100% STANDARD PROCTOR MAXIMUM DRY DENSITY (SPMD).
4. ROAD SUBDRAINS SHALL BE CONSTRUCTED AS PER CITY OF OTTAWA STANDARD R1.
5. ASPHALT WEAR COURSE SHALL NOT BE PLACED UNTIL THE VIDEO INSPECTION OF SEWERS & NECESSARY REPAIRS HAVE BEEN CARRIED OUT TO THE SATISFACTION OF THE CONSULTANT.
6. CONTRACTOR TO OBTAIN A ROAD OCCUPANCY PERMIT 48 HOURS PRIOR TO COMMENCING ANY WORK WITHIN THE MUNICIPAL ROAD ALLOWANCE IF REQUIRED BY THE MUNICIPALITY. ALL WORK ON THE MUNICIPAL RIGHT OF WAY AND EASEMENTS TO BE INSPECTED BY THE MUNICIPALITY PRIOR TO BACKFILLING.
7. PAVEMENT REINSTATEMENT FOR SERVICE AND UTILITY CUTS SHALL BE IN ACCORDANCE WITH CITY OF OTTAWA STANDARD R10, AND OPSD 509.01, AND OPSD 510.
8. CONCRETE CURBS SHALL BE CONSTRUCTED AS PER CITY STANDARD SC1.1.
9. CONCRETE SIDEWALKS SHALL BE CONSTRUCTED AS PER CITY STANDARD SC1.4.
10. PAVEMENT CONSTRUCTION AS PER GEOTECHNICAL INVESTIGATION 191-0634-00 PREPARED BY WSP DATE MAY 2019.

1. ALL GRANULAR BASE & SUB BASE COURSE MATERIALS SHALL BE COMPACTED TO 98% STANDARD PROCTOR MAX. DRY DENSITY.
2. SUB-EXCAVATE SOFT AREAS & FILL WITH GRANULAR R COMPACTED IN 0.30m LAYERS.
3. ALL DISTURBED GRASSED AREAS SHALL BE RESTORED TO ORIGINAL CONDITION BETTER WITH SOIL ON MIN. 100mm TOPSOIL. THE REMOVAL OF TREES AND SHRUBS SHALL BE SUBJECT TO APPROVAL BY THE PROJECT LANDSCAPE ARCHITECT OR ENGINEER.
4. EMBANKMENTS TO BE SLOPED AT MIN. 3:1 UNLESS OTHERWISE SPECIFIED OTHERWISE NOTED. THE MINIMUM LONGITUDINAL SLOPE TO BE 1.5% OR 1.0% WHEN PERFORATED SUBDRAIN IS INSTALLED.
5. ALL SWALES TO BE MIN. 0.15m DEEP WITH MIN. 3:1 SIDE SLOPES UNLESS OTHERWISE NOTED.
6. TOP OF GRATE (T/G) ELEVATIONS FOR ALL STREET CATCHBASINS SHOWN ON PLANS. REFER TO THE ELEVATION AT EACH EDGE OF PAVEMENT, OR GUTTERLINE WHERE APPLICABLE.
7. ALL RETAINING WALLS GREATER THAN 1.0m IN HEIGHT ARE TO BE DESIGNED, APPROVED, AND STAMPED BY STRUCTURAL ENGINEER LICENSED IN THE PROVINCE OF ONTARIO.
8. FENCES OR RAILINGS ARE REQUIRED FOR RETAINING WALLS GREATER THAN 0.60m IN HEIGHT.
9. EXCESS EXCAVATED MATERIAL SHALL BE REMOVED FROM THE SITE.
10. ALL NECESSARY CLEARING AND GRUBBING SHALL BE COMPLETED BY THE CONTRACTOR. REVIEW WITH CONTRACT ADMINISTRATOR AND THE CITY OF OTTAWA PRIOR TO TREE CUTTING.
11. REFER TO DRAWING ECDS-1 FOR EROSION AND SEDIMENT CONTROL DETAILS.

40mm HL3 OR SUPERPAVE 12.5 ASPHALTIC CONCRETE  
90mm HL8 OR SUPERPAVE 19.0 ASPHALTIC CONCRETE  
200mm OPSS GRANULAR A BASE  
400mm OPSS GRANULAR B TYPE II

40mm HL8 OR SUPERPAVE 12.5 ASPHALTIC CONCRETE  
40mm HL8 OR SUPERPAVE 19.0 ASPHALTIC CONCRETE  
200mm OPSS GRANULAR A BASE  
250mm OPSS GRANULAR B TYPE II

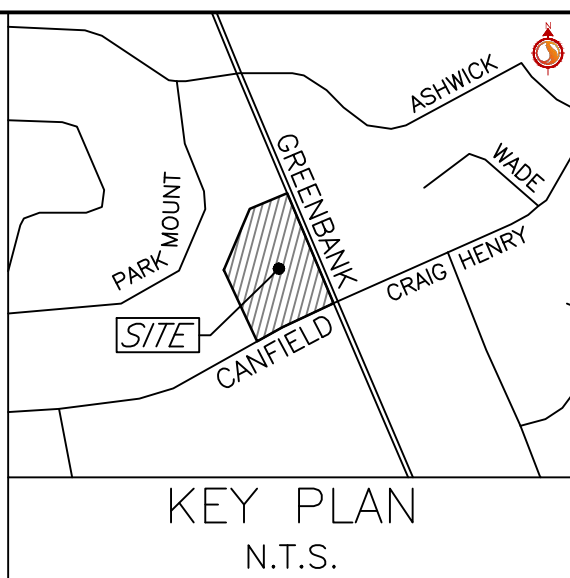

Stantec Consulting Ltd.  
400 - 1331 Clyde Avenue  
Ottawa ON  
Tel. 613.722.4420  
[www.stantec.com](http://www.stantec.com)

The Contractor shall verify and be responsible for all dimensions. DO NOT scale the drawing - any errors or omissions shall be reported to Stantec without delay.

The Copyrights to all designs and drawings are the property of Stantec. Reproduction or use for any purpose other than that authorized by Stantec is forbidden.

	ORIGINAL GROUND ELEVATION
	PROPOSED ELEVATION
	PROPOSED LOT CORNER ELEVATION
	EXISTING ELEVATION AT LOT CORNER
	FLOW DIRECTION AND GRADE
	FINISHED FIRST FLOOR ELEVATION
	UNDERGRADE OF FOOTING ELEVATION
	NUMBER OF TREES
	TERRACING 3:1 SLOPE MAXIMUM (UNLESS OTHERWISE SHOWN)
	PROPOSED SWALE
	DIRECTION OF OVERLAND FLOW
	PROPOSED VALVE BOX
	PROPOSED FIRE HYDRANT
	PROPOSED SANITARY SEWER MANHOLE
	PROPOSED STORM SEWER MANHOLE
	PROPOSED CATCHBASIN
	PROPOSED CATCHBASIN
	PROPOSED DEPRESSED CURB LOCATION
	MAXIMUM STATIC PONDING LIMITS
	PROPOSED RETAINING WALL
	PROPOSED HEAVY DUTY ASPHALT
	PROPERTY LINE
	EXISTING VALVE CHAMBER
	EXISTING FIRE HYDRANT
	EXISTING MANHOLE
	EXISTING CATCHBASIN
	PROPOSED ENTRANCE

1. SITE PLAN PREPARED BY N45 ARCHITECTURE INC. DATED NOVEMBER 29, 2019.
2. TOPOGRAPHIC SURVEY SUPPLIED BY STANTEC GEOMATICS LTD. DATED JUNE 15, 2019.  

SITE BENCHMARK #1  
TOP OF SPINDLE OF FIRE HYDRANT  
ELEV=89.14

SITE BENCHMARK #2  
TOP OF SPINDLE OF FIRE HYDRANT  
ELEV=89.735
3. GEOTECHNICAL REPORT 191-04634-00 PREPARED BY WSP DATED MAY 2019.

1 ISSUED FOR REVIEW	WAJ	AMP	19.11.27
Revision	By	Appd.	YY.MM.DD

File Name: 160410203\_DB.dwg

	Dwn.	Chkd.	Dsgn.	YY.MM.D
--	------	-------	-------	---------

Permit-Sea

Client/Project

ST. MARY'S COPTIC ORTHODOX CHURCH  
1 Canfield Road

PROPOSED ST. MARYS CHRISTIAN CHURCH

OTTAWA, ON

## GRADING PLAN

Project No. \_\_\_\_\_

160410203

Drawing No.

Scale 0 3 9 15



Sheet

Revision

1