

CONTRACTOR MUST CHECK & VERIFY ALL DIMENSIONS ON THE JOB.
DO NOT SCALE DRAWINGS.
ALL DRAWINGS, SPECIFICATIONS AND RELATED DOCUMENTS ARE THE COPYRIGHT PROPERTY OF THE ARCHITECT AND MUST BE RETURNED UPON REQUEST. REPRODUCTION OF DRAWINGS, SPECIFICATIONS AND RELATED DOCUMENTS IN PART OR IN WHOLE IS FORBIDDEN WITHOUT THE WRITTEN PERMISSION OF THE ARCHITECT.
THIS DRAWING IS NOT TO BE USED FOR CONSTRUCTION UNTIL SIGNED BY THE ARCHITECT.

MORRISON HERSFIELD
200-2932 BASELINE ROAD, OTTAWA, ON K2H 1B1

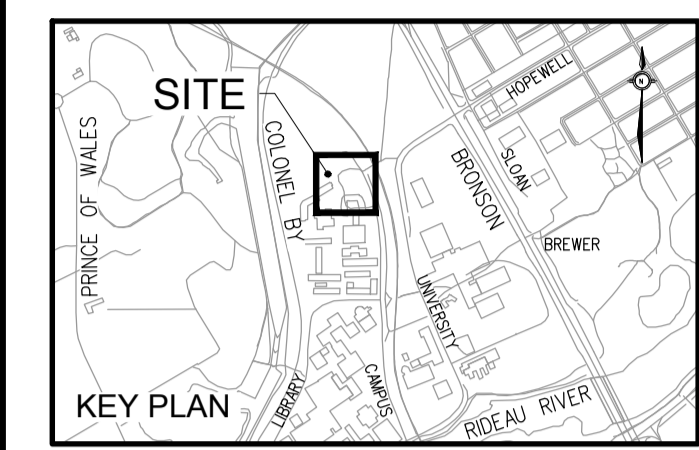

ISSUED

No.	Date	Description
1	13/12/2019	ISSUED FOR SITE PLAN APPROVAL

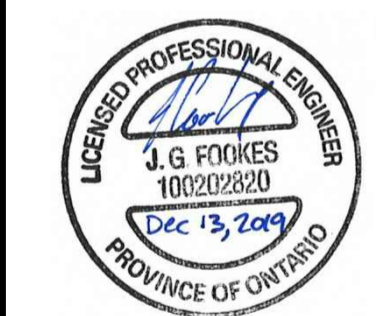

Diamond Schmitt Architects 384 Adelaide Street West, Suite 100, Toronto, Ontario M5V 1R7, Canada. Tel: 416 862 8800, Fax: 416 862 5508, info@dsai.ca, www.dsai.ca

KWC Architects Inc. 383 Parkdale Avenue, Suite 201, Ottawa, Ontario K1Y 4K4, Canada. Tel: 613 238 2117, Fax: 613 238 6595, kw@kwc-arch.com, www.kwc-arch.com

CARLETON UNIVERSITY NEW STUDENT RESIDENCE

CARLETON UNIVERSITY
1125 COLONEL BY DRIVE
OTTAWA ON
K1S 5S6

EROSION AND SEDIMENT CONTROL PLAN

Scale: 1:200
Project No: 1952
Date: 12/13/19

C004

LEGEND

- LIGHT DUTY SILT FENCE BARRIER (PER OPSD 219.110)
- CATCH BASIN PROTECTION (SILTSACK WITHIN CB, OR SURROUND CB WITH SILT SOCK)

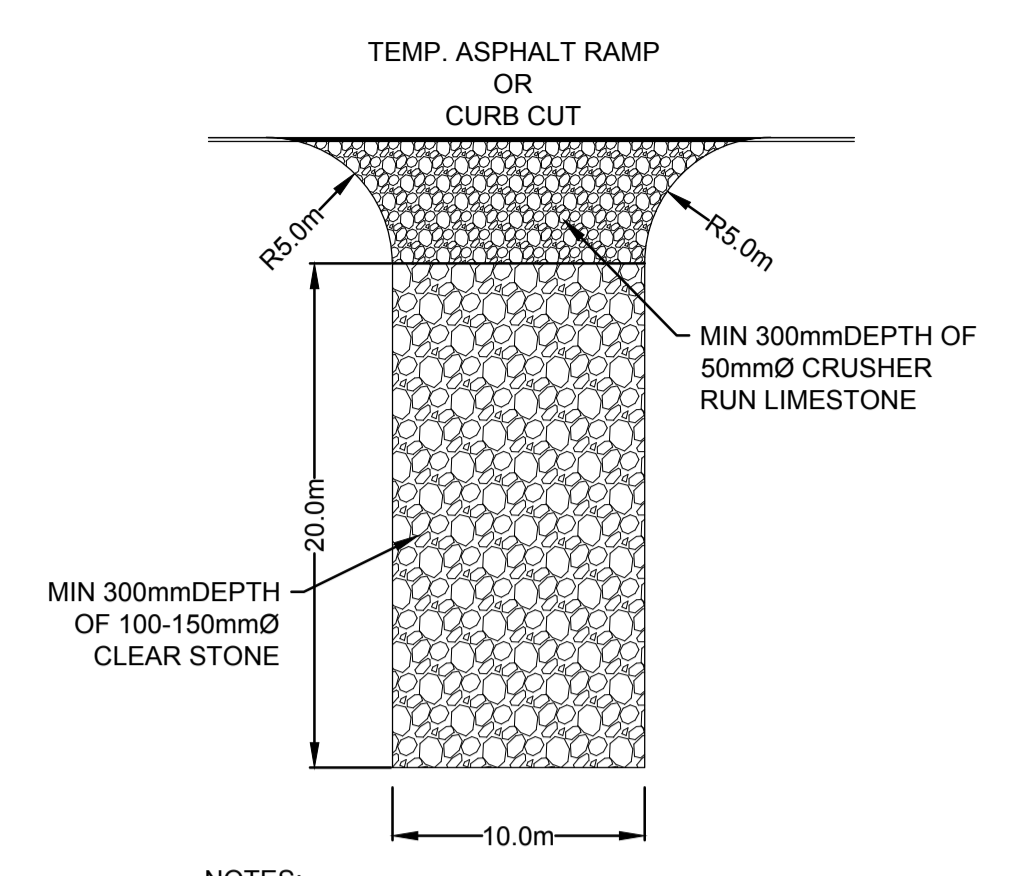

- NOTES:
- INSTALL AT ALL SITE ACCESS LOCATIONS.
 - TEMPORARY CONSTRUCTION ACCESS SHALL BE REMOVED ON COMPLETION OF THE WORK AND ALL DISTURBED AREAS SHALL BE RESTORED TO ORIGINAL OR BETTER CONDITION.

1 TEMPORARY ACCESS CONSTRUCTION
N.T.S.

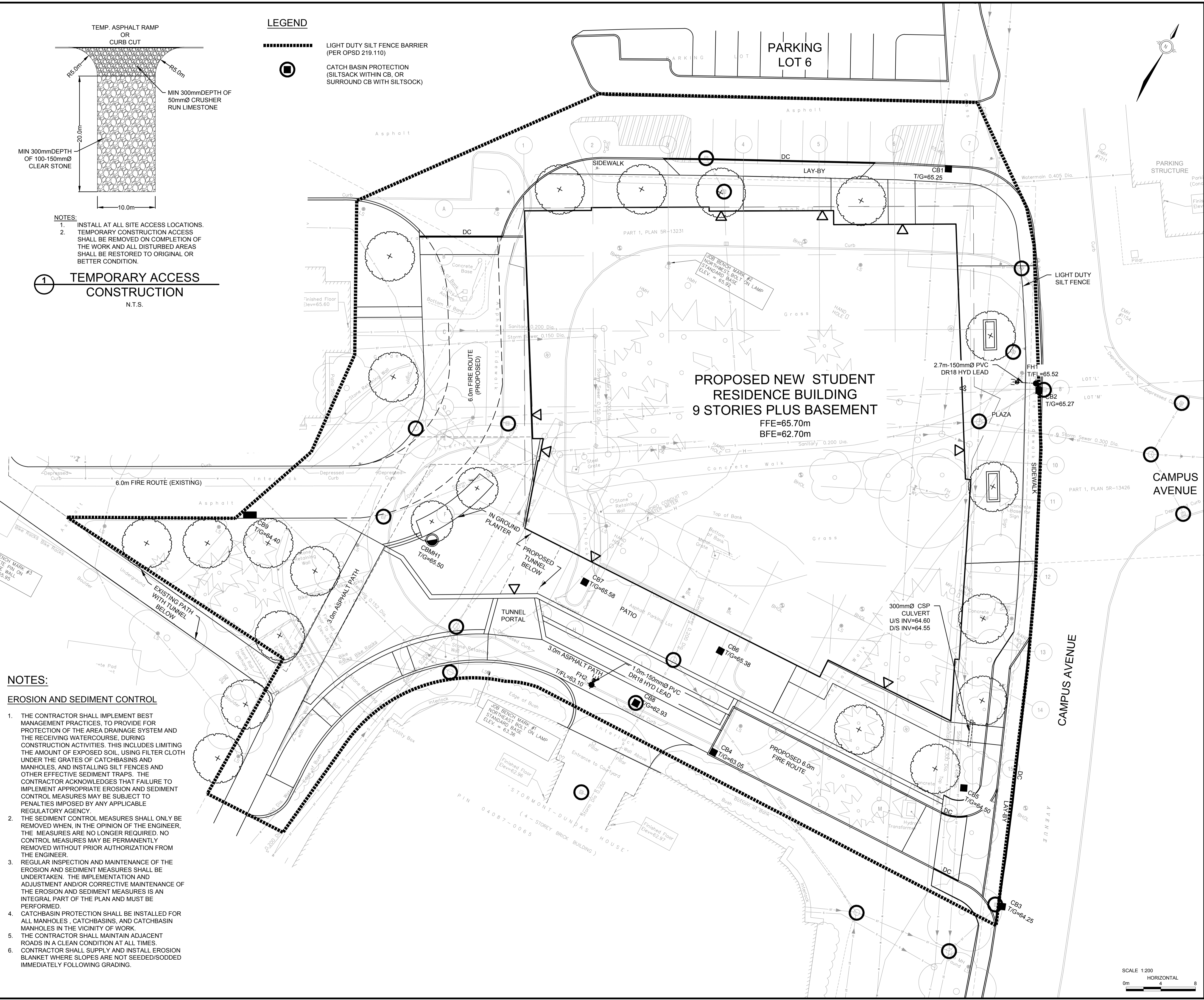

NOTES:

EROSION AND SEDIMENT CONTROL

- THE CONTRACTOR SHALL IMPLEMENT BEST MANAGEMENT PRACTICES, TO PROVIDE FOR PROTECTION OF THE AREA DRAINAGE SYSTEM AND THE RECEIVING WATERCOURSE, DURING CONSTRUCTION ACTIVITIES. THIS INCLUDES LIMITING THE AMOUNT OF EXPOSED SOIL, USING FILTER CLOTH UNDER THE GRATES OF CATCHBASINS AND MANHOLES, AND INSTALLING SILT FENCES AND OTHER EFFECTIVE SEDIMENT TRAPS. THE CONTRACTOR ACKNOWLEDGES THAT FAILURE TO IMPLEMENT APPROPRIATE EROSION AND SEDIMENT CONTROL MEASURES MAY BE SUBJECT TO PENALTIES IMPOSED BY ANY APPLICABLE REGULATORY AGENCY.
- THE SEDIMENT CONTROL MEASURES SHALL ONLY BE REMOVED WHEN, IN THE OPINION OF THE ENGINEER, THE MEASURES ARE NO LONGER REQUIRED. NO CONTROL MEASURES MAY BE PERMANENTLY REMOVED WITHOUT PRIOR AUTHORIZATION FROM THE ENGINEER.
- REGULAR INSPECTION AND MAINTENANCE OF THE EROSION AND SEDIMENT MEASURES SHALL BE UNDERTAKEN. THE IMPLEMENTATION AND ADJUSTMENT AND/OR CORRECTIVE MAINTENANCE OF THE EROSION AND SEDIMENT MEASURES IS AN INTEGRAL PART OF THE PLAN AND MUST BE PERFORMED.
- CATCHBASIN PROTECTION SHALL BE INSTALLED FOR ALL MANHOLES, CATCHBASINS, AND CATCHBASIN MANHOLES IN THE VICINITY OF WORK.
- THE CONTRACTOR SHALL MAINTAIN ADJACENT ROADS IN A CLEAN CONDITION AT ALL TIMES.
- CONTRACTOR SHALL SUPPLY AND INSTALL EROSION BLANKET WHERE SLOPES ARE NOT SEEDED/SODDED IMMEDIATELY FOLLOWING GRADING.

