

****TO BE ACCOMMODATED WITHIN THE INTERANAL MECHANICAL SYSTEM**
REFER TO DS-1 FOR NOTES

IVS CONNECTION TO EXISTING 400mm² WATERMAIN BY CITY FORCES. EXCAVATION AND REINSTATEMENT BY SITE SERVICING CONTRACTOR.
SAN CROSSING EX. WTR WTR INV=84.84 SAN OBV=82.96
BREAK INTO EX. 375mm SAN EX. SL=82.80 NEW INV=82.68
BREAK INTO EX. 3000mm STM EX. OBV=84.46 NEW INV=82.96
STM CROSSING EX. SAN SAN OBV=82.93 STM INV=83.23
STM CROSSING EX. WTR WTR INV=84.82 STM OBV=84.52

CODD'S ROAD

3.6m MULTI USE PATH
2.0m CONC. SIDEWALK

EXISTING CB TO BE REMOVED AND LEAD CAPPED AT PROPERTY LINE

HEMLOCK ROAD
1.75m BIKE PATH
2.0m CONC. SIDEWALK

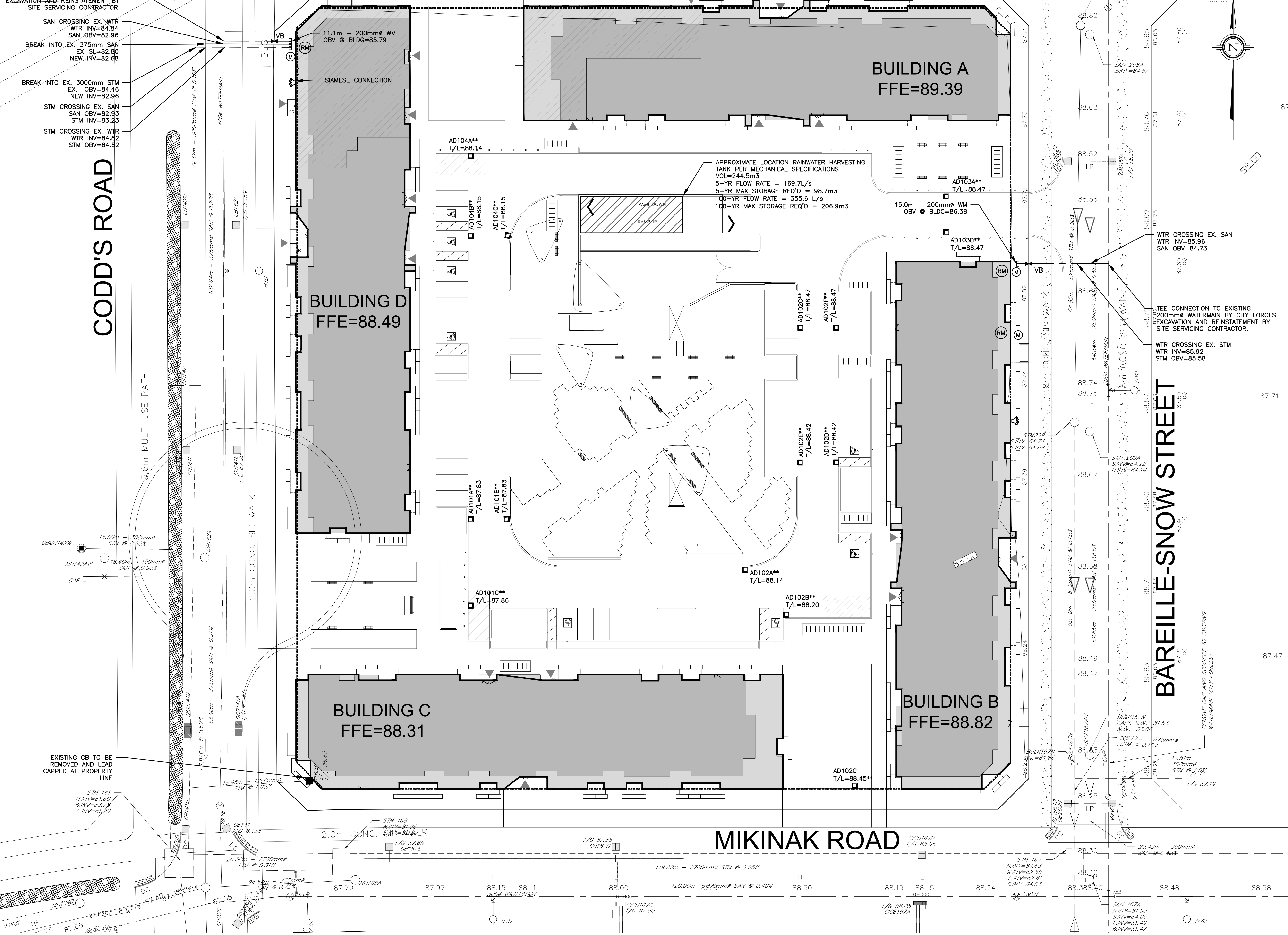

APPROXIMATE LOCATION RAINWATER HARVESTING TANK PER MECHANICAL SPECIFICATIONS
VOL=244.5m³
5-YR FLOW RATE = 169.7L/s
5-YR MAX STORAGE REQ'D = 98.7m³
100-YR FLDW RATE = 355.6 L/s
100-YR MAX STORAGE REQ'D = 206.9m³

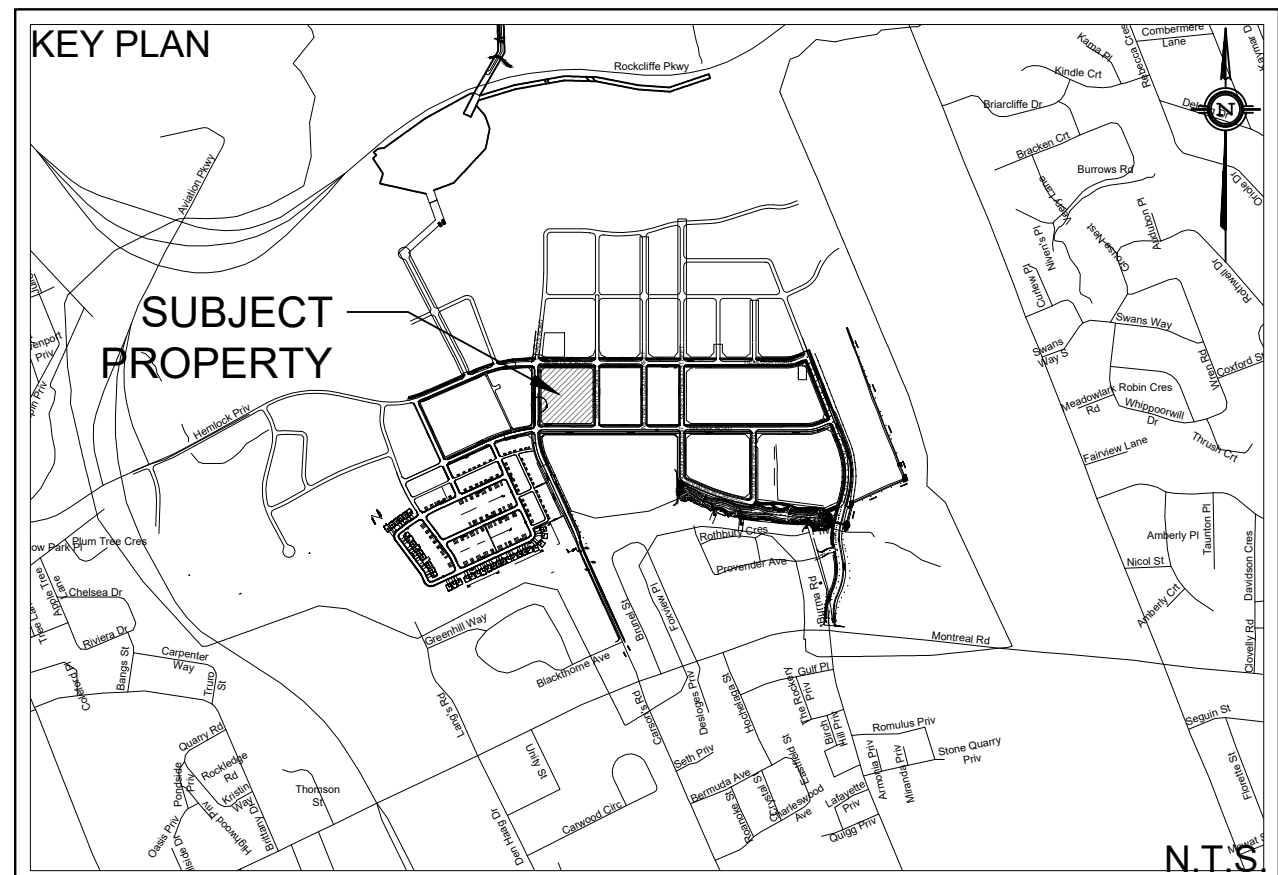

- LEGEND**
- PROPERTY LINE
 - PROPOSED WATERMAIN
 - PROPOSED SANITARY SEWER
 - PROPOSED STORM SEWER
 - PROPOSED PERFORATED SUBDRAIN
 - PROPOSED VALVE BOX
 - PROPOSED CURB STOP
 - PROPOSED FIRE HYDRANT
 - PROPOSED SIAMSE CONNECTION
 - PROPOSED REMOTE WATER METER
 - PROPOSED WATER METER
 - PROPOSED AREA DRAIN TO BE SPECIFIED AND ACCOMMODATED BY MECHANICAL SYSTEM

EXISTING UNDERGROUND SERVICES AND UTILITY LOCATIONS DERIVED FROM THE BEST AVAILABLE DATA, AS-CONSTRUCTED DRAWINGS, UTILITY DRAWINGS AND INFRASTRUCTURE MAPPING PROVIDED BY THE CITY OF OTTAWA.

CONTRACTOR TO CONFIRM ELEVATIONS AND LOCATIONS OF EXISTING UNDERGROUND SERVICES AND UTILITIES WITHIN THE RIGHT OF WAY PRIOR TO INSTALLATION OF SITE SERVICING INFRASTRUCTURE.

THE CONTRACTOR SHALL IMPLEMENT BEST MANAGEMENT PRACTICES, TO PROVIDE FOR PROTECTION OF THE AREA DRAINAGE SYSTEM AND THE RECEIVING WATERCOURSE DURING CONSTRUCTION ACTIVITIES. THE CONTRACTOR ACKNOWLEDGES THAT THE FAILURE TO IMPLEMENT APPROPRIATE EROSION AND SEDIMENT CONTROL MEASURES MAY BE SUBJECT TO PENALTIES IMPOSED BY ANY APPLICABLE REGULATORY AGENCY.

NOT FOR CONSTRUCTION

SITE PLAN INFORMATION
SITE PLAN PROVIDED BY G4 ARCHITECTS INC.
PROJ. NO. 17045
DATED OCTOBER 15, 2019

GEOTECHNICAL STUDY
GEOTECHNICAL RECOMMENDATIONS PROVIDED BY PATERSON GROUP INC.
PROJ. NO. PGR064-2
DATED AUGUST 2017

SITE SERVICING AND STORMWATER MANAGEMENT STUDY
SERVICING AND STORMWATER MANAGEMENT RECOMMENDATIONS PROVIDED BY DSEL
PROJ. NO. 17-947
DATED OCTOBER 2019

BENCH MARK
ELEVATIONS ARE GEODETIC, REFERRED TO CITY OF OTTAWA VERTICAL BENCHMARK NO. 396
ELEV= 95.06 METERS

No.	BY	YY.MM.DD	DESCRIPTION
2	A.J.G.	19.10.17	ISSUED FOR MUNICIPAL REVIEW
1	S.L.M.	18.05.25	ISSUED FOR MUNICIPAL REVIEW



PROJECT No. 17-947

**SITE SERVICING PLAN
WATERIDGE - BLOCK 19** © DSEL

MATTAMY HOMES
50 Hines Road, Suite 100
Ottawa, Ontario, K2K 2M5
Tel. (613) 831-5144

120 Iber Road Unit 103
Stittsville, Ontario, K2S 1E9
Tel. (613) 836-0856
Fax. (613) 836-7183
www.DSEL.ca

DSEL
david schaeffer engineering ltd
SMART SUBDIVISIONS

DRAWN BY:	A.W.T.	CHECKED BY:	S.L.M.	DRAWING NO.	SHEET NO.
DESIGNED BY:	B.N.C.	CHECKED BY:	A.D.F.	SSP-1	3 of 5
SCALE:	1:300	DATE:	MAY 2018		