

3.0m ACCESS ROAD

POND
MAINTENANCE
ACCESS

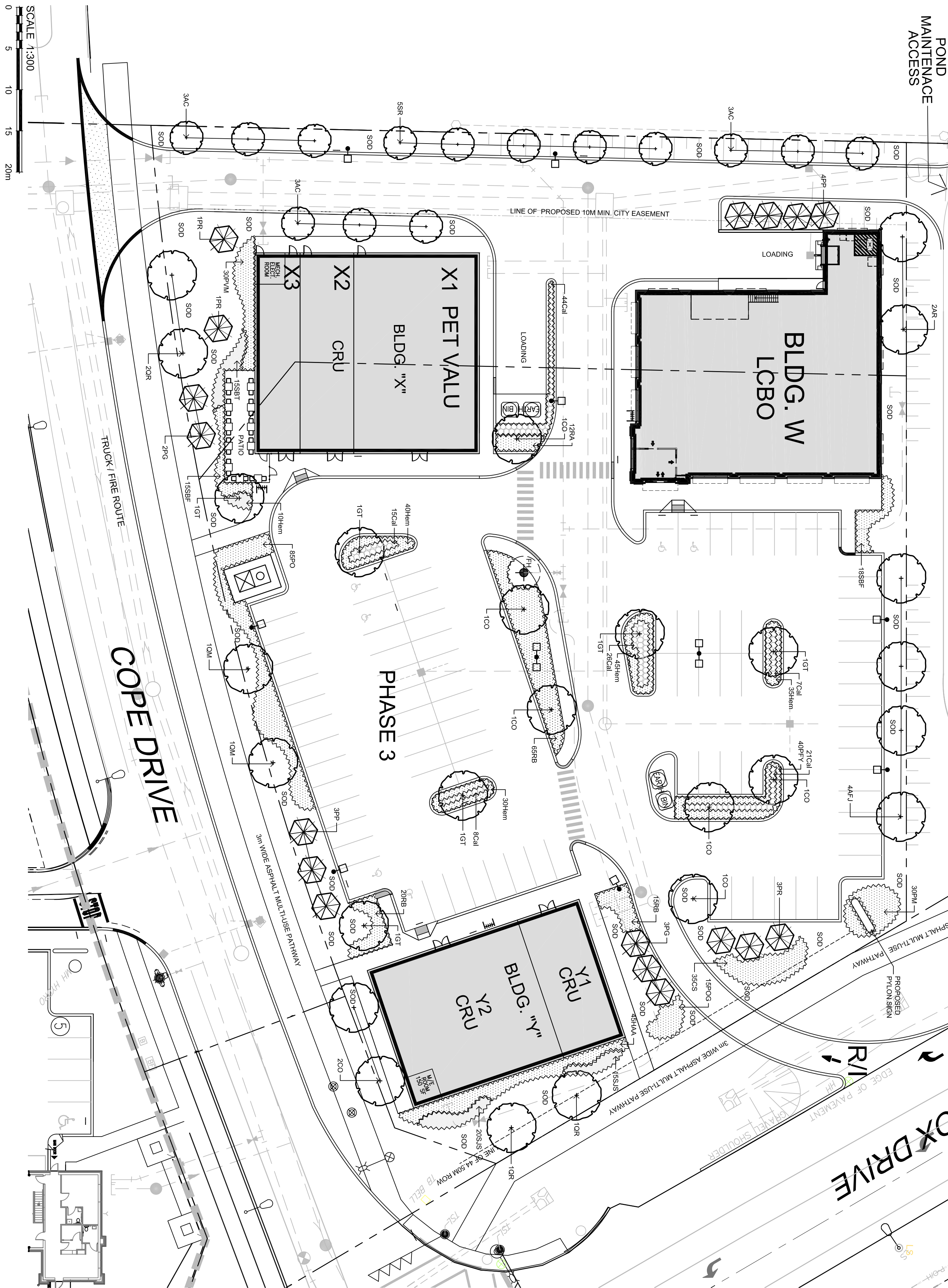

1	PLANTING DETAILS	NTS
L1.01		

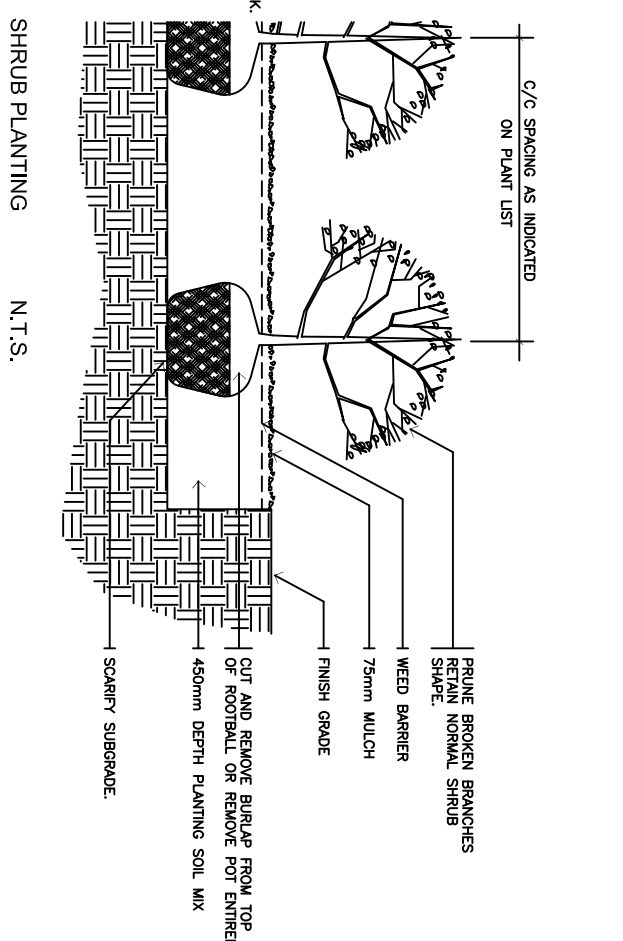
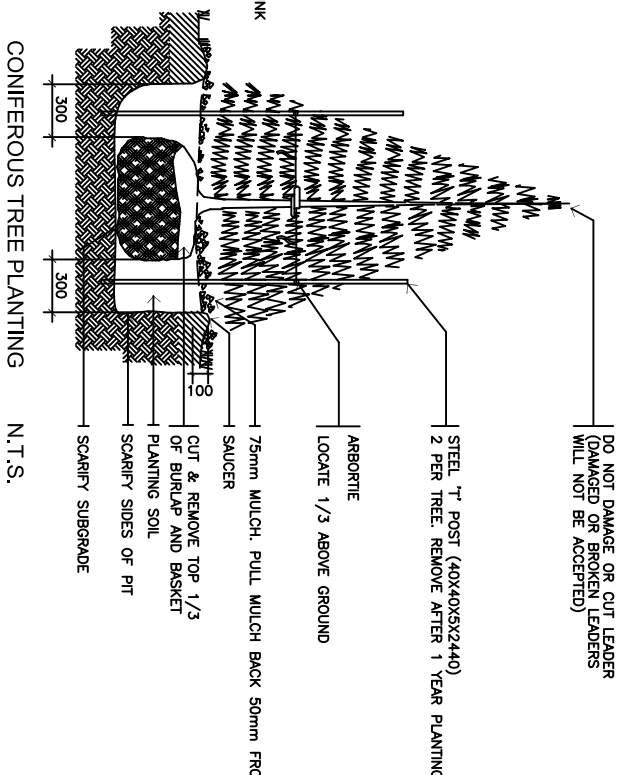
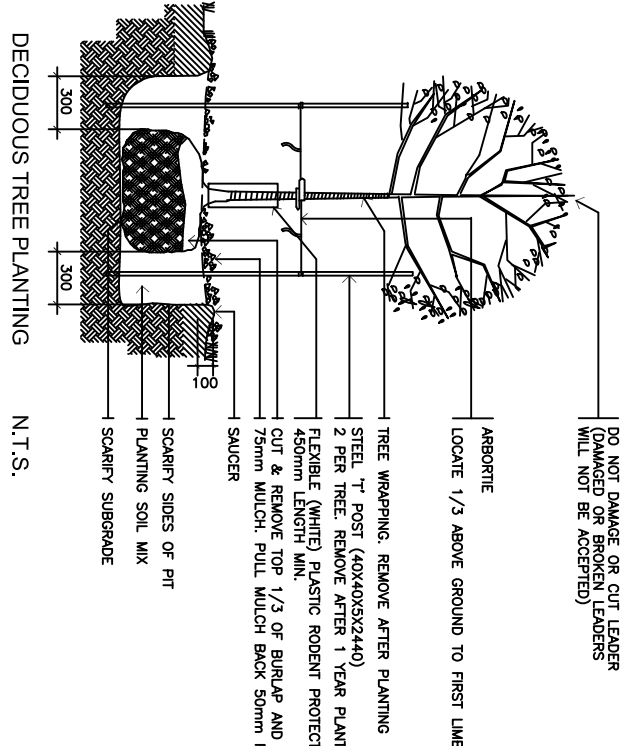

- 1 This drawing shall be read in conjunction with all relevant Architectural, Engineering and related Drawings and Documents.
- 2 Refer to Engineering Drawings for Grading and Servicing.
- 3 Refer to Architectural Drawings for Site layout.
- 4 Contractor shall provide the location(s) of all services/utilities by consulting Municipal Authorities and Utility companies and shall be responsible for adequate protection from damage during construction.
- 5 Plant material shall be No. 1 Grade and shall comply with the Plant Guide Specifications for Nursery Stock (latest edition), published by the Canadian Nursery Trades Association.

- 6 Plant Material locations are Schematic Approved.
- 7 Only Contractor shall state out locations to site and provide.
- 8 Contractor shall guarantee all plant material for a period of one (1) full year from the date of final acceptance. Shrubs shall be planted in a continuous prepared bed of 12" deep mulch.
- 9 Only polypropylene weed control fabric (LINO WEED CONTROL FABRIC-Green-LINO) and 75mm depth composted pine mulch to finish grade, as specified.
- 10 Perennials and Ornamental Grasses shall be planted in a continuous prepared bed of 12" deep mulch. The soil must be covered over with 75mm depth composted pine mulch to finish grade (LINO WEED CONTROL FABRIC, as specified).
- 11 Seed areas to receive 125mm topsoil. Seed shall be No. 1 seed, as specified.
- 12 All areas remaining to be revegetated (Vegetary Soil) Specification.
- 13 Reestablish all areas damaged or disturbed beyond the limit of Work.
- 14 All areas substitutions shall not be permitted without written approval from the Consultant.
- 15 Contractor shall advise Consultant a minimum of 48hrs prior to proceeding landscape work and any required.
- 16 THIS PLAN HAS BEEN PREPARED FOR ANY MINOR SITE OR PLAN APPROVAL ONLY AND MAY NOT BE USED FOR ANY OTHER PURPOSE.

CODE	BOTANICAL NAME	COMMON NAME	QTY.	SIZE	REMARKS
------	----------------	-------------	------	------	---------

CODE	BOTANICAL NAME	COMMON NAME	QTY.	SIZE	REMARKS
DECIDUOUS TREES					
AC	ALE. ANCHERUS CHAMDENIS	SHABLOW SERVICEBERRY	9	50mm cal	RB8, single stem
AF	AFR. AFRICANUM	RED BAY	4	60mm cal	RB8, single stem
AL	ALB. ALBIFLORUM	RED BAY	6	60mm cal	RB8, single stem
CE	CET. OCCIDENTALIS	COMMON HUCKLEBERRY	8	60mm cal	RB8, single stem
GT	GLADIOL. THYACANTHOS	SKYLINE HONEYLOCUST	6	60mm cal	RB8, single stem
OM	OM. MACROCARPA	BLIP OAK	2	60mm cal	RB8, single stem
OR	QUERCUS RUBRA	RED OAK	4	60mm cal	RB8, single stem
SR	SILV. RETICULATA VIVARY	IVORY SILK, JAPANESE TREE LILAC	5	50mm cal	RB8, single stem
CONIFEROUS TREES					
PP	PICEA GLAUCA	WHITE SPRUCE	5	180 cm ht	RB8
PP	PICEA PUNGENS	COLORED GREEN SPRUCE	7	180 cm ht	RB8
PR	PINUS RESINOSA	RED PINE	5	180cm ht	RB8
SHRUBS					
HA	CORNUS SERICEA	RED GASTR DOGWOOD	35	50cm ht	RB8, 100cm o/c
HA	HYDRANGEA ARBORESCENS	ANNABELLE HYDRANGEA	45	50cm ht	potlet, 100cm o/c
AM	AMMEL. HYPERICUM	YELLOW GEM CINCQUEFOID	40	50cm ht	potlet, 80cm o/c
PR	PINUS MUGO MUGHS	MUGHO PINE	30	50cm ht	potlet, 100cm o/c
PO	PHYSCOCARPUS OPULIFOLIUS	COMMON LINDBERK	85	50cm ht	potlet, 100cm o/c
POG	PHYSOCARPUS OPULIFOLIUS	DART'S GOLD NINEBARK	15	50cm ht	potlet, 100cm o/c
PV	PART. F. GOLDEN VINCIGALIS	MINNISTOTA SNOWFLAKE	30	50cm ht	potlet, 100cm o/c
PVM	MINNISTOTA SNOWFLAKE	MCCORMACKAGE	30	50cm ht	potlet, 100cm o/c
RA	REDS AMERICANUM	WILD BLACK CURRANT	102	50cm ht	potlet, 100cm o/c
RB	ROSA BLANDA	SHRUB ROSE (red-rose)	10	50cm ht	potlet, 100cm o/c
RB	ROSA BLANDA	SHRUB ROSE (red-rose)	30	50cm ht	potlet, 100cm o/c
SBT	SPRAEA BETULIFOLIA TOR	BIRCH LEAF SPIREA	15	50cm ht	potlet, 100cm o/c
SIS	SPRAEA JAPONICA SHIROBANA	SHIROBANA SPIREA	35	50cm ht	potlet, 80cm o/c
PERENNIALS					
HEM	HEM. THEROCALUS hyperion	Hyperion DAYLILY	160	15cm pot	plant 60cm o/c
HERBACEOUS					
CE	CET. CARAGORISTIS S. australis	KARL FOERSTER REED GRASS	121	15cm pot	plant 75cm o/c
CE	Karl Foerster				

KEY PLAN
NOT TO SCALE

Map of the project area showing the intersection of Fernbank Road and Eagleston Side Road. The project site is located in the northeast corner of this intersection. The map includes labels for Fernbank Road, Eagleston Side Road, and various local streets like Terry Fox, South Entrance, and Oakridge Drive. A north arrow and a scale bar (1 inch = 100 feet) are also present.

LEVSTEK CONSULTANTS
LANDSCAPE ARCHITECTS

5871 Hugh Crescent • Ottawa • Ontario • K0A 2W0
Tel: 613-735-1111 • Fax: 613-735-1112
www.levstek.com

COMMERCIAL DEVELOPMENT
1157 TERRY FOX DRIVE
KANATA, SOUTH, ONTARIO
SMART CENTRES
3200 HIGHWAY 7, WAUGHAN, ON, L4K 5Z5
TEL: 905-326-6400 FAX: 905-769-6220

LANDSCAPE PLAN-PHASE

LANDSCAPE PLAN-PHASE 3

DESIGN BY : RL	CHECKED BY :	PROJECT No.
DRAWN BY : MOB	CHECKED BY :	978.05
SCALE : AS SHOWN	DATE : OCTOBER 2019	
CONSULTANTS NO.		DRAWING No.
		L1.01