

DRAWING No: 190117-ESC

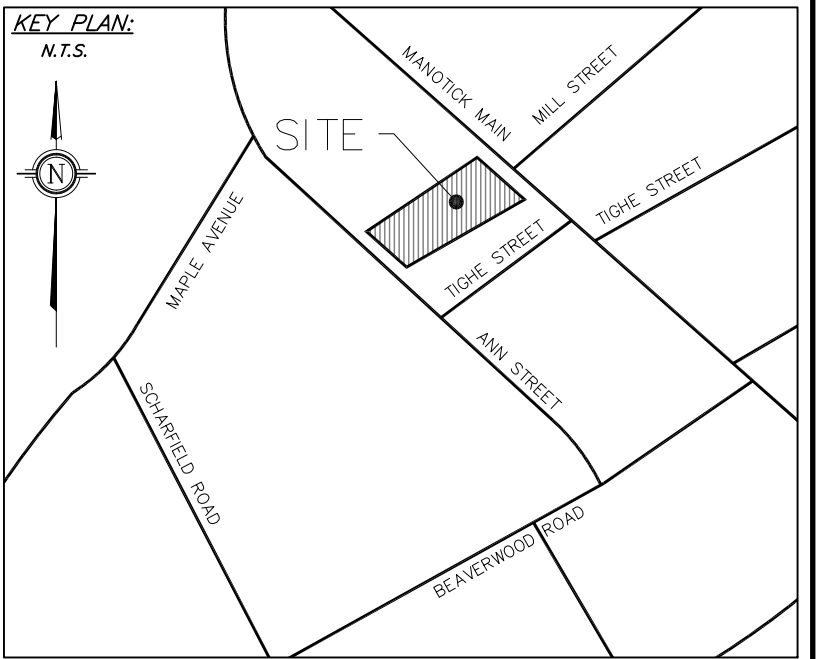

SCALE 1:200 METRES

- GENERAL NOTES:
- All dimensions are in metres; all elevations are in metres and are geodetic.
 - TBM=Spike in utilities pole. Elevation=89.55 (geodetic).
 - This is not a legal survey. Boundary and topographic information is derived from H.A.KEN SHIPMAN SURVEYING LTD. File No. 18-11497.
 - Contractor is responsible for location and protection of utilities.
 - All dimensions to be verified on site by contractor prior to construction.
 - Any changes made to this plan must be verified and approved by Kollaard Associates Inc.
 - Client is responsible for acquiring all necessary permits. This drawing is not for construction until a building permit has been granted.
 - Existing services shown are based on best current information. Contractor to verify exact location of services and report any discrepancies to Kollaard Associates Inc.
 - The owner agrees to prepare and implement an erosion and sediment control plan to the satisfaction of the City of Ottawa, appropriate to the site conditions, prior to undertaking any site alterations (filling, grading, removal of vegetation, etc.) and during all phases of site preparation and construction in accordance with the current Best Management Practices for Erosion and Sediment Control such as, and not limited to installing filter cloths across manhole/catchbasin lids to prevent sediments from entering structures and install and maintain a light duty silt fence barrier as required.
 - The contractor shall implement best management practices, to provide for protection of the area drainage system and the receiving watercourse, during construction activities. The contractor acknowledges that failure to implement appropriate erosion and sediment control measures may be subject to penalties imposed by any applicable regulatory agency.
 - All materials and construction to be in accordance with City of Ottawa standards and Ontario Provincial Standards and Specifications.
 - Reference to Kollaard File #190117 for Storm Water Management Design, Servicing Brief Report and Geotechnical Report.

No.	REVISION	DATE	BY
0	ISSUED FOR SITE PLAN CONTROL APPROVAL	JULY 23, 2019	ML

K Kollaard Associates
Engineers
(613) 860-0923
info@kollaard.ca

P.O. BOX 189, 210 PRESCOTT ST.
KEMPTVILLE, ONTARIO
K0G 1J0 FAX (613) 258-0475
http://www.kollaard.ca

CLIENT:
ROYAL LEPAGE TEAM REALTY
101-555 LEGGET DRIVE
KANATA ON K2K 2X3
ATTN: JASON RALPH

PROJECT:
PROPOSED COMMERCIAL BUILDING

LOCATION:
5536 MANOTICK MAIN STREET
CITY OF OTTAWA,
ONTARIO

DESIGNED BY: SD
CHECKED BY: SD
DRAWN BY: ML
APPROVED BY: SD
DATE: MARCH 22, 2019
PROJECT NUMBER:
190117

DRAWING No: 190117-ESC

DRAWING NAME: EROSION AND SEDIMENT CONTROL PLAN

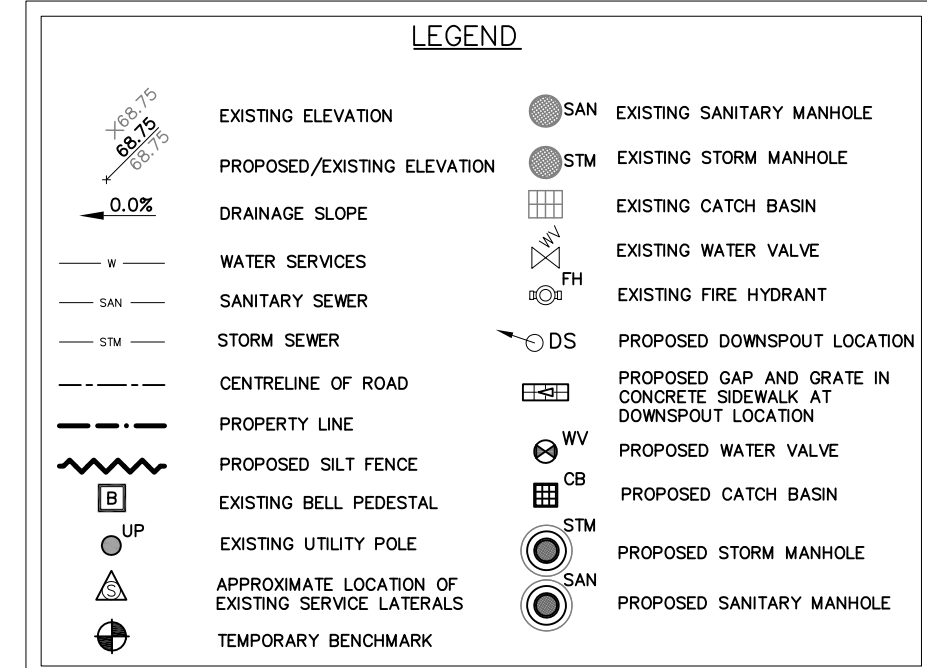

EROSION AND SEDIMENT CONTROL NOTES:

- THE CONTRACTOR SHALL IMPLEMENT BEST MANAGEMENT PRACTICES, TO PROVIDE FOR PROTECTION OF THE AREA DRAINAGE SYSTEM AND THE RECEIVING WATERCOURSE, DURING CONSTRUCTION ACTIVITIES. THE CONTRACTOR ACKNOWLEDGES THAT FAILURE TO IMPLEMENT APPROPRIATE EROSION AND SEDIMENT CONTROL MEASURES MAY BE SUBJECT TO PENALTIES IMPOSED BY ANY APPLICABLE REGULATORY AGENCY.
- THE OWNER (AND/OR CONTRACTOR) AGREES TO PREPARE AND IMPLEMENT AN EROSION AND SEDIMENT CONTROL PLAN AT LEAST EQUAL TO THE STATED MINIMUM REQUIREMENTS AND TO THE SATISFACTION OF THE CITY OF OTTAWA, APPROPRIATE TO THE SITE CONDITIONS, PRIOR TO UNDERTAKING ANY SITE ALTERATIONS (FILLING, GRADING, REMOVAL OF VEGETATION, ETC.) AND DURING ALL PHASES OF SITE PREPARATION AND CONSTRUCTION IN ACCORDANCE WITH THE CURRENT BEST MANAGEMENT PRACTICES FOR EROSION AND SEDIMENT CONTROL.
- THE CONTRACTOR IS TO ENSURE THAT THE SITE ACCESS POINTS AND ADJACENT STREETS TO THE ACCESS POINTS ARE MAINTAINED AND KEPT CLEAN OF CONSTRUCTION MATERIALS SUCH AS, BUT NOT LIMITED TO MUD, DIRT, CLAY AND GRANULARS ON A DAILY BASIS OR AS NECESSARY, TO THE SATISFACTION OF THE CITY OF OTTAWA.
- PRIOR TO CONSTRUCTION, SILT FENCE BARRIERS (OPSD 219.110) WILL BE PLACED ALONG THE LIMIT OF DEVELOPMENT FOR THE SITE AS SHOWN ON THE DRAWING. THE SILT FENCE IS TO BE MAINTAINED THROUGHOUT CONSTRUCTION.
- EVERY EFFORT WILL BE MADE TO ENSURE THAT ALL DISTURBED AREAS ARE TOPSOILED AND SEEDS AS SOON AS REASONABLY POSSIBLE.
- THE SEDIMENT AND EROSION CONTROL PLAN IS A LIVING DOCUMENT WHICH MAY BE AMENDED BY ONSITE REQUIREMENTS AT THE APPROVAL OF THE MUNICIPALITY AND THE CONSERVATION AUTHORITY.

MINIMUM EROSION AND SEDIMENT CONTROL PLAN REQUIREMENTS:

- TIME THE DEMOLITION AND EXCAVATION ACTIVITIES SO THAT THEY OCCUR NO SOONER THAN IS NECESSARY FOR SUBSEQUENT CONSTRUCTION ACTIVITIES.
- LANDSCAPE THE SITE AS SOON AS PRACTICALLY POSSIBLE.
- USE SILT FENCES AROUND ANY STOCKPILES OF SOIL.
- PRIOR TO CONSTRUCTION, SILT FENCE BARRIERS (OPSD 219.110) WILL BE PLACED ALONG THE PROPERTY LINES AS ON THE DRAWING.
- THE SILT FENCE SHOULD BE REMOVED ONLY WHEN THE SITE IS STABILIZED.
- INSTALL FILTER CLOTH ACROSS ALL EXISTING AND PROPOSED CATCH BASINS AND CATCH BASIN MANHOLES PRIOR TO CONSTRUCTION.

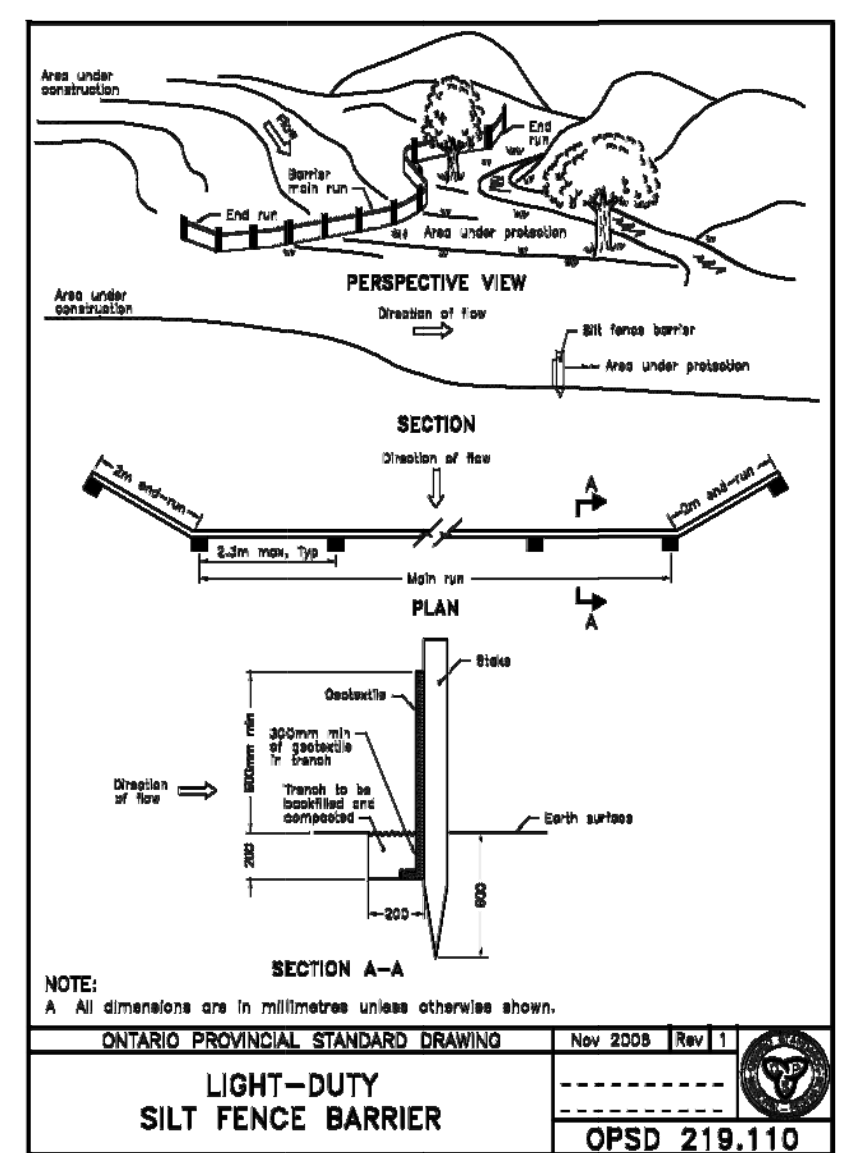

NOTE:
A All dimensions are in millimetres unless otherwise shown.

ONTARIO PROVINCIAL STANDARD DRAWING
LIGHT-DUTY
SILT FENCE BARRIER
OPSD 219.110

EROSION & SEDIMENT CONTROL PLAN
SCALE 1:200

