

DECIDUOUS/CONIFEROUS TREE PLANTING SPECIFICATIONS

PLANTING PIT:

- TO DETERMINE WIDTH AT BOTTOM OF PLANTING PIT, TAKE WIDTH OF ROOTBALL AND ADD 300mm (150mm TO EACH SIDE). DEPTH OF PLANTING PIT DIRECTLY BELOW ROOTBALL TO BE 900mm MINIMUM, WITH SLOPING SIDES TO GRADE, TOP WIDTH OF PLANTING PIT AT GRADE TO BE 3X DIAMETER OF ROOTBALL.
- SCARIFY SUBGRADE PRIOR TO PLANTING.
- ADD SUFFICIENT COMPACTED TOPSOIL MIX TO BOTTOM OF PLANTING PIT TO ENSURE THAT WHEN TREE IS PLACED, TRUNK FLARE WILL BE VISIBLE.

TREE PLANTING:

- INSERT TREE AND REMOVE WIRE BASKET AND TOP 1/3 OF BURLAP.
- USE TWO (2) T-BAR IRON STAKES (40x40x2440) TO STABILIZE TREE WHEN TREE IS OVER 25mmØ OR OVER 2M HIGH.
- INFILL PLANTING PIT WITH 50/50 MIXTURE OF TOPSOIL AND NATIVE SOIL.
- CREATE 50mm TOPSOIL SAUCER WITH 50mm MULCH LAYER. TOP OF MULCH/FINISHED GRADE TO MATCH PREVIOUS EXISTING GRADE.
- IF STAKES ARE USED, FASTEN TRUNK TO IRON STAKES WITH 9 GAUGE GALVANIZED TWISTED WIRE AND TWO PLY REINFORCED RUBBER HOSE. PLACE ONE OF TWO STAKES ON SIDE OF PREVAILING WIND.
- PRUNE DEAD OR BROKEN BRANCHES ONLY.
- DO NOT DAMAGE OR CUT TREE LEADER.

SHRUB PLANTING SPECIFICATIONS

PLANTING PIT:

- PROVIDE A 600mm MINIMUM DEEP PLANTING PIT.
- LOOSEN SUBGRADE BELOW BOTTOM OF PLANTING PIT TO 300mm DEEP.
- ADD SUFFICIENT PLANTING SOIL MIX TO BOTTOM OF PLANTING PIT TO ENSURE THAT WHEN SHRUB IS PLACED, TOP OF ROOTBALL IS EVEN WITH FINISHED GRADE.

SHRUB PLANTING:

- REFER TO PLANTING LIST FOR PLANT SPACING.
- INSERT SHRUBS WITH ROOT CONDITION AS SPECIFIED.
- INFILL PLANTING SOIL AS SPECIFIED.
- CREATE 100mm HIGH TOPSOIL SAUCER ENCLOSING 50MM HIGH MULCH LAYER.
- PRUNE DAMAGED BRANCHES.

Plant List - New Trees					
Code	Qty.	Bontanical Name	Common Name	Size	Remarks
AR	6	Acer rubrum	Red Maple	70mm	W.B.
PSL	4	Pinus sylvestris L.	Scots Pine	2m height	W.B.
Plant List - Shrubs					
Code	Qty.	Bontanical Name	Common Name	Size	Remarks
EAC	30	Euonymus alatus 'Compactus'	Dwarf Burning Bush Shrubs	400mm height	potted / planted at 1200mm o.c.

TREE & SHRUB LEGEND

- (30) NEW DWARK BURNING BUSH SHRUBS
- (6) NEW RED MAPLES 70mm CALIPER
- (4) NEW SCOTS PINE 2M MINIMUM HEIGHT
- EXISTING TREE TO REMAIN
- EXISTING TREE TO BE REMOVED

ZONING DATA (BASED ON ZONING BY-LAW 2008-250)

Municipal Address:
3025 Carp Road, Ottawa, Ontario

Legal Description:
Part of Lot 11, Concession 3, Geographic Township of Huntley, City of Ottawa

Zoning Designation:
Rural Commercial Zone; Carp Road Corridor (RC9); Area D - Rural

Site Area: 1,828 Ha (18,281.3 Sq.M.)

Building Area:

- New Building: 874.25 Sq.M.
- Existing/Relocated Buildings: N/A
- Total Buildings Gross Area: 874.25 Sq.M.

Lot Coverage: (874.25/18281.3) x 100 = 4.78%

Gross Floor Area (Principal Use Bldg.):

- First Floor Area: 874.25 Sq.M.
- Second Floor Area: 133.15 Sq.M.
- Total GFA: 1,007.4 Sq.M.

RC9 ZONING PROVISIONS

ZONING MECHANISM

FRONT YARD SET BACK
REAR YARD SET BACK
INTERIOR SIDE YARD SET BACK
OTHERS (min.)

PRINCIPAL BUILDING HEIGHT

LOT COVERAGE

PARKING REQUIREMENTS

DISABLED PARKING SPACES

REQUIRED

10M (min.)
10M (min.)
6M ABUTTING RESIDENTIAL/3M
OTHERS (min.)
11M (max.)
25% (max.)

REPAIR GARAGE:

(Table 101 - Row N41) 0.75/100 Sq.M. GFA
(741.10 Sq.M./100) X 0.75 = 5.6 parking spaces

OFFICE:

(Table 101 - Row N59) 2.4/100 Sq.M. GFA
(266.3 Sq.M./100) X 2.4 = 6.4 parking spaces

Total: 5.6 + 6.4 = 12 spaces

58 Spaces

1 Space

NOTE:

Lines representing edge of water, top of existing bank/slope, and existing buildings shown on this architectural site plan drawing are based on the information provided on the survey plan, prepared by Ontario Land Surveyor Annis, O'Sullivan, Vollebakk Ltd., dated January 31, 2019.

1 SITE & LANDSPACE PLAN
A1.0 SCALE 1:500



LEGEND

PROPERTY LINE

OUTLINE OF NEW BUILDING

OUTLINE OF ASPHALT AREA

OUTLINE OF GRAVEL AREA

OUTLINE OF LANDSCAPED AREA

OUTLINE OF STORAGE YARD DESIGNATED FOR SNOW STORAGE

EXISTING TOP OF SLOPE

EXISTING BOTTOM OF SLOPE

EXISTING TOP OF SLOPE

EXISTING BOTTOM OF SLOPE

EXISTING TOP OF SLOPE

EXISTING BOTTOM OF SLOPE

EXISTING LIGHT STANDARD

PROPOSED TRUCK POWER PLUG/BOLLARD

PROPOSED PAINTED GALVANIZED STEEL BOLLARD

EXISTING UTILITY POLE



GENERAL NOTES

- CONTRACTOR SHALL VERIFY ALL DIMENSIONS ON SITE AND SHALL REPORT ANY DISCREPANCIES TO THE ARCHITECT PRIOR TO COMMENCEMENT OF WORK.
- CONTRACTOR MUST COMPLY WITH ALL CODES AND BYLAWS AND OTHER REGULATIONS BY AUTHORITIES HAVING JURISDICTION OVER THE WORK.
- DO NOT SCALE THIS DRAWING.
- THIS DRAWING MAY NOT BE USED FOR CONSTRUCTION UNLESS SEALED/SIGNED BY THE ARCHITECT.
- COPYRIGHT OF THIS DRAWINGS IS RESERVED.

SURVEY PLAN DISCLAIMER

THIS ARCHITECTURAL SITE PLAN DRAWING IS PREPARED BASED ON A SURVEY PLAN PROVIDED TO A+ ARCHITECTURE INC. OF EXISTING LAND FEATURES, INCLUDING BUT NOT LIMITED TO, EXISTING LEGAL BOUNDARIES, LOT LINES, GRADES, TOPOGRAPHY, VEGETATION ETC., SHOWN ON THIS DRAWING FOR COORDINATION PURPOSES ONLY AND ARE BASED ON THE SURVEY PLAN PREPARED BY ANNIS, O'SULLIVAN, VOLLEBEKK LTD., ONTARIO LAND SURVEYOR, DATED JANUARY 31, 2019.

THE AFOREMENTIONED SURVEY PLAN WAS INCORPORATED INTO THE ARCHITECTURAL SITE PLAN DRAWING, AS PROVIDED TO A+ ARCHITECTURE INC., WITH NO ALTERATIONS WHATSOEVER. A+ ARCHITECTURE INC. SHALL NOT BE HELD LIABLE AS TO THE ACCURACY OF THE INFORMATION PROVIDED ON THE SURVEY PLAN.

LANDSCAPE PLAN DISCLAIMER

THE ARCHITECT SHALL ASSUME NO LIABILITY, WHATSOEVER, FOR THE SUITABILITY OF THE SELECTED TREES, PLANTING SPECIFICATIONS, NOR FOR THE RECOMMENDED WATERING AND MAINTENANCE PROCEDURES. THE CONSTRUCTION MANAGER SHALL RETAIN THE SERVICES OF A PROFESSIONAL AND EXPERIENCED LANDSCAPER FOR THE INSPECTION AND APPROVAL OF THE PLANTING PROCESS AND TO PROVIDE A FOLLOW UP INSPECTION IN THE FOLLOWING CALENDAR YEAR UPON COMPLETION OF CONSTRUCTION.

00 ISSUED FOR SITE PLAN APPROVAL 2019/11/13

NO.1 ISSUE DATE (YY/MM/DD)

REVISIONS

ORIENTATION

SEAL

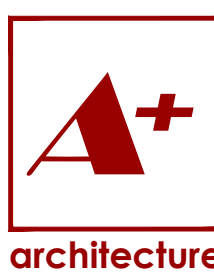

A+ Architecture Inc.
555 LEGGET DRIVE
TOWER A, SUITE 304
Kanata, ON K2K 2X3
+1 613 699 6860
info@aplus-arch.com
www.aplus-arch.com

CLIENT



PROJECT

**BADGER DAYLIGHTING
EQUIPMENT STORAGE AND
OFFICE BUILDING**
3025 CARP ROAD, OTTAWA, ON

DRAWING TITLE

**SITE & LANDSCAPE
PLAN**

DRAWN BY

A.A.

REVIEWED BY

A.A.

START DATE 2019/08/06

PROJECT NO. 19011

REVISION NO. 00

A1.0