

| PROPOSED VEGETATION | | | | | |
|----------------------|-----------------------------------|---|-----|------------------|-------|
| PLANT LIST | | | | | |
| KEY | SCIENTIFIC NAME | COMMON NAME | NO. | SIZE | COND. |
| DECIDUOUS TREES | | | | | |
| AP | <i>Acer Palmatum</i> | Japanese Maple | 2 | Relocate on Site | |
| SR | <i>Syringa reticulata</i> | 'Ivory Silk' Ivory Silk Japanese Tree Lilac | 4 | 75mm Cal. | WB |
| DECIDUOUS SHRUBS | | | | | |
| EA | <i>Euonymus alatus</i> | Burning Bush | 5 | 80cm Ht. | Pot |
| EC | <i>Euonymus alatus</i> | 'Compacta' Dwarf Burning Bush | 6 | 80cm Ht. | Pot |
| HP | <i>Hydrangea paniculata</i> | Pinkie Winky Hydrangea | 3 | 80cm Ht. | Pot |
| 'Pinkie Winky' | | | | | |
| PG | <i>Potentilla</i> | 'Goldfinger' Goldfinger Cinquefoil | 6 | 60cm Ht. | Pot |
| RA | <i>Ribes alpinum</i> | Alpine Currant | 7 | 80cm Ht. | Pot |
| SS | <i>Sorbaria sorbifolia</i> | False Spirea | 7 | 1.0m Ht. | Pot |
| SV | <i>Spirea x vanhouttii</i> | Bridle Wreath Spirea | 4 | 1.0m Ht. | Pot |
| PERENNIALS & GRASSES | | | | | |
| CA | <i>Calamagrostis x acutifolia</i> | Karl Foerster Feather Reed Grass | 23 | 15cm Pot | |
| 'Karl Foerster' | | | | | |
| FV | <i>Filipendula vulgaris</i> | Double Dropwort 'Flora Plena' | 16 | 15cm Pot | |
| 'Flora Plena' | | | | | |
| HS | <i>Hemerocallis</i> | 'Stella D'or' Stella D'or Daylily | 14 | 15cm Pot | |
| VM | <i>Vinca minor</i> | Periwinkle | 46 | 10cm Pot | |

- LANDSCAPE NOTES**
- Plant material shall be No.1 Grade and shall comply with the Metric Guide Specifications for Nursery Stock (latest version) published by the Canadian Nursery Trades Association.
 - Plant substitutions shall not be permitted unless approved by the Landscape Architect.
 - Contractor shall warranty all plant materials for a period of one (1) full years from the date of final acceptance.
 - Obtain approval of planting locations prior to digging.
 - All planting beds shall be mulched with 75mm shredded wood mulch.
 - Topsoil for planting shall be friable sandy loam: add 30% peatmoss by volume and bonemeal at a rate of 3 kg/cubic metre to topsoil.
 - Sod areas to receive 100mm topsoil. Sod shall be No.1 Grade conforming to the Canadian Sod Growers Specification.
 - Reinstate all areas damaged or disturbed beyond the limit of work.

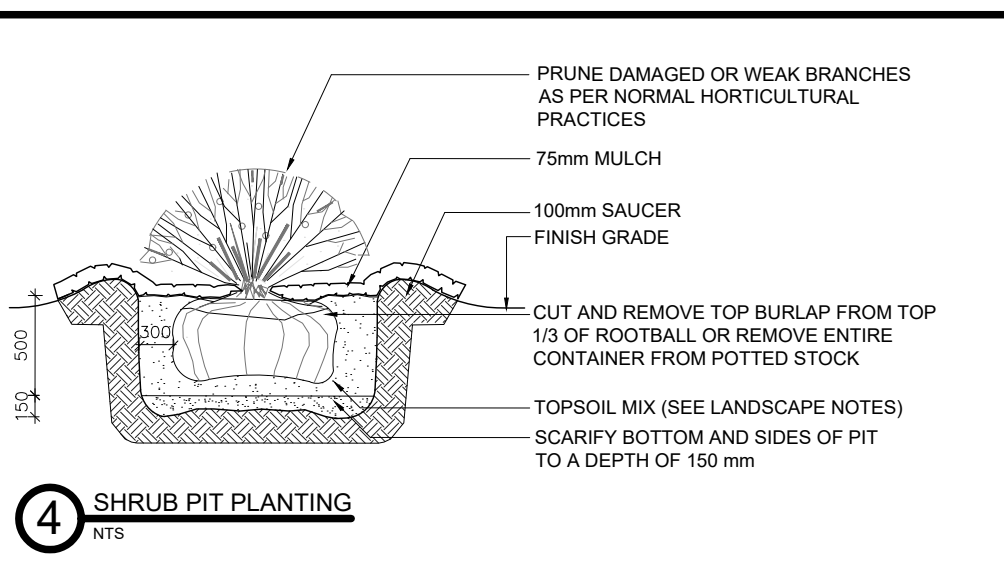
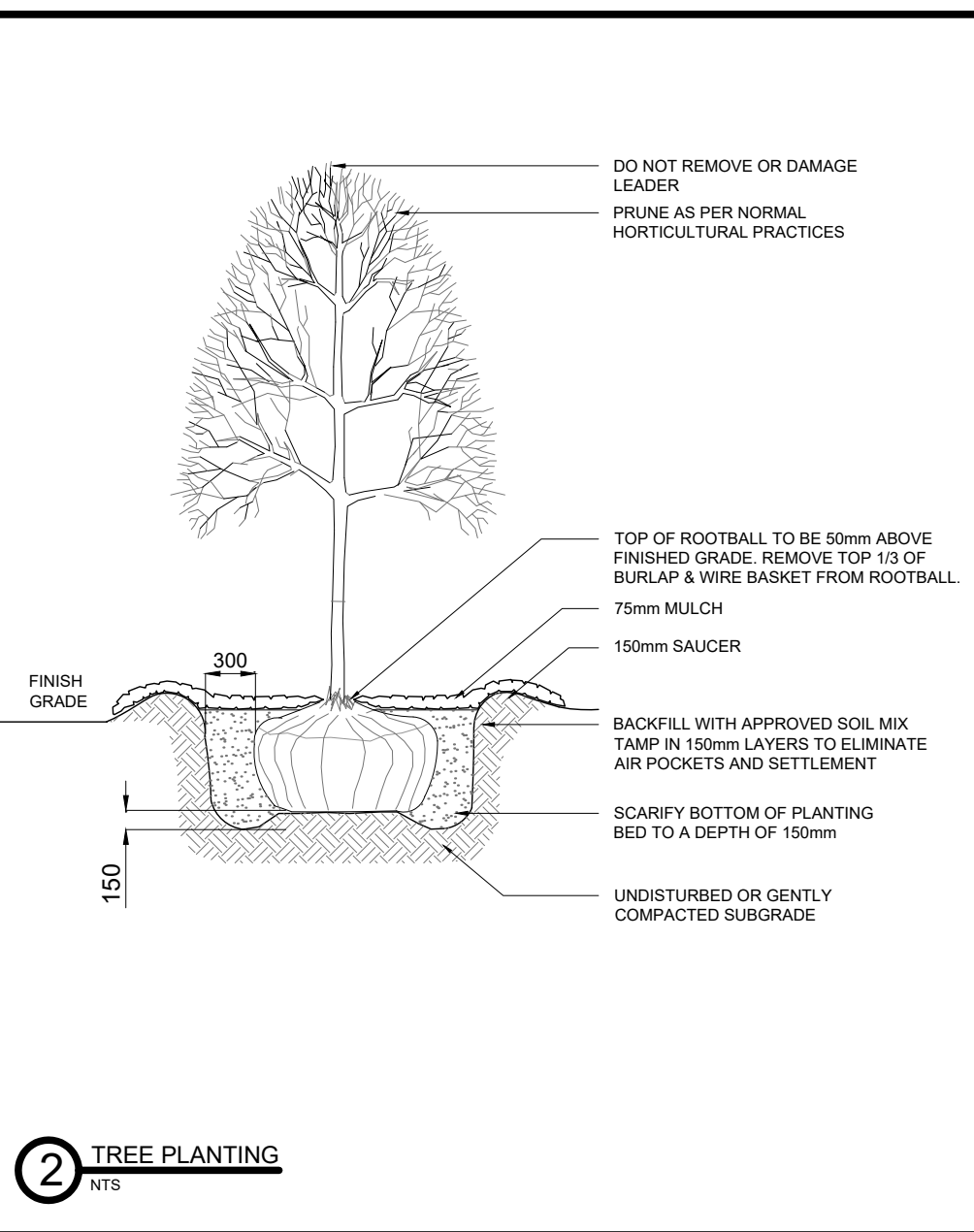
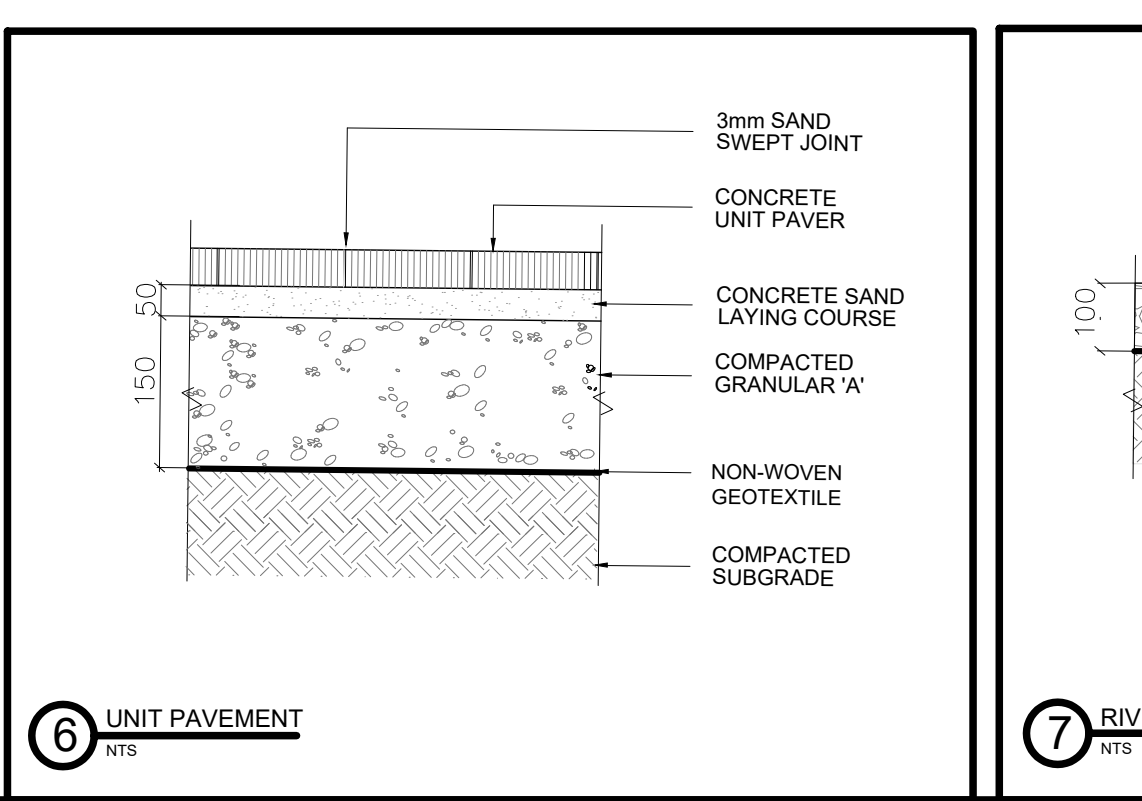
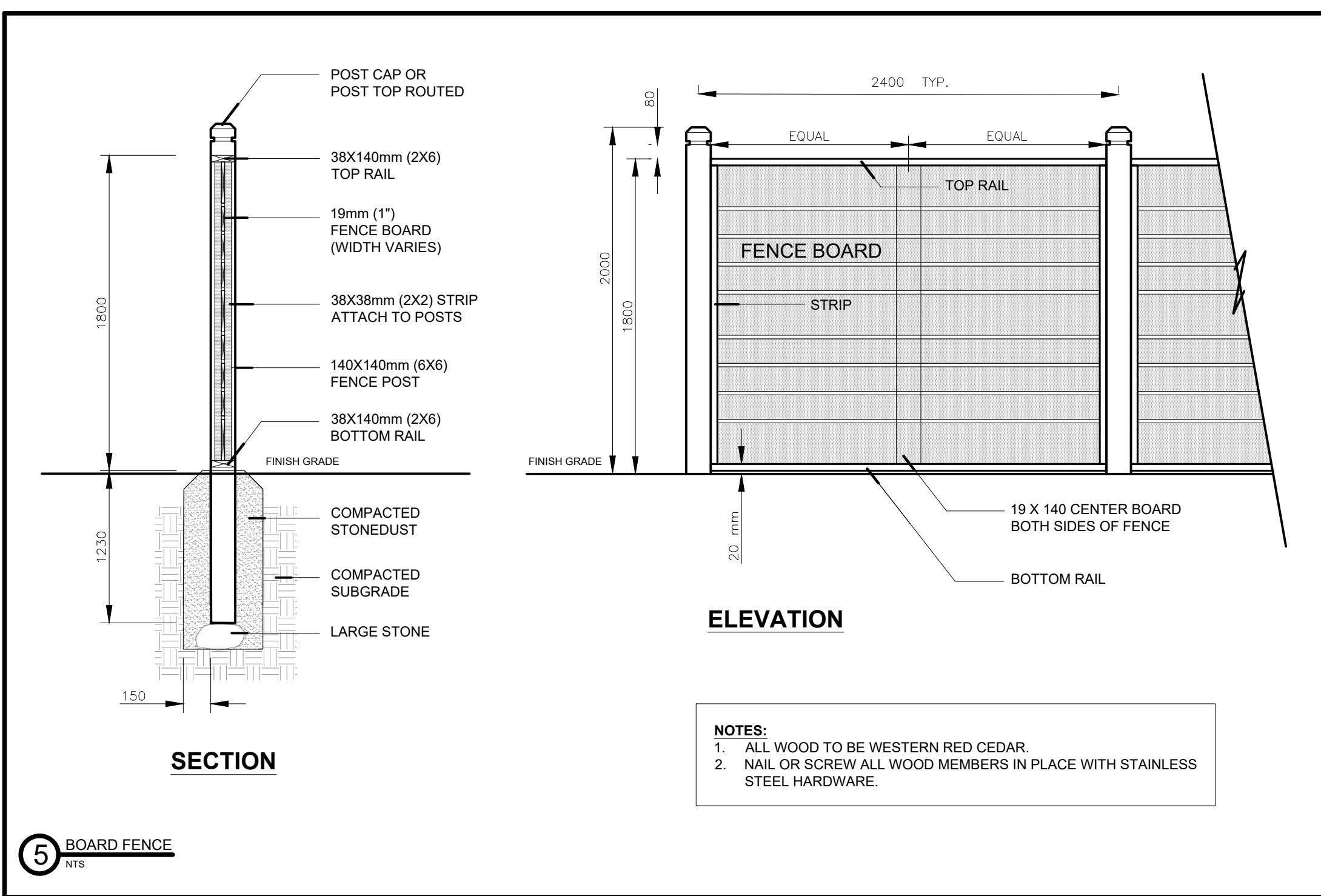
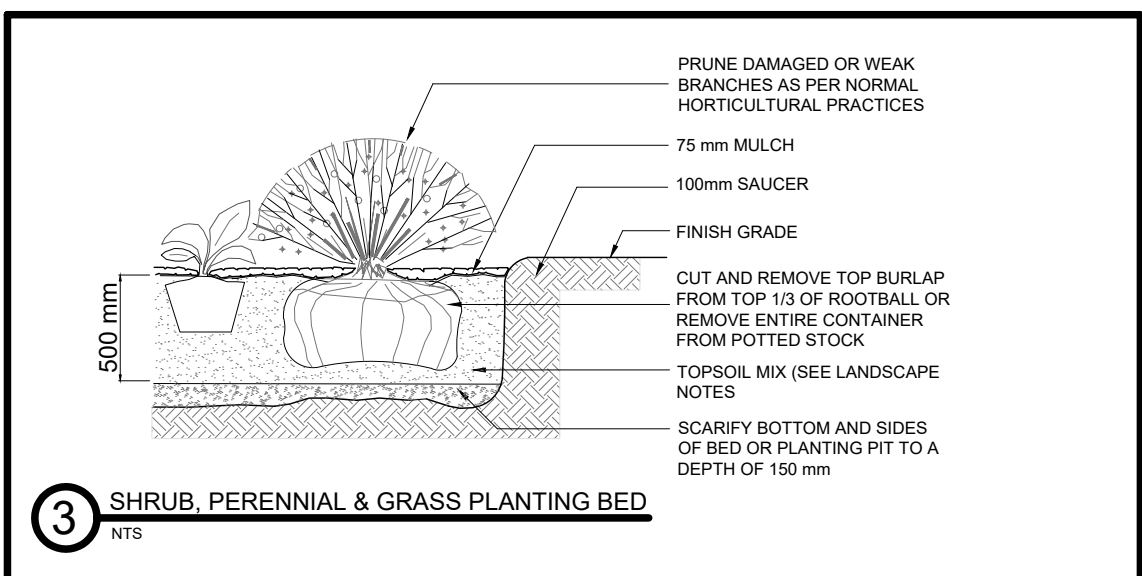
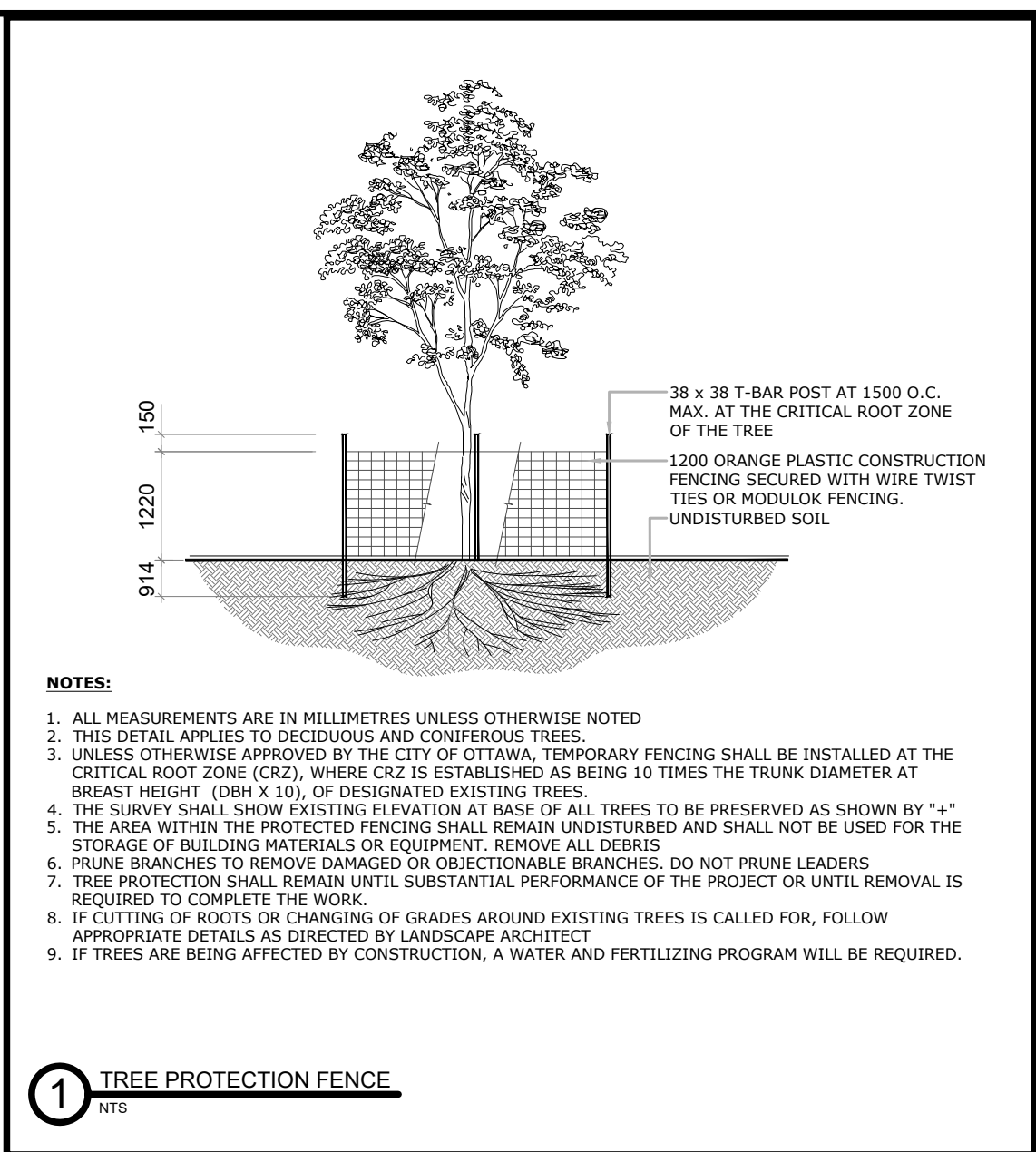

GENERAL NOTES

- This drawing has been prepared for site plan approval only. Additional detailing and specifications are required for construction.
- It is the responsibility of the Contractor to verify all dimensions & conditions on site. Report any errors or omissions to the Landscape Architect prior to commencing work.
- It is the responsibility of the Contractor to locate all underground utilities prior to construction.
- All dimensions are in metric.
- Do not scale the drawings.
- All drawings & designs remain the property of TRACY WHALEN - LANDSCAPE ARCHITECT & are protected by copyright.

TREE CONSERVATION NOTES
(PERTAINING TO TREES WHICH ARE ON SITE & PARTIALLY LOCATED ON ADJACENT PROPERTIES)

- Do not place any material or equipment within the critical root zone (CRZ) of the trees.
- Do not attach any sign, notice or posters to any tree.
- Do not raise or lower the existing grade within the CRZ without approval.
- Tunnel or bore when digging within the CRZ of a tree.
- Do not damage the root system, trunk or branches of any tree.
- Ensure that exhaust fumes from all equipment are NOT directed towards any tree's canopy.

LEGEND

EXISTING

- OVERHEAD HYDRO
- OVERHEAD PHONE

PROPOSED

- TREE PROTECTION FENCE
- BOARD FENCE
- DECIDUOUS TREES
- DECIDUOUS SHRUBS
- PERENNIALS
- PLANTING BED
- SOD
- RA O/C
- SPECIES KEY ON CENTRE
- UNIT PAVERS
- RIVERWASH STONE

DETAIL NUMBER
DRAWING NUMBER

DETAIL KEY

| | | |
|-----|---|------------|
| 03 | Revised & Reissued for Site Plan Approval | 2019-10-21 |
| 02 | Issued for Site Plan Approval | 2019-09-25 |
| 01 | Issued for Discussion | 2019-09-20 |
| NO. | REVISION | DATE |

WOODMAN ARCHITECT & ASSOCIATES LTD.

4 BEECHWOOD, SUITE 201, OTTAWA, ONTARIO, CANADA K1L 8L9
TEL: 613 228 9850 FAX: 613 228 9848 mailbox@woodmanarchitect.com

DEVELOPER:
NICK & CARMEN ARGENTINA
1504 GOTH AVENUE, OTTAWA

CONSULTANTS:

TRACY WHALEN - LANDSCAPE ARCHITECT
Studio B, 5 Wellfleet Cres., Ottawa, Ontario K2J 2X7 (613) 825-9756

ASSOCIATION OF LANDSCAPE ARCHITECTS OF ONTARIO

PROJECT
114, 118, 122
RUSSELL AVENUE - OTTAWA

DRAWING:
LANDSCAPE SITE PLAN
PROPOSED DEVELOPMENT

DATE: SEPTEMBER 25, 2019 **JOB NO.:** 190993

SCALE: 1:150 **DRAWING NO.:**

DRAWN BY: T.W. **REVIEWED BY:** T.W.

L2