

STREET THREE PROFILE

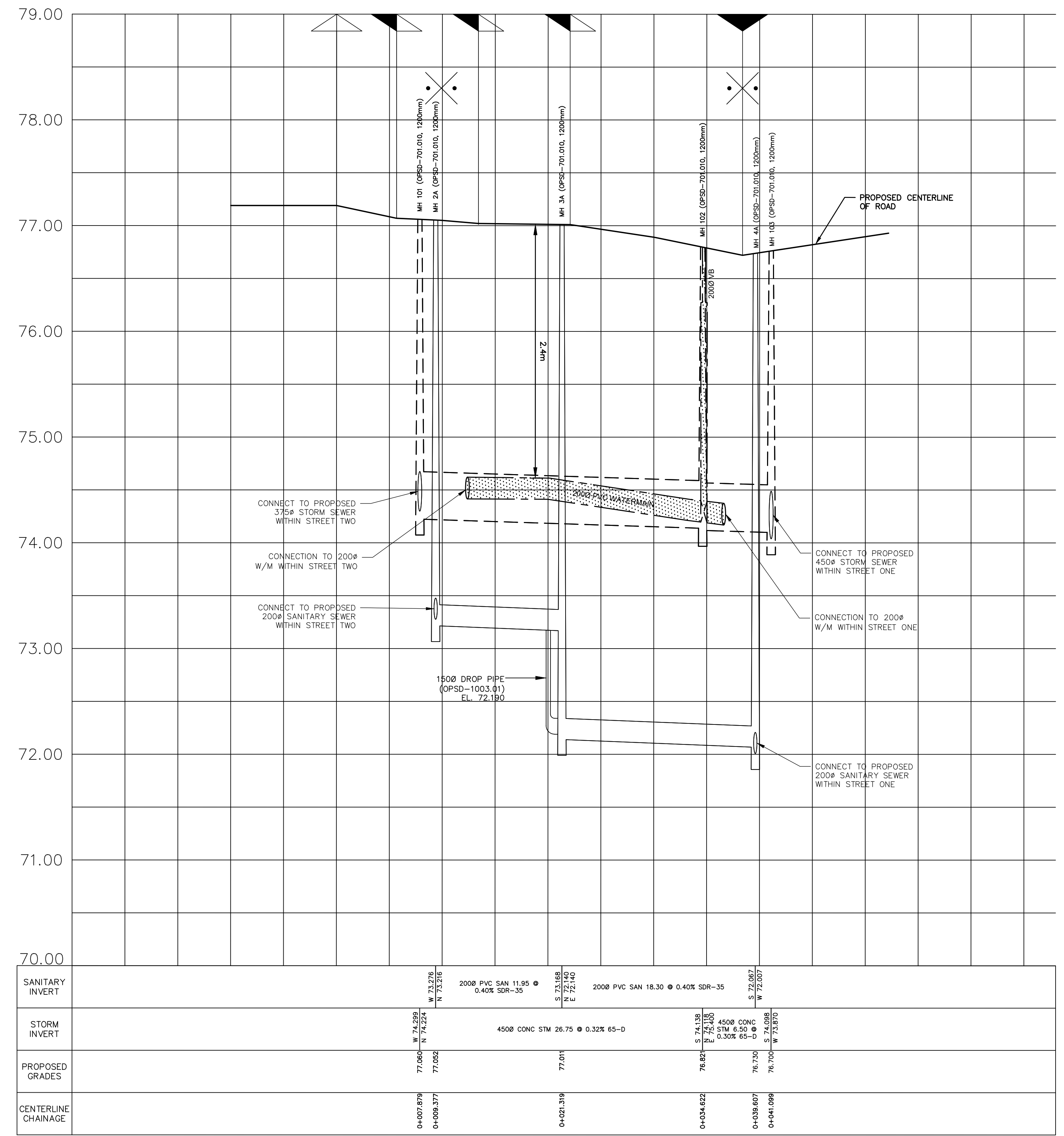

- LEGEND**
- PROPERTY LINE
 - PROPOSED WATERMAIN
 - PROPOSED SANITARY SEWER
 - PROPOSED STORM SEWER
 - PROPOSED PERFORATED SUBDRAIN
 - PROPOSED VALVE BOX
 - PROPOSED CURB STOP
 - PROPOSED FIRE HYDRANT
 - PROPOSED SANITARY MANHOLE
 - PROPOSED STORM MANHOLE
 - PROPOSED CATCH BASIN
 - PROPOSED CB 'T' OR CB 'L'
 - PROPOSED SERVICE LATERAL PER CITY STD. S11.3

EXISTING UNDERGROUND SERVICES AND UTILITY LOCATIONS DERIVED FROM THE BEST AVAILABLE DATA, AS-CONSTRUCTED DRAWINGS, UTILITY DRAWINGS AND INFRASTRUCTURE MAPPING PROVIDED BY THE CITY OF OTTAWA.

CONTRACTOR TO CONFIRM ELEVATIONS AND LOCATIONS OF EXISTING UNDERGROUND SERVICES AND UTILITIES WITHIN THE RIGHT OF WAY PRIOR TO INSTALLATION OF SITE SERVICING INFRASTRUCTURE.

THE CONTRACTOR SHALL IMPLEMENT BEST MANAGEMENT PRACTICES, TO PROVIDE FOR PROTECTION OF THE AREA DRAINAGE SYSTEM AND THE RECEIVING WATERCOURSE. DURING CONSTRUCTION ACTIVITIES, THE CONTRACTOR ACKNOWLEDGES THAT THE FAILURE TO IMPLEMENT APPROPRIATE EROSION AND SEDIMENT CONTROL MEASURES MAY BE SUBJECT TO PENALTIES IMPOSED BY ANY APPLICABLE REGULATORY AGENCY.

NOT FOR CONSTRUCTION

TOPOGRAPHIC INFORMATION
 TOPOGRAPHIC INFORMATION PROVIDED BY ANNIS, O'SULLIVAN, VOLLEBEKK LTD.
 PROJ. NO. 19336-17
 DATED MAY 16, 2017

SITE PLAN INFORMATION
 SITE PLAN PROVIDED BY RLA ARCHITECTURE
 PROJ. NO. 1733
 ISSUED SEPTEMBER 5, 2019

GEOTECHNICAL STUDY
 GEOTECHNICAL RECOMMENDATIONS PROVIDED BY PATERSON GROUP INC.
 PROJ. NO. PG1630-5
 DATED JANUARY 14, 2018

SITE SERVICING AND STORMWATER MANAGEMENT STUDY
 SERVICING AND STORMWATER MANAGEMENT RECOMMENDATIONS PROVIDED BY DSEL
 PROJ. 18-1055
 DATED SEPTEMBER 2019

BENCH MARK
 TOP OF HYDRANT SPINDLE LOCATED NEAR THE SOUTH EAST CORNER OF 2781 BASELINE ROAD
 ELEV=78.88m

No.	BY	YY.MM.DD	DESCRIPTION
2	A.J.G.	19.09.11	ISSUED FOR MUNICIPAL REVIEW
1	A.J.G.	19.01.15	ISSUED FOR MUNICIPAL REVIEW



PROJECT No18-1055

PLAN & PROFILE - STREET THREE
 2795 BASELINE ROAD - PHASE 2 © DSEL

GREATWISE DEVELOPMENTS 333 Wilson Avenue, Suite 200
 Toronto, Ontario, M3H 1T2

DSEL
 david schaeffer engineering ltd
 SMART SUBVISIONS™

120 Iber Road Unit 103
 Stittsville, Ontario, K2S 1E9
 Tel. (613) 836-0856
 Fax. (613) 836-7183
 www.DSEL.ca

DRAWN BY: A.J.G. CHECKED BY: A.D.F. DRAWING NO. SHEET NO.
 DESIGNED BY: A.J.G. CHECKED BY: A.D.F. PP-3 8 of 8
 SCALE: h:1:250 v:1:25 DATE: JANUARY 2019

PLEASE REFER TO DRAWING DS-1 FOR NOTES

D07-12-XX-XXXX