

CROSSING TABLE			
CROSSING ID	TOP PIPE	BOTTOM PIPE	CLEARANCE
1	SAN INV. 87.62	WM OBV. 87.12 (DEFLECTED)	0.5m
2	SAN OBV. 87.42	WM OBV. 86.92 (DEFLECTED)	0.5m
3	WM INV. 87.10	STM OBV. 86.56	0.5m

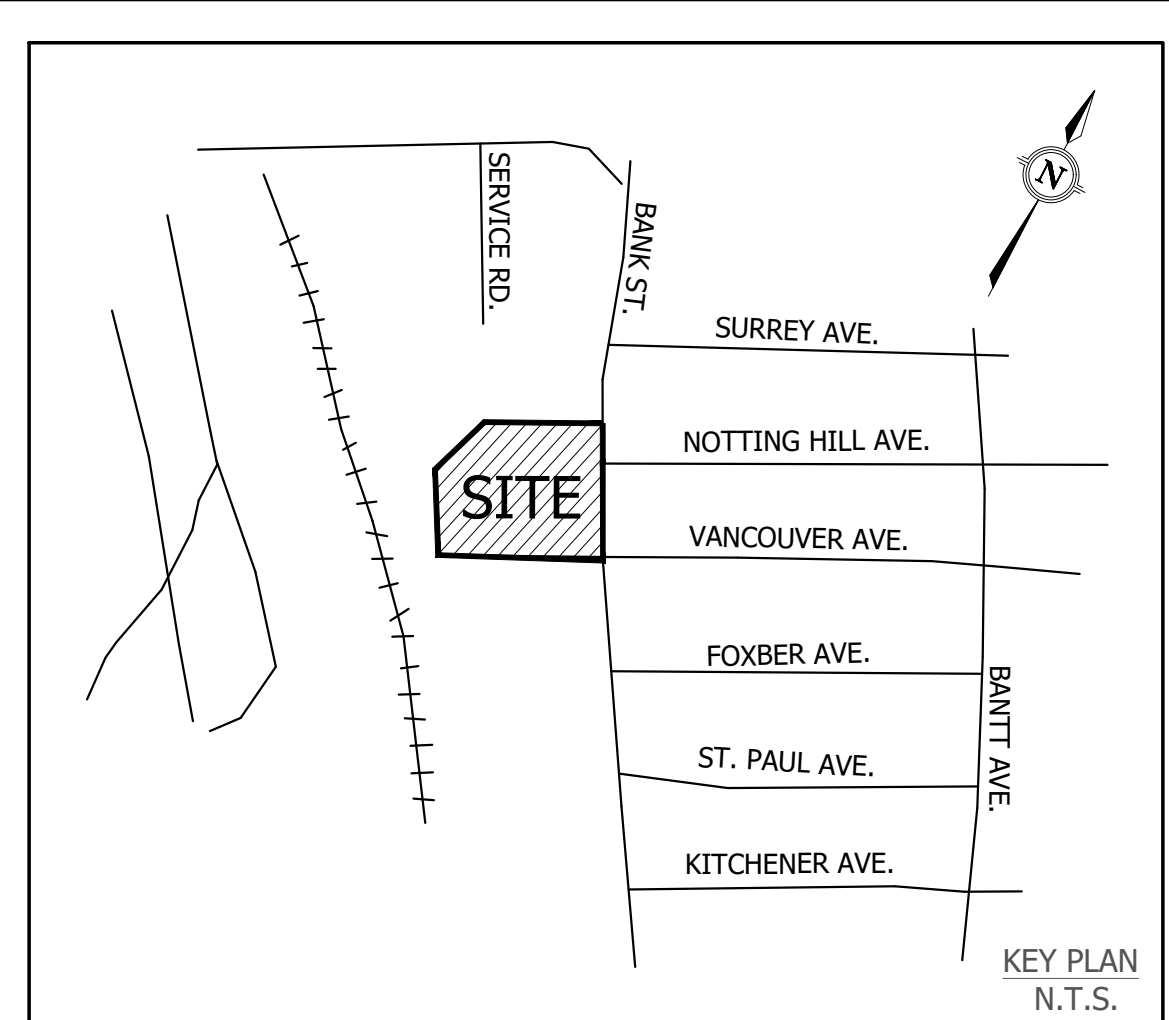

LEGEND

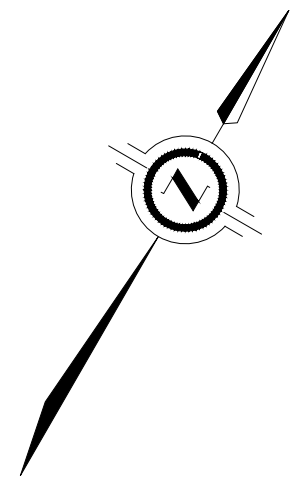
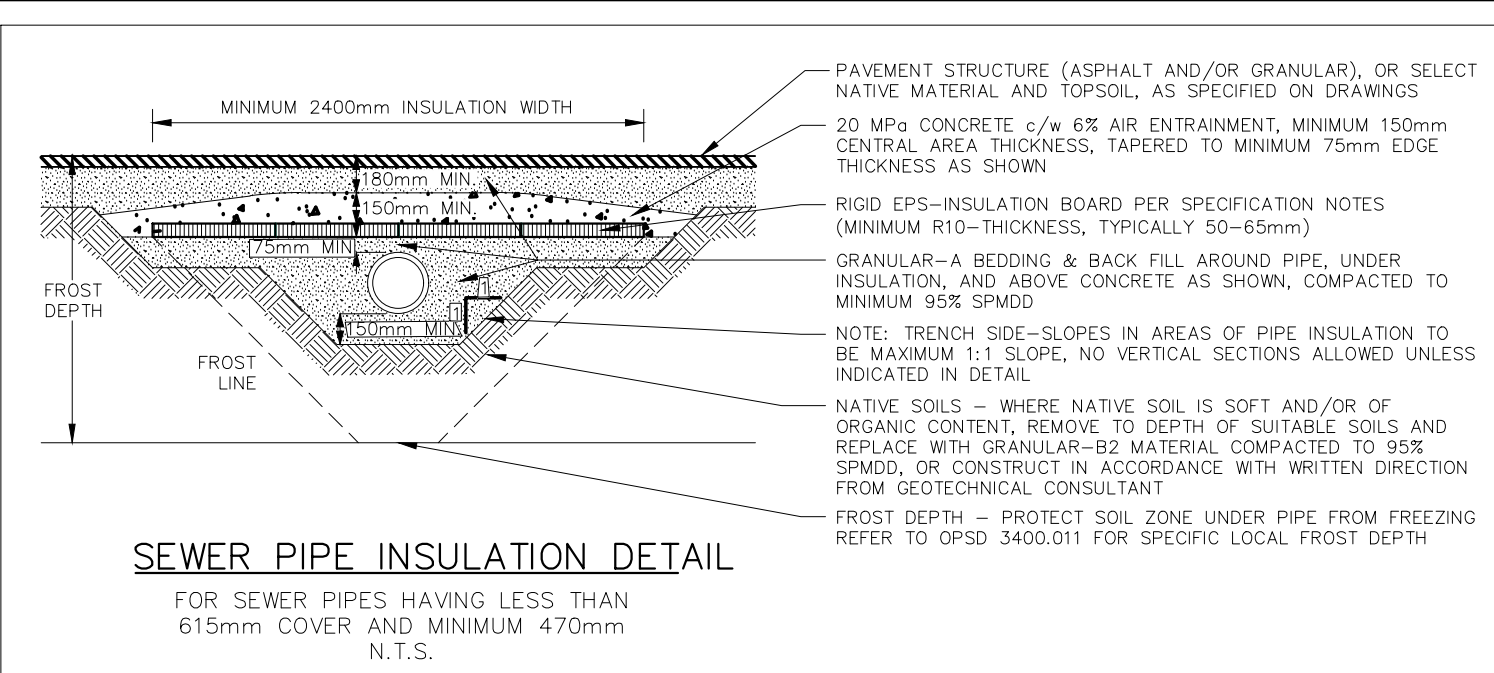
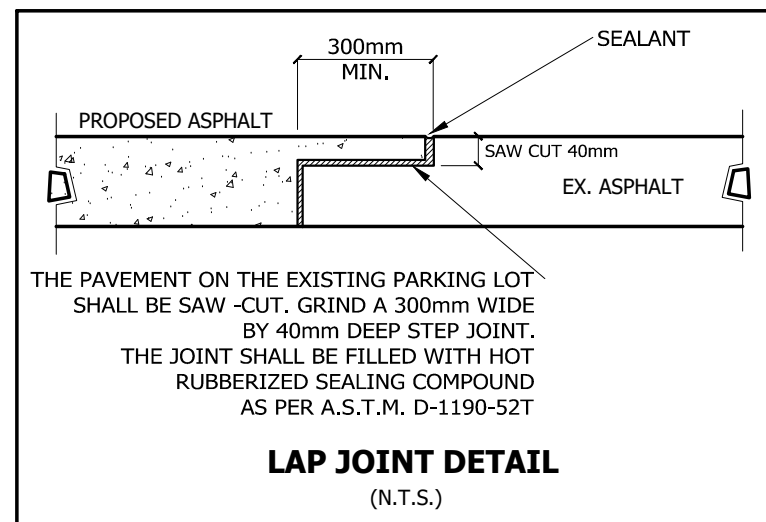
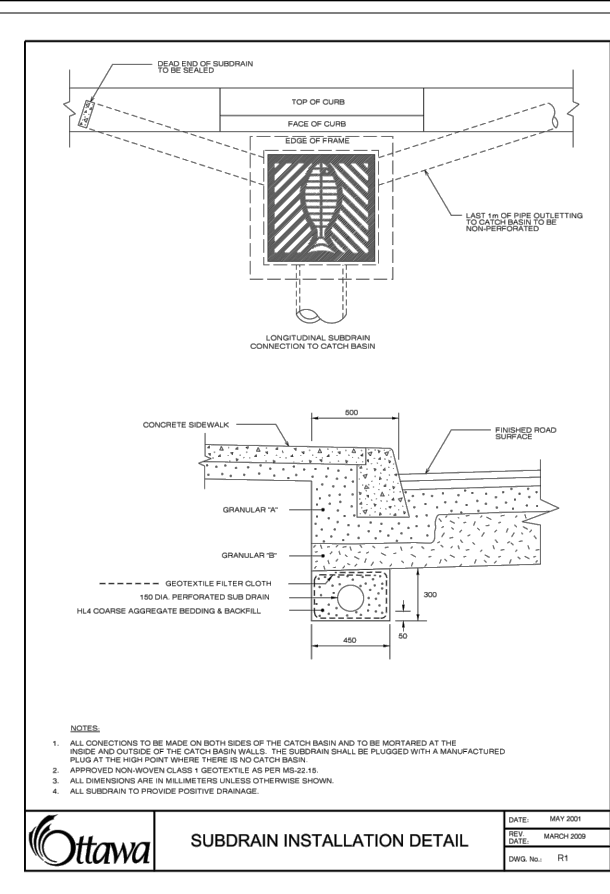
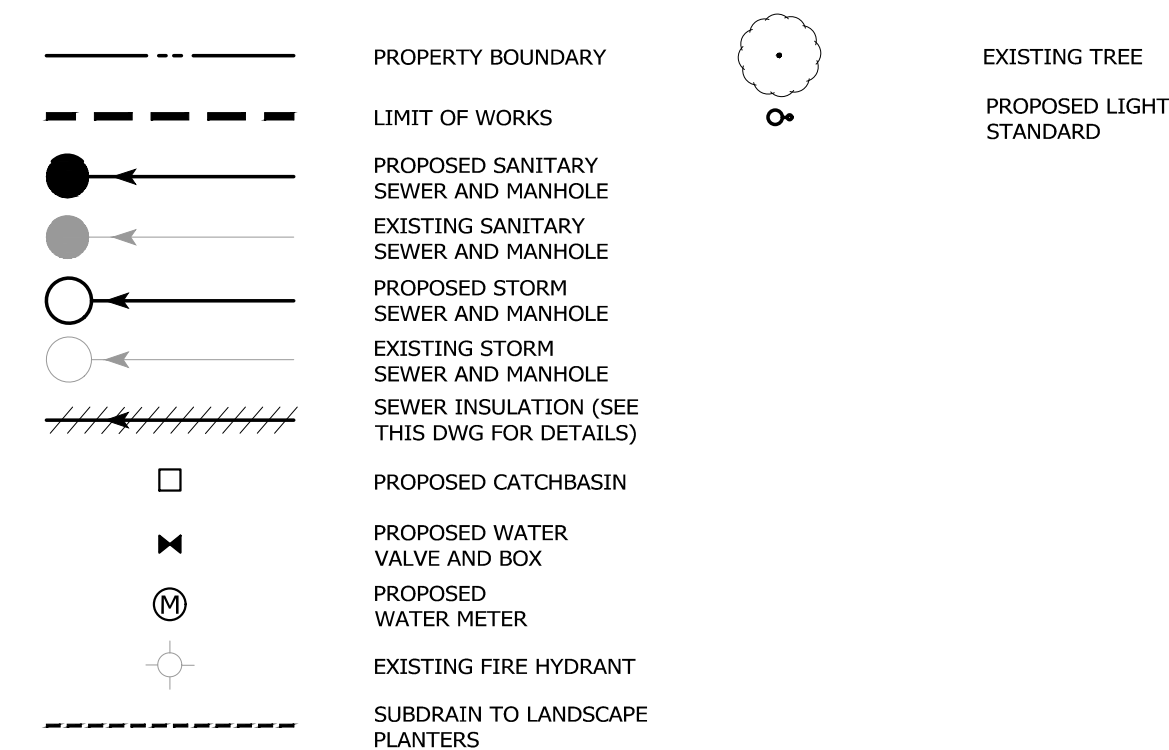

GENERAL NOTES

1. ANY INFORMATION SHOWN ON THIS PLAN REGARDING LOCATION AND SIZE OF EXISTING UTILITIES OR SERVICES IS FURNISHED AS THE BEST INFORMATION AVAILABLE. THE OWNER AND HIS AGENTS DISCLAIM ANY RESPONSIBILITY FOR ITS ACCURACY OR SUFFICIENCY. THE CONTRACTOR SHALL BE RESPONSIBLE FOR CONTACTING ALL UTILITY COMPANIES PRIOR TO CONSTRUCTION TO OBTAIN STAKE OUTS AND DETAILS OF EXISTING SERVICES.
2. ALL CONSTRUCTION WORK FOR THIS PROJECT SHALL COMPLY WITH THE CITY OF OTTAWA OR ONTARIO PROVINCIAL STANDARDS AND SPECIFICATIONS.
3. ALL SURFACE DRAINAGE SHALL BE SELF CONTAINED, COLLECTED AND DISCHARGED AT A LOCATION TO BE APPROVED PRIOR TO ISSUANCE OF A BUILDING PERMIT. DRAINAGE OF ADJUTING PROPERTIES SHALL NOT BE ADVERSELY AFFECTED.
4. PROPOSED ELEVATIONS ALONG SITE PROPERTY LINES MUST MATCH EXISTING ELEVATIONS UNLESS SHOWN OTHERWISE.
5. A UTILITY CLEARANCE RADIUS OF 1.2m BETWEEN THE PROPOSED DRIVEWAY ENTRANCE CURB RETURN AND ALL ABOVE GROUND UTILITIES MUST BE MAINTAINED.
6. A SILT FENCE AS PER DETAIL B ON THIS DRAWING MUST BE PLACED ALONG PROPERTY LINE AT THE LOW POINTS.
7. ALL CURB ON PRIVATE PROPERTY TO BE BARRIER CURB AS PER OPSD 600.11 UNLESS OTHERWISE DIRECTED BY THE OWNER. CONTRACTOR SHALL VISIT THE SITE TO DETERMINE THE REQUIRED REMOVALS.
8. CONNECTION TO EXISTING ASPHALT SHALL BE DONE AS PER LAP JOINT DETAIL THIS DRAWING.
9. TOPOGRAPHIC SURVEY PROVIDED BY FARLEY, SMITH & DENIS SURVEYING LTD., ONTARIO LAND SURVEYORS, FEB 19, 2002 (FILE NO. 374-01).
10. ALL DIMENSIONS SHALL BE CHECKED AND VERIFIED IN THE FIELD BY THE CONTRACTOR PRIOR TO CONSTRUCTION AND ANY DISCREPANCIES SHALL BE REPORTED IMMEDIATELY TO THE ENGINEER.
11. ALL AREAS DISTURBED BY THE CONTRACTOR DURING THE CONSTRUCTION OF WORKS SHOWN HEREON SHALL BE RESTORED TO ORIGINAL CONDITION OR BETTER TO THE SATISFACTION OF THE CITY OF OTTAWA. ALL GRASS AND VEGETATION COVERED AREAS SHALL BE RESTORED BY PLACING 100mm OF APPROVED TOPSOIL AND SOD TO ESTABLISH A GRASS COVER TO THE SATISFACTION OF THE CITY OF OTTAWA.
12. ALL CONSTRUCTION WORKS SHALL BE CARRIED OUT IN ACCORDANCE WITH THE REQUIREMENTS OF THE OCCUPATIONAL HEALTH AND SAFETY ACT AND REGULATIONS THEREOF, THE CONTRACTOR IS DEEMED TO BE THE CONSTRUCTOR, FOR THE PURPOSES OF THE ACT. ALL CONSTRUCTION SIGNS MUST CONFORM TO THE WTO MANUAL "UNIFORM TRAFFIC CONTROL DEVICES" LATEST ADDITION.
13. THE CONTRACTOR SHALL OBTAIN THE PERMIT FROM THE CITY TO CUT THE ROAD, AND CONNECT TO THE EXISTING MUNICIPAL SERVICES. THE CONTRACTOR SHALL MAINTAIN VEHICLE AND PEDESTRIAN TRAFFIC AT ALL TIMES.

ELEVATION NOTE

ELEVATIONS SHOWN HEREON ARE GEODETIC (CGVD-1928-1978) AND ARE DERIVED FROM THE CAN-NET VRS NETWORK MONUMENT: OTTAWA ELEVATION=95.230.

UTILITY NOTE

LOCATION OF UNDERGROUND SERVICES ARE APPROXIMATE AND ARE PER THE CITY OF OTTAWA UCC SHEET No. S-M-15-03 AND M-15-04, PLAN AND PROFILE DWG No. 1725 (SHEET 4 of 6) AND SITE SERVICING PLAN 01 (12320) AND MUST BE VERIFIED PRIOR TO CONSTRUCTION. SITE UNDERGROUND SERVICES LOCATED ON SEPTEMBER 19, 2018 AND MUST BE VERIFIED PRIOR TO CONSTRUCTION.

7	REVISED PER CITY COMMENTS	JUL 09, 2019	R.M.
6	REVISED PER CITY COMMENTS	JUN 12, 2019	R.M.
5	ISSUED FOR SITE PLAN APPROVAL - SECOND SUBMISSION	APR 26, 2019	R.M.
No.	REVISION	DATE	BY

RIO CAN

RioCan Holdings Inc.
RioCan Yonge Eglinton Centre
2300 Yonge Street Suite 500, P.O. Box 2386
Toronto, Ontario M4P 1E4



GENERAL SERVING
PLAN - 1

DESIGNED:	R.M.	CHECKED:	R.M.	PROJECT No.:	18-227W
DRAWN:	R.N.	DATE:	NOVEMBER 2018	DRAWING No.:	
SCALE:	H 1:250				

