

ADAM BROWN
 MANAGER, DEVELOPMENT REVIEW - RURAL
 PLANNING, INFRASTRUCTURE & ECONOMIC
 DEVELOPMENT DEPARTMENT, CITY OF OTTAWA

APPROVED
 By Adam Brown at 11:01 am, Aug 19, 2019

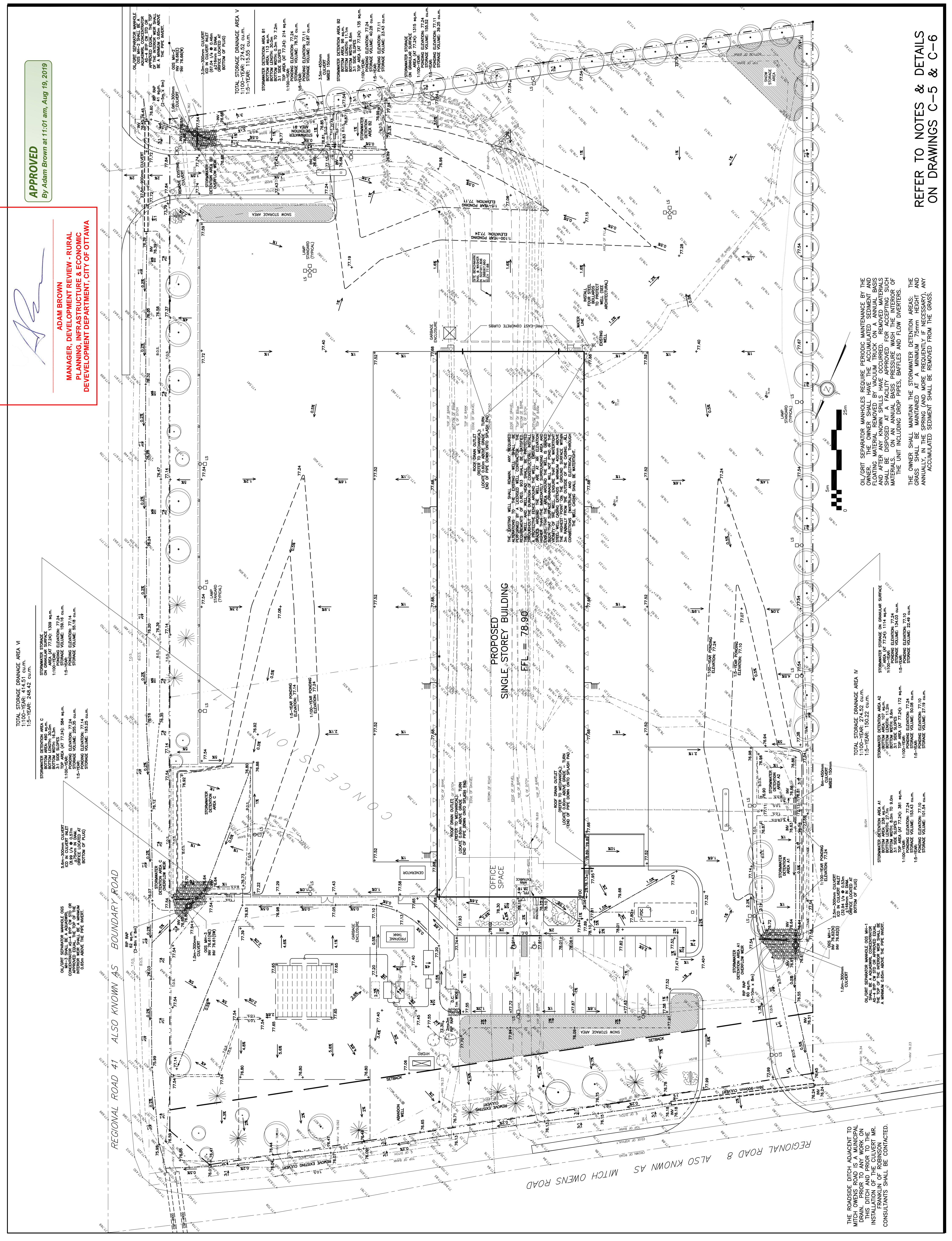

THE ROADSIDE DITCH ADJACENT TO MITCH OWENS ROAD IS A MUNICIPAL ROAD. THE CITY OF OTTAWA HAS AGREED TO MAINTAIN THIS DITCH AND PRIOR TO THE INSTALLATION OF THE CULVERT MR. FRANKLIN OF ROBINSON CONSULTANTS SHALL BE CONTACTED.

Oil/Grease Separator Manholes require periodic maintenance by the owner. The owner shall have the accumulated sediment and floating material removed by vacuum truck on an annual basis and after any known spills have occurred. Removed materials shall be disposed at a facility approved for accepting such materials. The unit including drop pipes, baffles and flow diverters. The owner shall maintain the stormwater detention areas. The grass shall be maintained at a minimum 75mm height and accumulated sediment shall be removed from the grass.

GRADING PLAN

Project: PROPOSED CROSS DOCK FACILITY MITCH OWENS ROAD / BOUNDARY ROAD OTTAWA, ONTARIO

Engineer's Seal
D.B. GRAY ENGINEERING INC.
 Chartered Professional Engineer
 No. 17015502
 Date JUN 9-18
 Job No. 18029
 D.B.G.
 Drawn: 1:400
 Vert. Scale: 1:1
 Date: JUN 9-18
 Job No: 18029

D.B. GRAY ENGINEERING INC.
 700 Long Point Circle
 Ottawa, Ontario K1T 4E9
 Tel: 613-425-8044
 dgray@ingers.com

No.	Date	REVISION
1	JUN 9-18	ISSUED FOR CLIENT REVIEW
2	DEC 13-18	FOR SEPTIC PERMIT
3	DEC 19-18	ISSUED FOR APPROVAL
4	FEB 22-19	RE-ISSUED TO OSO
5	MAR 5-19	ISSUED FOR APPROVAL
6	MAR 20-19	RE-ISSUED FOR BUILDING PERMIT
7	MAY 2-19	RE-ISSUED FOR APPROVAL
8	JUN 14-19	SNOW STORAGE AREAS ADDED
9	JUN 25-19	MINOR REVISIONS - CITY FILE & PLAN NO. ADDED - RE-ISSUED FOR APPROVAL

DRAWING LEGEND	
CB	CATCH BASIN
MM	MANHOLE
CS/MS	CATCH BASIN/MANHOLE
WS/W	WATER SERVICE / WATERMAIN
SM	SANITARY SEWER
ST	STORM SEWER
PH	FIRE HYDRANT
PC	FIRE DEPARTMENT CONNECTION
UP	UTILITY POLE
+	EXISTING GRADE ELEVATION
+	PROPOSED GRADE ELEVATION
---	CONCRETE
---	GRANULAR SURFACE
---	LIGHT DUTY PAVEMENT
---	HEAVY DUTY PAVEMENT
---	SLOPE OF GRADE
---	EXISTING SLOPE OF GRADE
---	EMERGENCY OVERLAND FLOW
---	SWALE/DITCH (CENTRELINE)
---	TOP OF SLOPE
---	BOTTOM OF SLOPE
---	150mm CORR / DERESSED CURB
---	SILT FENCE BARRIER
---	PROPERTY LINE
---	FIRST FLOOR ELEVATION
---	UNDERSIDE OF FOOTING ELEVATION

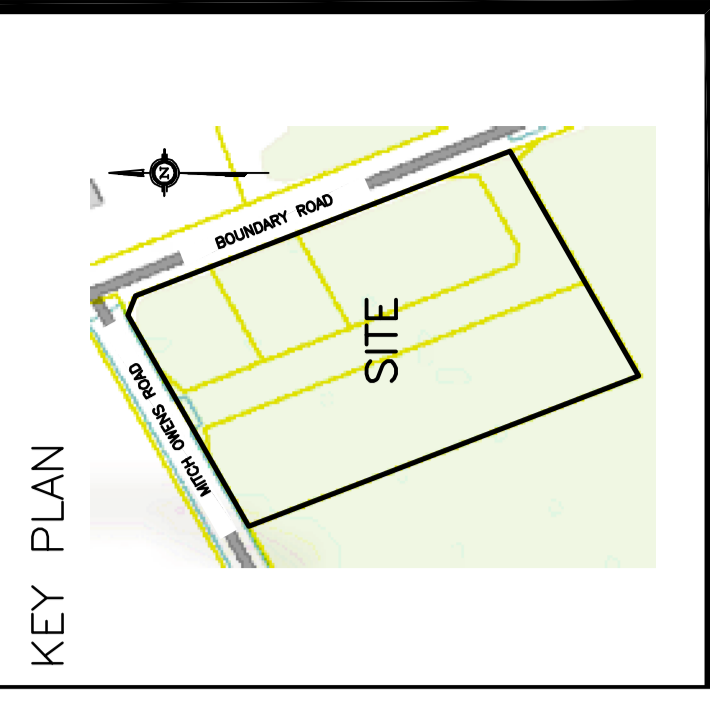

REFER TO NOTES & DETAILS
 ON DRAWINGS C-5 & C-6