

**LEGEND**

---	PROPERTY LINE	○	PROPOSED STORM MANHOLE
---	PROPOSED WATERMAIN	●	PROPOSED SANITARY MANHOLE
---	PROPOSED SANITARY SEWER	■	PROPOSED CATCH BASIN
---	PROPOSED STORM SEWER	○	PROPOSED AREA DRAIN (PER CITY STD. S30 & S31)
---	PROPOSED PERFORATED SUBDRAIN	CMB	COMMUNITY MAILBOX
VB	PROPOSED VALVE BOX	TWSI	TWSI (TACTILE WALKING SURFACE INDICATOR)
◆	PROPOSED FIRE HYDRANT		
▨	PEDESTRIAN CROSSWALK		
---	DEPRESSED CURB		
---	MOUNTABLE CURB (CITY STD SC1.3)		
---	BARRIER CURB (CITY STD SC1.1)		
▤	RIVERSTONE 100mm DIA, 200mm DEEP 1.5m x 1.3m UNLESS OTHERWISE NOTED		
■	1.0m CURB CUT UNLESS OTHERWISE NOTED SEE DETAIL ON DWG DS-1		
▽	STANDARD SERVICES BACK TO BACK TOWNHOMES SEE DETAIL ON DWG DS-2		
▽	STANDARD SERVICES STACKED TOWNHOMES SEE DETAIL ON DWG DS-2		

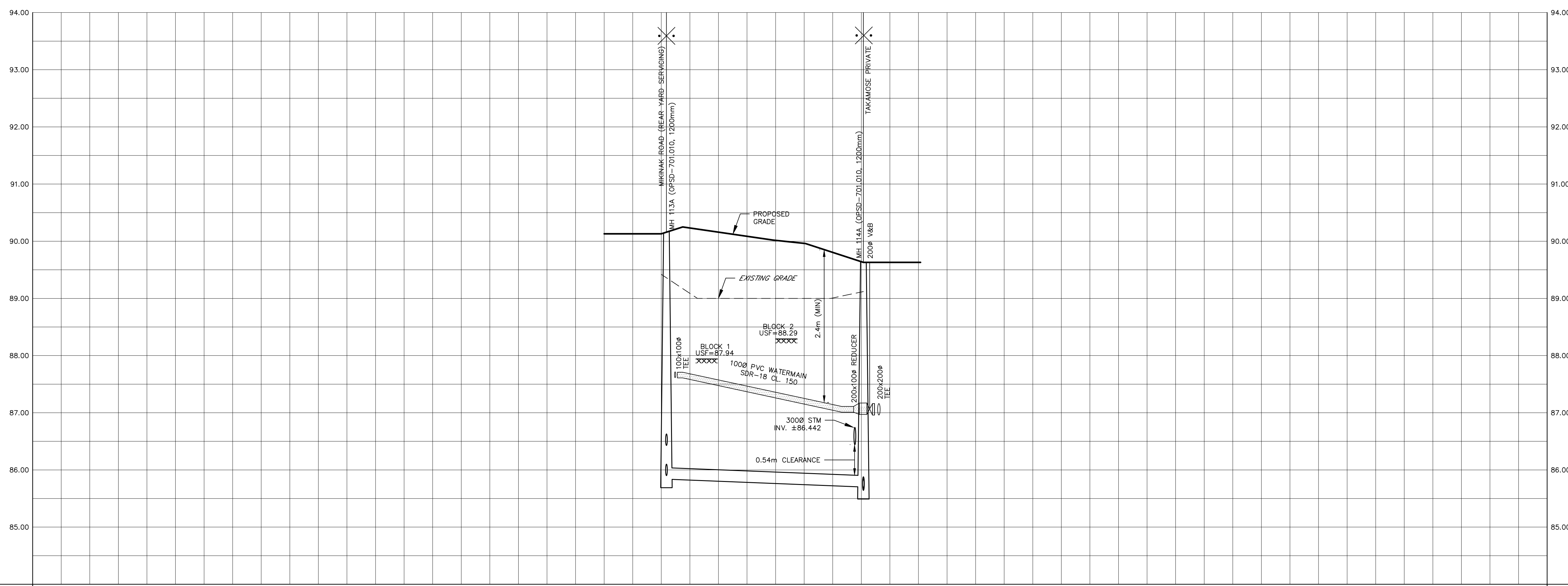

**SITE PLAN INFORMATION**  
 SITE PLAN PROVIDED BY KORSIAK URBAN PLANNING  
 DATED JANUARY 17, 2019

**GEOTECHNICAL STUDY**  
 GEOTECHNICAL RECOMMENDATIONS PROVIDED BY PATERSON GROUP INC.  
 PROJ. NO. PG4064-1  
 DATED AUGUST 8, 2017

**SITE SERVICING AND STORMWATER MANAGEMENT STUDY**  
 SERVICING AND STORMWATER MANAGEMENT RECOMMENDATIONS PROVIDED BY DSEL  
 PROJ. NO. 17-946  
 DATED JANUARY 2019

**BENCH MARK**  
 ELEVATIONS ARE GEODETIC, REFERRED TO CITY OF OTTAWA VERTICAL BENCHMARK NO. 396  
 ELEV= 95.06 METERS

No.	BY	YY.MM.DD	DESCRIPTION
2	G.G.G.	19.06.28	ISSUED FOR MUNICIPAL REVIEW
1	S.L.M.	19.02.01	ISSUED FOR MUNICIPAL REVIEW

TOP OF WATERMAIN	100+000 TEE 86.714 87.709	200+000 TEE 87.110 87.709	200+000 TEE 87.160 87.709	TOP OF WATERMAIN
SANITARY INVERT	W 85.809 E 86.427 S 85.839	2000 PVC SAN 34.45 @ 0.40% SDR-35	N 85.701 E 85.679 W 85.641	SANITARY INVERT
STORM INVERT				STORM INVERT
PROPOSED CENTERLINE GRADES	90.189		89.630	PROPOSED CENTERLINE GRADES
CENTERLINE CHAINAGE	0+000.000	0+020.000	0+035.360 0+040.000	CENTERLINE CHAINAGE

PROJECT No. 17-946

**SERVICING BETWEEN BLK 1 & BLK 2 - PLAN & PROFILE**  
 (STA 0+000.00 TO STA 0+040.00)  
 WATERIDGE - BLOCK 15 © DSEL

MATTAMY HOMES  
 50 Hines Road, Suite 100  
 Ottawa, Ontario, K2K 2M5  
 Tel. (613) 831-5144

**DSEL**  
 david schaeffer engineering ltd  
 SMART SUBDIVISIONS™  
 120 Iber Road Unit 103  
 Stittsville, Ontario, K2S 1E9  
 Tel. (613) 836-0856  
 Fax. (613) 836-7183  
 www.DSEL.ca

DRAWN BY:	G.G.G.	CHECKED BY:	S.L.M.	DRAWING NO.	
DESIGNED BY:	G.G.G.	CHECKED BY:	S.L.M.	PP-6	
SCALE:	H 1:400, V 1:40	DATE:	JANUARY 2019		SHEET NO. 9 of 12