

REV	DATE	DESCRIPTION
01	AUG 30, 2018	ISSUED FOR REVIEW
02	SEPT 11, 2018	ISSUED FOR SITE PLAN APPROVAL
03	JAN 15, 2019	RE-ISSUED FOR SITE PLAN APPROVAL
04	FEB 20, 2019	RE-ISSUED FOR SITE PLAN APPROVAL
05	FEB 27, 2019	ISSUED FOR BUILDING PERMIT

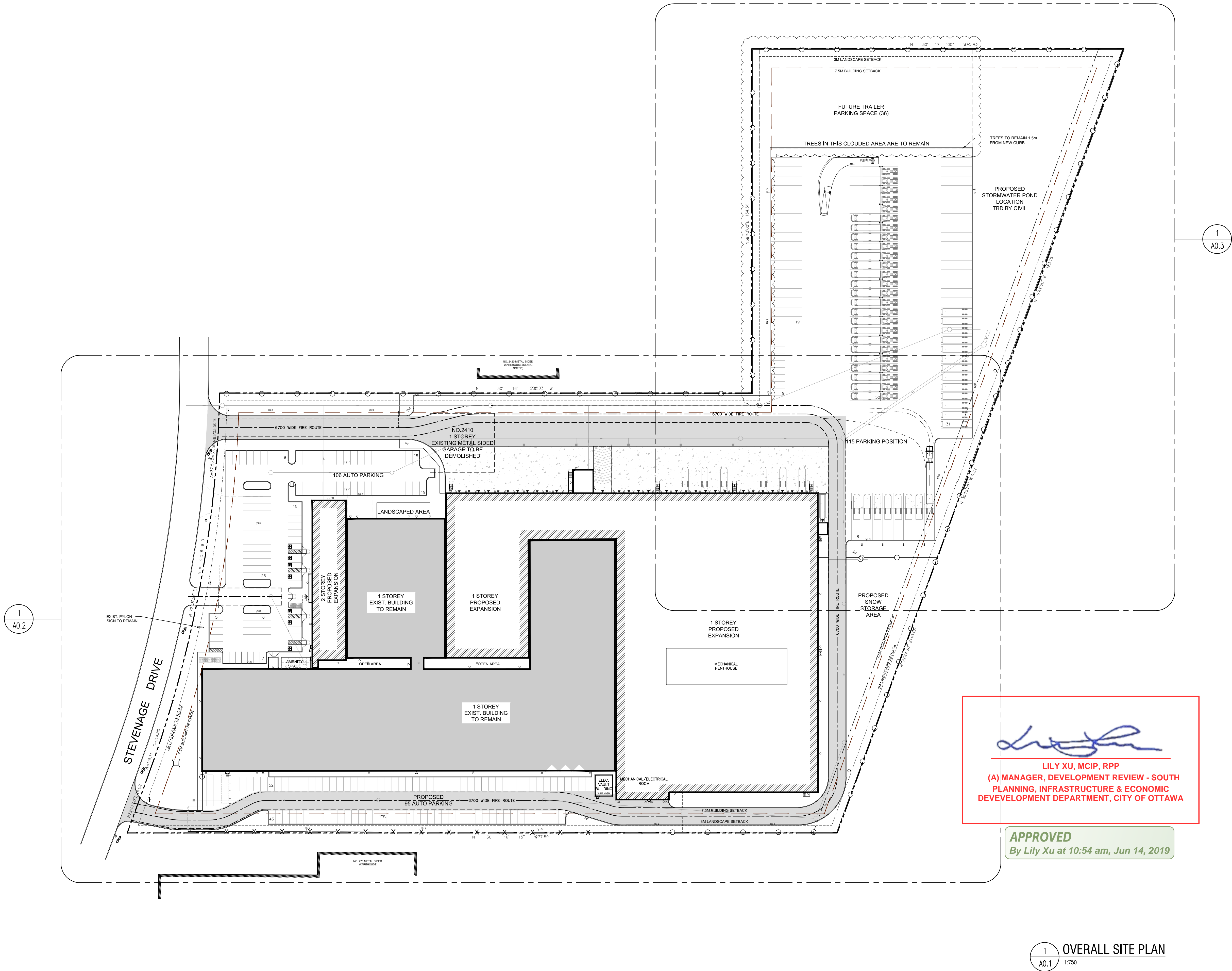

PROPERTY BOUNDARY INFORMATION WAS DERIVED FROM SURVEY OF:
PART OF LOTS 3 AND 4
CONCESSION 5 (RIDEAU FRONT)
GEOGRAPHIC TOWNSHIP OF GLOUCESTER, CITY OF OTTAWA
SURVEYED BY ANNIS, O'SULLIVAN, VOLLEBEKK LTD.
SURVEY COMPLETED ON AUGUST 22, 2018

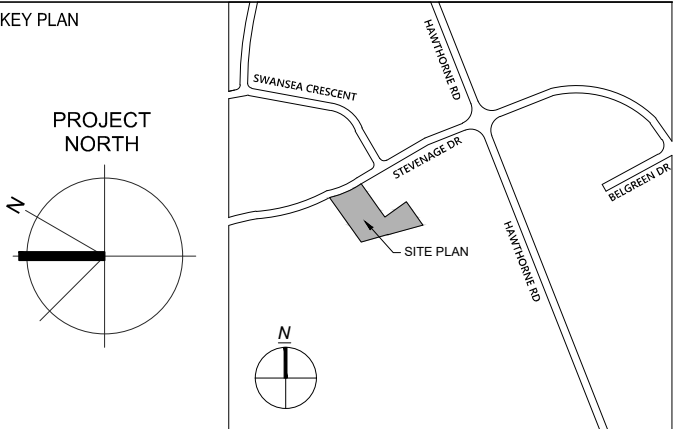

Glenn Piotrowski Architect

ONTARIO ASSOCIATION OF ARCHITECTS
GLENN PIOTROWSKI ARCHITECT LTD.
167 NAVY STREET
OAKVILLE, ON
L6J 2Z6
905.338.8855

DESIGN BUILDER
BBS
BUILDING A REPUTATION ON EXCELLENCE
BBS CONSTRUCTION (ONTARIO) LTD.
1805 WOODWARD DRIVE,
OTTAWA, ON K2C 0P9 CANADA
TEL:613-226-8830 FAX:613-226-7709

PROJECT
SYSCO TANNIS
FACILITY EXPANSION & SITE PLAN MODIFICATIONS

2390 STEVENAGE DRIVE, OTTAWA, ON K1G 3W3

SHEET TITLE
OVERALL SITE PLAN

DRAWN BY PY
DATE
SCALE 1:750
PROJECT NO.
SHEET NO.

A0.1

#17811

LILY XU, MCIP, RPP
(A) MANAGER, DEVELOPMENT REVIEW - SOUTH
PLANNING, INFRASTRUCTURE & ECONOMIC
DEVELOPMENT DEPARTMENT, CITY OF OTTAWA

APPROVED
By Lily Xu at 10:54 am, Jun 14, 2019

1
A0.1 1:750



ZONING BY LAW		
IH 201 HEAVY INDUSTRIAL ZONE PROVISIONS		
ZONING MECHANISMS	REQUIRED	PROVIDED
(A) MINIMUM LOT WIDTH (M)	N/A	175 (EXISTING)
(B) MINIMUM LOT AREA (M ²)	4,000	65,342
(C) MINIMUM FRONT YARD AND CORNER YARD SETBACK (M)	7.5	7.74 (EXISTING)
(D) MINIMUM INTERIOR YARD AND REAR YARD SETBACK (M)		
(i) ABUTTING A RESIDENTIAL OR INSTITUTIONAL ZONE	15	N/A
(ii) ALL OTHER CASES	7.5	12.47
(E) MAXIMUM FLOOR SPACE INDEX	2	2-TBD
(F) MAXIMUM BUILDING HEIGHT	22	11-TBD
(G) MINIMUM WIDTH OF LANDSCAPING (M)		
(i) ABUTTING A RESIDENTIAL OR INSTITUTIONAL ZONE	7.5	N/A
(ii) IN ALL OTHER CASES	3	3 AND 1.05@LOADING AREA ONLY

Site plan for the proposed development at 15000 104th Avenue. The plan shows the layout of the parking lot, building footprint, and surrounding streets. Key dimensions and features include:

- Lot dimensions: 134.56m (North-South) and 113.39m (East-West).
- Building footprint: 83.22m (North-South) and 12.03m (East-West).
- Parking stalls: 91.44m (North-South) and 12.03m (East-West).
- Block heaters on HSS post @ EVERY OTHER PARKING STALL c/w 2 OR 4 RECEPTACLES FOR TOTAL 50 PARKING.
- Dimensions for the parking lot: 7.500m, 12.192m, 18.653m, 12.203m, 0.705m, 16.757m, 12.199m.
- Dimensions for the building footprint: 3.00m, 3.60m, 83.22m, 12.03m.
- Dimensions for the parking stalls: 91.44m, 12.03m.
- Dimensions for the parking lot: 96.80m, 3.55m (12' 0").
- Dimensions for the building footprint: 83.22m, 12.03m.
- Dimensions for the parking stalls: 91.44m, 12.03m.
- Dimensions for the parking lot: 7.500m, 12.192m, 18.653m, 12.203m, 0.705m, 16.757m, 12.199m.
- Dimensions for the building footprint: 3.00m, 3.60m, 83.22m, 12.03m.
- Dimensions for the parking stalls: 91.44m, 12.03m.
- Dimensions for the parking lot: 96.80m, 3.55m (12' 0").

APPROVED
By Lily Xu at 10:54 am, Jun 14, 2019

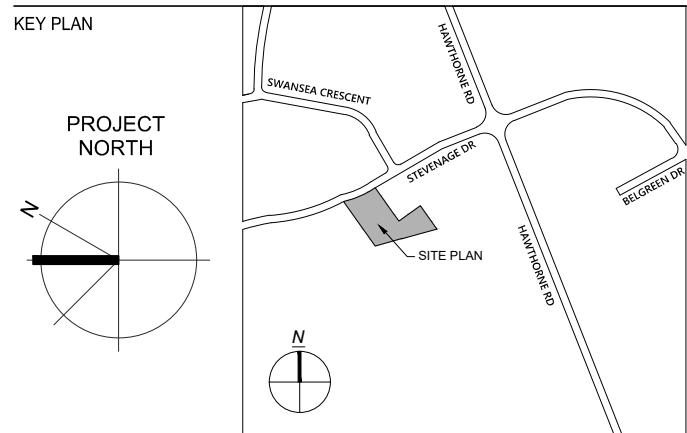
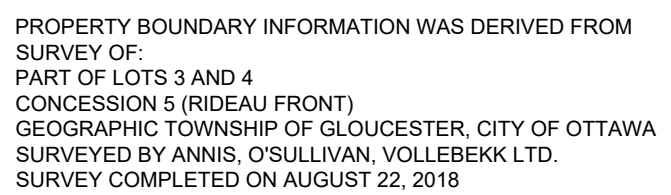

Good things
come from
Sysco®

Glenn Piotrowski Architect

 GLENN PIOTROWSKI ARCHITECT LTD.
 167 NAVY STREET
 OAKVILLE, ON.
 L6J 2Z6
 905.338.8855

DESIGN BUILDER

BBS

BUILDING A REPUTATION ON EXCELLENCE

BBS CONSTRUCTION (ONTARIO) LTD.
1805 WOODWARD DRIVE,
OTTAWA, ON K2C 0P9 CANADA
TEL: 613-226-8830 FAX: 613-226-7709

PROJECT

SYSCO TANNIS

**FACILITY EXPANSION & SITE PLAN
MODIFICATIONS**

**2390 STEVENAGE DRIVE, OTTAWA,
ON K1G 3W3**

PARTIAL SITE PLAN

DRAWN BY PY

DATE _____

SCALE 1:500

PROJECT NO. _____

A0.2

LEGEND					
+ 00.00	EXISTING SPOT ELEVATION	□ LS	NEW LIGHT POLE	GM	GAS METER
+ 00.00	NEW SPOT ELEVATION	○	NEW WALL MOUNTED LIGHT	○ EX. MH	EXISTING MANHOLE
●	EXISTING TREE	■	HEAVY DUTY ASPHALT	⊠ EX. HYD	EXISTING CITY HYDRANT
Y SC	SIAMESE CONNECTION (WALL MOUNTED)	□	CONCRETE PAVING	◆ EX. LS	EXISTING LIGHT STANDARD
▨	PAINTED LINES TYP.	△	EXIT/ACCESS DOOR	□ EX. CB	EXISTING CATCH BASIN
HC	BARRIER FREE RAMP CW WITH CURB DEPRESSION (CD)	▲	SECURE EXIT/ACCESS DOOR	○ MH	MANHOLE
---	PROPERTY LINE	△	O/H DOOR AT LOADING DOCKS	⊠ HYD	CITY HYDRANT
---	REQUIRED ROAD WIDENING SETBACK	□	ENTRANCE SIGNAGE	□ CB	CATCH BASIN
-x-x-x-	EXISTING CHAIN LINK FENCE	□ CB	SIGNAGE "DO NOT USE HORNS TO SIGNAL THE OPENING OF BAY DOORS"	□ CB	DOUBLE CATCH BASIN
---	NEW CHAIN LINK FENCE	FC	FLUSH CURB	○ HC	HANDICAP PARKING SIGN
		TW	TOP OF RETAINING WALL	⊕	VEHICULAR ENTRANCE SIGN
		TC	TOP OF CURB	⊕	BOLLARD
		BC	BOTTOM OF CURB	⊕	PARKING COUNT
		⊕ CBMH	CATCH BASIN MANHOLE	⊕ P	PRINCIPAL ENTRANCE

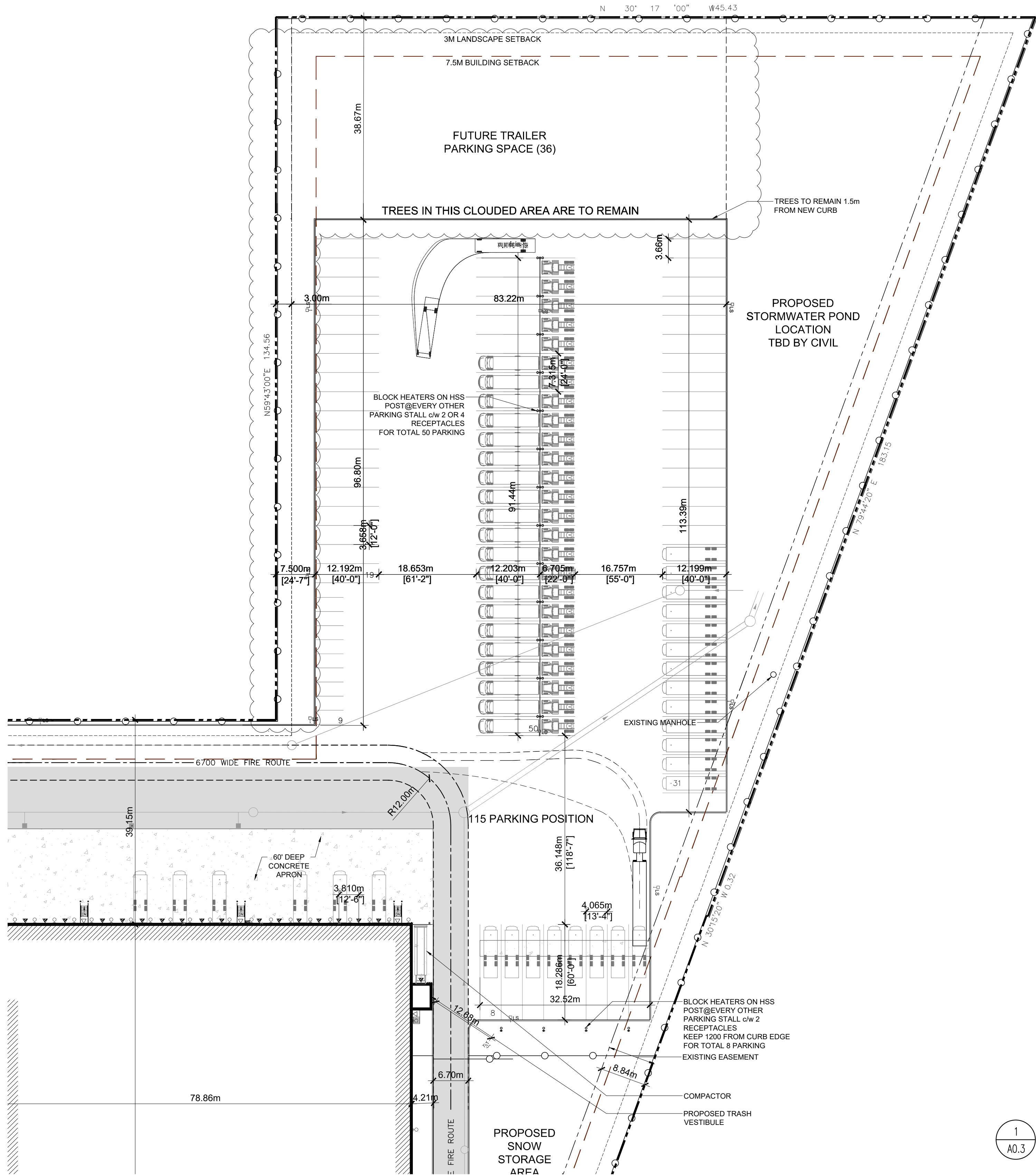

1 PARTIAL SITE PLAN
A0.3 1:500



REV	DATE	DESCRIPTION
01	AUG 30, 2018	ISSUED FOR REVIEW
02	SEPT 11, 2018	ISSUED FOR SITE PLAN APPROVAL
03	JAN 15, 2019	RE-ISSUED FOR SITE PLAN APPROVAL
04	FEB 20, 2019	RE-ISSUED FOR SITE PLAN APPROVAL
05	FEB 27, 2019	ISSUED FOR BUILDING PERMIT

[Signature]

LILY XU, MCIP, RPP
(A) MANAGER, DEVELOPMENT REVIEW - SOUTH
PLANNING, INFRASTRUCTURE & ECONOMIC
DEVELOPMENT DEPARTMENT, CITY OF OTTAWA

APPROVED

By Lily Xu at 10:54 am, Jun 14, 2019

PROPERTY BOUNDARY INFORMATION WAS DERIVED FROM
SURVEY OF:
PART OF LOTS 3 AND 4
CONCESSION 5 (RIDEAU FRONT)
GEOGRAPHIC TOWNSHIP OF GLOUCESTER, CITY OF OTTAWA
SURVEYED BY ANNIS, O'SULLIVAN, VOLLEBEKK LTD.
SURVEY COMPLETED ON AUGUST 22, 2018

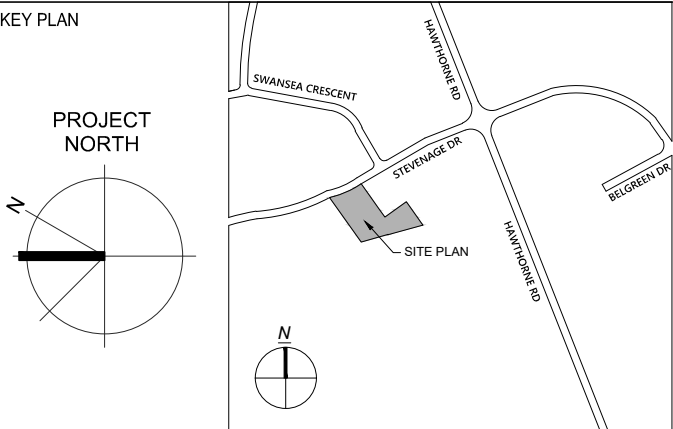

Glenn Piotrowski Architect

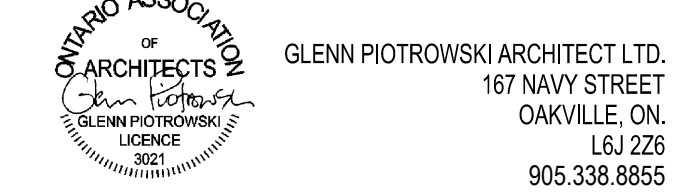

DESIGN BUILDER



BBS CONSTRUCTION (ONTARIO) LTD.
1805 WOODWARD DRIVE,
OTTAWA, ON K2C 0P9 CANADA
TEL:613-226-8830 FAX:613-226-1709

PROJECT

SYSCO TANNIS

FACILITY EXPANSION & SITE PLAN
MODIFICATIONS

2390 STEVENAGE DRIVE, OTTAWA,
ON K1G 3W3

SHEET TITLE

PARTIAL SITE PLAN

DRAWN BY PY

DATE

SCALE

1:500

PROJECT NO.

SHEET NO.

A0.3

#17811

D07-12-18-0135

REV	DATE	DESCRIPTION
01	JAN 15, 2019	ISSUED FOR SITE PLAN APPROVAL
02	FEB 20, 2019	RE-ISSUED FOR SITE PLAN APPROVAL
03	FEB 27, 2019	ISSUED FOR BUILDING PERMIT

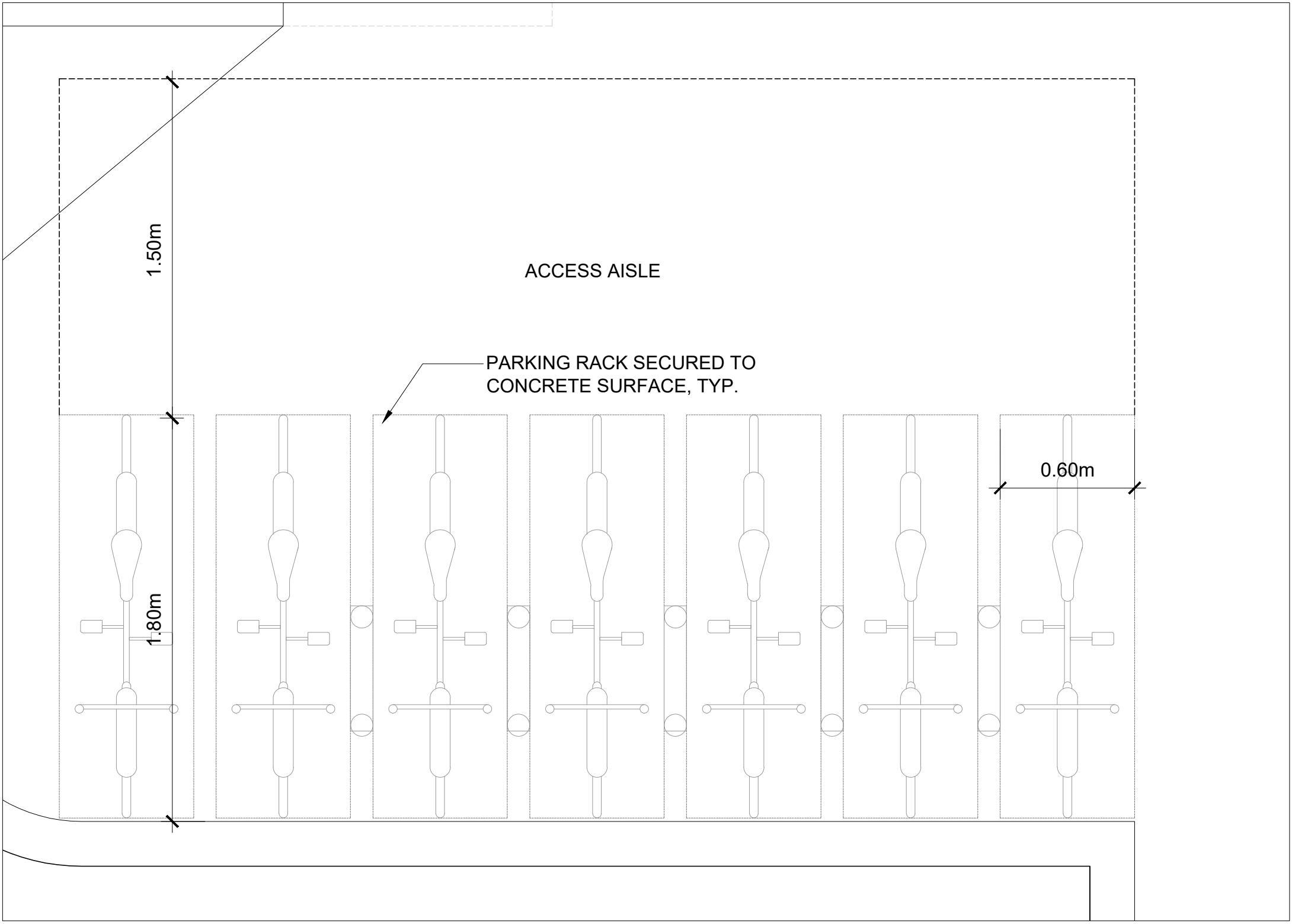

1 BICYCLE PARKING PLAN
A0.4 1:20

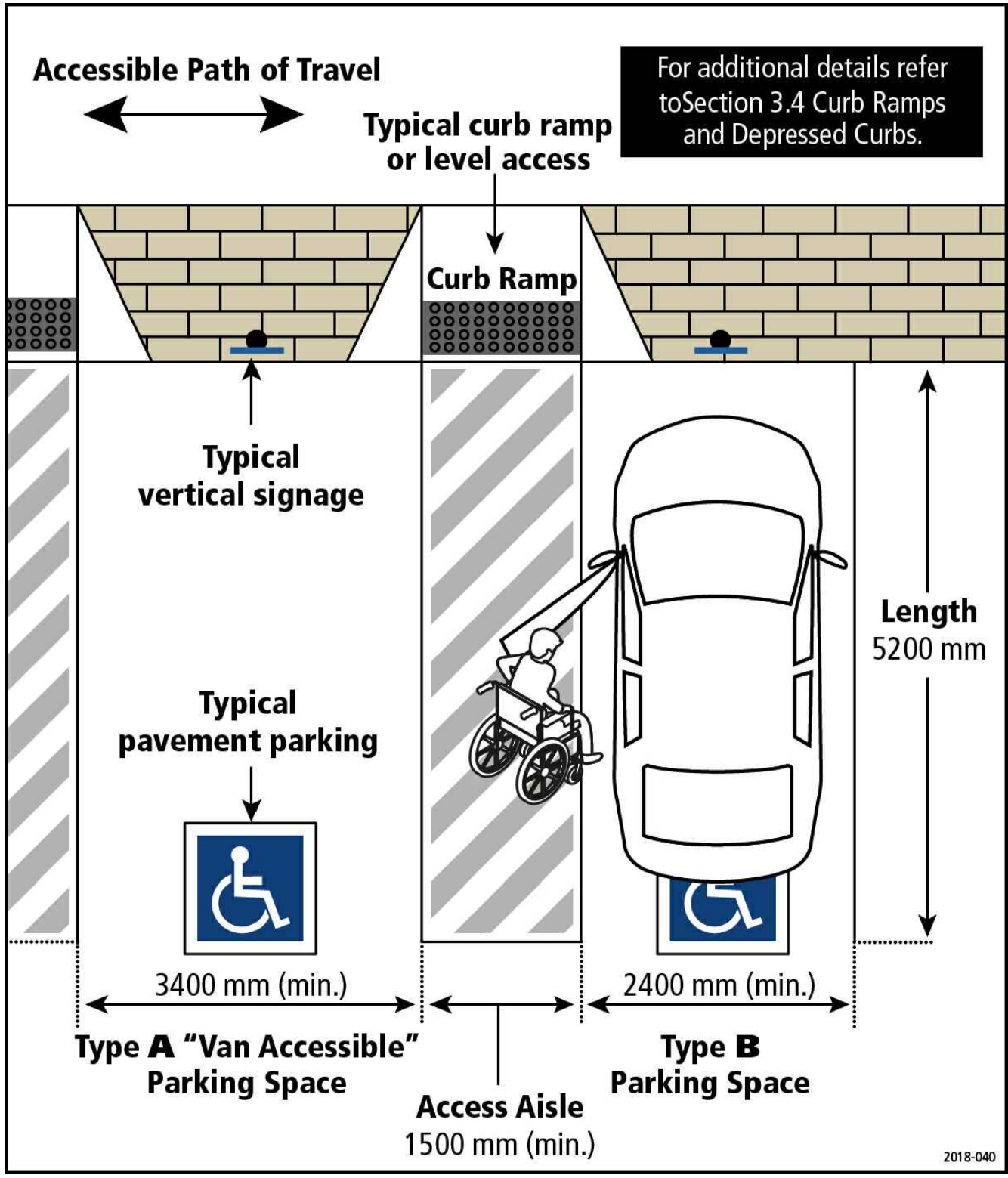

2 ACCESSIBLE PARKING DETAILS
A0.4 1:20

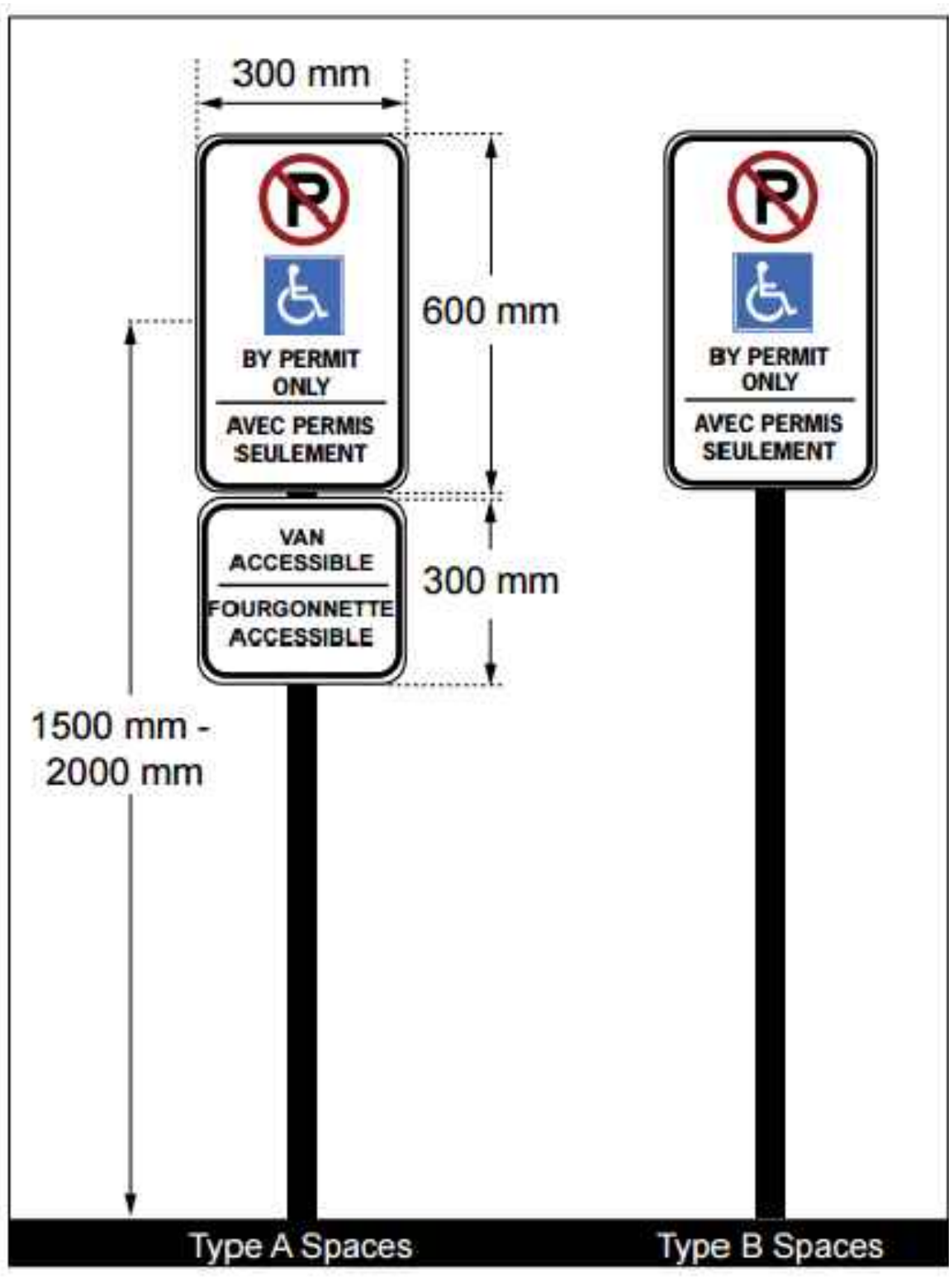

3 ACCESSIBLE PARKING SIGNAGE DETAILS
A0.4 1:20

Lily Xu
LILY XU, MCIP, RPP
(A) MANAGER, DEVELOPMENT REVIEW - SOUTH
PLANNING, INFRASTRUCTURE & ECONOMIC
DEVELOPMENT DEPARTMENT, CITY OF OTTAWA

APPROVED
By Lily Xu at 10:54 am, Jun 14, 2019

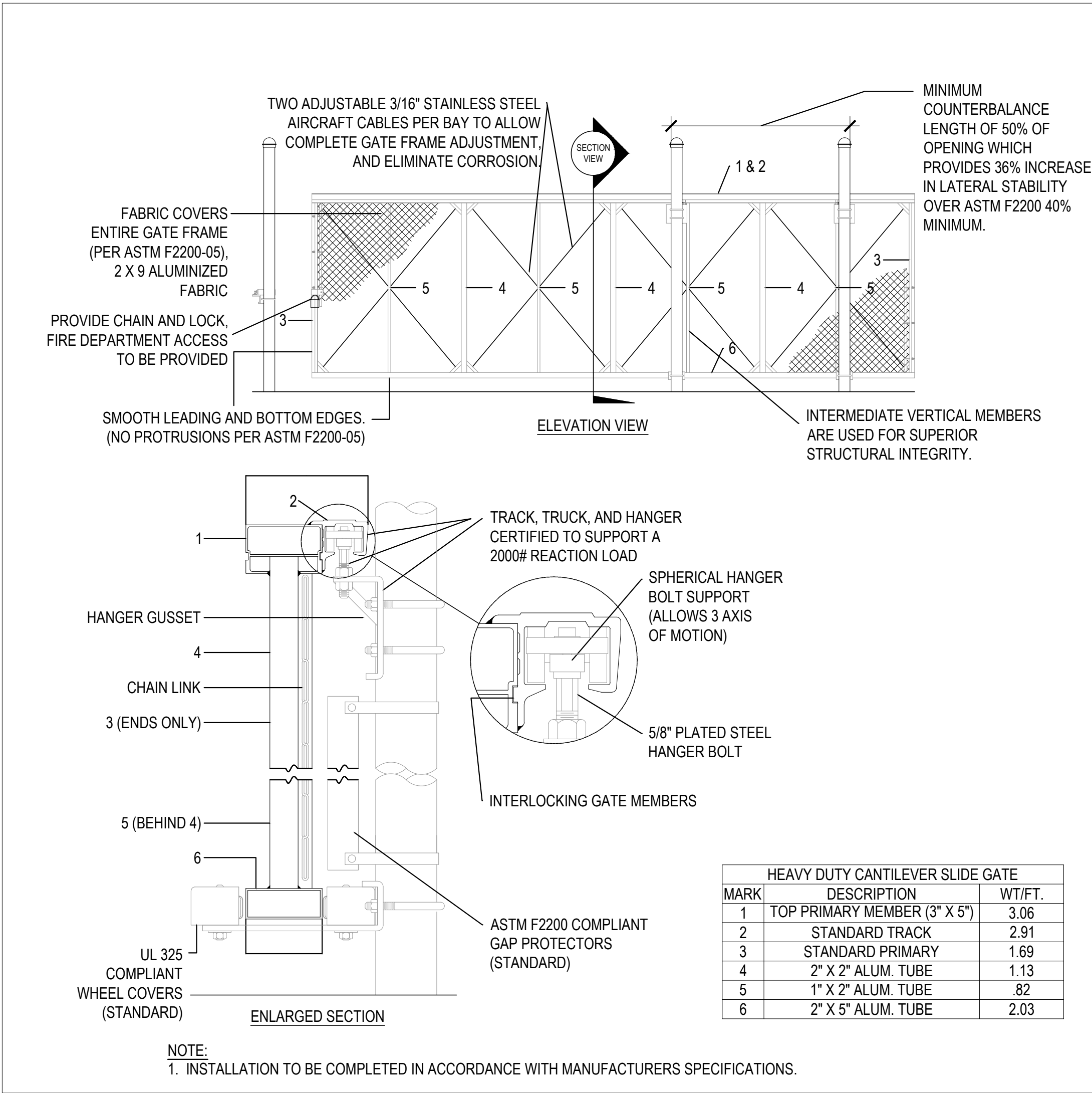

4 GATE DETAIL - MANUAL SLIDING GATE
A0.4 1:20

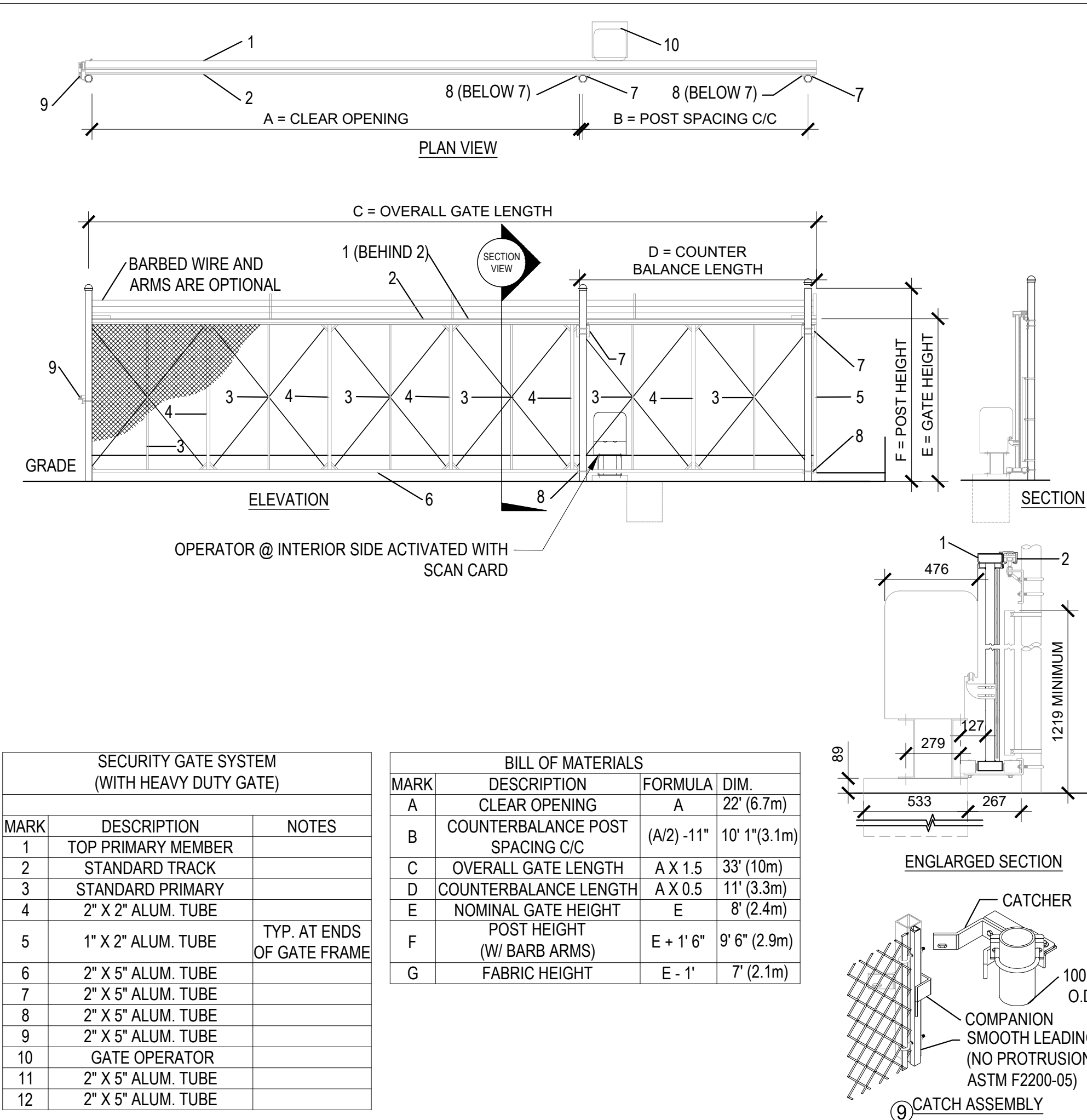

5 GATE DETAIL - MOTORIZED SLIDING GATE
A0.4 1:20

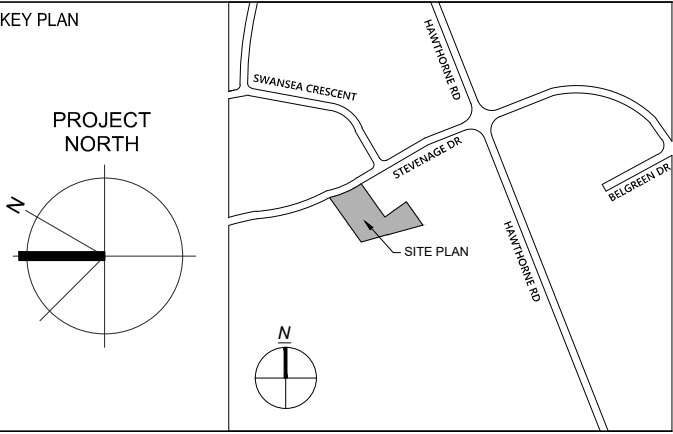

Good things
come from
Sysco

Glenn Piotrowski Architect

ONTARIO ASSOCIATION
OF ARCHITECTS
GLENN PIOTROWSKI ARCHITECT LTD.
167 NAVY STREET
OAKVILLE, ON.
L6J 2Z6
905.338.8855

DESIGN BUILDER
BBS
BUILDING A REPUTATION ON EXCELLENCE
BBS CONSTRUCTION (ONTARIO) LTD.
1805 WOODWARD DRIVE,
OTTAWA, ON K2C 0P9 CANADA
TEL: 613-226-8830 FAX: 613-226-1709

PROJECT
SYSCO TANNIS
FACILITY EXPANSION & SITE PLAN
MODIFICATIONS

2390 STEVENAGE DRIVE, OTTAWA,
ON K1G 3W3

SHEET TITLE
SITE DETAILS

DRAWN BY: VD
DATE:
SCALE: AS INDICATED
PROJECT NO.:
SHEET NO.:

A0.4

#17811