

- LEGEND**
- DC BARRIER CURB
  - CURB DEPRESSION
  - MOUNTABLE CURB
  - EASEMENT
  - HEAVY DUTY ASPHALT
  - CONCRETE SIDEWALK
  - PAVING STONE
  - STORM MANHOLE
  - CATCHBASIN OR DITCH INLET
  - LANDSCAPE CATCHBASIN
  - SAINTARY MANHOLE
  - PERFORATED PIPE IN SWALES
  - WATER VALVE/CHAMBER
  - FIRE HYDRANT
  - WATER METER LOCATION
  - REMOTE METER LOCATION
  - CENTRELINE OF SWALE
  - CENTRELINE OF DITCH
  - SLOPING AT 3:1 (UNLESS SPECIFIED)
  - PROPOSED ELEVATION
  - EXISTING ELEVATION
  - SWALE ELEVATION
  - TOP OF WALL ELEVATION
  - BOTTOM OF WALL ELEVATION
  - EMERGENCY OVERLAND FLOW ROUTE
  - SILT FENCE (AS PER OPSD 219.130)
  - STRAW BALE CHECK DAM (AS PER OPSD 219.180)
  - ROOF DRAIN LOCATION
  - ROOF SCUPPER LOCATION
  - WATER COVER TABLE POINT
  - CROSSING CONFLICT TABLE LOCATION
  - PROPOSED ENTRANCE
  - OVERHEAD DOOR ENTRANCE

**FOR REVIEW ONLY**  
**NOT FOR CONSTRUCTION**

5	REVISED PER CITY COMMENTS	MAY 24, 2019
4	REVISED PER SYSCO COMMENTS	MAY 17, 2019
3	REVISED PER CITY COMMENTS	MAR. 4, 2019
2	REVISED PER CITY COMMENTS	JAN. 10, 2019
1	ISSUED FOR SITE PLAN CONTROL	SEPT. 10, 2018
No.	Revisions	Date

Check and verify all dimensions before proceeding with the work. Do not scale drawings.

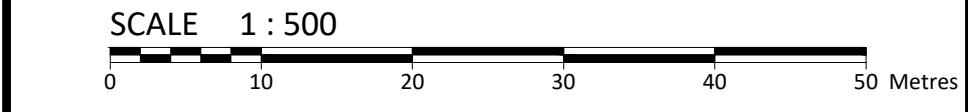

**McINTOSH PERRY**  
115 Walgreen Road, RR3, Carp, ON K0A 1L0  
Tel: 613-836-2184 Fax: 613-836-3742  
www.mcintoshperry.com

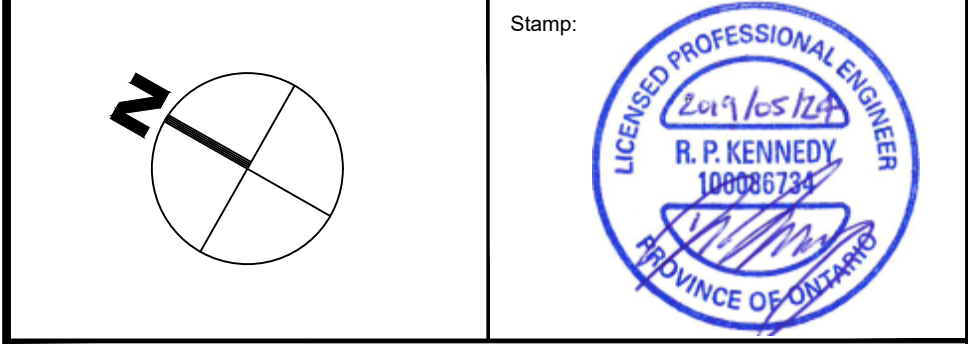

Client: **BBS CONSTRUCTION LTD.**  
1805 WOODWARD DRIVE  
OTTAWA, ON K2C 0P9

Project: **SYSCO TANNIS - FACILITY EXPANSION**  
2390 STEVENAGE DRIVE  
OTTAWA, ON K1G 3W3

Drawing Title: **SITE GRADING & DRAINAGE PLAN**

Scale:	1:500	Project Number:	CP-18-0170
Drawn By:	P.G.K.	Drawing Number:	C101
Checked By:	R.P.K.		
Designed By:	P.G.K.		

**SEE DRAWING C104 FOR NOISE BERM DETAIL/DESIGN**

**APPROVED**  
By Lily Xu at 10:46 am, Jun 14, 2019

**LILY XU, MCIP, RPP**  
(A) MANAGER, DEVELOPMENT REVIEW - SOUTH  
PLANNING, INFRASTRUCTURE & ECONOMIC  
DEVELOPMENT DEPARTMENT, CITY OF OTTAWA

FILENAME: A:\17 Project - Perseus\2019\06\04\CP18-0170-BBS\_Sysco Building\_2390 Stevenage Drive\C101-170\_Presentation.dwg  
LAST SAVED: Friday, May 24, 2019 10:19:10 AM  
LAST PLOTTED: Friday, May 24, 2019 10:19:10 AM  
LAST PLOTTED BY: P.G.K.

D07-12-18-0135



## GENERAL NOTES

- THE ORIGINAL TOPOGRAPHY, GROUND ELEVATION AND SURVEY DATA SHOWN ARE SUPPLIED FOR INFORMATION PURPOSES ONLY, AND IMPLY NO GUARANTEE OF ACCURACY. THE CONTRACTOR SHALL BE RESPONSIBLE FOR THE CONTRACTOR TO VERIFY ALL INFORMATION SHOWN.
- THIS PLAN IS NOT A CADASTRAL SURVEY SHOWING LEGAL PROPERTY BOUNDARIES AND EASEMENTS. THE PROPERTY BOUNDARIES SHOWN HEREON HAVE BEEN DERIVED FROM INFORMATION SUPPLIED BY (OR SHOWN ON) JAMES, O'SULLIVAN, VOLLEBEK LTD. SURVEY PLAN #18929-18, DATED SEPTEMBER 4, 2018 AND CANNOT BE RELIED UPON TO BE ACCURATE OR COMPLETE. THE PRECISE LOCATION OF THE CURRENT PROPERTY BOUNDARIES AND EASEMENTS CAN ONLY BE DETERMINED BY AN UP-TO-DATE LAND TITLES SEARCH AND A SUBSEQUENT CADASTRAL SURVEY PERFORMED AND CERTIFIED BY AN ONTARIO LAND SURVEYOR.
- THE CONTRACTOR IS TO OBTAIN AND PAY FOR ALL NECESSARY PERMITS AND APPROVALS FROM THE CITY OR TOWNSHIP BEFORE COMMENCING CONSTRUCTION.
- THE CONTRACTOR IS RESPONSIBLE FOR ALL LAYOUT.
- THE CONTRACTOR IS TO DETERMINE THE EXACT LOCATION, SIZE, MATERIAL AND ELEVATION OF ALL EXISTING UTILITIES PRIOR TO COMMENCING CONSTRUCTION, PROTECT AND ASSUME ALL RESPONSIBILITY FOR EXISTING UTILITIES WHETHER OR NOT SHOWN ON THESE DRAWINGS. IF THERE IS ANY DISCREPANCY THE CONTRACTOR IS TO NOTIFY THE ENGINEER PROMPTLY.
- RESTORE ALL TRENCHES AND SURFACES OF PUBLIC ROAD ALLOWANCES TO CONDITION EQUAL OR BETTER THAN ORIGINAL CONDITION AND TO THE SATISFACTION OF THE CITY OR TOWNSHIP AUTHORITIES.
- EXCAVATE AND DISPOSE OF ALL EXCESS EXCAVATED MATERIAL SUCH AS ASPHALT, CURBING AND DEBRIS, OFF SITE AS DIRECTED BY THE ENGINEER AND THE CITY OR TOWNSHIP.
- TOPSOIL TO BE STRIPPED AND STOCKPILED FOR REHABILITATION. CLEAN FILL TO BE PLACED IN FILL AREAS AND COMPACTED TO 95% STANDARD PROCTOR DENSITY.
- ALL DISTURBED AREAS TO BE RESTORED TO ORIGINAL CONDITION OR BETTER UNLESS OTHERWISE SPECIFIED.
- THE CONTRACTOR SHALL BE RESPONSIBLE FOR ALL TRAFFIC CONTROL AND SAFETY MEASURES DURING THE CONSTRUCTION PERIOD, INCLUDING THE SUPPLY, INSTALLATION, AND REMOVAL OF ALL NECESSARY SIGNAGE, DELINEATORS, MARKERS AND BARRIERS.
- DO NOT ALTER GRADING OF THE SITE WITHOUT PRIOR APPROVAL OF THE CITY OR TOWNSHIP.
- ALL ROADWAY, PARKING LOT, AND GRADING WORKS TO BE UNDERTAKEN IN ACCORDANCE WITH CITY OR TOWNSHIP STANDARDS AND SPECIFICATIONS. THE CONTRACTOR IS TO PROVIDE POSITIVE DRAINAGE AWAY FROM THE BUILDING.
- CONTACT THE CITY OR TOWNSHIP FOR INSPECTION OF ROUGH GRADING OF PARKING LOTS, ROADWAYS AND LANDSCAPED AREAS PRIOR TO PLACEMENT OF ASPHALT AND TOPSOIL. ALL DEFICIENCIES NOTED SHALL BE RECTIFIED TO THE CITY OR TOWNSHIP SATISFACTION PRIOR TO PLACEMENT OF ANY ASPHALT, TOPSOIL, SEED & MULCH AND/OR SOD.
- ALL DIMENSIONS AND INVERTS MUST BE VERIFIED PRIOR TO CONSTRUCTION. IF THERE IS ANY DISCREPANCY THE CONTRACTOR IS TO NOTIFY THE ENGINEER PROMPTLY.
- ELECTRICAL, GAS, TELEPHONE AND TELEVISION SERVICE LOCATIONS ARE SUBJECT TO THE INDIVIDUAL AGENCY.
  - ELECTRICAL SERVICE - HYDRO OTTAWA,
  - GAS SERVICE - ENBRIDGE,
  - TELEPHONE SERVICE - BELL CANADA,
  - TELEVISION SERVICE - ROGERS.
- INSTALLATION TO BE IN ACCORDANCE WITH CURRENT CODES AND STANDARDS OF APPROVAL AGENCIES HYDRO OTTAWA, BELL AND THE CITY OR TOWNSHIP.
- ALL PROPOSED CURB SHALL BE CONCRETE BARRIER CURB UNLESS SPECIFIED.
- ALL EXISTING REDUNDANT PRIVATE APPROACHES FRONTING THIS DEVELOPMENT MUST BE REMOVED TO THE SATISFACTION OF THE CITY OR TOWNSHIP.
- THIS PLAN MUST BE READ IN CONJUNCTION WITH THE GEOTECHNICAL INVESTIGATION BY PATERSON GROUP, DATED JULY 30, 2018 REPORT #PG4583-1 AND THE SITE SERVICING & STORMWATER MANAGEMENT REPORT BY MCINTOSH PERRY REPORT #CP-18-0170, DATED SEPTEMBER 10, 2018.

## SEWER NOTES

- CONSTRUCT ALL SEWERS AND APPURTENANCES TO CITY OR TOWNSHIP STANDARDS (IF AVAILABLE) OR AS PER OPSD STANDARDS.
- SEWER TRENCHING AND BEDDING SHALL CONFORM TO OPSD 802.010 AND 802.013 UNLESS NOTED OTHERWISE.
- BEDDING SHALL BE A MINIMUM 150mm OF GRANULAR "A", COMPACTED TO MINIMUM 95% STANDARD PROCTOR DRY DENSITY. CLEAR STONE BEDDING SHALL NOT BE PERMITTED.
- SUB-BEDDING, IF REQUIRED SHALL BE AS PER THE DIRECTION OF A GEOTECHNICAL ENGINEER.
- BACKFILL TO AT LEAST 300mm ABOVE TOP OF PIPE WITH GRANULAR "A" OR SAND.
- TO MINIMIZE DIFFERENTIAL FROST HEAVING, TRENCH BACKFILL (FROM PAVEMENT SUBGRADE TO 2.0m BELOW FINISHED GRADE) SHALL MATCH EXISTING SOIL CONDITIONS.
- SEWERS AND CONNECTIONS 150mm DIAMETER AND SMALLER TO BE PVC SDR 28 OR APPROVED EQUIVALENT. SEWERS AND CONNECTIONS 200mm DIAMETER AND LARGER TO BE PVC SDR 35 OR APPROVED EQUIVALENT.
- SEWER CONNECTIONS ARE TO BE MADE ABOVE THE SPRINGLINE OF THE SEWERMAIN AS PER CITY OF OTTAWA STANDARD DRAWINGS S11, S11.1 & S11.2.
- INSULATE ALL SEWERS AND/OR SERVICES THAT HAVE LESS THAN 1.5m OF COVER WITH THERMAL INSULATION AS PER OPSD 1109.030.
- SUPPLY AND INSTALL ALL PIPING AND APPURTENANCES AS SHOWN AND DETAILED TO WITHIN 1.0m OF BUILDING. ALL ENDS OF SERVICES TO BE PROPERLY CAPPED AND LOCATED WITH 2"x4"x8" LONG MARKER.
- CONTRACTOR TO TELEVIEW (CTV) ALL PROPOSED SEWERS ONSITE. OUTLET CONNECTION TO THE MAIN AND PIPES 150mmØ OR GREATER PRIOR TO BASE COURSE ASPHALT. UPON COMPLETION OF CONTRACT, THE CONTRACTOR IS RESPONSIBLE TO FLUSH AND CLEAN ALL SEWERS & APPURTENANCES.
- DYE TESTING IS TO BE COMPLETED ON SANITARY SERVICE TO CONFIRM PROPER CONNECTION TO THE SANITARY SEWER MAIN.
- ALL CATCHBASIN AND CATCHBASIN MANHOLE LEADS ARE TO BE MINIMUM 200mmØ WITH MINIMUM 1.0% SLOPE UNLESS OTHERWISE NOTED.
- ALL CATCHBASINS EXCLUDING LANDSCAPE CATCHBASINS ARE TO HAVE 150mmØ PERFORATED PIPE FOR 3.0m ON ALL AVAILABLE SIDES AS PER CITY OF OTTAWA STANDARD DRAWING "R1".
- FOUNDATION BACKWATER VALVES AND SANITARY BACKWATER VALVES ARE TO BE INSTALLED AS PER CITY OF OTTAWA STANDARD DRAWINGS S14, S14.1 & S14.2.

## WATERMAIN NOTES

- CONSTRUCT ALL WATERMAINS AND APPURTENANCES IN ACCORDANCE WITH OPSD STANDARDS AND SPECIFICATIONS, AS WELL AS CITY OR TOWNSHIP STANDARDS.
- INDUSTRIAL/COMMERCIAL SERVICE CONNECTIONS TO BE 50mm COPPER PIPING AND SHALL CONFORM TO ASTM B88 TYPE "K" SOFT.
- WATERMAINS AND/OR WATER SERVICES ARE TO HAVE A MINIMUM COVER OF 2.4m. OTHERWISE THERMAL INSULATION IS REQUIRED AS PER CITY OR TOWNSHIP STANDARDS (IF AVAILABLE) OR OPSD 1109.030.
- IF THE WATERMAIN MUST BE DEFLECTED TO MEET ALIGNMENT, ENSURE THAT THE AMOUNT OF DEFLECTION USED IS EQUAL TO OR LESS THAN THAT WHICH IS RECOMMENDED BY THE MANUFACTURER.
- USE APPROVED SADDLE CONNECTION WITH MAIN (CORPORATION) STOP AS PER CITY OF OTTAWA STANDARD DRAWING "W26".
- CONNECTION TO EXISTING BY CITY OR TOWNSHIP FORCES. EXCAVATION, BACKFILLING AND REINSTATEMENT IS TO BE COMPLETED BY THE CONTRACTOR.
- THERMAL INSULATION OF WATERMAINS AT OPEN STRUCTURES AS PER CITY OR TOWNSHIP STANDARDS (IF AVAILABLE) OR OPSD 1109.030.
- THERMAL INSULATION OF WATERMAINS UNDER ROAD SIDE DITCHES AS PER CITY OF OTTAWA STANDARD DRAWING "W21".

WATER COVER TABLE				
LOCATION	STATION	FINISHED GRADE	TOP OF PIPE DEPTH OF PIPE	
A - 300 x 300 TEE	1+000.00	82.36	79.96	2.40
VALVE & BOX	1+006.50	82.27	79.87	2.40
B - 300 x 65 TEE	1+049.78	82.70	80.30	2.40
C - 300 x 150 TEE	1+080.83	82.58	80.18	2.40
VALVE & BOX	1+148.80	81.63	79.23	2.40
45° BEND	1+248.04	81.71	79.31	2.40
45° BEND	1+251.04	81.74	79.34	2.40
D - 300 x 150 TEE	1+287.22	81.93	79.53	2.40
3.9° DEFLECTION	1+294.11	81.90	79.50	2.40
22.5° BEND	1+378.42	82.27	79.87	2.40
22.5° BEND	1+385.15	82.10	79.70	2.40
45° BEND	1+404.04	81.48	79.08	2.40
3.9° DEFLECTION	1+407.75	81.52	79.12	2.40
VALVE & BOX	1+451.67	82.23	79.83	2.40
E - 300 x 150 TEE	1+453.67	82.28	79.88	2.40
F - 300 x 150 TEE	1+480.69	82.79	80.39	2.40
VALVE & BOX	1+459.66	83.06	80.66	2.40
22.5° BEND	1+660.73	83.08	80.68	2.40
G - 300 x 300 TEE	1+666.75	83.20	80.80	2.40
B - 300 x 65 TEE	2+000.00	82.70	80.30	2.40
BUILDING	2+018.04	82.95	80.55	2.40
C - 300 x 150 TEE	3+000.00	82.58	80.18	2.40
VALVE & BOX	3+001.00	82.61	80.21	2.40
HYDRANT	3+004.27	82.20	79.80	2.40
D - 300 x 150 TEE	4+000.00	81.93	79.53	2.40
VALVE & BOX	4+001.00	81.93	79.53	2.40
HYDRANT	4+005.13	81.09	78.69	2.40
E - 300 x 300 TEE	5+000.00	82.28	79.88	2.40
VALVE & BOX	5+001.00	82.31	79.91	2.40
BUILDING	5+012.55	82.83	80.43	2.40
F - 300 x 150 TEE	6+000.00	82.79	80.39	2.40
VALVE & BOX	6+001.00	82.77	80.37	2.40
HYDRANT	6+005.30	82.71	80.31	2.40
H - BUILDING	7+000.00	81.70	79.30	2.40
45° BEND	7+002.38	81.68	79.28	2.40
45° BEND	7+005.38	82.06	79.31	2.75
45° BEND	7+096.52	81.71	79.31	2.40
45° BEND	7+099.52	81.74	79.34	2.40
3.9° BEND	7+155.89	81.83	79.43	2.40
22.5° BEND	7+225.23	82.30	79.90	2.40
22.5° BEND	7+231.76	82.26	79.86	2.40
22.5° BEND	7+235.46	82.07	79.67	2.40
22.5° BEND	7+252.02	82.23	79.83	2.40
45° BEND	7+293.17	82.63	80.23	2.40
45° BEND	7+296.17	82.74	80.34	2.40
I - BUILDING	7+298.97	82.82	80.42	2.40

STM STRUCTURE TABLE				
NAME	RIM ELEV.	INVERT IN	INVERT OUT	DESCRIPTION
CB1	81.59		NE81.101	COVER CITY STD S19 FRAME CITY STD S19 STRUC. OPSD 705.010
CB2	81.59		NE81.061	COVER CITY STD S19 FRAME CITY STD S19 STRUC. OPSD 705.010
CB3	81.59		NE81.031	COVER CITY STD S19 FRAME CITY STD S19 STRUC. OPSD 705.010
CB4	81.59		NE80.991	COVER CITY STD S19 FRAME CITY STD S19 STRUC. OPSD 705.010
CB5	81.59		NE80.951	COVER CITY STD S19 FRAME CITY STD S19 STRUC. OPSD 705.010
CB6	81.59		NE80.911	COVER CITY STD S19 FRAME CITY STD S19 STRUC. OPSD 705.010
CB7	81.59		NE80.881	COVER CITY STD S19 FRAME CITY STD S19 STRUC. OPSD 705.010
CB10	82.95	NW81.421		COVER CITY STD S19 FRAME CITY STD S19 STRUC. OPSD 705.010
CB11	82.95	SE81.273	NW81.263	COVER CITY STD S19 FRAME CITY STD S19 STRUC. OPSD 705.010
CB15	82.43		NE81.103	COVER CITY STD S19 FRAME CITY STD S19 STRUC. OPSD 705.010
CB20	82.44		SE81.523	COVER CITY STD S19 FRAME CITY STD S19 STRUC. OPSD 705.010
CBM1H3	82.50	SW81.098	NE81.068	COVER CITY STD S28.1 FRAME CITY STD S25 STRUC. OPSD 701.010
CBM1H4	82.43	SW80.986	E80.956	COVER CITY STD S24.1 FRAME CITY STD S25 STRUC. OPSD 701.011
CBM2H1	82.40	NW81.199	SE81.189	COVER CITY STD S28.1 FRAME CITY STD S25 STRUC. OPSD 701.010

### NOTES:

- ALL STORM SEWERS ARE TO BE INSULATED WITH THE EXCEPTION OF PIPES FROM EX.MHP" TO MH3
- ELEVATION OF THE EXISTING WATERMAIN IS TO BE CONFIRMED DURING CONSTRUCTION. IF A CROSSING CONFLICT OCCURS WITH THE STORM AND/OR THE SANITARY SEWERS, THEN THE WATERMAIN IS TO BE RECONSTRUCTED WITH VERTICAL BENDS AS PER CITY OF OTTAWA STANDARDS W25 OR W25.2

### PAVEMENT STRUCTURE

- LIGHT DUTY
  - 50mm SUPERPAVE 12.5
  - 150mm GRANULAR A
  - 300mm GRANULAR B TYPE II
- HEAVY DUTY
  - 40mm SUPERPAVE 12.5
  - 50mm SUPERPAVE 19.0
  - 150mm GRANULAR A
  - 450mm GRANULAR B

STM STRUCTURE TABLE				
NAME	RIM ELEV.	INVERT IN	INVERT OUT	DESCRIPTION
CBM2H2	82.35	NW81.059	SE81.049	COVER CITY STD S28.1 FRAME CITY STD S25 STRUC. OPSD 701.010
CBM2H3	82.05	NW80.879	E80.849	COVER CITY STD S24.1 FRAME CITY STD S25 STRUC. OPSD 701.011
CBM2H3B	81.95	W80.798	NE80.768	COVER CITY STD S28.1 FRAME CITY STD S25 STRUC. OPSD 701.010
CBM2H4	81.80	SW80.681	NE80.671	COVER CITY STD S28.1 FRAME CITY STD S25 STRUC. OPSD 701.010
CDS	82.25	SE80.212	NW80.182	UNIT PMSU30_35m
Ex.MHP"	82.28	SE79.870 SW79.811	NE79.810	N/A
MH1	82.53	SE79.899	NW79.889	COVER CITY STD S24.1 FRAME CITY STD S25 STRUC. OPSD 701.011
MH2	82.48	SE80.046	NW80.036	COVER CITY STD S24.1 FRAME CITY STD S25 STRUC. OPSD 701.011
MH4	81.66	E80.352	NW80.322	COVER CITY STD S24.1 FRAME CITY STD S25 STRUC. OPSD 701.011
MH12	82.98	SE81.201	NE81.171	COVER CITY STD S24.1 FRAME CITY STD S25 STRUC. OPSD 701.010
MH16	82.23	W80.890	SE80.860	COVER CITY STD S24.1 FRAME CITY STD S25 STRUC. OPSD 701.011
MH17	82.25	NW80.656	SE80.646	COVER CITY STD S24.1 FRAME CITY STD S25 STRUC. OPSD 701.011
MH18	82.14	SW80.550 NW80.520	SE80.490	COVER CITY STD S28.1 FRAME CITY STD S25 STRUC. OPSD 701.012
MH19	81.83	NW80.424	E80.394	COVER CITY STD S28.1 FRAME CITY STD S25 STRUC. OPSD 701.012

SAN STRUCTURE TABLE				
NAME	RIM ELEV.	INVERT IN	INVERT OUT	DESCRIPTION
MH1A	82.40	SE79.220 SW79.068	NE79.068	COVER CITY STD S24 FRAME CITY STD S25 STRUC. OPSD 701.010
MH2A	82.69	SE79.300 SW79.380	NW79.277	COVER CITY STD S24 FRAME CITY STD S25 STRUC. OPSD 701.010
MH3A	82.73	SE79.435 SW80.000	NW79.425	COVER CITY STD S24 FRAME CITY STD S25 STRUC. OPSD 701.010
MH4A	81.61	SW80.040	NW79.802	COVER CITY STD S24 FRAME CITY STD S25 STRUC. OPSD 701.010
MH5A	83.26	579.450 W79.300	E79.300	COVER CITY STD S24 FRAME CITY STD S25 STRUC. OPSD 701.010
MH6A	83.19	SE79.524	N79.494	COVER CITY STD S24 FRAME CITY STD S25 STRUC. OPSD 701.010
MH7A	82.97	SE79.935	NW79.925	COVER CITY STD S24 FRAME CITY STD S25 STRUC. OPSD 701.010
MH8A	82.42	NE80.400	NW80.336	COVER CITY STD S24 FRAME CITY STD S25 STRUC. OPSD 701.010

**LILY XU, MCIP, RPP**  
(A) MANAGER, DEVELOPMENT REVIEW - SOUTH  
PLANNING, INFRASTRUCTURE & ECONOMIC  
DEVELOPMENT DEPARTMENT, CITY OF OTTAWA

**APPROVED**  
By Lily Xu at 10:46 am, Jun 14, 2019

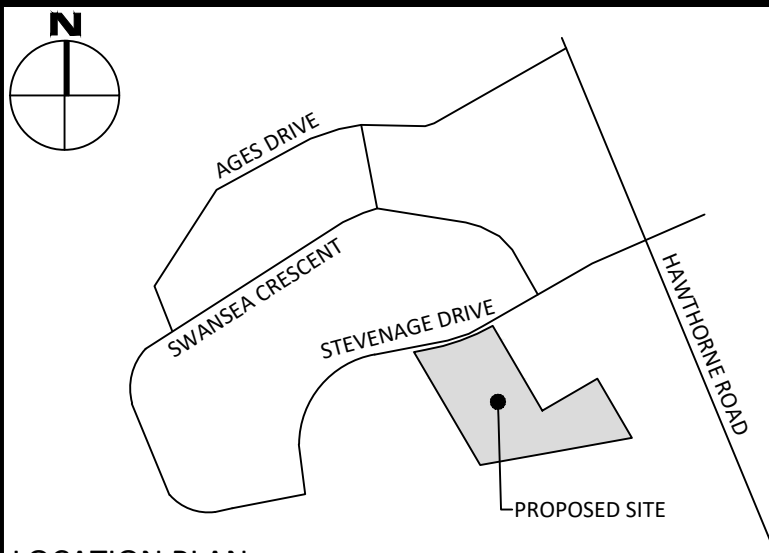

## LEGEND

DC	BARRIER CURB	~	SILT FENCE (AS PER OPSD 219.130)
~	CURB DEPRESSION	~	STRAW BALE CHECK DAM (AS PER OPSD 219.180)
~	MOUNTABLE CURB	~	ROOF DRAIN LOCATION
~	EASEMENT	~	ROOF SCUPPER LOCATION
~	HEAVY DUTY ASPHALT	~	WATER COVER TABLE POINT
~	CONCRETE SIDEWALK	~	CROSSING CONFLICT TABLE LOCATION
~	PAVING STONE	~	PROPOSED ENTRANCE
~	STORM MANHOLE	~	OVERHEAD DOOR ENTRANCE
~	CATCHBASIN OR DITCH INLET	~	
~	LANDSCAPE CATCHBASIN	~	
~	SANITARY MANHOLE	~	
~	PERFORATED PIPE IN SWALES	~	
~	WATER VALVE/CHAMBER	~	
~	FIRE HYDRANT	~	
~	WATER METER LOCATION	~	
~	REMOTE METER LOCATION	~	
~	CENTRELINE OF SWALE	~	
~	CENTRELINE OF DITCH	~	
~	SLOPING AT 3:1 (UNLESS SPECIFIED)	~	
~	PROPOSED ELEVATION	~	
~	EXISTING ELEVATION	~	
~	SWALE ELEVATION	~	
~	TOP OF WALL ELEVATION	~	
~	BOTTOM OF WALL ELEVATION	~	
~	EMERGENCY OVERLAND FLOW ROUTE	~	

**FOR REVIEW ONLY**  
NOT FOR CONSTRUCTION

No.	Revisions	Date
5	REVISED PER CITY COMMENTS	MAY 24, 2019
4	REVISED PER SYSCO COMMENTS	MAY 17, 2019
3	REVISED PER CITY COMMENTS	MAR. 4, 2019
2	REVISED PER CITY COMMENTS	JAN. 10, 2019
1	ISSUED FOR SITE PLAN CONTROL	SEPT. 10, 2018

Check and verify all dimensions before proceeding with the work Do not scale drawings

SCALE 1 : 750  
0 25 50 75 Metres

**McINTOSH PERRY**

115 Walgreen Road, RR3, Carp, ON K0A 1L0  
Tel: 613-836-2184 Fax: 613-836-3742  
www.mcintoshperry.com

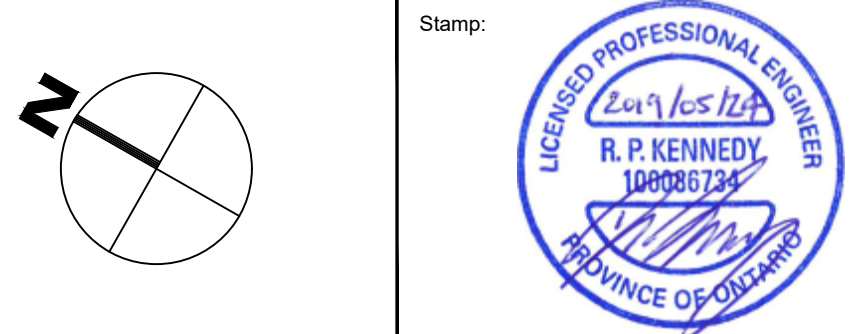

Client: **BBS CONSTRUCTION LTD.**  
1805 WOODWARD DRIVE  
OTTAWA, ON K2C 0P9

Project: **SYSCO TANNIS - FACILITY EXPANSION**  
2390 STEVENAGE DRIVE  
OTTAWA, ON K1G 3W3

Drawing Title: **SITE SERVICING PLAN**

Scale: 1:750	Project Number: CP-18-0170
Drawn By: P.G.K.	Drawing Number: C102
Checked By: R.P.K.	
Designed By: P.G.K.	



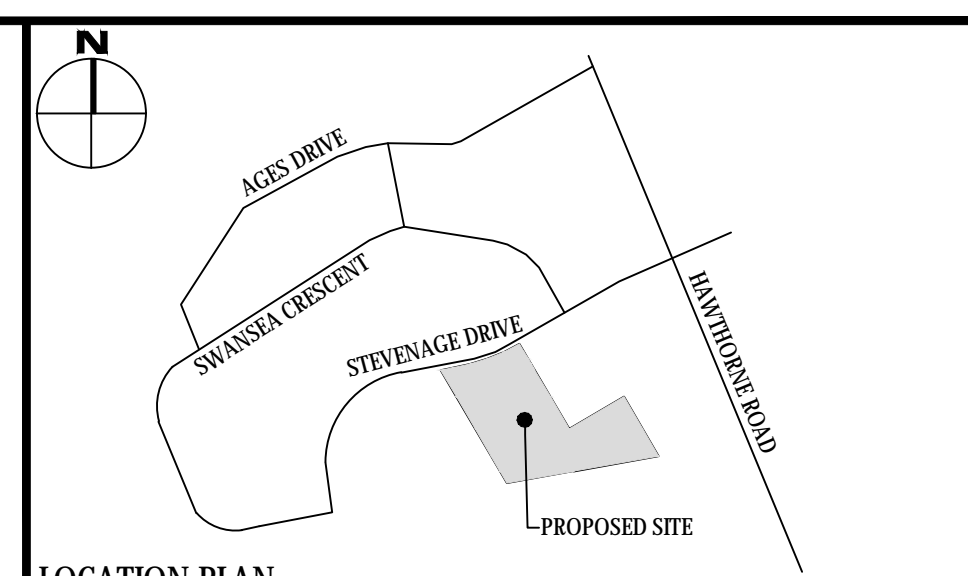
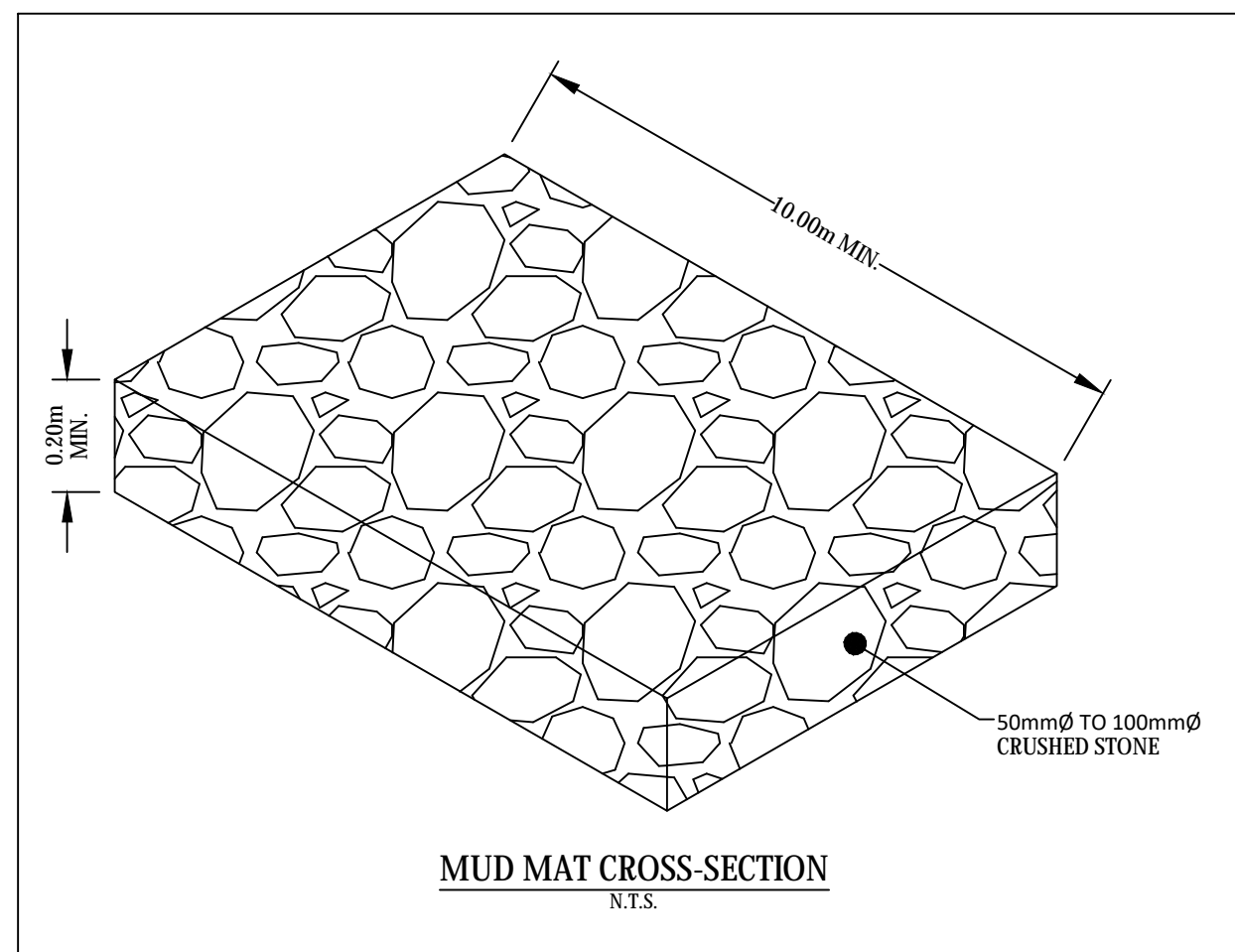

### LOCATION PLAN

	BARRIER CURB		SILT FENCE
	CURB DEPRESSION		(AS PER OPSD 219.130)
	MOUNTABLE CURB		STRAW BALE CHECK DAM
	EASEMENT		(AS PER OPSD 219.180)
	HEAVY DUTY ASPHALT		ROOF DRAIN LOCATION
	CONCRETE SIDEWALK		ROOF SCUPPER LOCATION
	PAVING STONE		WATER COVER TABLE POINT
	STORM MANHOLE		CROSSING CONFLICT TABLE LOCATION
	CATCHBASIN OR DITCH INLET		PROPOSED ENTRANCE
	LANDSCAPING CATCHBASIN		OVERHEAD DOOR ENTRANCE
	SANITARY MANHOLE		
	PERFORATED PIPE IN SWALES		
	WATER VALVE/CHAMBER		
	FIRE HYDRANT		
	WATER METER LOCATION		
	REMOTE METER LOCATION		
	CENTRELINE OF SWALE		
	CENTRELINE OF DITCH		
	SLOPING AT 3:1		
	PROPOSED ELEVATION		
	EXISTING ELEVATION		
	SWALE ELEVATION		
	TOP OF WALL ELEVATION		
	BOTTOM OF WALL ELEVATION		
	EMERGENCY OVERLAND FLOW ROUTE		

**FOR REVIEW ONLY**  
*NOT FOR CONSTRUCTION*

5	REVISED PER CITY COMMENTS	MAY 24, 2019
4	REVISED PER SYSCO COMMENTS	MAY 17, 2019
3	REVISED PER CITY COMMENTS	MAR. 4, 2019
2	REVISED PER CITY COMMENTS	JAN. 10, 2019
1	ISSUED FOR SITE PLAN CONTROL	SEPT. 10, 2018
No.	Revisions	Date

Check and verify all dimensions before proceeding with the work	Do not scale drawings
---	-----------------------



**McINTOSH PERRY**  
115 Walgreen Road, RR3, Carp, ON K0A 1L0  
Tel: 613-836-2184 Fax: 613-836-3742  
[www.mcintoshperry.com](http://www.mcintoshperry.com)

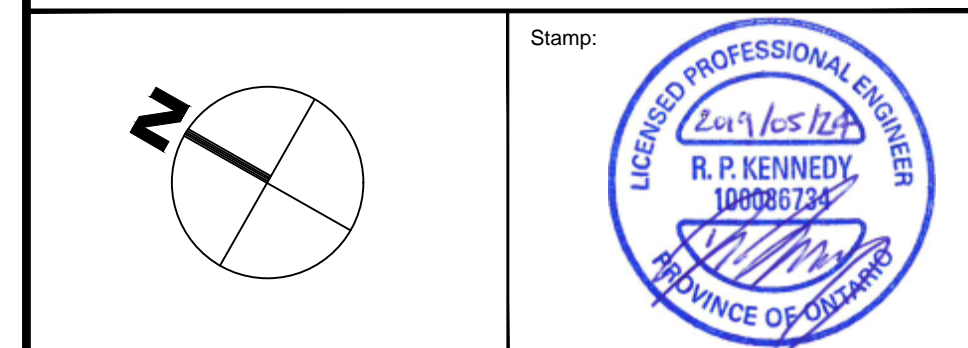

Client:

**BBS CONSTRUCTION LTD.**  
1805 WOODWARD DRIVE  
OTTAWA, ON K2C 0P9

Project:

**SYSCO TANNIS - FACILITY EXPANSION**  
2390 STEVENAGE DRIVE  
OTTAWA, ON K1G 3W3

Drawing Title:

**SEDIMENT & EROSION CONTROL PLAN**

Scale:	1:750	Project Number:	CP-18-0170
Drawn By:	P.G.K.		
Checked By:	R.P.K.	Drawing Number:	C103
Designed By:	P.G.K.		



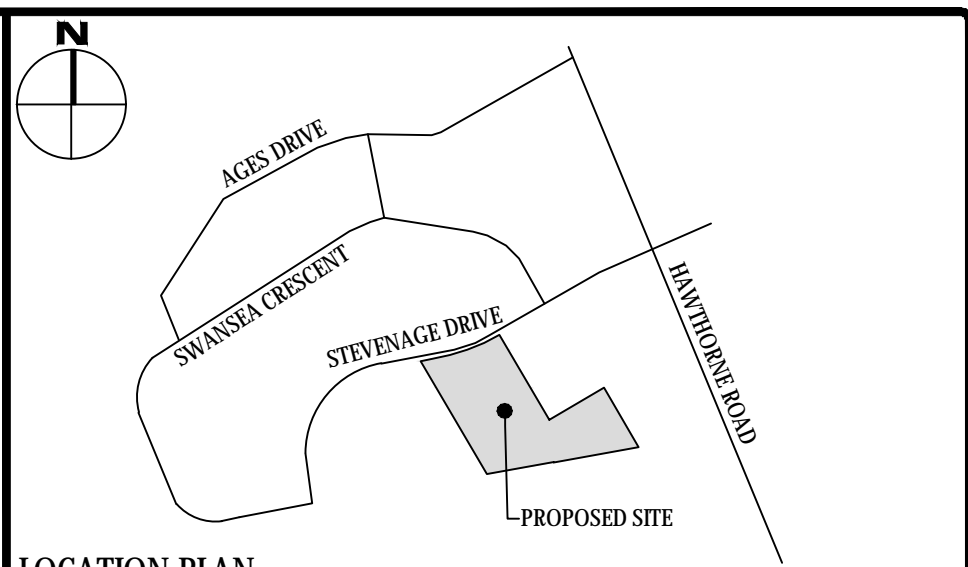
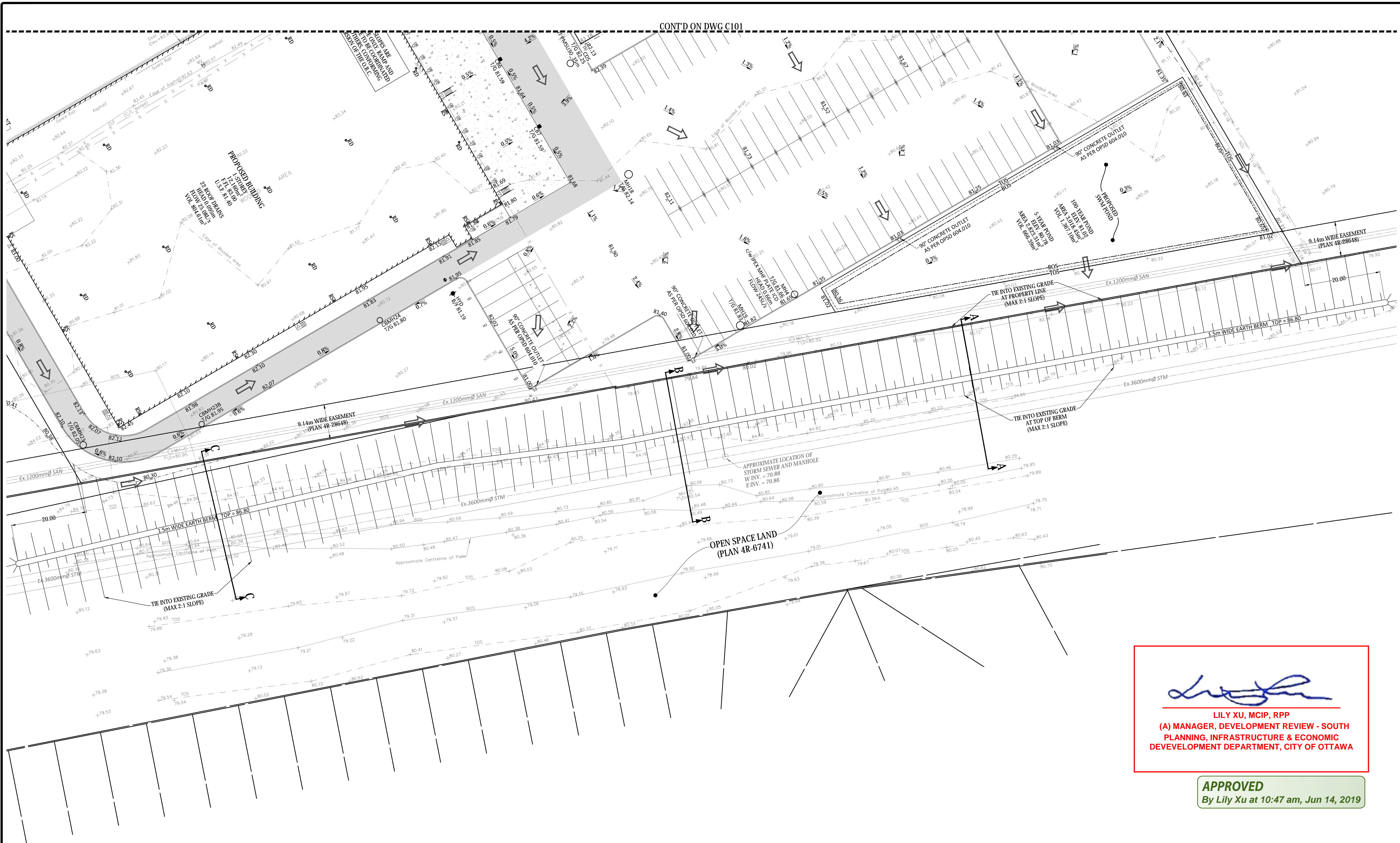

LEGEND	
DC	BARRIER CURB
	CURB DEPRESSION
	MOUNTABLE CURB
	EASEMENT
	HEAVY DUTY ASPHALT
	CONCRETE SIDEWALK
	PAVING STONE
	STORM MANHOLE
CB	CATCHBASIN OR DITCH INLET
ECB	LANDSCAPE CATCHBASIN
MH7A	SANITARY MANHOLE
	PERFORATED PIPE IN SWALES
	WATER VALVE/CHAMBER
	FIRE HYDRANT
	WATER METER LOCATION
	REMOTE METER LOCATION
	CENTRELINE OF SWALE
	CENTRELINE OF DITCH
	SLOPING AT 3:1 (UNLESS SPECIFIED)
	PROPOSED ELEVATION
	EXISTING ELEVATION
	SWALE ELEVATION
	TOP OF WALL ELEVATION
	BOTTOM OF WALL ELEVATION
	EMERGENCY OVERLAND FLOW ROUTE
	SILT FENCE (AS PER OPSD 219.130)
	STRAW BALE CHECK DAM (AS PER OPSD 219.180)
	ROOF DRAIN LOCATION
	WATER COVER TABLE POINT
	CROSSING CONFLICT TABLE LOCATION
	PROPOSED ENTRANCE
	OVERHEAD DOOR ENTRANCE

**FOR REVIEW ONLY**  
**NOT FOR CONSTRUCTION**

No.	Revisions	Date
4	REVISED PER CITY COMMENTS	MAY 24, 2019
3	REVISED PER SYSCO COMMENTS	MAY 17, 2019
2	REVISED PER CITY COMMENTS	MAR. 4, 2019
1	REVISED PER CITY COMMENTS	FEB. 25, 2019

Check and verify all dimensions before proceeding with the work. Do not scale drawings.

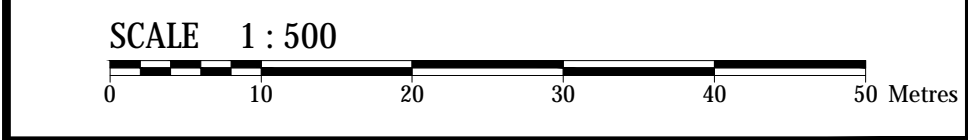

  
**LILY XU, MCIP, RPP**  
**(A) MANAGER, DEVELOPMENT REVIEW - SOUTH**  
**PLANNING, INFRASTRUCTURE & ECONOMIC**  
**DEVELOPMENT DEPARTMENT, CITY OF OTTAWA**

**APPROVED**  
By Lily Xu at 10:47 am, Jun 14, 2019

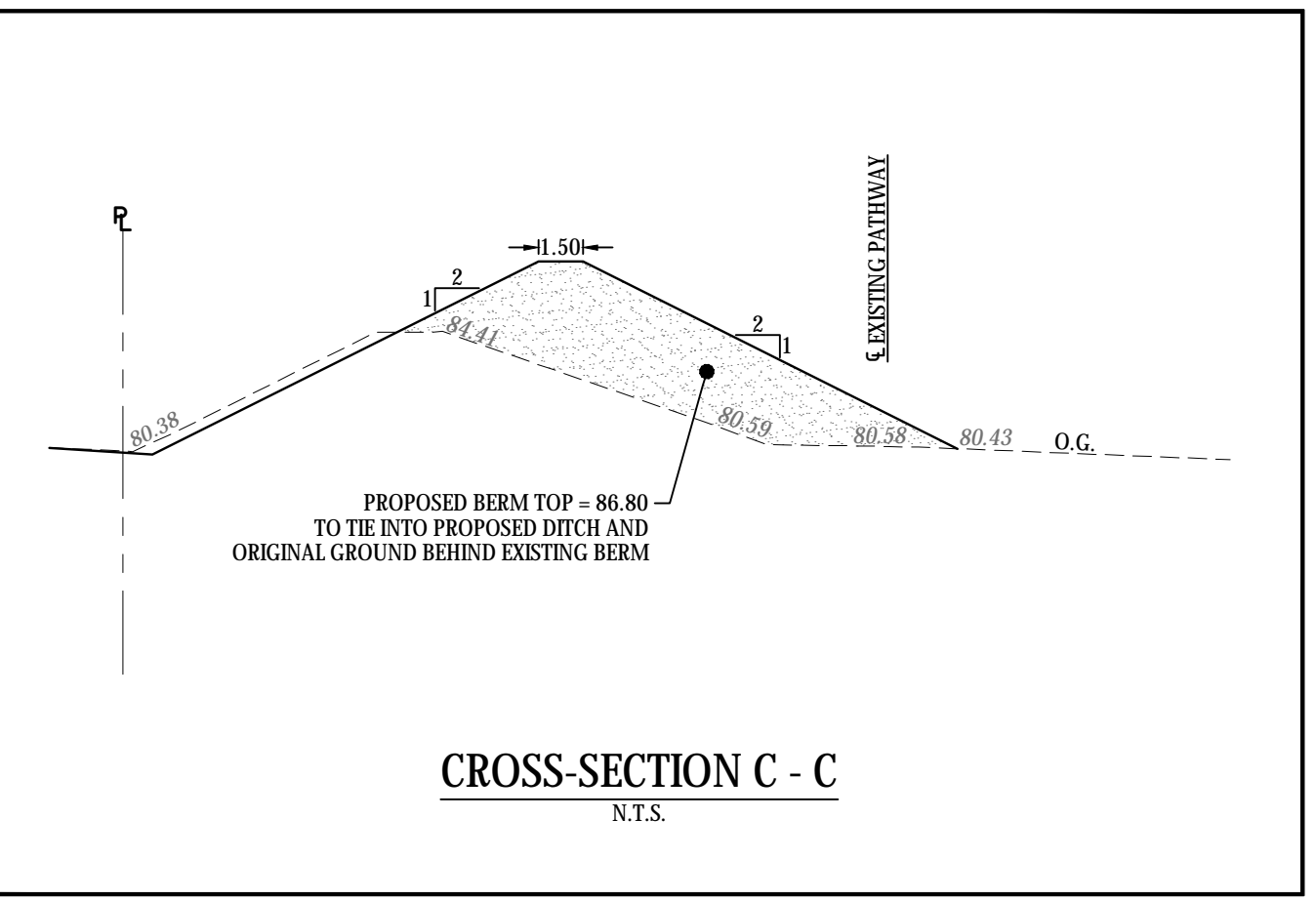
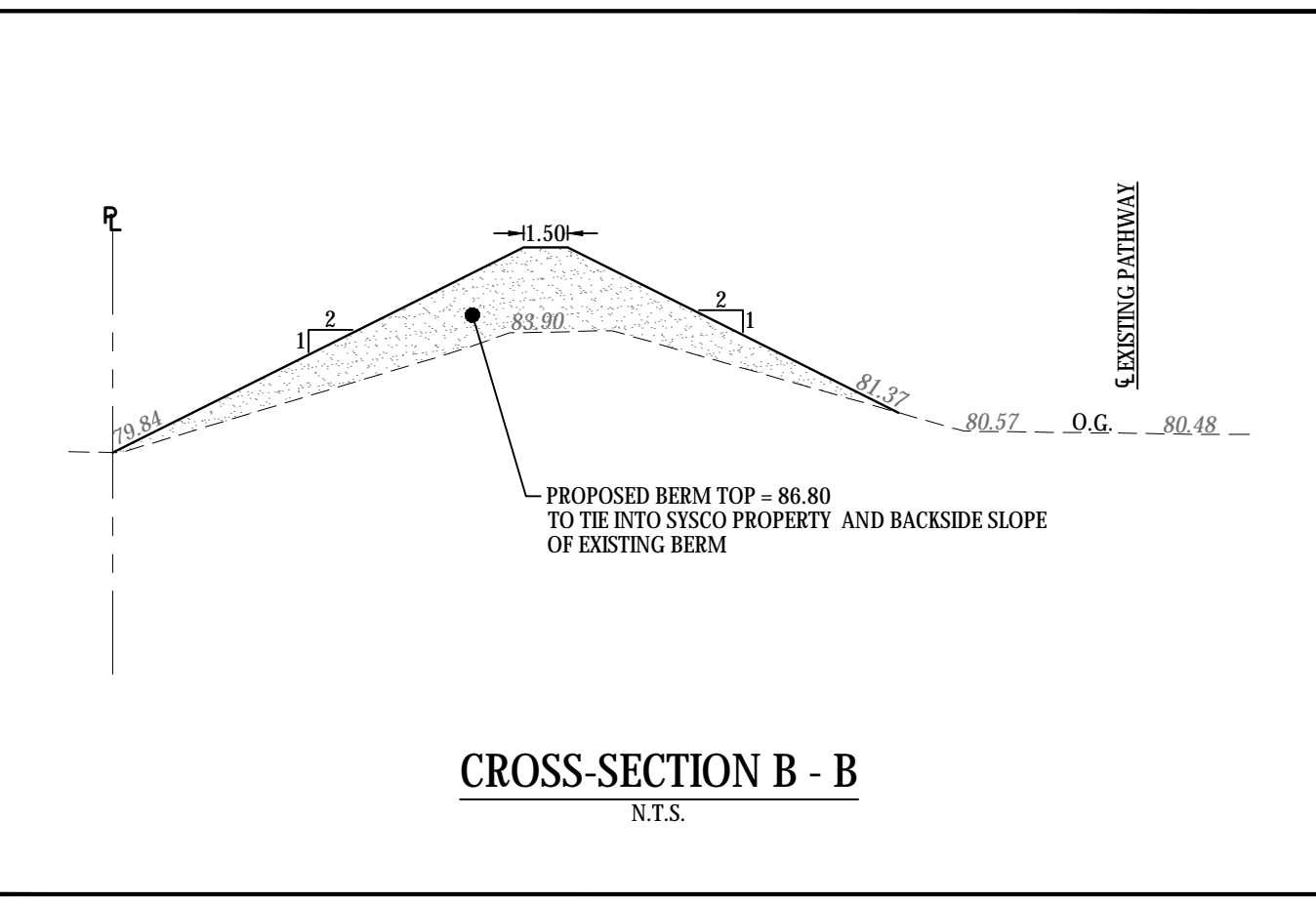
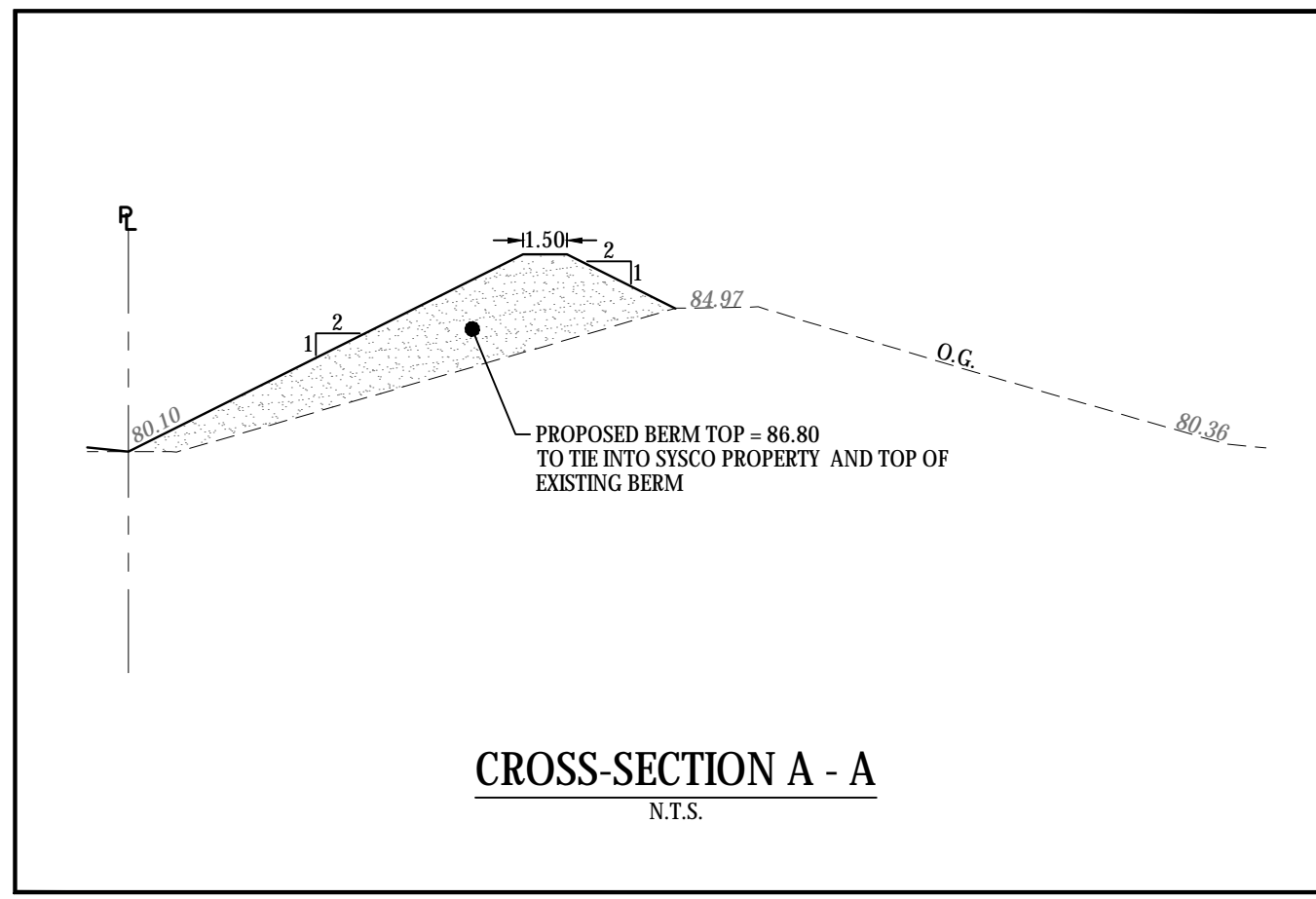

**McINTOSH PERRY**  
115 Walgreen Road, RR3, Carp, ON K0A 1L0  
Tel: 613-836-2184 Fax: 613-836-3742  
www.mcintoshperry.com

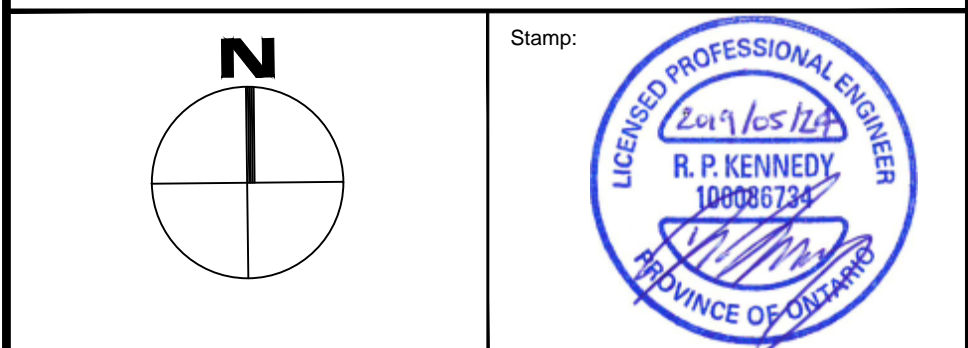

Client: **BBS CONSTRUCTION LTD.**  
1805 WOODWARD DRIVE  
OTTAWA, ON K2C 0P9

Project: **SYSCO TANNIS - FACILITY EXPANSION**  
2390 STEVENAGE DRIVE  
OTTAWA, ON K1G 3W3

Drawing Title: **NOISE BERM IMPROVEMENT PLAN**

Scale: 1:500	Project Number: CP-18-0170
Drawn By: P.G.K.	
Checked By: R.P.K.	Drawing Number:
Designed By: P.G.K.	

**C104**

FILENAME: R:\01 Project - Projects\2019\1805 Woodward Drive\0170 BBS Sysco Building - 2390 Stevenage Drive\CD\15 Drawings\CP 18-0170 Presentation.dwg  
LAST SAVED: Friday, May 24, 2019 1:45:10 PM  
LAST PLOTTED: Friday, May 24, 2019 1:45:10 PM  
PLOTTER: HP DesignJet T1100e

007-12-18-0135