

KEY PLAN
NTS

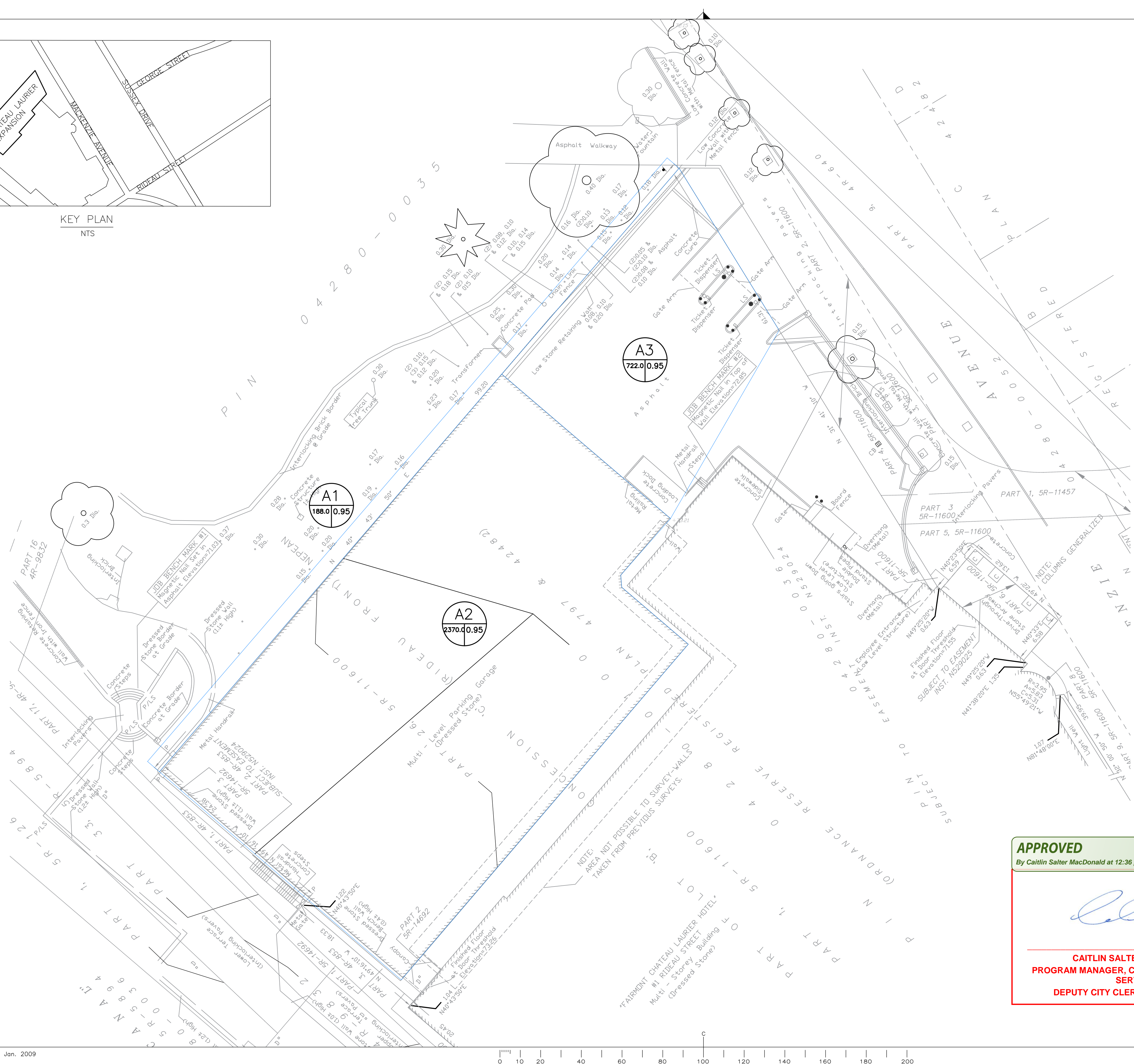

THE LOCATION OF UTILITIES IS APPROXIMATE ONLY, AND THE EXACT LOCATION SHOULD BE DETERMINED BY CONSULTING THE MUNICIPAL AUTHORITIES AND UTILITY COMPANIES CONCERNED. THE CONTRACTOR SHALL PROVE THE LOCATION OF UTILITIES AND SHALL BE RESPONSIBLE FOR ADEQUATE PROTECTION FROM DAMAGE DURING CONSTRUCTION.

GENERAL NOTES:

1. ELEVATIONS ARE SHOWN IN METRES.
2. CONTRACTOR IS RESPONSIBLE FOR LOCATING AND PROTECTING EXISTING UTILITIES.
3. FINISHED GRADE ELEVATIONS ARE TO BE AS SHOWN ON THE DRAWING.
4. ALL DIMENSIONS TO BE VERIFIED ON SITE BY CONTRACTOR PRIOR TO CONSTRUCTION,
5. NO EXCESS DRAINAGE IS TO BE DIRECTED TO NEIGHBORING PROPERTIES DURING OR AFTER CONSTRUCTION.
6. NO ALTERATIONS TO EXISTING GRADE ARE PERMITTED ON OR BEYOND PROPERTY LINE.
7. ALL TREES TO BE PROTECTED BEFORE AND DURING CONSTRUCTION.
8. EXISTING DRIVEWAY TO BE REMOVED AND REPLACED WITH INTERLOCK AS PER ARCHITECTURAL DESIGN.



5	14/02/19	GENERAL REVISION	BU
4	18/07/18	AS PER CITY REVIEW	BU
3	19/01/18	AS PER CITY REVIEW	BU
2	20/07/17	AS PER DESIGNER REVISION	BU
1	08/06/17	AS PER CITY REVIEW	BU
No.	Date	Revision	By:



57 Auriga Dr. Suite 102
Ottawa, ON, K2E 8B2
tel.: (613) 225-1162
fax: (613) 225-4529

Client
LARCO INVESTMENTS LTD.

Project
CHATEAU LAURIER EXPANSION
1 RIDEAU STREET
OTTAWA, ON

Drawing
PRE-DEVELOPMENT
STORM WATER DRAINAGE

Designed	—	Date	08/06/17
Drawn	SL	Scale	1:250
Checked	BU	Sheet	5 of 6
Project No.	2016-146	Dwg. No.	S-04

APPROVED

By Caitlin Salter MacDonald at 12:36 pm, Jun 20, 2019

CAITLIN SALTER MACDONALD
PROGRAM MANAGER, COMMITTEE AND COUNCIL
SERVICES
DEPUTY CITY CLERK, CITY OF OTTAWA