

- LEGEND**
- PROPERTY LINE
 - TREE PROTECTION FENCE
 - SNOW STORAGE AREA
 - EXISTING DECIDUOUS TREE TO REMAIN
 - EXISTING CONIFEROUS TREE TO REMAIN
 - EXISTING TREE TO BE REMOVED
 - NEW SHRUBS/GRASSES
 - EXISTING HEDGE
 - EXISTING HEDGE TO BE REMOVED
 - CONCRETE
 - MULCH
 - SOD
 - EXISTING SOD
 - EXISTING WELL
 - DEPRESSED CURB
 - ACCESSIBLE PARKING SIGNAGE
 - PROPOSES SANITARY MANHOLE, SEE CIVIL
 - PROPOSES CATCH BASIN, SEE CIVIL
 - PROPOSES STORM MANHOLE, SEE CIVIL
 - PROPOSES LIGHTING, SEE ELECTRICAL

- GENERAL NOTES**
- Contractor shall verify all dimensions on site and shall report any discrepancies to the architect prior to commencement of work.
 - Contractor must comply with all codes and bylaws and other regulations by authorities having jurisdiction over the work.
 - Do not scale this drawing.
 - This drawing may not be used for construction unless sealed/signed by the architect.
 - Copyright of this drawings is reserved.

- GENERAL NOTES**
- All general site information and conditions compiled from survey and Architectural site plan by A Plus Architecture.
 - Do not scale this drawing.
 - Report any discrepancies prior to commencing work. No responsibility is born by the Landscape Architect for unknown subsurface conditions.
 - Contractor to check and verify all dimensions on site and report any errors and/or omissions.
 - Reinstate all areas and items damaged as a result of construction activities.
 - Drawing may not be used for construction until signed by Landscape Architect as issued for construction.
 - The accuracy of the position of utilities is not guaranteed.
 - Individual utility co. must be contacted for confirmation of utility existence and location prior to digging.
 - This drawing is an instrument of service and requires the permission of the Landscape Architect for use. Copyright is reserved by Lashley+Associates corporation.

- LANDSCAPING NOTES**
- Plant material shall be No.1 Grade and shall comply with the Metric Guide Specifications for Nursery stock (latest edition), published by Canadian Nursery Trades Association.
 - Plant substitutions shall not be permitted unless approved by the Landscape Architect.
 - Turf areas shall be No.1 Nursery grade sod conforming to the Canadian Nursery Sod Growers Specifications, installed on min. 150mm topsoil over scarified acceptable subgrade.
 - Contractor shall guarantee all plant material for a period of one (1) full year from the date of substantial completion.
 - Obtain approval of planning prior to digging.
 - All plant beds shall be mulched with 75mm composted pine bark mulch.
 - Topsoil shall be garden silt mixture sandy loam with min. 5% organic matter and peat moss added at ratio of 1:10, topsoil to be approved by Landscape Architect.

NO.	ISSUED FOR SITE PLAN RE-SUBMISSION	DATE
9	ISSUED FOR SITE PLAN RE-SUBMISSION	2018/05/31
8	ISSUED FOR SITE PLAN RE-SUBMISSION	2018/04/24
7	ISSUED FOR SITE PLAN RE-SUBMISSION	2018/04/09
6	ISSUED FOR SITE PLAN RE-SUBMISSION	2018/02/14
5	ISSUED FOR SITE PLAN RE-SUBMISSION	2018/11/15
4	ISSUED FOR SITE PLAN RE-SUBMISSION	2018/10/10
3	ISSUED FOR SITE PLAN RE-SUBMISSION	2018/06/29
2	ISSUED FOR CLIENT REVIEW	2018/06/26
1	ISSUED FOR CLIENT REVIEW	2018/06/20
NO. ISSUE		DATE
REVISIONS		

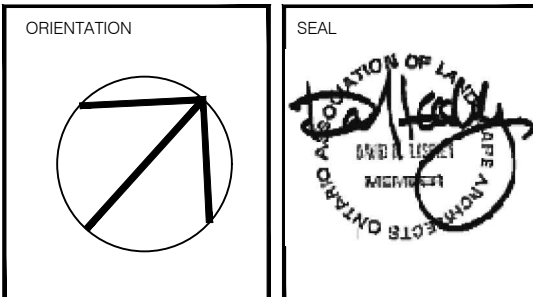

CLIENT
KANATA MUSLIM ASSOCIATION

PROJECT
KMA MOSQUE AND COMMUNITY CENTER
351 SANDHILL ROAD
KANATA, ON K2K 1X7

DRAWING TITLE
LANDSCAPE PLAN PHASE 1

DRAWN BY	AK + SG	DRAWING NO.	L1-1
REVIEWED BY	D.L.	START DATE	2018/06/18
PROJECT NO.	18710-1	REVISION NO.	

LANDSCAPE PLAN-PHASE 1

BIKE RACK FASTENED TO CONCRETE PAD
AS PER MANUFACTURER'S SPECIFICATIONS

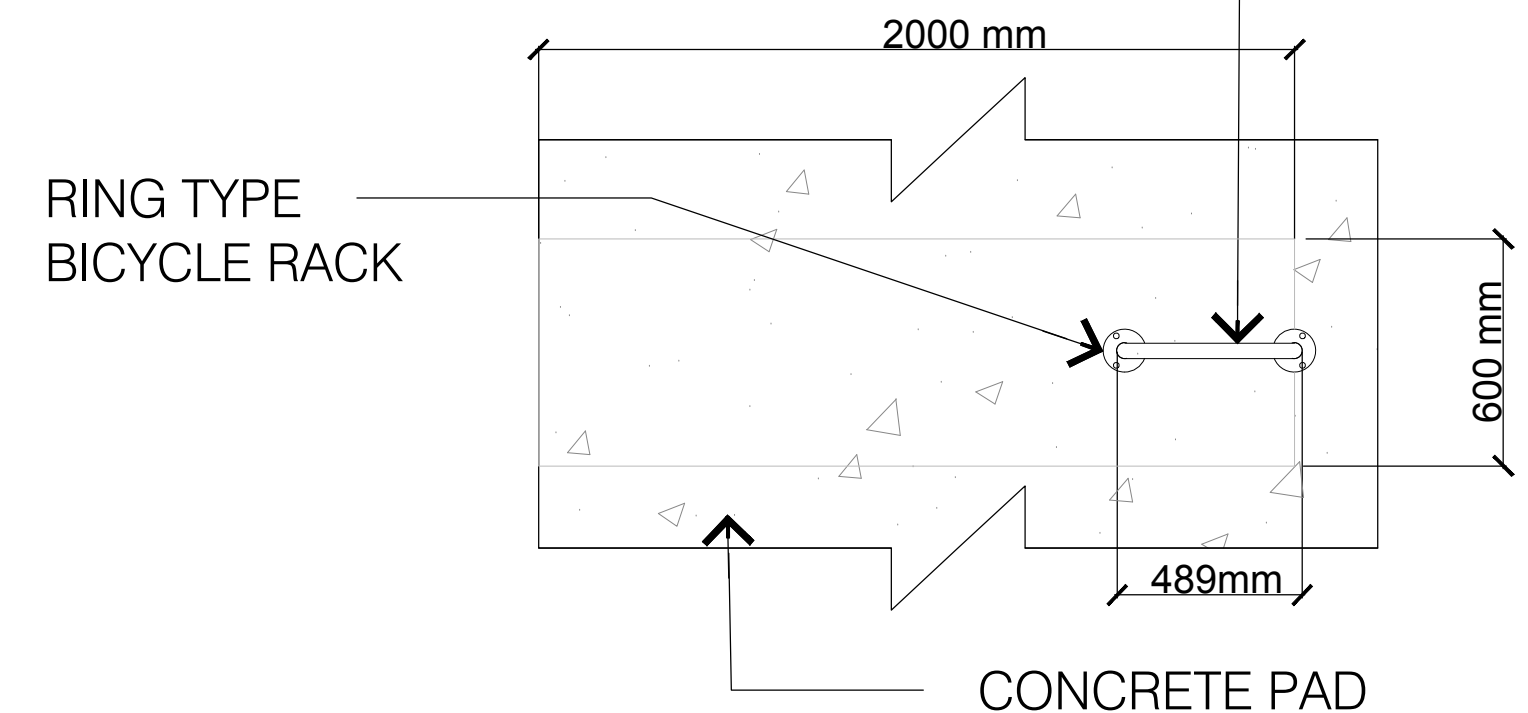

TYPICAL BICYCLE RACK ON CONCRETE PAD

NTS

GENERAL PLANT LIST PHASE 1					
KEY	QTY	BOTANICAL NAME	COMMON NAME	SIZE	COMMENTS SPACING O.C.
SHRUBS					
Ea	8	<i>Euonymus alatus</i> 'little moser'	Little Moses Burning Bush	60cm; 5GAL	POTTED 1000mm
GRASSES					
Ca	7	<i>Calamagrostis acutiflora</i> 'Karl Foerster	Feather Reed Grass	1GAL	POTTED 700mm

TREE INVENTORY			
NO.	SPECIES	SIZE (DBH)	HEALTH + CONDITION
1	ASH / <i>Fraxinus</i> spp.	28CM	POOR
2	ASH / <i>Fraxinus</i> spp.	27CM	POOR
3	ASH / <i>Fraxinus</i> spp.	24CM	POOR
4	RED PINE/ <i>Pinus resinosa</i>	23CM	FAIR/DIEBACK, FALLING BRANCHES
5	RED PINE/ <i>Pinus resinosa</i>	19CM	FAIR/DIEBACK
6	RED PINE/ <i>Pinus resinosa</i>	22CM	FAIR/DIEBACK
7	RED PINE/ <i>Pinus resinosa</i>	26CM	FAIR
8	RED PINE/ <i>Pinus resinosa</i>	18CM	FAIR
9	WHITE SPRUCE / <i>Picea glauca</i>	19CM	GOOD, FAIR
10	ASH / <i>Fraxinus</i> spp.	27CM	POOR
11	ASH / <i>Fraxinus</i> spp.	31CM	POOR
12	WHITE SPRUCE / <i>Picea glauca</i>	29CM	GOOD
13	WHITE SPRUCE / <i>Picea glauca</i>	34CM	GOOD
14	WHITE SPRUCE / <i>Picea glauca</i>	26CM	GOOD, ADJACENT PRIVATE PROPERTY
15	WHITE SPRUCE / <i>Picea glauca</i>	30CM	GOOD, ADJACENT PRIVATE PROPERTY
16	WHITE SPRUCE / <i>Picea glauca</i>	31CM	GOOD, ADJACENT PRIVATE PROPERTY
17	WHITE SPRUCE / <i>Picea glauca</i>	29CM	GOOD, ADJACENT PRIVATE PROPERTY
18	WHITE SPRUCE / <i>Picea glauca</i>	22CM	GOOD, ADJACENT PRIVATE PROPERTY
19	WHITE SPRUCE / <i>Picea glauca</i>	21CM	GOOD, ADJACENT PRIVATE PROPERTY
20	WHITE SPRUCE / <i>Picea glauca</i>	36CM	GOOD, ADJACENT PRIVATE PROPERTY
21	WHITE SPRUCE / <i>Picea glauca</i>	22CM	GOOD, ADJACENT PRIVATE PROPERTY
22	WHITE SPRUCE / <i>Picea glauca</i>	36CM	GOOD, ADJACENT PRIVATE PROPERTY
23	WHITE SPRUCE / <i>Picea glauca</i>	38CM	GOOD, ADJACENT PRIVATE PROPERTY
24	WHITE SPRUCE / <i>Picea glauca</i>	28CM	GOOD, ADJACENT PRIVATE PROPERTY
25	WHITE SPRUCE / <i>Picea glauca</i>	32CM	GOOD, ADJACENT PRIVATE PROPERTY
26	WHITE SPRUCE / <i>Picea glauca</i>	25CM	GOOD, ADJACENT PRIVATE PROPERTY
27	WHITE SPRUCE / <i>Picea glauca</i>	29CM	FAIR, ADJACENT PRIVATE PROPERTY
28	WHITE SPRUCE / <i>Picea glauca</i>	29CM	GOOD, ADJACENT PRIVATE PROPERTY
29	WHITE SPRUCE / <i>Picea glauca</i>	30CM	GOOD, ADJACENT PRIVATE PROPERTY
30	WHITE SPRUCE / <i>Picea glauca</i>	30CM	FAIR, ADJACENT PRIVATE PROPERTY
31	WHITE SPRUCE / <i>Picea glauca</i>	26CM	GOOD
32	WHITE SPRUCE / <i>Picea glauca</i>	31CM	GOOD
33	WHITE SPRUCE / <i>Picea glauca</i>	31CM	GOOD

NO.	SPECIES	SIZE (DBH)	HEALTH + CONDITION
34	WHITE SPRUCE / <i>Picea glauca</i>	29CM	FAIR
35	WHITE SPRUCE / <i>Picea glauca</i>	28CM	POOR
36	WHITE SPRUCE / <i>Picea glauca</i>	31CM	GOOD
37	WHITE SPRUCE / <i>Picea glauca</i>	31CM	GOOD
38	WHITE SPRUCE / <i>Picea glauca</i>	31CM	FAIR
39	WHITE SPRUCE / <i>Picea glauca</i>	27CM	GOOD
40	WHITE SPRUCE / <i>Picea glauca</i>	34CM	GOOD
41	WHITE SPRUCE / <i>Picea glauca</i>	29CM	GOOD
42	WHITE SPRUCE / <i>Picea glauca</i>	29CM	FAIR
43	WHITE SPRUCE / <i>Picea glauca</i>	29CM	GOOD
44	WHITE SPRUCE / <i>Picea glauca</i>	28CM	GOOD
45	WHITE SPRUCE / <i>Picea glauca</i>	28CM	FAIR
47	WHITE SPRUCE / <i>Picea glauca</i>	29CM	GOOD
48	WHITE SPRUCE / <i>Picea glauca</i>	32CM	GOOD
49	WHITE SPRUCE / <i>Picea glauca</i>	30CM	GOOD
50	WHITE SPRUCE / <i>Picea glauca</i>	30CM	GOOD
51	WHITE SPRUCE / <i>Picea glauca</i>	30CM	FAIR
52	WHITE SPRUCE / <i>Picea glauca</i>	31CM	FAIR
53	WHITE SPRUCE / <i>Picea glauca</i>	29CM	FAIR
54	WHITE SPRUCE / <i>Picea glauca</i>	35CM	FAIR
55	WHITE SPRUCE / <i>Picea glauca</i>	31CM	FAIR
56	WHITE SPRUCE / <i>Picea glauca</i>	30CM	GOOD
58	MANITOBA MAPLE/ <i>Acer negundo</i>	18CM	GOOD
60	MANITOBA MAPLE/ <i>Acer negundo</i>	29CM	GOOD-MINOR LOWER LIMB DIEBACK
67	WHITE SPRUCE / <i>Picea glauca</i>	28CM	GOOD
72	CRABAPPLE/ <i>Malus</i> spp.	17, 10CM	FAIR
75	ASH / <i>Fraxinus</i> spp.	39CM	POOR
76	RED PINE/ <i>Pinus resinosa</i>	21CM	POOR
77	RED PINE/ <i>Pinus resinosa</i>	22CM	FAIR
78	WHITE CEDAR/ <i>Thuja occidentalis</i>		GOOD

TREES TO BE REMOVED IN PHASE 1			
NO.	SPECIES	SIZE (DBH)	HEALTH + CONDITION
46	WHITE SPRUCE / <i>Picea glauca</i>	27CM	DEAD
57	ASPEN / <i>Populus</i> spp.	18, 16CM	DEAD/DOUBLE STEM
59	MANITOBA MAPLE/ <i>Acer negundo</i>	26, 28, 23, 20CM	GOOD/FAIR-SUSCEPTIBLE TO TRUNK ROT
61	MANITOBA MAPLE/ <i>Acer negundo</i>	42CM	POOR-LARGE SNAPPED LIMB, SAFETY HAZARD
62	PAPER BIRCH/ <i>Betula papyrifera</i>	26, 29CM	FAIR-DOUBLE STEMMED, SNAPPED UPPER LIMBS, DAMAGED BARK
63	NORWAY MAPLE / <i>Acer platanoides</i>	39CM	GOOD
64	NORWAY MAPLE / <i>Acer platanoides</i>	28CM	GOOD
65	NORWAY MAPLE / <i>Acer platanoides</i>	30CM	GOOD
66	NORWAY MAPLE / <i>Acer platanoides</i>	34CM	GOOD
68	ASH / <i>Fraxinus</i> spp.	33CM	POOR
69	ASH / <i>Fraxinus</i> spp.	36CM	POOR
70	ASH / <i>Fraxinus</i> spp.	28CM	POOR
71	ASH / <i>Fraxinus</i> spp.	37CM	POOR
73	RED PINE/ <i>Pinus resinosa</i>	25CM	FAIR
74	RED PINE/ <i>Pinus resinosa</i>	27CM	GOOD

Derrick Moodie
DERRICK MOODIE
MANAGER
PLANNING, INFRASTRUCTURE & ECONOMIC
DEVELOPMENT DEPARTMENT, CITY OF OTTAWA
APPROVED
By Derrick Moodie at 10:46 am, Jun 12, 2019

1 LANDSCAPE PLAN-PHASE 2

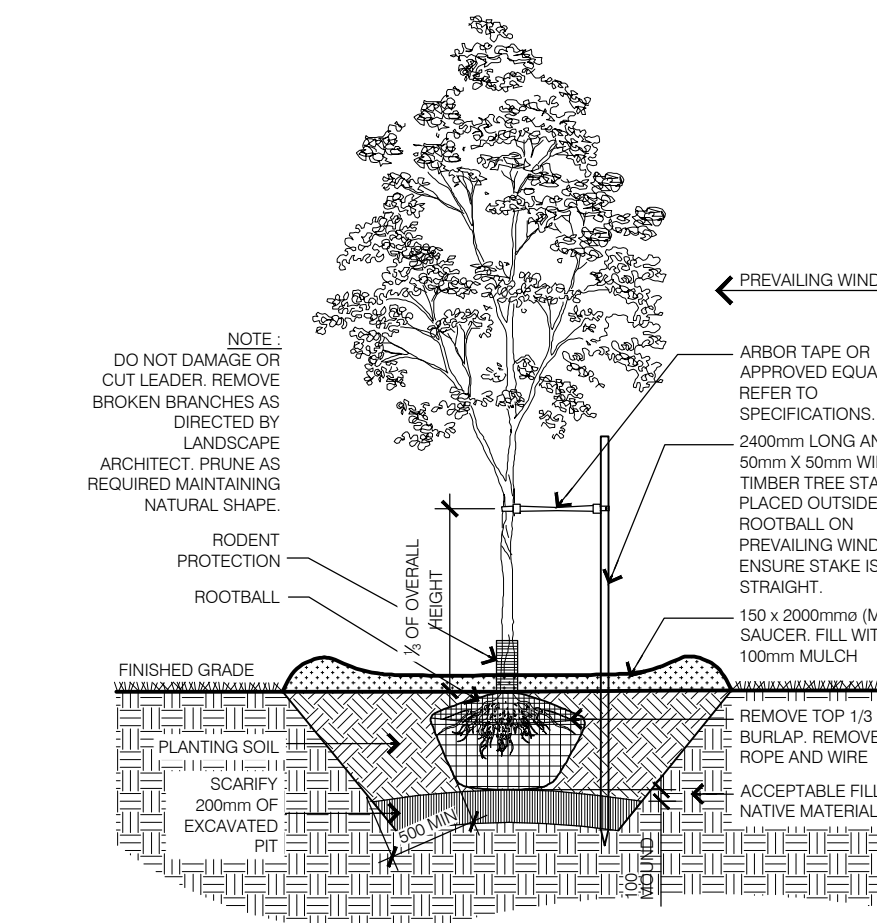

2 DECIDUOUS TREE PLANTING

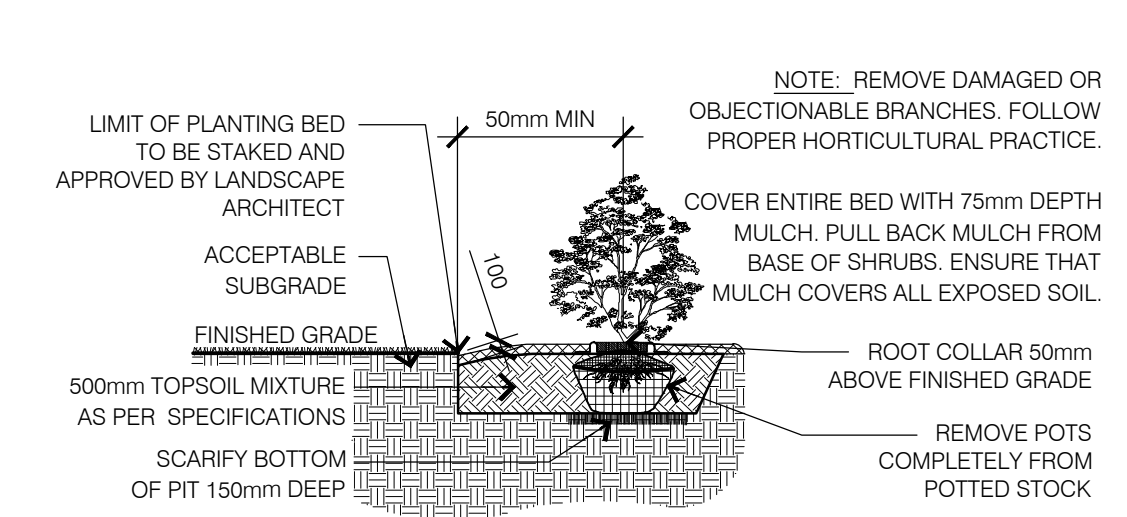

3 SHRUB PLANTING



4 PERENNIAL PLANTING



DERRICK MOODIE
MANAGER
PLANNING, INFRASTRUCTURE & ECONOMIC
DEVELOPMENT DEPARTMENT, CITY OF OTTAWA
APPROVED
By Derrick Moodie at 10:47 am, Jun 12, 2019

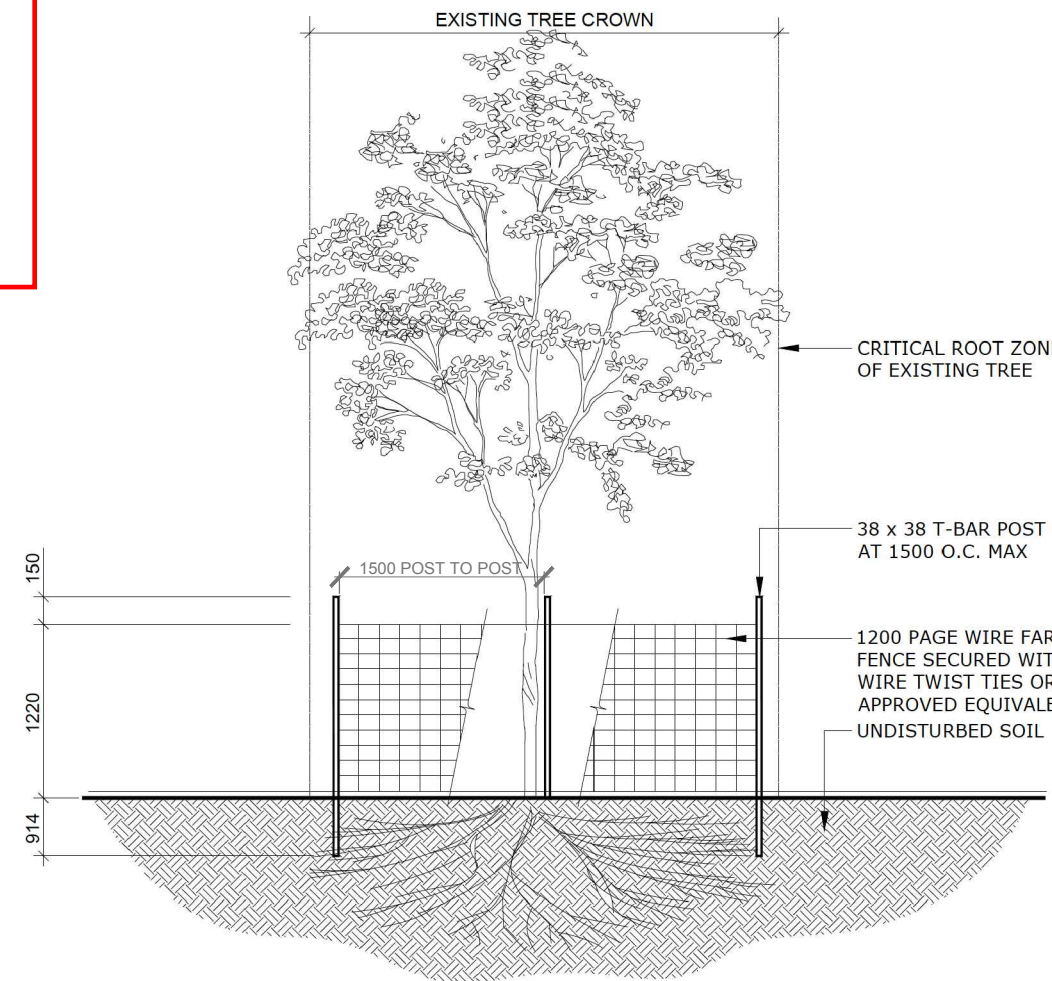

5 TREE PROTECTION FENCING



TREE INVENTORY			
NO.	SPECIES	SIZE (DBH)	HEALTH + CONDITION
9	WHITE SPRUCE / <i>Picea glauca</i>	19CM	GOOD/FAIR
14	WHITE SPRUCE / <i>Picea glauca</i>	26CM	GOOD, ADJACENT PRIVATE PROPERTY
15	WHITE SPRUCE / <i>Picea glauca</i>	30CM	GOOD, ADJACENT PRIVATE PROPERTY
16	WHITE SPRUCE / <i>Picea glauca</i>	31CM	GOOD, ADJACENT PRIVATE PROPERTY
17	WHITE SPRUCE / <i>Picea glauca</i>	29CM	GOOD, ADJACENT PRIVATE PROPERTY
18	WHITE SPRUCE / <i>Picea glauca</i>	22CM	GOOD, ADJACENT PRIVATE PROPERTY
19	WHITE SPRUCE / <i>Picea glauca</i>	21CM	GOOD, ADJACENT PRIVATE PROPERTY
20	WHITE SPRUCE / <i>Picea glauca</i>	36CM	GOOD, ADJACENT PRIVATE PROPERTY
21	WHITE SPRUCE / <i>Picea glauca</i>	22CM	GOOD, ADJACENT PRIVATE PROPERTY
22	WHITE SPRUCE / <i>Picea glauca</i>	36CM	GOOD, ADJACENT PRIVATE PROPERTY
23	WHITE SPRUCE / <i>Picea glauca</i>	38CM	GOOD, ADJACENT PRIVATE PROPERTY
24	WHITE SPRUCE / <i>Picea glauca</i>	28CM	GOOD, ADJACENT PRIVATE PROPERTY
25	WHITE SPRUCE / <i>Picea glauca</i>	32CM	GOOD, ADJACENT PRIVATE PROPERTY
26	WHITE SPRUCE / <i>Picea glauca</i>	25CM	PRIVATE PROPERTY
27	WHITE SPRUCE / <i>Picea glauca</i>	29CM	FAIR, ADJACENT PRIVATE PROPERTY
28	WHITE SPRUCE / <i>Picea glauca</i>	29CM	GOOD, ADJACENT PRIVATE PROPERTY
29	WHITE SPRUCE / <i>Picea glauca</i>	30CM	GOOD, ADJACENT PRIVATE PROPERTY
30	WHITE SPRUCE / <i>Picea glauca</i>	30CM	FAIR, ADJACENT PRIVATE PROPERTY
31	WHITE SPRUCE / <i>Picea glauca</i>	26CM	GOOD
32	WHITE SPRUCE / <i>Picea glauca</i>	31CM	GOOD
33	WHITE SPRUCE / <i>Picea glauca</i>	31CM	GOOD
34	WHITE SPRUCE / <i>Picea glauca</i>	29CM	FAIR
35	WHITE SPRUCE / <i>Picea glauca</i>	29CM	GOOD
36	WHITE SPRUCE / <i>Picea glauca</i>	31CM	GOOD
37	WHITE SPRUCE / <i>Picea glauca</i>	31CM	GOOD
38	WHITE SPRUCE / <i>Picea glauca</i>	31CM	FAIR
39	WHITE SPRUCE / <i>Picea glauca</i>	27CM	GOOD
40	WHITE SPRUCE / <i>Picea glauca</i>	34CM	GOOD
41	WHITE SPRUCE / <i>Picea glauca</i>	29CM	GOOD
42	WHITE SPRUCE / <i>Picea glauca</i>	29CM	FAIR
43	WHITE SPRUCE / <i>Picea glauca</i>	29CM	GOOD
44	WHITE SPRUCE / <i>Picea glauca</i>	28CM	GOOD
45	WHITE SPRUCE / <i>Picea glauca</i>	28CM	FAIR
47	WHITE SPRUCE / <i>Picea glauca</i>	29CM	GOOD
48	WHITE SPRUCE / <i>Picea glauca</i>	32CM	GOOD
49	WHITE SPRUCE / <i>Picea glauca</i>	30CM	GOOD
50	WHITE SPRUCE / <i>Picea glauca</i>	30CM	GOOD
51	WHITE SPRUCE / <i>Picea glauca</i>	30CM	FAIR
52	WHITE SPRUCE / <i>Picea glauca</i>	31CM	FAIR
53	WHITE SPRUCE / <i>Picea glauca</i>	29CM	FAIR
54	WHITE SPRUCE / <i>Picea glauca</i>	35CM	FAIR
55	WHITE SPRUCE / <i>Picea glauca</i>	31CM	FAIR
56	WHITE SPRUCE / <i>Picea glauca</i>	30CM	GOOD
58	MANITOBA MAPLE / <i>Acer negundo</i>	18CM	GOOD
60	MANITOBA MAPLE / <i>Acer negundo</i>	29CM	GOOD-MINOR LOWER LIMB DIEBACK
78	WHITE CEDAR / <i>Thuja occidentalis</i>		GOOD

TREES TO BE REMOVED IN PHASE 2			
NO.	SPECIES	SIZE (DBH)	HEALTH + CONDITION
1	ASH / <i>Fraxinus</i> spp.	28CM	POOR
2	ASH / <i>Fraxinus</i> spp.	27CM	POOR
3	ASH / <i>Fraxinus</i> spp.	24CM	POOR
4	RED PINE / <i>Pinus resinosa</i>	23CM	FAIR/DIEBACK, FALLING BRANCHES
5	RED PINE / <i>Pinus resinosa</i>	19CM	FAIR/DIEBACK
6	RED PINE / <i>Pinus resinosa</i>	22CM	FAIR/DIEBACK
7	RED PINE / <i>Pinus resinosa</i>	26CM	FAIR
8	RED PINE / <i>Pinus resinosa</i>	18CM	FAIR
10	ASH / <i>Fraxinus</i> spp.	27CM	POOR
11	ASH / <i>Fraxinus</i> spp.	31CM	POOR
12	WHITE SPRUCE / <i>Picea glauca</i>	29CM	GOOD
13	WHITE SPRUCE / <i>Picea glauca</i>	34CM	GOOD
36	WHITE SPRUCE / <i>Picea glauca</i>	31CM	GOOD
67	WHITE SPRUCE / <i>Picea glauca</i>	28CM	GOOD
72	CRABAPPLE / <i>Malus</i> spp.	17, 10CM	FAIR
75	ASH / <i>Fraxinus</i> spp.	39CM	POOR
76	RED PINE / <i>Pinus resinosa</i>	21CM	POOR
77	RED PINE / <i>Pinus resinosa</i>	22CM	FAIR

GENERAL PLANT LIST PHASE 2						
PHASE	KEY	QTY	BOTANICAL NAME	COMMON NAME	SIZE	COMMENTS SPACING O.C.
DECIDUOUS TREES						
2	Al	1	<i>Amelanchier laevis</i>	Allegheny Serviceberry	45mm	W.B.
2	Co	2	<i>Celtis occidentalis</i>	Common Hackberry	45mm	W.B.
2	Pu	3	<i>Pyrus x ussuriensis 'Ure'</i>	Ure Pear	45mm	W.B.
2	Sr	3	<i>Syringa meyeri</i>	Meyer Lilac	100cm High	TREE FORM, W.B.
SHRUBS						
2	Bx	21	<i>Buxus microphylla 'Winter Beauty'</i>	Winter Beauty Boxwood	1GAL	POTTED 800mm
2	Cac	21	<i>Cornus alternifolia</i>	Peking Dogwood	2GAL	POTTED 1100mm
2	Ds	6	<i>Diervilla sessilifolia 'Cool Splash'</i>	Cool Splash Honeysuckle	2GAL	POTTED 1000mm
2	Ig	14	<i>Ilex glabra 'Compacta'</i>	Compact Inkberry	50cm; 3GAL	POTTED 800mm
2	Js	23	<i>Juniperus sabina 'Calgary Carpet'</i>	Calgary Carpet Juniper	3GAL	POTTED 800mm
2	Ra	13	<i>Rhus aromatica 'Gro-Low'</i>	Fragrant Sumac	1GAL	POTTED 1500mm
PERENNIALS						
2	Hs	42	<i>Hemerocallis 'Stella D'oro'</i>	Stella Doro Daylily	1GAL	POTTED 500mm
2	As	61	<i>Astilbe chinensis 'Vision in White'</i>	Chinese Astilbe	1GAL	POTTED 500mm

GENERAL NOTES

- Contractor shall verify all dimensions on site and shall report any discrepancies to the architect prior to commencement of work.
- Contractor must comply with all codes and bylaws and other regulations by authorities having jurisdiction over the work.
- Do not scale this drawing.
- This drawing may not be used for construction unless sealed/signed by the architect.
- Copyright of this drawings is reserved.

GENERAL NOTES

- All general site information and conditions compiled from survey and Architectural site plan by A Plus Architecture.
- Do not scale this drawing.
- Report any discrepancies prior to commencing work. No responsibility is born by the Landscape Architect for unknown subsurface conditions.
- Contractor to check and verify all dimensions on site and report any errors and/or omissions.
- Reinstall all areas and items damaged as a result of construction activities.
- Drawing may not be used for construction until signed by Landscape Architect as issued for construction.
- The accuracy of the position of utilities is not guaranteed.
- Individual utility co. must be contacted for confirmation of utility existence and location prior to digging.
- This drawing is an instrument of service and requires the permission of the Landscape Architect for use. Copyright is reserved by Lashley + Associates corporation.

LANDSCAPING NOTES

- Plant material shall be No.1 Grade and shall comply with the Metric Guide Specifications for Nursery stock (latest edition), published by Canadian Nursery Trades Association.
- Plant substitutions shall not be permitted unless approved by the Landscape Architect.
- Turf areas shall be No.1 Nursery grade sod conforming to the Canadian Nursery Sod Growers Specifications, installed on min. 150mm topsoil over scarified acceptable subgrade.
- Contractor shall guarantee all plant material for a period of one (1) full year from the date of substantial completion.
- Obtain approval of planting prior to digging.
- All plant beds shall be mulched with 75mm composted pine bark mulch.
- Topsoil shall be garden air mixture sandy loam with min. 5% organic matter and peat moss added at ratio of 1:10, topsoil to be approved by Landscape Architect.

9	ISSUED FOR SITE PLAN RE-SUBMISSION	2018/05/31
8	ISSUED FOR SITE PLAN RE-SUBMISSION	2018/04/24
7	ISSUED FOR SITE PLAN RE-SUBMISSION	2018/04/09
6	ISSUED FOR SITE PLAN RE-SUBMISSION	2018/02/14
5	ISSUED FOR SITE PLAN RE-SUBMISSION	2018/11/15
4	ISSUED FOR SITE PLAN RE-SUBMISSION	2018/10/10
3	ISSUED FOR SITE PLAN RE-SUBMISSION	2018/06/29
2	ISSUED FOR CLIENT REVIEW	2018/06/26
1	ISSUED FOR CLIENT REVIEW	2018/06/20
NO. ISSUE		DATE
REVIEWS		

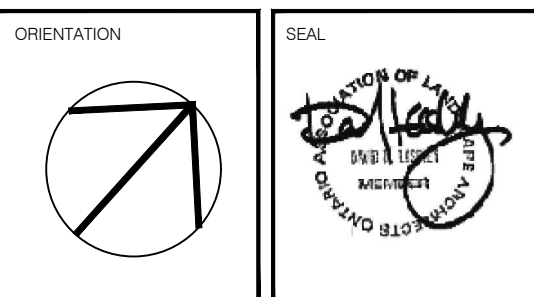

CLIENT
KANATA MUSLIM ASSOCIATION

PROJECT
KMA MOSQUE AND COMMUNITY CENTER
351 SANDHILL ROAD
KANATA, ON K2K 1X7

DRAWING TITLE
LANDSCAPE PLAN PHASE 2

DRAWN BY	A.K. + S.G.	DRAWING NO.	
REVIEWED BY	D.L.		
START DATE	2018/06/18		
PROJECT NO.	18710-1	REVISION NO.	

L1-2

#17532