

JEFF MCEWEN P.ENG.
MANAGER, DEVELOPMENT REVIEW EAST BRANCH
PLANNING, INFRASTRUCTURE & ECONOMIC
DEVELOPMENT DEPARTMENT, CITY OF OTTAWA

APPROVED
By mcewenje at 3:32 pm, Mar 18, 2019

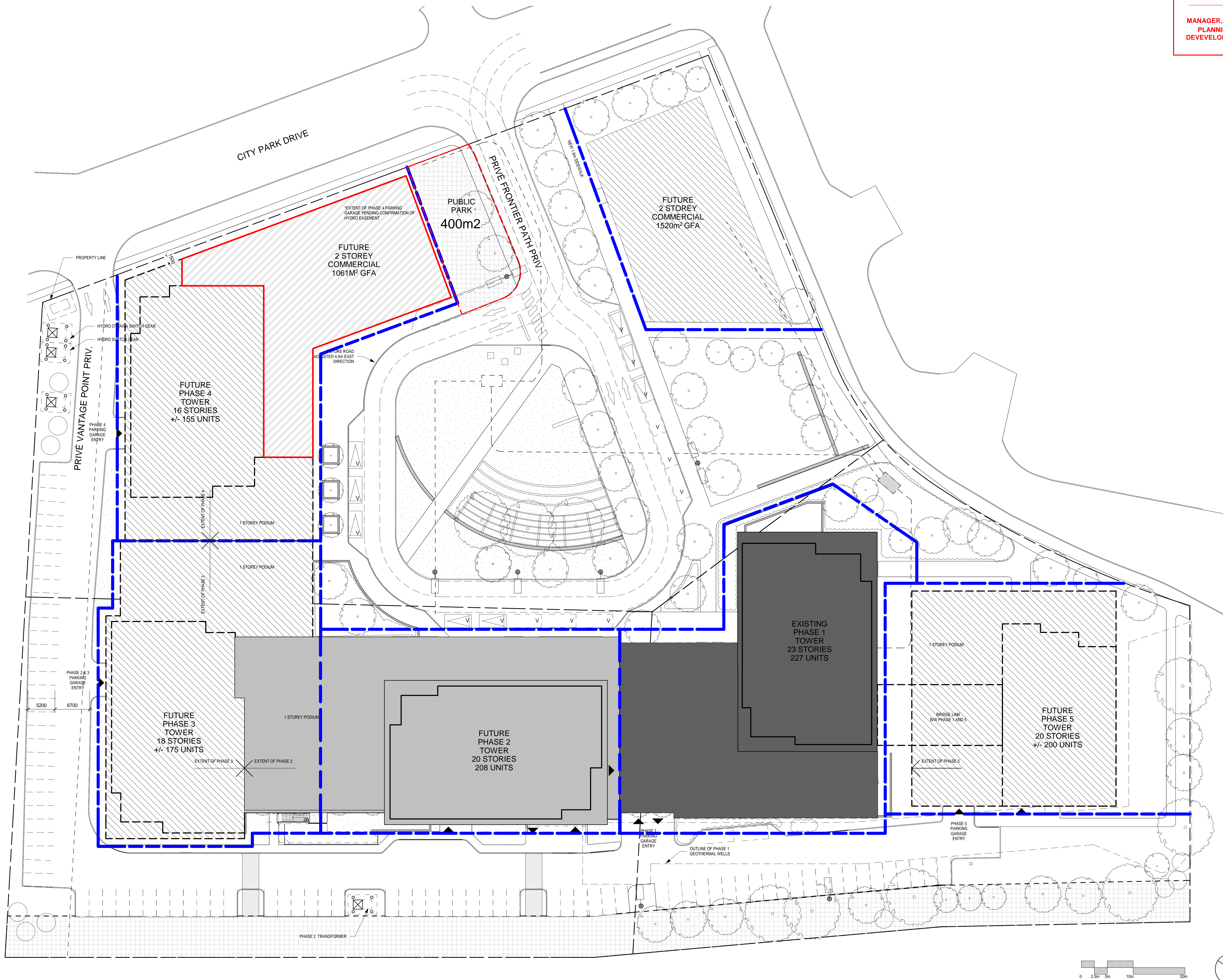

1 MASTER SITE PLAN
A1.0 SCALE: 1 : 300

E	19.03.14	Re-issued for Site Plan Application
D	19.02.15	Issued for Site Plan Application
C	19.01.16	Issued for 90% Review
B	18.11.09	Issued for Site Plan Application Revision 1
A	18.10.31	Issued for 66% Review

No. Date Revision

It is the responsibility of the appropriate contractor to check and verify all dimensions on site and report all errors and/or omissions to the engineer.

All contractors must comply with all.

Do not scale drawings.

This drawing may not be used for construction until signed.

Copyright reserved.

Hobin Architecture
Incorporated
63 Pamela Street
Ottawa, Ontario
Canada K1S 3K7
T: 613-238-7200
F: 613-235-2005
E: mail@hobinarc.com
hobinarc.com

HOBIN
ARCHITECTURE

PROJECT
RIOCAN - CITY PARK
PHASE 2

200 FRONTIER PATH PRIV.
(FORMALLY 2280 City Park Dr.)

DRAWING TITLE
MASTER SITE PLAN

DRAWN DATE SCALE
R.L.K. 06/28/18 1 : 300

PROJECT
1750

DRAWING NO.
A1.0

REVISION NO. F

17741