

1 DECIDUOUS TREE PLANTING

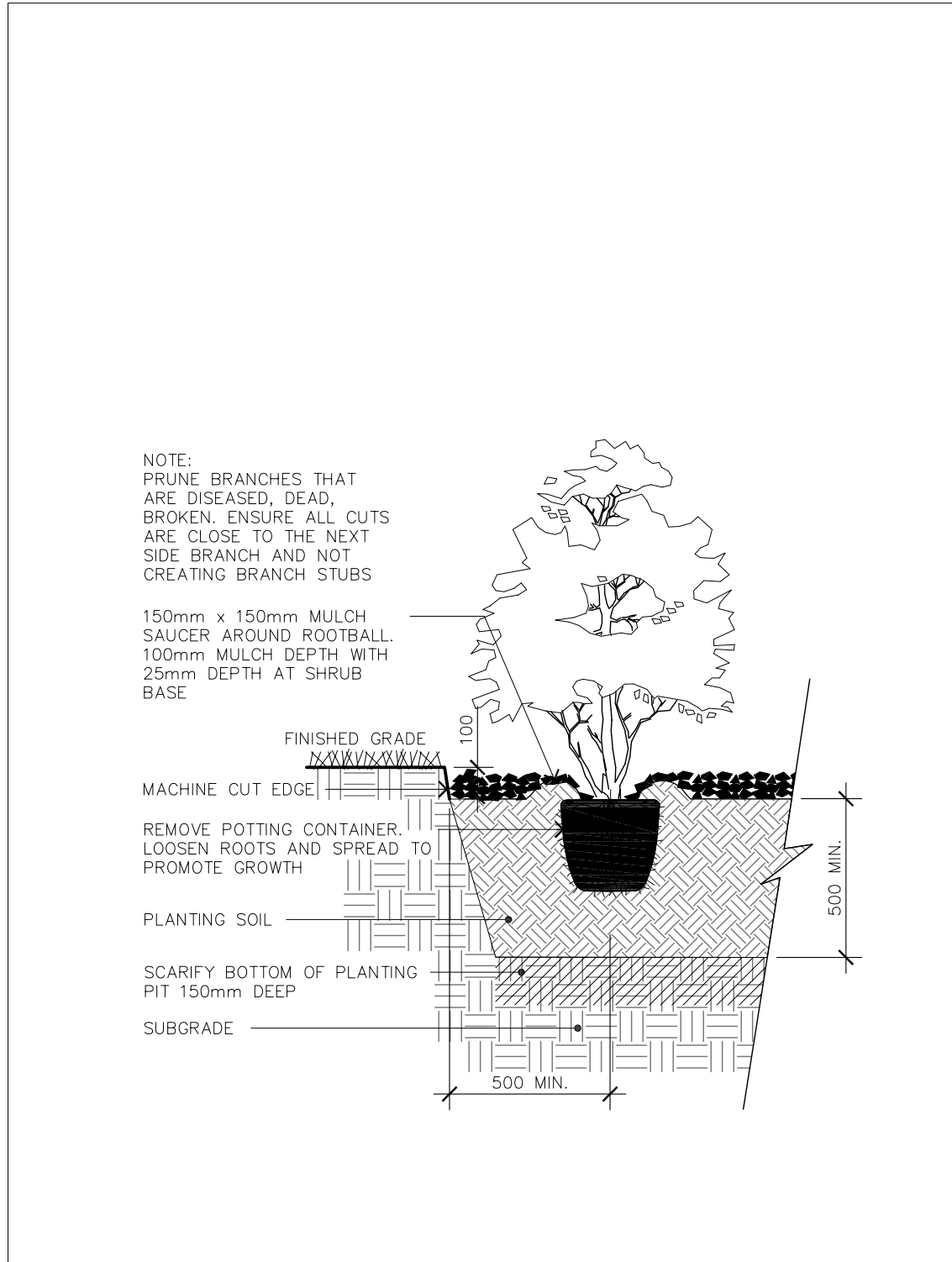

2 SHRUB PLANTING

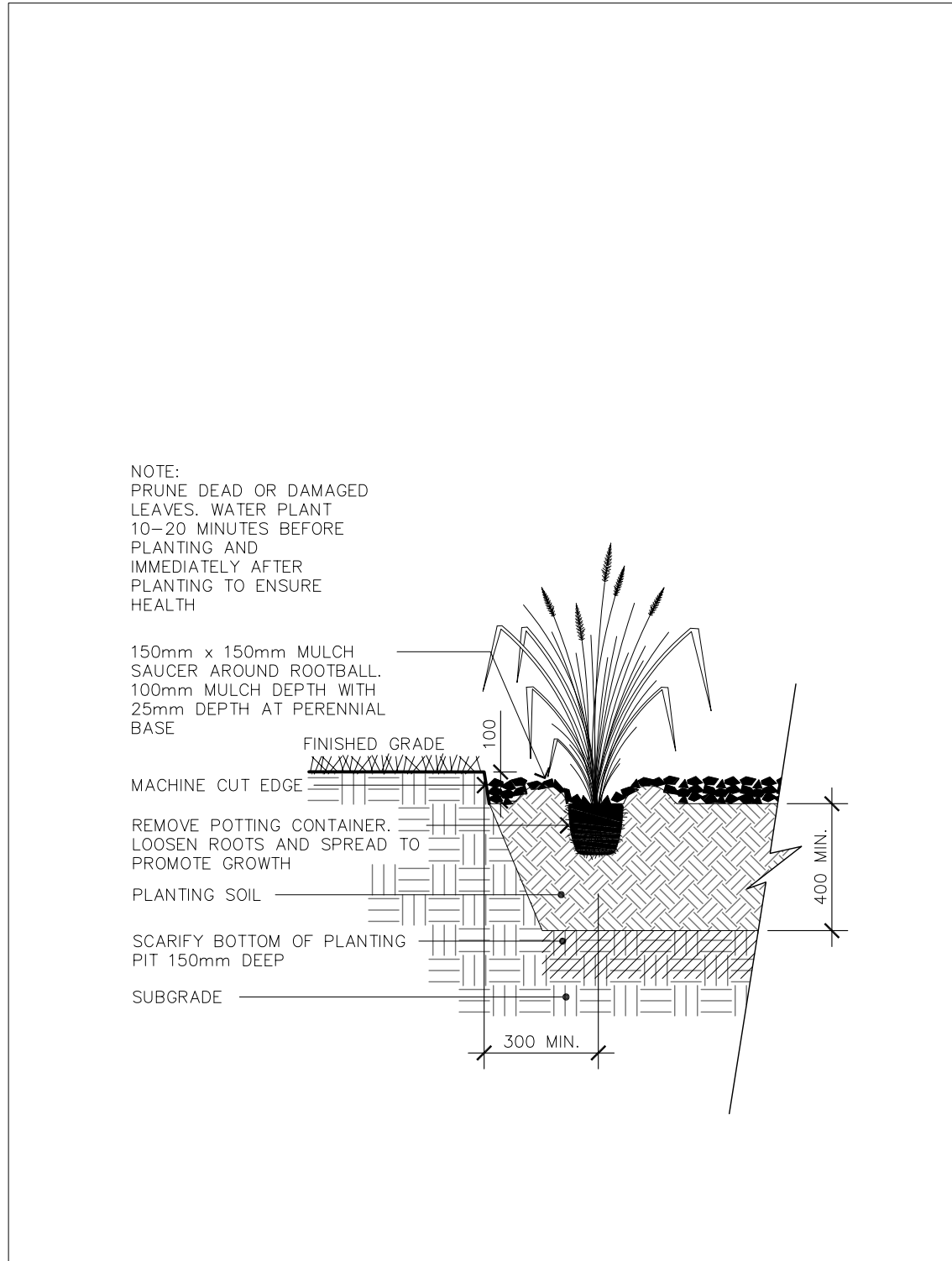

3 PERENNIAL AND GRASS PLANTING

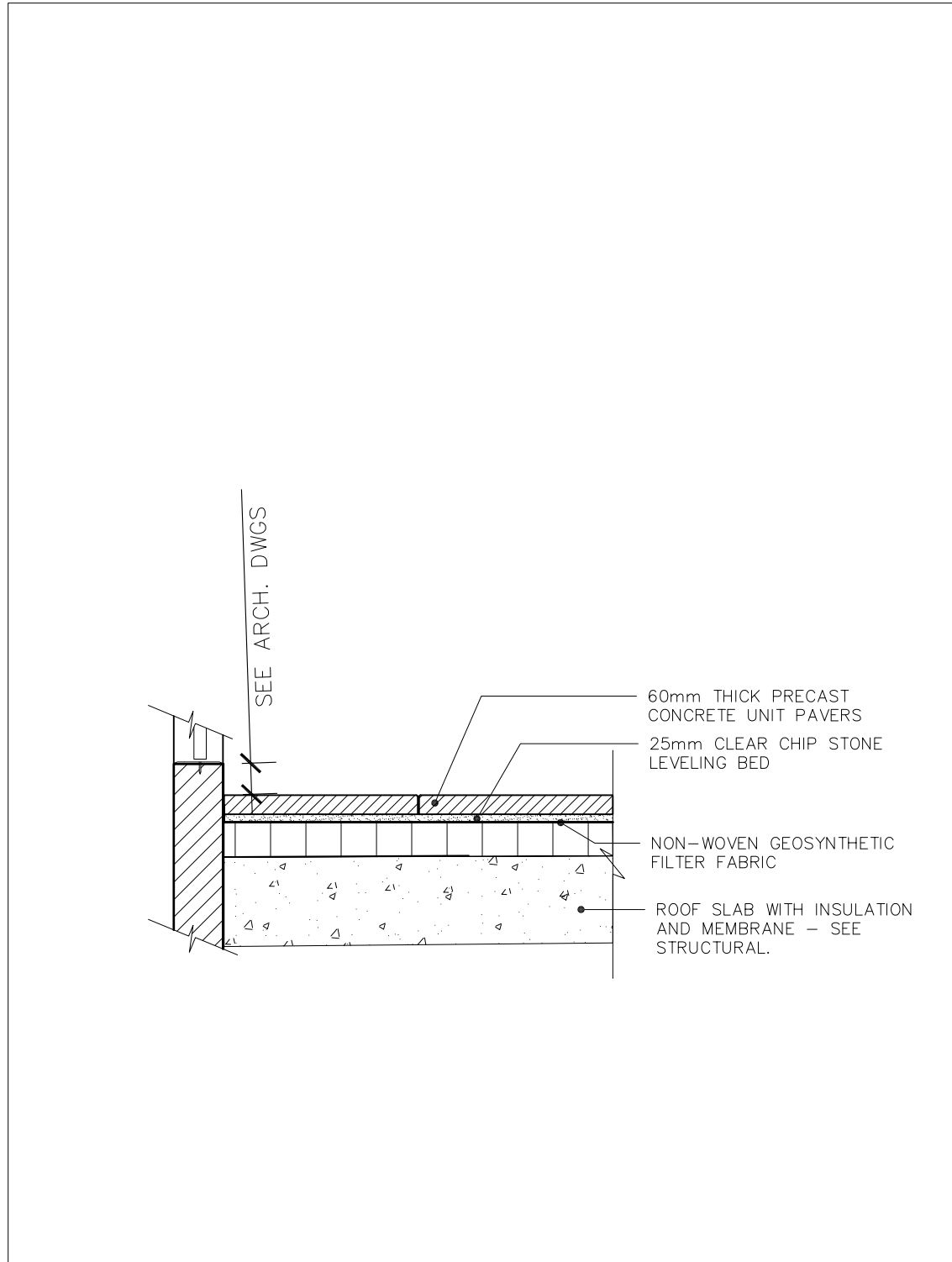

4 UNIT PAVING ON SLAB

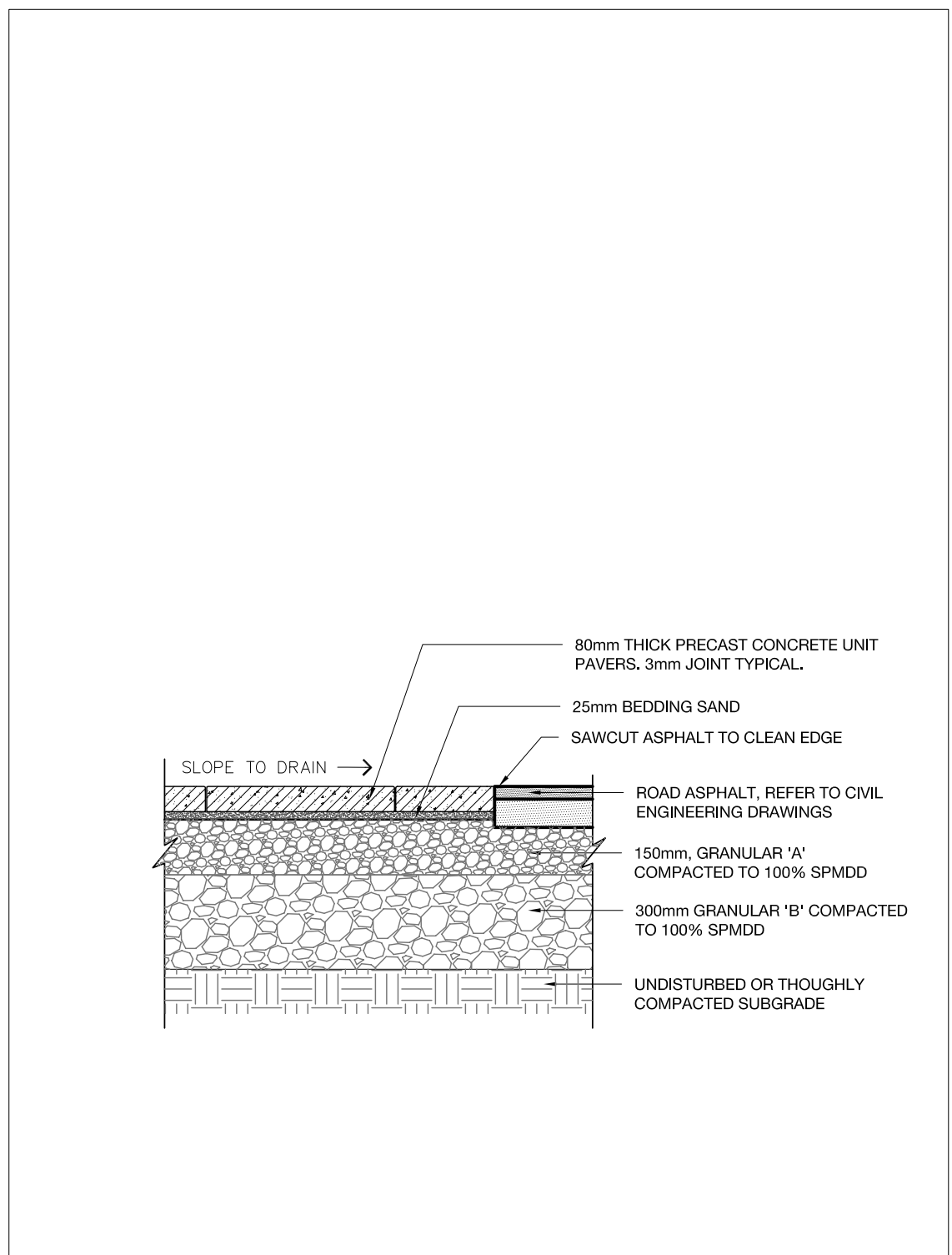

5 HEAVY DUTY UNIT PAVING

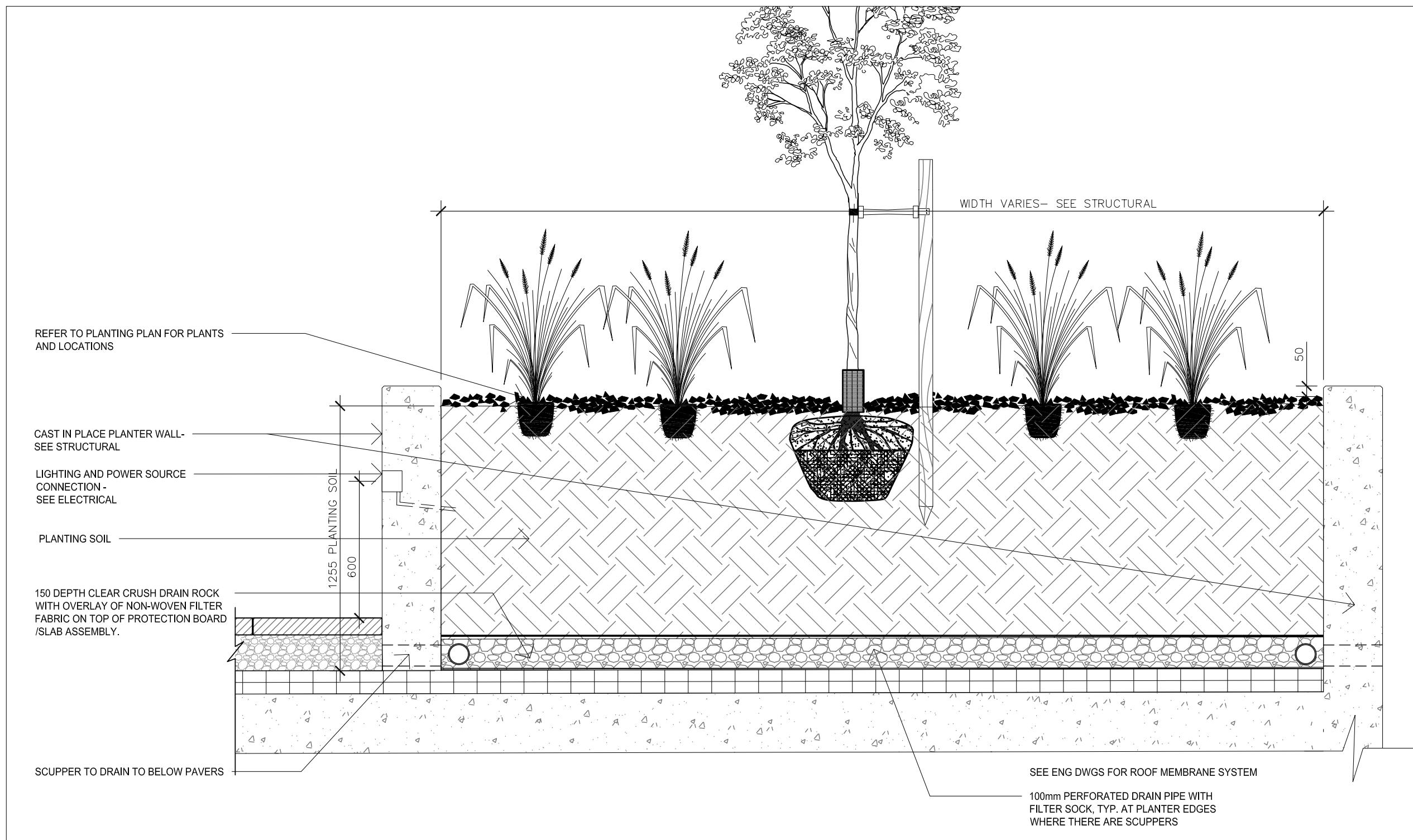

6 AMENITY TERRACE PLANTERS

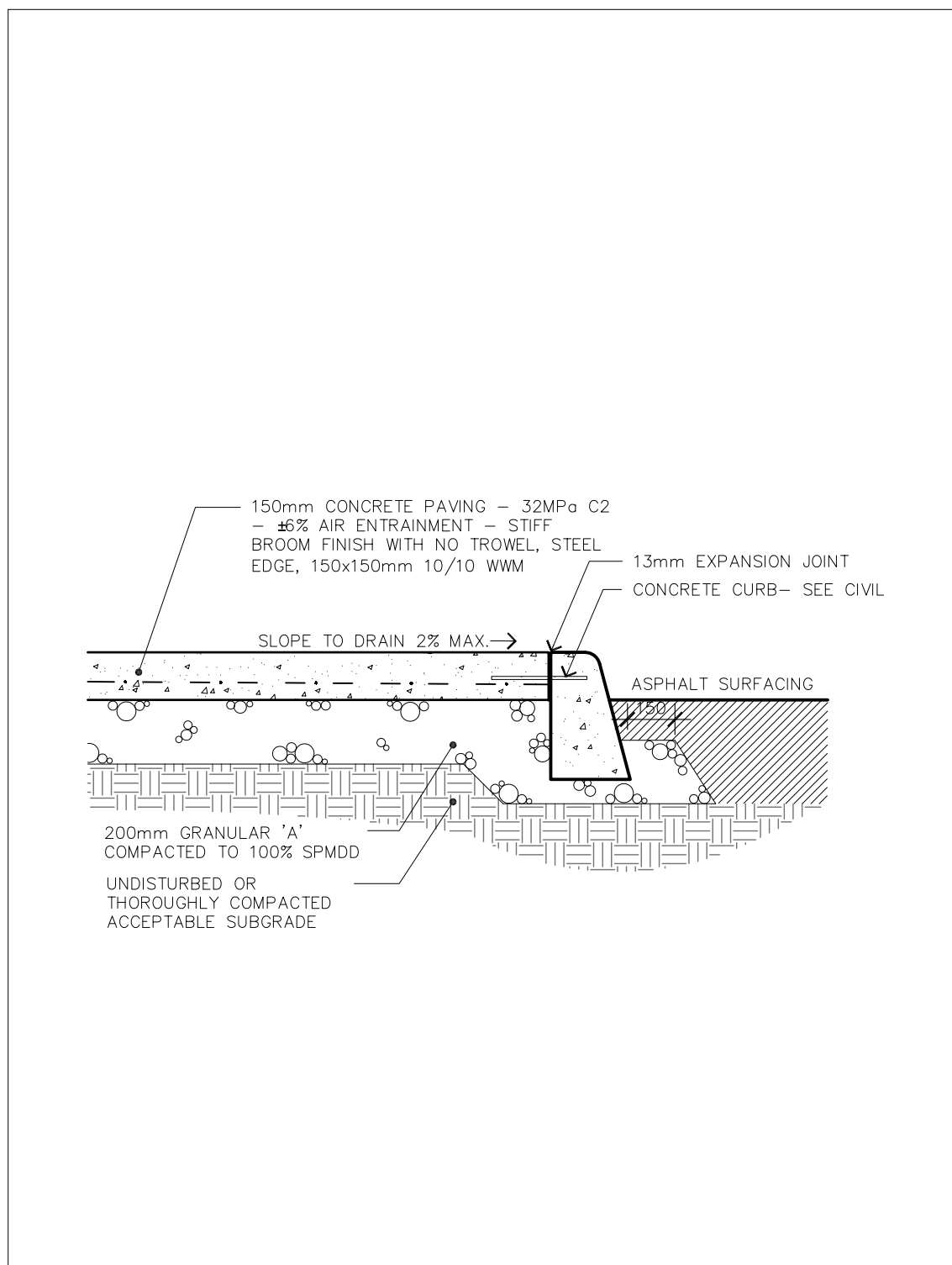

7 LIGHT DUTY CONCRETE PAVING

- GENERAL NOTES
- CONTRACTOR SHALL CHECK AND VERIFY ALL DIMENSIONS ON SITE AND REPORT ANY DISCREPANCIES, ERRORS AND/OR OMISSIONS TO THE LANDSCAPE ARCHITECT PRIOR TO COMMENCING WORK.
 - ALL UNDERGROUND UTILITIES TO BE LOCATED BY THE CONTRACTOR PRIOR TO THE COMMENCEMENT OF ANY WORK. THE LANDSCAPE ARCHITECT BARES NO RESPONSIBILITY FOR ANY UNKNOWN SUBSURFACE CONDITIONS.
 - MINIMUM CLEARANCE FROM ANY UNDERGROUND SERVICES TO TREES SHALL BE 2.0 METRES.
 - MAINTAIN A MINIMUM 2100mm FOR ALL PEDESTRIAN SIDEWALKS AS PER CITY STANDARD.
 - CONTRACTOR TO COMPLETE LAYOUT TO APPROVAL OF LANDSCAPE ARCHITECT PRIOR TO ANY EXCAVATION.
 - ALL DISTURBED AREAS TO BE RESTORED TO ORIGINAL CONDITION OR BETTER UNLESS OTHERWISE SPECIFIED.
 - ALL WORK SHALL BE IN ACCORDANCE WITH THE ONTARIO BUILDING CODE AND ALL SUPPLEMENTS AND APPLICABLE MUNICIPAL REGULATIONS.
 - ALL WORK SHALL BE IN ACCORDANCE WITH THE GEOTECHNICAL INVESTIGATION PREPARED BY PATERSON GROUP JANUARY 23, 2017.
 - THIS DRAWING IS TO BE READ IN CONJUNCTION WITH ALL OTHER PROJECT DRAWINGS AND SPECIFICATIONS.
 - ALL GENERAL SITE INFORMATION AND CONDITIONS SHOWN HAVE BEEN COMPILED FROM THE LATEST EXISTING PLANS, SURVEYS, AERIAL PHOTOS, AND LANDSCAPE ARCHITECT'S FIELD NOTES, SURVEY AND TOPOGRAPHICAL INFORMATION.
 - THIS DRAWING IS AN INSTRUMENT OF SERVICE AND REQUIRES THE PERMISSION OF THE LANDSCAPE ARCHITECT FOR USE. COPYRIGHT IS RESERVED BY THE LANDSCAPE ARCHITECT THAT HAS STAMPED AND SIGNED THE DRAWINGS.
 - DRAWING MAY NOT BE USED FOR CONSTRUCTION UNTIL SIGNED BY THE LANDSCAPE ARCHITECT, AS ISSUED FOR CONSTRUCTION.
 - ALL DIMENSIONS IN MILLIMETERS UNLESS OTHERWISE NOTED.
 - DO NOT SCALE DRAWING.

REVISIONS			
NO.	D/M/Y	MILESTONE / FAIT SAILLANT	FORMAT
3	12/19/2018	RE-ISSUED FOR SPA	PDF + HC
A	12/07/2018	ISSUED FOR PERMIT	PDF + HC
2	11/09/2018	RE-ISSUED FOR SPA	PDF + HC
1	10/08/2018	ISSUED FOR SPA	PDF + HC

RIOCAN CITY PARK PHASE 2

PROJECT / LOCATION :

2280 City Park Drive
OTTAWA, ONTARIO

DRAWING

FOTENN

Planning + Design

223 McLeod Street, Ottawa ON K2P 0Z8 613.730.5709 www.fotenn.com



SHEET TITLE

PHASE TWO DETAILS 1

REVIEWED	GH	DRAWING NO. L3-1
DRAWN	MD	
DATE	JULY 2018	
SCALE	1:200	

APPROVED
By mcewenje at 3:50 pm, Mar 18, 2019

JEFF MCEWEN P.ENG.
MANAGER, DEVELOPMENT REVIEW EAST BRANCH
PLANNING, INFRASTRUCTURE & ECONOMIC
DEVELOPMENT DEPARTMENT, CITY OF OTTAWA