

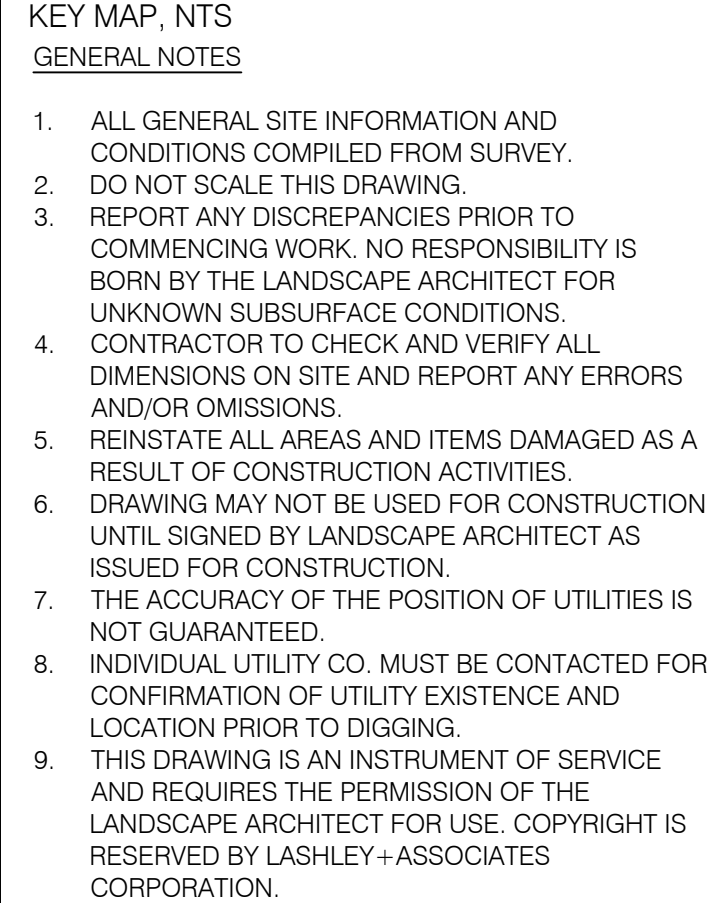

NOTES: THE FOLLOWING PROTECTION MEASURES MUST BE IMPLEMENTED FOR RETAINED TREES, BOTH WITHIN THE WORK AREA AND AN ADJACENT PARCELS.

1. UNDER THE GUIDANCE OF AN ARBORIST, ERECT A FENCE AT THE CRITICAL ROOT ZONE (CRZ) OF TREES WHERE THE CRZ IS ESTABLISHED AS BEING 100 CENTIMETERS FROM THE TRUNK FOR EVERY CIRCUMFERENCE OF TRUNK DIAMETER BY THE TRUNK.
2. TREE PROTECTION SHALL BE ERECTED TO PROVIDE A CONTINUOUS BARRICADE BETWEEN DESIGNATED TREES AND THE WORK AREA PRIOR TO CONSTRUCTION.
3. TUNNEL OR BORE WHEN DIGGING WITHIN THE CRZ OF A TREE.
4. ENSURE ALL EQUIPMENT AND CONSTRUCTION RELATED MATERIAL ARE NOT PLACED OR TEMPORARILY STORED WITHIN THE CRZ.
5. ENSURE EXHAUST FUMES FROM ALL EQUIPMENT ARE NOT DIRECTED TOWARDS ANY TREE'S CANOPY.
6. FLOODING OR DEPOSITION OF SEDIMENT SHALL BE PREVENTED WHERE TREES ARE LOCATED.
7. ALL DISTURBED ROOT SYSTEMS SHALL BE EXPOSED AND BACKFILLED IN ONE CONTINUOUS OPERATION TO MINIMIZE EXPOSURE.
8. EXPOSED ROOTS SHALL BE KEPT CONTINUOUSLY MOIST DURING EXCAVATION.
9. REMOVE BROKEN AND DAMAGED ROOTS WITH SHARP PRUNING SHEARS.
10. THE TREE PROTECTION FENCE IS TEMPORARY, SHALL BE MAINTAINED AT ALL TIMES DURING CONSTRUCTION OPERATIONS, AND SHALL BE REMOVED UPON COMPLETION OF WORK WHEN AGREED TO BY THE CONTRACT ADMINISTRATOR AND LANDSCAPE ARCHITECT.

STATED/ AUTHORIZED TREE PROTECTION FENCE BEYOND CRITICAL ROOT ZONE
UNLESS AUTHORED BY THE CONTRACT ADMINISTRATOR AND LANDSCAPE ARCHITECT

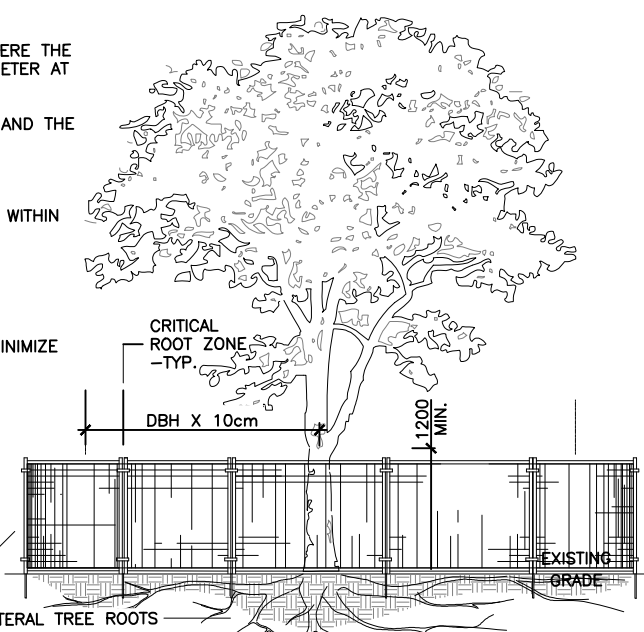

TREE PRESERVATION, PROTECTION & REMOVAL NOTES			
1.	ALL EXISTING TREES TO REMAIN SHALL BE PROTECTED FROM DAMAGE DURING CONSTRUCTION BY MAINTAINING A PROTECTION FENCE AT THE CRITICAL ROOT ZONE OF THE TREE OR GROUP OF TREES.		
	-CRZ: DIAMETER OF TRUNK IN CM MULTIPLIED BY 10CM		
2.	STORAGE OF MATERIALS AND/OR EQUIPMENT IS PROHIBITED WITHIN THE DRIP LINE OF ALL EXISTING TREES TO REMAIN.		
3.	CONTRACTOR MUST COMPLY WITH THE MIGRATORY BIRDS CONVENTION ACT (MBCA), 1994 AND REGULATIONS.		
4.	TREES NOTED FOR REMOVAL MUST BE CUT OUTSIDE OF BIRD NESTING SEASON.		
5.	BIRD NESTING SEASON: APRIL 1ST UNTIL AUGUST 31ST.		
2	2019/ 02/ 21	ISSUED FOR SITE PLAN APPLICATION REVIEW	
1	2018/ 05/ 28	ISSUED FOR SITE PLAN APPLICATION	

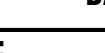
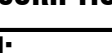
NO.	DATE	DESCRIPTION
SEAL:		NORTH:
		

**LASHLEY
+ ASSOCIATES**
LANDSCAPE ARCHITECTURE
AND SITE ENGINEERING

202-250 GLADSTONE AVENUE
OTTAWA, ON K1Y 3E6

T 613 233 8579
F 613 233 4051

W LashleyLA.com

PROJECT:

HAZELDEAN PLAZA

6150 HAZELDEAN ROAD
OTTAWA, ON

CAPITAL COMMERCIAL
1505 CARLING AVENUE
OTTAWA, ON K1Z 7L9

DRAWING TITLE: _____

LANDSCAPE SITE PLAN

DATE:	2018/05/22	DRAWING NO.: L-101
SCALE:	1:250	
DRAWN BY:	S.G.	
LA PROJECT NO.	18705-1	

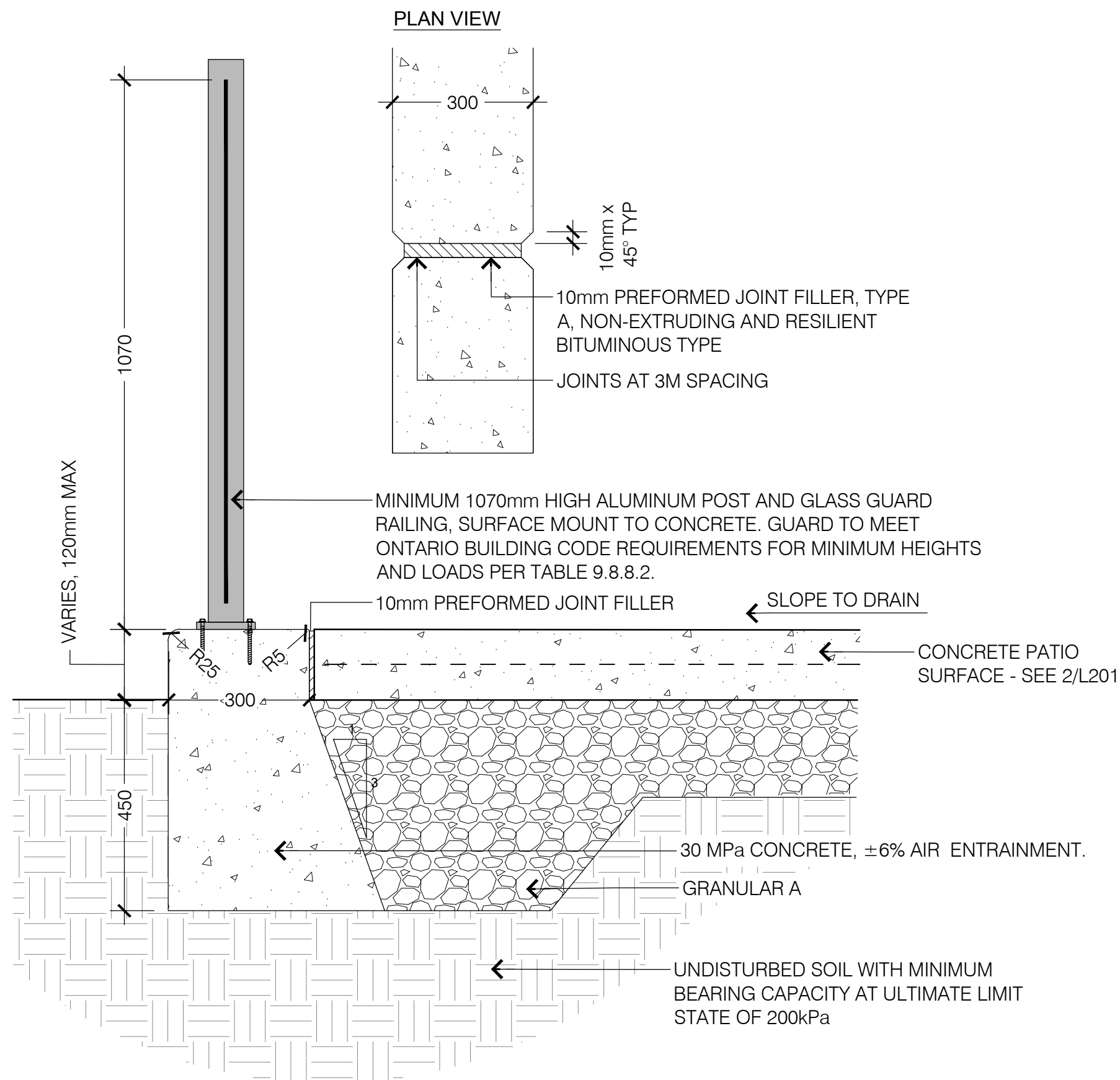

1
L201

CONCRETE RETAINING WALL AND GUARD

1:10

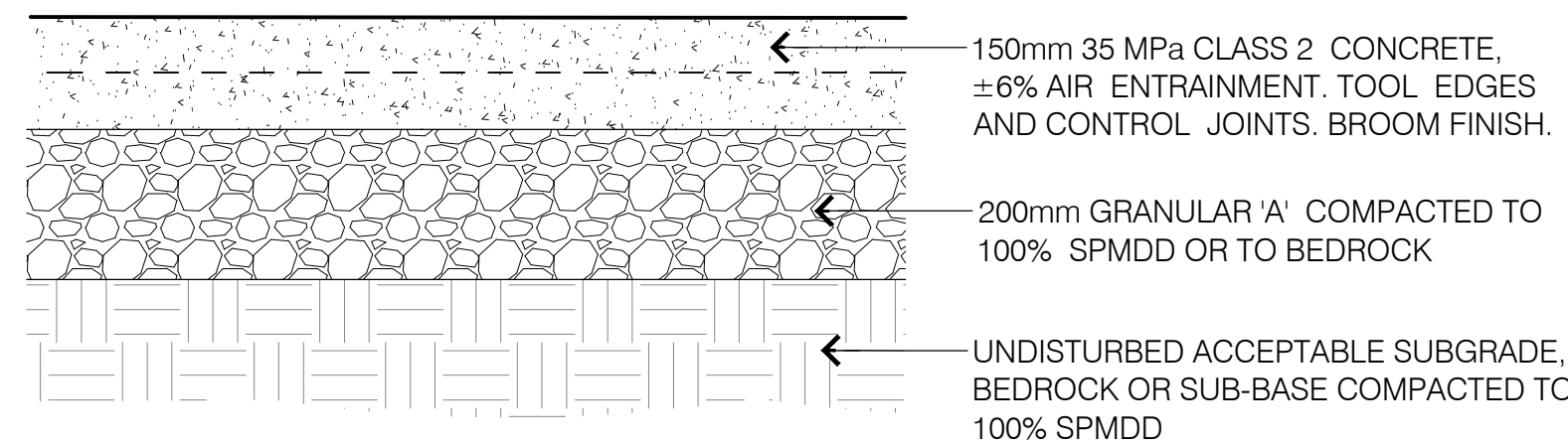

2
L201

CONCRETE PATIO SURFACING

1:10

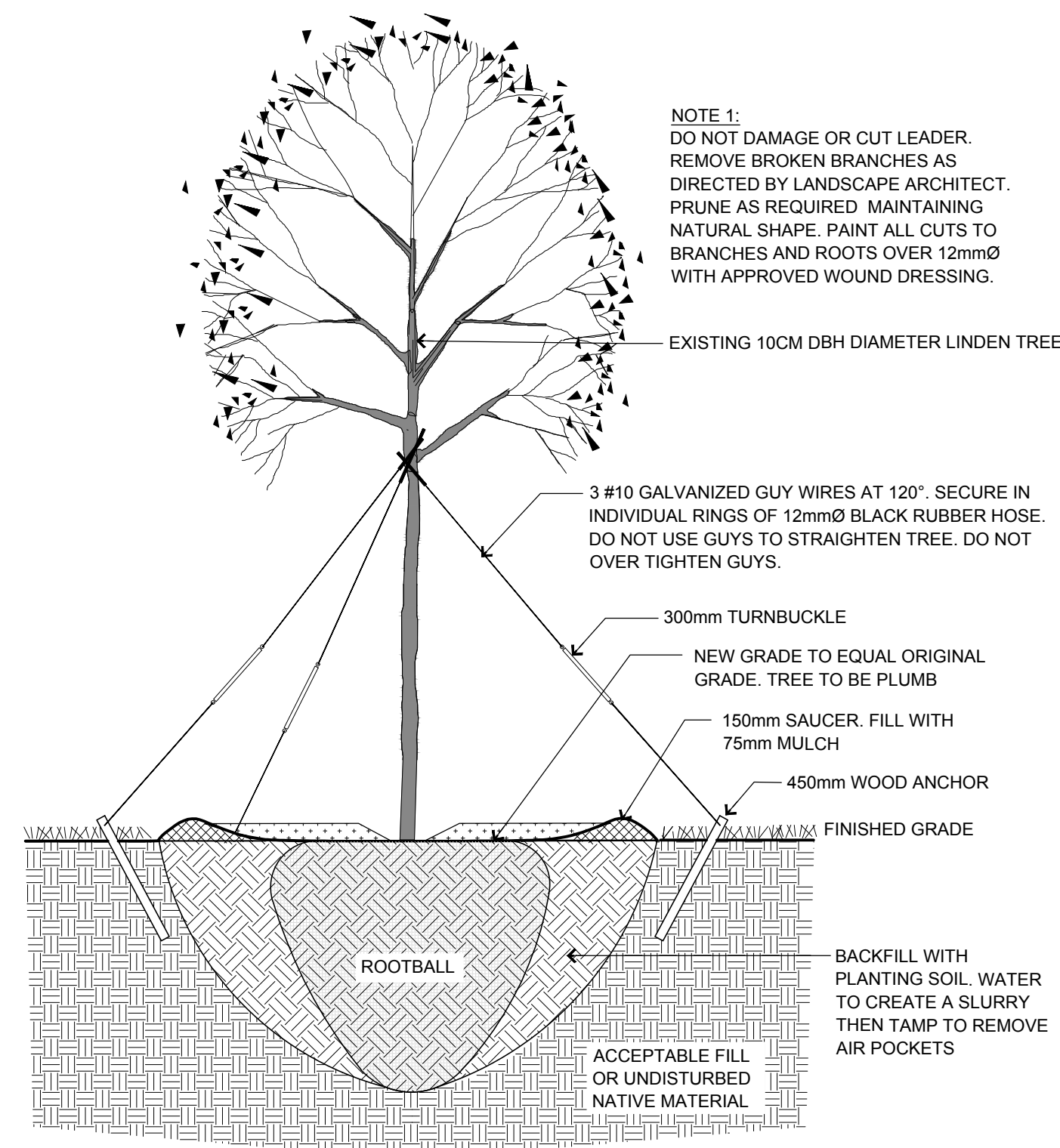

3
L201

TREE TRANSPLANT

1:40

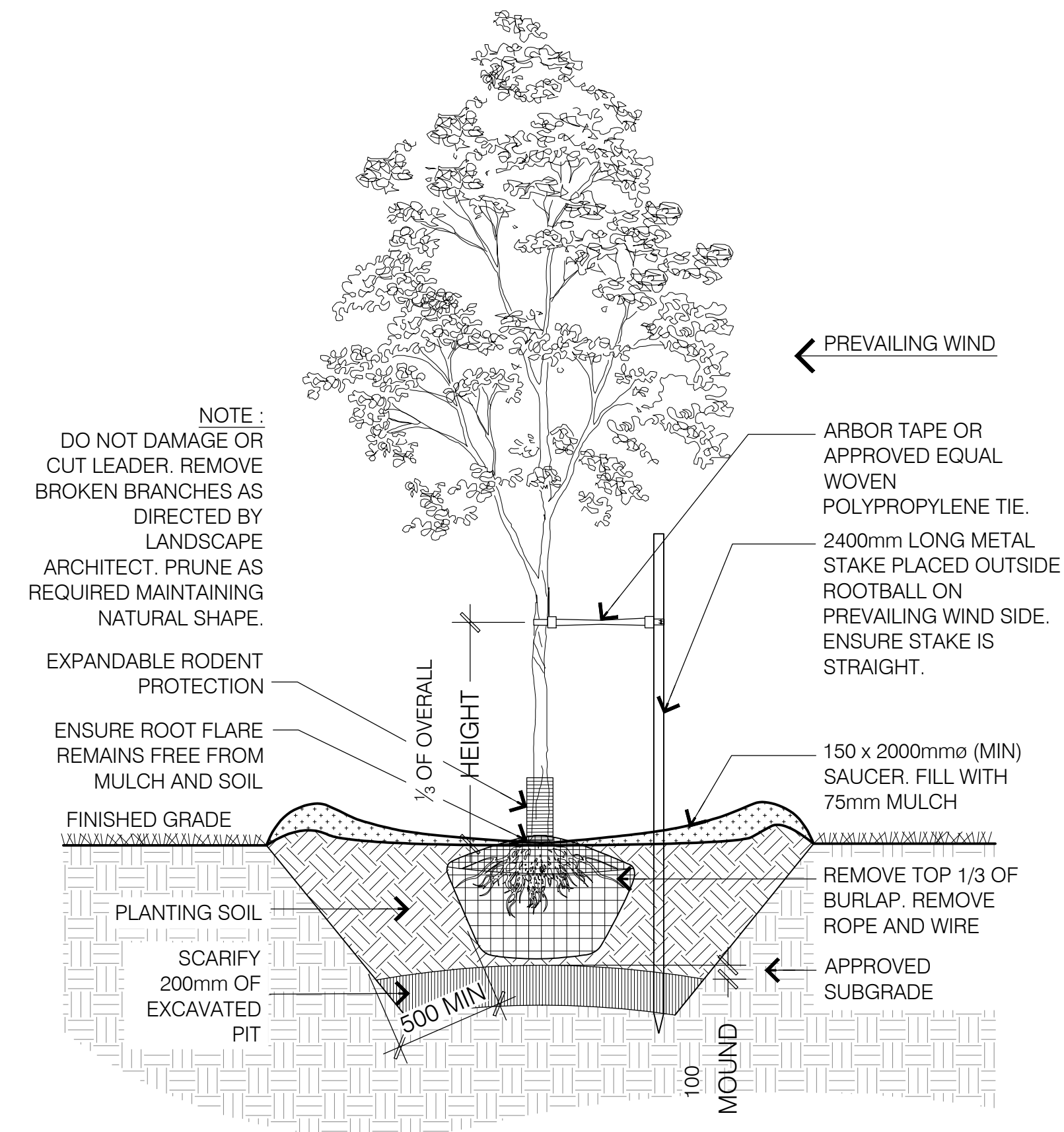

4
L201

DECIDUOUS TREE PLANTING

NTS

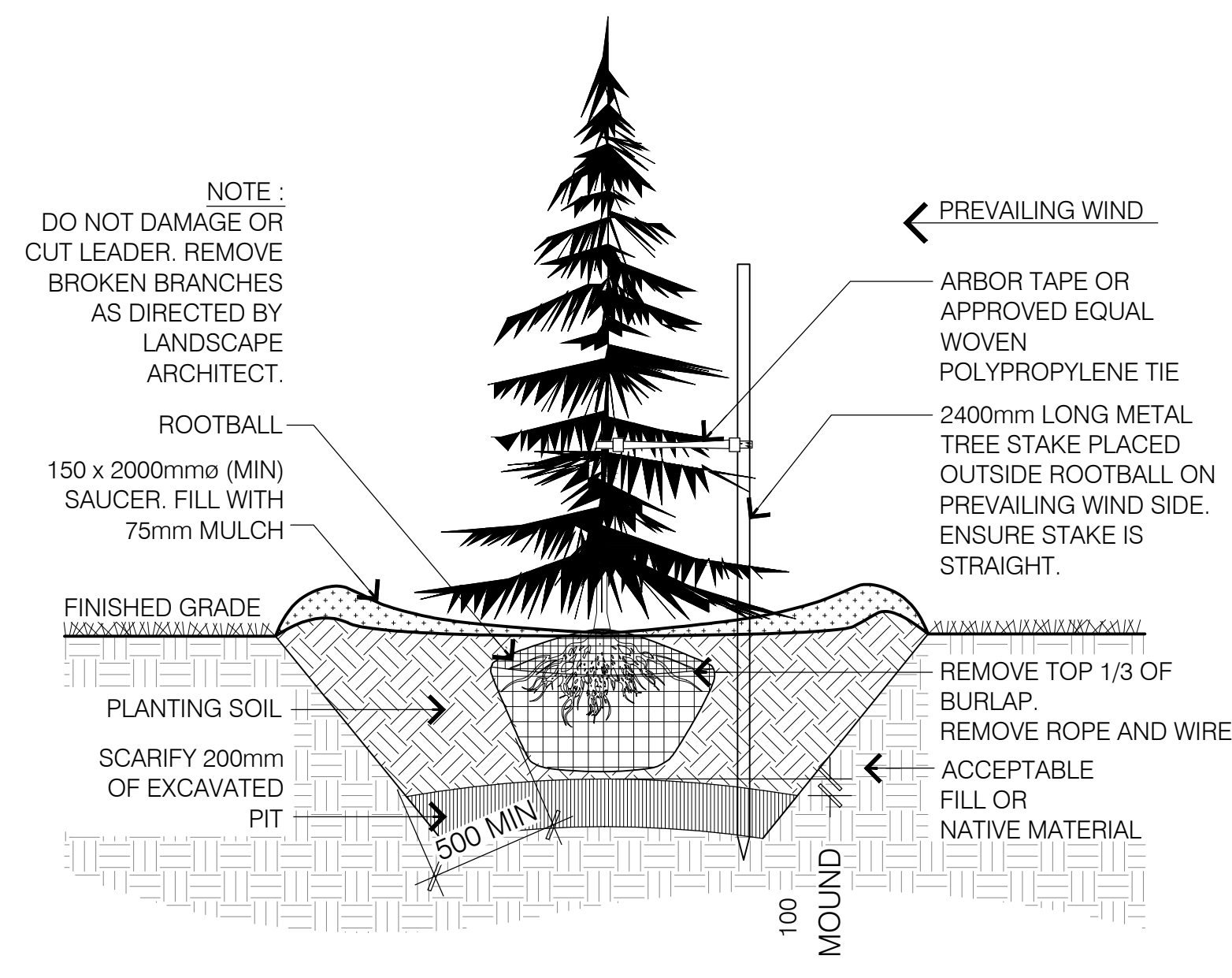

5
L201

CONIFEROUS TREE PLANTING

NTS

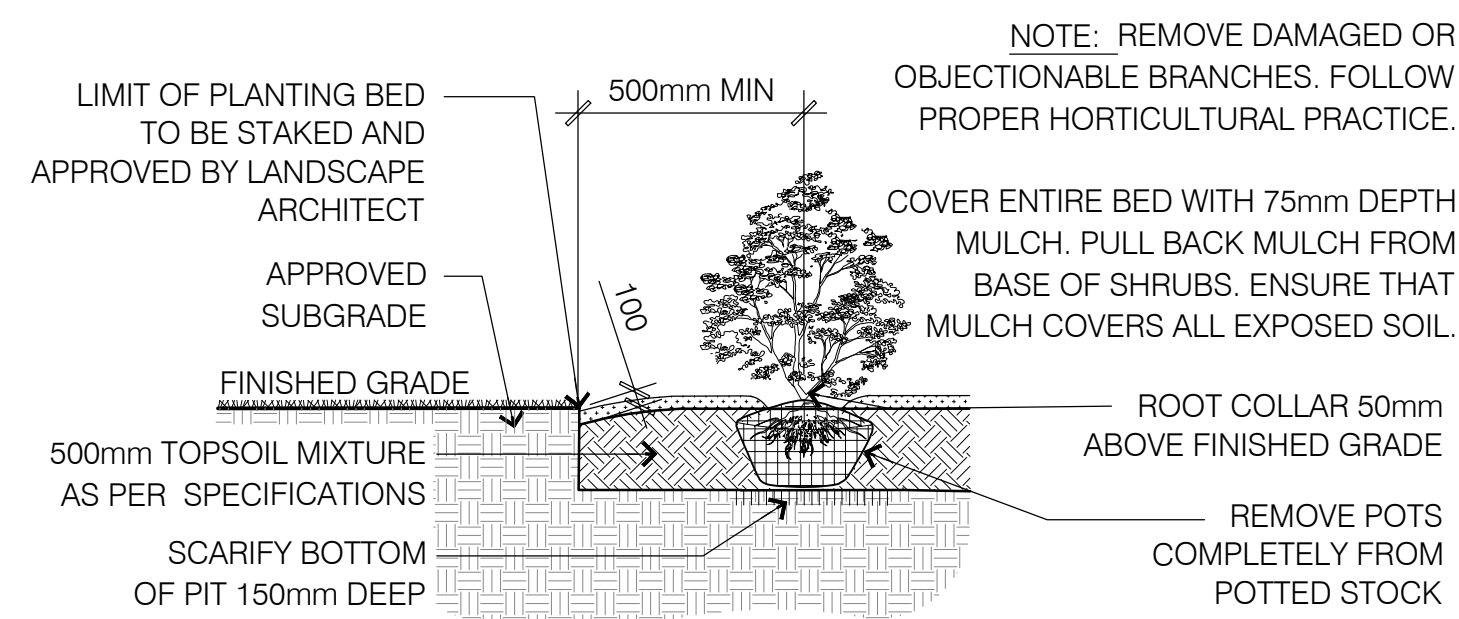

6
L201

CONTINUOUS SHRUB BED PLANTING

NTS

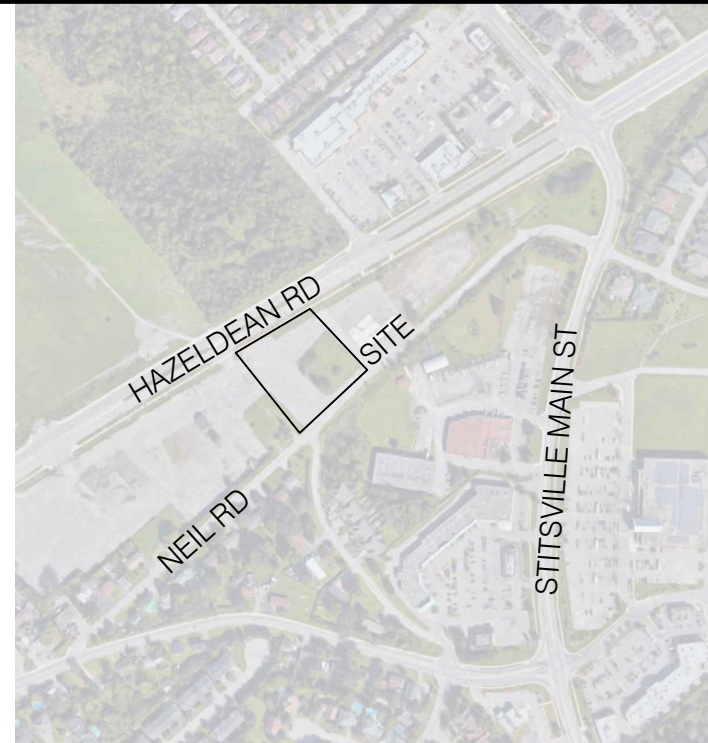

KEY MAP, NTS

GENERAL NOTES

1. ALL GENERAL SITE INFORMATION AND CONDITIONS COMPILED FROM SURVEY. DO NOT SCALE THIS DRAWING.
2. REPORT ANY DISCREPANCIES PRIOR TO COMMENCING WORK. NO RESPONSIBILITY IS BORN BY THE LANDSCAPE ARCHITECT FOR UNKNOWN SUBSURFACE CONDITIONS.
3. CONTRACTOR TO CHECK AND VERIFY ALL DIMENSIONS ON SITE AND REPORT ANY ERRORS AND/OR OMISSIONS.
4. REINSTATE ALL AREAS AND ITEMS DAMAGED AS A RESULT OF CONSTRUCTION ACTIVITIES.
5. DRAWING MAY NOT BE USED FOR CONSTRUCTION UNTIL SIGNED BY LANDSCAPE ARCHITECT AS ISSUED FOR CONSTRUCTION.
6. THE ACCURACY OF THE POSITION OF UTILITIES IS NOT GUARANTEED.
7. INDIVIDUAL UTILITY CO. MUST BE CONTACTED FOR CONFIRMATION OF UTILITY EXISTENCE AND LOCATION PRIOR TO DIGGING.
8. THIS DRAWING IS AN INSTRUMENT OF SERVICE AND REQUIRES THE PERMISSION OF THE LANDSCAPE ARCHITECT FOR USE. COPYRIGHT IS RESERVED BY LASHLEY+ASSOCIATES CORPORATION.

2	2019/ 02/ 21	ISSUED FOR SITE PLAN APPLICATION REV01
1	2018/ 05/ 28	ISSUED FOR SITE PLAN APPLICATION

NO.	DATE	DESCRIPTION
SEAL:		
NORTH:		
PROJECT:		
HAZELDEAN PLAZA 6150 HAZELDEAN ROAD OTTAWA, ON		
CAPITAL COMMERCIAL 1505 CARLING AVENUE OTTAWA, ON K1Z 7L9		
DRAWING TITLE:		
LANDSCAPE DETAILS		
DATE: 2018/05/22 DRAWING NO.:		
SCALE: 1:250 S.G.		
DRAWN BY: S.G. L-201		
LA PROJECT NO. 18705-1		