

KEY	NAME	SIZE HT/SPR	COND	QUAN
AS	ACER SACCHARUM SUGAR MAPLE	75 mm cal	W/B	5
JS	JUNIPERUS SABINA SAVIN JUNIPER	500 mm spread	POT	36
GT	QUERCUS TRACANTHUS SHAGBARK HICKORY	70 mm cal	W/B	4
PP	PICEA PUNGENS GREEN COLORADO SPRUCE	2000 mm high	W/B	7
PS	PINUS SYLVESTRIS SCOTTS PINE	2000 mm high	W/B	6
PST	PINUS STROBUS WHITE PINE	2000 mm high	W/B	3
SR	STRONGIA RETICULATA JAPANESE TREE LILAC	50 mm cal	W/B	4

PLANTING LIST

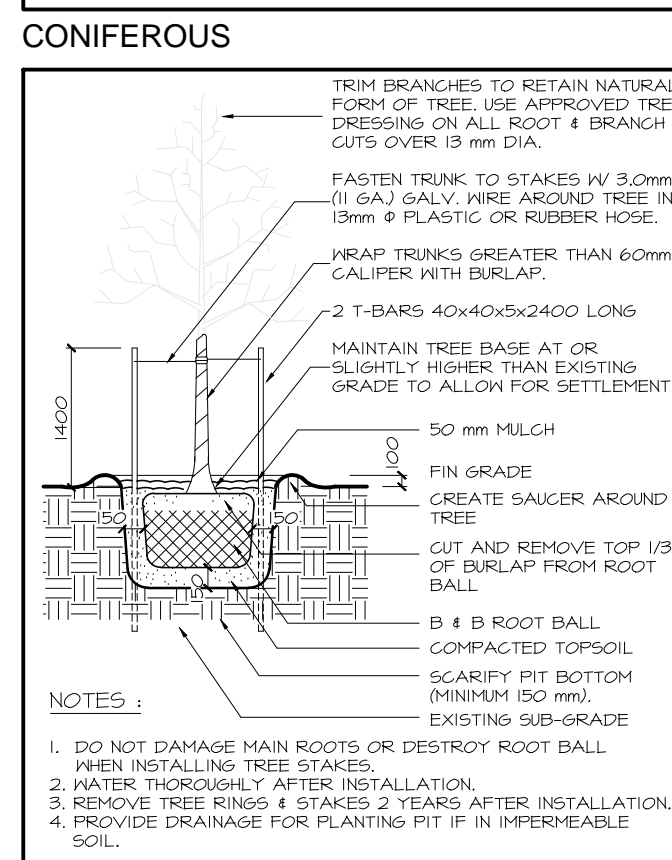
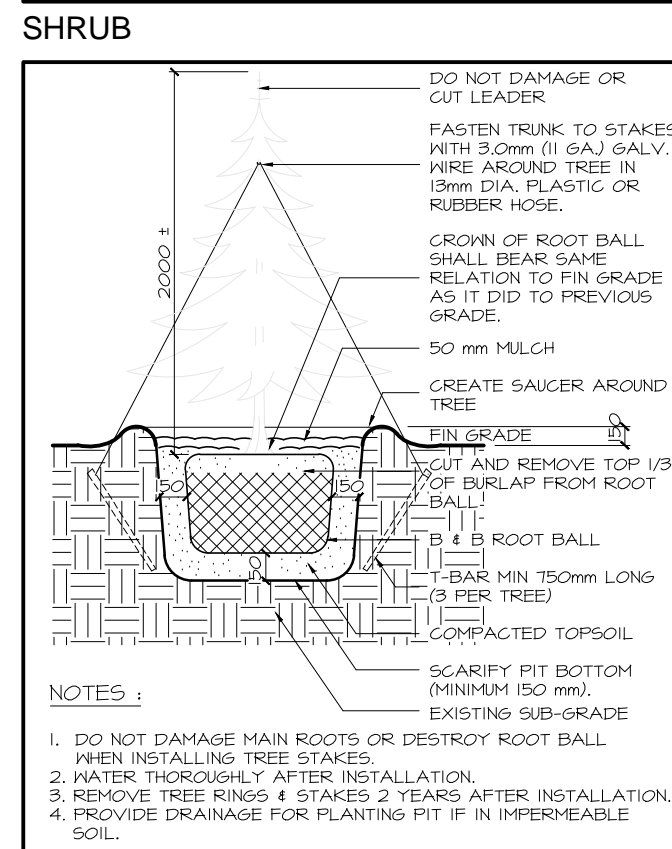
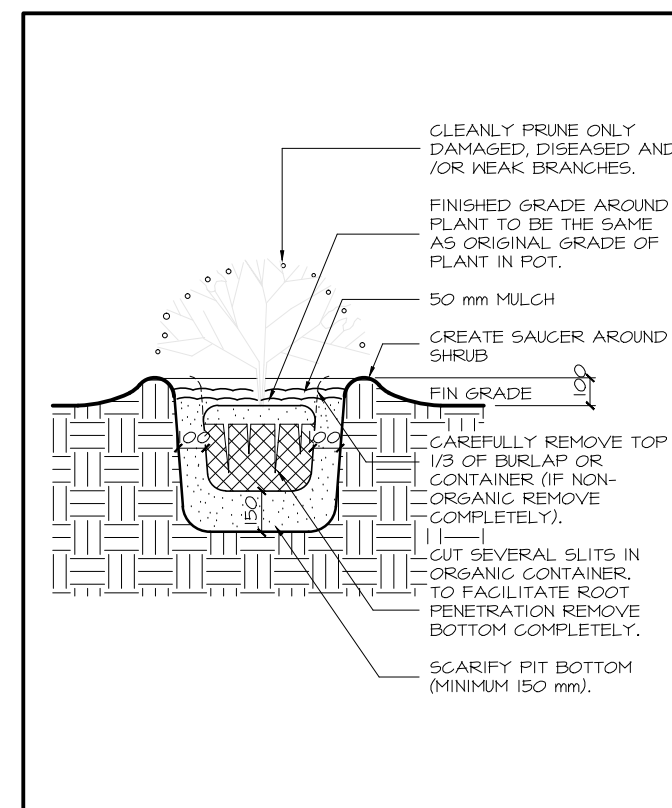

DECIDUOUS

A PLANTING DETAILS
A1.1 | 1:50

BUILDING STATISTICS:

BLDG FOOTPRINT	=	4991.5 SQ. M. 11.8 % COVERAGE
BLDG AREA	=	OFFICE AREA GROUND FLR 296 SQ. M.
	=	INDUSTRIAL AREA GROUND FLR 4645.5 SQ. M.
	=	TOTAL GROSS FLOOR AREA 4941.5 SQ. M.

BLDG HEIGHT = +/- 4.83 M

SITE STATISTICS:

CURRENT ZONING = R6 [184] PROPOSED USE: TRUCK DOCK TRANSFER FACILITY

LOT AREA = 42,066 SQ. M. (10.39 acres)

SETBACKS	front yd	15m
	corner side yd	12m
	interior yd	8m

(this zone abuts an RU zone)

PROP YD	max bldg height	15m
	max lot coverage	50%

AREA OF:

ASPHALT PAVEMENT	3,181	SQ.M.
CONCRETE APRONS, PADS	4,116	SQ.M.
GRANULARS	10,592	SQ.M.
SIDEWALKS	306	SQ.M.
SOD, PLANTERS	11,074	SQ.M.

PARKING (AREA D' ON SCHEDULE IA)

TYPICAL PARKING STALL TO BE 2.6 m WIDE x 5.2 m IN LENGTH

TYP. HANDICAPPED PARKING STALL TO BE 3.6 m WIDE x 5.2 m IN LENGTH

OFFICE SPACE	24 PER 100 SQ. M. 6.5A	1 SPACES REQUIRED
INDUSTRIAL SPACE	3 PER 100 SQ. M. 6.F.A	30 SPACES REQUIRED

TOTAL 45 SPACES REQUIRED AND 52 SPACES ARE PROVIDED INCLUDING 2 H/C SPACES

BICYCLE PARKING 4 SPACES PROVIDED

TYPICAL BICYCLE PARKING STALL TO BE 0.6 m WIDE x 1.8 m IN LENGTH

LOADING SPACE (AREA D' ON SCHEDULE IA)

UNDER 500 SQ. M, 1 SPACE REQUIRED AND 0 OVERSIZED SPACES ARE REQUIRED

LOADING SPACE TO BE 3.5 x 7 m

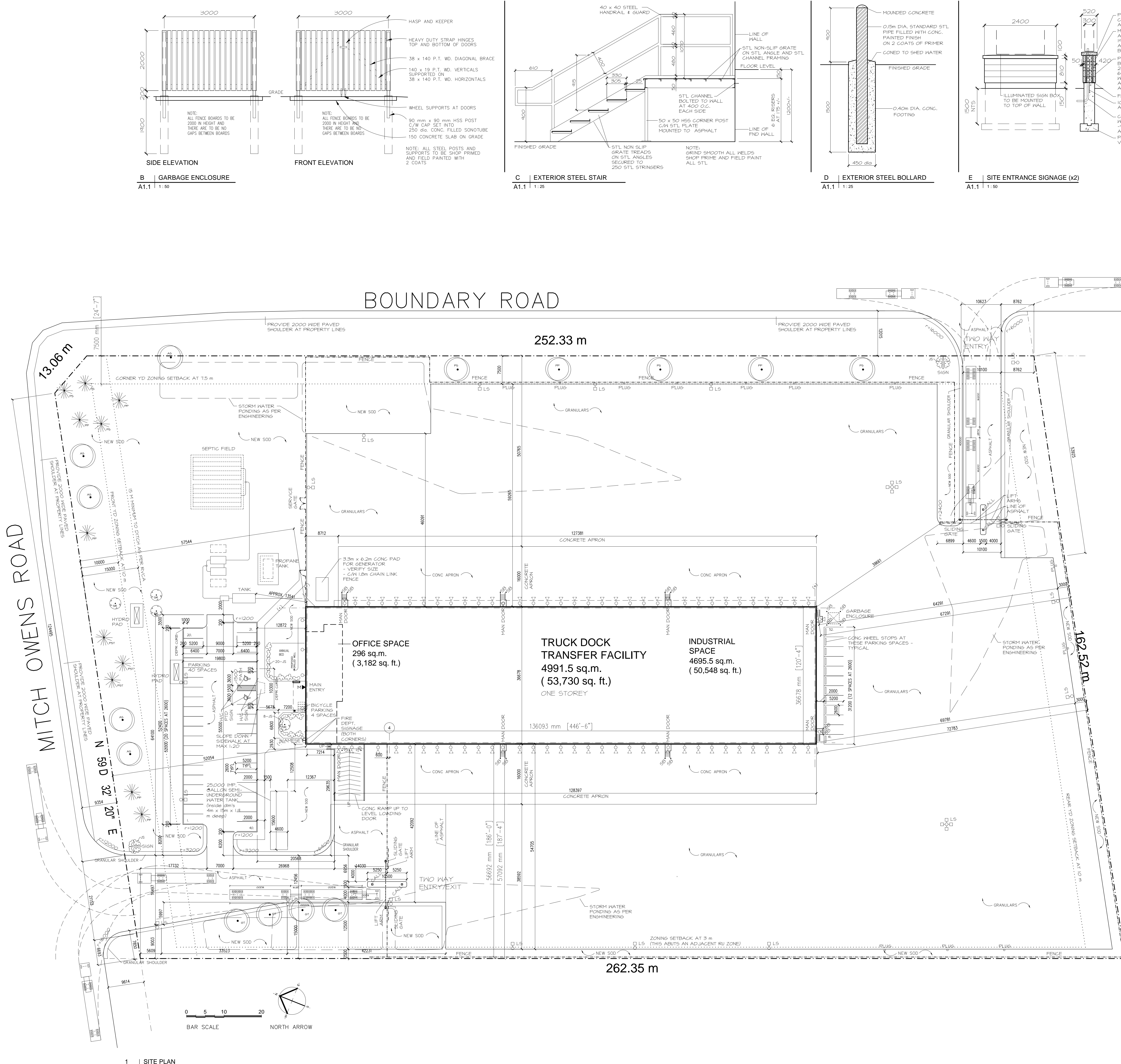

1 SITE PLAN
A1.1 | 1:400 metric

B GARBAGE ENCLOSURE
A1.1 | 1:50

C EXTERIOR STEEL STAIR
A1.1 | 1:25

D EXTERIOR STEEL BOLLARD
A1.1 | 1:25

E SITE ENTRANCE SIGNAGE (x2)
A1.1 | 1:50

j. guy monette
architecture and urban design
308a fairmont ave. ottawa, on, K1Y 1Y8
613.659.6483 guymonette@rogers.com

SURVEY INFORMATION
SURVEY INFORMATION TAKEN FROM PLAN 4E-8152
DATED JUN 15, 1992
PART OF LOT 1 CONGRESSION II TOWNSHIP OF OSSEOUE REGIONAL MUNICIPALITY OF OTTAWA CARLETON
H.A. KEN SHIPMAN SURVEYING LTD 1992

- LEGEND:**
- 2" DENOTES STALL NUMBER
 - H/C DENOTES HANDICAPPED STALL
 - M MAIN ENTRY
 - MAN DOOR SECONDARY ENTRANCES
 - OVERHEAD DOOR LOCATION
 - STEEL BOLLARD
 - PROPERTY LINE
 - ZONING SETBACKS
 - FENCE LINE
 - LIFT ARMS
 - ENTRY/EXIT CALL FOR GATE ACCESS
 - L5 LIGHT STANDARD
 - L6 LIGHT STANDARD
 - PLUS-IN BOLLARDS
 - MALL LIGHT

REVISION	No	DATE	PAR
Issued for Site Plan Control w/ Revisions	1	4Mar2019	bjs
Issued for Site Plan Control	0	17Dec2018	bjs

It is the responsibility of the appropriate Contractor to check and verify all dimensions on site and report all errors and/or omissions to the Architect.

All Contractors must comply with all pertinent codes and by-laws.

Do not scale drawings.

This drawing may not be used for construction until signed.

Architect's copyright reserved.

PROPOSED TRUCK DOCK TRANSFER FACILITY

9460 Mitch Owens; 5606,5630,5592 Boundary Road
Ottawa, ON

SITE PLAN LANDSCAPE PLAN

D07-14-18-0006

DESIGNED BY Brian Sindall	CHECKED BY GUY MONETTE
DRAWN BY STAFF	SCALE As Noted
PROJECT No.	DRAWING No.

2018-00 **A1.1**