

368 Chapel Street

*DJL*

DOUGLAS JAMES, MCP, RPP  
MANAGER, DEVELOPMENT REVIEW - CENTRAL  
PLANNING, INFRASTRUCTURE & ECONOMIC  
DEVELOPMENT DEPARTMENT, CITY OF OTTAWA

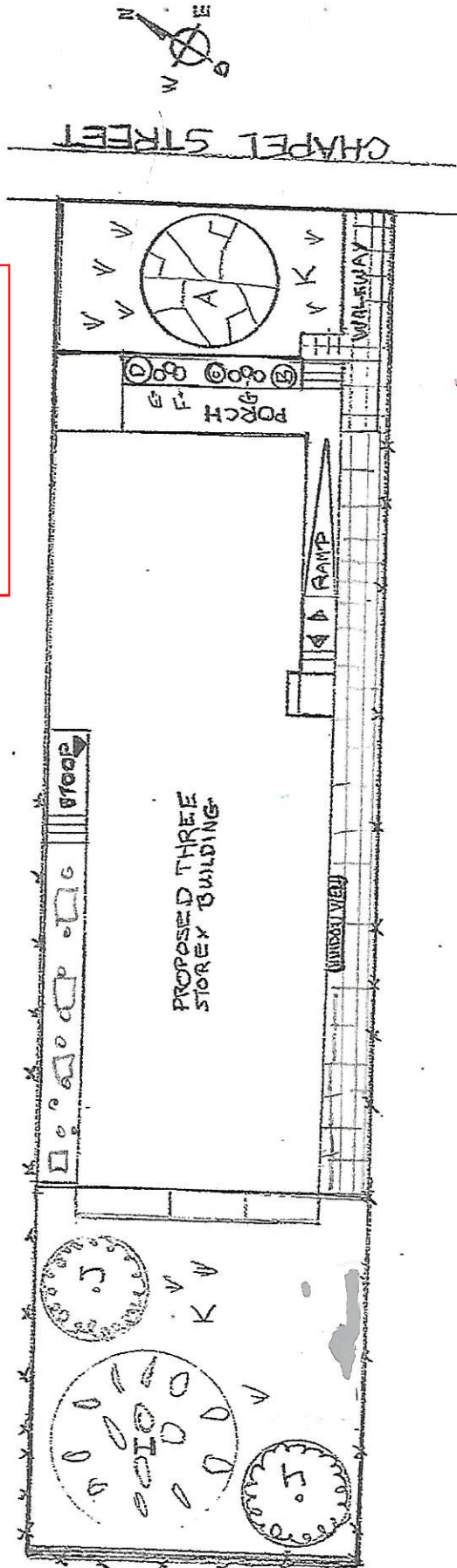

FEB. 8, 2013

## LANDSCAPE DESIGN

### Plant Material

- A Ginkgo biloba 'Princeton Sentry' x1
- B Acer Palmatum 'Bloodgood' x1
- C Rhododendron 'PJM' x1
- D Viburnum Plicatum x1
- E Heuchera sp. (peach colour) x3
- F Sedum 'Autumn Joy' x1
- G Hemeracallis sp. (purple and yellow colour) x5
- H Allium 'Purple Sensation' x1
- I Gladiolus triancanthos 'Sunburst' x 1
- J Cornus racemosa x 2
- K Sod for front and backyard

### Hardscape Material

- Interlocking Stone for pathway
- Decorative Pea gravel (1/8" to 3/8" in size) in beds and side of house
- 3x Limestone rocks (2' to 3' rectangular size)
- Fence for sideyard (5' to 7' ht)

# Tree Planting Detail

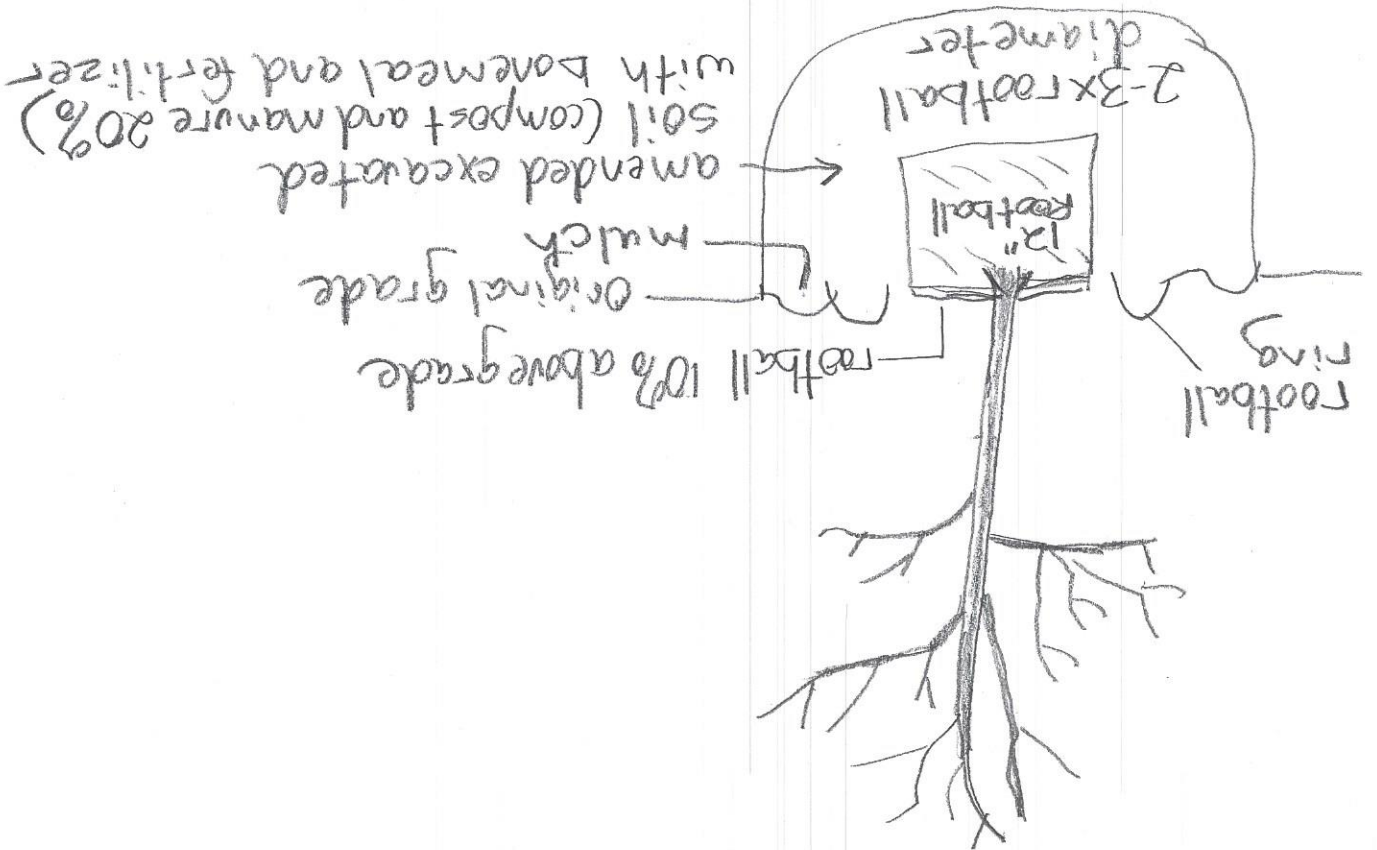

## Interlock Detail

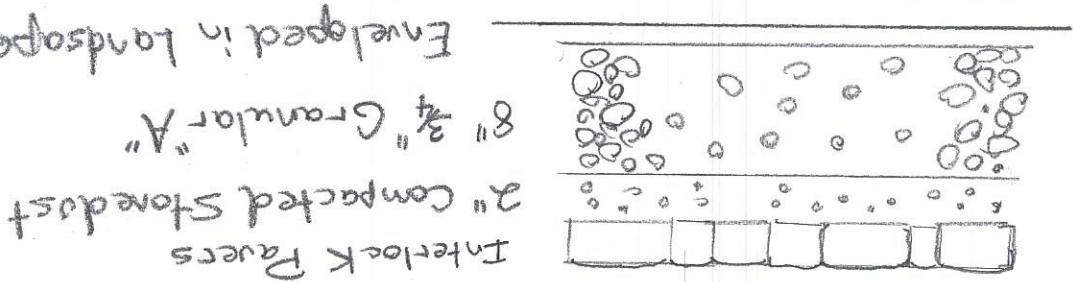

## Concrete Pad Detail

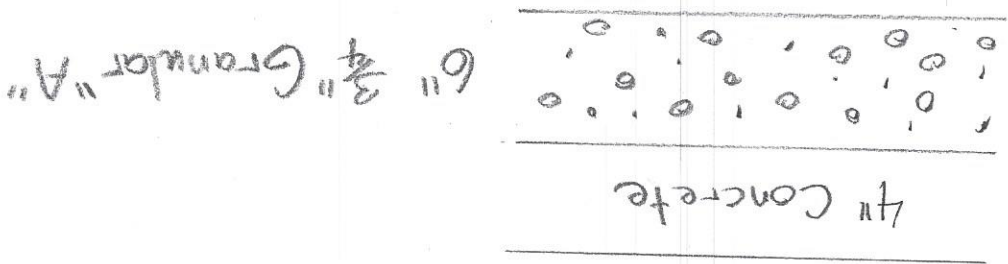

# Wooden Fence Detail

