

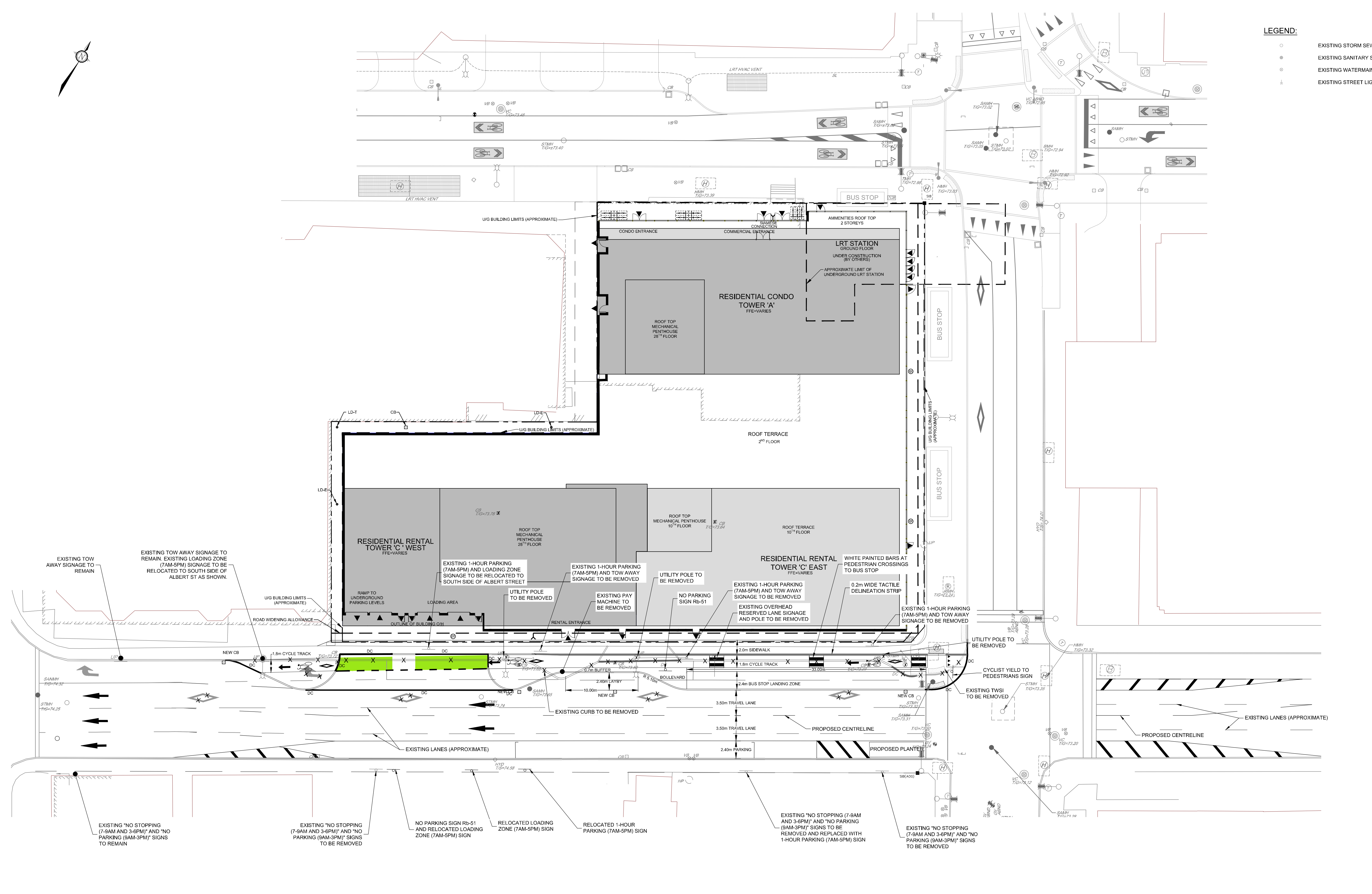

- LEGEND:**
- EXISTING STORM SEWER MANHOLE
  - EXISTING SANITARY SEWER MANHOLE
  - ⊙ EXISTING WATERMAIN VALVE
  - ⊥ EXISTING STREET LIGHT



**NOTE:**  
 THE POSITION OF ALL POLE LINES, CONDUITS, WATERMANS, SEWERS AND OTHER UNDERGROUND AND OVERGROUND UTILITIES AND STRUCTURES IS NOT NECESSARILY SHOWN ON THE CONTRACT DRAWINGS, AND WHERE SHOWN, THE ACCURACY OF THE POSITION OF SUCH UTILITIES AND STRUCTURES IS NOT GUARANTEED. BEFORE STARTING WORK, DETERMINE THE EXACT LOCATION OF ALL SUCH UTILITIES AND STRUCTURES AND ASSUME ALL LIABILITY FOR DAMAGE TO THEM.

No.	REVISION	DATE	BY
2.	ISSUED FOR SITE PLAN APPLICATION	FEB 14/2019	GJM
1.	DRAFT FOR COORDINATION	FEB 1/2019	JL

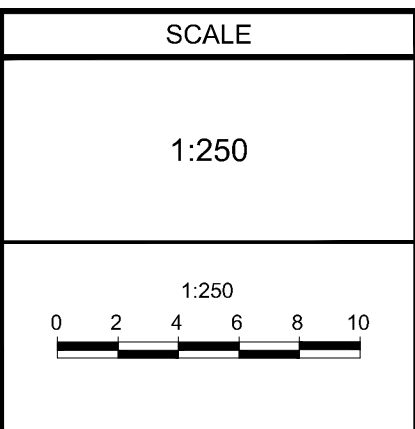

DESIGN	LGB
CHECKED	JLL
DRAWN	LGB
CHECKED	JLL
APPROVED	JL
	GJM

**FOR REVIEW ONLY**

**NOVATECH**  
 Engineers, Planners & Landscape Architects  
 Suite 200, 240 Michael Cowpland Drive  
 Ottawa, Ontario, Canada K2M 1P6  
 Telephone (613) 254-9643  
 Facsimile (613) 254-5867  
 Website www.novatech-eng.com

**LOCATION**  
 CITY OF OTTAWA  
 383 ALBERT ST & 340 QUEEN ST

**DRAWING NAME**  
 FUNCTIONAL DESIGN  
 (ULTIMATE)

PROJECT No.	109111-00
DATE	FEBRUARY 2019
DRAWING No.	109111-FD

M:\2009\109111\FD\109111-FD.dwg, 109111-FD, Feb 14, 2019 - 3:12pm, mason@j