

1. THE ORIGINAL TOPOGRAPHY, GROUND ELEVATION AND SURVEY DATA SHOWN ARE PROVIDED FOR INFORMATION PURPOSES ONLY, AND IMPLY NO GUARANTEE OF ACCURACY. IT SHALL BE THE RESPONSIBILITY OF THE USER TO OBTAIN ALL INFORMATION SHOWN.
2. THIS PLAN IS NOT A CADASTRAL SURVEY SHOWING LEGAL PROPERTY BOUNDARIES AND EASEMENTS. THE PROPERTY BOUNDARIES SHOWN HEREON HAVE BEEN DERIVED INFORMATION SUPPLIED BY (OR SHOWN ON) FARLEY, SMITH & DENIS SURVEYING LTD. SURVEY PLAN #253-18-01, DATED JUNE 8, 2018 AND CANNOT BE RELIED UPON TO BE ACCURATE OR COMPLETE. THE PRECISE LOCATION OF THE CURRENT PROPERTY BOUNDARIES AND EASEMENTS CAN ONLY BE DETERMINED BY AN UP-TO-DATE LAND TITLES SEARCH AND A SUBSEQUENT CADASTRAL SURVEY PERFORMED AND CERTIFIED BY AN ONTARIO LAND SURVEYOR.
3. THE CONTRACTOR IS TO OBTAIN AND PAY FOR ALL NECESSARY PERMITS AND APPROVALS FROM THE CITY OR TOWNSHIP BEFORE COMMENCING CONSTRUCTION.
4. THE CONTRACTOR IS RESPONSIBLE FOR ALL LAYOUT.
5. THE CONTRACTOR IS TO DETERMINE THE EXACT LOCATION, SIZE, MATERIAL AND ELEVATION OF ALL EXISTING UTILITIES PRIOR TO COMMENCING CONSTRUCTION. PROTECT AND ASSUME ALL RESPONSIBILITY FOR EXISTING UTILITIES WHETHER OR NOT SHOWN ON THESE DRAWINGS. THE CONTRACTOR SHALL BE RESPONSIBLE FOR OBTAINING ALL NECESSARY ENGINEERING APPROVALS.
6. RESTORE ALL TRENCHES AND SURFACES OF PUBLIC ROAD ALLOWANCES TO CONDITION EQUAL OR BETTER THAN ORIGINAL CONDITION AND TO THE SATISFACTION OF THE CITY OR TOWNSHIP AUTHORITIES.
7. EXCAVATE AND DISPOSE OF ALL EXCESS EXCAVATED MATERIAL, SUCH AS ASPHALT, CURBING AND DEBRIS, OFF SITE AS DIRECTED BY THE ENGINEER AND THE CITY OR TOWNSHIP.
8. TOPSOIL TO BE STRIPPED AND STOCKPILED FOR REHABILITATION. CLEAN FILL TO BE PLACED IN FILL AREAS AND COMPACTED TO 95% STANDARD PROCTOR DENSITY.
9. ALL DISTURBED AREAS TO BE RESTORED TO ORIGINAL CONDITION OR BETTER UNLESS OTHERWISE SPECIFIED.
10. THE CONTRACTOR SHALL BE RESPONSIBLE FOR ALL TRAFFIC CONTROL AND SAFETY MEASURES DURING THE CONSTRUCTION PERIOD, INCLUDING THE CITY'S INSTALLATION, AND REMOVAL OF ALL NECESSARY SIGNAGE, DELINEATORS, MARKERS AND BARRIERS.
11. DO NOT ALTER GRADING OF THE SITE WITHOUT PRIOR APPROVAL OF THE CITY OR TOWNSHIP.
12. ALL ROADWAY, PARKING LOT AND GRADING WORKS TO BE UNDERTAKEN IN ACCORDANCE WITH CITY OR TOWNSHIP STANDARDS AND SPECIFICATIONS. THE CONTRACTOR IS TO PROVIDE POSITIVE DRAINAGE AWAY FROM THE BUILDING.
13. CONTACT THE CITY OR TOWNSHIP FOR INSPECTION OF ROUGH GRADING OF PARKING LOTS, ROADWAYS AND LANDSCAPED AREAS PRIOR TO PLACEMENT OF ASPHALT AND TOPSOIL. ALL GRADING SHALL BE TO THE SATISFACTION OF THE CITY OR TOWNSHIP ENGINEER PROMPTLY.
14. ALL DIMENSIONS AND INVERTS MUST BE VERIFIED PRIOR TO CONSTRUCTION, IF THERE IS ANY DISCREPANCY THE CONTRACTOR IS TO NOTIFY THE ENGINEER PROMPTLY.
15. ELECTRICAL, GAS, TELEPHONE AND TELEVISION SERVICE LOCATIONS ARE SUBJECT TO THE INDIVIDUAL AGENCY.
 - ELECTRICAL SERVICE - HYDRO ONTARIO,
 - GAS SERVICE - ENBRIDGE,
 - TELEPHONE SERVICE - BELL CANADA,
 - TELEVISION SERVICE - ROGERS.
17. INSTALLATION TO BE IN ACCORDANCE WITH CURRENT CODES AND STANDARDS OF APPROVAL AGENCIES HYDRO ONTARIO, BELL AND THE CITY OR TOWNSHIP.
18. ALL PROPOSED CURB SHALL BE CONCRETE BARRIER CURB UNLESS SPECIFIED.
19. ALL EXISTING REDUNDANT PRIVATE APPROACHES FRONTING THIS DEVELOPMENT MUST BE REMOVED TO THE SATISFACTION OF THE CITY OR TOWNSHIP.
20. THIS PLAN MUST BE READ IN CONJUNCTION WITH GEOTECHNICAL REPORT BY PATERSON GROUP INC. DATED JUNE 15, 2018 AND A SITE SPECIFIC TRAIL SERVING REPORT BY MONTGOMERY PERRY REPORT HCP-18-0254, DATED JUNE 22, 2018.

1. THE CONTRACTOR SHALL IMPLEMENT BEST MANAGEMENT PRACTICES, TO PROVIDE FOR PROTECTION OF THE AREA DRAINAGE SYSTEM AND THE RECEIVING WATERCOURSE, DURING ALL CONSTRUCTION ACTIVITIES. THE CONTRACTOR SHALL NOT USE OR EXPOSE SOD, TEMPORARY SEDIMENT CONTROL (GEOTEXTILES INSERTS WITH AN OVERFLOW UNDER GRADE OR SOD) TO BE IMPLEMENTED DURING CONSTRUCTION ON THE EXISTING WATERCOURSE, REARWARD CATCHBASINS AND CATCHBASIN MANHOLES, AND OTHER SEDIMENT TRAPS. NO RECYCLED GEOTEXTILE MATERIAL SHALL BE PERMITTED FOR USE ON SITE.
2. AT THE DISCRETION OF THE PROJECT MANAGER OR MUNICIPAL STAFF, ADDITIONAL SILT CONTROL DEVICES SHALL BE INSTALLED AT DESIGNATED LOCATIONS.
3. FOR SILT FENCE BARRIER, USE OPSD 219.110. GEOTEXTILE FOR SILT FENCE AS PER OPSD 1860, TABLE 3.
4. EXCEPT AS PROVIDED IN PARAGRAPHS 4.1., and 4.2. below, STABILIZATION MEASURES SHALL BE INSTALLED AS SOON AS POSSIBLE AFTER THE SITE WHERE CONSTRUCTION ACTIVITIES HAVE TEMPORARILY OR PERMANENTLY CEASED, BUT IN NO CASE MORE THAN 14 DAYS AFTER THE CONSTRUCTION ACTIVITY HAS TEMPORARILY OR PERMANENTLY CEASED.
- 4.1. FOR TEMPORARILY INTERRUPTED STABILIZATION MEASURES, THE CONTRACTOR SHALL CONSTRUCT AN ACTIVITY TEMPORARILY OR PERMANENTLY CEASED IS PRECELUDED BY SNOW COVER, STABILIZATION MEASURES SHALL BE INITIATED AS SOON AS FEASIBLE AFTER THE CONSTRUCTION ACTIVITY TEMPORARILY OR PERMANENTLY CEASED, WITHIN 21 DAYS FROM WHEN ACTIVITIES CEASED, (E.G. THE TOTAL TIME PERIOD THAT CONSTRUCTION ACTIVITY IS TEMPORARILY CEASED IS LESS THAN 21 DAYS) THEN STABILIZATION MEASURES SHALL BE INSTALLED AS SOON AS POSSIBLE AFTER THAT PORTION OF SITE BY THE 14TH DAY AFTER CONSTRUCTION ACTIVITY TEMPORARILY CEASED.
5. SEDIMENT THAT IS ACCUMULATED BY THE TEMPORARY EROSION AND SEDIMENT CONTROL MEASURES SHALL BE REMOVED IN A MANNER THAT AVOIDS ESCAPE OF THE SEDIMENT TO THE RECEIVING WATERCOURSE. THE SEDIMENT SHALL BE REMOVED TO THE LEVEL OF THE GRADE EXISTING AT THE TIME THE CONTROL MEASURE WAS CONSTRUCTED AND BE ACCORDING TO THE FOLLOWING:
 - 5.1. FOR EROSION CONTROL MEASURES, THE SEDIMENT SHALL BE REMOVED ONCE IT REACHES THE LESSER OF THE FOLLOWING:
 - 5.1.1. A DEPTH OF ONE-HALF THE EFFECTIVE HEIGHT OF THE CONTROL MEASURE.
 - 5.1.2. A DEPTH OF 300 MILLIMETRES (12 INCHES) FOR TEMPORARY MEASURES.
 - 5.2. FOR ALL CONTROL MEASURES, ACCUMULATED SEDIMENT SHALL BE REMOVED AS SOON AS FEASIBLE AFTER THE SEDIMENT HAS ACCUMULATED TO THE FOLLOWING:
 - 5.2.1. ACCUMULATED SEDIMENT SHALL BE REMOVED PRIOR TO THE REMOVAL OF THE CONTROL MEASURE.
- 5.4. ACCUMULATED SEDIMENT IS TO BE REMOVED AND DISPOSED OF AS PER OPSD 180.
6. AT TEMPORARY EROSION AND SEDIMENT CONTROL MEASURES SHALL BE MONITORED TO ENSURE THEY ARE IN EFFECTIVE WORKING ORDER. THE CONDITION OF THE CONTROL MEASURES SHALL BE MONITORED PRIOR TO ANY FORECAST STORM EVENT AND FOLLOWING A STORM EVENT.
7. DUST CONTROL MEASURES SHOULD BE CONSIDERED PRIOR TO CLEANING AND GRADING. THE DUST CONTROL MEASURES SHALL BE MAINTAINED THROUGHOUT THE CONSTRUCTION. FLAKES/SOLUTION SHALL BE USED AS DUST SUPPRESSANTS AS PER OPSD 506. THIS IS TO LIMIT WIND EROSION OF SOILS WHICH MAY TRANSPORT SEDIMENTS OFFSITE, WHEN THEY MAY BE WASHED INTO THE RECEIVING WATER BY THE NEXT RAINSTORM.
8. ALL "GREEN AREAS" TO BE TREATED WITH 150mm TOPSOIL AND SOD AS SOON AS FEASIBLE, AS PER OPSD 570.
9. TOPSOIL TO BE STRIPPED AND STOCKPILED FOR REHABILITATION. CLEAN FILL TO BE PLACED IN FILL AREAS AND COMPACTED TO 95% STANDARD PROCTOR DENSITY.
10. ALL DISTURBED AREA TO BE RESTORED TO ORIGINAL CONDITION OR BETTER UNLESS OTHERWISE SPECIFIED.
11. STOCKPILED MATERIAL IS TO BE STORED AWAY FROM POTENTIAL RECEIVERS (E.G. STORM CATCHBASINS, MANHOLES), AND BE SURROUNDED BY EROSION CONTROL MEASURES WHERE MATERIAL IS LEFT IN PLACE IN EXCESS OF 14 DAYS.
12. IF REQUIRED, DOWATERING/SETTLING BASINS SHALL BE CONSTRUCTED AS PER OPSD 219.240 AND LOCATED ON FLAT GRADE UPSTREAM OF OTHER EXISTING MITIGATION MEASURES. THE DOWATERING/SETTLING BASINS SHALL BE DESIGNED TO BE CAPABLE OF REMOVING SANDY WATERCOURSE CROSSINGS SHALL NOT BE CONSTRUCTED OR UTILIZED, UNLESS OTHERWISE SPECIFIED IN THE CONTRACT. IF CLOSURE OF ANY PERMANENT WATER PASSAGE IS NECESSARY, THE CONTRACTOR SHALL RELEASE ANY STRANDED FISH TO THE OPEN PORTION OF THE WATERCOURSE WITHIN FOUR HOURS.
13. ALL EROSION AND SEDIMENT CONTROL MEASURES SHALL CONFORM TO OPSD 577.
14. WHEN DOWATERING IS REQUIRED, THE DISCHARGED WATER SHALL BE CONTROLLED IN ACCORDANCE WITH OPSD 518.
15. ALL SETTLING/FILTRATION BASINS SHALL BE EQUIPPED WITH TERAFLEX 270R GEOTEXTILE (OR APPROVED EQUIVALENT) AND SHALL BE CLEANED AND REPLACED AS REQUIRED.

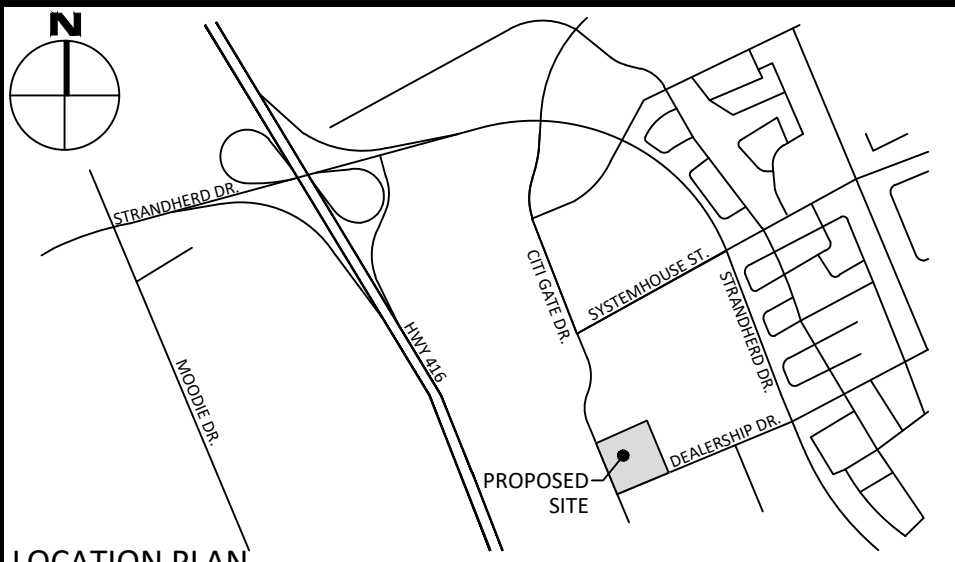
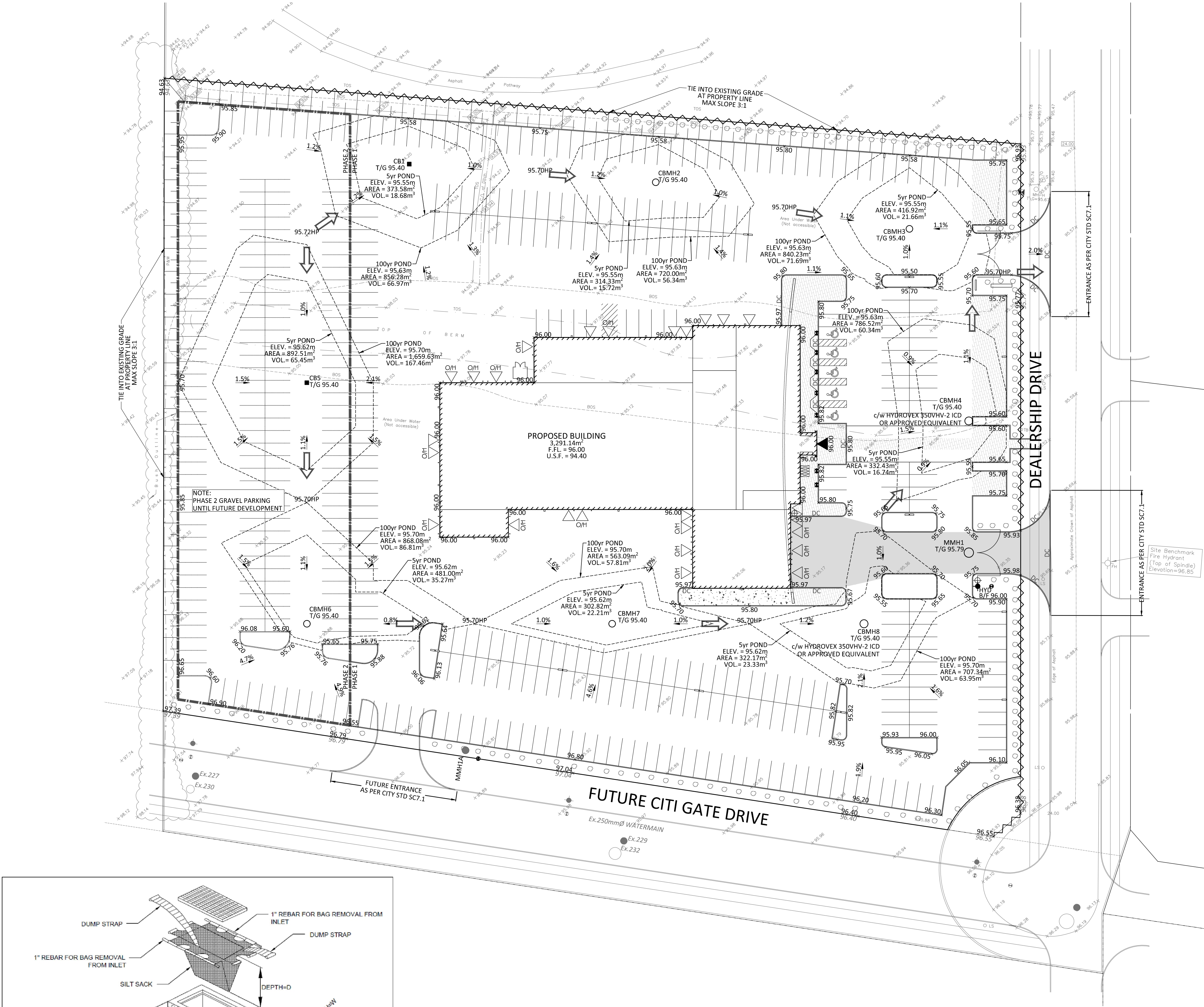
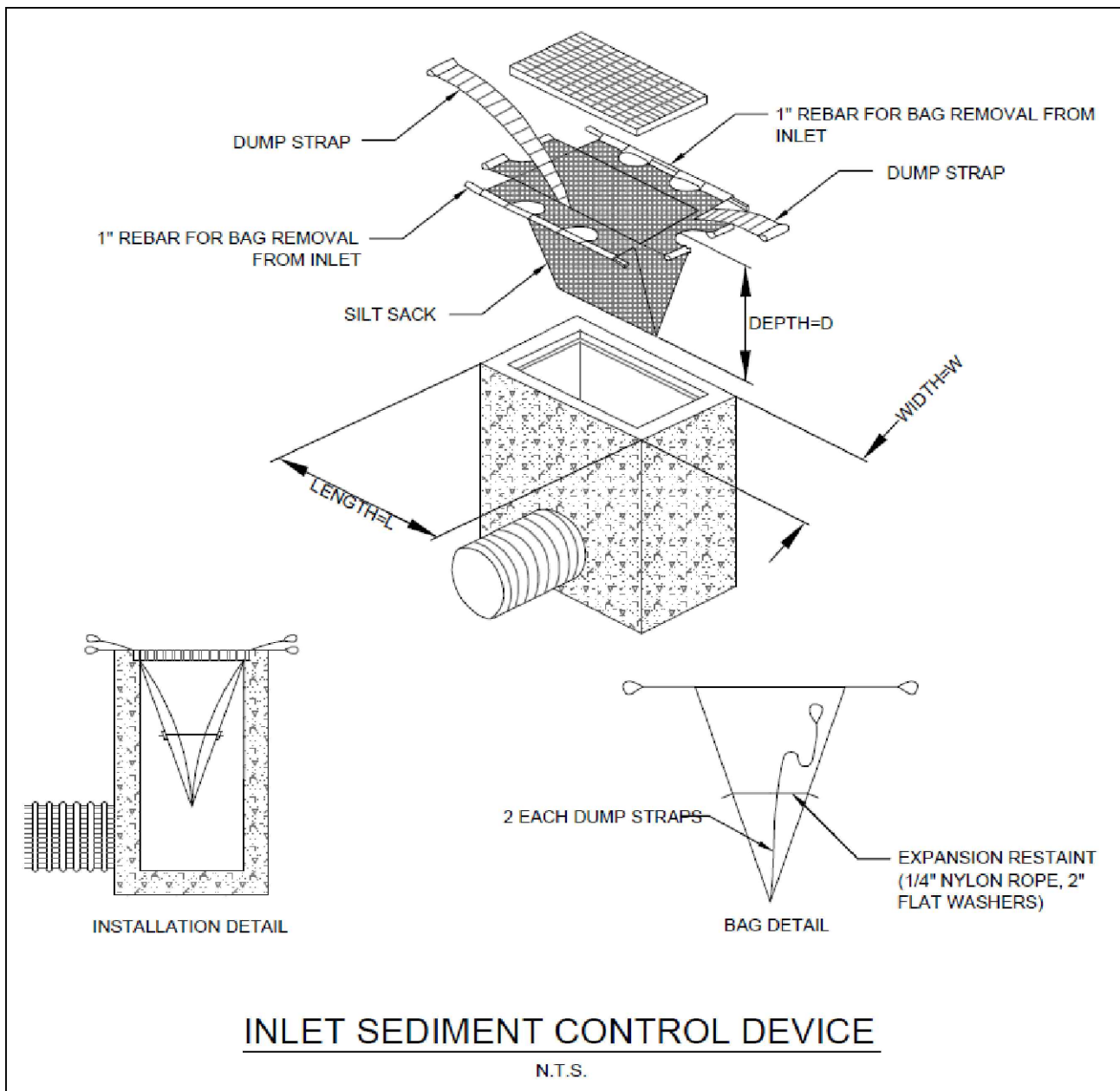

LEGEND

	BARRIER CURB CURB DEPRESSION		SILT FENCE (AS PER OPSPD 219 130)
	MOUNTABLE CURB		STRAW BALE CHECK DAM (AS PER OPSPD 219 180)
	EASEMENT		BUILDING ENTRANCES (MAIN, SIDE, OVERHEAD)
	HEAVY DUTY ASPHALT		
	CONCRETE SIDEWALK		
	PAVING STONE		
	STORM MANHOLE		
	CATCHBASIN OR DITCH INLET		
	LANDSCAPE CATCHBASIN		
	SANITARY MANHOLE		
	PERFORATED PIPE IN SWALES		
	WATER VALVE/CHAMBER		
	FIRE HYDRANT		
	CENTRELINE OF SWALE		
	SLOPING AT 3:1 (UNLESS SPECIFIED)		
	PROPOSED ELEVATION		
	EXISTING ELEVATION		
	SWALE ELEVATION		
	TOP OF WALL ELEVATION		
	BOTTOM OF WALL ELEVATION		
	EMERGENCY OVERLAND FLOW ROUTE		

FOR REVIEW ONLY
NOT FOR CONSTRUCTION

3	REVISED AS PER SITE PLAN ADDITIONS	NOV. 19, 2018
2	REVISED AS PER CITY COMMENTS	SEPT. 18, 2018
1	ISSUED FOR SITE PLAN CONTROL	JUN. 25, 2018
No.	Revisions	Date

Check and verify all dimensions before proceeding with the work	Do not scale drawings
---	-----------------------

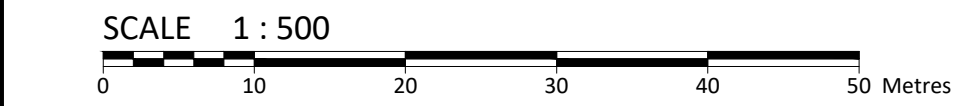

McINTOSH PERRY
115 Walgreen Road, RR3, Carp, ON K0A 1L0
Tel: 613-836-2184 Fax: 613-836-3742
www.mcintoshperry.com

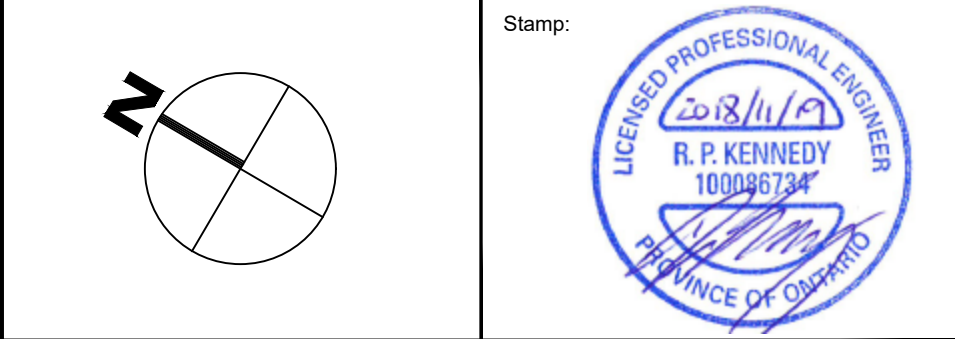

Client: **BBS CONSTRUCTION LTD.**
1805 WOODWARD DRIVE
OTTAWA, ON K2C 0P9

Project:

BARRHAVEN FORD
555 DEALERSHIP DRIVE

Drawing Title:

SITE GRADING, DRAINAGE AND
SEDIMENT & EROSION CONTROL PLAN

Scale:	1:500	Project Number:	CP-18-0254
Drawn By:	P.G.K.		
Checked By:	R.P.K.	Drawing Number:	C101
Designed By:	P.G.K.		