

NOTE: WATERMAIN CONNECTION BY CITY FORCES EXCAVATION, BACKFILLING AND REINSTATEMENT BY CONTRACTOR

PRICES FOR MATERIALS AND LABOR REFER TO TCR BY IFS

13  
12  
11  
10  
9  
8  
7  
6  
5  
4  
3  
2  
1

Turf - Sod 1.2m Wide at Pavement Edge Then Hydro Seed and 150mm Topsoil Typical

Turf - Sod 1.2m Wide at Pavement Edge Then Hydro Seed and 150mm Topsoil Typical

Turf - Sod 1.2m Wide at Pavement Edge Then Hydro Seed and 150mm Topsoil Typical

Turf - Sod 1.2m Wide at Pavement Edge Then Hydro Seed and 150mm Topsoil Typical

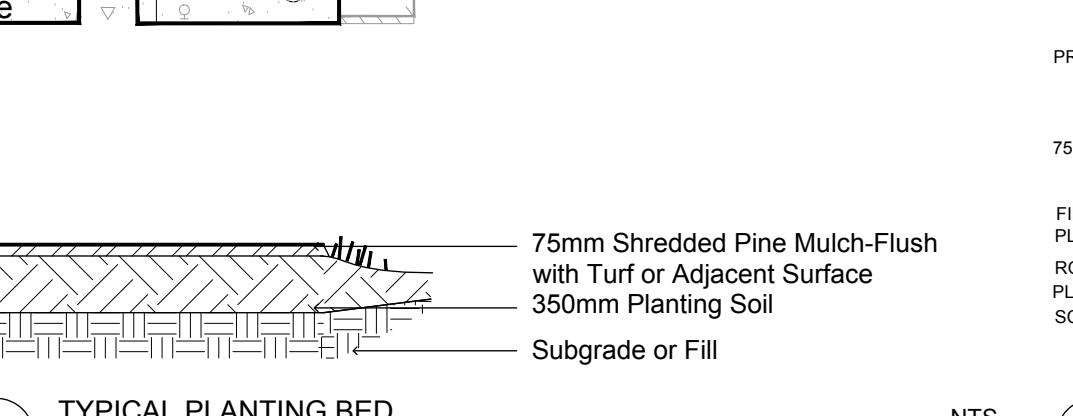
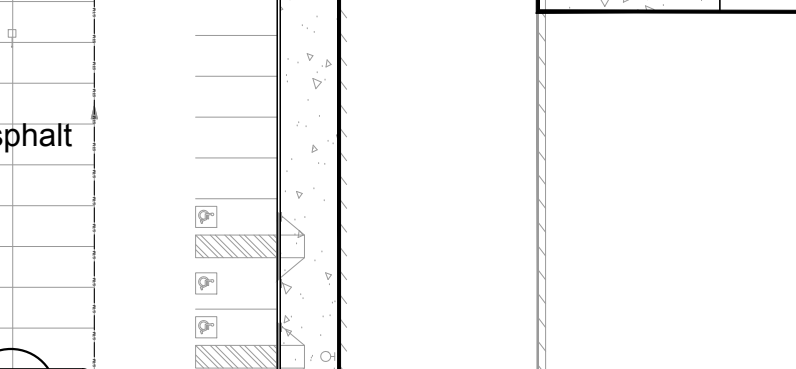

During Excavation/Bed Preparation if Extreme Conditions are Encountered (Water, Rock, Gravel...) that Could Effect the Planting, Notify GJALA Immediately.

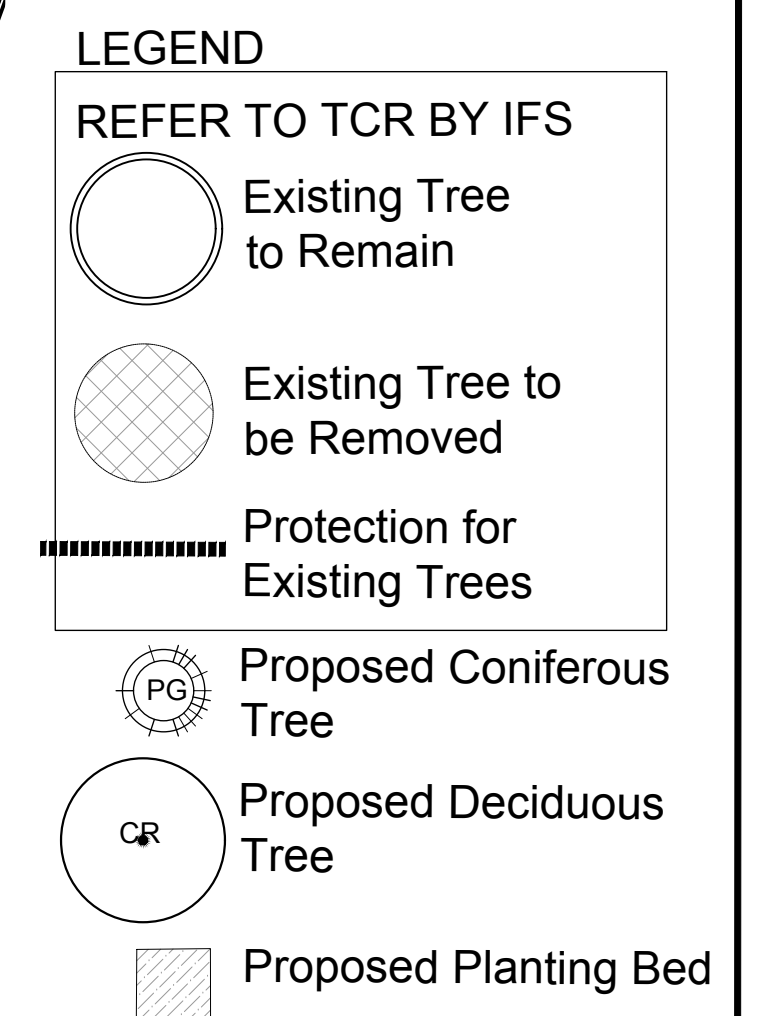

TURF AREAS TO BE SOD/SEED C/W 150MM DEPTH TOPSOIL ON APPROVED SUBGRADE. SOD TO BE NUMBER ONE GRADE TURFGRASS NURSERY SOD per NSGA - Fine Fescue/Kentucky Bluegrass Sod. PLANTING MIX TO BE APPROVED BY LANDSCAPE ARCHITECT. ALL PLANT MATERIAL TO MEET CNLA STANDARDS, AND BE APPROVED BY LANDSCAPE ARCHITECT PRIOR TO PLANTING. REFER TO CIVIL ENGINEER'S DRAWING FOR ELEVATIONS / GRADING. ALL WORK TO INCLUDE 1 YEAR WARRANTY FROM DATE OF FINAL ACCEPTANCE. MAINTAIN ALL LANDSCAPE AREAS UNTIL FINAL ACCEPTANCE, INCLUDING MOWING OF TURF, WEEDING OF BEDS, WATERING, SWEEPING HARD SURFACES. PROVIDE WATERING OF ALL PLANT MATERIAL AS REQUIRED FOR PROPER ESTABLISHMENT, UNTIL END OF WARRANTY PERIOD.

The Landscape Plan is to be read in conjunction with the grading and survey plan, underground services engineering drawings, construction details and contract documents and cannot be used for construction until signed by the landscape architect. Bare root material to be planted in season only. All plant material locations to be staked on site by the landscape contractor and checked by the landscape architect prior to planting. All trees to be preserved on or directly adjacent to the site will be protected. Plant material are to be installed a minimum of; 3.0m away from any part of any hydro transformer, 3.0m corridor between a fire hydrant and the curb, a 2.5m radius beside or behind a fire hydrant, 2.0m from any servicing/utility line or structure.

Drawing Remains the Property of Gino J. Aiello Landscape Architect. Copyright Reserved by Gino J. Aiello Landscape Architect. Do Not Use or Reproduce Without Approval of Gino J. Aiello. Do Not Use For Construction Unless Signed By Landscape Architect. Contractor is Responsible for Verification of Site Locations of all Utilities. Report any Discrepancies Between Site and Drawing Immediately to Gino J. Aiello.

3	FOR SPC SECOND SUBMISSION	JANUARY 15 2019
2	FOR SPC FIRST SUBMISSION	September 11 2018
1	FOR COORDINATION	September 5 2018
No.	Revision	Date

Property Owner  
 Tannis  
 Sysco - Tannis  
 2390 Stevenage Drive  
 Ottawa, ON K1G 3W3

Gino J. Aiello landscape architect  
 www.GJALA.com  
 Gino@GJALA.com (613) 852 1343  
 110 Didsbury Road Unit # 9 | Ottawa Ontario | K2T 0C2

Project **SITE & BUILDING EXPANSION**  
 2390 Stevenage Drive  
 Drawing **Landscape Plan**

Date: SEPTEMBER 2018  
 Scale: 1:500  
 City of Ottawa  
 Dwg - #17811

Sheet Number  
**L1**  
 D07-12-18-0135

Code	Qty	Botanical Name	Common Name	Size	Condition
AC	2	Amelanchier canadensis	Tree Serviceberry	60mm cal. B	B specimen
AF	2	Acer pseudoplatanus	Autumn Blaze Freeman Maple	60mm cal. B	B specimen
AR	3	Acer rubrum	Red Maple	60mm cal. B	B specimen
AS	1	Acer saccharum	Sugar Maple	60mm cal. B	B specimen
CO	2	Cornus occidentalis	Common Hackberry	60mm cal. B	B specimen
CS	2	Cornus rugosa	Common Dogwood	60mm cal. B	B specimen
GS	2	Geonoma sp.	Geonoma sp.	60mm cal. B	B specimen
LD	2	Lonicera xylosteum	Mahoe	60mm cal. B	B specimen
OP	2	Opuntia sp.	Pink Cholla	60mm cal. B	B specimen
QA	2	Quercus sp.	Red Oak	60mm cal. B	B specimen
RR	2	Rubus sp.	Red Raspberry	60mm cal. B	B specimen
SA	3	Salix sp.	Sweet Birch	1.5m H. B	B specimen
ST	3	Staphylea trifolia	Eastern Red Cedar	1.5m H. B	B specimen
TA	3	Taxus canadensis	Eastern Larch / Tamarack	1.5m H. B	B specimen
TR	3	Thuja occidentalis	White Spruce	1.5m H. B	B specimen
VA	3	Viburnum sp.	White Pine	1.5m H. B	B specimen