

JAVA STREET



OTTAWA-CARLETON DISTRICT SCHOOL BOARD

CONSULTANTS  
ARCHITECTS:  
**EDWARD J. CUHACI & ASSOCIATES ARCHITECTS INC.**  
171 Slater St, Suite 100, Ottawa, Ontario, K1P 5H7  
Fax: (613) 236-1844 Telephone: (613) 236-7135 E-mail: info@ecuaci.com

CIVIL ENGINEERS:  
**Jp2g Consultants Inc.**  
ENGINEERS - PLANNERS - PROJECT MANAGERS  
1150 MORRISON DRIVE, SUITE 410, OTTAWA, ON K2H 8S9  
PHONE: 613-428-7800 FAX: 613-428-2000

LEGEND

	EXISTING TREE TO REMAIN
	EXISTING TREE TO BE REMOVED
	PROPOSED SODDED GRASS AREA
	PROPOSED ENGINEERED WOOD FIBRE
	PROPOSED ASPHALT
	PROPOSED CONCRETE
	PROPOSED DECIDUOUS TREE
	PROPOSED TREE PROTECTION FENCE

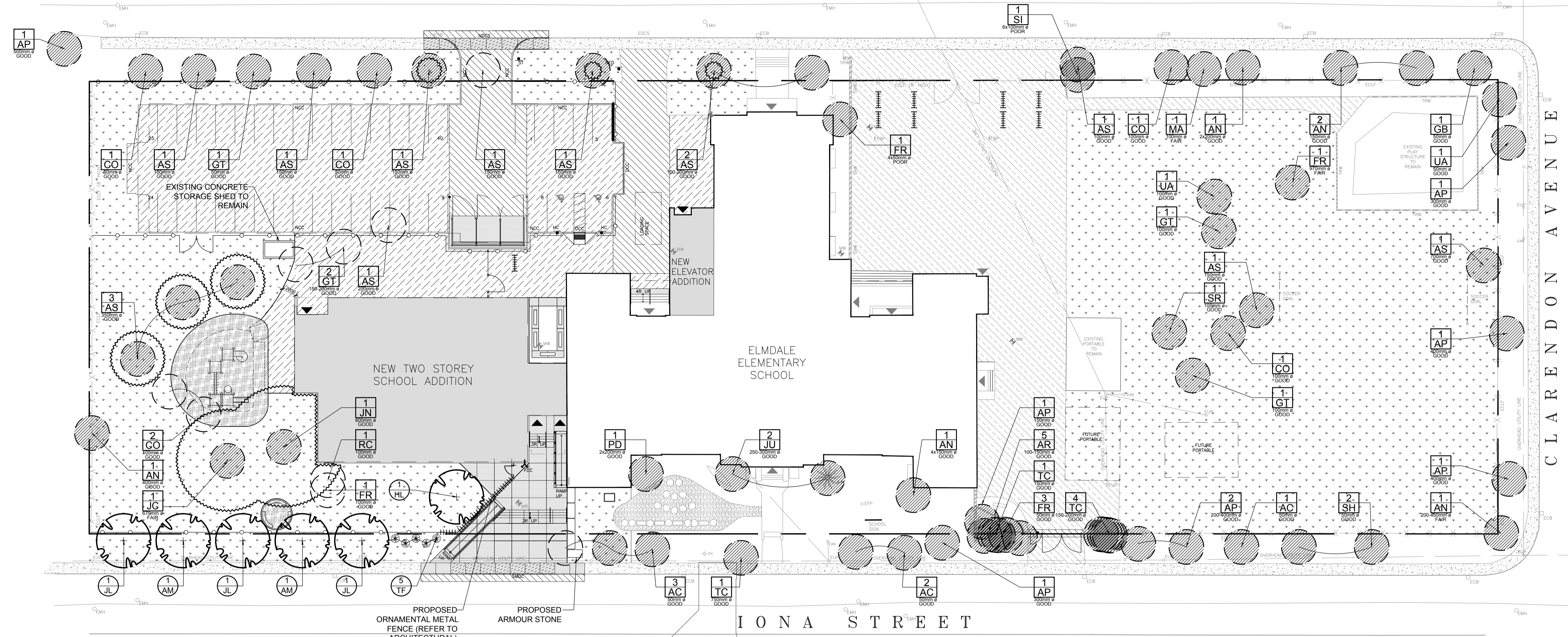

1 TREE CONSERVATION REPORT & LANDSCAPE PLAN  
L.1 SCALE 1:300

PROPOSED PLANT LIST						
KEY	QTY	BOTANICAL NAME	COMMON NAME	SIZE	CONDITION	REMARKS
<b>TREES</b>						
AM	2	Acer ginnala	Amur Maple	60mmø	B&B	Space 8000mm O.C.
HL	1	Gleditsia triacanthos	Honey Locust	60mmø	B&B	Space 8000mm O.C.
JL	3	Syringa reticulata	Japanese Tree Lilac	60mmø	B&B	Space 8000mm O.C.
TF	5	Thuja occidentalis 'Fastigiata'	Pyramidal Cedar	1500mm Ht.	B&B	Space 600mm O.C.
<b>EXISTING TREE LIST</b>						
KEY	QTY	BOTANICAL NAME	COMMON NAME	SIZE	CONDITION	REMARKS
<b>TREES</b>						
AC	6	Amelanchier canadensis	Serviceberry	50mmø	Good	See Plan
AN	6	Acer negundo	Manitoba Maple	150-450mmø	Fair-Good	See Plan
AP	8	Acer platanoides	Norway Maple	150-500mmø	Good	See Plan
AR	5	Acer rubrum	Red Maple	100-150mmø	Good	See Plan
AS	14	Acer saccharum	Sugar Maple	150-700mmø	Good	See Plan
CO	6	Celtis occidentalis	Hackberry	50-100mmø	Good	See Plan
JU	2	Juniperus sp.	Juniper	250-300mmø	Good	See Plan
FR	6	Fraxinus sp.	Ash	50-970mmø	Fair-Good	See Plan
GB	1	Ginkgo biloba	Maidenhair Tree	50mmø	Good	See Plan
GT	5	Gleditsia triacanthos	Honey Locust	50-100mmø	Good	See Plan
JC	1	Juglans x hybrida	Butternut Hybrid	670mmø	Fair	See Plan
JN	1	Juglans nigra	Black Walnut	600mmø	Good	See Plan
MA	1	Malus sp.	Crabapple	100mmø	Fair	See Plan
PD	1	Populus deltoides	Eastern Cottonwood	2x200mmø	Good	See Plan
RC	1	Rhamnus cathartica	Common Buckthorn	100mmø	Good	See Plan
SI	1	Acer saccharinum	Silver Maple	6x100mmø	Poor	See Plan
SH	2	Sorbus x hybrida	Oakleaf Mountain Ash	50mmø	Good	See Plan
SR	1	Syringa reticulata	Japanese Tree Lilac	100mmø	Good	See Plan
TC	6	Tilia cordata	Littleleaf Linden	150-750mmø	Good	See Plan
UA	2	Ulmus americana	American Elm	100mmø	Good	See Plan

- GENERAL NOTES:**
- It is the responsibility of the appropriate contractor or official to report any errors, omissions or discrepancies on this plan with actual site conditions to the Landscape Architect before proceeding with construction.
  - The contractor is to notify all utility companies and authorities prior to any excavation and ascertain locations of underground services.
  - The contractor is to reinstate all areas and items damaged as a result of construction activity.
  - The contractor is to comply with all pertinent codes and by-laws.
  - The contractor is to maintain a positive surface run-off throughout the entire construction period.
  - The Landscape Architect is not responsible for subsurface conditions.
  - The contractor is to identify all existing trees to remain on site with the Landscape Architect prior to construction.
  - The contractor is to stake the proposed location of all plant material in conjunction with the Landscape Architect prior to excavation.
  - Minimum distances for selected deciduous trees are as follows:
    - Building Foundations 7.5m
    - Sidewalks 1.5m
    - Public Streets 2.5m
    - Underground Infrastructure 2.0m
  - All trees within 1m of underground utility trenches are to be excavated by hand.
  - Remove all protective wrapping from tree trunks after installation.
  - Staking of trees shall only be performed if necessary.
  - Ensure that mulch is pulled back a min. distance of 75mm from base of tree trunk.

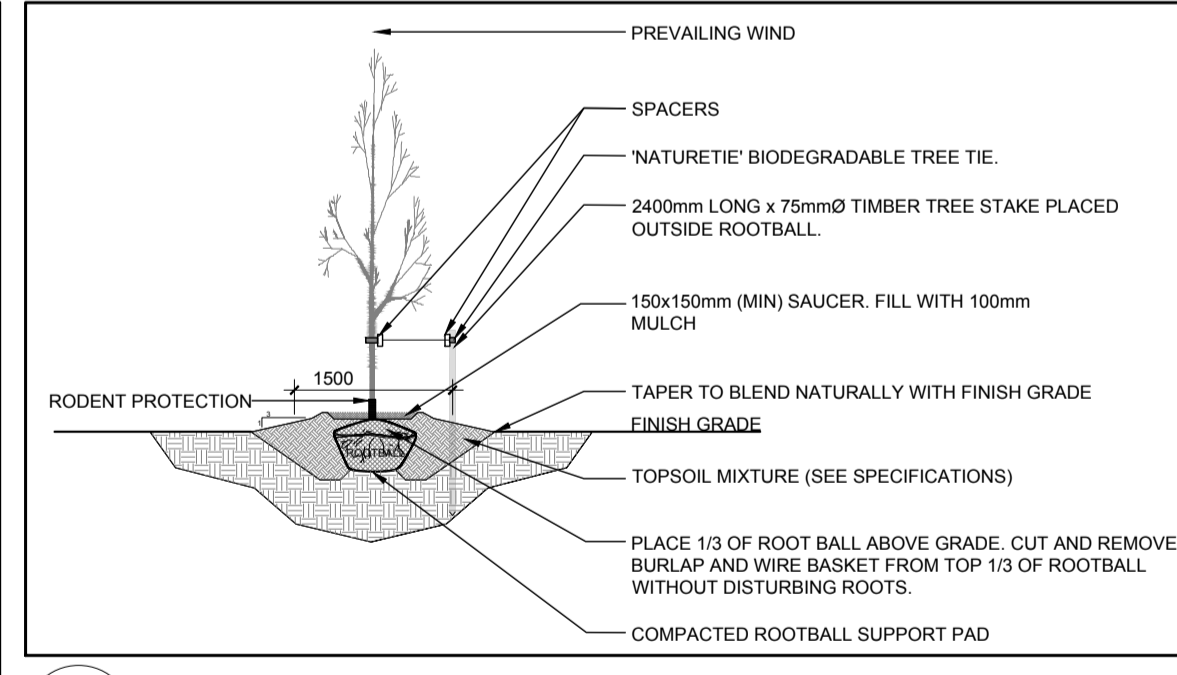

2 DECIDUOUS TREE PLANTING  
L.1 SCALE: NTS

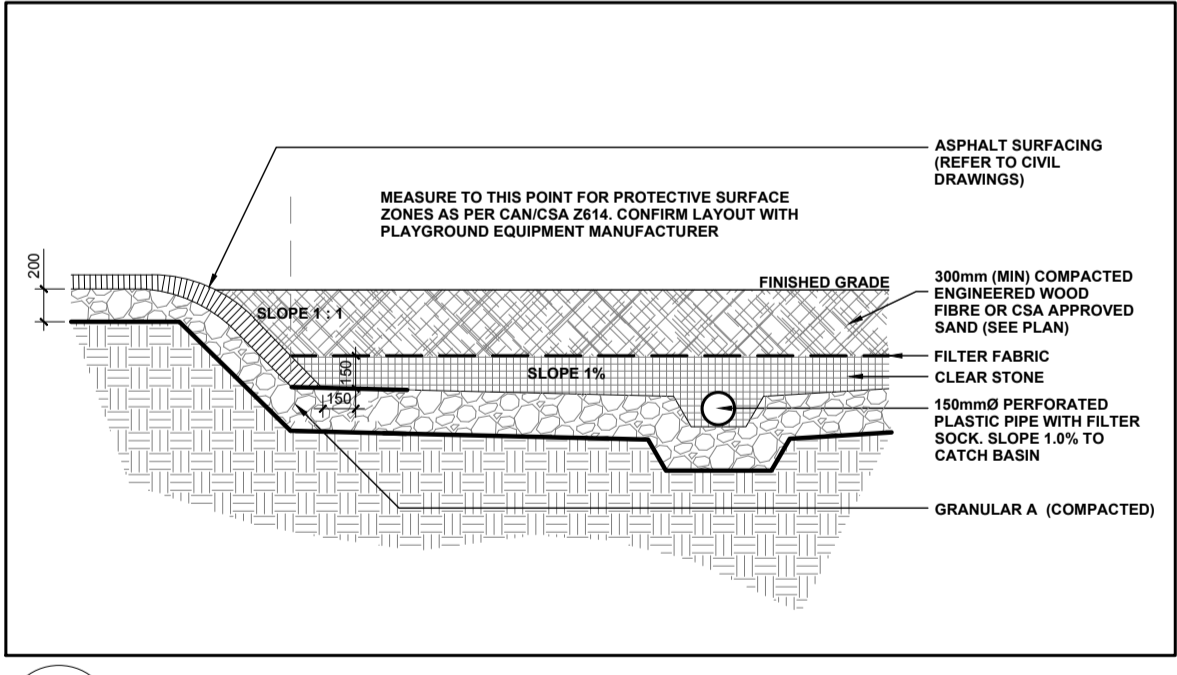

4 PLAY AREA C/W ASPHALT RAMP EDGE  
L.1 SCALE: NTS

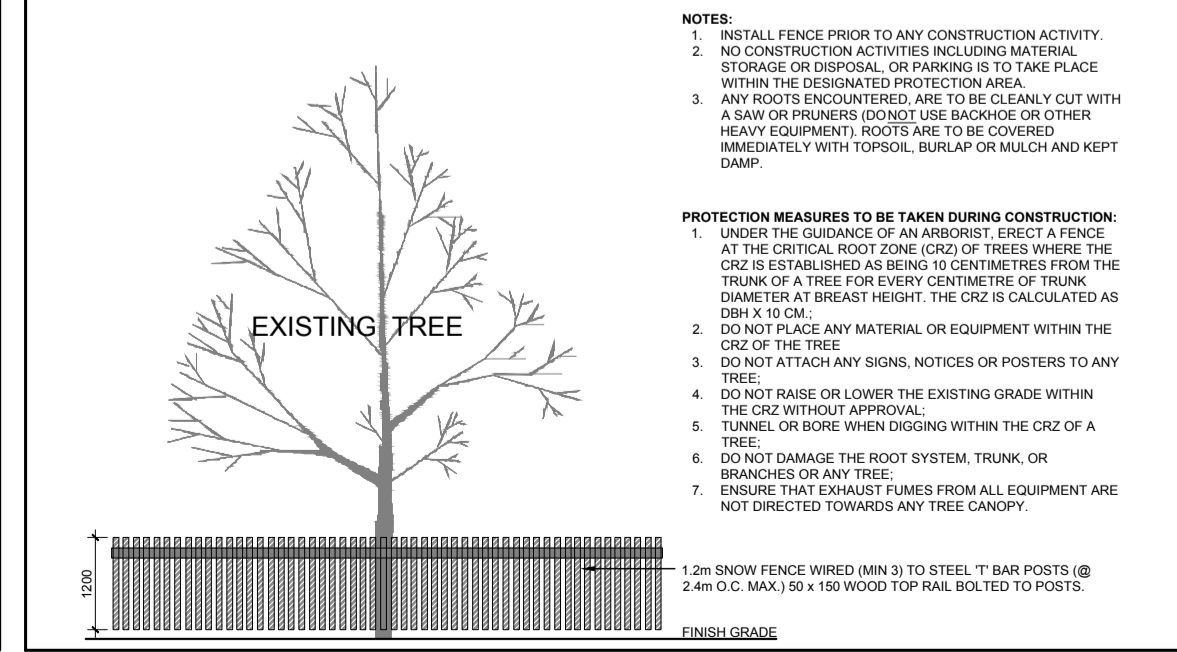

3 TREE PROTECTION FENCE  
L.1 SCALE: NTS

1	ISSUED FOR SITE PLAN CONTROL	12/18/2018	ML	JL
No.	Issue	Date	DR	CK

**JAMES B. LENNOX & ASSOCIATES INC.**  
LANDSCAPE ARCHITECTS  
3332 CARLING AVE. OTTAWA, ONTARIO K2H 5A8  
Tel. (613) 722-5168 Fax. (1-866) 343-3942

PROJECT  
ELMDALE PUBLIC SCHOOL ADDITION AND RENOVATION  
49 IONA STREET, OTTAWA ONTARIO

DRAWING  
TREE CONSERVATION REPORT & LANDSCAPE PLAN

	SCALE	AS SHOWN
	START DATE	DECEMBER 2018
	PROJECT NO.	18-EJC-1875

PROJECT NORTH

DRAWING NO.  
**L.1**  
PLOT SIZE A1