

**Q4 ARCHITECTS INC.**

271 Avenue Road  
Suite 302, Toronto ON  
M5M 4B4  
T: 416.322.6354  
F: 416.322.7294  
E: info@q4architects.com



The contractor / builder must verify all dimensions on the job and report any discrepancy to the designer before proceeding with the work.  
Drawings are NOT to be scaled. All drawings and specifications are instruments of service and the copyright property of the designer and must be returned upon request.

Q4 Architects Inc. retains the copyright in all drawings, plans, sketches, and all digital information. They may not be copied or used for any other projects or purposes or distributed without the written consent of Q4 Architects Inc.

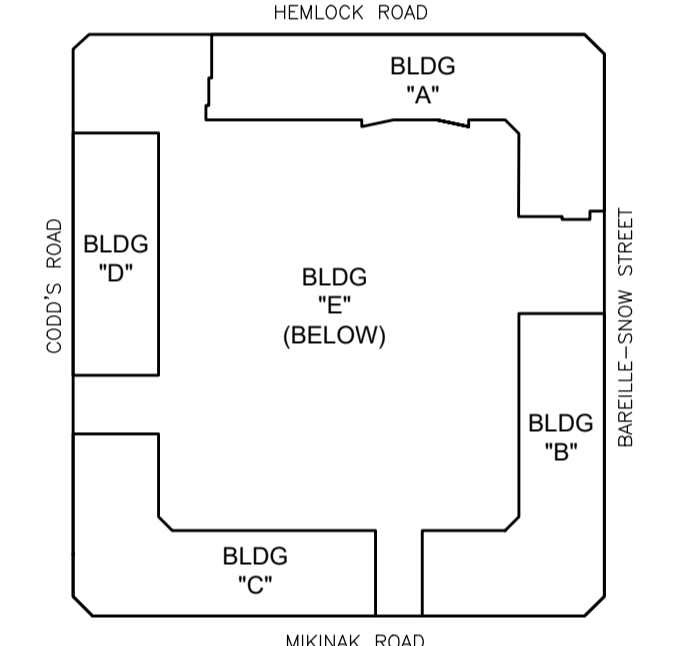

**KEY PLAN**

1 ISSUED FOR SPA NO. 1 2018-04-27

Revision Chart  
Project Title

**WATERIDGE BLOCK 19**

Location  
**CODD'S ST.**  
Client



Project No. 17045  
Scale 1:250  
Drawn By MT  
Checked By MT

**PARKADE PLAN**

Sheet Title

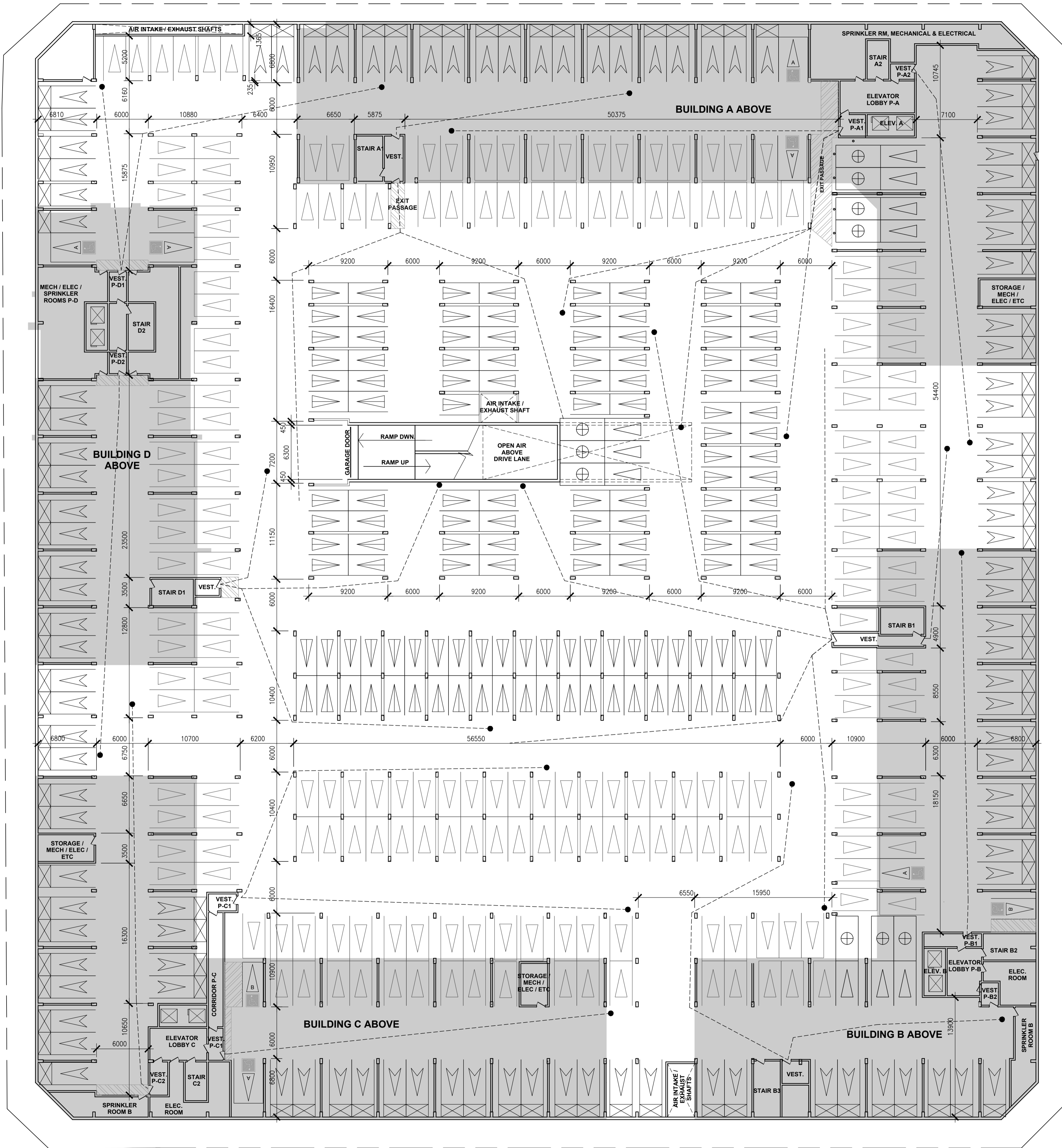

**SYMBOLS LEGEND**

	5 YARD ROLLING GARBAGE BINS		INTERIOR VERT. BIKE SPACE 1.04 L X 0.6W X 1.5H
	PROPOSED LOCATION FOR NEW TREES		INTERIOR BIKE SPACE 1.8L X 0.6W X 1.9H
	BIKE ROUTE MARKERS		EXTERIOR BIKE SPACE 1.8L X 0.6W X 1.9H
	PRIMARY RESIDENTIAL ENTRANCE		COMMON ENTRANCES
	SERVICE ENTRANCES		BH### BOREHOLE LOCATION
	BH### BOREHOLE LOCATION WITH MONITORING WELL		TP### TEST PIT LOCATION
	TP### TEST PIT LOCATION BY OTHERS		BH### BOREHOLE LOCATION (DST.2015)

**PARKING DISTRIBUTION**

<b>32 SPACES</b>	<b>ON GRADE</b>		PARALLEL PARKING SPACE 6.7M X 2.6M
<b>8 SPACES</b>			LOADING SPACE 9M X 3.5M
<b>200 SPACES</b>	<b>29 SPACES</b>		REGULAR PARKING SPACE 5.2M X 2.6M
<b>6 SPACES</b>			"A" TYPE ACCESSIBLE SPACE 5.2M X 3.4M
<b>2 SPACES</b>	<b>6 SPACES</b>		"B" TYPE ACCESSIBLE SPACE 5.2M X 2.4M
<b>105 SPACES</b>			REGULAR PARKING SPACE WITH STORAGE IN FRONT 5.2M X 2.6M + 5.2M X 1.47M STOR.
<b>129 SPACES</b>			REDUCED PARKING SPACE 4.6M X 2.4M
<b>10 SPACES</b>			REGULAR PARKING SPACE WITH TANDEM SPACE 5.2M X 2.6M + 5.2M X 2.6M

FRONT LOADING GARBAGE TRUCK WITH 18M REVERSING LANE